

Falcon™ Computer Workstation

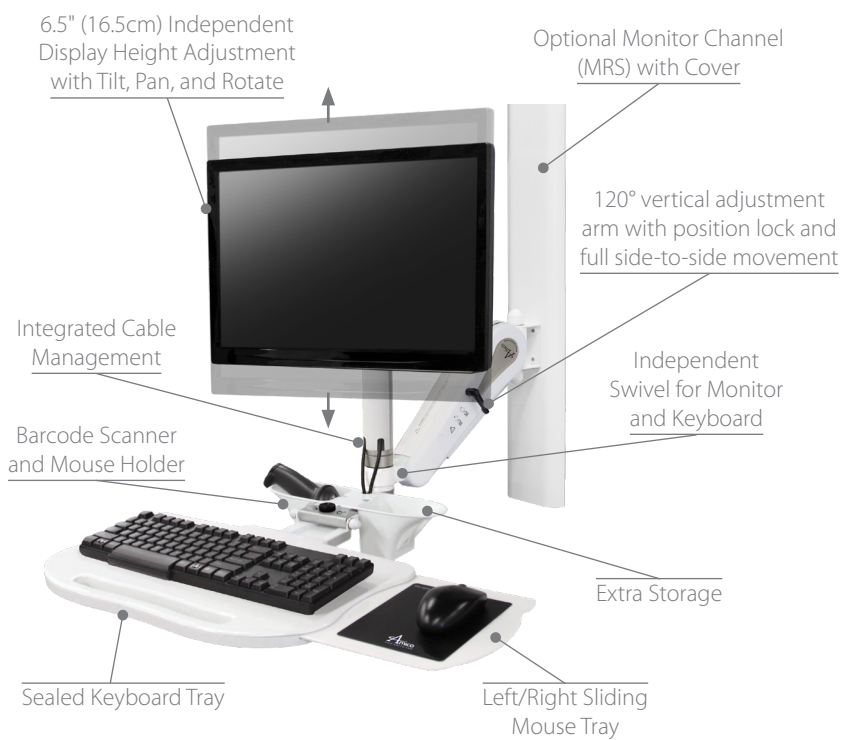

Features:

- Independent LCD height adjustment 6.5" (16.5 cm)
- Entire workstation folds back to as little as 9" (22.9 cm) from wall for storage when not in use
- Includes both 75/100 VESA mounting options with easy installation slots
- Intelligent cable management systems on arm, wall channel, and post
- Optional CPU mounts available
- Negative tilt keyboard adjustment
- Completely sealed keyboard tray for better infection control
- Easy access to barcode scanner and mouse holders
- Conveniently and ergonomically position your monitor and keyboard for maximum productivity, comfort, and patient to caregiver eye contact
- Can easily adjust from sitting to standing in one smooth motion
- 120° vertical arm adjustment with position lock and full side-to-side movement
- Overall vertical adjustment range can accommodate users of any height 17" (43.2 cm)
- Counterbalanced to provide effortless movement
- Durable aluminum construction

Falcon with SideKick Secondary Surface



Sidekick Features:

- Integrated LED keyboard light with touch switch
- Large work surface with spill guard edge
- Magnetic whiteboard surface
- Lightweight, flip up with one hand

Optional Folding Extensions



NOTE: Dimensions are exact to within 0.5" (1.2 cm)

Falcon Ordering Guide

AHM-FIT

Color

W
White ☐

X
Custom ☒

Keyboard Tray



F
Falcon



M
Mini



X
Custom



D
Sidekick Secondary Surface

Additional Extension Length

0

No Extension



7

6" (15.2 cm) Extension



3

9" (22.9 cm) Extension



1

12" (30.5 cm) Extension



5

16" (40.6 cm) Extension

Spring Strength

25

5.5-8 lbs (2.5-3.6 kg) Monitors

35

7.5-10 lbs (3.4-4.5 kg) Monitors

50

13-15.5 lbs (5.8-7 kg) Monitors

60 **

15.5-16.7 lbs (7-7.6 kg) Monitors

65 ***

16.7-18 lbs (7.6-8.1 kg) Monitors

75

18-22 lbs (8.1-10 kg) Monitors

XX

Custom

For Monitors > 22 lbs (10 kg) or Fixed Height

** Add MON-LCD-HANDLE for displays between 10-13 lbs (4.5-5.8 kg)

*** Maximum

Track Adapter



M
Monitor Channel



AB
*Amico Horizontal Direct Mount - Bottom



AT
*Amico Horizontal Direct Mount - Top



V
*Amico Vertical Direct Mount



G
*Hill-Rom Vertical Direct Mount



D
Datex/Ohmeda, Dovetail Direct Mount

Extension Type



F
Folding



R
Reverse Folding

5
N/A (No Extension)

NOTE: All dimensions are not exact.

See page 4 for Accessories

* Direct mount options not available with extensions.

Falcon Dimensions and Movement Range

With No Extension

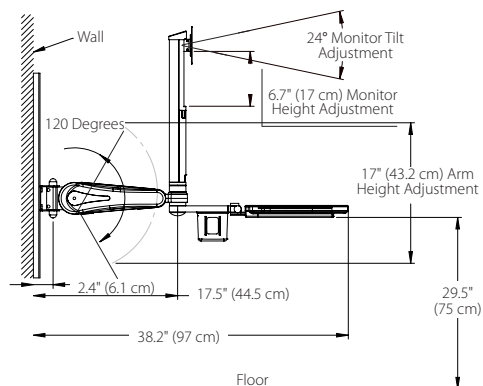

Extended Position

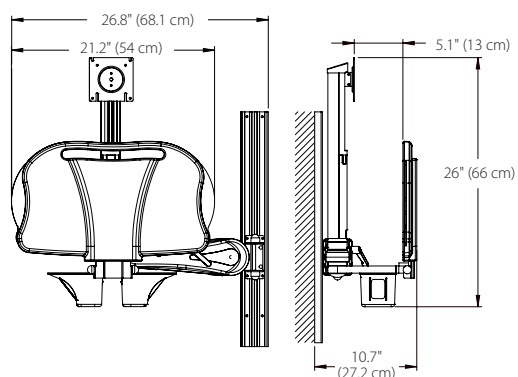

Folded Position

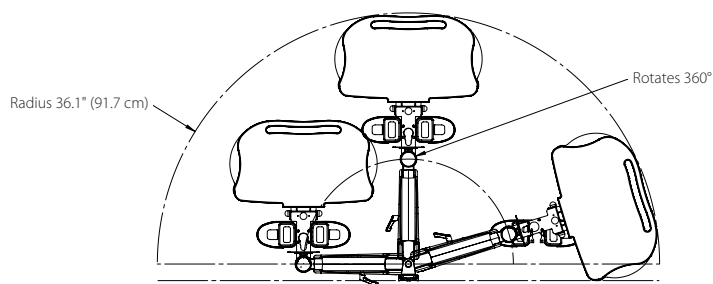

NOTE: Mouse tray may add 7" (17.8 cm) on either side when extended. All measurements are made with the arm in horizontal position.

With Optional Extensions

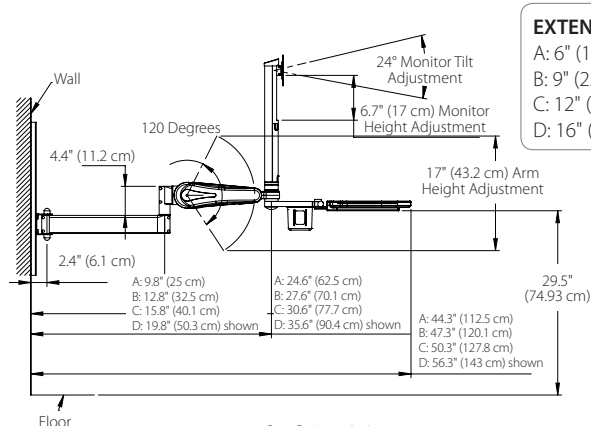

Extended Position

EXTENSIONS

- A: 6" (15.2 cm)
- B: 9" (22.9 cm)
- C: 12" (30.5 cm)
- D: 16" (40.6 cm)

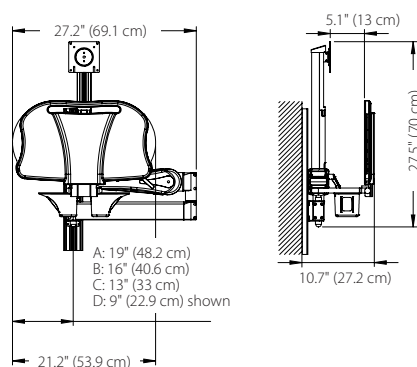

Folded Position

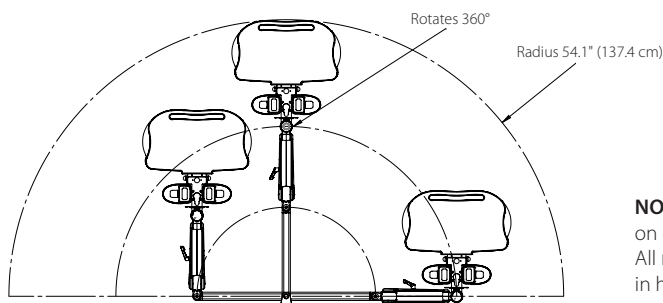

NOTE: Mouse tray may add 7" (17.8 cm) on either side when extended. All measurements are made with the arm in horizontal position.

NOTE: All dimensions are not exact.

Falcon Accessories

Power Bar



- Hospital grade, 4 power outlets
- 120 VAC, 60Hz
- MON Adapter

Part Number: PWRBAR4-MON

Power Holder



- Holds most power adapters for PCs, patient monitors, and LCDs
- MON Adapter

Part Number: PWRHLD-MON

Cord Wrap



- Ideal for managing wires and cords

Part Number: CORDWRAP

LCD Handle



- Ergonomic handles can be added to any Amico LCD mount
- Knuckle guard protects walls and user's hands
- Weight: 4.3 lbs (2 kg)

Part Number: MON-LCD-HANDLE

Monitor Channel



- Standard wall channel 34" (86.4 cm)
- Seismic options and custom lengths available (ask sales rep for details)

Part Number: MRS-S034

Channel Covers



- Easy way to hide wires
- Available in patterns and colors to match any decor

Call for part number.

Wire Baskets



10" W x 06" D x 09" H
(25.4 cm x 15.2 cm x 22.9 cm)
White wire basket
MON Adapter
Part No: 100609-MON-BB



13" W x 09" D x 07" H
(33 cm x 22.9 cm x 17.8 cm)
BP cuff basket
MON Adapter
Part No: CUFBASK-MON

All baskets can be sterilized

Printer Mounts



- Mounts most portable printers to conveniently print at the bedside

CPU Mounts



Adjustable

1.5" - 3" (3.8 cm - 7.6 cm)
Part No: CPUMNT1-MON

1.5" - 7" (3.8 cm - 17.8 cm)
Part No: CPUMNTA-MON

7" - 9.5" (17.8 cm - 24.1 cm)
Part No: CPUMNT4-MON



Thin Client Mount behind LCD

10" x 10" x 1.75"
(25.4 cm x 25.4 cm x 4.4 cm)

10" x 10" x 3"
(25.4 cm x 25.4 cm x 7.6 cm)



Enclosed CPU Mount



Tangent Rugged Mini Mount

NOTE: All dimensions are not exact.
* Includes MON Adapter.

Please visit www.amico.com for all technical specifications, installation instructions, detailed AutoCAD drawings, and more Mounting Solutions.



Distributed By:



Amico Accessories Inc. 85 Fulton Way, Richmond Hill, ON L4B 2N4, Canada
Toll Free Tel: 1.877.264.2697 | Tel: 905.763.7778 | Fax: 905.763.8587
www.amico.com