

SITE DEVELOPMENT PLANS

HARBOR FREIGHT TOOLS

388 ROUTE 59
NYACK, NEW YORK, 10960

GENERAL NOTES:

A. TOPOGRAPHIC BOUNDARY SURVEY, INCLUDING PROPERTY LINES, LEGAL DESCRIPTION, EXISTING UTILITIES, SITE TOPOGRAPHY WITH SPOT ELEVATIONS, OUTSTANDING PHYSICAL FEATURES AND EXISTING STRUCTURE LOCATIONS WAS PROVIDED BY THE FOLLOWING COMPANY, AS A CONTRACTOR TO THE SELLER/OWNER:

TOPOGRAPHY: AREK SURVEYING PC,
10 TAFT PL
ALBERTSON, NY 11507
(516) 792-6676

CEI ENGINEERING AND ITS ASSOCIATES WILL NOT BE HELD RESPONSIBLE FOR THE ACCURACY OF THE SURVEY OR FOR DESIGN ERRORS OR OMISSIONS RESULTING FROM SURVEY INACCURACIES.

B. ALL PHASES OF SITE WORK FOR THIS PROJECT SHALL MEET OR EXCEED THE OWNER / DEVELOPER SITE WORK SPECIFICATIONS.

C. CONTRACTOR SHALL BE RESPONSIBLE FOR THE REMOVAL OF EXISTING STRUCTURES, RELATED UTILITIES, PAVING, UNDERGROUND STORAGE TANKS AND ANY OTHER EXISTING IMPROVEMENTS AS NOTED. SEE SITE WORK SPECIFICATIONS.

D. CONTRACTOR IS TO REMOVE AND DISPOSE OF ALL DEBRIS, RUBBISH AND OTHER MATERIALS RESULTING FROM PREVIOUS AND CURRENT DEMOLITION OPERATIONS. DISPOSAL WILL BE IN ACCORDANCE WITH ALL LOCAL, STATE AND/OR FEDERAL REGULATIONS GOVERNING SUCH OPERATIONS.

E. THE GENERAL CONTRACTOR WILL BE HELD SOLELY RESPONSIBLE FOR AND SHALL TAKE ALL PRECAUTIONS NECESSARY TO AVOID PROPERTY DAMAGE TO ADJACENT PROPERTIES DURING THE CONSTRUCTION PHASES OF THIS PROJECT.

F. WARRANTY/DISCLAIMER: THE DESIGNS REPRESENTED IN THESE PLANS ARE IN ACCORDANCE WITH ESTABLISHED PRACTICES OF CIVIL ENGINEERING FOR THE DESIGN FUNCTIONS AND USES INTENDED BY THE OWNER AT THIS TIME. HOWEVER, NEITHER THE ENGINEER NOR ITS PERSONNEL CAN OR DO WARRANT THESE DESIGNS OR PLANS AS CONSTRUCTED EXCEPT IN THE SPECIFIC CASES WHERE THE ENGINEER INSPECTS AND CONTROLS THE PHYSICAL CONSTRUCTION ON A CONTEMPORANEOUS BASIS AT THE SITE.

G. SAFETY NOTICE TO CONTRACTOR: IN ACCORDANCE WITH GENERALLY ACCEPTED CONSTRUCTION PRACTICES, THE CONTRACTOR SHALL BE SOLELY AND COMPLETELY RESPONSIBLE FOR CONDITIONS OF THE JOB SITE, INCLUDING SAFETY OF ALL PERSONS AND PROPERTY DURING PERFORMANCE OF THE WORK. THIS REQUIREMENT WILL APPLY CONTINUOUSLY AND NOT BE LIMITED TO NORMAL WORKING HOURS. ANY CONSTRUCTION OBSERVATION BY THE ENGINEER OF THE CONTRACTOR'S PERFORMANCE IS NOT INTENDED TO INCLUDE REVIEW OF THE ADEQUACY OF THE CONTRACTOR'S SAFETY MEASURES, IN, ON OR NEAR THE CONSTRUCTION SITE.

H. ALL CONSTRUCTION IN STATE HIGHWAY DEPARTMENT RIGHT-OF-WAY SHALL BE COORDINATED WITH THE HIGHWAY DEPARTMENT RESIDENT ENGINEER.

I. WETLANDS NOTE: ANY DEVELOPMENT, EXCAVATION, CONSTRUCTION, OR FILLING IN A U.S. CORPS OF ENGINEERS DESIGNATED WETLAND IS SUBJECT TO LOCAL, STATE AND FEDERAL APPROVALS. THE CONTRACTOR SHALL COMPLY WITH ALL PERMIT REQUIREMENTS AND/OR RESTRICTIONS AND ANY VIOLATION WILL BE SUBJECT TO FEDERAL PENALTY. THE CONTRACTOR SHALL HOLD THE OWNER/DEVELOPER, THE ENGINEER AND THE LOCAL GOVERNING AGENCIES HARMLESS AGAINST SUCH VIOLATION.

J. RESIDENT ENGINEERING SERVICES: WHEN REQUESTED BY THE OWNER, RESIDENT ENGINEERING SERVICES SHALL BE PROVIDED BY THE ENGINEERS (ON A TIME AND FREQUENCY BASIS) ACCEPTABLE TO THE CITY ENGINEER FOR IMPROVEMENTS TO PUBLIC WATER MAINS, PUBLIC SEWER, AND CITY STREETS, AT THE COMPLETION OF CONSTRUCTION, THE ENGINEER SHALL CERTIFY THE CONSTRUCTION TO BE IN COMPLIANCE WITH THE PLANS AND SPECIFICATIONS. THIS WORK WILL BE AT THE OWNER/DEVELOPER'S DIRECT EXPENSE AND SHALL BE COORDINATED WITH CEI ENGINEERING ASSOCIATES, INC. IT WILL BE THE CONTRACTOR'S RESPONSIBILITY TO NOTIFY THE RESIDENT ENGINEER OF ANY PRECONSTRUCTION / CONSTRUCTION CONFERENCES AND ANY PUBLIC CONSTRUCTION 24 HOURS PRIOR TO SAID ACTION.

FLOOD CERTIFICATION:

BY SCALED MAP LOCATION AND GRAPHICAL PLOTTING ONLY. THIS PROPERTY IS DETERMINED TO BE LOCATED WITHIN ZONE 'X', OR AREAS OUTSIDE THE 0.2% ANNUAL CHANCE 100-YR FLOODPLAIN AS DETERMINED BY THE NATIONAL FLOOD INSURANCE PROGRAM. FLOOD INSURANCE MAP FOR ALLEGANY COUNTY, NEW YORK.
MAP NUMBER: 36087C0177G
MAP REVISED: 8/26/2021

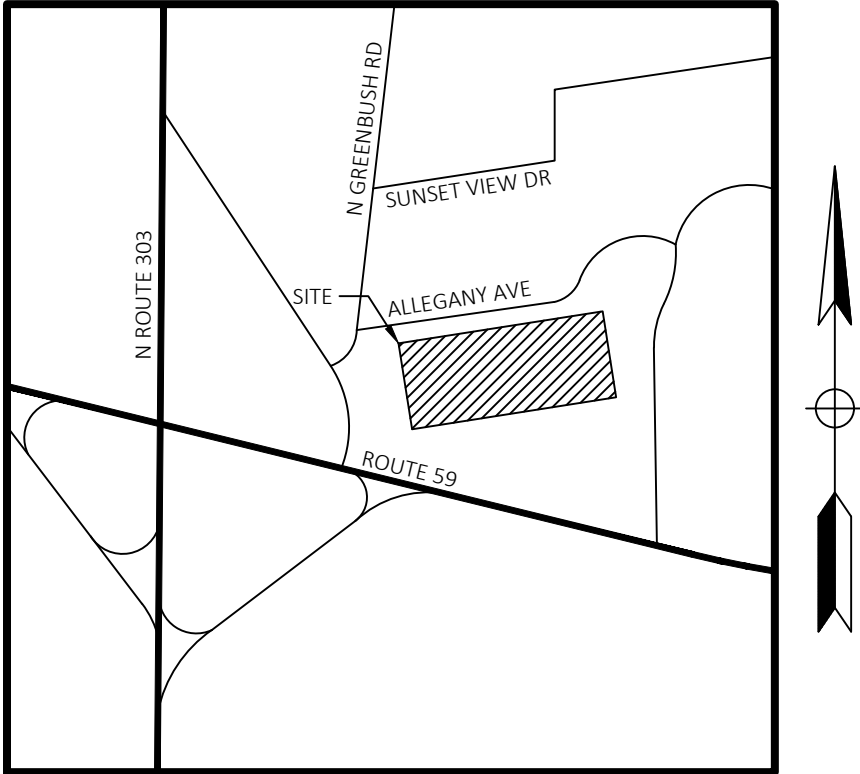

VICINITY MAP
NOT TO SCALE

CEI CONTACT:

NAME: JOEL E. HAYS
EMAIL: JHAYS@CEIENG.COM
PHONE: (972) 488-3737

CLIENT CONTACT:

NAME: DAN COLLINS
EMAIL: DCOLLINS@ADAARCHITECTS.COM
PHONE: (216) 521-5134
ADDRESS: 17710 DETROIT AVE.
LAKEWOOD, OH 44107



CIVIL ENGINEERING • LANDSCAPE ARCHITECTURE • LAND SURVEYING • PLANNING
BENTONVILLE | DALLAS | FRESNO | HOUSTON | JACKSONVILLE | MINNEAPOLIS | PHILADELPHIA | PHOENIX



CEI ENGINEERING ASSOCIATES, INC.
3108 SW REGENCY PKWY
BENTONVILLE, AR 72712
PHONE: (479) 273-9472
FAX: (479) 273-0844

PLAN INDEX:

- C0 COVER SHEET
- C1 DEMOLITION & EROSION CONTROL PLAN
- C1.1 EROSION CONTROL NOTES
- C2 SITE PLAN
- C3 PAVEMENT PLAN
- C4 UTILITY PLAN
- C5 GRADING PLAN
- C6 DETAIL SHEET 1

ASSOCIATED PLANS:

- 1. SURVEY

RESOURCE LIST:

AGENCY
TOWN OF CLARKSTOWN
10 MAPLE AVE #5013
NEW CITY, NEW YORK 10956
PHONE: (845) 639-2000

AGENCY
VILLAGE OF NYACK WATER DEPARTMENT
9 N BROADWAY
NYACK, NEW YORK 10960
PHONE: (845) 358-0641

HARBOR FREIGHT TOOLS

388 ROUTE 59
NYACK, NEW YORK, 10960

PROFESSIONAL OF RECORD	JDG
PROJECT MANAGER	JEH
DESIGNER	HMK
CEI PROJECT NUMBER	32286
DATE	9/21/2021
REVISION	REV-0

COVER

SHEET TITLE
SHEET NUMBER

C0