

DRAWING LOCATION: P:\23000\32286\DRAWINGS\DESIGN\WORKING\32286-ED.DWG - SAVED BY: HKDD

HARBOR FREIGHT TOOLS  
(14,435 SQ. FT.)  
FF= 116.31

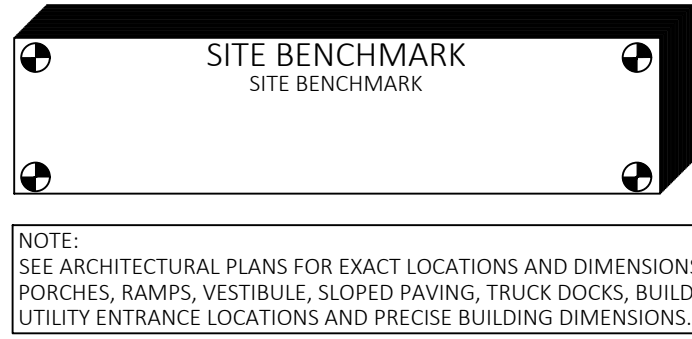

NOTE:  
SEE ARCHITECTURAL PLANS FOR EXACT LOCATIONS AND DIMENSIONS OF  
PORCHES, RAMPS, VESTIBULE, SLOPED PAVING, TRUCK DOCKS, BUILDING  
UTILITY ENTRANCE LOCATIONS AND PRECISE BUILDING DIMENSIONS.

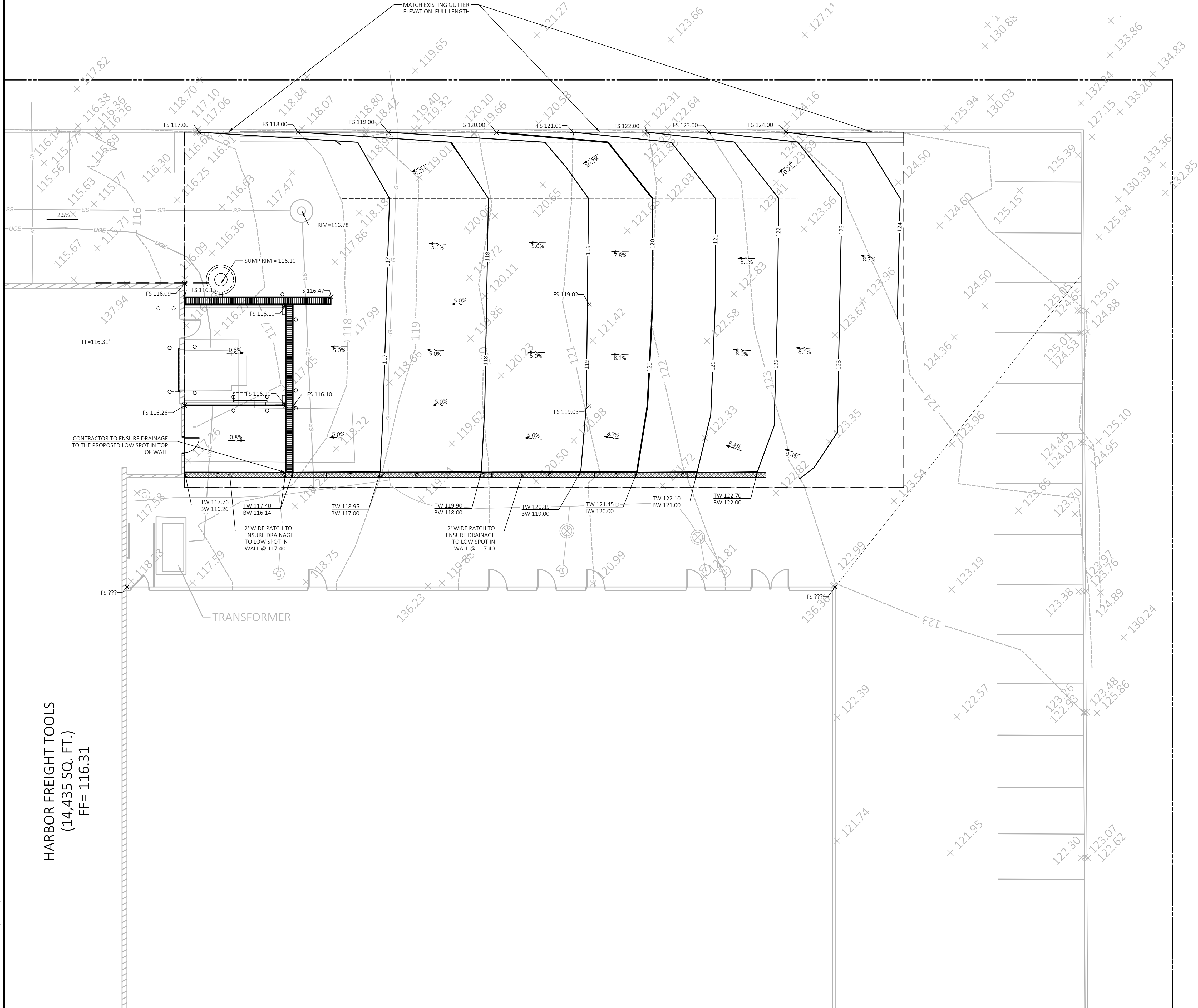
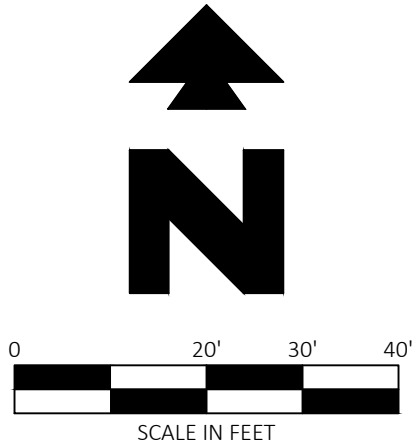

Know what's below.  
Call before you dig.

#### EXISTING LEGEND

|                  |                                 |                  |                                    |
|------------------|---------------------------------|------------------|------------------------------------|
| <i>e</i>         | EAST OR ELECTRIC                | <i>OHT</i>       | OVERHEAD TELEPHONE                 |
| <i>n</i>         | NORTH                           | <i>OHTV</i>      | OVERHEAD TV                        |
| <i>oh</i>        | OVERHEAD                        | <i>X"SS</i>      | SANITARY SEWER                     |
| <i>s</i>         | SOUTH OR SEWER                  | <i>UGE</i>       | UNDERGROUND ELECTRIC               |
| <i>t</i>         | TELEPHONE                       | <i>UGE&amp;T</i> | UNDERGROUND ELECTRIC AND TELEPHONE |
| <i>ug</i>        | UNDERGROUND                     | <i>UGT</i>       | UNDERGROUND TELEPHONE              |
| <i>w</i>         | WEST OR WATER                   | <i>UGTV</i>      | UNDERGROUND TV                     |
| ---              | PROPERTY LINE                   | <i>X"W</i>       | WATER                              |
| ---              | RIGHT OF WAY LINE               |                  |                                    |
| ---              | STORM DRAIN                     |                  |                                    |
| <i>X"G</i>       | GAS                             |                  |                                    |
| <i>OHE</i>       | OVERHEAD ELECTRIC               |                  |                                    |
| <i>OHE&amp;T</i> | OVERHEAD ELECTRIC AND TELEPHONE |                  |                                    |

#### PROPOSED LEGEND

|     |                                 |         |   |
|-----|---------------------------------|---------|---|
| --- | PROPERTY LINE/RIGHT OF WAY LINE | x XX.XX | SPOT ELEVATIONS:<br>TC = TOP OF CURB<br>G = GUTTER<br>FFE = FINISH FLOOR ELEVATION<br>FG = FINISH GRADE |
| --- | CONTOUR ELEVATIONS              |         |   |
| --- | GRADE BREAK                     |         |   |
| --- | FLOWLINE                        |         |   |
| --- | STORM DRAIN                     |         |   |

#### GENERAL GRADING NOTES

- A. ALL SLOPES AND AREAS DISTURBED BY CONSTRUCTION SHALL BE GRADED SMOOTH AND 4" OF TOPSOIL APPLIED. IF ADEQUATE TOPSOIL IS NOT AVAILABLE ON SITE, THE CONTRACTOR SHALL PROVIDE TOPSOIL, APPROVED BY THE OWNER, AS NEEDED. THE AREA SHALL THEN BE SEEDED, FERTILIZED, MULCHED, WATERED AND MAINTAINED UNTIL HARDY GRASS GROWTH IS ESTABLISHED IN ALL AREAS (SEE LANDSCAPE PLAN FOR SEED MIX AND PROPER APPLICATION RATE). ANY AREAS DISTURBED FOR ANY REASON PRIOR TO FINAL ACCEPTANCE OF THE PROJECT SHALL BE CORRECTED BY THE CONTRACTOR AT NO ADDITIONAL COST TO THE OWNER.
- B. THE CONTRACTOR IS SPECIFICALLY CAUTIONED THAT THE LOCATION AND/OR ELEVATION OF EXISTING UTILITIES AS SHOWN ON THESE PLANS IS BASED ON RECORDS OF THE VARIOUS UTILITY COMPANIES, AND WHERE POSSIBLE, MEASUREMENTS TAKEN IN THE FIELD. THE INFORMATION IS NOT TO BE RELIED ON AS BEING EXACT OR COMPLETE. THE CONTRACTOR MUST CALL THE APPROPRIATE UTILITY COMPANY AT LEAST 48 HOURS BEFORE ANY EXCAVATION TO REQUEST EXACT FIELD LOCATION OF UTILITIES.

HARBOR FREIGHT TOOLS

388 ROUTE 59  
NYACK, NEW YORK, 10960

|                        |           |
|------------------------|-----------|
| PROFESSIONAL OF RECORD | JDG       |
| PROJECT MANAGER        | JEH       |
| DESIGNER               | HMK       |
| CEI PROJECT NUMBER     | 32286     |
| DATE                   | 9/21/2021 |
| REVISION               | REV-0     |

#### GRADING PLAN

SHEET TITLE  
SHEET NUMBER

C5



CEI ENGINEERING ASSOCIATES, INC.  
3108 SW REGENCY PKWY  
BENTONVILLE, AR 72712  
PHONE: (479) 273-9472  
FAX: (479) 273-0844