

December 6, 2021

**IRVINGTON UNION FREE SCHOOL DISTRICT
FACILITIES STORAGE BUILDING AT IRVINGTON CAMPUS:
SED Control Number: 66-04-02-02-2-022-001**

**CONTRACT G – GENERAL CONSTRUCTION, CIVIL & SITE WORK
HVAC WORK, PLUMBING WORK
ELECTRICAL WORK**

WESTCHESTER COUNTY, NEW YORK

NOTE: *This clarification forms a part of the contract documents for the above project and must be acknowledged in the plans and specifications. Attach it to the inside front cover of each of the specifications.*

CLARIFICATION TO DRAWINGS:

1. Remove DRAWING G0.0 GENERAL NOTES, ABBREVIATIONS, DRAWING LIST, STAGING PLAN, LOCATION MAP AND LEGEND and replace with revised DRAWING G0.0 GENERAL NOTES, ABBREVIATIONS, DRAWING LIST, STAGING PLAN, LOCATION MAP AND LEGEND attached herewith. Please note the drawing has updated the civil and structural drawing list.

REQUEST FOR INFORMATION FROM ALL CON CONTRACTING:

1. The following drawings are included in the bid set but are not on the cover sheet. Are they to be included in the bid? CD100, C100, C101, C500, C501, S001, S100, S101, S102, S300, S500.

RFI response: Yes, these drawings are included in the bid. Please reference revised G000.00 GENERAL NOTES, MAPS, DRAWING LIST, STAGING PLAN, LEGENDS attached herewith.

2. The following drawings are missing from the bid set CD1.0, CD1.0, CD5.0, S1.0, S1.1, S5.0, S5.1.

RFI response: The drawing titles have been revised on the sheet G000.00 GENERAL NOTES, MAPS, DRAWING LIST, STAGING PLAN, LEGENDS attached herewith.

End of Addendum No. 1

IRVINGTON UNION FREE SCHOOL DISTRICT
FACILITIES STORAGE BUILDING

40 N. BROADWAY, IRVINGTON, NY 10533

SED PROJECT CONTROL NUMBER 66-04-02-02-2-022-001

CONTRACT G - GENERAL CONSTRUCTION, HVAC CONSTRUCTION, ELECTRICAL CONSTRUCTION,
PLUMBING CONSTRUCTION, CIVIL & SITE WORK

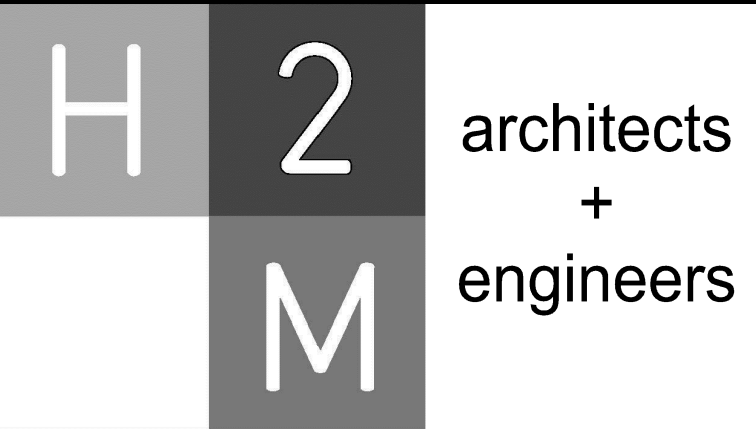

2700 Westchester Avenue, Suite 415
Purchase, NY 10577
914.358.5623 www.h2m.com

CONSULTANTS:

MARK	DATE	DESCRIPTION
1	12/01/2021	ADDENDUM #1
	11/18/2021	FINAL BID DOCUMENT



DESIGNED BY: CWP	DRAWN BY: CWP	CHECKED BY: CWP	REVIEWED BY: CWP
PROJECT NO: IRSD1903	DATE: NOV 2021	SCALE: AS SHOWN	

CLIENT
Irvington Union Free School District

**Facilities Storage Building
at Irvington Campus**



**Irvington Campus
40 N. Broadway
Irvington, NY 10533**

SED Number:66-04-02-02-2-022-001

CONTRACT
**CONTRACT G
GENERAL CONSTRUCTION**

STATUS
FINAL BID DOCUMENT

SHEET TITLE
**GENERAL NOTES, ABBREVIATIONS
DRAWING LIST, STAGING PLAN,
LOCATION MAP AND LEGEND**

DRAWING NO.
G0.0

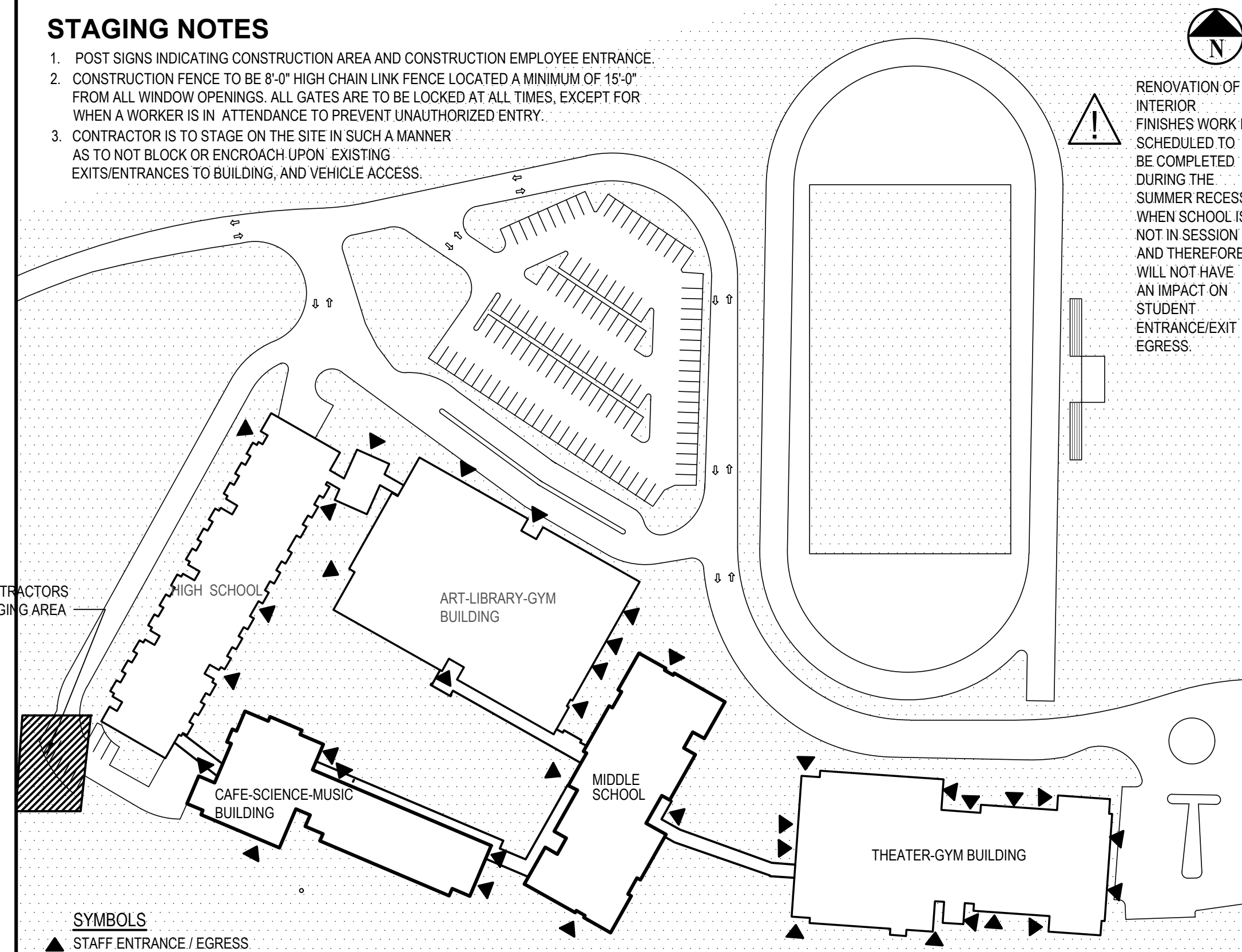
ABBREVIATIONS				GENERAL NOTES		DRAWING LIST		STAGING PLAN	
AB	ANCHOR BOLT	FAI	FRESH AIR INTAKE	1.	ALL WORK SHALL COMPLY WITH THE 2020 BUILDING CODE OF NEW YORK STATE, 2020 FIRE CODE OF NEW YORK STATE AND THE NEW YORK STATE EDUCATION DEPARTMENT MANUAL OF PLANNING STANDARDS.	INFORMATIONAL DRAWINGS		<div>STAGING NOTES</div> <div>1. POST SIGNS INDICATING CONSTRUCTION AREA AND CONSTRUCTION EMPLOYEE ENTRANCE.</div> <div>2. CONSTRUCTION FENCE TO BE 8'-0" HIGH CHAIN LINK FENCE LOCATED A MINIMUM OF 15'-0" FROM ALL WINDOW OPENINGS. ALL GATES ARE TO BE LOCKED AT ALL TIMES, EXCEPT FOR WHEN A WORKER IS IN ATTENDANCE TO PREVENT UNAUTHORIZED ENTRY.</div> <div>3. CONTRACTOR IS TO STAGE ON THE SITE IN SUCH A MANNER AS TO NOT BLOCK OR ENROACH UPON EXISTING EXITS/ENTRANCES TO BUILDING, AND VEHICLE ACCESS.</div>  <div>RENOVATION OF INTERIOR FINISHES WORK IS SCHEDULED TO BE COMPLETED DURING THE SUMMER RECESS WHEN SCHOOL IS NOT IN SESSION AND THEREFORE WILL NOT HAVE AN IMPACT ON STUDENT ENTRANCE/EXIT EGRESS.</div>	
A/C	AIR CONDITIONING	F.C.	FIRE CODE	2.	ALL NOTES APPEARING HEREIN, WITH THOSE ON VARIOUS DRAWINGS SHALL APPLY TO ALL DRAWINGS AND FORM PART OF THE CONTRACT DOCUMENTS.	G.0.0 GENERAL NOTES, MAPS, DRAWING LIST, STAGING PLAN, EXIT PLAN & LEGENDS			
ACI	AMERICAN CONCRETE INSTITUTE	FIN	FINISH	3.	IT IS THE CONTRACTORS RESPONSIBILITY TO FIELD VERIFY ALL DIMENSIONS, SQUARE FOOTAGES, LOCATIONS AND QUANTITIES OF ALL ITEMS AND/OR SPACES WHETHER INDICATED IN THE DRAWINGS OR NOT.	G1.0 CODE ANALYSIS			
ACST	ACOUSTIC	FR	FIRE RETARDANT	4.	DO NOT SCALE MEASURE ANY DRAWING. VERIFY THE FIGURES, DIMENSIONS AND DESIGN INTENTION SHOWN ON THE DRAWINGS BEFORE BEGINNING LAYOUT OF THE WORK AND REPORT ANY ERRORS, INACCURACIES, OR CONFLICTS TO THE ARCHITECT/ENGINEER IN WRITING BEFORE BEGINNING ANY WORK.	G1.1 COM CHECK			
ACT	ACOUSTICAL CEILING TILE	FTG	FOOTING	5.	ALL WORK SHALL COMPLY WITH ALL APPLICABLE CODES, LAWS AND STATUTES AS REQUIRED. STRICTLY ADHERE TO MANUFACTURER'S PRINTED INSTRUCTIONS.	CIVIL DRAWINGS			
ACU	AIR CONDITIONING UNIT	GA	GAUGE	6.	VERIFY EXACT LAYOUT COMPATIBILITY WITH ALL EXISTING CONDITIONS BEFORE BEGINNING WORK.	CD100.00 EXISTING CONDITIONS AND DEMOLITION SITE PLAN			
AD	ACCESS DOOR ADJUSTABLE	GWB	GYPSUM WALL BOARD	7.	DISTURB ONLY THOSE AREAS OF THE SITE AFFECTED BY RENOVATION, UNLESS NOTED OTHERWISE. PROTECT ALL OTHER AREAS. CONTRACTORS SHALL BE RESPONSIBLE FOR ALL PATCH AND REPAIR OF EXISTING FINISHES WHICH ARE DAMAGED DURING CONSTRUCTION.	C100.00 SITE IMPROVEMENT PLAN			
ADJ	A/E ARCHITECT/ENGINEER	GYP	GYPSUM	8.	EACH CONTRACTOR SHALL COMPLY WITH THE REQUIREMENTS OF ANSI AND PROVIDE WHERE APPLICABLE ADA COMPLIANT BUILDING COMPONENTS.	C101.00 SANITARY ALIGNMENT PLAN			
AFF	ABOVE FINISH FLOOR	GYP. BD.	GYPSUM BOARD	9.	THE OWNER RESERVES THE RIGHT AT ALL TIMES TO DELIVER, PLACE AND INSTALL EQUIPMENT AND FURNISHINGS AS THE WORK PROGRESSES SO LONG AS THERE IS NOT A CONFLICT WITH THE CONTRACTORS.	C200.00 SITE DETAILS			
ALUM	ALUMINUM	HC	HANDICAPPED	10.	THE CONTRACTOR SHALL MAINTAIN AT THE SITE ONE RECORD COPY OF ALL DRAWINGS, SPECIFICATIONS AND APPROVED SHOP DRAWINGS AND APPROVED SAMPLES MARKED CURRENTLY TO RECORD ALL CHANGES DURING CONSTRUCTION.	C501.00 SANITARY DETAILS			
ANCH	ANCHOR ANSI AMERICAN NATIONAL STANDARDS INSTITUTE	HOR	HORIZONTAL	11.	ANY CHANGES TO THE SCOPE OF WORK OR IN THE CONSTRUCTION DETAILS, WHETHER DUE TO FIELD CONDITIONS OR OMISSION SHALL BE DOCUMENTED BY THE ARCHITECT PRIOR TO EXECUTION. ANY INCREASE OR DECREASE IN THE CONTRACT PRICE MUST BE APPROVED IN WRITING PRIOR TO EXECUTION.	STRUCTURAL DRAWINGS			
APA	ACCESS PANEL	INSUL	HOT WATER	12.	THE CONTRACTOR BY PRESENTING THEIR BID FOR THE WORK, REPRESENTS THAT HE/SHE HAS INSPECTED THE SITE AND IS COMPLETELY FAMILIAR WITH THE SCOPE OF WORK AND ALL FIELD CONDITIONS RELATED TO, AND AFFECTING THE WORK AND ITS PERFORMANCE. EXCEPTIONS AFFECTING THE WORK AND ITS PERFORMANCE, OR CONFLICTS BETWEEN FIELD CONDITIONS, SHALL BE BROUGHT TO THE ATTENTION OF THE ARCHITECT PRIOR TO THE SUBMISSION OF BIDS. FAILURE TO DO SO WILL NOT RESULT IN A CHANGE TO THE CONTRACT PRICE IT SHALL BE THE CONTRACTOR'S SOLE RESPONSIBILITY TO PROVIDE ALL NECESSARY ACCOMMODATIONS TO COMPLETE THE SCOPE OF WORK.	S001.00 GENERAL NOTES			
APPROX	APPROXIMATELY	INT	INTERIOR			S100.00 FOUNDATION PLAN			
ASPH	ASPHALT	LAV	LAVATORY			S101.00 SLAB PLAN			
ASTM	AMERICAN SOCIETY FOR TESTING & MATERIALS	LDR	LEADER			S102.00 ROOF FRAMING PLAN			
AWS	AMERICAN WELDING SOCIETY	LT	LIGHT			S300.00 STRUCTURAL SECTIONS			
B	FIRE BLANKET	MAX	MAXIMUM			S600.00 STRUCTURAL DETAILS			
BAL	BALANCE	MECH	MECHANICAL			ARCHITECTURAL DRAWINGS			
BB	BULLETIN BOARD	MISC	MISCELLANEOUS			A1.0 FLOOR PLAN & REFLECTED CEILING PLAN			
BD	BOARD	MO	MASONRY OPENING			A1.1 ROOF PLAN			
B.DS	BUILDING	MR	MOISTURE RESISTANT			A2.0 ELEVATIONS			
BLK	BLOCK	MR	MOISTURE RESISTANT			A3.0 BUILDING SECTION AND WALL SECTION			
BLKG	BLOCKING	NTS	NOT TO SCALE			A6.0 DOOR SCHEDULE AND DETAILS			
BM	BEAM	OC	ON CENTER			PLUMBING DRAWINGS			
B.O.	BOTTOM OF	OD	OUTSIDE DIAMETER			P0.0 PLUMBING NOTES, LEGEND ABBREVIATIONS, AND SCHEDULES			
BOL	BOTTOM OF LINTEL	PLYWD	PLYWOOD			P1.0 SITE PLAN AND EXISTING BASEMENT PLAN			
BOT	BOTTOM	PSF	POUNDS PER SQUARE FOOT			P2.0 GROUND FLOOR PLANS			
CEIL	CEILING	PSI	POUNDS PER SQUARE INCH			P3.0 PLUMBING DETAILS			
CEM	CEMENT	PTD	PAINTED			P4.0 PLUMBING RISER DIAGRAMS			
CER	CERAMIC	PVC	POLYVINYL CHLORIDE			HVAC DRAWINGS			
CLO	CLOSET	R	RADIUS OR RISER			H0.0 HVAC LEGENDS, SYMBOLS, ABBREVIATIONS, AND GENERAL NOTES			
CMU	CONCRETE MASONRY UNIT	RCF	REFLECTED CEILING PLAN			H1.0 HIGH SCHOOL FACILITIES STORAGE BUILDING HVAC CONSTRUCTION			
COL	COLUMN	RD	ROOF DRAIN			ELEVATION DRAWINGS			
CONC	CONCRETE	REIN	REINFORCED			E0.0 ELECTRICAL LEGENDS			
CONST	CONSTRUCTION	RM	ROOM			E1.0 ELECTRICAL SITE PLAN			
CONT	CONTINUOUS	RO	ROUGH OPENING			E2.0 ELECTRICAL PARTIAL LOWER LEVEL CAFE - SCIENCE - MUSIC BUILDING POWER PLAN			
CORR	CORRIDOR	SIM	SIMILAR			E2.1 ELECTRICAL FACILITIES STORAGE BUILDING PLAN			
CPT	CARPET	SPEC	SPECIFICATIONS			E3.0 ELECTRICAL SINGLE LINE DIAGRAM, DETAILS AND SCHEDULES			
DS	DOWNSPOUT	SS	SQUARE						
DW	DISHWASHER	SQ	STAINLESS STEEL						
DWG	DRAWING	STL	STEEL						
EA	EACH	TEMP	TEMPERATURE						
EL	ELEVATION	TER	TERRAZZO						
ELEC	ELECTRIC/ELECTRICAL	THK	THICK						
ELEV	ELEVATOR	TYP	TYPICAL						
EP	ELECTRICAL PANEL	UTL	UTILITY						
EPY	EPOXY COATING	VB	VAPOR BARRIER						
EQ	EQUAL	VCT	VINYL COMPOSITION TILE						
EQUIP	EQUIPMENT	VERT	VERTICAL						
EXIST	EXISTING	VTR	VENT THRU ROOF						
EXST	EXHAUST	WC	WATER CLOSET						
		WH	WATER HEATER						
		WWF	WELDED WIRE FABRIC						

LOCATION MAP			
			

SYMBOLS LEGEND			
DESCRIPTION	SYMBOL	DESCRIPTION	SYMBOL
ROOM DESIGNATION		GYPSUM	
SECTION MARK		CONCRETE	
DETAIL SYMBOL		AGGREGATE SUB-BASE	
ELEVATION KEY		EARTH	
INTERIOR ELEVATION REFERENCE		BATT INSULATION	
ELEVATION LINE		PLYWOOD	
REVISION		RIGID INSULATION	
PARTITION TYPE		STEEL	
		WOOD	
		WOOD BLOCKING	

UNIFORM SAFETY STANDARDS - FOR SCHOOL CONSTRUCTION AND MAINTENANCE PROJECTS (NYSED 155.5 REGULATION)			
1. "THE OCCUPIED PORTION OF ANY SCHOOL BUILDING SHALL ALWAYS COMPLY WITH THE MINIMUM REQUIREMENTS NECESSARY TO MAINTAIN A CERTIFICATE OF OCCUPANCY."	BOARD MUST BE USED IN EXIT WAYS OR OTHER AREAS THAT REQUIRE FIRE RATED SEPARATION. HEAVY DUTY PLASTIC SHEETING MAY BE USED ONLY FOR A VAPOR, FINE DUST OR AIR INFILTRATION BARRIER, AND SHALL NOT BE USED TO SEPARATE OCCUPIED SPACES FROM CONSTRUCTION AREAS.	7. A PLAN DETAILING HOW ADEQUATE VENTILATION WILL BE MAINTAINED DURING CONSTRUCTION.	ISOLATED PORTION OF THE BUILDING MUST CONTAIN EXITS THAT DO NOT PASS THROUGH THE OCCUPIED PORTION AND VENTILATION SYSTEMS MUST BE PHYSICALLY SEPARATED AND SEALED AT THE ISOLATION BARRIER.
2. PORTIONS OF WORK TO BE DISTURBED DURING THIS PROJECT ARE KNOWN TO CONTAIN ASBESTOS AND SHALL BE ABATED AS SHOWN.	(1) A SPECIFIC STAIRWELL AND/OR ELEVATOR SHALL BE ASSIGNED OR CONSTRUCTION WORKER USE DURING WORK HOURS. IN GENERAL, WORKERS MAY NOT USE CORRIDORS, STAIRS OR ELEVATORS DESIGNATED FOR STUDENTS OR SCHOOL STAFF. WHERE NO STAIRWELL AND OR ELEVATOR IS ASSIGNED, WORKERS MUST ENTER THE CONSTRUCTION SPACES DIRECTLY FROM THE BUILDING EXTERIOR.	8. WORK UNDER THIS PROJECT WILL NOT BE OCCUPIED BY FACULTY, STAFF OR STUDENTS. IF A PORTION OF THE BUILDING IS TO BECOME OCCUPIED DURING THE CONSTRUCTION PROJECT THE CONTRACTOR SHALL CLOSE OFF ALL INTAKES, OPENINGS, AND MECHANICAL VENTILATION SYSTEMS ADJACENT TO THE WORK AREA. THE ARCHITECT SHALL ASSIST THE CONTRACTOR IN DEVELOPING A PLAN TO PROVIDE ALTERNATE MEANS OF FRESH AIR TO ALL OCCUPIED SPACES.	13. EXTERIOR WORK SUCH AS ROOFING, FLASHING, SIDING, OR SOFFIT WORK MAY BE PERFORMED ON OCCUPIED BUILDINGS PROVIDED PROPER VARIANCES ARE IN PLACE AS REQUIRED, AND COMPLETE ISOLATION OF VENTILATION SYSTEMS AND AT WINDOWS IS PROVIDED. CARE MUST BE TAKEN TO SCHEDULE WORK SO THAT CLASSES ARE NOT DISTURBED BY NOISE OR VISUAL DISTRACTION.
3. "GENERAL SAFETY AND SECURITY STANDARDS FOR CONSTRUCTION PROJECTS:	(1) ALL CONSTRUCTION MATERIALS SHALL BE STORED IN A SAFE AND SECURE MANNER.	9. "CONSTRUCTION AND MAINTENANCE OPERATIONS SHALL NOT PRODUCE NOISE IN EXCESS OF 60 DBA IN OCCUPIED SPACES OR SHALL BE SCHEDULED FOR TIMES WHEN THE BUILDING OR AFFECTED BUILDING SPACES ARE NOT OCCUPIED OR ACOUSTICAL ABATEMENT MEASURES SHALL BE TAKEN."	14. MINOR ASBESTOS PROJECTS DEFINED BY 12NYCRR56 AS AN ASBESTOS PROJECT INVOLVING THE REMOVAL, DISTURBANCE, REPAIR, ENCAPSULATION, ENCLOSURE OR HANDLING OF 10 SQUARE FEET OF ASBESTOS OR ASBESTOS MATERIAL MAY BE PERFORMED IN UNOCCUPIED AREAS OF AN OCCUPIED BUILDING IN ACCORDANCE WITH 12NYCRR56.
(1) ALL CONSTRUCTION MATERIALS SHALL BE STORED IN A SAFE AND SECURE MANNER.	(2) LARGES AMOUNTS OF DEBRIS MUST BE REMOVED BY USING ENCLOSED CHUTES OR A SIMILAR SEALED SYSTEM. THERE SHALL BE NO MOVEMENT OF DEBRIS THROUGH WALLS OF OCCUPIED SPACES OF THE BUILDING. NO MATERIAL SHALL BE DROPPED OR THROWN OUTSIDE THE WALLS OF THE BUILDING.	10. "THE CONTRACTOR SHALL BE RESPONSIBLE FOR THE CONTROL OF CHEMICAL FUMES, GASES, AND OTHER CONTAMINATES PRODUCED BY WELDING, GASOLINE OR DIESEL ENGINES, ROOFING, PAVING, PAINTING, ETC. TO ENSURE THEY DO NOT ENTER OCCUPIED PORTIONS OF THE BUILDING OR AIR INTAKES." ALL VENTS SHALL BE SEALED TO PREVENT CONTAMINANTS FROM THE CONSTRUCTION AREA FROM ENTERING THE OCCUPIED AREAS OF THE BUILDING.	15. NONE OF THE SURFACES AND/OR MATERIALS TO BE REMOVED OR DISTURBED BY THIS RENOVATION ARE SUSPECT OF CONTAINING LEAD.
(2) DURING EXTERIOR RENOVATION WORK, OVERHEAD PROTECTION SHALL BE PROVIDED FOR ANY SIDEWALKS OR AREAS IMMEDIATELY BENEATH THE WORK SITE OR SUCH AREAS SHALL BE FENCED OFF AND PROVIDED WITH WARNING SIGNS TO PREVENT ENTRY.	(3) GATES SHALL ALWAYS BE LOCKED UNLESS A WORKER IS IN ATTENDANCE TO PREVENT UNAUTHORIZED ENTRY.	11. "THE CONTRACTOR SHALL BE RESPONSIBLE TO ENSURE THAT ACTIVITIES AND MATERIALS WHICH RESULT IN "OFF-GASSING" OF VOLATILE ORGANIC COMPOUNDS SUCH AS GLUES, PAINTS, FURNITURE, CARPETING, WALL COVERING, DRAPERY, ETC. ARE SCHEDULED, CURED OR VENTILATED IN ACCORDANCE WITH MANUFACTURERS RECOMMENDATIONS BEFORE A SPACE CAN BE OCCUPIED."	16. UNDER NEW YORK STATE LAW SMOKING IS PROHIBITED ON SCHOOL GROUNDS. EMPLOYEES FOUND TO BE SMOKING ON SCHOOL GROUNDS SHALL BE ORDERED OFF SITE AND A SECOND OFFENSE WILL BE GROUNDS FOR PERMANENT REMOVAL FROM PROJECT. LEGAL PENALTIES MAY ALSO BE APPLIED.
(5) WORKERS SHALL BE REQUIRED TO WEAR PHOTO-IDENTIFICATION BADGES AT ALL TIMES FOR IDENTIFICATION AND SECURITY PURPOSES WHILE WORKING AT OCCUPIED SITES."	(4) SEPARATION OF CONSTRUCTION AREAS FROM OCCUPIED SPACES: CONSTRUCTION AREAS WHICH ARE UNDER THE CONTROL OF A CONTRACTOR AND THEREFORE NOT OCCUPIED BY DISTRICT STAFF OR STUDENTS SHALL BE SEPARATED FROM OCCUPIED AREAS. PROVISIONS SHALL BE MADE TO PREVENT THE PASSAGE OF DUST AND CONTAMINANTS INTO OCCUPIED PARTS OF THE BUILDING. PERIODIC INSPECTION AND REPAIRS OF THE CONTAINMENT BARRIERS MUST BE MADE TO PREVENT EXPOSURE TO DUST OR CONTAMINANTS. GYPSUM	12. "LARGE AND SMALL ASBESTOS ABATEMENT PROJECTS AS DEFINED BY 12NYCRR56 SHALL NOT BE PERFORMED WHILE THE BUILDING IS OCCUPIED." IT IS OUR INTERPRETATION THAT THE TERM "BUILDING", AS REFERENCED IN THIS SECTION, MEANS A WING OR MAJOR SECTION OF A BUILDING THAT CAN BE COMPLETELY ISOLATED FROM THE REST OF THE BUILDING WITH SEALED NON COMBUSTIBLE CONSTRUCTION. THE	17. ALL CONTRACTORS SHALL TAKE EVERY PRECAUTION AND SHALL PROVIDE SUCH EQUIPMENT AND FACILITIES AS ARE NECESSARY OR REQUIRED FOR THE SAFETY OF ITS EMPLOYEES. IN CASE OF AN ACCIDENT, FIRST AID SHALL BE ADMINISTERED TO ANY WHO MAY BE INJURED IN THE PROGRESS OF THE WORK. IN ADDITION, THE CONTRACTOR SHALL BE PREPARED FOR THE REMOVAL TO THE HOSPITAL FOR TREATMENT OF ANY EMPLOYEE EITHER SERIOUSLY INJURED OR ILL.
			18. THE CONTRACTOR SHALL PROVIDE TEMPORARY WEATHER-TIGHT AND INSULATED ENCLOSURES AS MAY BE REQUIRED BY THE SCOPE OF WORK FOR ALL EXTERIOR OPENINGS SO AS TO PROTECT ALL WORK FROM THE WEATHER, AND TO PROVIDE SECURITY AGAINST UNAUTHORIZED ENTRY. ENCLOSURES SHALL NOT CREATE DEAD END CONDITIONS, REQUIRED EXITS SHALL BE MAINTAINED FREE AND CLEAR.