

December 9, 2021

**IRVINGTON UNION FREE SCHOOL DISTRICT  
FACILITIES STORAGE BUILDING AT IRVINGTON CAMPUS:  
SED Control Number: 66-04-02-02-2-022-001**

**CONTRACT G – GENERAL CONSTRUCTION, CIVIL & SITE WORK  
HVAC WORK, PLUMBING WORK  
ELECTRICAL WORK**

WESTCHESTER COUNTY, NEW YORK

**NOTE:** *This clarification forms a part of the contract documents for the above project and must be acknowledged in the plans and specifications. Attach it to the inside front cover of each of the specifications.*

**CLARIFICATION TO SPECIFICATIONS:**

---

1. Delete *SPECIFICATION 004116.11 – PROPOSAL (PB-G)* and Insert *SPECIFICATION 004116.11 – PROPOSAL (PB-G)*, attached herewith. Item 5 – Division 2 – Asbestos Removal was removed.
2. Insert *SPECIFICATION 104416 FIRE EXTINGUISHERS*, attached herewith.

**CLARIFICATION TO DRAWINGS:**

---

1. Remove *DRAWING C100.00 SITE IMPROVEMENT PLAN* and replace with revised *DRAWING C100.00 SITE IMPROVEMENT PLAN*, attached herewith. Silt fence locations and detail have been added.

**REQUEST FOR INFORMATION FROM BERTUSSI CONTRACTING:**

---

1. There is no wheel cleaner or gravel entrance pad on the site drawings. Please advise.

**RFI response:** Due to the location of the proposed improvements, a stabilized construction entrance is not proposed. Wheel cleaning of construction vehicles should occur over existing paved areas as close as feasible to the proposed facilities storage building site. Care should be taken to ensure drainage system inlets downstream of the wheel cleaning operations are protected from sediment intrusion and pavement should be swept clean to prevent tracking off-site.

2. There is no silt fence shown site. Please advise

**RFI response:** Please refer to revised sheet C100.00 (revision date 12/8/2021) for proposed silt fence locations (see 'CLARIFICATIONS TO DRAWINGS' #1)

3. There is a fire extinguisher shown on detail 1/G1.0 at an elevation. However there aren't any shown on the plans or specs. Please advise.

**RFI response:** A fire extinguisher is shown on the interior of the building adjacent to the man door on Drawing A/A1.0. See Clarifications to Specifications #1 above.

December 9, 2021

4. There is a sign above the elevation for a fire extinguisher but is not shown on the plans and specs. Is there a sign at the entrance door? Please advise.

**RFI response: A fire extinguisher is shown on the interior of the building adjacent to the man door on Drawing A/A1.0. See Clarifications to Specifications #1 above. A fire extinguisher sign shall be provided above the fire extinguisher as shown on 1/G1.0.**

5. On the PB-G-1 bidform – item 5 there is a line for asbestos removal. The environmental report shows no asbestos or lead paint. Please advise.

**RFI response: Item 5 – Division 2 – Asbestos Removal was removed from SPECIFICATION 004116.11 PROPOSAL (PB-G)**

6. Can dynamite be used at the 1-1/2" thick force main excavation for rock removal using blasting mats? Please advise.

**RFI response: Dynamite can not be used on the project.**

*End of Addendum No. 2*

X:\VRSD (IRVINGTON UFSD)\VRSD 1903 (HS FACILITIES STORAGE BUILDING)\03-BID\ADDENDA\VRSD1903 ADDENDUM 2.DOCX



CONSULTANTS:

MARK	DATE	DESCRIPTION
	12/08/2021	RESPONSE TO BID RFI
1	12/01/2021	ADDENDUM #1
	11/18/2021	FINAL BID DOCUMENT



DESIGNED BY: RJR	DRAWN BY: RPM	CHECKED BY: RJR	REVIEWED BY:
PROJECT NO: IRSD1903	DATE: NOV 2021	SCALE: AS SHOWN	

CLIENT  
**Irvington Union Free School District**

**Facilities Storage Building  
at Irvington Campus**



**Irvington Campus  
40 N. Broadway  
Irvington, NY 10533**

**SED Number:66-04-02-02-2-022-001**

CONTRACT  
**CONTRACT G  
GENERAL CONSTRUCTION**

STATUS  
**FINAL BID DOCUMENT**

SHEET TITLE  
**SITE IMPROVEMENT PLAN**

DRAWING No.  
**C100.00**

**GRADING AND DRAINAGE NOTES:**

- FOR NEW CONSTRUCTION THAT MEETS EXISTING CONDITIONS, ABUTTING SURFACES SHALL BE FLUSH AND ALIGNED.
- ADJUST ALL EXISTING CASTINGS AND VALVE COVERS TO MEET PROPOSED GRADE.
- CONSTRUCTION DEBRIS AND EXCESS SOIL SHALL BE REMOVED AND LEGALLY DISPOSED OFF SITE.
- UNSUITABLE SOILS ENCOUNTERED DURING CONSTRUCTION SHALL BE BROUGHT TO THE ATTENTION OF THE OWNER AND ENGINEER IMMEDIATELY IN WRITING BEFORE REMOVAL OR DISTURBANCE.

**SITE PLAN NOTES:**

- INSPECT THE SITE PRIOR TO SUBMISSION OF BIDS AND MAKE NO ADDITIONAL CLAIMS REGARDING SITE CONDITIONS THEREAFTER.
- NOTIFY THE OWNER AND H2M (TELEPHONE 631-756-8000) AT LEAST 48 HOURS PRIOR TO THE COMMENCEMENT OF THE WORK. THE SAME NOTICE SHALL BE REQUIRED WHEN RESUMING WORK AFTER ANY STOPPAGE OR DELAY.
- COMPLETE ALL SURVEY AND STAKEOUT AS REQUIRED TO PROPERLY COMPLETE THE WORK.
- PERFORM DAILY CLEANUP OPERATIONS INCLUDING REMOVAL OF DEBRIS AND EXCESS CONSTRUCTION MATERIAL, AND DRIVEWAY/STREET CLEANING TO THE SATISFACTION OF THE OWNER.
- DURING ALL NON-WORKING HOURS, STORE ALL EQUIPMENT AND MATERIALS WITHIN AN AREA DESIGNATED BY THE OWNER AT THE PROJECT SITE.
- ALL CURB DIMENSIONS SHOWN REFER TO THE FACE OF CURB.
- ALL CONSTRUCTION TO CONFORM WITH ALL APPLICABLE FEDERAL, STATE AND LOCAL CODE REQUIREMENTS.
- COORDINATE CONSTRUCTION ACTIVITIES WITH OWNER TO MINIMIZE INTERRUPTION TO THE OWNER'S OPERATIONS.
- RESTORE SURROUNDING AREAS DAMAGED OR DISTURBED DURING CONSTRUCTION. RESTORE TO NEW CONDITIONS AT NO ADDITIONAL COST TO THE OWNER.
- RESTORE ALL DISTURBED GRASS AREAS AND ALL AREAS NOT SPECIFICALLY IDENTIFIED FOR OTHER IMPROVEMENTS WITH 4 INCHES OF TOPSOIL AND SEED.
- REMOVE ALL ASPHALT FROM EXISTING CASTINGS.
- SEAL ALL JOINTS BETWEEN NEW ASPHALT AND EXISTING ASPHALT WITH HOT ASPHALT CEMENT.

**LEGEND**

DESCRIPTION	SYMBOL
BASE CONTRACT ASPHALT PAVEMENT	[Pattern]
CONCRETE PAVEMENT SIDEWALK	[Pattern]
ADD ALTERNATE ASPHALT PAVEMENT	[Pattern]
ROCK RETAINING WALL	[Pattern]
DOOR	[Symbol]
OVERHEAD DOOR	[Symbol]
SPOT ELEVATION	+121.50
TOP AND BOTTOM CURB ELEVATION	TC140.00 BC139.50
MAJOR CONTOUR	240
MINOR CONTOUR	241
RIDGE LINE	---
RETAINING WALL	[Pattern]
SANITARY LINE	S S
DRAINAGE LINE	D D
ELECTRIC LINE	E E
WATER SERVICE LINE	WS WS

**EROSION CONTROL NOTES:**

- DURING THE COURSE OF CONSTRUCTION, EROSION AND SEDIMENT CONTROL MEASURES ARE NECESSARY TO PREVENT THE TRANSPORT OF SEDIMENT TO UNDISTURBED AREAS, PONDS, WATER COURSES, DRAINAGE SYSTEMS, RECHARGE BASINS, AND ROADS. THE MINIMUM EROSION CONTROL MEASURES REQUIRED ARE INDICATED ON THIS PLAN. IN ADDITION, THE FOLLOWING GENERAL CONDITIONS SHALL BE OBSERVED:
  - EXISTING VEGETATION SCHEDULED TO REMAIN SHALL BE PROTECTED AND REMAIN UNDISTURBED.
  - INSTALL ADDITIONAL EROSION AND SEDIMENT CONTROL MEASURES AS REQUIRED TO PREVENT THE INCIDENTAL DISCHARGE OF SEDIMENT FROM THE SITE.
- SPECIFIC METHODS AND MATERIALS EMPLOYED IN THE INSTALLATION AND MAINTENANCE OF EROSION CONTROL MEASURES MUST CONFORM TO THE LATEST EDITION OF THE "NEW YORK STATE STANDARDS AND SPECIFICATIONS FOR EROSION AND SEDIMENT CONTROL".
- INSTALL PROPRIETARY EROSION AND SEDIMENT CONTROL PRODUCTS IN ACCORDANCE WITH MANUFACTURERS INSTRUCTIONS.
- ADJUST EROSION AND SEDIMENT CONTROL MEASURES TO ACCOMMODATE CONSTRUCTION PHASING TO MAINTAIN EFFECTIVENESS OF EROSION AND SEDIMENT CONTROL MEASURES.
- PROTECT EXISTING DRAINAGE INLETS WITHIN THE PROJECT LIMITS AND NEW DRAINAGE INLETS INSTALLED AS PART OF THIS PROJECT FROM SEDIMENT INTRUSION.
- PERFORM INSPECTION AND MAINTENANCE OF EROSION AND SEDIMENT CONTROL MEASURES ON A WEEKLY BASIS AND AFTER HEAVY OR PROLONGED STORMS. MAINTENANCE MEASURES INCLUDE, BUT ARE NOT LIMITED TO, CLEANING AND REPAIR OF ALL EROSION AND SEDIMENT CONTROL MEASURES.
- UTILIZE APPROPRIATE MEANS TO CONTROL DUST DURING CONSTRUCTION, INCLUDING BUT NOT LIMITED TO APPLYING WATER TO BARE SOIL SURFACES.
- MAINTAIN THE STABILIZED CONSTRUCTION ENTRANCE TO PREVENT SOIL AND LOOSE DEBRIS FROM BEING TRACKED ONTO LOCAL ROADS. MAINTAIN THE CONSTRUCTION ENTRANCE WEEKLY UNTIL THE SITE IS PERMANENTLY STABILIZED.
- ALL EROSION AND SEDIMENT CONTROL MEASURES SHALL REMAIN IN PLACE UNTIL DISTURBED AREAS ARE PERMANENTLY STABILIZED. AFTER PERMANENT STABILIZATION, REMOVE ALL TEMPORARY EROSION AND SEDIMENT CONTROL MEASURES AND ALL ACCUMULATED SEDIMENT AND DEBRIS FROM THE SITE AND DRAINAGE STRUCTURES.

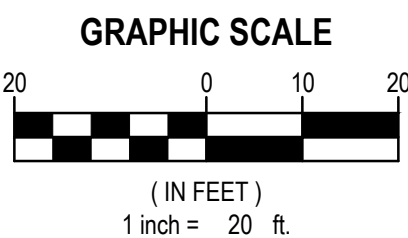
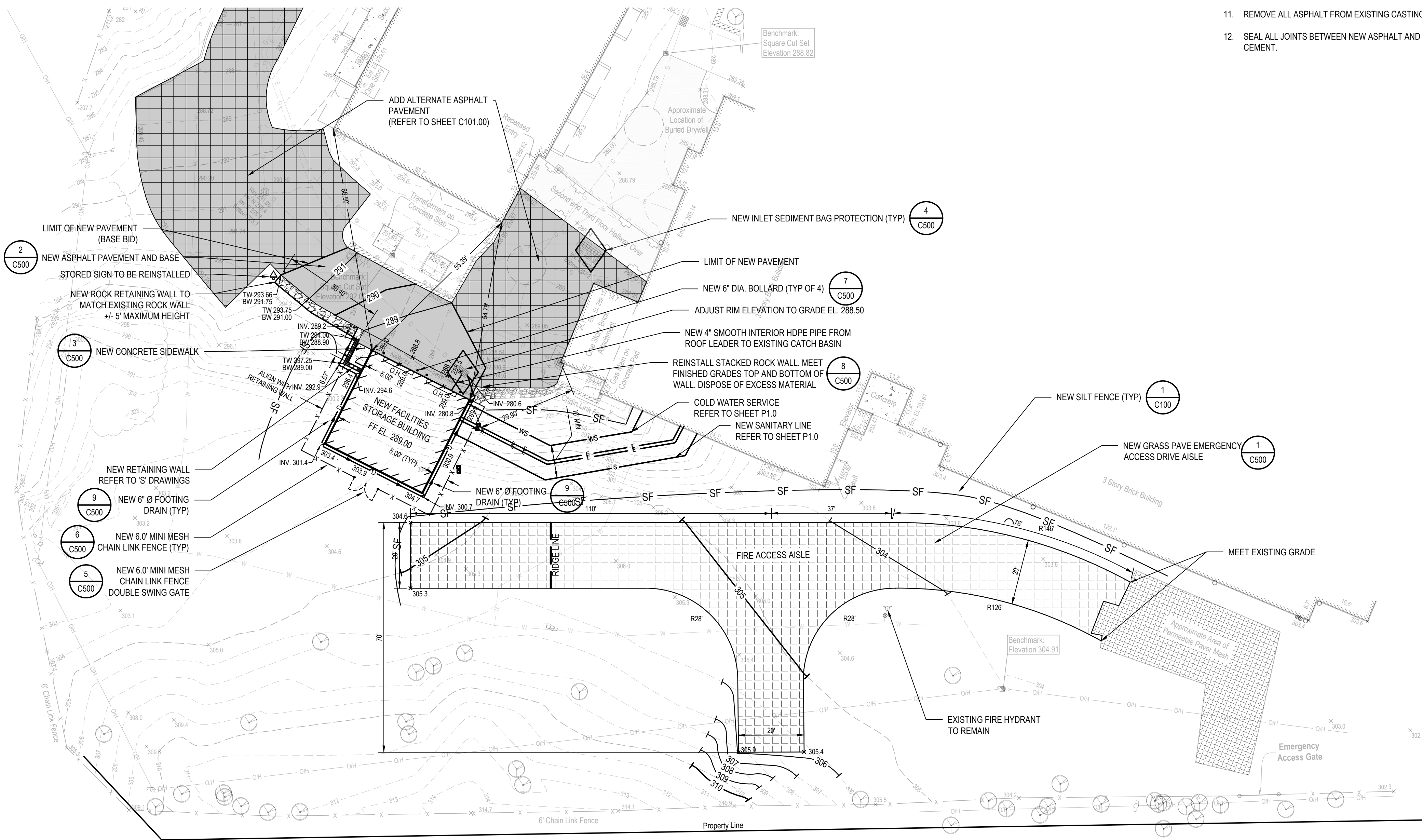
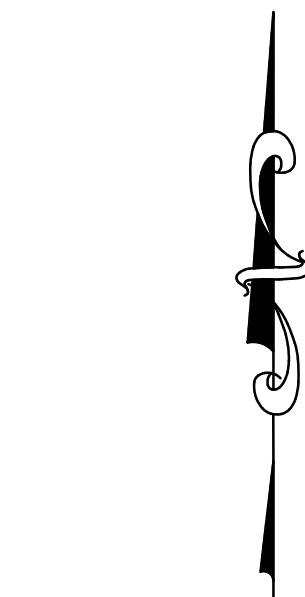
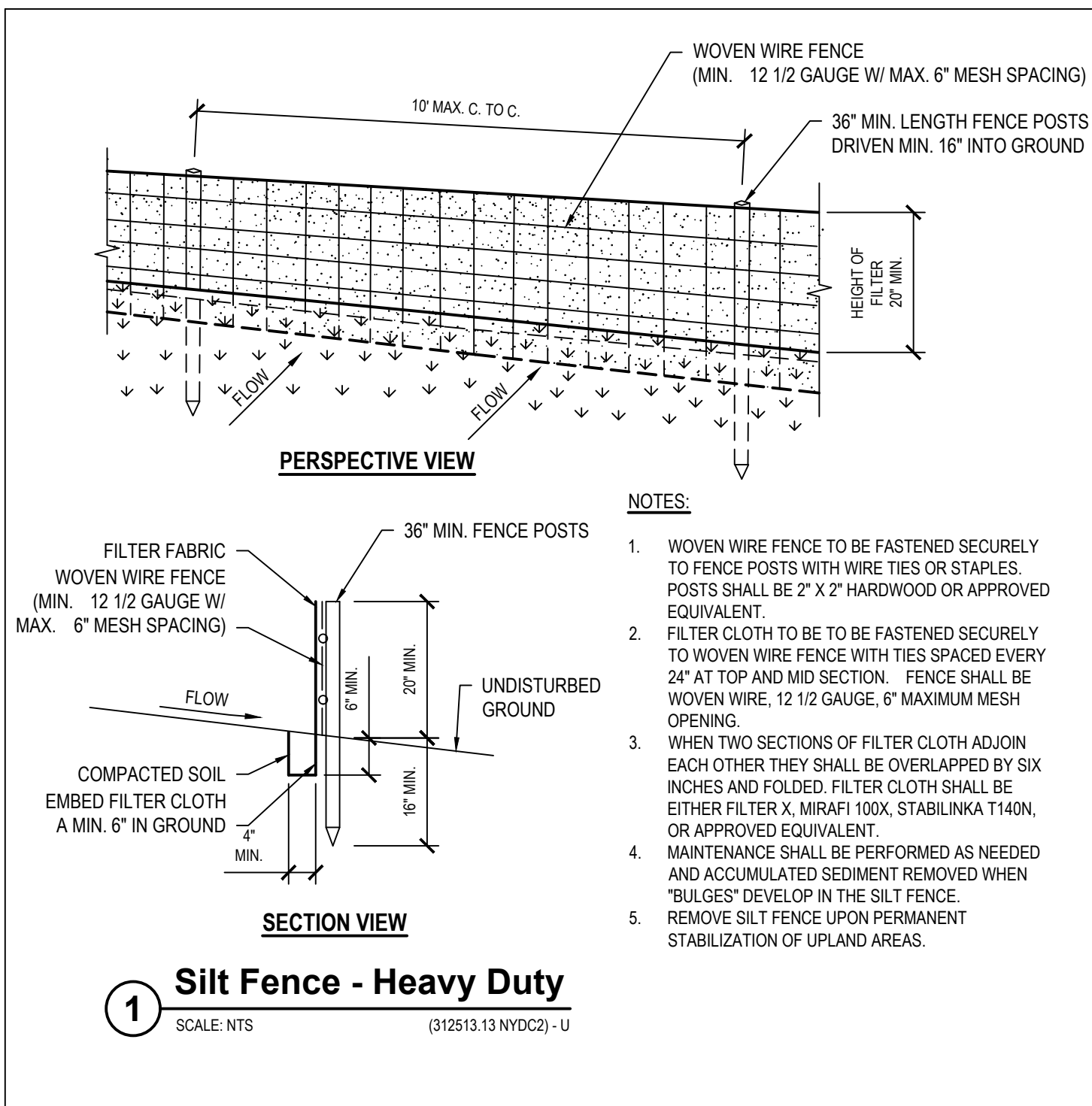



**Note: The bidder is asked to use either black ink or typewriter (black ribbon) in completing this proposal form. Each line item amount must be completed. Failure to do so will be grounds for disqualification of the bidder.**

<b>BASE BID: Contract G – General Construction Work</b>
---

**ITEM 1 – BONDS and INSURANCES**

(written in words) \_\_\_\_\_ ( \$ )

**ITEM 2 – DIVISION 1 – GENERAL REQUIREMENTS**

(written in words) \_\_\_\_\_ ( \$ )

**ITEM 3 – DIVISION 1 – PROJECT SUPERVISION**

(written in words) \_\_\_\_\_ ( \$ )

**ITEM 4 – DIVISION 2 – EXISTING CONDITIONS & DEMOLITION WORK**

(written in words) \_\_\_\_\_ ( \$ )

**ITEM 6 – DIVISION 3 – CONCRETE**

(written in words) \_\_\_\_\_ ( \$ )

**ITEM 7 – DIVISION 4 – MASONRY**

(written in words) \_\_\_\_\_ ( \$ )

**ITEM 8 – DIVISION 5 – METALS**

(written in words) \_\_\_\_\_ ( \$ )

**ITEM 9 – DIVISION 6 – WOOD, PLASTICS AND COMPOSITES**

(written in words) \_\_\_\_\_ ( \$ )

**ITEM 10 – DIVISION 7 – THERMAL AND MOISTURE PROTECTION**

(written in words) \_\_\_\_\_ ( \$ )

**ITEM 11 – DIVISION 7 – PENETRATION FIRESTOPPING**

(written in words) \_\_\_\_\_ ( \$ )

**ITEM 12 – DIVISION 8 - OPENINGS**

(written in words) \_\_\_\_\_ ( \$ )

**ITEM 13 – DIVISION 9 - FINISHES**

(written in words) \_\_\_\_\_ ( \$ )

**ITEM 14 – DIVISION 32 – WATER SUPPLY SYSTEM**

(written in words) \_\_\_\_\_ ( \$ )

**ITEM 15 – DIVISION 22 – PLUMBING EQUIPMENT**

(written in words) \_\_\_\_\_ ( \$ )

**ITEM 16 – DIVISION 22 – ALL OTHER PLUMBING CONTRACT ITEMS**

(written in words) \_\_\_\_\_ ( \$ )

**ITEM 17 – DIVISION 23 – SHEET METAL WORK**

(written in words) \_\_\_\_\_ ( \$ )

**ITEM 18 – DIVISION 23 – DIFFUSERS, REGISTERS & GRILLES**

(written in words) \_\_\_\_\_ ( \$ )

**ITEM 19 – DIVISION 23 – HVAC CONTROLS**

(written in words) \_\_\_\_\_ ( \$ )

**ITEM 20 – DIVISION 23 – ALL OTHER MECHANICAL CONTRACT ITEMS**

(written in words) \_\_\_\_\_ ( \$ )

**ITEM 21 – DIVISION 26 – CONDUIT, CONDUCTORS, BOXES & WIRE TROUGHS**

(written in words) \_\_\_\_\_ ( \$ )

**ITEM 22 – DIVISION 26 – WIRING DEVICES**

(written in words) \_\_\_\_\_ ( \$ )

**ITEM 23 – DIVISION 26 – ELECTRIC SERVICE AND PANEL BOARDS**

(written in words) \_\_\_\_\_ ( \$ )

**ITEM 24 – DIVISION 26 – LIGHTING**

(written in words) \_\_\_\_\_ ( \$ )

**ITEM 25 – DIVISION 28 – ALARM, SIGNAL & DETECTION**

(written in words) \_\_\_\_\_ ( \$ )

**ITEM 26 – DIVISION 26– ALL OTHER ELECTRICAL CONTRACT ITEMS**

(written in words) \_\_\_\_\_ ( \$ )

**ITEM 27 – DIVISION 31 – EARTHWORK**

(written in words) \_\_\_\_\_ ( \$ )

**ITEM 28 – DIVISION 32 – EXTERIOR IMPROVEMENTS**

(written in words) \_\_\_\_\_ ( \$ \_\_\_\_\_ )

**ITEM 29 – PROJECT CLOSEOUT**

(written in words) \_\_\_\_\_ ( \$ \_\_\_\_\_ )

**ALLOWANCE G1 – ALLOWANCE FOR GENERAL CONTINGENCY**

(written in words) Thirty Thousand Dollars and 00 Cents ( \$30,000.00 )

**TOTAL BASE BID ( ITEMS 1 – 29 INCLUSIVE, PLUS ALLOWANCE G1)**

(written in words) \_\_\_\_\_ ( \$ \_\_\_\_\_ )

**Note: The IRVINGTON UNION FREE SCHOOL DISTRICT is exempt from Federal, New York State and local taxes. TOTAL AMOUNT BID shall be exclusive of all taxes.**

EACH BIDDER SHALL SUBMIT WITH IT'S BID A SEPARATE SEALED LIST THAT NAMES THE SUBCONTRACTORS THAT THE BIDDER WILL USE TO PERFORM WORK AND THE AGREED UPON AMOUNT TO BE PAID FOR A.) HEATING, VENTILATION AND AIR-CONDITIONING WORK, B.) PLUMBING WORK AND C.) ELECTRICAL WORK. AFTER THE LOW BID IS ANNOUNCED, THE SEALED LIST OF SUBCONTRACTORS SUBMITTED BY THE APPARENT LOW BIDDER SHALL BE OPENED AND THE NAMES OF THE SUBCONTRACTORS ANNOUNCED. ANY CHANGE OF SUBCONTRACTOR OR AGREED UPON AMOUNT TO BE PAID SHALL REQUIRE THE APPROVAL OF THE PUBLIC OWNER, UPON A SHOWING OF "LEGITIMATE CONSTRUCTION NEED" FOR SUCH CHANGE.

"LEGITIMATE CONSTRUCTION NEED" SHALL INCLUDE, BUT NOT BE LIMITED TO:

A CHANGE IN PROJECT SPECIFICATIONS,  
A CHANGE IN CONSTRUCTION MATERIAL COSTS,  
A CHANGE IN SUBCONTRACTOR STATUS, OR  
THE SUBCONTRACTOR HAS BECOME UNWILLING, UNABLE OR UNAVAILABLE TO PERFORM THE SUBCONTRACT.

THE SEALED LISTS OF SUBCONTRACTORS SUBMITTED BY ALL OTHER BIDDERS SHALL BE RETURNED TO THEM UNOPENED AFTER THE CONTRACT AWARD.

PAYMENTS TO SUBCONTRACTORS AND MATERIAL MEN MUST BE MADE WITHIN 7 CALENDAR DAYS AS OPPOSED TO 15 CALENDAR DAYS OF THE RECEIPT OF PAYMENT FROM THE PUBLIC OWNER. FAILURE TO PAY WITHIN 7 CALENDAR DAYS WILL RESULT IN INTEREST DUE FOR ALL CALENDAR DAYS SUBSEQUENT TO THE SEVENTH DAY THROUGH THE DATE THAT PAYMENT IS MADE.

THE BIDDER UNDERSTANDS THAT THE OWNER RESERVES THE RIGHT TO REJECT ANY OR ALL BIDS AND TO WAIVE ANY INFORMALITIES IN THE BIDDING.

THE BIDDER AGREES THAT THE BID SHALL BE GOOD AND MAY NOT BE WITHDRAWN FOR A PERIOD OF **FORTY-FIVE (45)** CALENDAR DAYS AFTER THE SCHEDULED CLOSING TIME FOR RECEIVING BIDS.

THE BIDDER HAS SUBMITTED ALL REQUESTS FOR OTHER BRAND NAMES OR PRODUCTS NOT LISTED IN THE SPECIFICATIONS IN ACCORDANCE WITH ARTICLE 6(W) OF THE GENERAL CONDITIONS OF THE CONTRACT FOR CONSTRUCTION.

ALTERNATE WORK

THE CONTRACTOR SHALL CLEARLY STATE WHETHER COST INDICATED IS TO BE ADDED TO OR DEDUCTED FROM THE BASE BID COST. FAILURE TO CLEARLY STATE SAME WILL BE GROUNDS FOR DISQUALIFICATION OF THE BIDDER.

ALL WORK INCLUDED UNDER THIS HEADING SHALL BE SUBJECT TO THE GENERAL CONDITIONS OF THE PROJECT. ALL CONSTRUCTION, WORKMANSHIP AND FINISHES REQUIRED BY THE ALTERNATES SHALL BE AS SPECIFIED IN THE APPLICABLE SECTIONS OF THE SPECIFICATIONS MANUAL.

THE BIDDER PROPOSES AND AGREES THAT SHOULD THE FOLLOWING ALTERNATES BE ACCEPTED AND INCLUDED IN THE CONTRACT, THE AMOUNT OF THE TOTAL BASE BID WILL BE REVISED AS FOLLOWS. THE UNDERSIGNED FURTHER AGREES THAT SHOULD THE FOLLOWING ALTERNATES BE ACCEPTED, THE ALTERNATE BID PRICES INDICATED SHALL BE HELD AND HONORED FOR A PERIOD OF ONE YEAR FROM THE DATE OF CONTRACT SIGNING.

NUMBER	DESCRIPTION	COST
C-1	<b>PAVEMENT RESTORATION</b> Provide all labor, material and equipment required and as specified for work related to restoring pavement including but not limited to removal of materials as required, new asphaltic concrete courses and pavement striping, for areas of existing pavement as shown on the contract documents	\$ _____ Is

**TOTAL BID ( ITEMS 1 – 29 INCLUSIVE, PLUS ALLOWANCE G1 AND ALTERNATE C-1)**

**(written in words) \_\_\_\_\_ ( \$ \_\_\_\_\_ )**

UNIT PRICES

THE CONTRACT SHALL INCLUDE UNIT PRICES AS HEREIN STATED. SHOULD THE AMOUNT OF WORK REQUIRED BY THE CONTRACT DOCUMENTS BE INCREASED OR DECREASED, THE FOLLOWING UNIT PRICES SHALL BE USED AS A BASIS FOR COMPUTING THE COST TO THE DISTRICT, OR THE CREDIT DUE THE DISTRICT AS THE CASE MAY BE, FOR SUCH INCREASES OR DECREASES IN THE WORK. THE LISTED UNIT PRICES WILL ALSO BE USED FOR DETERMINING THE VALUE OF QUANTITIES INCLUDED IN THE SPECIFICATIONS. PRICES SHALL REFLECT THE BASIS FOR FURNISHING ALL LABOR, MATERIAL, EQUIPMENT AND OTHER RELATED ITEMS NECESSARY FOR COMPLETION OF WORK (IN PLACE). THE QUOTED FIGURE SHALL INCLUDE CONTRACTOR'S OVERHEAD AND PROFIT.

THE OWNER/ARCHITECT HEREBY RESERVES THE RIGHT TO ORDER ANY ADDITION OR DEDUCTION OF MATERIALS ON BASIS OF UNIT COST FIGURES QUOTED.

NUMBER	DESCRIPTION	COST
--------	-------------	------

<b>CU-1</b>	<b>Trench Rock</b> Provide all labor, material and equipment trench rock and replace with compacted structural fill, to be used as an add or deduct from bid quantities and/or allocation of bid allowance. Unit of Measurement: per cubic yard of trench rock measured in place.	\$ _____cy
<b>CU-2</b>	<b>Rock Excavation / Removal</b> Provide all labor, material and equipment for rock excavation / removal using non-blasting methods and replace with compacted structural fill, to be used from allocation of bid allowance. Unit of Measurement: per cubic yard of rock measured in place.	\$ _____cy

### **SITE SUPERVISION**

**THE SUCCESSFUL CONTRACTOR IS TO PROVIDE FULL TIME SITE SUPERVISION FOR HIS OR HER STAFF, SUBCONTRACTORS AND SUPPLIERS FOR THE DURATION OF THIS PROJECT. A COMPETENT SUPERINTENDENT SHALL BE IN ATTENDANCE AT THE JOB SITE AT ALL TIMES WHEN WORK IS BEING PERFORMED UNDER THEIR CONTRACT. THE SUPERINTENDENT IS RESPONSIBLE TO VISIT THE JOB SITE DAILY WHEN WORK IS NOT BEING PERFORMED UNDER THEIR CONTRACT AND TO MONITOR THE OVERALL CONSTRUCTION PROGRESS. A QUALIFIED SITE SUPERINTENDENT MUST HAVE THE AUTHORITY TO REPRESENT AND MAKE DECISIONS FOR HIS OR HER COMPANY WITH REGARDS TO THE SUBJECT JOB, MUST BE ABLE TO GIVE GUIDANCE AND DIRECTION TO EMPLOYEES, SUBCONTRACTORS AND SUPPLIERS, AND MUST BE KNOWLEDGEABLE ABOUT THE WORK TO BE PROVIDED. FAILURE TO PROVIDE A QUALIFIED SITE SUPERINTENDENT AT THE JOB SITE SHALL SUBJECT SAID PRIME CONTRACTOR TO A PENALTY OF \$1,000 PER DAY FOR EVERY OCCURRENCE.**

### **TIME OF COMPLETION**

**ALL WORK UNDER THIS CONTRACT SHALL BE COMPLETED BETWEEN THE FOLLOWING HOURS, IN ACCORDANCE WITH THE FOLLOWING DATES:**

<b>WORK DAYS:</b>	<b>MONDAY – FRIDAY</b>
<b>WORK HOURS:</b>	<b>7:00 AM – 5:00 PM</b>
<b>WEEKEND WORK DAYS:</b>	<b>SATURDAY</b>
<b>WEEKEND WORK HOURS:</b>	<b>9:00 AM – 5:00 PM</b>
<b>CONSTRUCTION START DATE:</b>	<b>MONDAY, JUNE 27, 2022</b>
<b>SUBSTANTIAL COMPLETION:</b>	<b>TUESDAY, AUGUST 30, 2022</b>
<b>FINAL COMPLETION:</b>	<b>FRIDAY, SEPTEMBER 30, 2022</b>

**IF NECESSARY, WEEKEND, HOLIDAY AND EVENING WORK SHALL BE PROVIDED TO ENSURE**



**THE COMPLETION DATES LISTED ABOVE, AT THE SOLE COST AND EXPENSE OF THE BIDDER.**

FAILURE OF THE CONTRACTOR TO COMPLETE WORK BY THE SPECIFIED TIME SHALL SUBJECT HIM/HER TO LIQUIDATED DAMAGES AS SET FORTH IN ARTICLE 13 OF THE GENERAL CONDITIONS.

THE ARCHITECT/ENGINEER SHALL ACT AS THE RECORD KEEPER OF CONTRACT DAYS; HE WILL BE THE SOLE JUDGE OF DELAYS CAUSED BY WEATHER. ONLY WEATHER DELAYS, AS ADJUDGED BY THE ARCHITECT/ENGINEER, WILL BE CONSIDERED FOR EXTENSIONS OF THE CONSTRUCTION PERIOD. THE CONTRACTOR SHALL SUBMIT A BI-WEEKLY REQUEST FOR DELAYS DUE TO WEATHER TO THE ARCHITECT/ENGINEER FOR APPROVAL. NO OTHER DELAY CLAIMS WILL BE ACCEPTED, FOR CREDIT TOWARDS THE PROJECT COMPLETION SCHEDULE, REGARDLESS OF THE SOURCE OF THE DELAY.

FAILURE OF THE CONTRACTOR TO COMPLETE ALL WORK SHOWN AND SPECIFIED IN THE CONTRACT DOCUMENTS, BY ALL OF THE SPECIFIED TIME FRAMES, SHALL SUBJECT THE CONTRACTOR TO LIQUIDATED DAMAGES, AS SET FORTH IN ARTICLE 13 OF THE GENERAL CONDITIONS OF THE CONTRACT FOR CONSTRUCTION, IN THE SUM OF ONE THOUSAND DOLLARS (\$1,000.00) PER CALENDAR DAY. SUCH DAMAGES WILL COMMENCE ON THE DAY AFTER THE COMPLETION DATE OR THE DAY AFTER ANY LISTED MILESTONE DATE IN THE NOTICE TO PROCEED.

WITHIN TEN (10) CONSECUTIVE CALENDAR DAYS AFTER THE DATE OF THE NOTICE OF AWARD, THE BIDDER SHALL EXECUTE THE CONTRACT AND FURNISH THE REQUIRED PERFORMANCE BOND, PAYMENT BOND AND INSURANCES.

**THE BOARD OF EDUCATION OF THE DISTRICT RESERVES THE RIGHT TO AWARD THIS CONTRACT TO OTHER THAN THE LOW BIDDER IF THE LAW SO PERMITS.**

THE UNDERSIGNED HEREBY ACKNOWLEDGES RECEIPT OF THE FOLLOWING ADDENDA (IF ANY):

ADDENDUM NO.

DATED

\_\_\_\_\_  
\_\_\_\_\_

\_\_\_\_\_  
\_\_\_\_\_

**SPECIFIC DAMAGES WILL BE ASSESSED AND DEDUCTED FROM AMOUNTS OTHERWISE DUE THE CONTRACTOR FOR ADDITIONAL INSPECTION (FIELD) AND CONTRACT ADMINISTRATION (OFFICE) TIME EXPENDED BY THE ARCHITECT/ENGINEER AND/OR OTHER CONSTRUCTION EMPLOYEE(S) HIRED TO ADMINISTER OR OBSERVE THE CONTRACT, SHOULD THE CONTRACTOR COMPLETE THE CONTRACT BEYOND THE CONTRACT COMPLETION PERIOD SPECIFIED ABOVE.**

**SUCH DEDUCTION SHALL BE IN ACCORDANCE WITH THE ARCHITECT, ENGINEER'S, AND/OR OTHER CONSTRUCTION EMPLOYEE(S) STANDARD HOURLY BILLING RATES IN EFFECT AT THE TIME FOR THE SCHOOL DISTRICT.**

**THE REQUIREMENTS OF THE PROPOSAL HAVE BEEN COMPLETELY READ, UNDERSTOOD AND ACKNOWLEDGED BY THE BIDDER.**

BIDDER: \_\_\_\_\_

BIDDER'S ADDRESS: \_\_\_\_\_

SIGNED BY: \_\_\_\_\_ TITLE: \_\_\_\_\_

NOTICE TO BIDDERS  
IRVINGTON UNION FREE SCHOOL DISTRICT



DATE: \_\_\_\_\_

Telephone number where the contractor or a competent representative can accept a telephone message and provide a reasonable reply as soon as possible, but not later than twenty-four (24) hours:

DAY: ( ) \_\_\_\_\_ NIGHT: ( ) \_\_\_\_\_

FAX: ( ) \_\_\_\_\_

FEDERAL I.D. NO. OR SOCIAL SECURITY NO.: \_\_\_\_\_

## PART 1 - GENERAL

### 1.01 RELATED DOCUMENTS

- A. Drawings and general provisions of the Contract, including General and Supplementary Conditions and Division 01 Specification Sections, apply to this Section.

### 1.02 SUMMARY

- A. Section includes portable, hand-carried fire extinguishers and mounting brackets for fire extinguishers.

### 1.03 ACTION SUBMITTALS

- A. Product Data: For each type of product. Include rating and classification, material descriptions, dimensions of individual components and profiles, and finishes for fire extinguisher and mounting brackets.
- B. Product Schedule: Provide Fire Extinguishers in locations as shown on the drawings and as required by the AHJ.

### 1.04 INFORMATIONAL SUBMITTALS

- A. Warranty: Sample of special warranty.

### 1.05 CLOSEOUT SUBMITTALS

- A. Operation and Maintenance Data: For fire extinguishers to include in maintenance manuals.

### 1.06 COORDINATION

- A. Coordinate type and capacity of fire extinguishers with fire-protection cabinets to ensure fit and function.

### 1.07 WARRANTY

- A. Special Warranty: Manufacturer's standard form in which manufacturer agrees to repair or replace fire extinguishers that fail in materials or workmanship within specified warranty period.
  - 1. Failures include, but are not limited to, the following:
    - a. Failure of hydrostatic test according to NFPA 10.
    - b. Faulty operation of valves or release levers.
  - 2. Warranty Period: Six years from date of Substantial Completion.

## PART 2 - PRODUCTS

### 2.01 PERFORMANCE REQUIREMENTS

- A. NFPA Compliance: Fabricate and label fire extinguishers to comply with NFPA 10, "Portable Fire Extinguishers."
- B. Fire Extinguishers: Listed and labeled for type, rating, and classification by an independent testing agency acceptable to authorities having jurisdiction.
  - 1. Provide fire extinguishers approved, listed, and labeled by FM Global.

2. UL 299 - Dry Chemical Fire Extinguisher.

## 2.02 PORTABLE, HAND-CARRIED FIRE EXTINGUISHERS

- A. Fire Extinguishers: Type, size, and capacity for each fire-protection cabinet and wall-mounted bracket as indicated.
  1. Manufacturers: Subject to compliance with requirements, provide products by one of the following:
  2. Basis-of-Design Product: Subject to compliance with requirements, provide or comparable product by one of the following:
    - a. Amerex Corporation.
    - b. Ansul Incorporated.
    - c. JL Industries, Inc.; a division of the Activar Construction Products Group.
    - d. Kidde Residential and Commercial Division; Subsidiary of Kidde plc.
    - e. Potter Roemer LLC.
  3. Valves: Nickel-plated, polished-brass body.
  4. Handles and Levers: Stainless steel.
  5. Instruction Labels: Include pictorial marking system complying with NFPA 10, Appendix B, and bar coding for documenting fire extinguisher location, inspections, maintenance, and recharging.
- B. Multipurpose Dry-Chemical Type in Steel Container: UL-rated 4-A:60-B:C, 10-lb (4.5-kg) nominal capacity, with monoammonium phosphate-based dry chemical in enameled-steel container.
  1. Model 3010 as manufactured by Potter-Roemer or approved equal.

## 2.03 MOUNTING BRACKETS

- A. Mounting Brackets: Manufacturer's standard galvanized steel, designed to secure fire extinguisher to wall or structure, of sizes required for types and capacities of fire extinguishers indicated, with plated or red baked-enamel finish.
  1. Manufacturers: Subject to compliance with requirements, provide products by one of the following:
  2. Basis-of-Design Product: Subject to compliance with requirements, provide product indicated on Drawings or comparable product by one of the following:
    - a. Amerex Corporation.
    - b. Ansul Incorporated.
    - c. JL Industries, Inc.; a division of the Activar Construction Products Group
    - d. Larsen's Manufacturing Company.
    - e. Potter Roemer LLC.
- B. Identification: Lettering complying with authorities having jurisdiction for letter style, size, spacing, and location. Locate as indicated by Architect.
  1. Identify bracket-mounted fire extinguishers with the words "FIRE EXTINGUISHER" in red letter decals applied to mounting surface.
    - a. Orientation: Vertical.
    - b. Signage shall comply with the requirements of the authority having jurisdiction.
    - c. Signs shall be provided at each fire extinguisher location and shall be as follows:
      - 1) Enamel-coated Aluminum sign, 24" height by 5" wide, Triangle in shape and multi-angle viewable, Red background with white graphics reading "Fire Extinguisher". Sign shall be suitable for interior and exterior use.
      - 2) Signs shall be UV, chemical, abrasion and moisture resistant.



- 3) Model No. NHE-7497 Tri as manufactured by Compliance Signs 1-800-578-1245; Allstate Sign & Plaque 1-800-240-6039 or approved equal.

## **PART 3 - EXECUTION**

### **3.01 EXAMINATION**

- A. Examine fire extinguishers for proper charging and tagging.
  1. Remove and replace damaged, defective, or undercharged fire extinguishers.
- B. Proceed with installation only after unsatisfactory conditions have been corrected.

### **3.02 INSTALLATION**

- A. General: Install fire extinguishers, fire extinguisher cabinets and mounting brackets and compliance signage in locations indicated and in compliance with requirements of authorities having jurisdiction.
  1. Wall Mounted Fire Extinguishers: Mount Extinguishers as indicated on the drawings.
  2. Cabinet Mounted Fire extinguishers: Mount cabinets as indicated on the drawings. Note: cabinet mounting height shall provide a maximum height of 42" to the top of the extinguisher handle.
- B. Mounting Brackets: Fasten mounting brackets to surfaces, square and plumb, at locations indicated. Provide solid blocking in wall behind as required for anchorage of brackets and cabinets.

## **END OF SECTION**