



ADDENDUM

ADDENDUM NUMBER 3

PROJECT | Nanuet Union Free School District

Nanuet 2020 Miller Hydronic Conversion

OFFICE ADDRESS | KSQ DESIGN

215 W 40th Street, 15th Floor | New York, NY 10018 | 914.682.3700

PROJECT NUMBER | 1911002.00 Delta Engineers Number 2019.229.001

Date | 4/7/2021

NOTICE TO CONTRACTORS|

This Addendum issued prior to receipt of Bid shall and does hereby become a part of the Construction Documents for the above project.

All principal Contractors shall be responsible for seeing that their Subcontractors are properly apprised of the contents of this Addendum.

All information contained in this Addendum shall supersede and shall take precedence over any conflicting information in the original Bidding Documents dated [Click or tap to enter a date.](#) and all previous addenda.

All Contractors shall acknowledge receipt of this Addendum in the space provided in the Proposal Form. Failure to do so may subject Bidder to disqualification.

A. CHANGES TO PRIOR ADDENDA

None.

B. CHANGES TO BIDDING REQUIREMENT

None.

C. CHANGES TO CONDITIONS OF THE CONTRACT

None.

D. CHANGES TO SPECIFICATIONS

None

E. CHANGES TO DRAWINGS

- a. Sheet MES H601: Added notes requirements for the fan coil units AHU-1 & 2 in the gym. Replaced Sheet.
- b. Sheet MES E101 Deleted field installed disconnect. Replaced Sheet.

GENERAL: None

STRUCTURAL: None

ADDENDUM

ARCHITECTURAL: None

MECHANICAL:
Sheet MES H601

ELECTRICAL:
Sheet MES-E101:

PLUMBING: N/A

FIRE PROTECTION: N/A

ENCLOSURES:

SPEC SECTIONS
None

F. **CLARIFICATIONS**
None

SHEETS

GENERAL	CIVIL	STRUCT	ARCH	MECH	ELEC	PLUMB	FIRE PROT
				MES-M601	MES-E101		

END OF ADDENDA



NANUET
MILLER ES
HYDRONIC
CONVERSION
2020

103 Church St, Nanuet,
NY 10954

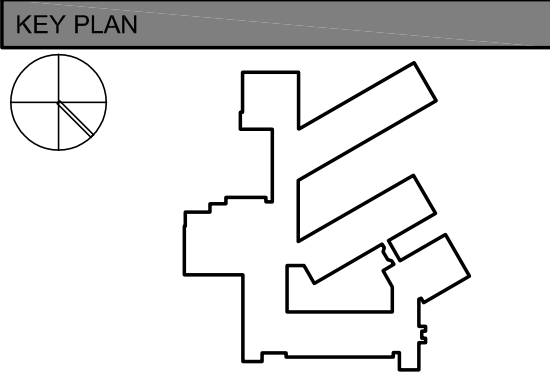
[illegible]

ISSUED: ISSUE FOR BID
DATE: MARCH 15, 2021
SCALE: As indicated
SHEET NAME: HVAC SCHEDULES

MES-M601

ISSUE FOR BID SET



3 FIRST FLOOR POWER & SYSTEMS PLAN
MES-E101 SCALE: 1/16" = 1'-0"

1. PROVIDE 3/4" EMT CONDUIT SLEEVES THROUGH ALL WALLS FOR FIRE ALARM AND POWER BRANCH CIRCUITS. PROVIDE FIRESTOPPING AROUND SLEEVES AND IN BETWEEN SLEEVE AND CABLE OR BRANCH CIRCUIT CABLE2
2. ROUTE SURFACE RACEWAY SW TO CORRIDOR WALL (MOUNT ON WALL JUST JUST ABOVE CEILING) AND TRANSITION TO MC CABLE AT WALL, THROUGH SLEEVE AND TO ABOVE ACCESSIBLE CORRIDOR CEILING, TYPICAL.
3. INSTALL ALL FIRE ALARM CABLE IN CLASSROOMS IN SURFACE RACEWAY TYPE SW ALSO REFER TO GENERAL NOTE 2 THIS DRAWING.
4. ANY ELECTRICAL WORK PERFORMED OR REQUIRED IN STEAM TUNNELS ARE TO BE CONSIDERED CONFINED SPACES. WORK IN THESE SPACES SHALL CONFORM TO ALL OSHA AND RELATED REGULATIONS.

- (1) PROVIDE RECONNECTION OF EXISTING POWER BRANCH CIRCUIT WIRING TO REPLACEMENT UNIT VENTILATOR. EXTEND AS NECESSARY USING #12/2 MC CABLE BRANCH CIRCUIT WIRING TO COMPLETE CONNECTION.
- (2) REFER TO POWER RISER DIAGRAM 1/MES-0500.
- (3) PROVIDE #12/2 MC CABLE TO PANELBOARD INDICATED.
- (4) PROVIDE 2-#12 AWG, 1-#12 AWG EGC IN SURFACE RACEWAY TYPE SR TO PANELBOARD INDICATED. TRANSITION TO #12/3 MC CABLE WHERE CONCEALED ABOVE CEILING.
- (5) PROVIDE 3-#8 AWG, 1-#12 AWG EGC IN 3/4" RIGID STEEL CONDUIT TO PANELBOARD INDICATED.
- (6) PROVIDE 3-#8 AWG, 1-#12 AWG EGC IN 1" GALVANIZED RIGID STEEL CONDUIT FROM VFD TO PUMP.
- (7) PROVIDE EQUIPMENT STATION MOUNTING TO MOUNT VFD'S. REFER TO DETAIL 4/MES-0500.
- (8) PROVIDE (1) 20 AMP, 1-POLE, 120V, 22K AIC CIRCUIT BREAKER INSTALLED WITHIN EXISTING PANELBOARD. CIRCUIT BREAKERS TO BE UL LISTED FOR INSTALLATION WITHIN EXISTING PANELBOARD AS MANUFACTURED BY SIEMENS IEC PANELBOARD TYPE UB28424. PANEL.
- (9) PROVIDE (1) 20 AMP, 1-POLE, 120V, 22K AIC CIRCUIT BREAKER INSTALLED WITHIN EXISTING PANELBOARD. CIRCUIT BREAKERS TO BE UL LISTED FOR INSTALLATION WITHIN EXISTING PANELBOARD AS MANUFACTURED BY SIEMENS IEC PANELBOARD TYPE CD-7.1 PANEL.
- (10) PROVIDE (1) 60 AMP, 3-POLE, 208V, 22K AIC CIRCUIT BREAKER (TO SERVE PUMPS P-1 & P-2) INSTALLED WITHIN EXISTING PANELBOARD. CIRCUIT BREAKERS TO BE UL LISTED FOR INSTALLATION WITHIN EXISTING PANELBOARD AS MANUFACTURED BY SQUARE D NOOD PANEL.
- (11) REUSE EXISTING 20A/3P CIRCUIT BREAKER (1,3,5) TO FEED BFU-1 UNIT.
- (12) PROVIDE (3) 30 AMP, 240 VOLT RATED, 3-POLE, NEMA 3R HEAVY DUTY NON FUSED DISCONNECT SWITCH.
- (13) PROVIDE RECONNECTION OF EXISTING POWER BRANCH CIRCUIT WIRING TO REPLACEMENT CABINET UNIT HEATER. EXTEND AS NECESSARY USING 2-#12 AWG, 1-#12 AWG EGC IN 3" CONDUIT BRANCH CIRCUIT WIRING TO COMPLETE CONNECTION.
- (14) PROVIDE (3) #12 AND (1) #12 EGC IN 1/2" C BRANCH CIRCUIT HOMERUN.
- (15) CONNECT BRACH CIRCUITS FOR AHU-1 AND AHU-2 TO EXISTING 20A, 3 POLE CIRCUIT BREAKERS.

ksqdesign

**NEW YORK OKLAHOMA NORTH
CAROLINA
TEXAS COLORADO SOUTH
CAROLINA**

KSQ Design
215 W 40th Street
New York, NY 10018
914.682.3700 office
917.591.7013 fax
www.ksq.design

Owner
Nanuet Union Free School District
 Nanuet High School Global Learning Commons
 103 Church St, Nanuet, NY 10954
 845.627.9880 office
 845.624.5338 fax
<http://www.nanuetbsd.org/>

Environmental Engineer
Green Path Environmental, Inc.
79 Glover Street, Suite 1
Staten Island, NY 10308
347.276.2339 office

MEP Engineer
DELTA Engineers, Architects, & Land
Surveyors, DPC
220 Harborside Dr, Suite 202
Schenectady, NY 12305
518.427.7200 office

SED CONTROL NUMBERS
MILLER ES #: 50-01-08-03-0-001-022



NANUET
MILLER ES
HYDRONIC
CONVERSION
2020

103 Church St, Nanuet,
NY 10954

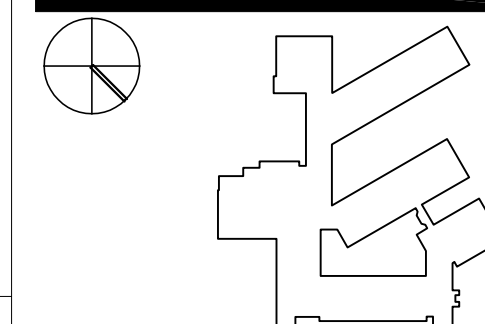
[illegible]

ISSUED: ISSUE FOR BID
DATE: MARCH 15, 2021
SCALE: As indicated
SHEET NAME:
FIRST FLOOR
POWER & SYSTEMS
PLAN
SHEET NUMBER:

MES-E101

SSUE FOR BID SET