

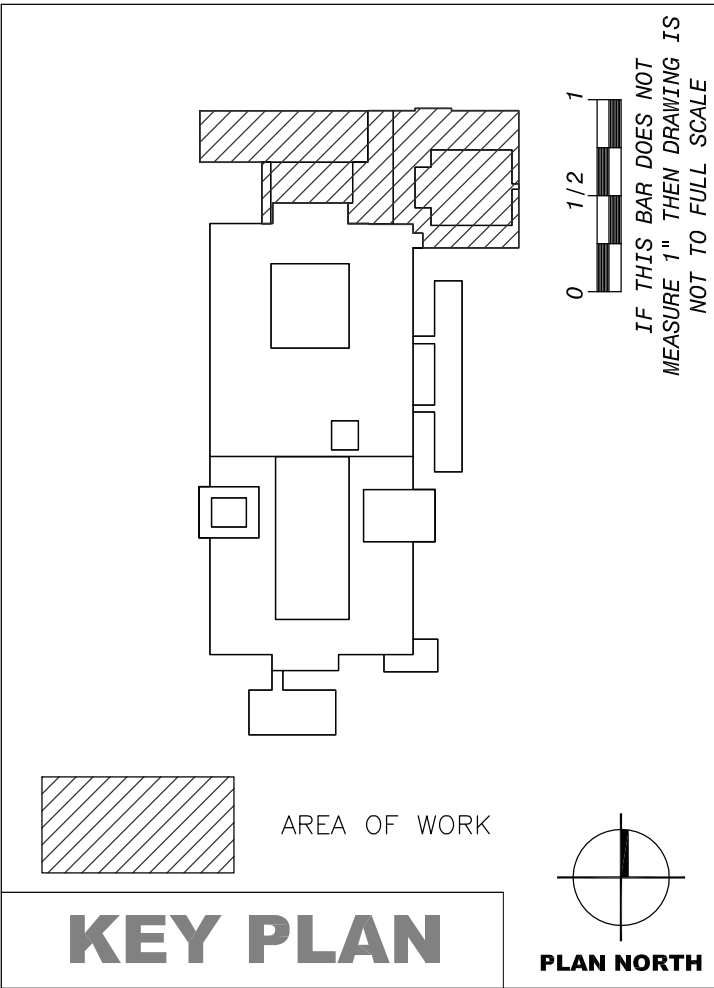

ABATEMENT FOR EACH ROOF SURFACE SHALL BE INCLUDED IN THE BASE BID REMOVAL AND EACH ALTERNATE. COORDINATE WITH ALTERNATE ROOFING AREAS ON DRAWING A-100.

NOTES

- ACM LEGEND:**
- REMOVE AND DISPOSE OF ACM PERIMETER FLASHING TAR.
 - REMOVE AND DISPOSE OF ACM EQUIPMENT/VENT FLASHING TAR.
 - 1** REMOVE AND DISPOSE OF ACM TERMINATION BAR CAULK.



BIDDING DOCUMENTS		
No.	Date	Revisions
1	11-26-21	

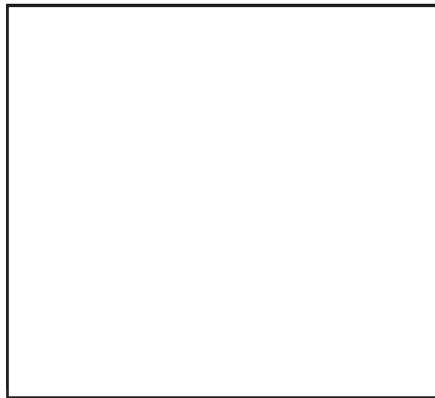

Drawn by	JP
Checked by	RL
Project No.	41056
Scale	AS NOTED
Date	09-22-21

Asbestos Consultant:	
Structural Engineer:	

NORTH ROCKLAND HIGH SCHOOL ANNEX ROOF REPLACEMENT	
SED # 50-02-01-06-0-016-032	
100 BLANKENY ROAD TIBBLES, NY 10984	
TOWN OF TOWNSHIRE COUNTY OF ROCKLAND	

MICHAEL SHILALE ARCHITECTS, L.L.P.
140 Park Avenue New City, NY 10956 Tel 914-705-5000
www.hsa.com

Drawing Title
ACM LOCATIONS ROOF PLAN

Drawing No.
ASB-100

