

BEFORE FABRICATION THIS CONTRACTOR SHALL VERIFY ALL MEASUREMENTS AND CONDITIONS ON JOB AND COORDINATE HIS WORK WITH THE WORK OF ALL OTHER CONTRACTORS

SCHEDULE OF MINIMUM VENTILATION ROOM FLOW RATES											
		A	B	C	D	E	F	G	H	I	
ROOM NAME/NUMBER	OCCUPANCY CATEGORY	ROOM AREA (SQ.FT.)	PEOPLE DENSITY (HP/1000 SQ.FT.)	PEOPLE OUTDOOR AIR FLOW RATE (CFM/PERSON)	AREA OUTDOOR AIR FLOW RATE IN BREATHING ZONE (CFM/SQ.FT.)	EXHAUST AIR FLOW RATE (CFM/SQ.FT.)	NUMBER OF PEOPLE (A+B)+1000=HP	OUTDOOR AIR FLOW RATE WITHOUT ZONE EFFECTIVENESS FACTOR (F+C)+(A+D)=CFM	ZONE AIR DISTRIBUTION EFFECTIVENESS FACTOR	MINIMUM ROOM VENTILATION AIR FLOW RATE G+H=CFM	MINIMUM EXHAUST AIR FLOW RATE A+E=CFM
H201											
CLASSROOM 1	CLASSROOM (AGES 5-8)	850	25	10	0.12	0	22	322	0.8	403	0
CLASSROOM 2	CLASSROOM (AGES 5-8)	850	25	10	0.12	0	22	322	0.8	403	0
CLASSROOM 3	CLASSROOM (AGES 5-8)	850	25	10	0.12	0	22	322	0.8	403	0
CLASSROOM 4	CLASSROOM (AGES 5-8)	850	25	10	0.12	0	22	322	0.8	403	0
CLASSROOM 5	CLASSROOM (AGES 5-8)	850	25	10	0.12	0	22	322	0.8	403	0
CLASSROOM 6	CLASSROOM (AGES 5-8)	850	25	10	0.12	0	22	322	0.8	403	0
CLASSROOM 7	CLASSROOM (AGES 5-8)	850	25	10	0.12	0	22	322	0.8	403	0
CLASSROOM 8	CLASSROOM (AGES 5-8)	850	25	10	0.12	0	22	322	0.8	403	0
CLASSROOM 9	CLASSROOM (AGES 5-8)	850	25	10	0.12	0	22	322	0.8	403	0
CLASSROOM 10	CLASSROOM (AGES 5-8)	970	25	10	0.12	0	25	366	0.8	458	0
CLASSROOM 11	CLASSROOM (AGES 5-8)	850	25	10	0.12	0	22	322	0.8	403	0
SMALL INSTRUCTION GROUP 12	CLASSROOM (AGES 5-8)	330	25	10	0.12	0	9	130	0.8	162	0
SMALL INSTRUCTION GROUP 14	CLASSROOM (AGES 5-8)	340	25	10	0.12	0	9	131	0.8	164	0
FACULTY 16	BREAK ROOMS	680	50	5	0.12	0	34	252	0.8	315	0
CLASSROOM 18	CLASSROOM (AGES 5-8)	765	25	10	0.12	0	20	292	0.8	365	0
FACULTY TOILET	TOILETS - PUBLIC	53	2 FXTURES	-	-	50 CFM/ FXTURE	-	-	-	-	100
CLASSROOM /3	CLASSROOM (AGES 5-8)	140	25	10	0.12	0	4	57	0.8	71	0
CAFETERIA 54	CAFETERIA/FAST-FOOD DINING	2170	100	7.5	0.18	0	217	2018	0.8	2523	0
Cafeteria Toilet 1	TOILETS - PUBLIC	24	2 FXTURES	-	-	50 CFM/ FXTURE	-	-	-	-	100
Cafeteria Toilet 2	TOILETS - PUBLIC	24	2 FXTURES	-	-	50 CFM/ FXTURE	-	-	-	-	100
CLASSROOM 3	CLASSROOM (AGES 5-8)	2126	25	10	0.12	0	64	795	0.8	994	0
CLASSROOM 13A	CLASSROOM (AGES 5-8)	420	25	10	0.12	0	11	160	0.8	201	0
CLASSROOM 13B	CLASSROOM (AGES 5-8)	303	25	10	0.12	0	8	116	0.8	145	0
CLASSROOM 13C	CLASSROOM (AGES 5-8)	354	25	10	0.12	0	9	132	0.8	166	0
TOILET F-2	TOILETS - PUBLIC	275	5 FXTURES	-	-	50 CFM/ FXTURE	-	-	-	-	250
TOILET F-2	TOILETS - PUBLIC	275	5 FXTURES	-	-	50 CFM/ FXTURE	-	-	-	-	250
TOILET F-3	TOILETS - PUBLIC	79	2 FXTURES	-	-	50 CFM/ FXTURE	-	-	-	-	100
TOILET T-4	TOILETS - PUBLIC	30	2 FXTURES	-	-	50 CFM/ FXTURE	-	-	-	-	100
TOILET T-5	TOILETS - PUBLIC	275	5 FXTURES	-	-	50 CFM/ FXTURE	-	-	-	-	250
TOILET T-6	TOILETS - PUBLIC	275	5 FXTURES	-	-	50 CFM/ FXTURE	-	-	-	-	250
Janitor	JANITOR CLOSETS, TRASH ROOMS, RECYCLING	53	0	0	0	1	0	0	0.8	0	53
TOILET 55A	TOILETS - PUBLIC	32	2 FXTURES	-	-	50 CFM/ FXTURE	-	-	-	-	100
KITCHEN 65	KITCHEN (COOKING)	402	20	7.5	0.12	0.7	9	116	0.8	145	281
H202											
SGR 141	CLASSROOM (AGES 5-8)	90	25	10	0.12	0	3	41	0.8	51	0
CONFERENCE ROOM 63	CONFERENCE/MEETING	196	50	5	0.06	0	10	62	0.8	77	0
WORKROOM 64A	BREAK ROOMS	67	50	5	0.12	0	4	28	0.8	35	0
SUPPLY 64	OCCUPIABLE STORAGE ROOMS FOR DRY MATERIALS	57	2	5	0.06	0	1	8	0.8	11	0
PRINCIPAL 61	OFFICE SPACE	154	5	5	0.06	0	1	14	0.8	18	0
MAIN OFFICE 67	OFFICE SPACE	385	5	5	0.06	0	2	33	0.8	41	0
ASSISTANT PRINCIPAL 62	OFFICE SPACE	111	5	5	0.06	0	1	12	0.8	15	0
SECURITY 60	OFFICE SPACE	88	5	5	0.06	0	1	10	0.8	13	0
SECURE VESTIBLE 59	OFFICE SPACE	207	5	5	0.06	0	2	22	0.8	28	0
MUSIC 20	MUSIC/THEATRE/DANCE	1165	35	10	0.06	0	41	480	0.8	600	0
GRAY BOX GB1.0	MUSIC/THEATRE/DANCE	2965	35	10	0.06	0	104	1218	0.8	1522	0
GYM 53	GYM, SPORTS ARENA (PLAY AREA)	2685	7	20	0.18	0.5	19	863	0.8	1079	1343
TOILET 53A	TOILETS - PUBLIC	475	2 FXTURES	-	-	50 CFM/ FXTURE	-	-	-	-	100
space 1	CONFERENCE/MEETING	542	50	5	0.06	0	28	173	0.8	216	0
space 2	MEDIA CENTER	1925	25	10	0.12	0	49	721	0.8	901	0
corridors	CORRIDORS		0	0	0.06	0	0	0	0.8	0	0
H203											
CLASSROOM 19	CLASSROOM (AGES 5-8)	875	25	10	0.12	0	22	325	0.8	406	0
CLASSROOM 21	CLASSROOM (AGES 5-8)	875	25	10	0.12	0	22	325	0.8	406	0
CLASSROOM 23	CLASSROOM (AGES 5-8)	875	25	10	0.12	0	22	325	0.8	406	0
CLASSROOM 24	CLASSROOM (AGES 5-8)	875	25	10	0.12	0	22	325	0.8	406	0
CLASSROOM 25	CLASSROOM (AGES 5-8)	875	25	10	0.12	0	22	325	0.8	406	0
CLASSROOM 26	CLASSROOM (AGES 5-8)	875	25	10	0.12	0	22	325	0.8	406	0
CLASSROOM 27	CLASSROOM (AGES 5-8)	875	25	10	0.12	0	22	325	0.8	406	0
CLASSROOM 28	CLASSROOM (AGES 5-8)	875	25	10	0.12	0	22	325	0.8	406	0
CLASSROOM 30	CLASSROOM (AGES 5-8)	875	25	10	0.12	0	22	325	0.8	406	0
NURSE 22	OFFICE SPACE	370	5	5	0.06	0	2	32	0.8	40	0
TOILET 22C	TOILETS - PUBLIC	49	2 FXTURES	-	-	50 CFM/ FXTURE	-	-	-	-	100
TOILET T-7	TOILETS - PUBLIC	119	2 FXTURES	-	-	50 CFM/ FXTURE	-	-	-	-	100
TOILET T-8	TOILETS - PUBLIC	115	2 FXTURES	-	-	50 CFM/ FXTURE	-	-	-	-	100
TOILET T-9	TOILETS - PUBLIC	47	2 FXTURES	-	-	50 CFM/ FXTURE	-	-	-	-	100
TOILET T-14	TOILETS - PUBLIC	55	2 FXTURES	-	-	50 CFM/ FXTURE	-	-	-	-	100
OFFICE 22A	OFFICE SPACE	170	5	5	0.06	0	1	15	0.8	19	0
OFFICE 22B	OFFICE SPACE	232	5	5	0.06	0	2	24	0.8	30	0
CLASSROOM 42	CLASSROOM (AGES 5-8)	900	25	10	0.12	0	23	338	0.8	423	0
CLASSROOM 42 TOILET	TOILETS - PUBLIC	31	2 FXTURES	-	-	50 CFM/ FXTURE	-	-	-	-	100
CLASSROOM 44	CLASSROOM (AGES 5-8)	930	25	10	0.12	0	24	352	0.8	440	0
TOILET 42A	TOILETS - PUBLIC	31	2 FXTURES	-	-	50 CFM/ FXTURE	-	-	-	-	100
CLASSROOM 46	CLASSROOM (AGES 5-8)	930	25	10	0.12	0	24	352	0.8	440	0
CLASSROOM 46 TOILET	TOILETS - PUBLIC	31	2 FXTURES	-	-	50 CFM/ FXTURE	-	-	-	-	100
CLASSROOM 50	CLASSROOM (AGES 5-8)	845	25	10	0.12	0	22	321	0.8	402	0
CLASSROOM 50/52 TOILET	TOILETS - PUBLIC	81	2 FXTURES	-	-	50 CFM/ FXTURE	-	-	-	-	100
CLASSROOM 52	CLASSROOM (AGES 5-8)	815	25	10	0.12	0	21	308	0.8	385	0
CLASSROOM 40	CLASSROOM (AGES 5-8)	855	25	10	0.12	0	22	323	0.8	403	0
CLASSROOM 38	CLASSROOM (AGES 5-8)	762	25	10	0.12	0	20	291	0.8	364	0
TOILET T-12	TOILETS - PUBLIC	58	2 FXTURES	-	-	50 CFM/ FXTURE	-	-	-	-	100
TOILET T-13	TOILETS - PUBLIC	58	2 FXTURES	-	-	50 CFM/ FXTURE	-	-	-	-	100
CORRIDOR 101A	CORRIDORS	433	0	0	0.06	0	0	26	0.8	32	0
corridors	CORRIDORS		0	0	0.06	0	0	0	0.8	0	0

Revision Schedule		
No.	Description	Date
1	SED Submission	09/15/2020
2	SED Submission Addendum#1	01/08/2021
3	ISSUED FOR BID	01/19/2021

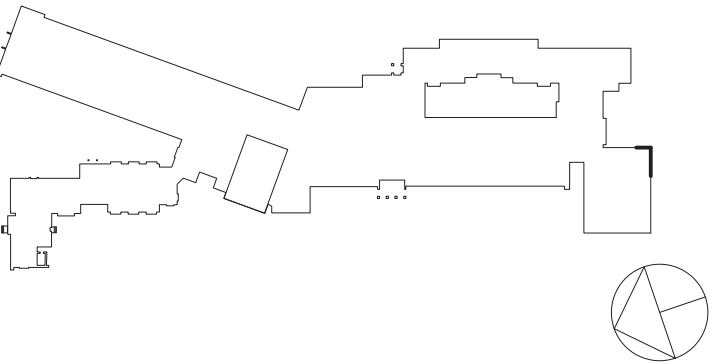

Geddis
Architects

Architecture. Planning. Interiors

71 Old Post Road
P.O. Box 1020
Southport, CT 06890
(203) 256-8700

Fielding
International

Transforming Education by Design

259 Water Street Suite 1L
Warren , RI 02885 USA
+1 401-289-2789

bga

BARILE GALLAGHER & ASSOCIATES

CONSULTING ENGINEERS
39 MARBLE AVE. PLEASANTVILLE, NY 10570
914.328.9060 GENERAL@BGA-ENG.com www.BGA-ENG.com

Construction Manager
SAVIN ENGINEERS, P.C.
3 Campus Drive
Pleasantville, NY 10570
914-769-3200

Structural Engineer
ODEH ENGINEERS
1223 Mineral Spring Ave
North Providence, RI 02904
401-724-1771

Civil Engineer
WESTON & SAMPOSON
1 Winners Circle, Suite 130
Albany, NY 12205
518-463-4400

Acoustic Consultant
DP DESIGN
12 Cold Spring Street
Providence, RI
401-861-3218

SED#: 6618-0001-0003-025

PROJECT

Rye City Schools

555 Theodore Fremd Ave, Suite B-101

Midland Elementary School

312 Midland Ave, Rye NY 10580

SCHEDULES

SEAL & SIGNATURE

DATE: 12/18/19
PROJECT No: 9200
DRAWING BY: BGA
CHK BY: BGA
DWG No: H2-303