

**31 BACKBAR PLAN**  
A507 3/4" = 1'-0"

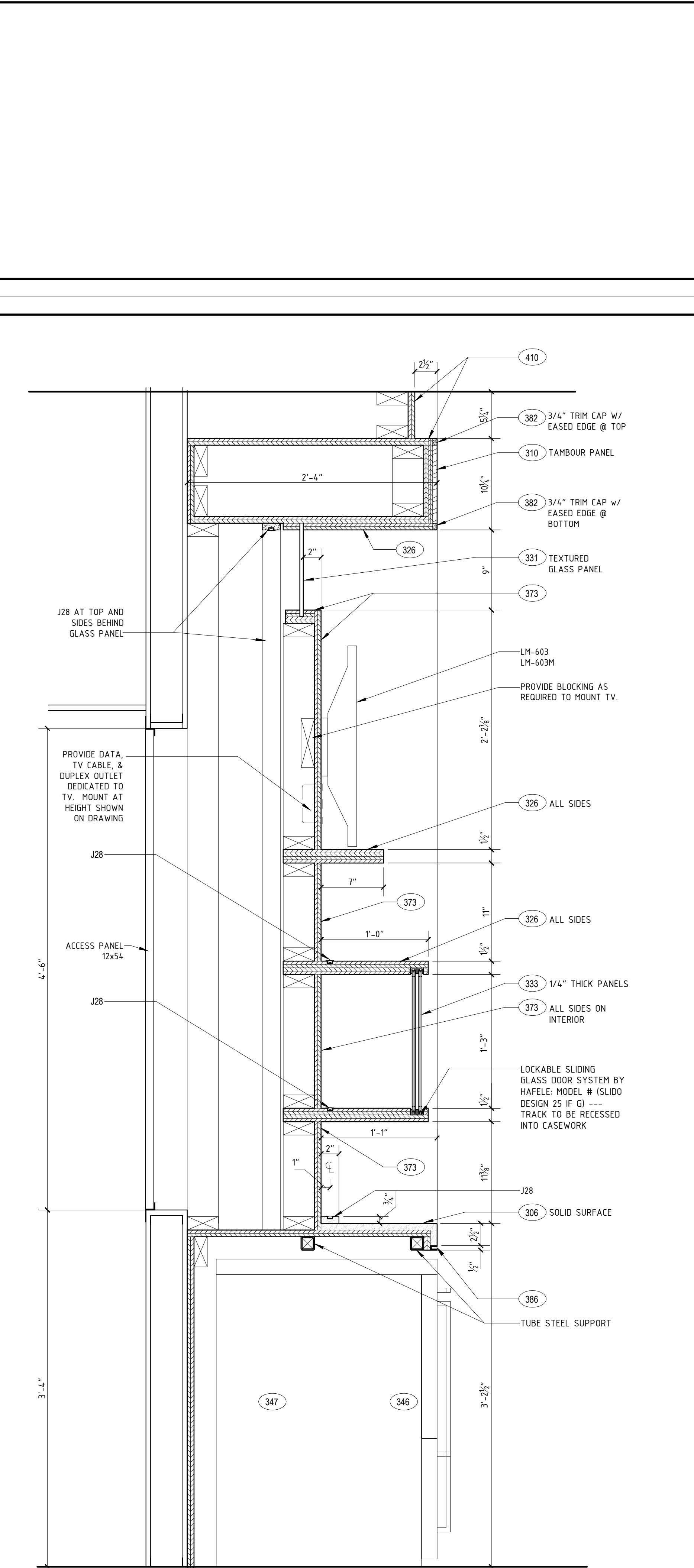

**54 BACKBAR SECTION**  
A507 1-1/2" = 1'-0"

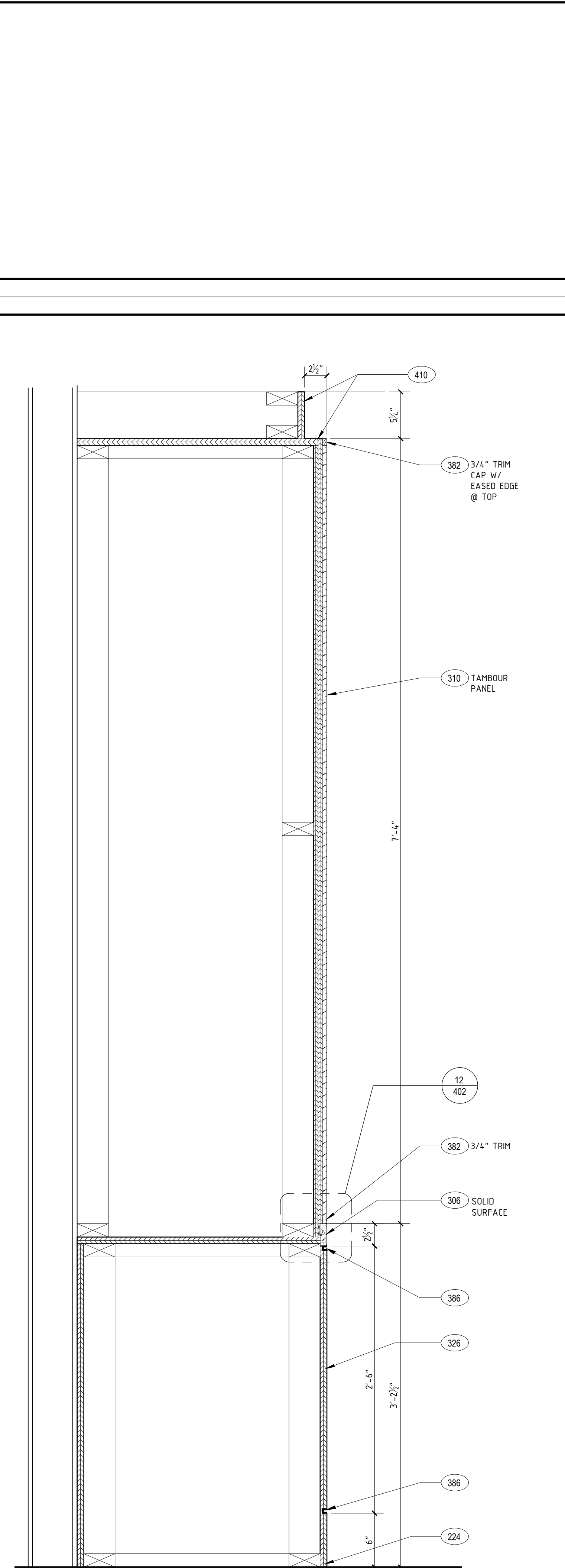

**11 BACKBAR SECTION**  
A507 1-1/2" = 1'-0"

**34 BACKBAR SECTION**  
A507 1-1/2" = 1'-0"

**14 BACKBAR SECTION**  
A507 1-1/2" = 1'-0"