

FOUNDATION PLAN - 2

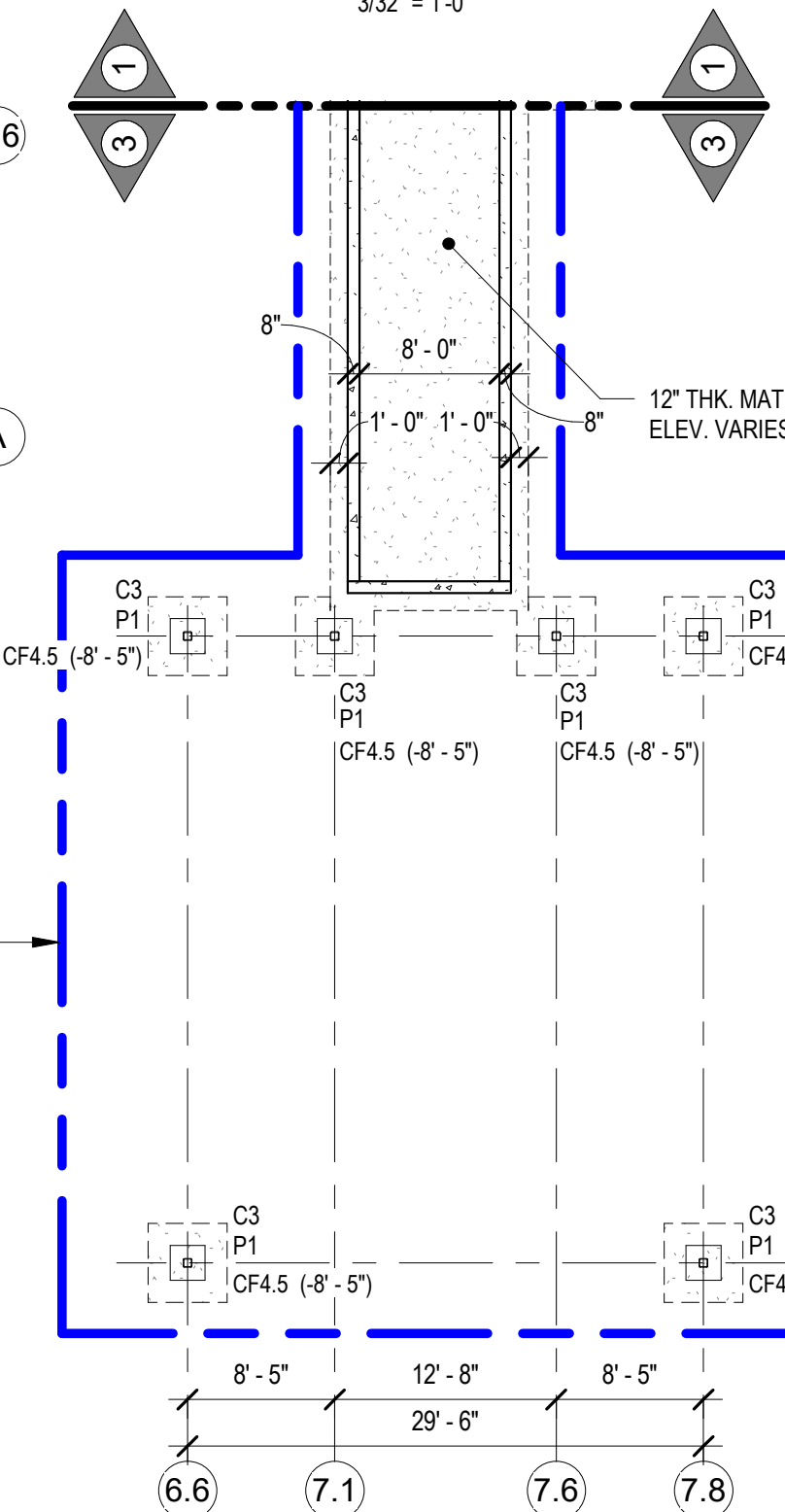

FOUNDATION PLAN - 3

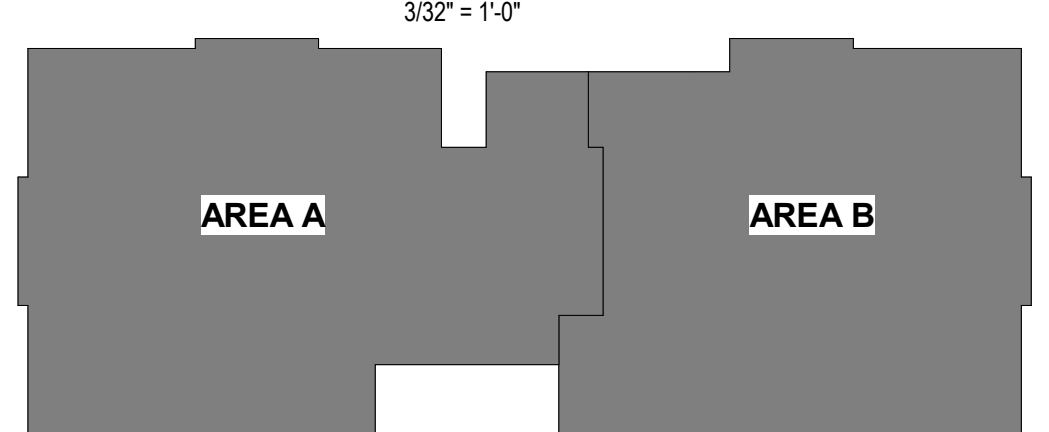

KEY PLAN

CONCRETE REINFORCING SPLICE LENGTH SCHEDULE				
REIN. SIZE	4000 psi		3000 psi	
	TOP HORIZ. BARS (IN.)	VERTICAL (IN.) OR BOTTOM HORIZ.	TOP HORIZ. BARS (IN.)	VERTICAL (IN.) OR BOTTOM HORIZ.
#3	15	12	17	13
#4	20	15	23	18
#5	25	19	28	22
#6	29	23	34	26
#7	43	33	49	38
#8	49	37	56	43
#9	60	46	69	53
#10	72	56	83	64
#11	85	66	98	76

NOTES:
1. TOP HORIZONTAL BARS ARE DEFINED AS HORIZONTAL BARS WITH MORE THAN 12" OF FRESH CONCRETE CAST IN THE MEMBER BELOW THE REINFORCEMENT.
2. BOTTOM HORIZONTAL BARS ARE ALL OTHER HORIZONTAL BARS.
3. FOR LIGHTWEIGHT AGGREGATE CONCRETE, MULTIPLY THE VALUES ABOVE BY 1.3.
4. FOR EPOXY COATED REINFORCEMENT WITH COVER LESS THAN 3db OR CLEAR SPACING LESS THAN 6db, MULTIPLY VALUES ABOVE BY 1.5. FOR ALL OTHER EPOXY COATED REINFORCEMENT, MULTIPLY THE VALUES ABOVE BY 1.3.
5. ALL SPLICES ASSUMED TO BE CLASS B SPLICES.
6. WHEN SPLICING BARS OF DIFFERENT SIZES, USE SPLICE LENGTH FOR LARGEST BAR.
7. MINIMUM HOOK LENGTH EQUALS 16db FOR NO. 3-8 BARS & 17db FOR NO. 9, 10, & 11 BARS.
8. SPLICE LENGTHS GIVEN ARE MINIMUM, U.N.O.

FOUNDATION PLAN

FOUNDATION PLAN NOTES:
1. FINISHED FIRST FLOOR ELEV. = 116.50 (0'-0"), U.N.O.
2. ALL ELEVATIONS NOTED THUS (X'-Y") DENOTATE TOP OF FOOTING OR PIER ELEVATIONS AND ARE WITH RESPECT TO THE FINISHED FIRST FLOOR ELEVATION.
3. TOP OF INTERIOR FOOTING ELEVATION IS (1'-0") BELOW FINISHED FIRST FLOOR ELEVATION, U.N.O.
4. TOP OF EXTERIOR FOOTING ELEVATION IS (3'-0") BELOW FINISHED FIRST FLOOR ELEVATION, U.N.O.
5. TOP OF PIER ELEVATION IS (0'-0") BELOW FINISHED FIRST FLOOR ELEVATION, U.N.O.
6. ALL WALL FOOTINGS SHALL BE WF2.5, U.N.O.
7. ALL COLUMNS TO CENTER ON FOOTINGS AND PIERS, U.N.O. ALL WALLS TO CENTER ON WALL FOOTINGS, U.N.O.
8. ALL INTERIOR FLOOR SLABS SHALL BE 4" THK. NON-AIR ENTRAINED FIBER-REINFORCED CONCRETE ON 4" OF NYSDOT TYPE 2 SUBBASE, U.N.O. PROVIDE SAWCUT CONTROL JOINTS AS INDICATED IN THE CAST-IN-PLACE CONCRETE CONSTRUCTION SECTION OF THE GENERAL SPECIFICATIONS. SUBMIT A CONTROL JOINT LOCATION PLAN TO THE COR FOR REVIEW AND APPROVAL.
9. ALL EXTERIOR CONCRETE SLABS SHALL BE 5" THK. AIR ENTRAINED CONCRETE W/ 6% W2.5xW2.5 W.W.R. ON 6" NYSDOT TYPE 2 SUBBASE, U.N.O. ALL EXTERIOR SLABS SHALL BE TURNED DOWN AROUND PERIMETER AND EXTEND TO (3'-0") BELOW FINISHED GRADE. REFER TO SLAB TURNDOWN DETAIL, SHEET S-201.
10. CONCRETE WALLS SHALL BE REINFORCED W/ #5 @ 18" O.C. VERT., E.F. & #4 @ 18" O.C. HORIZ., E.F., U.N.O. PROVIDE VERTICAL CONTROL JOINTS IN CONCRETE WALLS AS INDICATED IN THE CAST-IN-PLACE CONCRETE CONSTRUCTION SECTION OF THE GENERAL SPECIFICATIONS. U.N.O. SUBMIT A CONTROL JOINT LOCATION PLAN TO THE COR FOR REVIEW AND APPROVAL.
11. MASONRY WALLS SHALL BE REINFORCED W/ #6 @ 16" O.C. WHERE REINFORCING IS SHOWN, U.N.O. PROVIDE CONTROL JOINTS IN MASONRY WALLS AS INDICATED IN THE CONCRETE MASONRY CONSTRUCTION SECTION OF THE GENERAL SPECIFICATIONS, U.N.O.
12. REFER TO FOOTING, COLUMN & BASE PLATE, PIER AND WALL FOOTING SCHEDULES, THIS SHEET.
13. REFER TO ARCHITECTURAL DRAWINGS FOR ALL NECESSARY EMBEDDED ITEMS, RAMPS, STAIRS, LANDINGS, AND FINISH DETAILS.
14. REFER TO ARCHITECTURAL DRAWINGS FOR DIMENSIONS AND ELEVATIONS NOT SHOWN.
15. CONTRACTOR SHALL VERIFY WALL LOCATIONS WITH ARCHITECTURAL PLANS PRIOR TO FOUNDATION LAYOUT. ANY DISCREPANCIES SHALL BE BROUGHT TO THE IMMEDIATE ATTENTION OF THE COR.
16. REFER TO SHEET S-104 FOR ALTERNATE FOUNDATION PLAN.

DEDUCTIVE ALTERNATES (STRUCTURALLY APPLICABLE):

(DEDUCTIVE ALTERNATES ARE CASCAADING AND MUST BE EXERCISED IN THE ORDER PRESENTED). FOR A DETAILED DESCRIPTION OF EACH DEDUCTIVE ALTERNATE REFER TO COVER SHEET ON G1000.

- DEDUCTIVE ALTERNATE #2: ELIMINATE TUNNEL (EAST LEG)
DEDUCTIVE ALTERNATE #3: ELIMINATE FAUX WINDOWS AT CLEARSTORY
DEDUCTIVE ALTERNATE #7: REDUCE PLATFORM AT CHILLER
DEDUCTIVE ALTERNATE #8: ELIMINATE LARGE PORCH
DEDUCTIVE ALTERNATE #10: ELIMINATE SMALL PORCH A
DEDUCTIVE ALTERNATE #11: ELIMINATE SMALL PORCH B
DEDUCTIVE ALTERNATE #12: ELIMINATE ENTRANCE CANOPY
DEDUCTIVE ALTERNATE #14: ELIMINATE PATIENT LIFTS TRACK EXTENSIONS INTO RESIDENTS' ROOMS

GENERAL LEGEND

- REINFORCED MASONRY WALL
- CONCRETE
- 2" DEEPSLAB SLAB, REFER TO ARCH
- 5" CONCRETE SLAB W/ TURNDOWN EDGES
- SHEAR WALL LOCATIONS
- PROPOSED CONDITIONS
- EXISTING CONDITIONS
- SECTION MARK
- MOMENT CONNECTION
- INDICATES STEP FOOTING LOCATION
- INDICATES DEDUCTIVE ALTERNATE ITEM

COLUMN & BASE PLATE SCHEDULE

MARK	SIZE	BASE PLATE	ANCHOR BOLTS
C1	HSS5X5X1/4	11" x 11" x 3/4" THK	(4) 3/4" DIA. BOLTS - 9" EMBED.
C2	HSS8X8X5/8	1'-4" x 1'-4" x 1" THK	(8) 1 1/4" DIA. BOLTS - 22" EMBED.
C3	HSS6X6X1/2	1'-2" x 1'-2" x 1" THK	(4) 1" DIA. BOLTS - 18" EMBED.
C4	HSS10X10X3/4	1'-8" x 1'-8" x 1 1/2" THK	(8) 1 1/2" DIA. BOLTS - 24" EMBED.
C5	HSS5X5X1/2	11" x 11" x 1" THK	(4) 3/4" DIA. BOLTS - 9" EMBED.

REFER TO BASE PLATE DETAILS ON SHEET S-202 FOR ADDITIONAL DETAILS

COLUMN FOOTING SCHEDULE

MARK	DIMENSIONS			REINFORCING
	WIDTH	LENGTH	DEPTH	
CF4.5	4'-6"	4'-6"	1'-0"	5-#4 EACH DIRECTION BOTTOM
CF5.0	5'-0"	5'-0"	1'-0"	5-#5 EACH DIRECTION BOTTOM
CF6.0	6'-0"	6'-0"	1'-0"	5-#5 EACH DIRECTION BOTTOM
CF7.0	7'-0"	7'-0"	1'-5"	9-#6 EACH DIRECTION BOTTOM
CF8.0	9'-0"	9'-0"	1'-9"	9-#6 EACH DIRECTION BOTTOM
CF10.5	10'-6"	10'-6"	1'-9"	9-#7 EACH DIRECTION BOTTOM

PIER SCHEDULE

MARK	TYPE	HEIGHT	REINFORCING
P1	24 x 24	VARIES	(8) #8 BARS VERT. W/ #3 TIES @ 16" O.C. W/ (2) TIES IN TOP 5"
P2	14 x 14	VARIES	(6) #6 BARS VERT. W/ #3 TIES @ 12" O.C. W/ (2) TIES IN TOP 5"
P3	18 x 18	VARIES	(8) #8 BARS VERT. W/ #3 TIES @ 12" O.C. W/ (2) TIES IN TOP 5"
P4	14 x 14	VARIES	(4) #7 BARS VERT. W/ #3 TIES @ 14" O.C. W/ (3) TIES IN TOP 5"

REFER TO TYPICAL PIER DETAIL ON S-201.

WALL FOOTING SCHEDULE

MARK	DIMENSIONS		REINFORCING
	WIDTH	DEPTH	
WF2.5	2'-6"	1'-0"	3-#5 CONTINUOUS BOTTOM WITH #4 TIES AT 4'-0" ON CENTER

CONSULTANT

NORRIS DESIGN
Landscape Architect
416 North Toole Avenue
Tucson, AZ 85701
(520) 622-9565
Josh Orth, PLA

HINMAN
Protective Design Specialist
240 West 35th St, Suite 1004
New York, NY 10001
(212) 967-4890
Corinne Tan, SE

C.S. Davidson, Inc.
Structural
315 West Jackson Street, Suite 102
Lancaster, PA 17603
(717) 481-2991
Jason Vannoy, SE, PE

MES GROUP
MEP
550 North Reo Street, Suite 203
Tampa, FL 33609
(813) 289-4700
Nicholas Stephenson, PE

ARCHITECT/ENGINEER OF RECORD

A/E:
TRIPLE C - The A/E Group
201 E. Jefferson Street, Suite 200
Syracuse, NY 13202
(315) 484-9958
Mat Perkins

TRIPLE C - THE A/E GROUP
A MULTI-DISCIPLINE COMPANY

STAMP



Office of
Construction
and Facilities
Management



Drawing Title

FOUNDATION PLAN

Approved:

Phase

ISSUED FOR CONSTRUCTION

FULLY SPRINKLERED

Project Title

NEW COMMUNITY LIVING CENTER

Location

2094 Albany Post Road, Montrose, NY 10548

Issue Date

05/09/2022

Checked

WCW

Drawn

SIR

Project Number

620-334

Building Number

CLC

Drawing Number

S-101