

A

B

C

D

E

F

A

B

C

D

E

F

REFLECTED CEILING PLAN NOTES:

- ALL CEILING TO BE 9'-0" AFF UNLESS NOTED OTHERWISE.
- PROVIDED GYPSUM WALL BOARD & STUD BULKHEADS WHERE CEILING OF DIFFERENT HEIGHTS ADJUT. DO NOT BUILD BULKHEADS OF ACOUSTICAL CEILING MATERIAL UNLESS SPECIFICALLY DETAILED.
- REFER TO MECHANICAL DRAWINGS FOR QUANTITY AND TYPE OF DIFFUSERS, RETURN AIR GRILLES, & EXHAUST GRILLES. SCRIBE CEILING MATERIAL CAREFULLY FOR A TIGHT FIT.
- REFER TO ELECTRICAL DRAWINGS FOR QUANTITY AND TYPES OF LIGHTS AND DEVICES. SCRIBE CEILING MATERIAL CAREFULLY FOR TIGHT FIT.
- REFER TO FIRE PROTECTION DRAWINGS FOR FIRE SPRINKLER HEAD LOCATIONS. CENTER HEADS IN CEILING TILE AND SCRIBE CEILING MATERIALS FOR A TIGHT FIT.
- REFER TO ROOM FINISH SCHEDULE ON SHEET IN601 FOR CEILING FINISH INFORMATION.
- VERIFY CEILING HEIGHTS WITH STRUCTURE, MECHANICAL, PLUMBING, FIRE PROTECTION, ELECTRICAL AND CONTRACTOR'S REQUIRED COORDINATION DRAWINGS.
- ALL GWS SOFFITS, CEILINGS & BULKHEADS RECEIVE PAINT OR IF ALIGNING W/ ADJACENT WALL, PAINT P-2 UNO AT VERTICAL. PAINT AT UNDERSIDE.

ARCHITECTURAL SYMBOL LEGEND

- PROPOSED EXTERIOR WALL. SEE WALL SECTIONS
- INTERIOR STUD FRAMED WALL. SEE WALL TYPES
- AREA OF NO WORK, FACILITY TO REMAIN OPERATIONAL
- 1 HR FIRE RATED PARTITION
- 2 HR FIRE RATED PARTITION
- SMOKE RATED PARTITION / SMOKE BARRIER / COMPARTMENT
- 1 HR FIRE AND SMOKE BARRIER
- 2 HR FIRE AND SMOKE BARRIER
- VAVA ITEM - VA SUPPLIED & INSTALLED
- VA/CC OR VC ITEM - VA SUPPLIED & CONTRACTOR INSTALLED
- CC/CC ITEM - CONTRACTOR SUPPLIED & INSTALLED
- FURNITURE, FIXTURE, & EQUIPMENT INDICATOR
- DOWNSPOUT
- A1000 DS
- MATCHLINE
- DEDUCTIVE ALTERNATE
- EXPANSION JOINT

REFLECTED CEILING SYMBOLS

- ROOF SOFFIT
- (AT-1) ACOUSTICAL TILE CEILING (24x24)
- GYPSUM BOARD CEILING (PAINT: P-2 UNO)
- RECESSED LUMINAIRE (24x24)
- RECESSED LUMINAIRE (24x48)
- SHADING INDICATES EMERGENCY LIGHT
- RECESSED OR SURFACE MOUNTED ROUND DOWNLIGHT LUMINAIRE-CENTER IN CEILING TILE UNO. SHADING INDICATES EMERGENCY LIGHT
- PENDANT-MOUNTED LUMINAIRE- SHADING INDICATES EMERGENCY LIGHT
- WALL PACK
- LINEAR UPLIGHT LUMINAIRE- WALL MOUNTED OR SUSPENDED
- LINEAR SUSPENDED LUMINAIRE SHADING INDICATED EMERGENCY LIGHT
- CEILING FAN WITH LIGHT KIT
- ACCESS PANEL
- (AT-2) SUSPENDED ACOUSTICAL BLADES SIDEWALL REGISTER OR GRILLE
- SMOKE DETECTOR
- HEAT DETECTOR
- SPEAKER
- OCCUPANCY SENSOR
- EXIT LIGHT
- HVAC SUPPLY DIFFUSER
- HVAC RETURN DIFFUSER
- HVAC EXHAUST DIFFUSER
- SPRINKLER
- CEILING MOUNTED PATIENT LIFT
- DUCT ALT. 14 CHANDELER
- WALL MOUNTED SCONCE
- WALL WASHER

KEYNOTES

- DRYWALL CEILING - PART OF UL ASSEMBLY P526. SEE SHEET A-723
- OPEN TO EXTERIOR
- ROOF ACCESS LADDER AND HATCH
- EXTERIOR ROOF SOFFITS, SEE WALL ELEVATIONS FOR MORE INFORMATION
- PROVIDE LIGHTING TO MEET MINIMUM EGRESS REQUIREMENT IN AREAS OF CATWALK
- WALL PACK; REFER TO ELECTRICAL FOR MORE INFORMATION
- EXPANSION JOINT
- LINEAR UPLIGHT; REFER TO ELECTRICAL FOR MORE INFORMATION

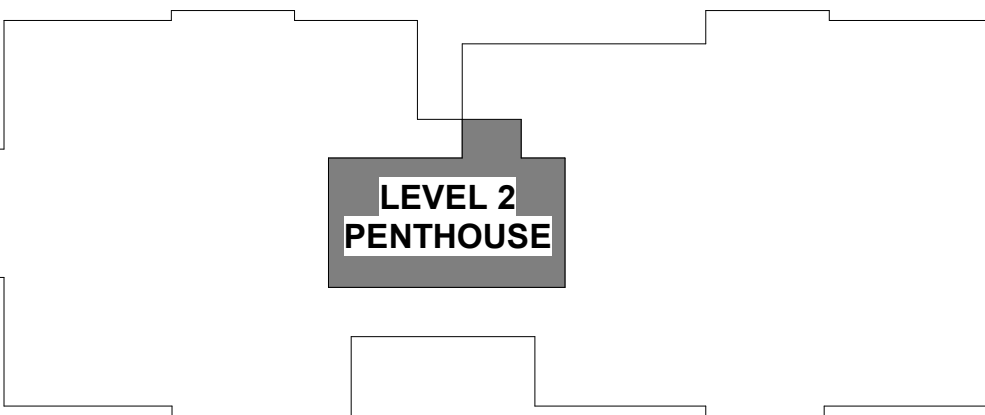

KEY PLAN

F2

ARCHITECTURAL OVERALL CEILING PLAN - MECHANICAL PENTHOUSE

3/32" = 1'-0"

DEDUCTIVE ALTERNATES:

(DEDUCTIVE ALTERNATES ARE CASCAADING AND MUST BE EXERCISED IN THE ORDER PRESENTED) FOR A DETAILED DESCRIPTION OF EACH DEDUCTIVE ALTERNATE REFER TO COVER SHEET G000

- DEDUCTIVE ALTERNATE #1: REDUCE WATER AND ICE SHIELD COVERAGE
- DEDUCTIVE ALTERNATE #2: ELIMINATE TUNNEL (EAST LEG)
- DEDUCTIVE ALTERNATE #3: ELIMINATE FAUX WINDOWS AT CLEARSTORY
- DEDUCTIVE ALTERNATE #4: ELIMINATE WORK AT R6 CORRIDOR
- DEDUCTIVE ALTERNATE #5: ELIMINATE CONCRETE
- DEDUCTIVE ALTERNATE #6: ELIMINATE LANDSCAPE
- DEDUCTIVE ALTERNATE #7: REDUCE PLATFORM AT CHILLER
- DEDUCTIVE ALTERNATE #8: ELIMINATE NVR SECURITY
- DEDUCTIVE ALTERNATE #9: ELIMINATE LARGE PORCH
- DEDUCTIVE ALTERNATE #10: ELIMINATE SMALL PORCH A
- DEDUCTIVE ALTERNATE #11: ELIMINATE SMALL PORCH B
- DEDUCTIVE ALTERNATE #12: ELIMINATE ENTRANCE CANOPY
- DEDUCTIVE ALTERNATE #13: ELIMINATE FENCE/FAUX ROOFS AT RESIDENT ROOMS
- DEDUCTIVE ALTERNATE #14: ELIMINATE PATIENT LIFT'S TRACK EXTENSIONS INTO RESIDENT RESTROOMS
- DEDUCTIVE ALTERNATE #15: REDUCE THE POROUS ASPHALT / PARKING / PORTION OF DRIVE ENTRANCE
- DEDUCTIVE ALTERNATE #16: ELIMINATE EXTERIOR SIGNAGE

CONSULTANT

NORRIS DESIGN
Landscape Architect
416 North Toole Avenue
Tucson, AZ 85701
(520) 622-9565
Josh Orth, PLA

HINMAN
Protective Design Specialist
240 West 35th St, Suite 1004
New York, NY 10001
(212) 967-4890
Corrine Tan, SE

C.S. Davidson, Inc.
Structural
315 West James Street, Suite 102
Lancaster, PA 17603
(717) 481-2991
Jason Vannoy, SE, PE

MES GROUP
MEP
550 North Rex Street, Suite 203
Tampa, FL 33609
(813) 289-4700
Nicholas Stephenson, PE

ARCHITECT/ENGINEER OF RECORD

A/E:
TRIPLE C - The A/E Group
201 E. Jefferson Street, Suite 200
Syracuse, NY 13202
(315) 484-5958
Mat Perkins

TRIPLE C - THE A&E GROUP
A MULTI-DISCIPLINE COMPANY

STAMP



Office of
Construction
and Facilities
Management

VA U.S. Department
of Veterans Affairs

Drawing Title

ARCHITECTURAL OVERALL CEILING PLAN -
PENTHOUSE

Approved:

Phase

ISSUED FOR
CONSTRUCTION

FULLY SPRINKLERED

Project Title

NEW COMMUNITY LIVING
CENTER

Location

2094 Albany Post Road, Montrose, NY 10548

Issue Date

05/09/2022

Checked

H. GARDINER

Drawn

K. MCDERMOTT

Project Number

620-334

Building Number

CLC

Drawing Number

AC102