

PLUMBING FIXTURE SCHEDULE											
ID	FIXTURE	ADA	MANUFACTURER	MODEL	DESCRIPTION	MOUNTING	REMARKS	PLUMBING FIXTURE ROUGH-IN			
								CW	HW	WASTE	VENT
P1	WALL MOUNTED TOILET	YES	SLOAN	ST-2459	WHITE VITREOUS CHINA, ELONGATED BOWL, WALL MOUNTED, WALL OUTLET, SIPHON JET FLUSHING ACTION ACHIEVES 1000g MAP SCORE WHEN USED WITH ANY SLOAN FLUSHOMETER , 1 1/2" I.P.S. TOP SPUD INLET, STATIC LOAD RATING OF 750 LBS. WATER SPOT AREA 10 1/8" X 9 3/8" (26 CM X24 CM).	WALL MOUNT	1.28 GPF, FLUSHOMETER TOILET, FOR ADA SEAT HEIGHT SET AT 17" TO 19" FROM FINISHED FLOOR	-	-	4"	2"
P1a	SOLAR POWERED DUAL FLUSH	-	SLOAN	8111-1.6/1.1	EXPOSED, SOLAR POWERED, SENSOR ACTIVATED SLOAN SOLIS DUAL FLUSH MODEL WATER CLOSET FLUSHOMETER FOR WALL HUNG TOP SPUD BOWLS. FULL FLUSH (LARGE BUTTON) 1.6 GPF/6.0 LPF. REDUCED FLUSH (SMALL BUTTON) 1.1 GPF/4.2 LPF.	-	-	1"	-	-	-
P2	URINAL/FLUSH VALVE COMBO	YES	SLOAN	WESU-7000.1201	WHITE VITREOUS CHINA, WASH-DOWN FLUSHING ACTION, INTEGRAL FLUSHING RIM, 3/4" I.P.S. TOP SPUD INLET, 2" NPT OUTLET FLANGE , VANDAL RESISTANT STRAINER ASSEMBLY INCLUDED, 100% FACTORY FLUSH TESTED , FLUSH VOLUME 0.125 GPF, SU-7009 URINAL AND SOLIS 8186 FLUSHOMETER COMBO.	WALL MOUNT	0.125 GPF EXPOSED SENSOR URINAL FLUSHOMETER	3/4"	-	2"	1-1/2"
P3a	WALL MOUNTED SINK	YES	DURAVIT	VERO	SINK DIMENSION 23 5/8" X 18 1/4" X 5 3/8" , WHITE VITREOUS CHINA WITH OVER FLOW, ORDER NO 045460.27	WALL MOUNT	-	-	-	2"	1-1/2"
P3b	WALL MOUNTED SINK	YES	DURAVIT	VERO	SINK DIMENSION 31 1/2" X 18 1/4" X 5 3/8" , WHITE VITREOUS CHINA WITH OVER FLOW, ORDER NO 045480.25	WALL MOUNT	-	-	-	2"	1-1/2"
P4	WALL MOUNTED SINK FAUCET	-	SLOAN	OPTIMA SOLIS EAF-275-ISM	SOLAR POWERED, SENSOR ACTIVATED , ELECTRONIC , CHROME PLATED CONSTRUCTED METAL , HAND WASHING FAUCET , MAGNETIC SOLENIID VALVE, AUTOMATIC SELF ADAPTING SENSOR TECHNOLOGY, 6 VDC LITHIUM BATTERY BACK-UP POWER.	-	0.5 GPM FLOW RATE, PROVIDE ASSE #1070 THERMOSTIC MIXING VALVE	1/2"	1/2"	-	-
P5b	VANITY SINK	YES	SOPHSTONE	SOPH-ST70	SINK DIMENSION 70" X 23 5/8" X 4-3/4" ADA COMPLIANT, SOPSSTONE COMPOSITE STONE WITH HONED FINISH, METICULOUSLY HAND CRAFTED, SMOOTH, EASY TO CLEAN SURFACE WITH STAIN RESISTANT QUALITIES. ECO- SENSITIVE WITH HIGH RECYCLED MATERIAL CONTEN	WALL MOUNT	FOR SOPHSTONE VANITY COLORS REFER TO ARCHITECTURAL DRAWINGS	-	-	2"	1-1/2"
P5c	VANITY SINK	YES	SOPHSTONE	SOPH-ST94	SINK DIMENSION 94" X 23 5/8" X 4-3/4" ADA COMPLIANT, SOPSSTONE COMPOSITE STONE WITH HONED FINISH, METICULOUSLY HAND CRAFTED, SMOOTH, EASY TO CLEAN SURFACE WITH STAIN RESISTANT QUALITIES. ECO- SENSITIVE WITH HIGH RECYCLED MATERIAL CONTEN	WALL MOUNT	FOR SOPHSTONE VANITY COLORS REFER TO ARCHITECTURAL DRAWINGS	-	-	2"	1-1/2"
P5d	VANITY SINK	YES	SOPHSTONE	SOPH-ST144	SINK DIMENSION 114" X 23 5/8" X 4-3/4" ADA COMPLIANT, SOPSSTONE COMPOSITE STONE WITH HONED FINISH, METICULOUSLY HAND CRAFTED, SMOOTH, EASY TO CLEAN SURFACE WITH STAIN RESISTANT QUALITIES. ECO- SENSITIVE WITH HIGH RECYCLED MATERIAL CONTEN	WALL MOUNT	FOR SOPHSTONE VANITY COLORS REFER TO ARCHITECTURAL DRAWINGS	-	-	2"	1-1/2"
P6	MOP SINK	-	ADVANCE TABCO	9-OP-20	16 GAUGE TYPE 304 SERIES STAINLESS STEEL SINK BOWL WITH FLOOR MOUNTED, SINK DIMENSION 21" X 25" X 10". FREE FLOW DRAIN.	FLOOR MOUNT	-	-	-	3'	2"
P7	MOP SINK WALL MOUNTED FAUCET	-	ADVANCE TABCO	K-240	BRASS CHROME PLATED BODY AND SPOUT, CHROME PLATED HANDLES, 8" O.C WATER SUPPLY , QUARTER TURN WEDGE STYLE HANDLES WITH COLORED HOT AND COLD INDEXES, VACUUM BREAKER, BUILT-IN STOPS.	-	-	3/4"	3/4"	-	-
P8	DRINKING FOUNTAIN	YES	ELKAY	LZS8WSLP	ELKAY ENHANCED EZH20 BOTTLE FILLING STATION & SINGLE ADA COOLER, FILTERED 8 GPH FINISH WITH LIGHT GREY GRANITE. 115V/60HZ , FULL LOAD 5 AMPS WITH CHILLING CAPACITY OF 8.0 GPH (GALLONS PER HOUR) OF 50° F DRINKING WATER, HANDS FREE, AUTOMATIC FILTER STATUS RESET, ENERGY SAVINGS, GREEN TICKER, LAMINAR FLOW, ANTIMICROBIAL, REAL DRAIN	WALL MOUNT	-	1/2"	-	2"	1-1/2"
3" FD	FLOOR DRAIN	-	PROSET	T35630-F-P	THE TRAP GUARD DEVICE IS AN INTERGRAL PART OF THE PROSET FLOOR DRAIN AND COMES AS A COMPLETE UNIT. THE DRAIN COMES WITH A PROTECTIVE PLASTIC STRAINER COVER AND A HEAVY PLUG UNDERNEATH THE STRAINER TOP.	FLOOR MOUNT	-	-	-	3'	2"
NOTE: *REFER TO ARCHITECTURAL PLANS FOR EXACT FIXTURE LOCATIONS, QUANTITIES AND ADA REQUIREMENTS. *PLUMBING FIXTURE SCHEDULE INDICATING THE SPECIFIED PRODUCT ARE BASIS OF DESIGN.											

## RESTROOM RENOVATION PURCHASE COLLEGE

STATE UNIVERSITY OF NEW YORK

735 Anderson Hill Rd.  
Purchase, NY 10577

### PHASE 2:

MUSIC BUILDING  
DANCE BUILDING  
PHYS. ED. BUILDING  
LIBRARY

#### Conditions

ALL IDEAS, DESIGNS, ARRANGEMENTS AND PLANS INDICATED OR REPRESENTED BY THIS DRAWING ARE OWNED BY, AND THE PROPERTY OF RONNETTE RILEY ARCHITECT AND WERE CREATED, DEVELOPED AND DEVELOPED FOR THE USE OF, AND IN CONNECTION WITH THE NONE OF SUCH IDEAS, DESIGNS, ARRANGEMENTS OR PLANS SHALL BE USED BY OR DISCLOSED TO ANY PERSON, FIRM OR CORPORATION FOR ANY PURPOSE WHATSOEVER WITHOUT THE WRITTEN PERMISSION OF RONNETTE RILEY ARCHITECT.

© Copyright Ronnette Riley Architect 2020

Ronnette Riley *Architect*



494 Eighth Avenue, 15th Floor  
New York, NY 10001  
T 212 594 4015  
F 212 594 2868  
www.ronnetteriley.com

MEP Engineer

SETTY & Associates, Ltd  
149 W 36th Street, 8th floor  
New York, NY 10018  
T 646 253 9000  
F 646 224 8497

Rev Date Issue  
05 May 2022 Issue for Bid

## Title PLUMBING SCHEDULES AND DETAILS

Date 01-16-2020  
Project No. 1944  
Drawing By CHS  
CHK By KB  
Scale AS NOTED

DOB Rev

P-601.00

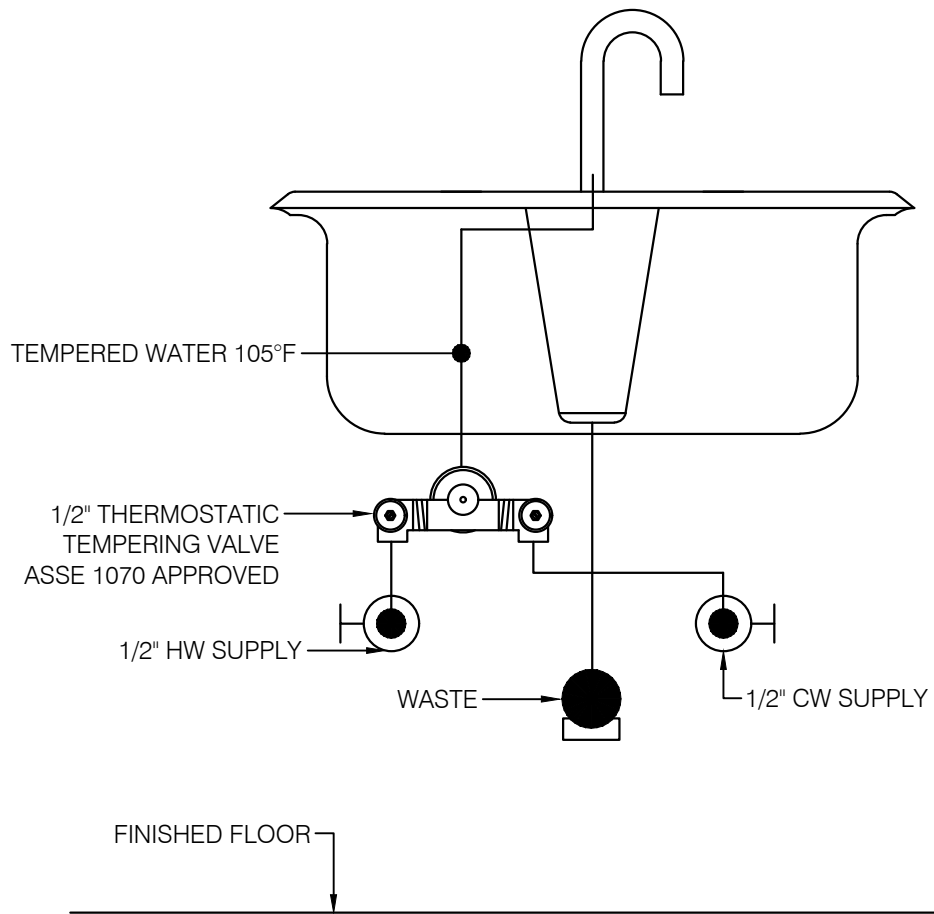

4 POINT OF USE MIXING VALVE DETAIL

SCALE: NOT TO SCALE

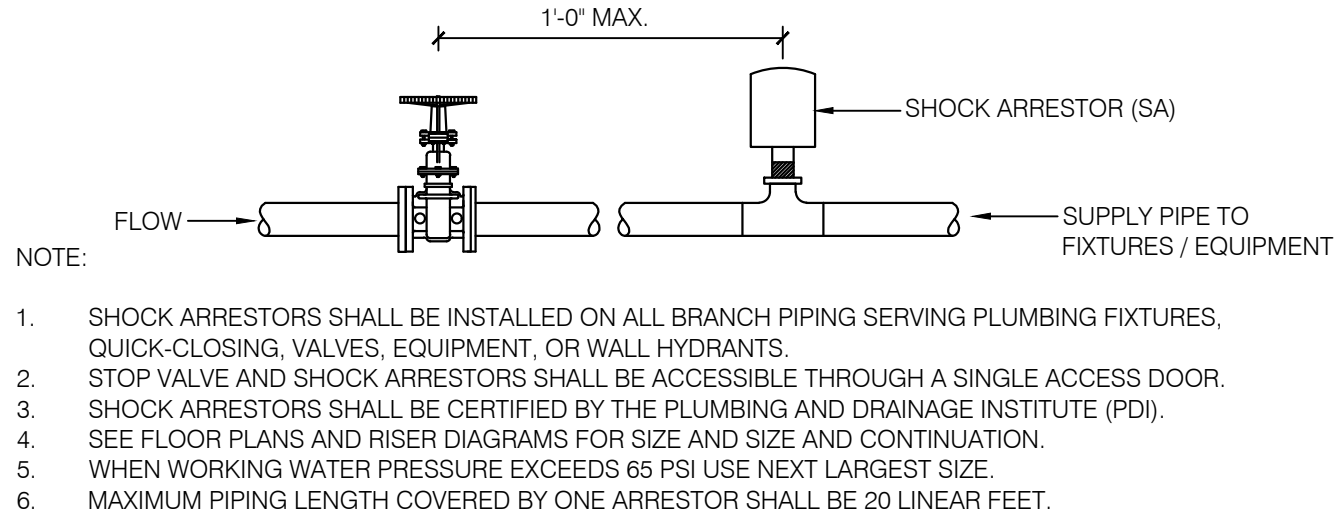

3 SHOCK ARRESTOR DETAIL

SCALE: NOT TO SCALE

WATER HAMMER ARRESTOR SIZE SCHEDULE			
SIZE OF PIPE	FIXTURE UNITS	HAMMER ARRESTOR SIZE (PDI REFERENCE)	
1/2"	1-11	A	
3/4"	12-32	B	
1"	33-60	C	
1 1/4"	61-113	D	
1 1/2"	114-154	E	
2"	155-330	F	

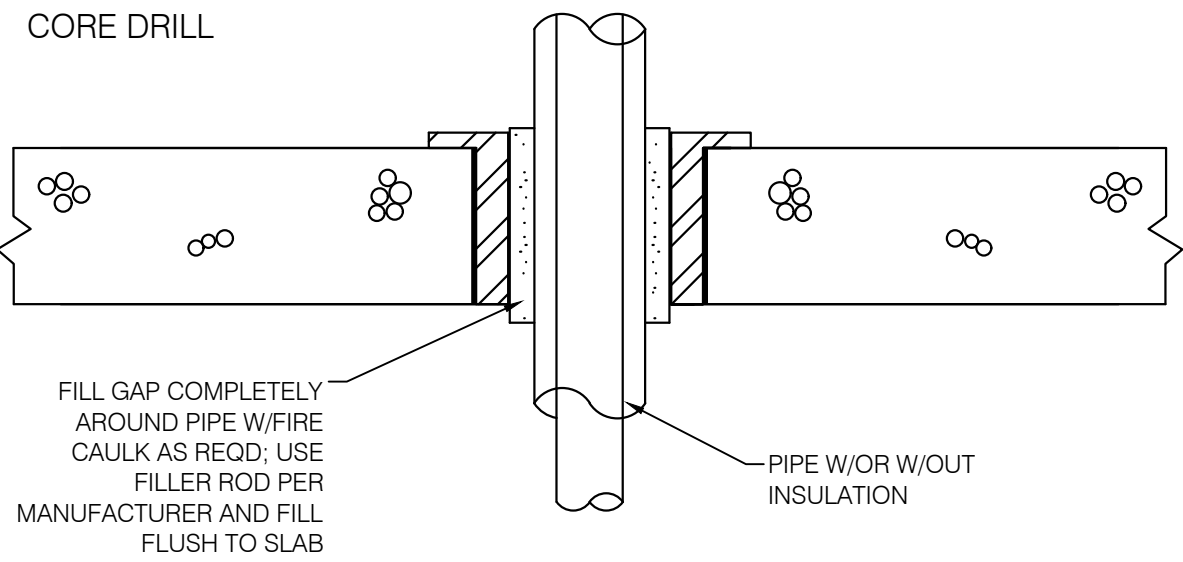

NOTE: ALL PIPING SLEEVES WILL BE SCHEDULE 40 STEEL PIPE

2 PIPE PENETRATION THROUGH CONCRETE

SCALE: NOT TO SCALE

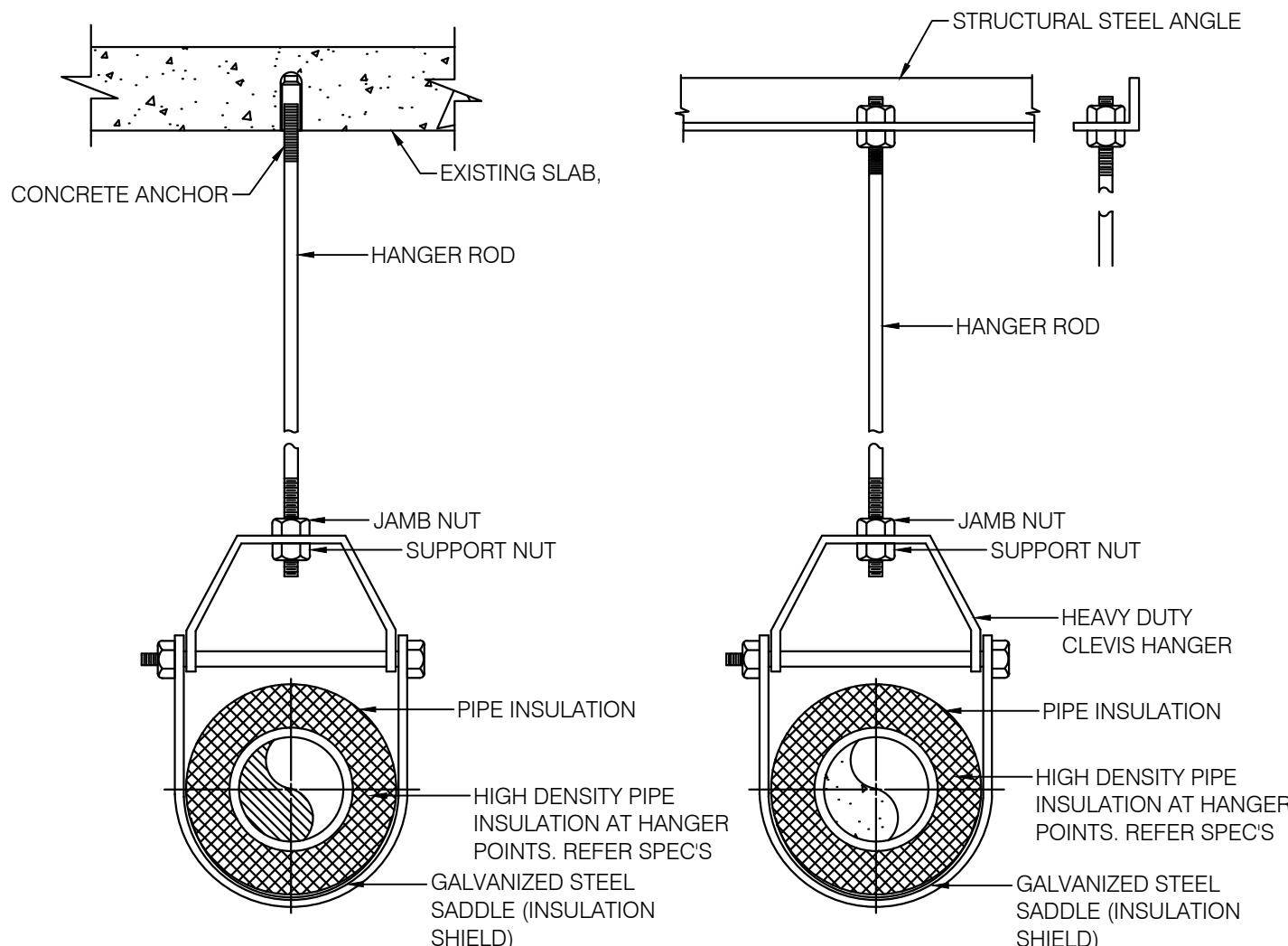

1 PIPE SUPPORT DETAIL

SCALE: NOT TO SCALE

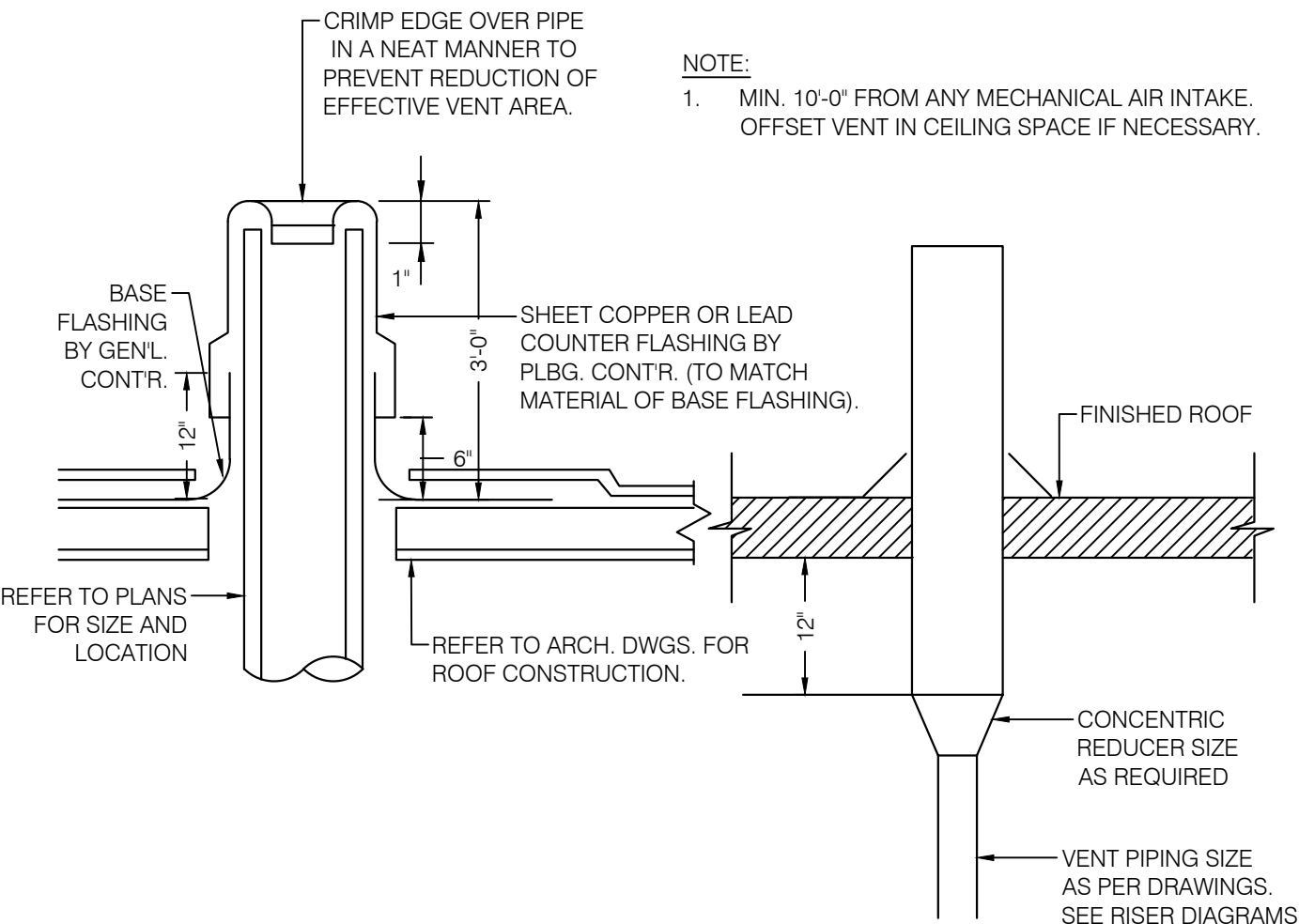

8 PLUMBING VENT THROUGH ROOF DETAIL

SCALE: NOT TO SCALE

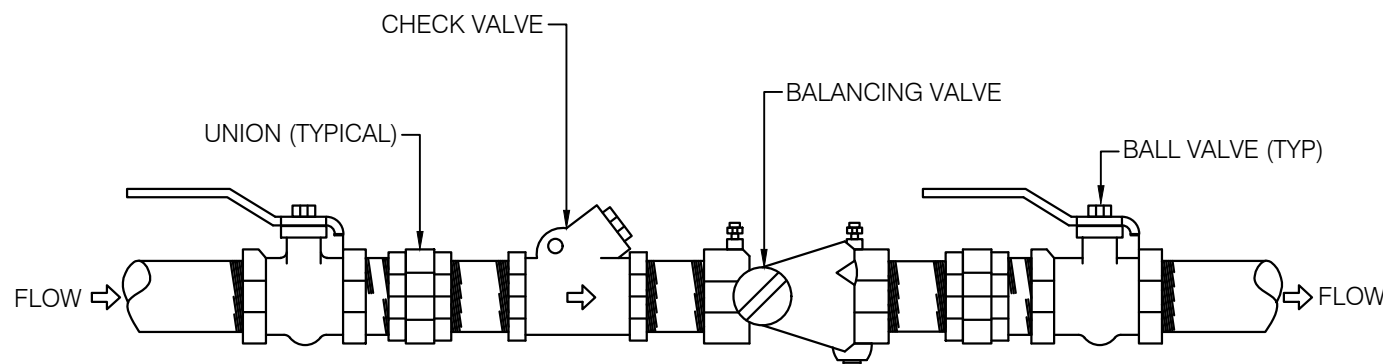

7 DOMESTIC HOT WATER RETURN BALANCING ASSEMBLY

SCALE: NOT TO SCALE

- NOTES:
- ALL THREADED PIPING BETWEEN UNIONS SHALL BE BRASS.
  - INSTALL DIE-ELECTRIC UNIONS FOR PIPING CONNECTIONS OF DISSIMILAR METALS.
  - CONTRACTOR SHALL BALANCE THE HWR SYSTEM TO ACHIEVE SUFFICIENT FLOW THROUGH THE SYSTEM TO MAINTAIN DESIRED TEMPERATURE OF 120° F AT REMOTE FIXTURE.

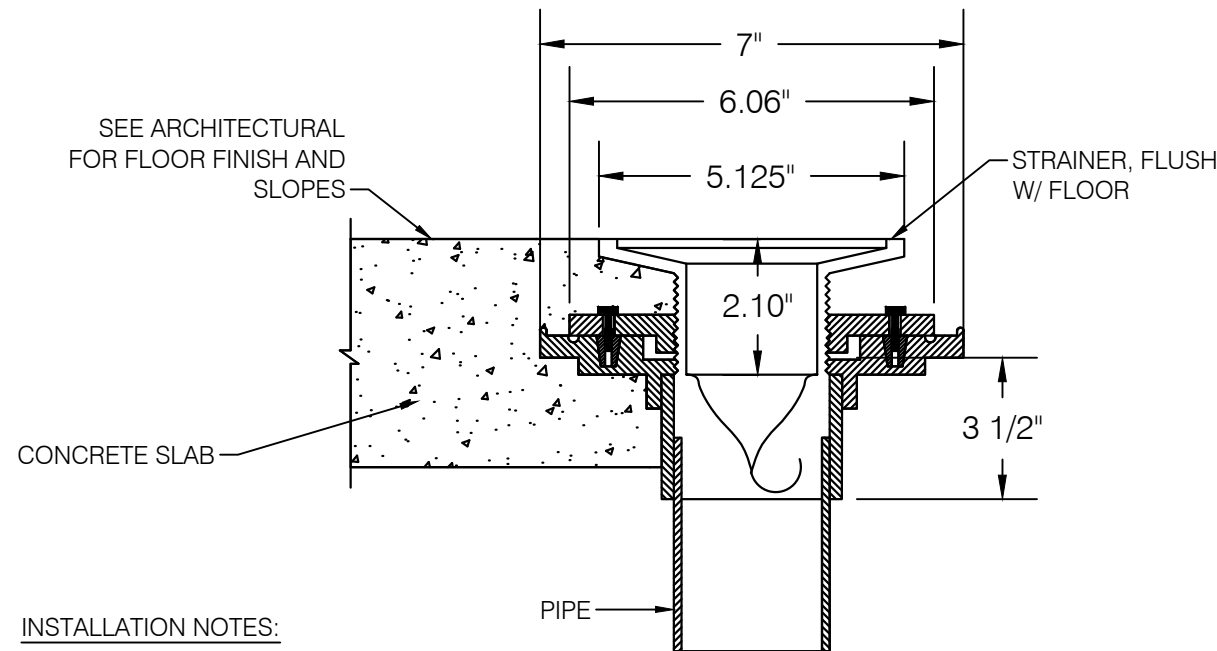

#### INSTALLATION NOTES:

- THE TRAP GUARD DEVICE IS AN INTEGRAL PART OF THE PRESET FLOOR DRAIN AND COMES AS A COMPLETE UNIT.
- THE INSTALLATION IS IDENTICAL TO ANY TYPICAL FLOOR DRAIN ASSEMBLY CONNECTING TO PLASTIC OR C.L. PIPE.
- THE DRAIN COMES WITH A PROTECTIVE PLASTIC STRAINER COVER AND A HEAVY PLUG UNDERNEATH THE STRAINER TOP.
- AFTER THE CONCRETE POUR, THE PLASTIC STRAINER COVER SHOULD BE REMOVED. A FACTORY INSTALLED ELASTOMERIC PLUG PROTECTS THE TRAP GUARD DEVICE DURING CONSTRUCTION AND CAN BE USED AS A TEST PLUG AND MUST BE REMOVED BEFORE NORMAL DRAIN USAGE. IF THE TRAP GUARD DEVICE SHOULD GET DAMAGED OR IMPAIRED IN ANY WAY, THE DEVICE CAN BE EASILY REMOVED. A PULLER TOOL ATTACHES TO THE TWO BUILT-IN LUGS INSIDE OF THE TRAP GUARD FOR EASY REMOVAL & REPLACEMENT. NOT TO BE USED ON WAXED OR GREASE-LANDEN FLOORS.

NOTE: CARE SHOULD BE TAKEN NOT TO TOUCH THE FLEXIBLE MATERIAL WITH PRIMER OR SOLVENT CEMENT.

6 TRAP GUARD FLOOR DRAIN DETAIL

SCALE: NOT TO SCALE

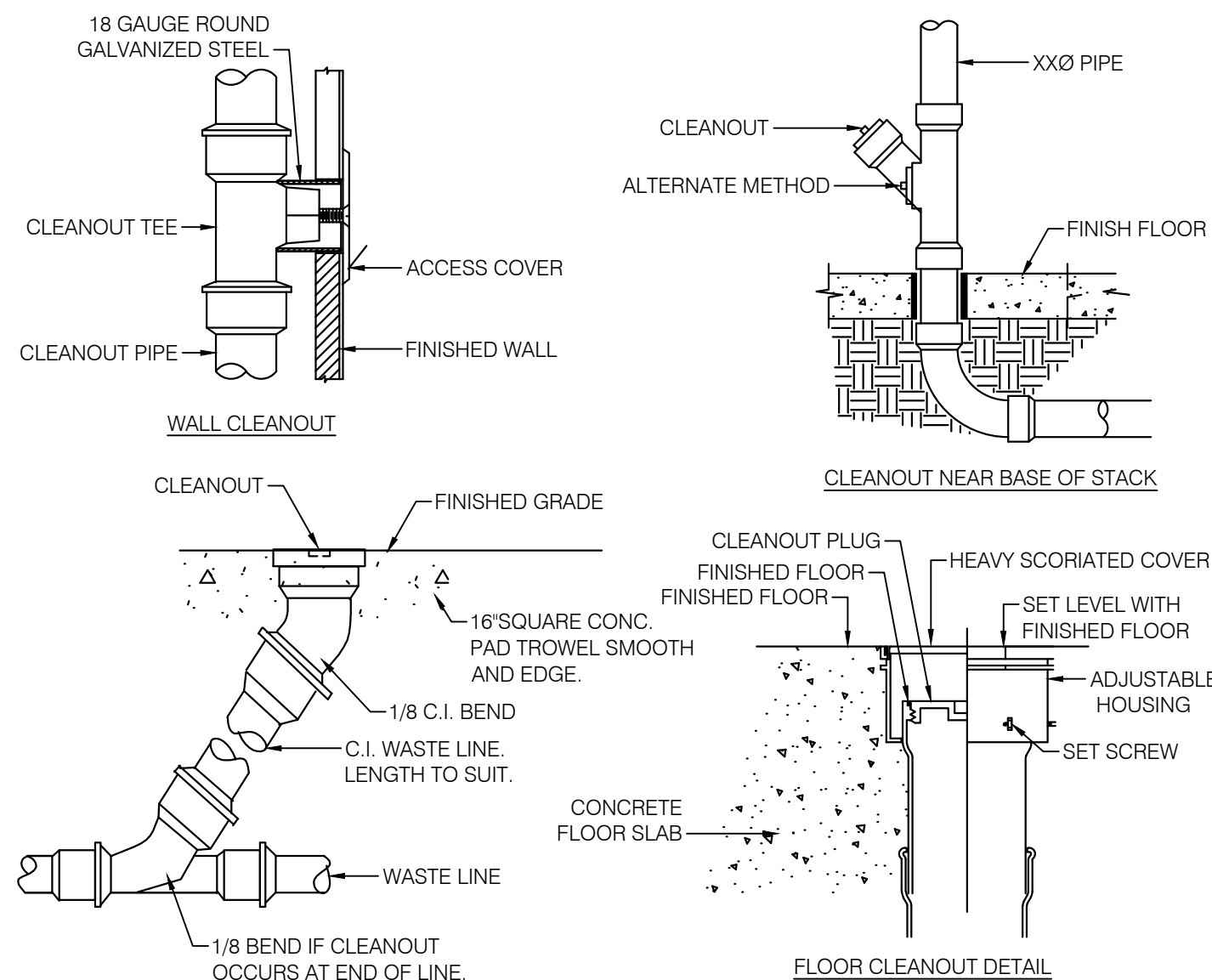

5 CLEANOUT DETAILS

SCALE: NOT TO SCALE