



2 PHOTO 11
D0.1A Not To Scale



3 FIRE ALARM EQUIPMENT
D0.1A Not To Scale



4 ENTRANCE TO MAIN LOBBY
D0.1A Not To Scale



5 PAY ON FOOT MACHINE
D0.1A Not To Scale

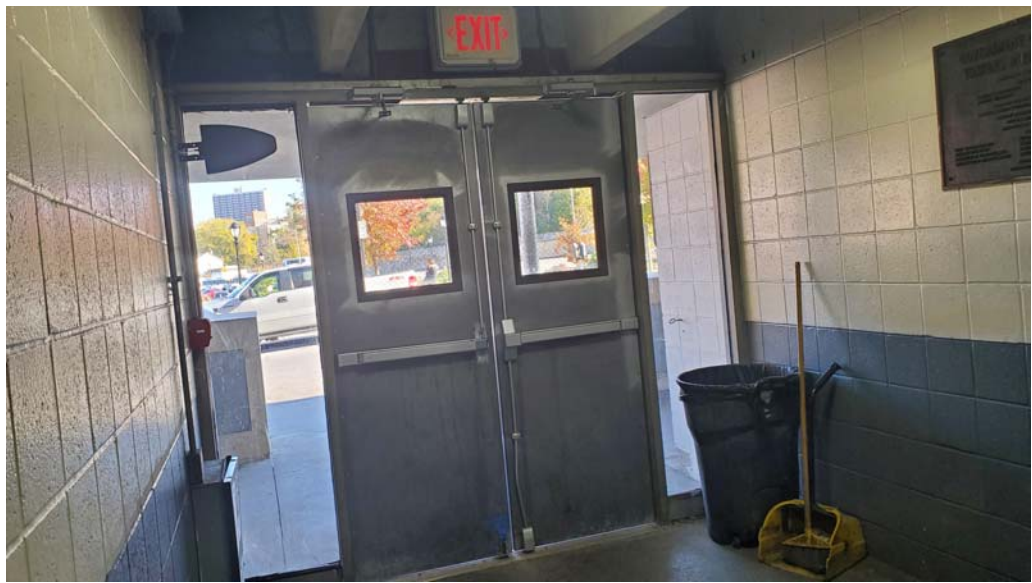

6 MAIN LOBBY ENTRANCE
D0.1A Not To Scale

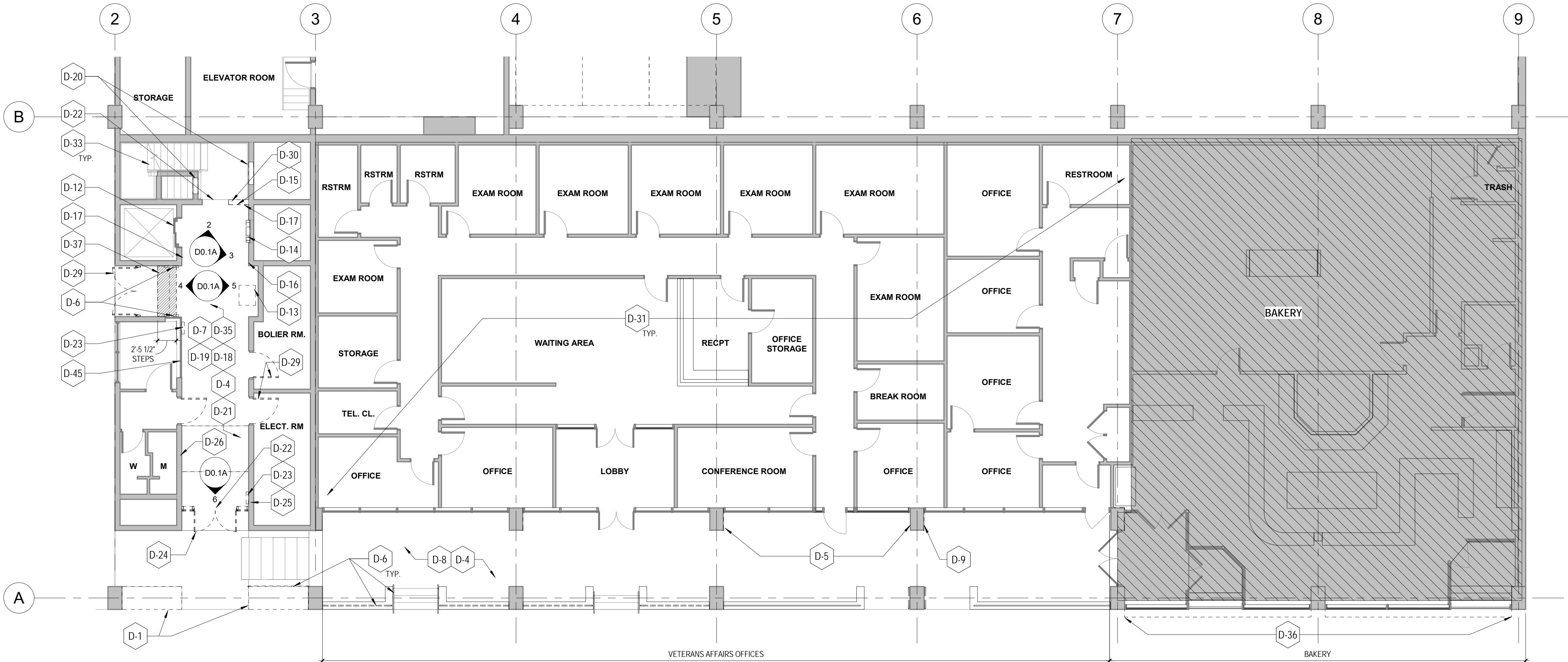

1 DM-GROUND TIER PARTIAL PLAN - LOBBY/VA OFFICES/BAKERY
D0.1A 1/8" = 1'-0"

DEMOLITION LEGEND	
	EXISTING WALL TO REMAIN
	EXISTING WALL OR ITEMS TO BE REMOVED.
	EXISTING DOOR TO REMAIN
	EXISTING DOOR, FRAME & HARDWARE TO BE REMOVED.
	EXISTING STRIPING TO BE REMOVED.
	DEMOLITION KEYNOTE TAG
	VIEW NUMBER (IMAGE INDICATOR)
	SHEET NUMBER
	NOT IN CONTRACT

KEYNOTE DEMOLITION LEGEND		KEYNOTE DEMOLITION LEGEND	
D-1	DEMO KNEE WALL AT PEDESTRIAN ENTRANCE.	D-1	DEMO KNEE WALL AT PEDESTRIAN ENTRANCE.
D-4	PREPARE CORRIDOR CONCRETE FLOOR SURFACE TO RECEIVE NEW EPOXY FLOORING.	D-4	PREPARE CORRIDOR CONCRETE FLOOR SURFACE TO RECEIVE NEW EPOXY FLOORING.
D-5	REMOVE ALL INSULATED METAL PANEL CLADDING, PATCH AND REPAIR SUB-SURFACE AS REQUIRED TO RECEIVE NEW CLADDING. REMOVE AND STORE EXISTING SIGANGE FOR RE-INSTALLATION IN THE SAME LOCATION. COORDINATE ALL SECURITY AND ELECTRICAL DEVICES, JUNCTION BOXES, ETC. TO REMAIN WITH NEW CONSTRUCTION.	D-5	REMOVE ALL INSULATED METAL PANEL CLADDING, PATCH AND REPAIR SUB-SURFACE AS REQUIRED TO RECEIVE NEW CLADDING. REMOVE AND STORE EXISTING SIGANGE FOR RE-INSTALLATION IN THE SAME LOCATION. COORDINATE ALL SECURITY AND ELECTRICAL DEVICES, JUNCTION BOXES, ETC. TO REMAIN WITH NEW CONSTRUCTION.
D-6	REMOVE EXSTING PIPE GUARDRAIL IN ITS ENTIRETY, PATCH AND REPAIR AS REQUIRED TO RECEIVE NEW PIPE GUARDRAIL.	D-6	REMOVE EXSTING PIPE GUARDRAIL IN ITS ENTIRETY, PATCH AND REPAIR AS REQUIRED TO RECEIVE NEW PIPE GUARDRAIL.
D-7	REMOVE EXISTING CEILING LIGHTS IN ITS ENTIRETY, PATCH AND REPAIR CEILING STRUCTURE AS REQUIRED.	D-7	REMOVE EXISTING CEILING LIGHTS IN ITS ENTIRETY, PATCH AND REPAIR CEILING STRUCTURE AS REQUIRED.
D-8	REMOVE EXISTING EXTERIOR CEILING SYSTEM AND LIGHTING INCLUDING BUT NOT LIMITED TO SUPPORT SYSTEM UP TO THE EXISTING BLACK IRON. EXISTING BLACK IRON, HANGERS, ANCHORS, ETC. WITH GOOD STRUCTURAL INTEGRITY ARE TO REMAIN AND TO BE COORDINATED WITH NEW CONSTRUCTION.	D-8	REMOVE EXISTING EXTERIOR CEILING SYSTEM AND LIGHTING INCLUDING BUT NOT LIMITED TO SUPPORT SYSTEM UP TO THE EXISTING BLACK IRON. EXISTING BLACK IRON, HANGERS, ANCHORS, ETC. WITH GOOD STRUCTURAL INTEGRITY ARE TO REMAIN AND TO BE COORDINATED WITH NEW CONSTRUCTION.
D-9	REMOVE EXISTING TILE CLADDING AT BASE. PATCH AND REPAIR FOR NEW CONSTRUCTION.	D-9	REMOVE EXISTING TILE CLADDING AT BASE. PATCH AND REPAIR FOR NEW CONSTRUCTION.
D-12	REFER TO ELEVATOR MODERNIZATION SPECIFICATION FOR DEMOLITION AND REPLACEMENT OF ELEVATOR COMPONENTS.	D-12	REFER TO ELEVATOR MODERNIZATION SPECIFICATION FOR DEMOLITION AND REPLACEMENT OF ELEVATOR COMPONENTS.
D-13	RELOCATE EXISTING PAY STATION. REFER TO NEW CONSTRUCTION AND ELECTRICAL PLANS.	D-13	RELOCATE EXISTING PAY STATION. REFER TO NEW CONSTRUCTION AND ELECTRICAL PLANS.
D-14	RELOCATE EXISTING FIRE PANELS. REFER TO NEW CONSTRUCTION AND ELECTRICAL PLANS.	D-14	RELOCATE EXISTING FIRE PANELS. REFER TO NEW CONSTRUCTION AND ELECTRICAL PLANS.
D-15	RELOCATE EXISTING FIRE STROBE. REFER TO NEW CONSTRUCTION AND ELECTRICAL PLANS.	D-15	RELOCATE EXISTING FIRE STROBE. REFER TO NEW CONSTRUCTION AND ELECTRICAL PLANS.
D-16	EXISTING WIRE AND CONDUIT TO BE TRACED, REMOVED AND REPLACE WITH NEW AS REQUIRED FOR NEW CONSTRUCTION. REFER TO ELECTRICAL DRAWINGS FOR FUTHTER INFORMATION.	D-16	EXISTING WIRE AND CONDUIT TO BE TRACED, REMOVED AND REPLACE WITH NEW AS REQUIRED FOR NEW CONSTRUCTION. REFER TO ELECTRICAL DRAWINGS FOR FUTHTER INFORMATION.
D-17	EXISTING SECURITY CAMERA TO BE SALVAGED/RELOCATED PER NEW CONSTRUCTION. IF CAMERA IS NO LONGER IN OPERATION, TURN THEM OVER TO THE CITY OF YONKERS ENGINEERING DEPARTMENT.	D-17	EXISTING SECURITY CAMERA TO BE SALVAGED/RELOCATED PER NEW CONSTRUCTION. IF CAMERA IS NO LONGER IN OPERATION, TURN THEM OVER TO THE CITY OF YONKERS ENGINEERING DEPARTMENT.
D-18	EXISTING LIGHTING TO BE SALVAGED/RELOCATED PER NEW CONSTRUCTION.	D-18	EXISTING LIGHTING TO BE SALVAGED/RELOCATED PER NEW CONSTRUCTION.
D-19	PATCH AND REPAIR HOLES IN MASONRY. PREP FOR NEW FINISH. REFER TO NEW CONSTRUCTION.	D-19	PATCH AND REPAIR HOLES IN MASONRY. PREP FOR NEW FINISH. REFER TO NEW CONSTRUCTION.
D-20	REMOVE AND REPLACE ACCESS PANEL WITH NEW. PRIME AND PAINT. REFER TO NEW CONSTRUCTION	D-20	REMOVE AND REPLACE ACCESS PANEL WITH NEW. PRIME AND PAINT. REFER TO NEW CONSTRUCTION
D-21	ALL EXISTING SIGNAGE TO BE REMOVED AND TURNED OVER TO THE COY ENGINEERING DEPARTMENT	D-21	ALL EXISTING SIGNAGE TO BE REMOVED AND TURNED OVER TO THE COY ENGINEERING DEPARTMENT
D-22	REMOVE AND REPLACE EXIT SIGN WITH NEW. REFER TO NEW CONSTRUCTION.	D-22	REMOVE AND REPLACE EXIT SIGN WITH NEW. REFER TO NEW CONSTRUCTION.
D-23	REMOVE/REPLACE EXISTING CABINET HEATER IN KIND.	D-23	REMOVE/REPLACE EXISTING CABINET HEATER IN KIND.
D-24	REMOVE EXISTING DOOR STOREFRONT SYSTEM FOR NEW. REFER TO NEW CONSTRUCTION. PATCH AND PREP FOR NEW SYSTEM, REFER TO NEW CONSUTRUCTION.	D-24	REMOVE EXISTING DOOR STOREFRONT SYSTEM FOR NEW. REFER TO NEW CONSTRUCTION. PATCH AND PREP FOR NEW SYSTEM, REFER TO NEW CONSUTRUCTION.
D-25	REMOVE AND REINSTALL EXISTING PULL STATION FOR NEW CONSTRUCTION.	D-25	REMOVE AND REINSTALL EXISTING PULL STATION FOR NEW CONSTRUCTION.
D-26	EXISTING WALL PLAQUE TO BE FULLY PROTECTED FROM DAMAGE DURING DEMO AND NEW CONSTRUCTION.	D-26	EXISTING WALL PLAQUE TO BE FULLY PROTECTED FROM DAMAGE DURING DEMO AND NEW CONSTRUCTION.
D-29	EXISTING HOLLOW METAL DOOR AND FRAME TO BE REMOVED FOR REPLACEMENT WITH NEW DOOR TO MATCH SIZE AND FUNCTION. PATCH AND PREP FOR NEW DOOR, REFER TO NEW CONSTRUCTION.	D-29	EXISTING HOLLOW METAL DOOR AND FRAME TO BE REMOVED FOR REPLACEMENT WITH NEW DOOR TO MATCH SIZE AND FUNCTION. PATCH AND PREP FOR NEW DOOR, REFER TO NEW CONSTRUCTION.
D-30	REMOVE PORTION OF MASONRY WALL FOR NEW OPENING. PREP AND REPAIR OPENING FOR NEW CONSTRUCTION. REFER TO STRUCTURAL DRAWINGS. CONTRACTOR TO V.I.F. EXISTING WALL MOUNTED ITEMS SUCH AS ELECTRICAL, LIGHTS, SIGNAGE, FIRE STROBS, ETC. AND COORDINATE RELOCATION WITH NEW CONSTRUCTION.	D-30	REMOVE PORTION OF MASONRY WALL FOR NEW OPENING. PREP AND REPAIR OPENING FOR NEW CONSTRUCTION. REFER TO STRUCTURAL DRAWINGS. CONTRACTOR TO V.I.F. EXISTING WALL MOUNTED ITEMS SUCH AS ELECTRICAL, LIGHTS, SIGNAGE, FIRE STROBS, ETC. AND COORDINATE RELOCATION WITH NEW CONSTRUCTION.
D-31	REMOVE EXISTING CEILING SYSTEM FOR REINSTALLATION. REPLACE EXISTING DAMAGED ACOUSTICAL CEILING TILES TO MATCH. TO BE COORDINATED WITH MECHANICAL SCOPE. REFER TO MECHANICAL DRAWINGS. REFER TO SHEET A0.1A FOR PHASING PLAN.	D-31	REMOVE EXISTING CEILING SYSTEM FOR REINSTALLATION. REPLACE EXISTING DAMAGED ACOUSTICAL CEILING TILES TO MATCH. TO BE COORDINATED WITH MECHANICAL SCOPE. REFER TO MECHANICAL DRAWINGS. REFER TO SHEET A0.1A FOR PHASING PLAN.
D-33	METAL PAN STAIRS TO BE SCRAPPED AND PREPPED FOR NEW FINISH. REFER TO STRUCTURE DRAWINGS FOR FUTHER INFORMATION.	D-33	METAL PAN STAIRS TO BE SCRAPPED AND PREPPED FOR NEW FINISH. REFER TO STRUCTURE DRAWINGS FOR FUTHER INFORMATION.
D-35	REMOVE ALL EXISTING SIGNS THROUGHOUT AND COORDINATE WITH NEW.	D-35	REMOVE ALL EXISTING SIGNS THROUGHOUT AND COORDINATE WITH NEW.
D-36	REMOVE EXISTING AWNING SYSTEM ABOVE FOR REINSTALLATION IN NEW CONSTRUCTION.	D-36	REMOVE EXISTING AWNING SYSTEM ABOVE FOR REINSTALLATION IN NEW CONSTRUCTION.
D-37	REMOVE CONCRETE STEPS AND PORTION OF CONCRETE PLATFORM DOWN TO THE EXISTING GROUND FLOOR. REFER TO THE PLANS.	D-37	REMOVE CONCRETE STEPS AND PORTION OF CONCRETE PLATFORM DOWN TO THE EXISTING GROUND FLOOR. REFER TO THE PLANS.
D-45	EXISTING SECURITY WINDOW TO REMAIN. GC TO PROTECT DURING CONSTRUCTION.	D-45	EXISTING SECURITY WINDOW TO REMAIN. GC TO PROTECT DURING CONSTRUCTION.

Yonkers GCG Restoration

PARKING GARAGE

118 New Main St,
Yonkers, NY 10701

SUBMISSIONS / REVISIONS

BID DOCUMENTS
04/11/2022

NO.	DESCRIPTION	DATE
1	ADDENDUM #2	9/21/22

DRAWN:	JC/VLJ
REVIEWED:	RP
DATE:	04/11/2022

NORTH
SHEET TITLE:

GROUND TIER ENTRY LOBBY
DEMO PLAN

SHEET NO.

DO.1A