

KEY MAP  
SCALE: 1" = 1,500'

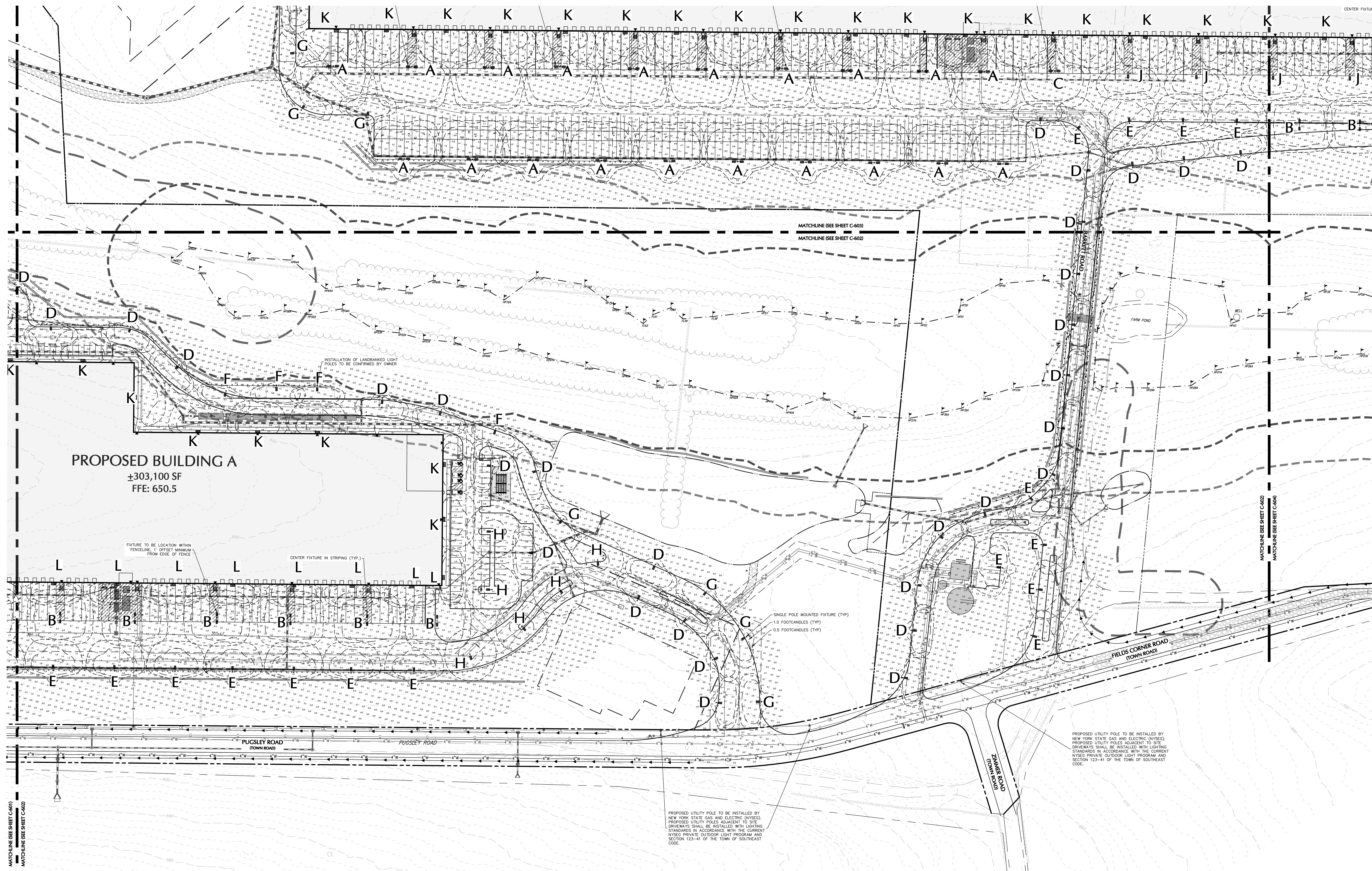

MATCHLINE (SEE SHEET C-601)  
MATCHLINE (SEE SHEET C-604)



03/06/2023	REVISED BUILDING B STORM ROOF LEADERS	8
02/10/2023	REV. NEW LOT LINE, SITE GRADING & STORM	7
12/30/2022	REV. BUILDING A UTILITIES	6
12/16/2022	REV. PER WATERSHED INSPECTOR GENERAL COMMENTS	5
Date	Description	No.
Revisions		

PROPOSED UTILITY POLE TO BE INSTALLED BY NEW YORK STATE GAS AND ELECTRIC (NYSEG). PROPOSED UTILITY POLES ADJACENT TO SITE DRIVEWAYS SHALL BE INSTALLED WITH LIGHTING STANDARDS IN ACCORDANCE WITH THE CURRENT NYSEG PRIVATE OUTDOOR LIGHT PROGRAM AND SECTION 123-41 OF THE TOWN OF SOUTHEAST CODE.



**LANGAN**  
Langan Engineering, Environmental, Surveying, Landscape Architecture, and Geology, D.P.C.  
One North Broadway, Suite 910  
White Plains, NY 10601  
T: 914.323.7400 F: 914.323.7401 www.langan.com

Project  
**LINCOLN LOGISTICS BREWSTER**  
TOWN OF SOUTHEAST  
PUTNAM COUNTY NEW YORK

Drawing Title  
**LIGHTING PLAN B**

Project No. <b>190065201</b>	Drawing No. <b>C-602</b>
Date <b>1/28/2022</b>	Sheet <b>63</b> of <b>96</b>
Drawn By <b>MJ</b>	
Checked By <b>MH</b>	