

# 1 GROUND FLOOR DEMOLITION RCP

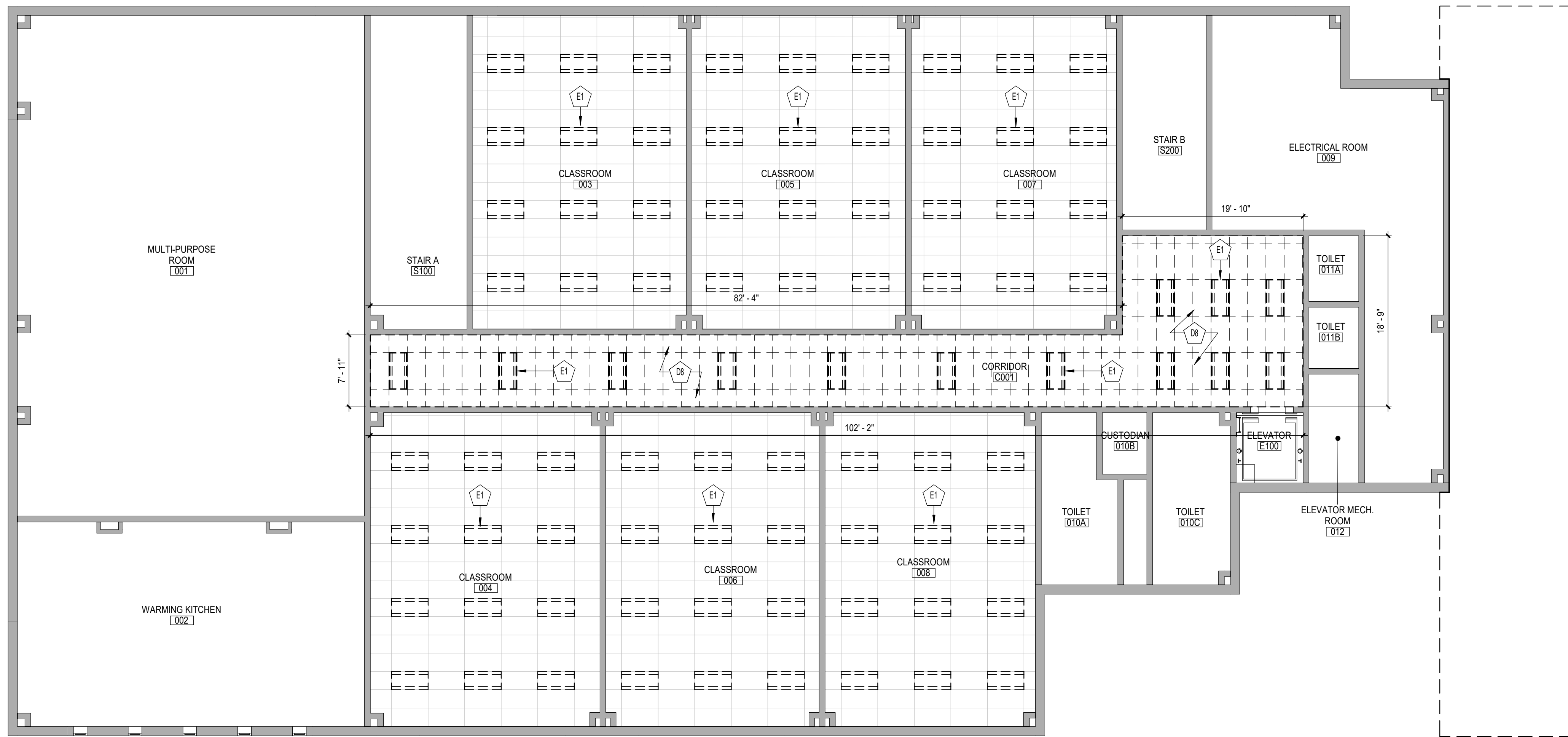

## GENERAL NOTES

1. COORDINATE ALL REMOVALS WITH NEW CONSTRUCTION
2. PATCH AND REPLACE EXISTING AND NEWLY CREATED HOLES IN WALLS (DUE TO REMOVAL) WITH MATERIALS TO MATCH EXISTING CONSTRUCTION.
3. SALVAGED ITEMS SHALL BE TURNED OVER TO OWNER, UNO
4. ALL KEY REMOVED STRUCTS SHALL INCLUDE REMOVAL OF ANY AND ALL ANCHORING SYSTEMS INCLUDING OBJECTS EMBEDDED INTO EXISTING WALLS.
5. REFER TO SECTOS AND MEP DRAWINGS FOR ADDITIONAL REMOVAL INFORMATION.
6. PROVIDE TEMPORARY SHORING AS NECESSARY AT ALL AREAS OF WALL REMOVAL AND NEW WALL PENETRATIONS.
7. DRILL CORNERS OF ALL NEW SAWCUT OPENING PRIOR TO SAWCUTTING, TO PREVENT CUTTING INTO SCHEDULED CONSTRUCTION TO REMAIN.

### CEILING LEGEND

- |  |  |
|--|--|
|  | <b>GWB OR PLASTER CEILING, REFER TO DETAILS AND ROOM FINISH SCHEDULE</b> |
|  | <b>SUSPENDED ACOUSTICAL PANEL CEILING SYSTEM</b>                         |
|  | <b>CEILING HEIGHT ABOVE FINISHED FLOOR</b>                               |
|  | <b>LIGHT FIXTURES</b>  |
|  | <b>COORDINATE REMOVALS WITH ELECTRICAL DEMOLITION DRAWINGS</b>           |
|  | <b>HVAC EQUIPMENT</b>  |
|  | <b>COORDINATE REMOVALS WITH MECHANICAL DEMOLITION DRAWINGS</b>           |

## KEY NOTES - DEMOLITION

X	DESCRIPTION
D8	REMOVE EXISTING ACT CEILING SYSTEM IN ITS ENTIRETY.
E1	LIGHT FIXTURE, TYPICAL. REFER TO ELECTRICAL DRAWINGS.

19 Front St. • Newburgh • New York 12550-7601  
845-561-3179 [www.csarchpc.com](http://www.csarchpc.com)

CSARCH

### Consultant

HIGHLAND CENTRAL SCHOOL DISTRICT  
HIGHLAND ELEMENTARY SCHOOL  
2022 CAPITAL IMPROVEMENT PROJECT - PHASE 1

Project Title



**Expiration Date:** 02/28/2025

	DATE	DESCRIPTION

Drawn By:	CSA
Checked By:	CSA
Proj. #:	62-08-03-04-0-010-01
CSArch Proj. #:	197-2201.0
Issued for Bid:	08/18/22

Sheet Title

GROUND  
FLOOR  
DEMOLITION  
RCP

Sheet No. HES  
AD801

## CONSTRUCTION DOCUMENTS

**COPYRIGHT © ALL RIGHTS RESERVED**