

HIGHLAND CENTRAL SCHOOL DISTRICT
HIGHLAND ELEMENTARY SCHOOL
2022 CAPITAL IMPROVEMENT PROJECT - PHASE 1



Expiration Date: 02/28/2021

	DATE	DESCRIPTION

Drawn By:	CSA
Checked By:	CSA
Proj. #:	62-08-03-04-0-010-014
CSArch Proj. #:	197-2201.0
Issued for Bid:	08/18/23

Sheet Title

GROUND
FLOOR NEW
WORK RCP -
AREA 'A'

Sheet No. HES
A801

CONSTRUCTION DOCUMENTS

1. INSTALL CEILING GRIDS CENTERED IN THE ROOM. UNO. IN ROOMS OTHER THAN RECTANGULAR SHAPED, INSTALL GRIDS CENTERED ON WALLS OR OTHER BUILT FEATURES AS INDICATED.
2. INSTALLATION HEIGHTS OF THE CEILINGS MAY VARY SLIGHTLY FROM PLANS IN ROOMS WITH EXTERIOR WINDOWS. ACTUAL CEILING HEIGHT TO BE VERIFIED IN THE FIELD.
3. FINAL INSTALLED CEILINGS SHALL HAVE HEIGHTS COORDINATED WITH OTHER CONTRACTORS WITH ABOVE CEILING WORK AND VERIFIED WITH FIELD CONDITIONS. ALL CHANGES IN CONFIGURATION OR HEIGHTS ARE TO BE APPROVED BY THE ARCHITECT.

 GWB OR PLASTER CEILING, REFER TO DETAILS AND ROOM FINISH SCHEDULE

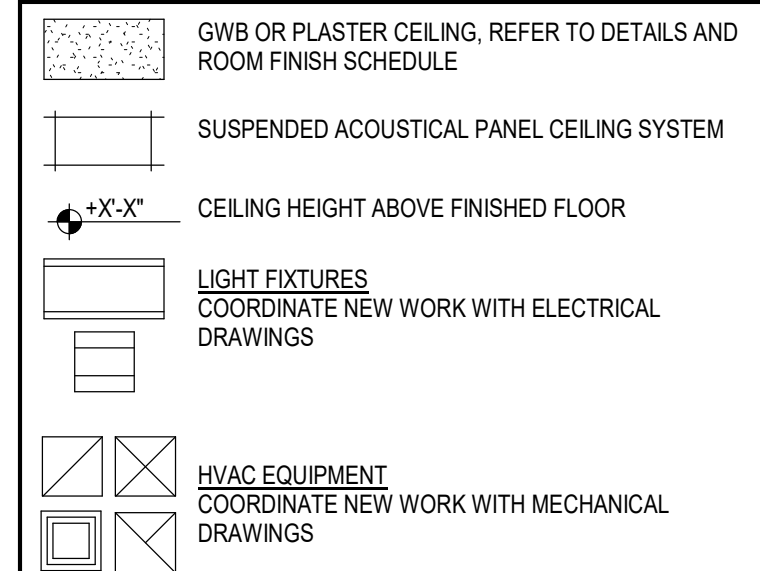

(X)	DESCRIPTION
8	PROVIDE NEW ACT CEILING AS SPECIFIED, COORDINATE WITH MECHANICAL AND ELECTRICAL DRAWINGS.
E1	LIGHT FIXTURE, TYPICAL. REFER TO ELECTRICAL DRAWINGS.

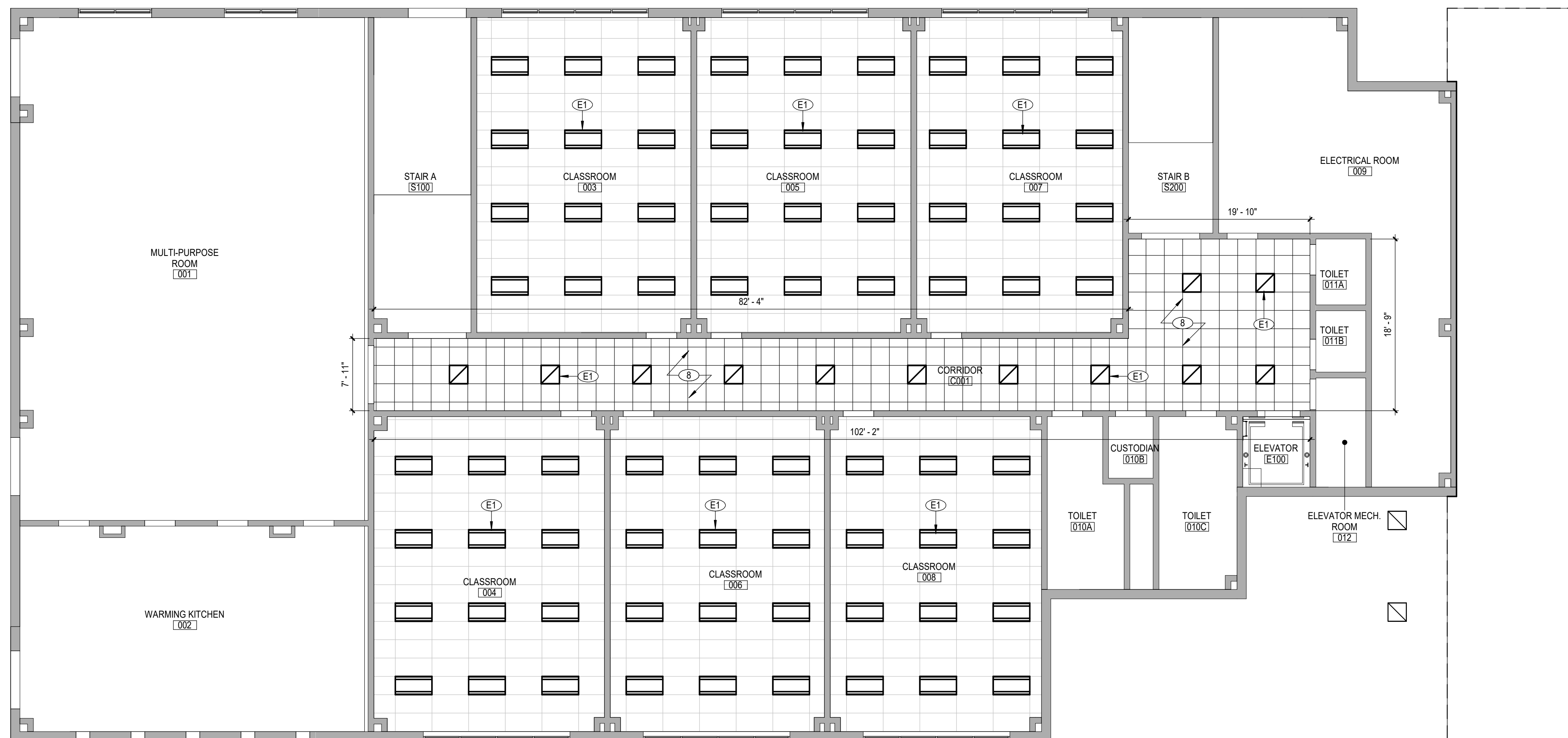

COPYRIGHT © ALL RIGHTS RESERVED