

C:\Users\dmiller\Documents\197-2201 - HHS Phase1_ARCH_dmliller303.rvt

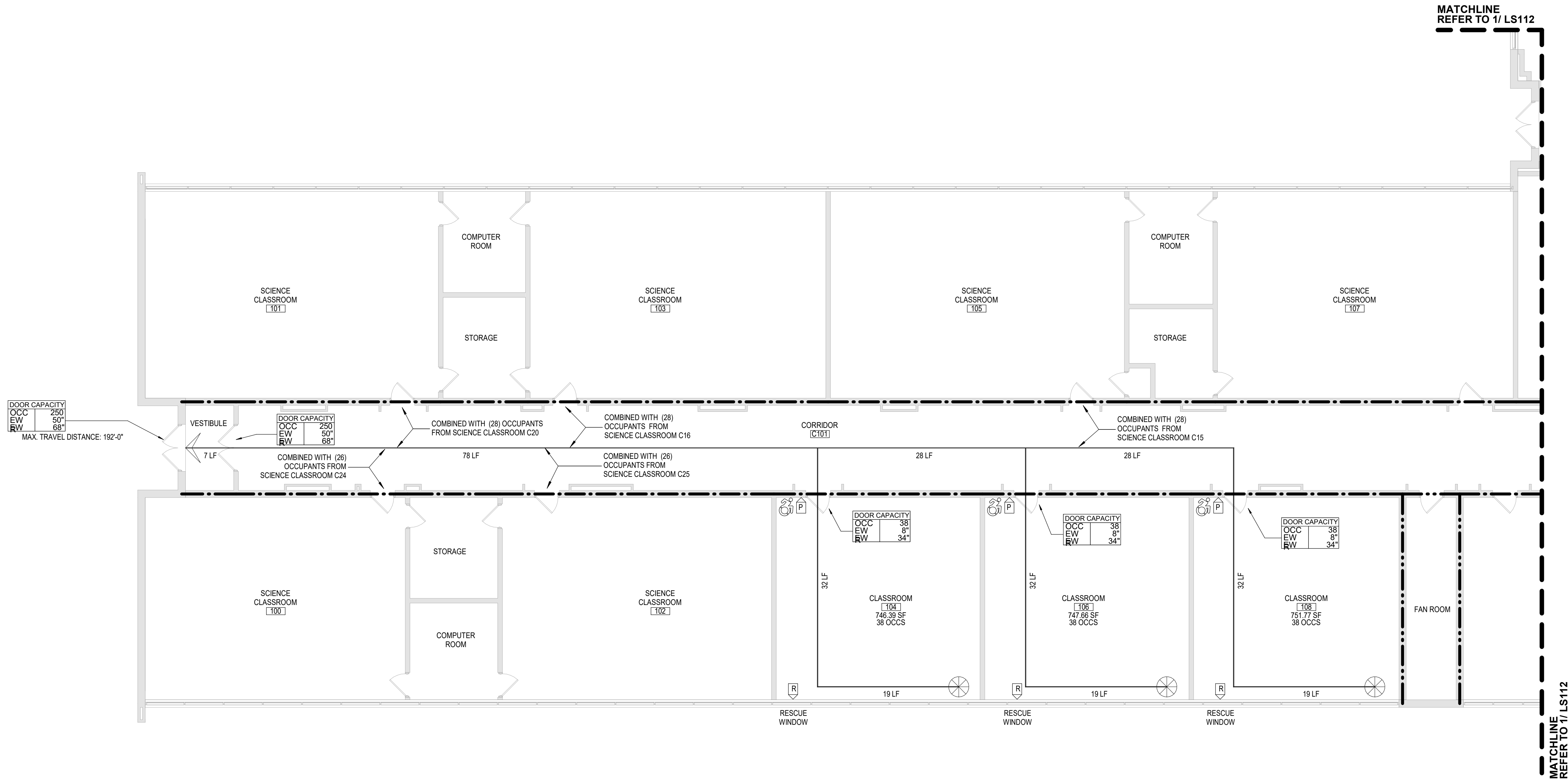

1 FIRST FLOOR LIFE SAFETY PLAN - AREA 'A'
LS111 1/8" = 1'-0"

CODE NOTES <p>ALL NEW WORK TO BE PERFORMED SHALL BE IN ACCORDANCE WITH THE FOLLOWING:</p> <ol style="list-style-type: none">2020 INTERNATIONAL BUILDING CODE2020 INTERNATIONAL EXISTING BUILDING CODENYS BUILDING CODE SUPPLEMENTSANSI A117.1-092022 NYSED MANUAL OF PLANNING STANDARDS <p>ALL EXISTING CONDITIONS AND NEW WORK CONDITIONS CONTAIN THE FOLLOWING MAXIMUM TRAVEL DISTANCES:</p> <ol style="list-style-type: none">EXIT ACCESS TRAVEL DISTANCE SHALL NOT EXCEED 200 FEET FOR UNSPRINKLERED BUILDINGS OF OCCUPANCY TYPE 'E'.ANY POINT IN ANY GROUND FLOOR CORRIDOR MUST BE WITHIN 150 FEET ALONG THE LINE OF TRAVEL TO AN EXTERIOR DOORWAY. ANY POINT IN A CORRIDOR OTHER THAN A GROUND FLOOR CORRIDOR SHALL NOT EXCEED 120 FEET ALONG THE LINE OF TRAVEL TO THE STAIR ENCLOSURE OF AN EXIT STAIRWAY. <p>ALL EXISTING CONDITIONS AND NEW WORK CONDITIONS CONTAIN THE FOLLOWING DEAD-END CORRIDOR INFORMATION:</p> <ol style="list-style-type: none">DEAD-END CORRIDOR POCKETS SHALL NOT EXCEED A MAXIMUM DEPTH OF 1 1/2 TIMES THE WIDTH OF THE POCKET, OR 1 1/2 TIMES THE WIDTH OF THE CORRIDOR, WHICHEVER IS LESS. MAX DEAD- END DISTANCE IS 20'.	LIFE SAFETY PLAN LEGEND <p>PRIMARY EXIT SECONDARY EXIT RESCUE WINDOW (SECONDARY EXIT) ACCESSIBLE EXIT RESCUE ASSISTANCE STATION / AREA OF REFUGE NUMBER OF OCCUPANTS PER TABLE 1004.1.2 (ACTUAL NUMBER OF OCCUPANTS) REQUIRED EXIT WIDTH FOR DOOR BASED ON (OCCUPANT * 0.2) REQUIRED EXIT WIDTH FOR STAIRS BASED ON (OCCUPANT * 0.3) EXIT PATH OF TRAVEL (START - END)</p> <p>ABBREVIATIONS DC DEFIBRILLATOR CABINET EWP EXIT WIDTH PROVIDED EWR EXIT WIDTH REQUIRED FE FIRE EXTINGUISHER FEC FIRE EXTINGUISHER CABINET OCCS NUMBER OF OCCUPANTS IN SPACE</p> SMOKE SEPARATION NOTES <p>PER S.E.D. §105-1.1, FLOORS SMOKE SEPARATED PER S.E.D. §109.3.1.5, SMOKE SEPARATED ZONES APPROX. 30,000 SF OR LESS SMOKE BARRIER DUCTWORK PENETRATIONS REQUIRED SMOKE DAMPER PER S.E.D. §105-2.4, IN SPRINKLERED BUILDINGS, ALL CORRIDORS SHALL BE PROTECTED FROM THE SPREAD OF SMOKE FROM ADJACENT SPACES. DOOR CLOSERS AND SMOKE DAMPERS ARE REQUIRED</p> FIRE SEPARATION NOTES <p>1 HOUR RATED FIRE PARTITION 2 HOUR RATED FIRE PARTITION</p> <p>CODE NARRATIVE: 1960 ORIGINAL CONSTRUCTION: CONSTRUCTION TYPE: IIA FIRST FLOOR AREA: 101,765 SF GROSS CURRENT USE: 'E' - EDUCATION 2001 CONSTRUCTION: CONSTRUCTION TYPE: IIB FIRST FLOOR AREA: 112,216 SF GROSS CURRENT USE: 'E' - EDUCATION BUILDING AREA: (PER TABLE 506.2) PERMITTED FOR TYPE IIB / GROUP 'E' REQUIRED CORRIDOR FIRE-RESISTANCE RATING: (PER TABLE 1004.3.2.1) 1 HOUR</p>
KEYPLAN <p>Diagram showing the location of Area 'A' (shaded) relative to other areas (B, C, D, E) on the first floor. Includes a north arrow.</p>	

19 Front St., Newburgh, New York 12550-7601
845.561.1317 www.csarch.com



HIGHLAND CENTRAL SCHOOL DISTRICT
HIGHLAND HIGH SCHOOL
2022 CAPITAL IMPROVEMENT PROJECT - PHASE 1

Project Title



Expiration Date: 02/28/2025

DATE	DESCRIPTION

Drawn By: CSA
Checked By: CSA
Proj. #: 62-08-03-04-0-009-014
CSArch Proj. #: 197-2201.01
Issued for Bid: 08/18/23

Sheet Title
FIRST FLOOR
LIFE SAFETY
PLAN - AREA
'A'

Sheet No.
HHS
LS111

CONSTRUCTION DOCUMENTS