

C:\Users\jmanuoro\Documents\197-2201 - HHS Phase1\_ARCH\jmanuoro.dwt

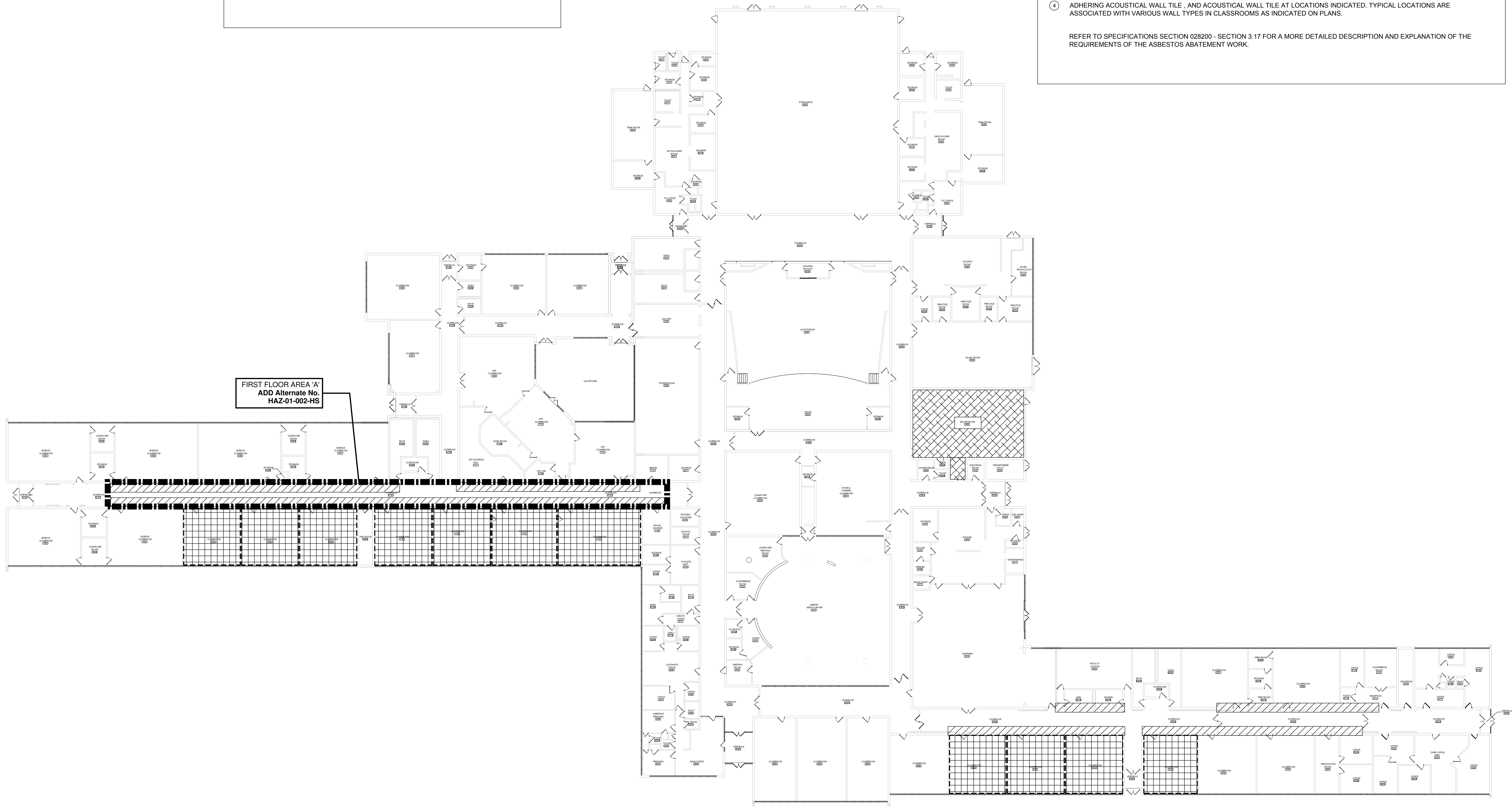

ASBESTOS ABATEMENT LEGEND

1

REMOVE AND DISPOSE OF FRIABLE ACM JOINT COMPOUND AND SHEETROCK AT WALL AND CEILING LOCATIONS. REFER TO NOTE 1

2

REMOVE AND DISPOSE OF ACM MUDDIED JOINT PACKING (MJP) AND THERMAL SYSTEMS INSULATION AT DESIGNATED LOCATIONS. REFER TO NOTE 2

3

REMOVE AND DISPOSE OF ACM FLOOR TILE AND MASTIC AT DESIGNATED LOCATIONS. REMOVE AND DISPOSE OF RUBBER WALL BASE AS ACM AT DESIGNATED LOCATIONS. REFER TO NOTE 3

4

CONTRACTOR TO REMOVE AND DISPOSE OF ACM CONTAMINATED GLUE DABS AT DESIGNATED LOCATIONS. REFER TO NOTE 4.

ASBESTOS ABATEMENT NOTES

1

ASBESTOS CONTRACTOR IS RESPONSIBLE FOR TOTAL AND COMPLETE REMOVAL AND DISPOSAL OF FRIABLE ACM CONTAINING JOINT COMPOUND AND ASSOCIATED SHEETROCK WALLS TO A HEIGHT OF SIX FEET. TYPICAL AT CORRIDOR LOCKER REMOVAL LOCATIONS. LIGHT FIXTURES WILL BE STABILIZED, HEPA VACUUMED, WET WIPED, PLASTICIZED AND REMAIN IN PLACE. ALL SMOKE AND CARBON MONOXIDE (CO) DETECTORS WILL BE PROTECTED WITH 2 LAYERS OF SIX MIL THICKNESS, FIRE RETARDANT POLY.

2

ASBESTOS ABATEMENT CONTRACTOR IS RESPONSIBLE FOR TOTAL AND COMPLETE REMOVAL AND DISPOSAL OF FRIABLE ASBESTOS CONTAINING MUDDIED JOINT PIPE (MJP) THERMAL SYSTEMS INSULATION LOCATED IN THE BOILER ROOM. SUSPENDED LIGHT FIXTURES WILL BE STABILIZED, HEPA VACUUMED, WET WIPED, PLASTICIZED AND REMAIN IN PLACE. GRID TO BE REMOVED UNDER CONTAINMENT TO ACCESS ACM. ALL SMOKE AND CARBON MONOXIDE (CO) DETECTORS WILL BE PROTECTED WITH 2 LAYERS OF SIX MIL THICKNESS, FIRE RETARDANT POLY.

3

ASBESTOS CONTRACTOR IS RESPONSIBLE FOR TOTAL AND COMPLETE REMOVAL AND DISPOSAL OF NON-FRIABLE ACM FLOOR TILE AND MASTIC AT LOCATIONS INDICATED ON THE PLANS.

4

ASBESTOS CONTRACTOR IS RESPONSIBLE FOR TOTAL AND COMPLETE REMOVAL AND DISPOSAL OF ACM GLUE DABS ADHERING ACOUSTICAL WALL TILE, AND ACOUSTICAL WALL TILE AT LOCATIONS INDICATED. TYPICAL LOCATIONS ARE ASSOCIATED WITH VARIOUS WALL TYPES IN CLASSROOMS AS INDICATED ON PLANS.

REFER TO SPECIFICATIONS SECTION 028200 - SECTION 3.17 FOR A MORE DETAILED DESCRIPTION AND EXPLANATION OF THE REQUIREMENTS OF THE ASBESTOS ABATEMENT WORK.

19 Park Ct., Newburgh, New York 12550-2603  
845.561.3179 www.csarch.com

QuEs&T  
Quality Environmental Services & Technology

CSARCH

HIGHLAND CENTRAL SCHOOL DISTRICT  
HIGHLAND HIGH SCHOOL  
2022 CAPITAL IMPROVEMENT PROJECT - PHASE 1

Project Title

J. Anthony ...

| DATE | DESCRIPTION |
|------|-------------|
|      |             |
|      |             |
|      |             |

Drawn By: AM  
Checked By: CD  
Proj. #: 62-08-03-04-0-009-014  
CSArch Proj. #: 197-2201.01  
Construction Documents: 1/31/22

Sheet Title  
HIGH SCHOOL  
FIRST FLOOR  
ABATEMENT  
PLAN

Sheet No.  
HHS  
HAZ-101

CONSTRUCTION DOCUMENTS

COPYRIGHT © ALL RIGHTS RESERVED