

PART 1 - GENERAL

1.01 GENERAL

- A. Pursuant to, and in compliance with, your Advertisement for Bids and the Information to Bidders relative thereto and all of the Contract Documents, including any Addenda issued by the Architect and mailed to the undersigned prior to the opening Bids, whether received by the undersigned or not, we

(CONTRACTOR NAME)

hereby proposes to furnish all plant, labor, supplies, materials, and equipment for Univent Replacement at Farley Elementary School and Willow Grove Elementary School – General Construction, as required by and in strict accord with the applicable provisions of the Drawings and Specifications entitled “Univent Replacement at Farley Elementary School and Willow Grove Elementary School – General Construction at North Rockland High School, 106 Hammond Rd, Thiells, NY 10984 for the North Rockland Central School District, 65 Chapel Street, Garnerville, NY 10923 ", all to the satisfaction and approval of the Architect and the Owner in accordance with the terms and conditions of the Contract Documents for the following prices:

1. _____ Dollars

(Write out in words)

(_____) Base Bid for all work.

_____ Consecutive Calendar Days for substantial completion _____ with base bid.

The undersigned further proposes and agrees hereby to commence work with an adequate force and equipment immediately after being notified in writing to do so, and to achieve substantial completion for all work as required by the plans and specifications within the number of consecutive calendar days as itemized above.

Univent Replacement at Farley Elementary School and Willow Grove Elementary School – General Construction

Univent Replacement a Farley Elementary School
(If only this project is awarded to the General Contractor)

(\$ _____)

Willow Grove Elementary School
(If only this project is awarded to the General Contractor)

(\$ _____)

Farley Elementary School and Willow Grove Elementary School
(If both projects are awarded to one General Contractor)
(Any saving of scale should be reflected in this total)

Total Project General Construction (\$ _____)

B. ALTERNATES

The undersigned further proposes and agrees that, should any of the following alternates be accepted and included in the Contract, the amount of the Base Bid, is hereto stated, shall be increased or decreased by the amounts indicated below.

Alternate No. 102 – Remove existing 12”X12” concealed spline ceiling. Provide new ACT ceiling and reinstall lighting.

Farley Elementary School (\$ _____)

Alternate No. 104 – Contractor to install one swing set and two add a swing kits with location to be determined in the field by owner. Swing set to be ADA GameTime – Powerscape Swing model number 81598. Add A Bay to be ADA Gametime – Powerscape Swing Add A Bay model number 81599. Swing set and Add A Bays will be provided to the contactor by the owner.

Farley Elementary School (\$_____)

Alternate No. 105 – Provide ¼’ thick soild surface material at all UV’s built into case work.

Farley Elementary School (\$_____)

Alternate No. 106 – Provide installation for a new canopy. Canopy to be provided to the contractor by the owner. Canopy model number RC201810IN. Attached cut sheets have been provided for the contractors reference. General Contractor shall include NYS P.E. signed and sealed drawing for footing design.

Farley Elementary School (\$_____)

Alternate No. 203 – Remove existing glass block and install new windows.

Willow Grove Elementary School (\$_____)

Alternate No. 204 – Contractor to install one swing set and two add a swing kits with location to be determined in the field by owner. Swing set to be ADA GameTime – Powerscape Swing model number 81598. Add A Bay to be ADA Gametime – Powerscape Swing Add A Bay model number 81599. Swing set and Add A Bays will be provided to the contactor by the owner.

Willow Grove Elementary School (\$_____)

Alternate No. 205 – Provide ¼” thick solid surface material at all UV’s built into case work.

Willow Grove Elementary School (\$_____)

Alternate No. 206 - Provide installation for a new canopy. Canopy to be provided to the contractor by the owner. Canopy model number RC201810IN. Attached cut sheets have been provided for the contractors reference. General Contractor shall include NYS P.E. signed and sealed drawing for footing design.

Willow Grove Elementary School (\$_____)

C. ALLOWANCES

The Contractor shall include in the Contract Sum all allowances stated in the Contract Documents.

Allowance No. 101 – Contractor to include an allowance for the LF of line set enclosure noted on the drawings.

Farley Elementary School (\$_____)

1.02 TIME OF COMPLETION

- A. (Farley ES): It is agreed by the undersigned that after receipt of Notice of Award and a consummation of a Contract Agreement in accord with the terms of the Contract Documents, contractor will start work on June 27th, 2024. Partial substantial completion will be August 23rd, 2024. The punch list work will be completed by September 23rd, 2024 and performed after school hours. Final substantial completion by August 22nd, 2025.
- B. (Willow Grove ES): It is agreed by the undersigned that after receipt of Notice of Award and a consummation of a Contract Agreement in accord with the terms of the Contract Documents, contractor will start work on June 20th, 2024. Substantial completion will be August 19th, 2024. The punch list work will be completed by September 19th, 2024 and performed after school hours.

1.03 BID SECURITY

- A. Attached hereto is Bid Security in the amount of five percent (5%) of the Base Bid.

1.04 UNIT PRICES

- A. For work to be supplied or omitted at the price rate stipulated herein should the volume of work be increased, the following unit prices will be established as the limitations for such items of work, and each unit price shall include material, labor and services of each and everything necessary or required to complete for like work in kind, quality and function.

Unit Price No. 101 – Provide a unit price for the installation of 10 linear feet of line set enclosure. (This amount will add or reduce Allowance No. 101).

Farley Elementary School (\$_____)

1.06 NON-COLLUSIVE BIDDING CERTIFICATION

- A. By submission of this bid, each bidder and each person signing on behalf of any bidder certifies, and in the case of a joint bid each party thereto certifies as to its own organization, under penalty of perjury, that to the best of knowledge and belief:

1. The prices in this bid have been arrived at independently without collusion, consultation, communication, or agreement, for the purpose of restricting competition, as to any matter relating to such prices with any other bidder or with any competitor.
2. Unless otherwise required by law, the prices which have been quoted in this bid have not been knowingly disclosed by the bidder and will not knowingly be disclosed by the bidder prior to opening, directly or indirectly, to any other bidder or to any competitor; and
3. No attempt has been made or will be made by the bidder to induce any other person, partnership or corporation to submit or not submit a bid for the purpose of restricting competition.

Resolved that _____
(Name of Individual)

be authorized to sign and submit the bid or proposal of this corporation for the following project

_____ and to include in such bid or proposal the certificate as to non-collusion required by Section One Hundred Three (d) (103d) of the General Municipal Law as the act and deed of such corporation, and for any inaccuracies or misstatements in such certificate this corporate bidder shall be liable under the penalty of perjury.

The foregoing is a true and correct copy of the resolution by

Corporation at a meeting of its Board of Directors held on the
_____ day of _____, 20____.

(SEAL OF THE CORPORATION)

Secretary

1.07 ACCEPTANCE

- A. When this Proposal is accepted, the undersigned agrees to enter into Contract with the Owner as provided in the Form of Agreement.

1.08 AFFIRMS

- A. The undersigned affirms and agrees that this Proposal is a firm one which remains in effect and will be irrevocable for a period of forty-five (45) days after opening of Bids.

1.09 TYPE OF BUSINESS

- A. The undersigned hereby represents that it is a _____
(Corporation, Partnership, or an Individual). If a corporation, then the undersigned further represents that it is duly qualified as a corporation under laws of New York State and it is authorized to do business in this State.

1.10 PLACE OF BUSINESS

- A. The following is the name and address of the person to whom all notices required in the connection with this Proposal may be telephoned, mailed, or delivered.

(Name)

(Address)

(Telephone)

1.11 EXECUTION OF CONTRACT

- A. When written Notice of Acceptance of the Proposal is mailed or delivered to the undersigned within forty-five (45) days after the opening of Bids, or anytime thereafter should the Proposal not be withdrawn, the undersigned, within ten (10) days, will execute the Form of Agreement with the Owner.

1.12 ADDENDA

- A. Any Addenda issued by the Architect and mailed or delivered to the undersigned prior to the Bid opening date shall become part of the Contract Documents. The Bidder shall enter on this list any addenda issued after this Form of Proposal has been received and shall fill in the addenda number and date.

Addendum # _____	Dated _____
Addendum # _____	Dated _____
Addendum # _____	Dated _____
Addendum # _____	Dated _____
Addendum # _____	Dated _____
Addendum # _____	Dated _____

1.13 ASBESTOS

- A. The Contractor certifies that no asbestos or asbestos-containing material will be incorporated into the Work of this Contract.

(Sign Bid Here)

Dated _____, 20____

Legal Name of Person, Partnership
or Corporation

By _____

Title _____

Address _____

PART 1 - GENERAL

1.01 GENERAL

- A. Pursuant to, and in compliance with, your Advertisement for Bids and the Information to Bidders relative thereto and all of the Contract Documents, including any Addenda issued by the Architect and mailed to the undersigned prior to the opening Bids, whether received by the undersigned or not, we

(CONTRACTOR NAME)

hereby proposes to furnish all plant, labor, supplies, materials, and equipment for Univent Replacement at Farley Elementary School and Willow Grove Elementary School – Mechanical Construction, as required by and in strict accord with the applicable provisions of the Drawings and Specifications entitled “Univent Replacement at Farley Elementary School and Willow Grove Elementary School – Mechanical at North Rockland High School, 106 Hammond Rd, Thiells, NY 10984 for the North Rockland Central School District, 65 Chapel Street, Garnerville, NY 10923”, all to the satisfaction and approval of the Architect and the Owner in accordance with the terms and conditions of the Contract Documents for the following prices:

1. _____ Dollars
(Write out in words)
(_____) Base Bid for all work.

_____ Consecutive Calendar Days for substantial completion _____ with base bid.

The undersigned further proposes and agrees hereby to commence work with an adequate force and equipment immediately after being notified in writing to do so, and to achieve substantial completion for all work as required by the plans and specifications within the number of consecutive calendar days as itemized above.

Univent Replacement at Farley Elementary School and Willow Grove Elementary School – Mechanical Construction

Univent Replacement a Farley Elementary School
(If only this project is awarded to the Mechanical Contractor) (\$ _____)

Willow Grove Elementary School
(If only this project is awarded to the Mechanical Contractor) (\$ _____)

Farley Elementary School and Willow Grove Elementary School
(If both projects are awarded to one Mechanical Contractor)
(Any saving of scale should be reflected in this total)
Total Project Mechanical Construction (\$ _____)

B. ALTERNATES

The undersigned further proposes and agrees that, should any of the following alternates be accepted and included in the Contract, the amount of the Base Bid, is hereto stated, shall be increased or decreased by the amounts indicated below.

Alternate No. 100 – Remove existing unused fan gear and ductwork in fan room 201. Fill and close existing 2 HR block wall with new block at old duct locations.

Farley Elementary School (\$ _____)

Alternate No. 200 – Replace existing unit ventilators in location specified on drawings WGES-A-100 and WGES-A-101. See plans for locations. Include an allowance to replace existing heat supply & return piping and insulation for 20 linear feet per each unit ventilator to be replaced.

Willow Grove Elementary School (\$_____)

Alternate No. 201 – Remove and replace cafeteria unit, see mechanical drawings.

Willow Grove Elementary School (\$_____)

Alternate No. 202 – Refurbish existing plenum mounted HVAC unit and provide new access panels and maintenance platforms for AHU-1 and AHU-2.

Willow Grove Elementary School (\$_____)

C. ALLOWANCES

The Contractor shall include in the Contract Sum all allowances stated in the Contract Documents.

Allowance No. 100 – Replace existing supply and return piping and insulation for 30 linear feet per each unit ventilator. (Number of UV's X 30 linear feet = Total linear feet in Allowance No. 100)
(To be modified by Unit Price No. 100)

Allowance No. 104 – Hazardous materials allowance.

Farley Elementary School (\$_____)

Allowance No. 200 – Replace existing heat & chilled water supply & return piping and insulation for 40 linear feet per each unit ventilator to be replaced as per base bid.
(Number of UV's X 40 linear feet = Total linear feet in Allowance No. 200)
(To be modified by Unit Price No. 200)

1.02 TIME OF COMPLETION

A. (Farley ES): It is agreed by the undersigned that after receipt of Notice of Award and a consummation of a Contract Agreement in accord with the terms of the Contract Documents, contractor will start work on June 27th, 2024. Partial substantial completion will be August 23rd, 2024. The punch list work will be completed by September 23rd, 2024 and performed after school hours. Final substantial completion by August 22nd, 2025.

(Willow Grove ES): It is agreed by the undersigned that after receipt of Notice of Award and a consummation of a Contract Agreement in accord with the terms of the Contract Documents, contractor will start work on June 20th, 2024. Substantial completion will be August 19th, 2024. The punch list work will be completed by September 19th, 2024 and performed after school hours.

1.03 BID SECURITY

A. Attached hereto is Bid Security in the amount of five percent (5%) of the Base Bid.

1.04 UNIT PRICES

- A. For work to be supplied or omitted at the price rate stipulated herein should the volume of work be increased, the following unit prices will be established as the limitations for such items of work, and each unit price shall include material, labor and services of each and everything necessary or required to complete for like work in kind, quality and function.

Unit Price No. 100 – Provide a unit price to replace additional existing supply and return piping and insulation. Price is per 10 linear feet. (This amount will add or reduce Allowance No. 100).

Farley Elementary School (\$_____)

Unit Price No. 200 – Provide unit price to replace 10 linear feet of existing heat or chilled water pipe (This amount will add or reduce Allowance No. 200).

Willow Grove Elementary School (\$_____)

1.06 NON-COLLUSIVE BIDDING CERTIFICATION

- A. By submission of this bid, each bidder and each person signing on behalf of any bidder certifies, and in the case of a joint bid each party thereto certifies as to its own organization, under penalty of perjury, that to the best of knowledge and belief:

1. The prices in this bid have been arrived at independently without collusion, consultation, communication, or agreement, for the purpose of restricting competition, as to any matter relating to such prices with any other bidder or with any competitor.
2. Unless otherwise required by law, the prices which have been quoted in this bid have not been knowingly disclosed by the bidder and will not knowingly be disclosed by the bidder prior to opening, directly or indirectly, to any other bidder or to any competitor; and
3. No attempt has been made or will be made by the bidder to induce any other person, partnership or corporation to submit or not submit a bid for the purpose of restricting competition.

Resolved that _____
(Name of Individual)

be authorized to sign and submit the bid or proposal of this corporation for the following project

_____ and to include in such bid or proposal the certificate as to non-collusion required by Section One Hundred Three (d) (103d) of the General Municipal Law as the act and deed of such corporation, and for any inaccuracies or misstatements in such certificate this corporate bidder shall be liable under the penalty of perjury.

The foregoing is a true and correct cop of the resolution by

Corporation at a meeting of its Board of Directors held on the _____ day of _____, 20____.

(SEAL OF THE CORPORATION)

Secretary

1.07 ACCEPTANCE

- A. When this Proposal is accepted, the undersigned agrees to enter into Contract with the Owner as provided in the Form of Agreement.

1.08 AFFIRMS

- A. The undersigned affirms and agrees that this Proposal is a firm one which remains in effect and will be irrevocable for a period of forty-five (45) days after opening of Bids.

1.09 TYPE OF BUSINESS

- A. The undersigned hereby represents that it is a _____
(Corporation, Partnership, or an Individual). If a Corporation, then the undersigned further represents that it is duly qualified as a Corporation under laws of New York State and it is authorized to do business in this State.

1.10 PLACE OF BUSINESS

- A. The following is the name and address of the person to whom all notices required in the connection with this Proposal may be telephoned, mailed or delivered.

(Name)

(Address)

(Telephone)

1.11 EXECUTION OF CONTRACT

- A. When written Notice of Acceptance of the Proposal is mailed or delivered to the undersigned within forty-five (45) days after the opening of Bids, or anytime thereafter should the Proposal not be withdrawn, the undersigned, within ten (10) days, will execute the Form of Agreement with the Owner.

1.12 ADDENDA

- A. Any Addenda issued by the Architect and mailed or delivered to the undersigned prior to the Bid opening date shall become part of the Contract Documents. The Bidder shall enter on this list any addenda issued after this Form of Proposal has been received and shall fill in the addenda number and date.

Addendum # _____	Dated _____
Addendum # _____	Dated _____
Addendum # _____	Dated _____
Addendum # _____	Dated _____
Addendum # _____	Dated _____
Addendum # _____	Dated _____

1.13 ASBESTOS

- A. The Contractor certifies that no asbestos or asbestos-containing material will be incorporated into the Work of this Contract.

(Sign Bid Here)

Dated _____, 20____

Legal Name of Person, Partnership
or Corporation

By _____

Title _____

Address _____

PART 1 - GENERAL

1.01 GENERAL

- A. Pursuant to, and in compliance with, your Advertisement for Bids and the Information to Bidders relative thereto and all of the Contract Documents, including any Addenda issued by the Architect and mailed to the undersigned prior to the opening Bids, whether received by the undersigned or not, we

(CONTRACTOR NAME)

hereby proposes to furnish all plant, labor, supplies, materials and equipment for Univent Replacement at Farley Elementary School and Willow Grove Elementary School - Electrical Construction as required by and in strict accord with the applicable provisions of the Drawings and Specifications entitled "Univent Replacement at Farley Elementary School and Willow Grove Elementary School – Electrical at 106 Hammond Rd, Thiells, NY 10984 for the North Rockland Central School District, 65 Chapel Street, Garnerville, NY 10923 ", all to the satisfaction and approval of the Architect and the Owner in accordance with the terms and conditions of the Contract Documents for the following prices:

1. _____ Dollars

(Write out in words)

(_____) Base Bid for all work.

_____ Consecutive Calendar Days for substantial completion _____ with base bid.

The undersigned further proposes and agrees hereby to commence work with an adequate force and equipment immediately after being notified in writing to do so, and to achieve substantial completion for all work as required by the plans and specifications within the number of consecutive calendar days as itemized above.

Univent Replacement at Farley Elementary School and Willow Grove Elementary School – Electrical Construction

Univent Replacement a Farley Elementary School

(If only this project is awarded to the Electrical Contractor)

(\$ _____)

Willow Grove Elementary School

(If only this project is awarded to the Electrical Contractor)

(\$ _____)

Farley Elementary School and Willow Grove Elementary School

(If both projects are awarded to one Electrical Contractor)

(Any saving of scale should be reflected in this total)

(\$ _____)

Total Project Electrical (\$ _____)

B. ALTERNATES

The undersigned further proposes and agrees that, should any of the following alternates be accepted and included in the Contract, the amount of the Base Bid, is hereto stated, shall be increased or decreased by the amounts indicated below.

Alternate No. 101 – Include ceiling and lighting replacement in corridors. See drawings FES-D-101, FES-D-102, FES-D-105, FES-A-401, FES-A-402, FES-A-403.

Farley Elementary School (\$ _____)

C. ALLOWANCES

The Contractor shall include in the Contract Sum all allowances stated in the Contract Documents.

Allowance No. 102 – Provide an Allowance for the relocation of 40 electrical devices that require relocation due to new UV size.

Farley Elementary School (\$_____)

Allowance No. 103 – Electrical contractor to provide new power connections to 10 existing UV locations where existing cannot be reused.

Willow Grove Elementary School (\$_____)

1.02 TIME OF COMPLETION

- A. (Farley ES): It is agreed by the undersigned that after receipt of Notice of Award and a consummation of a Contract Agreement in accord with the terms of the Contract Documents, contractor will start work on June 27th, 2024. Partial substantial completion will be August 23rd, 2024. The punch list work will be completed by September 23rd, 2024 and performed after school hours. Final substantial completion by August 22nd, 2025.
- B. (Willow Grove ES): It is agreed by the undersigned that after receipt of Notice of Award and a consummation of a Contract Agreement in accord with the terms of the Contract Documents, contractor will start work on June 20th, 2024. Substantial completion will be August 19th, 2024. The punch list work will be completed by September 19th, 2024 and performed after school hours.

1.03 BID SECURITY

- A. Attached hereto is Bid Security in the amount of five percent (5%) of the Base Bid.

1.04 UNIT PRICES

For work to be supplied or omitted at the price rate stipulated herein should the volume of work be increased, the following unit prices will be established as the limitations for such items of work, and each unit price shall include material, labor and services of each and everything necessary or required to complete for like work in kind, quality and function.

Unit Price No. 102 – Electrical Contractor to provide a unit price to relocate an existing electrical device that is required to be relocated. Price per 1 device. (This amount will add or reduce Allowance No. 102).

Farley Elementary School (\$_____)

Unit Price No. 103 – electrical Contractor to provide a unit price for a new power connection to existing UV location where an existing feeder cannot be reused. Price per 1 feed. (This amount will add or reduce Allowance No. 103).

Willow Grove Elementary School (\$_____)

1.06 NON-COLLUSIVE BIDDING CERTIFICATION

- A. By submission of this bid, each bidder and each person signing on behalf of any bidder certifies, and in the case of a joint bid each party thereto certifies as to its own organization, under penalty of perjury, that to the best of knowledge and belief:
1. The prices in this bid have been arrived at independently without collusion, consultation, communication, or

agreement, for the purpose of restricting competition, as to any matter relating to such prices with any other bidder or with any competitor.

2. Unless otherwise required by law, the prices which have been quoted in this bid have not been knowingly disclosed by the bidder and will not knowingly be disclosed by the bidder prior to opening, directly or indirectly, to any other bidder or to any competitor; and
3. No attempt has been made or will be made by the bidder to induce any other person, partnership or corporation to submit or not submit a bid for the purpose of restricting competition.

Resolved that _____
(Name of Individual)

be authorized to sign and submit the bid or proposal of this corporation for the following project _____ and to include in such bid or proposal the certificate as to non-collusion required by Section One Hundred Three (d) (103d) of the General Municipal Law as the act and deed of such corporation, and for any inaccuracies or misstatements in such certificate this corporate bidder shall be liable under the penalty of perjury.

The foregoing is a true and correct cop of the resolution by

Corporation at a meeting of its Board of Directors held on the _____ day of _____, 20____.

(SEAL OF THE CORPORATION)

Secretary

1.07 ACCEPTANCE

- A. When this Proposal is accepted, the undersigned agrees to enter into Contract with the Owner as provided in the Form of Agreement.

1.08 AFFIRMS

- A. The undersigned affirms and agrees that this Proposal is a firm one which remains in effect and will be irrevocable for a period of forty-five (45) days after opening of Bids.

1.09 TYPE OF BUSINESS

- A. The undersigned hereby represents that it is a _____ (Corporation, Partnership, or an Individual). If a Corporation, then the undersigned further represents that it is duly qualified as a Corporation under laws of New York State and it is authorized to do business in this State.

1.10 PLACE OF BUSINESS

- A. The following is the name and address of the person to whom all notices required in the connection with this Proposal may be telephoned, mailed or delivered.

(Name)

(Address)

(Telephone)

1.11 EXECUTION OF CONTRACT

- A. When written Notice of Acceptance of the Proposal is mailed or delivered to the undersigned within forty-five (45) days after the opening of Bids, or anytime thereafter should the Proposal not be withdrawn, the undersigned, within ten (10) days, will execute the Form of Agreement with the Owner.

1.12 ADDENDA

- A. Any Addenda issued by the Architect and mailed or delivered to the undersigned prior to the Bid opening date shall become part of the Contract Documents. The Bidder shall enter on this list any addenda issued after this Form of Proposal has been received and shall fill in the addenda number and date.

Addendum # _____	Dated _____
Addendum # _____	Dated _____
Addendum # _____	Dated _____
Addendum # _____	Dated _____
Addendum # _____	Dated _____
Addendum # _____	Dated _____

1.13 ASBESTOS

- A. The Contractor certifies that no asbestos or asbestos-containing material will be incorporated into the Work of this Contract.

(Sign Bid Here)

Dated _____, 20_____

Legal Name of Person, Partnership
or Corporation

By _____

Title _____

Address _____

SECTION 011200 - MULTIPLE CONTRACT SUMMARY

PART 1 - GENERAL

1.1 RELATED DOCUMENTS

- A. Drawings and general provisions of the Contract, including General and Supplementary Conditions and other Division 01 Specification Sections, apply to this Section.

1.2 SUMMARY

- A. Section includes a summary of each contract, including responsibilities for coordination and temporary facilities and controls.
- B. Specific requirements for Work of each contract are also indicated in individual Specification Sections and on Drawings.
- C. Related Requirements:
 - 1. Section 011000 "Summary" for the Work covered by the Contract Documents, restrictions on use of Project site, phased construction, coordination with occupants, and work restrictions.
 - 2. Section 013100 "Project Management and Coordination" for general coordination requirements.

1.3 DEFINITIONS

- A. Permanent Enclosure: As determined by Architect, the condition at which roofing is insulated and weathertight; exterior walls are insulated and weathertight; and all openings are closed with permanent construction or substantial temporary closures equivalent in weather protection to permanent construction.

1.4 PROJECT COORDINATOR

- A. Project coordinator shall be responsible for coordination between the General Construction Contract, Plumbing Contract, HVAC Contract, Electrical Contract,.
 - 1. HVAC Contractor will act as Project Coordinator.

1.5 COORDINATION ACTIVITIES

- A. Coordination activities of Project coordinator include, but are not limited to, the following:
 - 1. Provide overall coordination of the Work.
 - 2. Coordinate shared access to workspaces.
 - 3. Coordinate product selections for compatibility.
 - 4. Provide overall coordination of temporary facilities and controls.
 - 5. Coordinate, schedule, and approve interruptions of permanent and temporary utilities, including those necessary to make connections for temporary services.
 - 6. Coordinate construction and operations of the Work with work performed by each Contract and Owner's construction forces and separate contracts.
 - 7. Prepare coordination drawings in collaboration with each contractor to coordinate work by more than one contract.
 - 8. Coordinate sequencing and scheduling of the Work. Include the following:

- a. Initial Coordination Meeting: At earliest possible date, arrange and conduct a meeting with contractors for sequencing and coordinating the Work; negotiate reasonable adjustments to schedules.
 - b. Prepare a combined contractors' construction schedule for entire Project. Base schedule on preliminary construction schedule. Secure time commitments for performing critical construction activities from contractors. Show activities of each contract on a separate sheet. Prepare a simplified summary sheet indicating combined construction activities of contracts.
 - 1) Submit schedules for approval.
 - 2) Distribute copies of approved schedules to contractors.
9. Provide photographic documentation.
 10. Provide quality-assurance and quality-control services specified in Section 014000 "Quality Requirements."
 11. Coordinate sequence of activities to accommodate tests and inspections, and coordinate schedule of tests and inspections.
 12. Provide information necessary to adjust, move, or relocate existing utility structures affected by construction.
 13. Locate existing permanent benchmarks, control points, and similar reference points, and establish permanent benchmarks on Project site.
 14. Provide field surveys of in-progress construction and site work and final property survey.
 15. Provide progress cleaning of common areas and coordinate progress cleaning of areas or pieces of equipment where more than one contractor has worked.
 16. Coordinate cutting and patching.
 17. Coordinate protection of the Work.
 18. Coordinate firestopping.
 19. Coordinate completion of interrelated punch list items.
 20. Coordinate preparation of Project record documents if information from more than one contractor is to be integrated with information from other contractors to form one combined record.
 21. Print and submit record documents if installations by more than one contractor are indicated on the same contract drawing or shop drawing.
 22. Collect record Specification Sections from contractors, collate Sections into numeric order, and submit complete set.
 23. Coordinate preparation of operation and maintenance manuals if information from more than one contractor is to be integrated with information from other contractors to form one combined record.
- B. Responsibilities of Project coordinator for temporary facilities and controls include, but are not limited to, the following:
1. Provide common-use field office for use by all personnel engaged in construction activities.

1.6 GENERAL REQUIREMENTS OF CONTRACTS

- A. Extent of Contract: Unless the Agreement contains a more specific description of the Work of each Contract, requirements indicated on Drawings and in Specification Sections determine which contract includes a specific element of Project.
1. Unless otherwise indicated, the work described in this Section for each contract shall be complete systems and assemblies, including products, components, accessories, and installation required by the Contract Documents.
 2. Trenches and other excavation for the work of each contract shall be the work of each contract for its own work.
 3. Blocking, backing panels, sleeves, and metal fabrication supports for the work of each contract shall be the work of each contract for its own work.
 4. Furnishing of access panels for the work of each contract shall be the work of each contract for its own work. Installation of access panels shall be the work of the General Construction Contract.
 5. Equipment pads for the work of each contract shall be the work of each contract for its own work.
 6. Roof-mounted equipment curbs for the work of each contract shall be the work of each contract for its own work.
 7. Painting for the work of each contract shall be the work of each contract for its own work.
 8. Cutting and Patching: Each contract shall perform its own cutting; patching shall be under the General Construction Contract.

9. Through-penetration firestopping for the work of each contract shall be provided by each contract for its own work.
 10. Contractors' Startup Construction Schedule: Within five working days after startup horizontal bar-chart-type construction schedule submittal has been received from Project coordinator, submit a matching startup horizontal bar-chart schedule showing construction operations sequenced and coordinated with overall construction.
- B. Substitutions: Each contractor shall cooperate with other contractors involved to coordinate approved substitutions with remainder of the work.
1. Project coordinator shall coordinate substitutions.
- C. Temporary Facilities and Controls: In addition to specific responsibilities for temporary facilities and controls indicated in this Section and in Section 015000 "Temporary Facilities and Controls," each contractor is responsible for the following:
1. Installation, operation, maintenance, and removal of each temporary facility necessary for its own normal construction activity, and costs and use charges associated with each facility, except as otherwise provided for in this Section.
 2. Plug-in electric power cords and extension cords, supplementary plug-in task lighting, and special lighting necessary exclusively for its own activities.
 3. Its own field office, complete with necessary furniture, utilities, and telephone service.
 4. Its own storage and fabrication sheds.
 5. Temporary enclosures for its own construction activities.
 6. Staging and scaffolding for its own construction activities.
 7. General hoisting facilities for its own construction activities, up to 2 tons (2000 kg).
 8. Waste disposal facilities, including collection and legal disposal of its own hazardous, dangerous, unsanitary, or other harmful waste materials.
 9. Progress cleaning of work areas affected by its operations on a daily basis.
 10. Secure lockup of its own tools, materials, and equipment.
 11. Construction aids and miscellaneous services and facilities necessary exclusively for its own construction activities.
- D. Temporary Heating, Cooling, and Ventilation: Project coordinator] is responsible for temporary heating, cooling, and ventilation, including utility-use charges, temporary meters, and temporary connections.
- E. Use Charges: Comply with the following:
1. Water Service: Include the cost for water service, whether metered or otherwise, for water used by all entities engaged in construction activities at Project site in the General Construction Contract.
 2. Electric Power Service: Include the cost for electric power service, whether metered or otherwise, for electricity used by all entities engaged in construction activities at Project site in the General Construction Contract.
- 1.7 GENERAL CONSTRUCTION CONTRACT
- A. Supply all necessary materials, labor, services, equipment, and tools required to perform the following site General Construction, work for the UV Replacement and Rooftop HVAC Units. All work to be installed in strict accordance with Specifications and Drawings.
- B. Supply all necessary materials, equipment, devices and labor for implementation and up-keep of site safety as it relates to this scope of work, to meet or exceed OSHA and / or safety agencies having jurisdiction on this project. Any and all costs resulting from OSHA sited violations will be the complete responsibility of this subcontractor.
- C. This project is a prevailing wage project, and it is the responsibility of this sub-contractor to ensure that all of the latest rules and regulations published by the NYS Department of Labor, Wage and Workplace Standards Division, Public Contract Compliance Unit are strictly followed and adhered to. In the events of an audit conduct by the NYS Department of Labor, this sub-contractor will be responsible for any and all costs associated with the audit and the Departments' final decision.

- D. Work in the General Construction Contract includes, but is not limited to, the following:
1. Ceiling tile removal and installation. Provide replacement tiles and grid if damaged during removal.
 2. Supply/install all materials, labor, equipment, and tools for installation of metal stud partition/soffits and masonry walls.
 3. Supply/install all enclosures to encase new line sets, pipes, and electrical cables.
 4. Supply all materials, labor, equipment, and tools to install and finish gypsum at newly constructed metal stud chases, wall area, and masonry walls. Finish and paint all new surfaces, and any damaged existing surfaces.
 5. Supply all materials, labor, equipment, and tools to install all access panels, patch and paint all disturbed areas.
 6. Supply and install all necessary blocking, anchors, and hangers to support and secure ductwork, and roof curbs.
 7. Supply all materials, labor, equipment, and tools to modify/construct all interior walls, gypsum and masonry patching and paint as required. All case work modifications required for UV installation, including solid surface installation.
 8. File, pay for, and obtain all required permits, inspections and approvals.
 9. Schedule and perform all inspections required by this scope of work.
 10. Removal and disposal of daily generated debris. Upon completion of this contractor's work, all excess materials and debris in the building and site are to be removed and disposed of promptly.
 11. Fabricate, install, and paint all line set enclosures.
 12. This is a prevailing wage project.
 13. Structural steel work for installation of roof top chiller and VRF equipment, concrete pad and fence for ground mounted chiller.

1.8 PLUMBING CONTRACT – VOID, NOT IN CONTRACT

1.9 HVAC CONTRACT

- A. Supply all necessary materials, labor, services, equipment and tools required to perform the following site electrical work for the UV Replacement and Rooftop HVAC Units. All work to be installed in strict accordance with Specifications and Drawings.
- B. Supply all necessary materials, equipment, devices and labor for implementation and up-keep of site safety as it relates to this scope of work, to meet or exceed OSHA and / or safety agencies having jurisdiction on this project. Any and all costs resulting from OSHA sited violations will be the complete responsibility of this subcontractor
- C. This project is a prevailing wage project and it is the responsibility of this sub-contractor to ensure that all of the latest rules and regulations published by the NYS Department of Labor, Wage and Workplace Standards Division, Public Contract Compliance Unit are strictly followed and adhered to. In the events of an audit conduct by the NYS Department of Labor, this sub-contractor will be responsible for any and all costs associated with the audit and the Departments' final decision.
- D. Work in the HVAC Contract includes, but is not limited to, the following:
1. The remaining work not identified as work under other contracts.
 2. Curbs, RTUs/UV's/VRFs, chillers and accessories to be hoisted onto the roof or required floor level.
 3. Assemble roof curbs and dunnage, set in place, anchor, and flash to roof structure. (structural steel by GC)
 4. Cut and patch roofing. Willow Grove roof has a Tremco warranty. The contractor shall comply with Tremco standards to extend the warranty to modified areas. Farley has an older BUR roof any work performed shall meet Tremco 20 years warranty requirements.
 5. Supply and install galvanized supply and return curb transitions.
 6. Install RTUs onto curbs and weather-tight.
 7. Install all RTU accessories, including filters.
 8. Replace/modify UV's and new cabinets, associated ductwork work and pipe, insulation all new lines.

9. Install thermostats connect to BMS and make connections at RTUs and UV's.
10. Program thermostats for heat, cooling, and occupied & unoccupied times.
11. Make all supply and return ductwork connections.
12. Start up and test RTUs/UV's for heat. Cooling and fresh air where applicable.
13. Adjust all volume dampers and diffusers to provide proper air flow.
14. Make all ductwork connections for fans.
15. Test all fans.
16. Balance system as per specifications.
17. File, pay for, and obtain all required permit, inspections, and approvals.
18. Schedule and perform all inspections required by this scope of work.
19. Removal and disposal of daily generated debris.
20. Demolition of existing system that are being replaced.
21. Upon completion of this contractor's work, all excess materials and debris in the building and site are to be removed and disposed of promptly.
22. Integrate with current BMS system.
23. This is a prevailing wage project.
24. Installation of duct smoke detectors, provided by the Electrical Engineer.

E. Temporary facilities and controls in the HVAC Contract include, but are not limited to, the following:

1. Temporary facilities and controls that are not otherwise specifically assigned to the Plumbing Contract.
2. Temporary enclosure for building exterior.
3. Temporary roads and paved areas.
4. Project identification and temporary signs.
5. General waste disposal facilities.
6. Temporary fire-protection facilities.
7. Barricades, warning signs, and lights.
8. Site enclosure fence.
9. Security enclosure and lockup.
10. Environmental protection.
11. Restoration of Owner's existing facilities used as temporary facilities.

1.10 ELECTRICAL CONTRACT

- A. Supply all necessary materials, labor, services, equipment and tools required to perform the following site electrical work for the UV Replacement and Rooftop HVAC Units. All work to be installed in strict accordance with Specifications and Drawings.
- B. Supply all necessary materials, equipment, devices and labor for implementation and up-keep of site safety as it relates to this scope of work, to meet or exceed OSHA and / or safety agencies having jurisdiction on this project. Any and all costs resulting from OSHA sited violations will be the complete responsibility of this subcontractor
- C. This project is a prevailing wage project, and it is the responsibility of this sub-contractor to ensure that all of the latest rules and regulations published by the NYS Department of Labor, Wage and Workplace Standards Division, Public Contract Compliance Unit are strictly followed and adhered to. In the events of an audit conduct by the NYS Department of Labor, this sub-contractor will be responsible for any and all costs associated with the audit and the Departments' final decision.
- D. Work in the Electrical Contract includes, but is not limited to, the following:
 1. Supply and install all electrical materials, devices, and equipment for the RTU, UV, heat pumps, chillers.
 2. Supply and install complete electrical service from source to new RTU's, heat pumps.
 3. Supply and install complete electrical service from source to new RTU Condenser units.
 4. Supply and install RTU disconnects and make electrical connections.
 5. Supply and install RTU maintenance receptacles and make electrical connections.
 6. Excavation, backfill, site restoration for all electrical conduits.
 7. Concrete pads required for electrical equipment.
 8. Disconnect and reconnect electrical connection to UV's.

9. Supply and install all electrical materials, devices, and equipment for electrical service upgrade at Farley School.
10. Coordination with utility company for service upgrade.
11. Test all site installed systems.
12. Test all factory installed systems.
13. File and obtain and pay for all required permits, inspections, and approval.
14. Schedule and perform all inspections required by this scope of work.
15. Start up RTUs/UV's
16. Supply, install and coordinate fire alarm wiring and devices. Provide duct detectors to HVAC Contractor for installation.
17. Removal and disposal of daily generated debris.
18. Upon completion of this contractor's work, all excess materials and debris in the building, connecting link and site are to be removed and disposed of promptly, and site restored to original condition.
19. This is a prevailing wage project.

E. Temporary facilities and controls in the Electrical Contract include, but are not limited to, the following:

1. Electric power service and distribution.
2. Electrical connections to existing systems and temporary facilities and controls furnished by the General Construction Contract, Plumbing Contract, HVAC Contract, Electrical Contract.

PART 2 - PRODUCTS (Not Used)

PART 3 - EXECUTION (Not Used)

END OF SECTION 011200

SECTION 012300 - ALTERNATES

PART 1 - GENERAL

1.1 RELATED DOCUMENTS

- A. Drawings and general provisions of the Contract, including General and Supplementary Conditions and other Division 01 Specification Sections, apply to this Section.

1.2 SUMMARY

- A. Section includes administrative and procedural requirements for alternates.

1.3 DEFINITIONS

- A. Alternate: An amount proposed by bidders and stated on the Bid Form for certain work defined in the bidding requirements that may be added to or deducted from the base bid amount if the Owner decides to accept a corresponding change either in the amount of construction to be completed or in the products, materials, equipment, systems, or installation methods described in the Contract Documents.
 - 1. Alternates described in this Section are part of the Work only if enumerated in the Agreement.
 - 2. The cost or credit for each alternate is the net addition to or deduction from the Contract Sum to incorporate alternates into the Work. No other adjustments are made to the Contract Sum.

1.4 PROCEDURES

- A. Coordination: Revise or adjust affected adjacent work as necessary to completely integrate work of the alternate into Project.
 - 1. Include, as part of each alternate, miscellaneous devices, accessory objects, and similar items incidental to or required for a complete installation, whether or not indicated as part of alternate.
- B. Execute accepted alternates under the same conditions as other Work of the Contract.
- C. Schedule: A Part 3 "Schedule of Alternates" Article is included at the end of this Section. Specification Sections referenced in schedule contain requirements for materials necessary to achieve the work described under each alternate.

PART 2 - PRODUCTS (Not Used)

PART 3 - EXECUTION

3.1 SCHEDULE OF ALTERNATES

- A. Alternate No. 100 (Farley ES) : Remove existing unused fan gear and ductwork in fan room 201. Fill and close existing 2 HR block wall with new block at old duct locations.
- B. Alternate No. 101 (Farley ES): Include ceiling and lighting replacement in corridors. See drawings FES-D-101, FES-D-102, FES-D-105, FES-A-401, FES-A-402, FES-A-403.

ALTERNATES

012300 - 1

- C. Alternate No. 102 (Farley ES): Remove existing 12"x12" concealed spline ceiling, provide new ACT and reinstall lighting.
- D. Alternate No. 104 (Farley ES): Contractor to install one swing set and two add a swing kits with location to be determined in the field by owner. Swing set to be ADA GameTime – Powerscape Swing model number 81598. Add A Bay to be ADA Gametime – Powerscape Swing Add A Bay model number 81599. Swing set and Add A Bays will be provided to the contractor by the owner.
- E. Alternate No. 105 (Farley ES): Provide ¼" thick solid surface material at all UV's built into case work.
- F. Alternate No. 106 (Farley ES): Provide installation for a new canopy. Canopy to be provided to the contractor by the owner. Canopy model number RC201810IN. Attached cut sheets have been provided for the contractors reference. General Contractor shall include NYS P.E. signed and sealed drawing for footing design.
- G. Alternate No. 200 (Willow Grove ES): Replace existing UV's in location specified on drawings WGES-A-100 and WGES-A-101. See plans for locations. Include an allowance to replace existing heat supply & return piping and insulation for 20 linear feet per each unit ventilator to be replaced.
- H. Alternate No. 201 (Willow Grove ES): Remove and replace cafeteria unit, see mechanical drawings.
- I. Alternate No. 202 (Willow Grove ES): Refurbish existing plenum mounted HVAC unit and provide new access panels and maintenance platforms for AHU-1 and AHU-2.
- J. Alternate No. 203 (Willow Grove ES): Remove existing glass block and install new windows
- K. Alternate No. 204 (Willow Grove ES): Contractor to install one swing set with location to be determined in the field by Owner. Swing set to be GameTime ADA PowerScape 10847. Swing set will be provided to the contractor by the owner.
- L. Alternate No. 205 (Willow Grove ES): Provide ¼" thick solid surface material at all UV's built into case work.
- M. Alternate No. 206 (Willow Grove ES): Provide installation for a new canopy. Canopy to be provided to the contractor by the owner. Canopy model number RC201810IN. Attached cut sheets have been provided for the contractors reference. General Contractor shall include NYS P.E. signed and sealed drawing for footing design.

END OF SECTION 012300

81598 TWO-PLACE SWING

 = INSTALLATION
DETAIL

 = PARTS LIST
REFERENCE

FREESTANDING 81598
ADD-A-BAY 81599

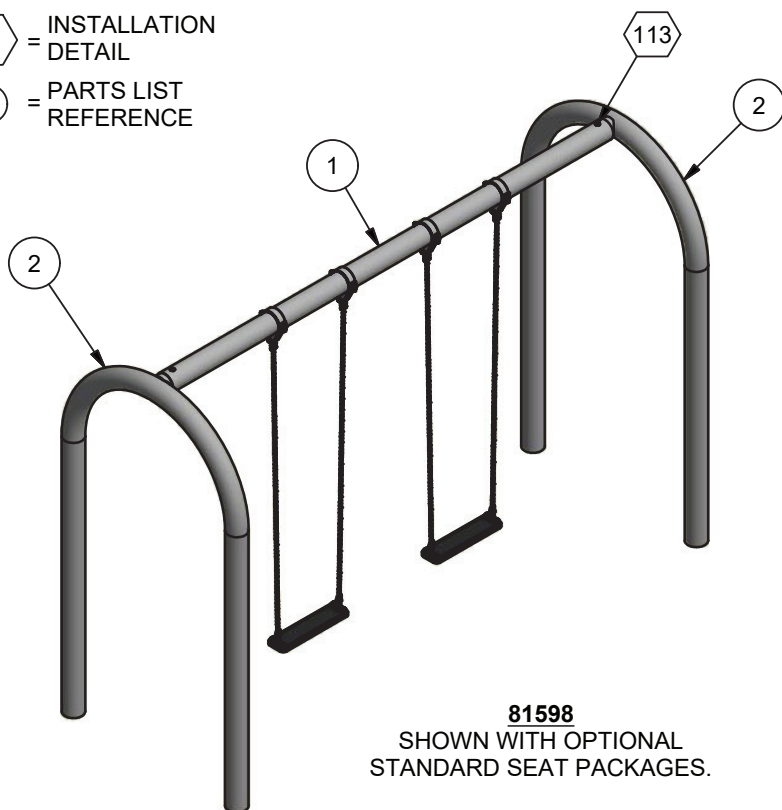

INSTALLATION INSTRUCTIONS

- 1.) Before assembling this equipment, read the enclosed INSTALLER INSTRUCTIONS in the installation booklet; follow all the instructions during installation.
- 2.) Assemble parts as shown in the ASSEMBLY DRAWING. Refer to the assembly details for the specific hardware required in each connection.

ASSEMBLY DRAWINGS

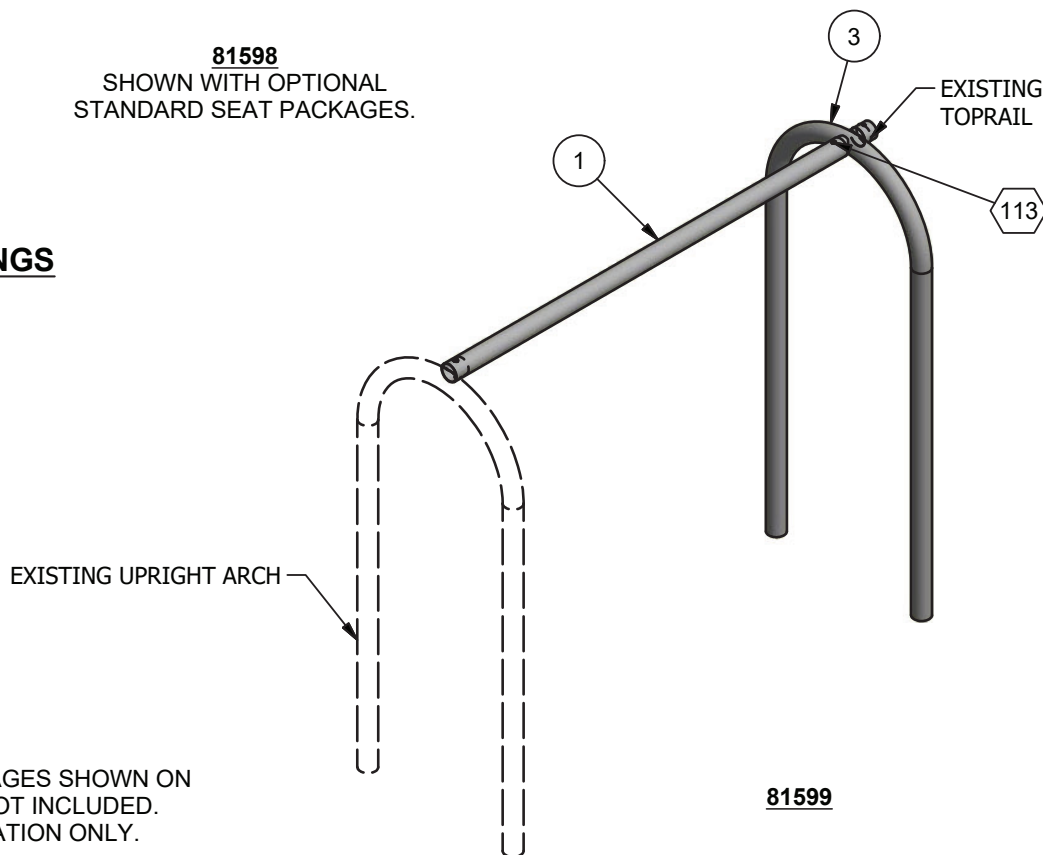

NOTE: SWING SEAT PACKAGES SHOWN ON
ASSEMBLY DRAWING NOT INCLUDED.
SHOWN FOR ILLUSTRATION ONLY.

TOPRAIL DIMENSIONS	
DIM A	2'-8 1/2" [82.55 cm]
DIM B	1'-9" [53.34 cm]
DIM C	2'-1" [62.50 cm]

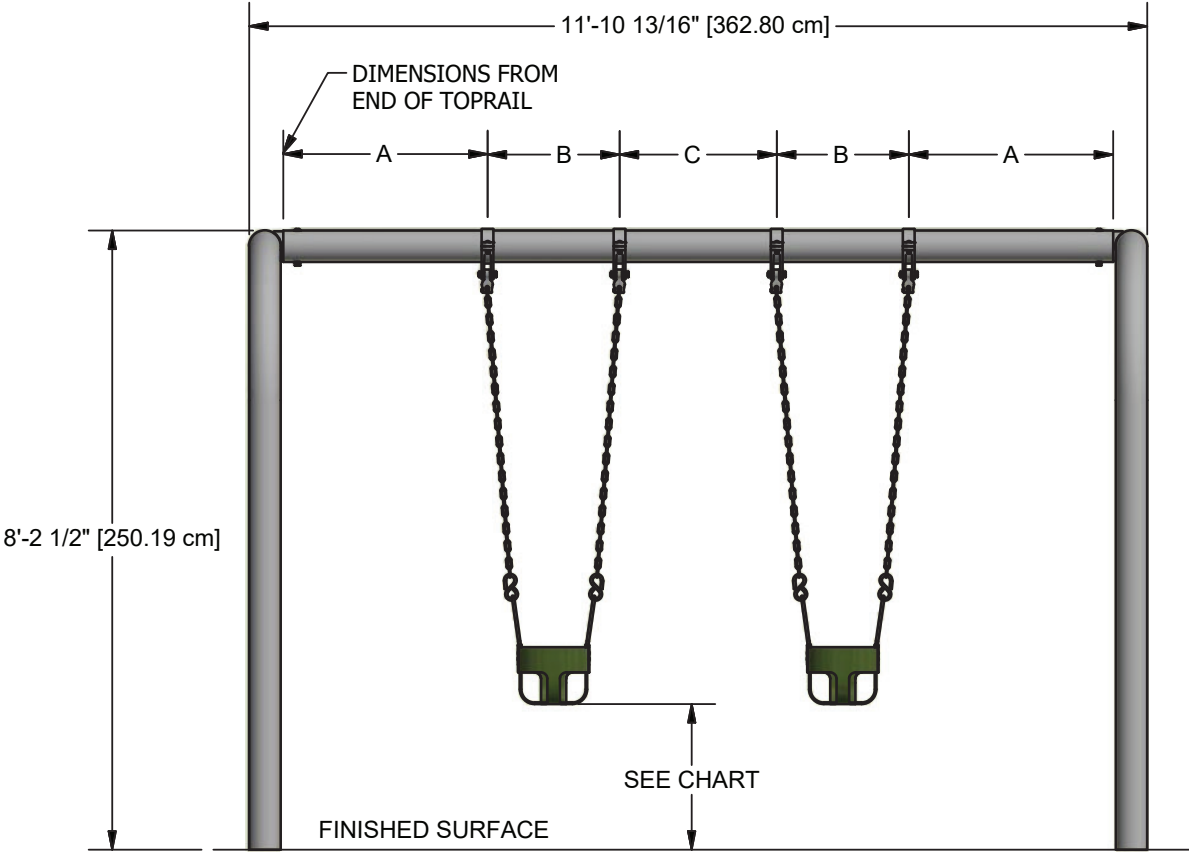

81598 SHOWN (81599 SIMILAR)
WITH OPTIONAL ENCLOSED TOT
SEAT PACKAGES (NOT INCLUDED)

DIMENSION FROM UNDERSIDE OF SEAT TO PROTECTIVE SURFACING		
STANDARD	MIN.	MAX.
CANADIAN	BELT & SUPER SEAT - 300mm [11.81"] ENCLOSED TOT SEAT - 600mm [23.62"]	N/A
ASTM	BELT & SUPER SEAT - 12" [305mm] ENCLOSED TOT SEAT - 24" [610mm]	N/A
BS EN	350 mm [13.77"]	N/A
CPSC	BELT & SUPER SEAT - 12" [305mm] ENCLOSED TOT SEAT - 24" [610mm]	N/A

MEASURED WHEN OCCUPIED BY MAXIMUM USERS

TOPRAIL DIMENSIONS	
DIM A	2'-4 5/8" [72.76 cm]
DIM B	1'-11 1/2" [59.69 cm]
DIM C	2'-3 11/16" [70.38 cm]

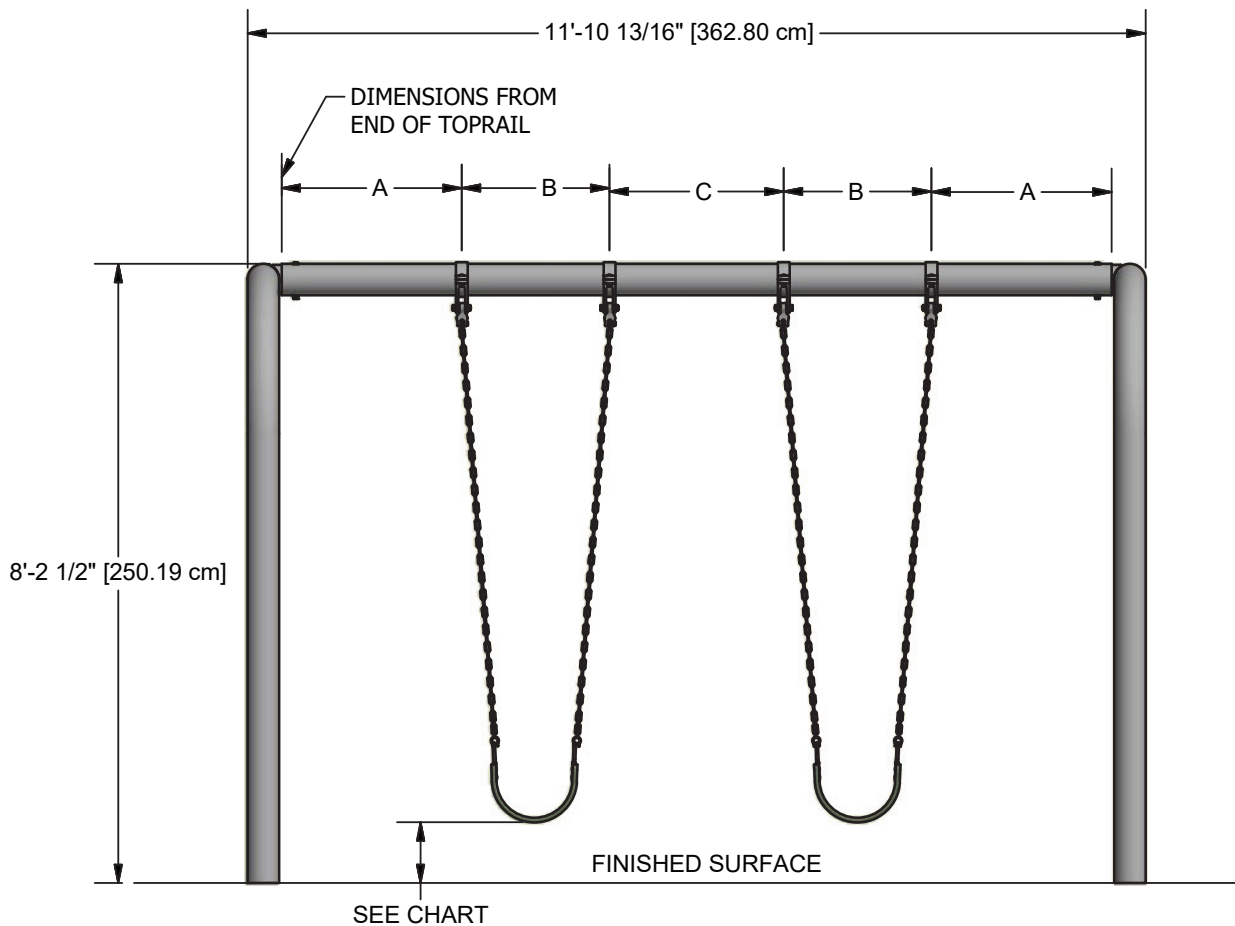

81598 SHOWN (81599 SIMILAR)
WITH OPTIONAL STANDARD
SEAT PACKAGES (NOT INCLUDED)

DIMENSION FROM UNDERSIDE OF SEAT TO PROTECTIVE SURFACING		
STANDARD	MIN.	MAX.
CANADIAN	BELT & SUPER SEAT - 300mm [11.81"] ENCLOSED TOT SEAT - 600mm [23.62"]	N/A
ASTM	BELT & SUPER SEAT - 12" [305mm] ENCLOSED TOT SEAT - 24" [610mm]	N/A
BS EN	350 mm [13.77"]	N/A
CPSC	BELT & SUPER SEAT - 12" [305mm] ENCLOSED TOT SEAT - 24" [610mm]	N/A

MEASURED WHEN OCCUPIED BY MAXIMUM USERS

Parts List				
ITEM	DESCRIPTION	81598	81599	PART NUMBER
1	TOPRAIL	1	1	208808
2	ARCH END UPRIGHT ASSEMBLY	2	0	147006
3	MULTI-BAY ARCH UPRIGHT ASSEMBLY	0	1	147009
	HARDWARE COMPLETE	1	1	147013
	1/2" x 5 1/2" B.H.C.S.	2	2	811071*
	1/2" LOCKWASHER	4	4	817342*
	1/2" HEX NUT	2	2	804055*

Unless Otherwise Specified, All Units of Measure are Each

* Included in Hardware

Warning: During Installation, Hardware And Small Parts Are Choking Hazards For Young Children. Store Unused Parts Appropriately Until Assembly Is Completed. Once Assembly Is Completed, Remove Any Unused Parts From The Play Environment And Dispose/Save Them In A Secure Location.

Note: Peen Tee-Nuts and Flatwashers to match radius of pipe after assembly is complete.

Note: Loctite (supplied by others) should be used on any non-patch hardware.

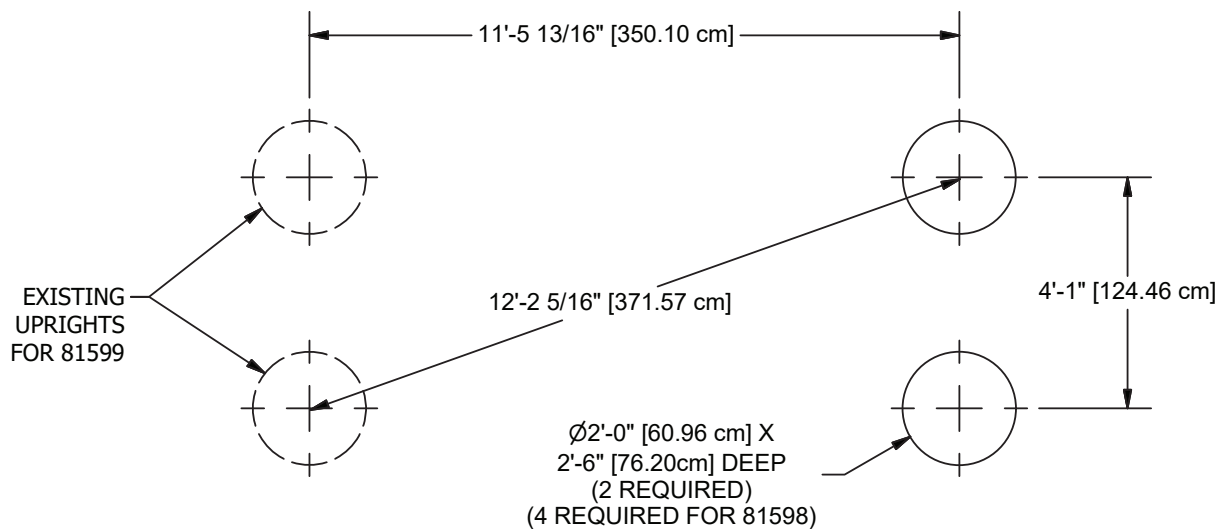

GROUND PLAN

NOTE: HOLE DEPTHS INDICATED ON ALL GROUND PLANS ARE MEASURED FROM THE FINISHED SURFACE. SEE DETAIL 005. ALL FOOTING DIMENSIONS ARE BASED ON LEVEL FINISHED SURFACE.

CONCRETE REQUIRED -81598
.68 CUBIC YARDS
[.52 CUBIC METERS]

CONCRETE REQUIRED - 81599
.34 CUBIC YARDS
[.26 CUBIC METERS]

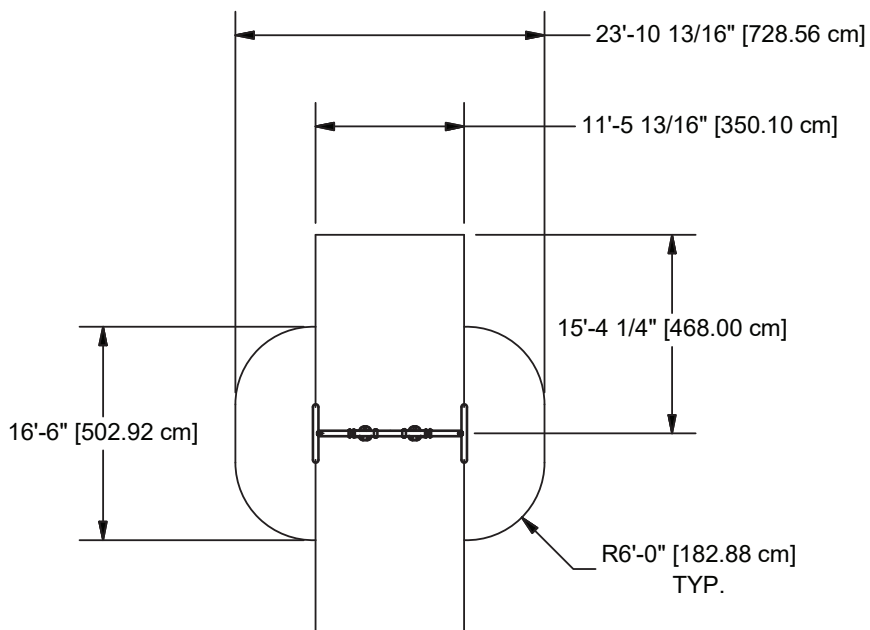

TOP VIEWS

81598

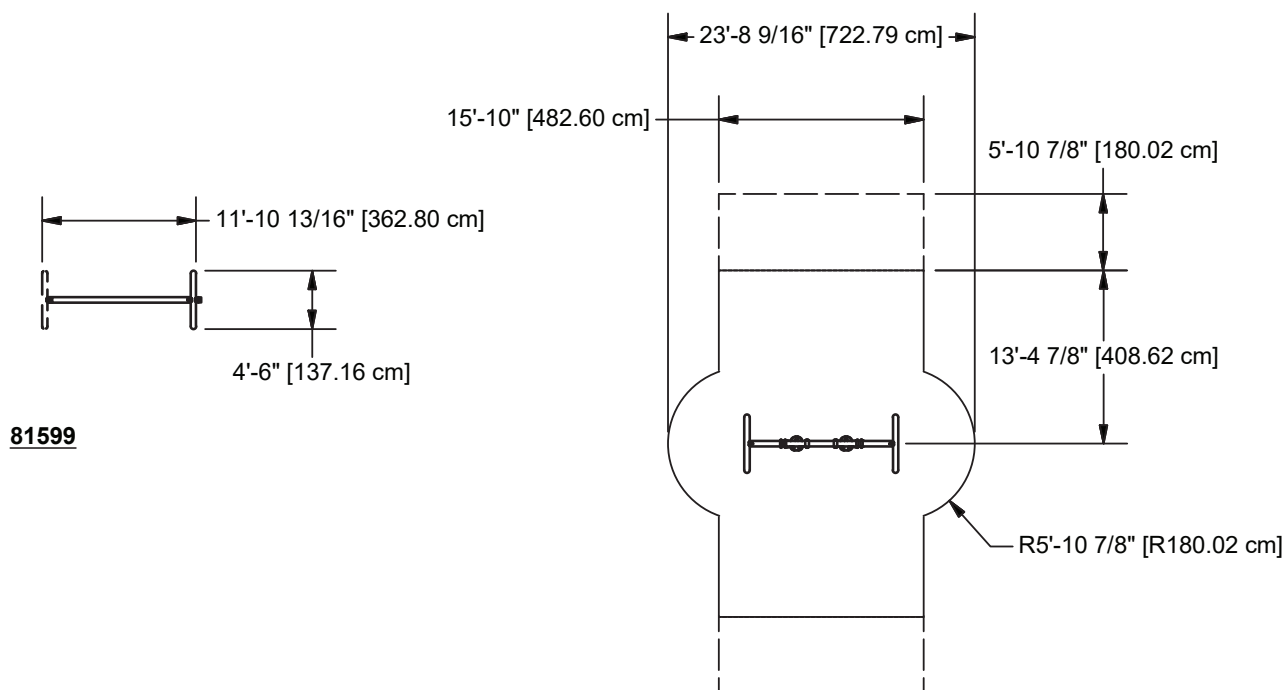

81598 (CSA ONLY)

NOTE:

1. OWNER/OPERATOR SHALL INSTALL AND MAINTAIN PROTECTIVE SURFACING WITHIN THE USE ZONE (U.S.) OR PROTECTIVE SURFACING ZONE (CANADA) OF ALL PLAY EQUIPMENT TO COMPLY WITH ASTM F-1292 AND ASTM F-1487 (U.S.) or CAN/CSA-Z-614 (CANADA).
2. SOLID OUTSIDE BORDER REPRESENTS MINIMUM REQUIRED ASTM USE ZONE AND CSA PROTECTIVE SURFACING ZONE FOR SWING FRAME SHOWN.
3. DASHED LINES REPRESENT CSA *NO ENCROACHMENT* ZONE (CANADA ONLY).
4. *EACH ADDITIONAL CONNECTED SWING FRAME BAY INCREASES THE USE ZONE SURFACING, AND *NO ENCROACHMENT* ZONE DIMENSIONS BY 11'-5 13/16" [3.79M].

DETAILS -for- 81598 & 81599

IMPORTANT

TO REDUCE THE RISK OF CLOTHING ENTANGLEMENT IN COMPLIANCE WITH ASTM F1487, ANY BOLT END PROTRUDING MORE THAN TWO FULL THREADS BEYOND THE FACE OF THE NUT SHALL BE CUT-OFF FLUSH, FILED SMOOTH AND TREATED TO PREVENT CORROSION.

NOTE: LOCTITE (SUPPLIED BY OTHERS) SHOULD BE USED ON ALL THREADED HARDWARE.

NOTE: AFTER ASSEMBLY IS COMPLETE, PEEN TEE-NUTS AND FLATWASHERS TO MATCH RADIUS OF PIPE.

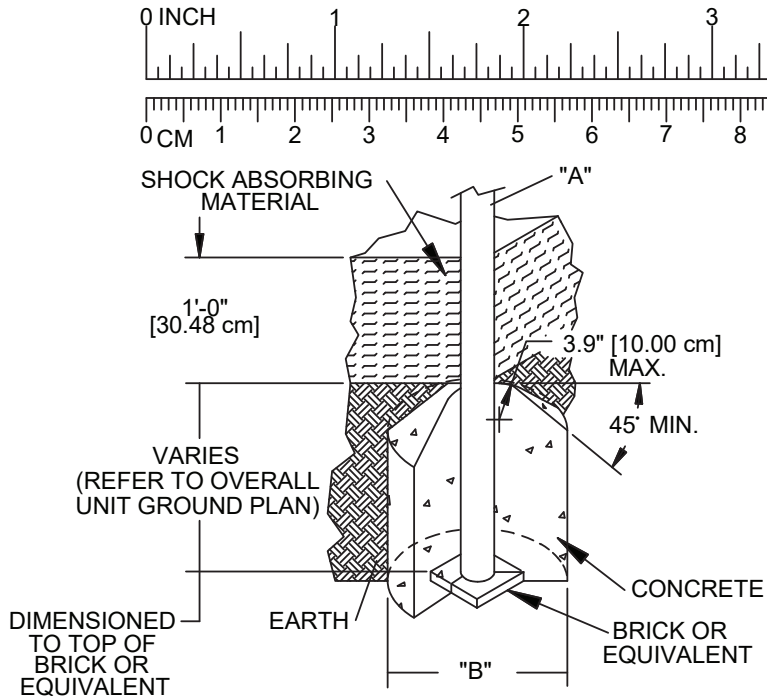

DIA. "A" (PIPE SIZE)	DIA. "B" (FOOTING SIZE)
1 1/16" [2.70 cm]	1'-2" [35.56 cm]
1 5/16" [3.33 cm]	1'-2" [35.56 cm]
1 5/8" [4.13 cm]	1'-2" [35.56 cm]
1 7/8" [4.83 cm]	1'-2" [35.56 cm]
2 3/8" [6.03 cm]	1'-2" [35.56 cm]
3 1/2" [8.89 cm]	1'-6" [45.72 cm]
ARCH SWING	
5" [12.70 cm]	2'-0" [60.96 cm]

NOTES:

- SLOPED FOOTING IS A REQUIREMENT OF EUROPEAN STANDARD EN1176-1 ONLY
- SUGGESTED MINIMUM CONCRETE RATING: 3000 PSI

005

SHOCK ABSORBING PROPERTIES OF SURFACING MATERIALS VARY. IF YOU DETERMINE THAT LESS THAN 1'-0" [30.48cm] OF SURFACING IS REQUIRED, MAKE UP THE DIFFERENCE IN ELEVATION WITH EARTH, BEFORE APPLYING SURFACING.

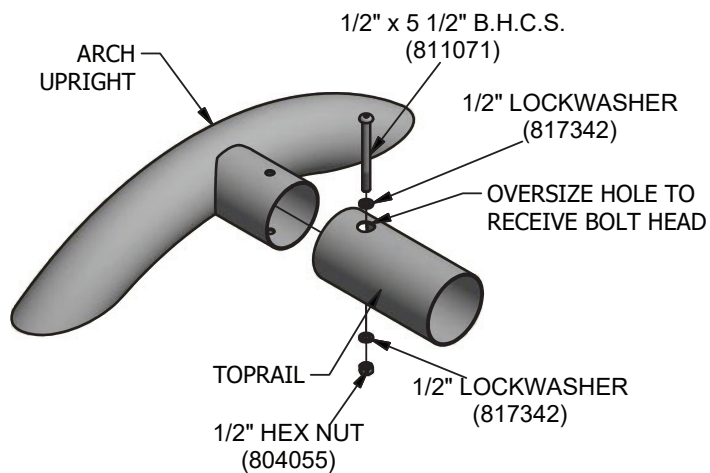

113



PowerScape Swing

PowerScape Swing Frame holds up to two swing seats per bay. PowerScape products are designed for maximum durability, making this the perfect swing set for schools, parks, and other large youth organizations with high volume play. Swing seats are sold separately.

FEATURES AND BENEFITS:

- ❑ PowerScape Line is designed for maximum durability compared to competing play systems
- ❑ Promotes social interaction and processing sensory information
- ❑ Increases spatial awareness and helps develop gross and fine motor skills
- ❑ Enhances core strength

SPECIFICATIONS

Model 81598

Number:

Fall Height: 8' (2.44 m)

Use Zone: 31'-0" x 24'-0"
(9.45m x 7.31m)

GameTime offers a limited lifetime warranty on uprights, hardware, and connections. Visit gametime.com/warranty for full warranty information.



PowerScape Swing Add-A-Bay

Our PowerScape Swing holds two swing seats per bay. It complements virtually any style, theme, or design. Swing seats are sold separately.

FEATURES AND BENEFITS:

- ☐ Creates soothing vestibular movement
- ☐ Highly customizable
- ☐ Compliments any theme
- ☐ Constructed with durable materials

SPECIFICATIONS

Model 81599
Number:

Fall Height: 8' (2.44 m)

Use Zone: 31'-0" x 23'-0"
 (9.45m x 7.01m)

GameTime offers a limited lifetime warranty on uprights, hardware, and connections. Visit gametime.com/warranty for full warranty information.

CANTILEVER/ CAR PARKING SHADE

20' x 18' x 10'

MODEL #:

RC201810IG (With Glide Elbows)

RC201810IN (Without Glide Elbows)

REF.#	PART DESCRIPTION	QTY.
1	5" Sq. Surface Mount Column x1/4"	4
2	4" x 6" Beam With Platform Caps x1/4"	2
3	Ø2 7/8" Angled Elbow x11. ga	4
4	Ø2 7/8" Hip Rafter w/ Swaged End	4
5	Ø2 7/8" Ridge Pole w/ Swaged Ends	1
6	Ø2 7/8" Rectangle "Y" Connection	2
7	Fabric Cover With Cable Insert	1
8	Frame Hardware Kit	1

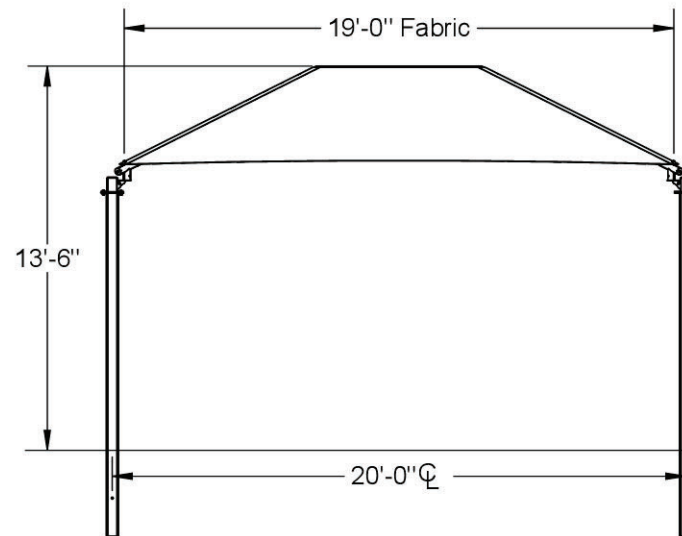

FRONT ELEVATION

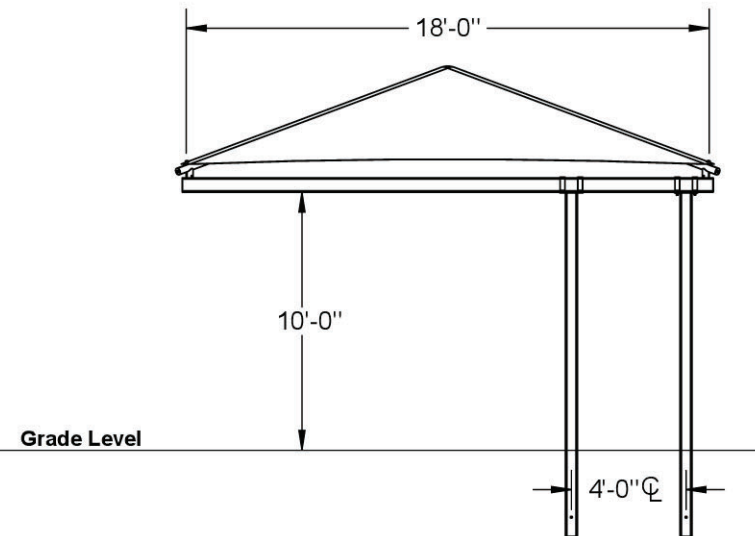

END ELEVATION

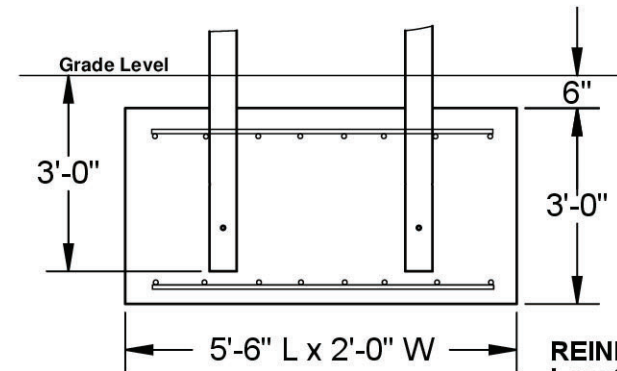
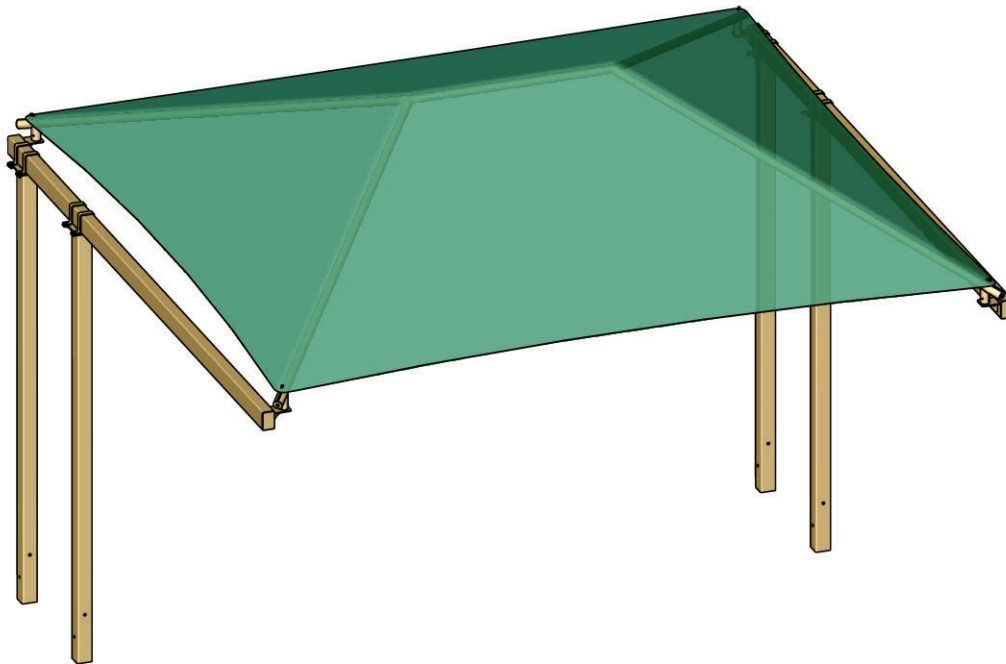

FOOTING DETAIL

*Footing design based on 1500 PSF soil bearing pressure.

REINF:
Length: (2)#5 x 60"
Width: (7)#5 x 18"

These drawings are for reference only and should not be used as construction details. Materials, fasteners, and foundations are subject to change if professionally sealed engineering drawings are required. Designed for 93 MPH Basic Wind Speed.