

ROOF FRAMING NOTES

- ALL EXISTING FRAMING CONDITIONS TO BE VERIFIED IN FIELD. EXISTING STEEL TO BE CHECKED BY ENGINEER OF RECORD FOLLOWING VERIFICATION OF EXISTING STEEL SIZES, SPANS, SPACING AND HVAC UNIT WEIGHT.
- ROOFTOP UNIT WEIGHTS IF SHOWN SHALL BE VERIFIED WITH MANUFACTURER BY CONTRACTOR. CONTRACTOR TO NOTIFY ENGINEER PRIOR TO INSTALLING ROOFTOP UNITS IF UNIT OPERATING WEIGHT EXCEEDS VALUE LISTED ON PLAN.
- REFER TO ARCHITECTURAL, MECHANICAL, ELECTRICAL, AND PLUMBING DRAWINGS FOR PENETRATIONS NOT SHOWN, AND ALL LOCATIONS SEE TYPICAL DETAILS FOR ADDITIONAL REINFORCEMENT REQUIREMENTS AT OPENINGS. CONTRACTOR TO COORDINATE.

KEY PLAN:

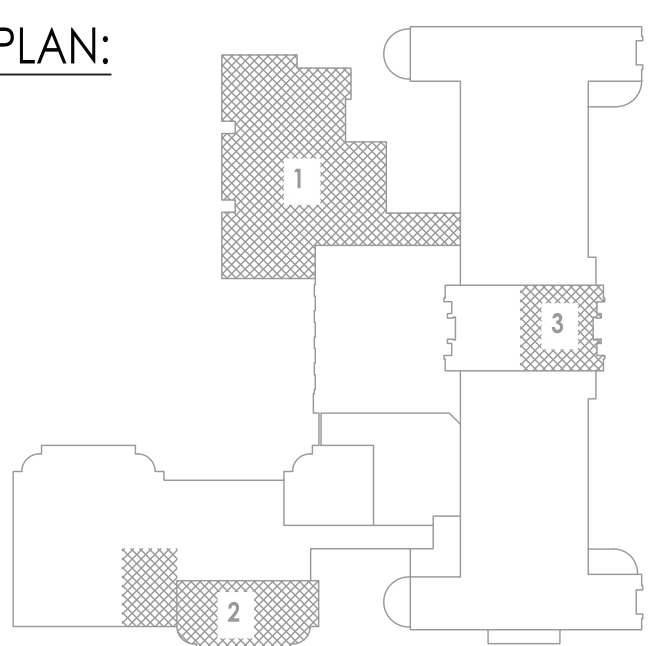

PROJECT INFORMATION

Project Number  
1428.20

Client Name

OSSINING UNION FREE SCHOOL  
DISTRICT

Project Name

2022-2023 CIP

District Office Address

22 EDWARD ST. OSSINING, NY 10562

OSSINING

PARK ELEVATORY SED# 86-14-01-03-0-034-024

PROJECT ISSUE & REVISION SCHEDULE

REV	DATE	DESCRIPTION
1	9/22/2023	ADDENDUM #1

PROFESSIONAL STAMPS

NEW YORK STATE EDUCATION STATEMENT

I, the undersigned, being a duly qualified and licensed professional engineer, hereby certify that the design and construction of the above described project has been completed in accordance with the provisions of the New York State Education Law and the Regulations of the Board of Education, and that the design and construction of the above described project has been completed in accordance with the provisions of the New York State Education Law and the Regulations of the Board of Education, and that the design and construction of the above described project has been completed in accordance with the provisions of the New York State Education Law and the Regulations of the Board of Education.

SHEET INFORMATION

Issued 08/14/23 Scale DRAWING SCALE

Project Status

BID SET

Drawn By

CLM

Drawing Title

RTU STRUCTURAL  
MODIFICATIONS

Drawing Number

PES  
S203