

1 STUDENT UNION BUILDING SOUTH END LOWER LEVEL ELEVATOR PART PLAN  
SCALE: 1/32"=1'-0"

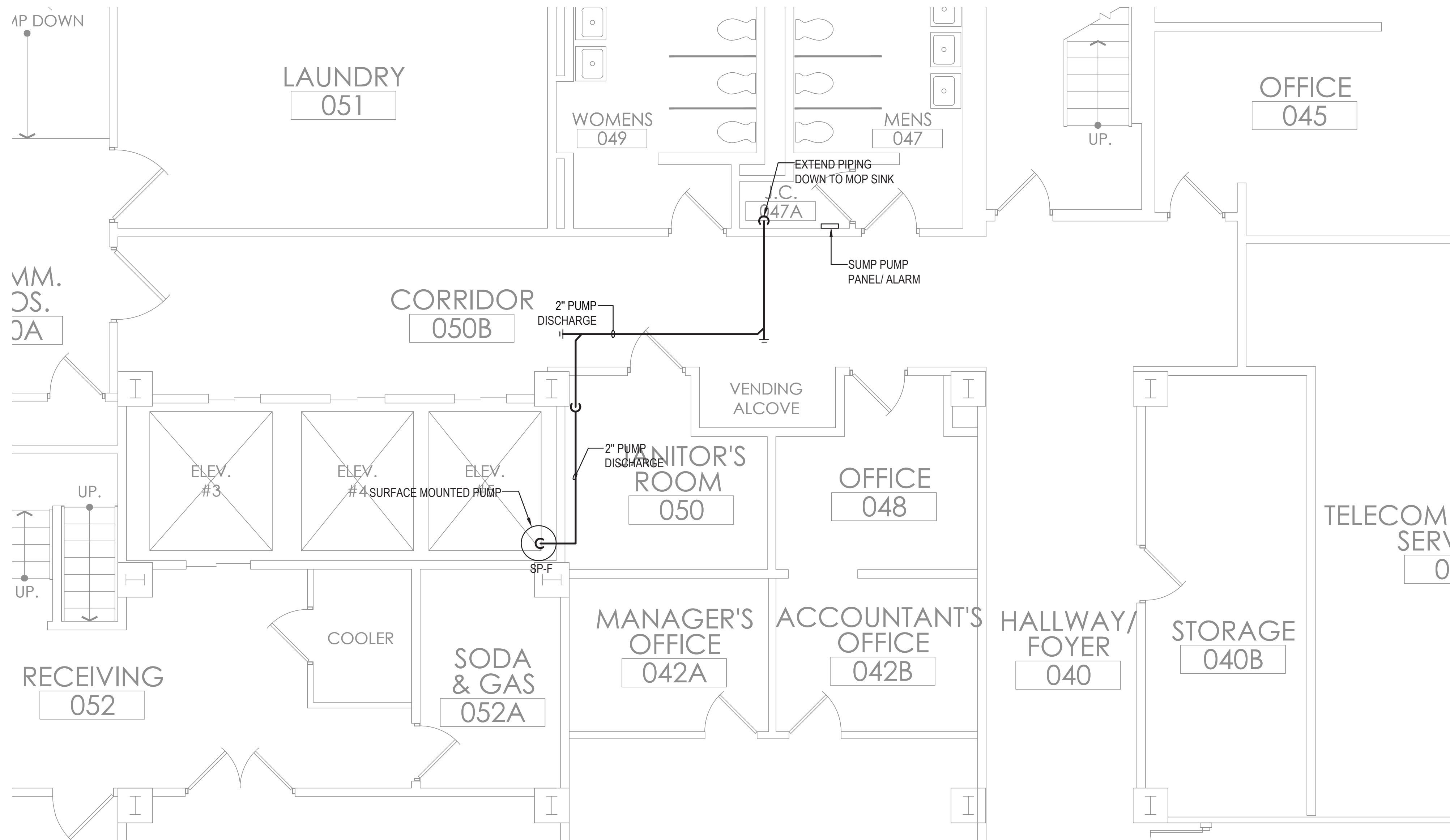

2 PLUMBING - STUDENT UNION BUILDING SOUTH END LOWER LEVEL PART PLAN  
SCALE: 1/4"=1'-0"



CONSULTANTS:



MOSZERBATY ASSOCIATES ARCHITECTURE  
307 7th AVENUE 15th FLOOR  
NEW YORK, NY 10001  
TEL: 212.352.3307



IAQ SYSTEMS INC., CONSULTING  
ENGINEERS  
355 8th AVENUE, SUITE 1502  
NEW YORK, NY 10018  
TEL: 212.680.8345



VDA  
145 WEST 30TH STREET, 4TH FLOOR  
NEW YORK, NY 10001  
TEL: 212.868.9090

10/03/2022 ISSUED FOR BID

Facility:  
SUNY NEW PALTZ  
Building Address:  
1 HAWK DRIVE, NEW PALTZ, NY 12561  
Building:  
SOJOURNER TRUTH LIBRARY,  
LECTURE CENTER,  
COYKENDALL SCIENCE BUILDING,  
SMILEY ARTS BUILDING,  
HAGGERTY ADMINISTRATION BUILDING,  
STUDENT UNION  
County of: Project No.:  
ULSTER 081058-00

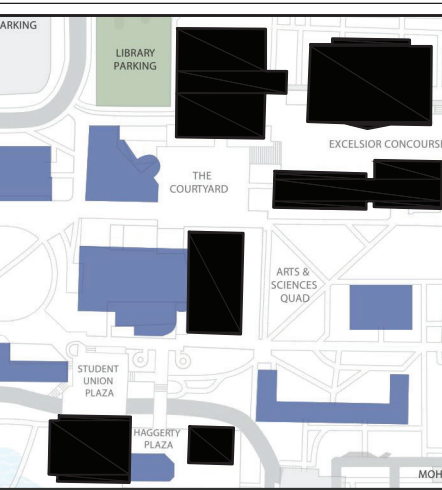

Key/Location Plan

Contract Title:  
UPGRADE ELEVATORS CAMPUS WIDE -  
SOJOURNER TRUTH LIBRARY, LECTURE  
CENTER, COYKENDALL SCIENCE  
BUILDING, SMILEY ARTS BUILDING,  
HAGGERTY ADMINISTRATION BUILDING,  
AND STUDENT UNION

Project No.: 081058-00

Drawing Title:  
PLUMBING- STUDENT UNION BUILDING  
LOWER LEVEL CONSTRUCTION PART  
PLAN

Seal & Signature:



Drawn By: -  
Checked By: SAI BARADE P.E.  
Date: SEPTEMBER 15, 2022  
Scale: AS NOTED

Drawing No.:

SUB-P101.00

Sheet 134 of 159