

- NOTES:
- CONTRACTOR SHALL INSTALL 1/2" PRE-FORMED EXPANSION JOINT MATERIAL AND JOINT SEALER WHERE PAVEMENT ABUTS BUILDING OR OTHER RIGID PAVEMENT.

D1 CONCRETE WALK
N.T.S.

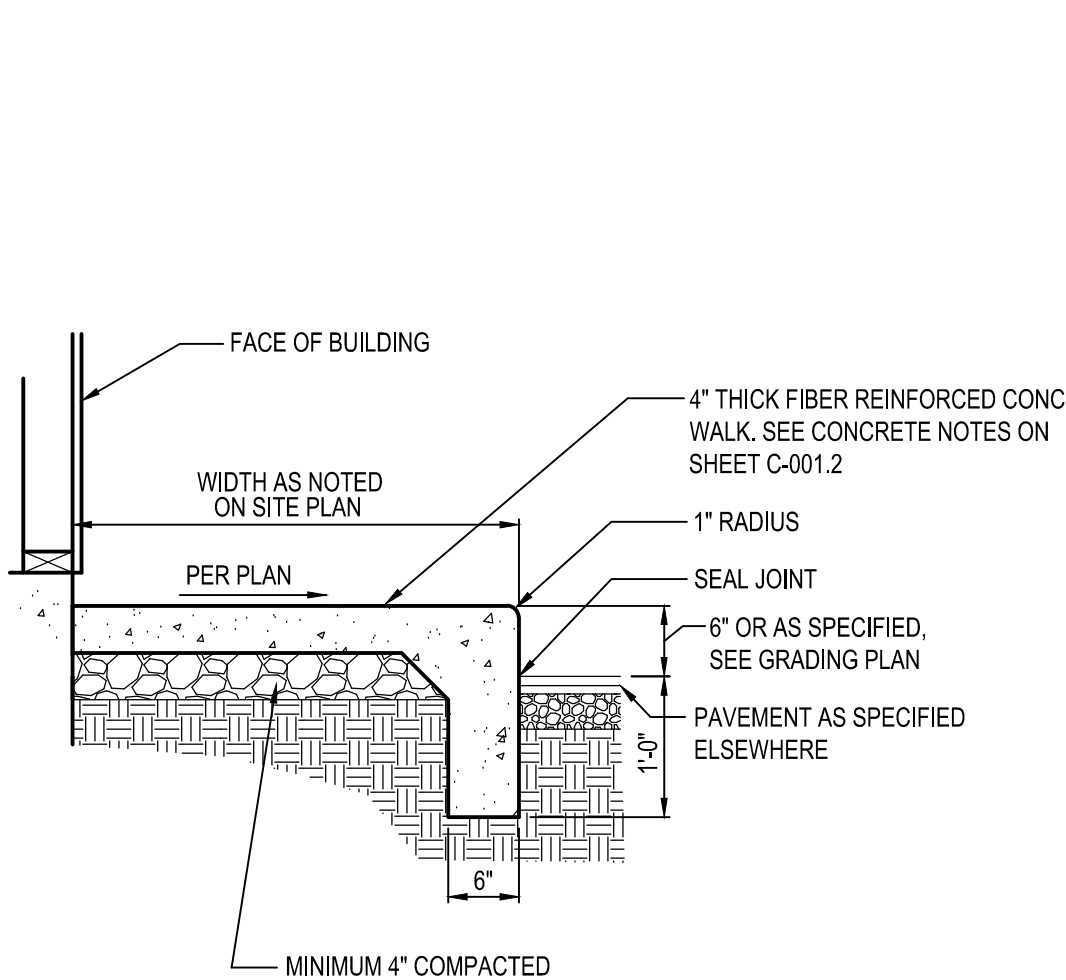

- NOTES:
- CONTRACTOR SHALL INSTALL 1/2" PRE-FORMED EXPANSION JOINT MATERIAL AND JOINT SEALER WHERE PAVEMENT ABUTS BUILDING.

D2 CONCRETE CURBED WALK
N.T.S.

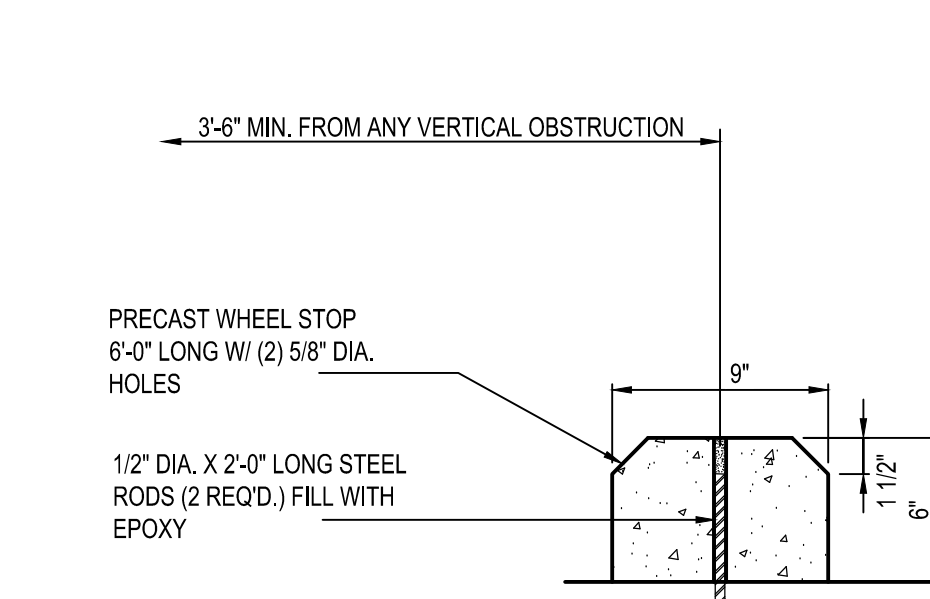

- NOTE:
- SEE SITE PLAN FOR LOCATION AND QUANTITY OF WHEELSTOPS.
 - WHEN APPLICABLE IN CONCRETE PAVEMENTS, WHEEL STOPS SHALL BE ANCHORED TO CONCRETE WITH HD#14" DROP-IN ANCHORS, 1" EMBEDMENT W/ 1/4" THREADED ROD.

C1 CONCRETE WHEELSTOP
N.T.S.

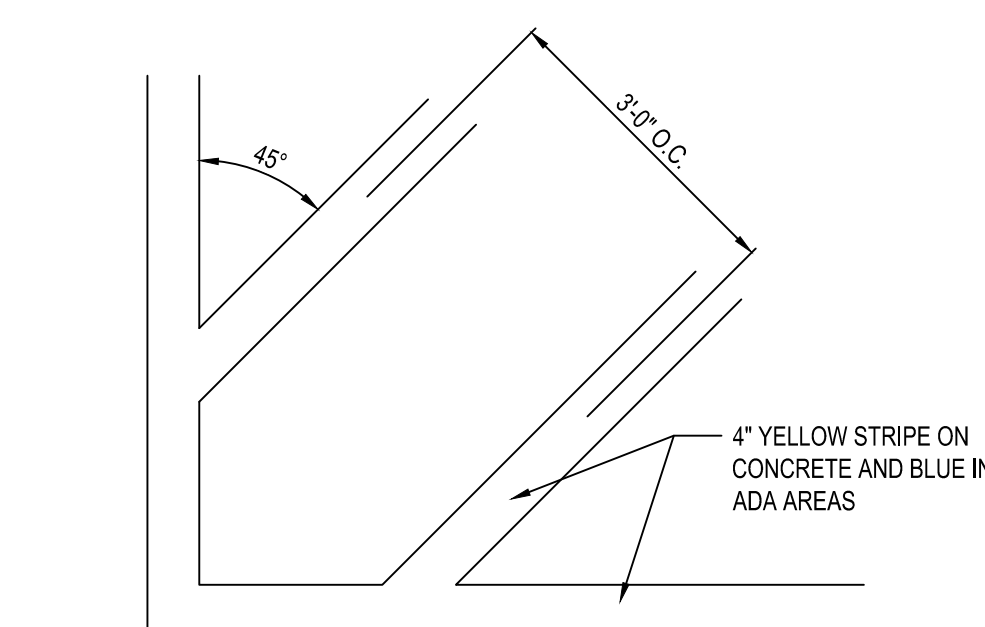

C2 PAINTED TRANSVERSE STRIPING
N.T.S.

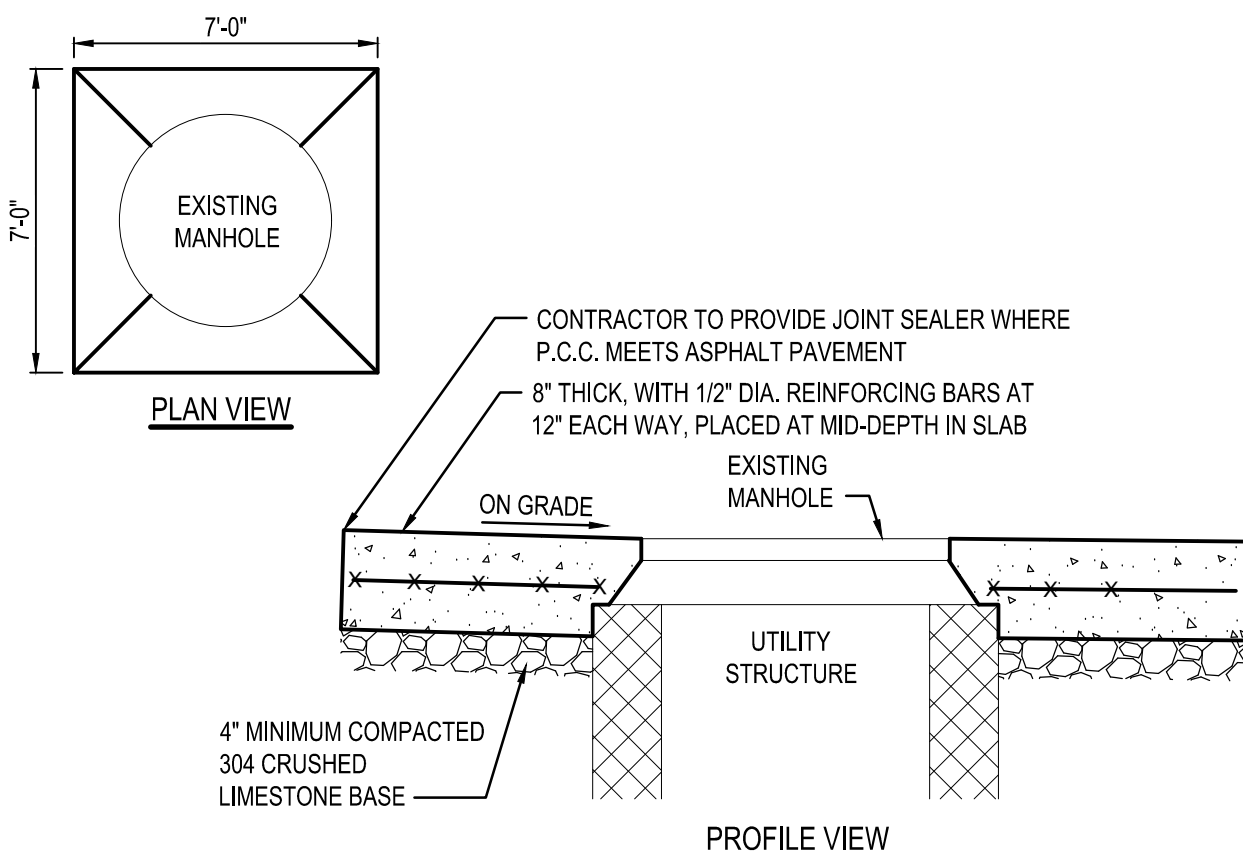

B1 UTILITY CONCRETE APRON
N.T.S.

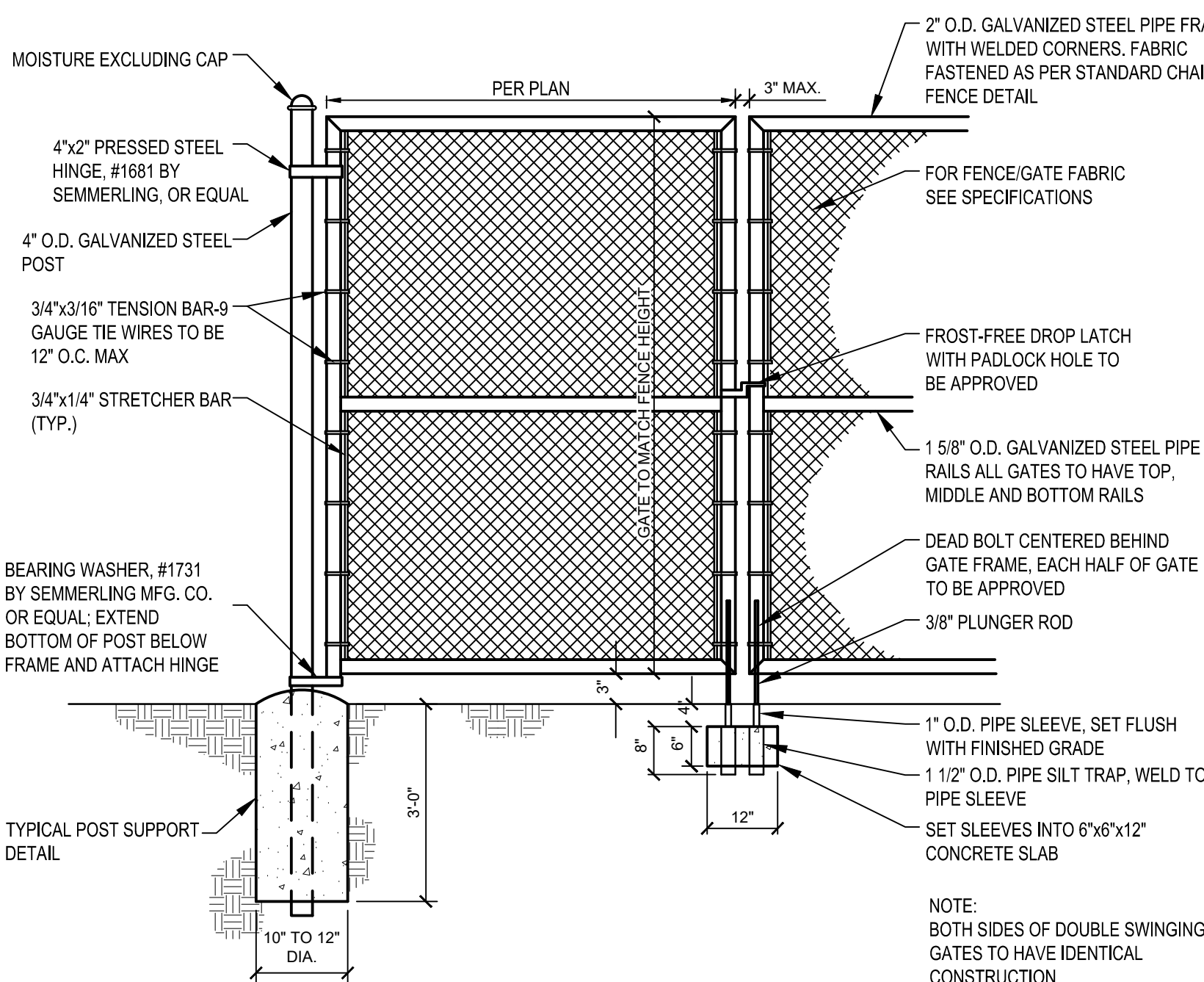

A1 DOUBLE GATE CHAIN LINK FENCE DETAIL
N.T.S.

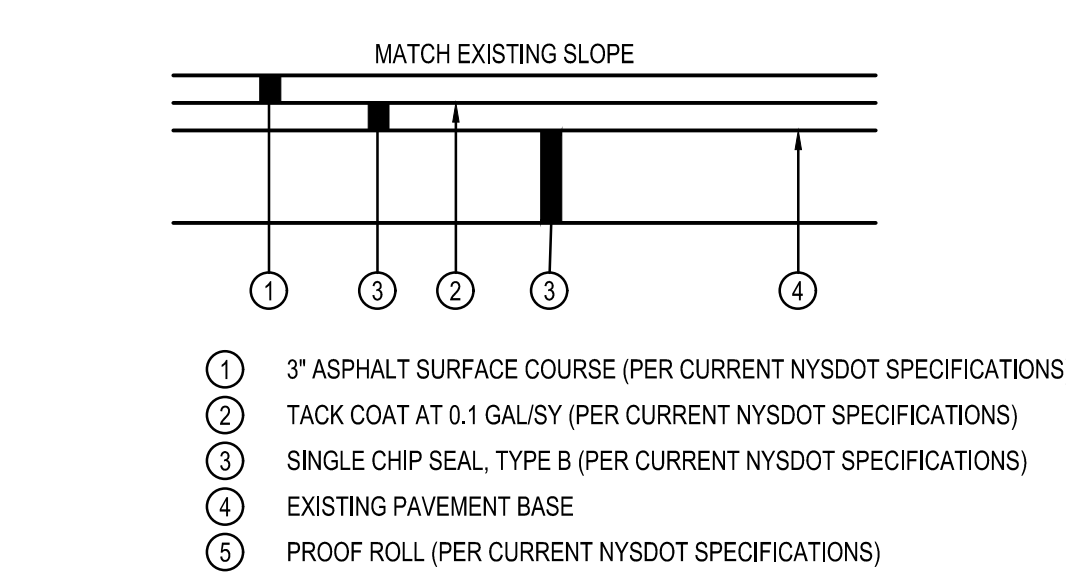

- NOTES:
- CONTRACTOR SHALL MILL DOWN EXISTING ASPHALT PAVEMENT 3" PER CURRENT NYSDOT SPECIFICATIONS BEFORE CONSTRUCTION OF RESURFACED TYPICAL SECTION.
 - PREPARED BASE SURFACE SHALL BE CLEAN AND FREE OF ANY LOOSE DEBRIS.
 - USE AIR COMPRESSOR (100 PSI MIN.) TO THOROUGHLY CLEAN ALL CRACKS PRIOR TO CHIP SEAL. PAVEMENT SHALL BE SWEEPED AFTER CRACKS HAVE BEEN CLEAN OUT.
 - APPLY LIQUID ASPHALT AT ALL JOINTS BETWEEN CONCRETE AND ASPHALT AND WHERE PROPOSED ASPHALT MEETS EXISTING ASPHALT INCLUDING SAW CUT JOINTS PER CURRENT NYSDOT SPECIFICATIONS
 - CONTRACTOR SHALL MILL ALL PAVEMENT EDGES TO PROVIDE SMOOTH BUTT JOINT TRANSITIONS TO EXISTING PAVEMENT.
 - NO RECYCLE MATERIAL SHALL BE PERMITTED IN ASPHALT SURFACE COURSE. SHALL BE 100% VIRGIN LIMESTONE MIX.

D3 ASPHALT OVERLAY PAVEMENT SECTION
N.T.S.

- NOTES:
- ALL PAVEMENT MARKINGS TO BE YELLOW PAVEMENT PAINT, UNLESS SPECIFIED OTHERWISE. ALL PAVEMENT MARKINGS WITHIN ADA AREAS SHALL BE PAINTED BLUE EXCEPT FOR COLORS DEFINED ON THE ADA PAVEMENT SYMBOL.
 - MARKING (STRIPING) PAINT FOR PARKING SPACES, TRAFFIC ARROWS, ADA PARKING AND SYMBOLS, ETC., PER LOCAL REQUIREMENTS AND AS FOLLOWS:
 - PAVEMENT MARKINGS SHALL BE PER PAINT SHALL BE WATER BASE FAST DRYING 100% ACRYLIC TYPE: WATER BASE TO MEET FEDERAL SPECIFICATION TTP-019528. FOR COLD WEATHER APPLICATION PAINT PRODUCT SHALL BE IN ACCORDANCE WITH ASTM-D2369, D1394, D3723, D1475, D562 AND D711
 - PROVIDE A NON-SLIP AGGREGATE ADDITIVE TO MARKING PAINT USED AT ADA ACCESS RAMP.
 - APPLY 2 COATS WITH STRAIGHT EDGES. CONTRACTOR SHALL APPLY THE SECOND COAT NO SOONER THAN 30 DAYS OF APPLYING THE FIRST COAT.

C3 PAVEMENT MARKINGS & NOTES
N.T.S.

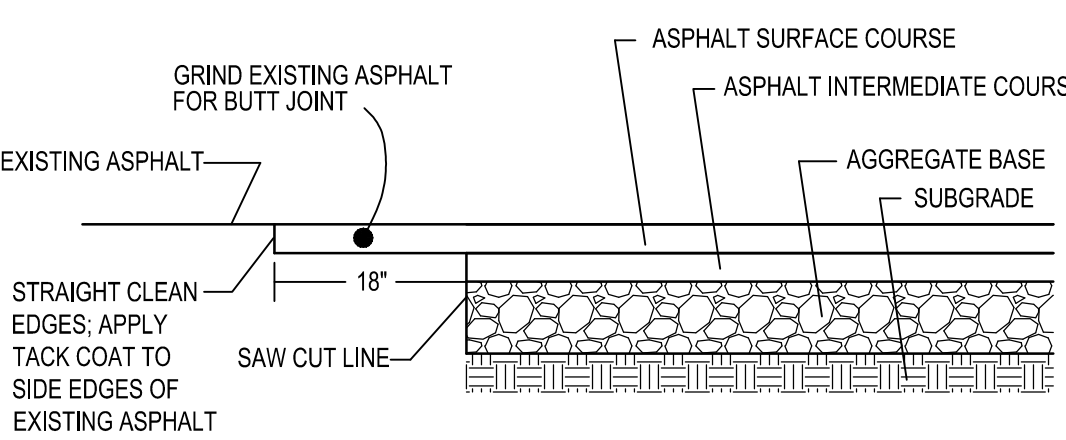

B3 BUTT JOINT
N.T.S.

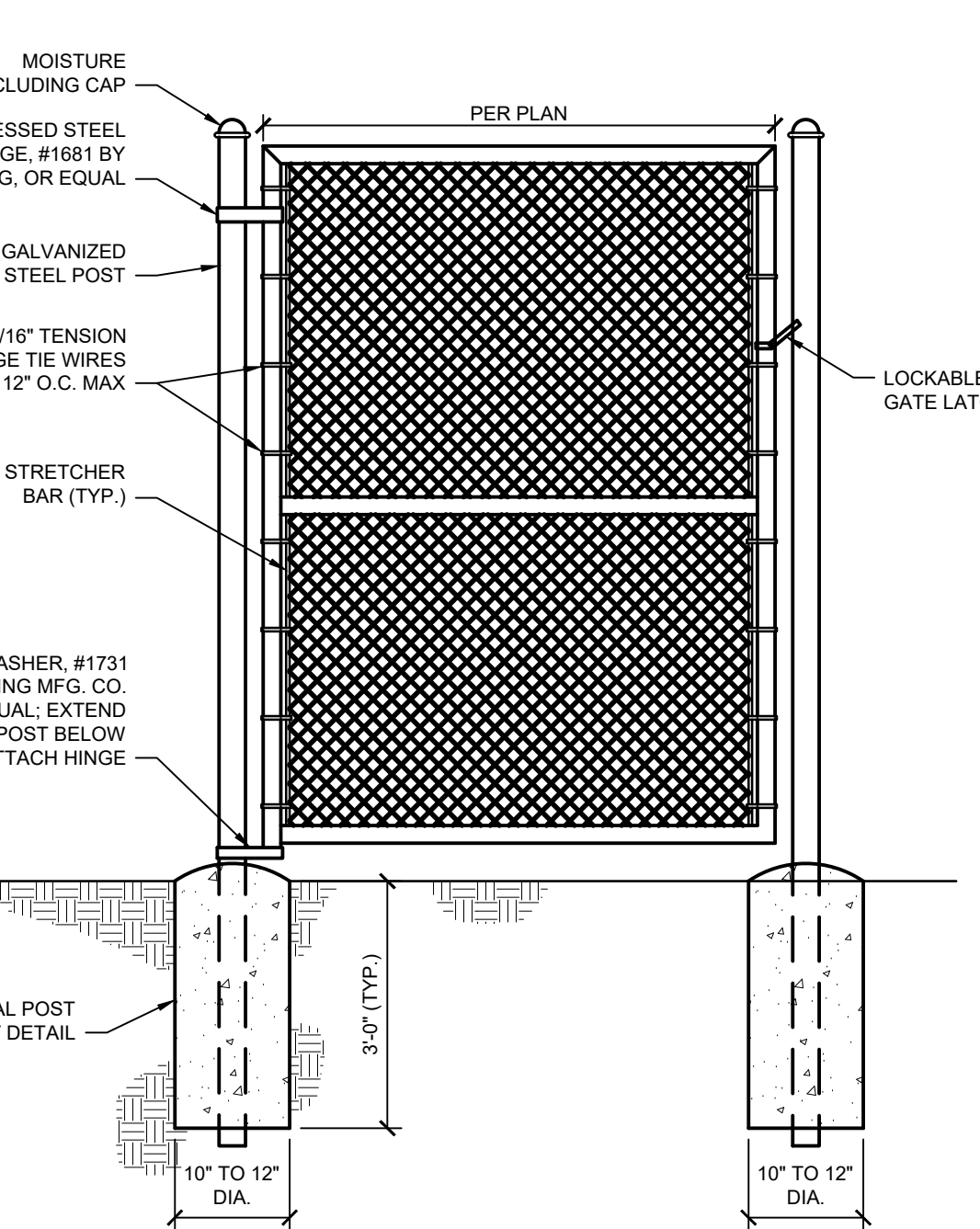

A3 SINGLE GATE CHAIN LINK FENCE DETAIL
N.T.S.

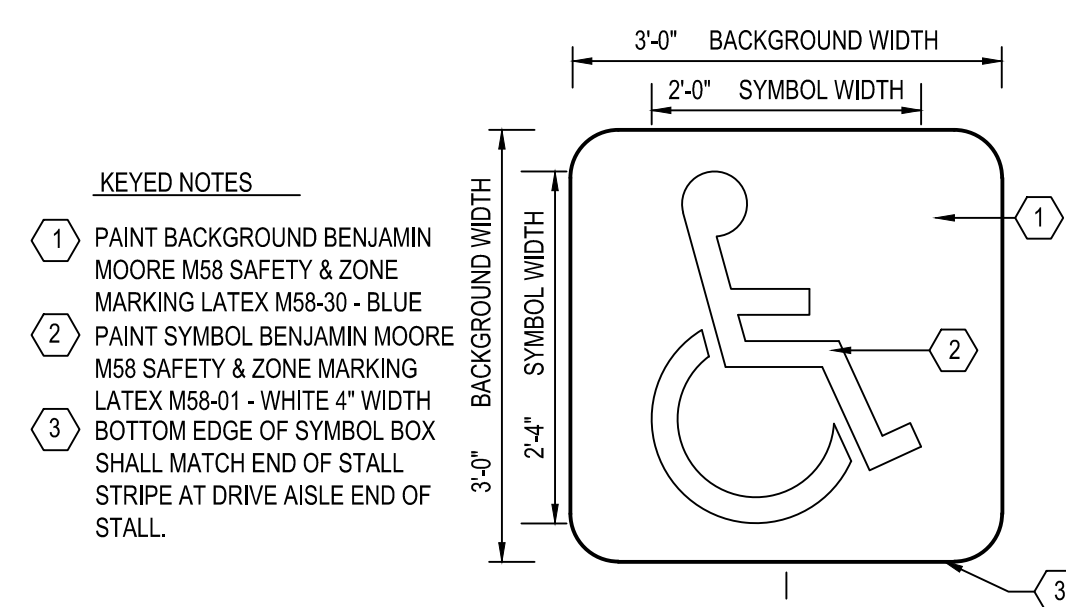

D4 ADA PAVEMENT SYMBOL
N.T.S.

- KEYED NOTES:
- 1.5 INCH ASPHALT SURFACE COURSE (PER CURRENT NYSDOT SPECIFICATIONS)
 - 1.5 INCH ASPHALT INTERMEDIATE COURSE (PER CURRENT NYSDOT SPECIFICATIONS)
 - MIN. 8.0 INCH CRUSHED VIRGIN LIMESTONE AGGREGATE BASE (PER CURRENT NYSDOT SPECIFICATIONS)
 - SUBGRADE COMPACTION (PER CURRENT NYSDOT SPECIFICATIONS)
 - PROOF ROLLING (PER CURRENT NYSDOT SPECIFICATIONS)
 - TACK COAT (PER CURRENT NYSDOT SPECIFICATIONS)

- NOTES:
- APPLY LIQUID ASPHALT AT ALL JOINTS BETWEEN CONCRETE AND ASPHALT AND WHERE PROPOSED ASPHALT MEETS EXISTING ASPHALT INCLUDING SAW CUT JOINTS.
 - SUBGRADE SHALL BE PROPERLY PREPARED WITH SUFFICIENT STRENGTH FOR PAVING OPERATIONS. SEE GEOTECHNICAL ENGINEERING REPORT FOR MORE INFORMATION.
 - NO RAP SHALL BE PERMITTED IN ASPHALT SURFACE COURSE.
 - MAXIMUM 35% RAP IN THE INTERMEDIATE COURSE.

C4 STANDARD DUTY ASPHALT PAVEMENT
N.T.S.

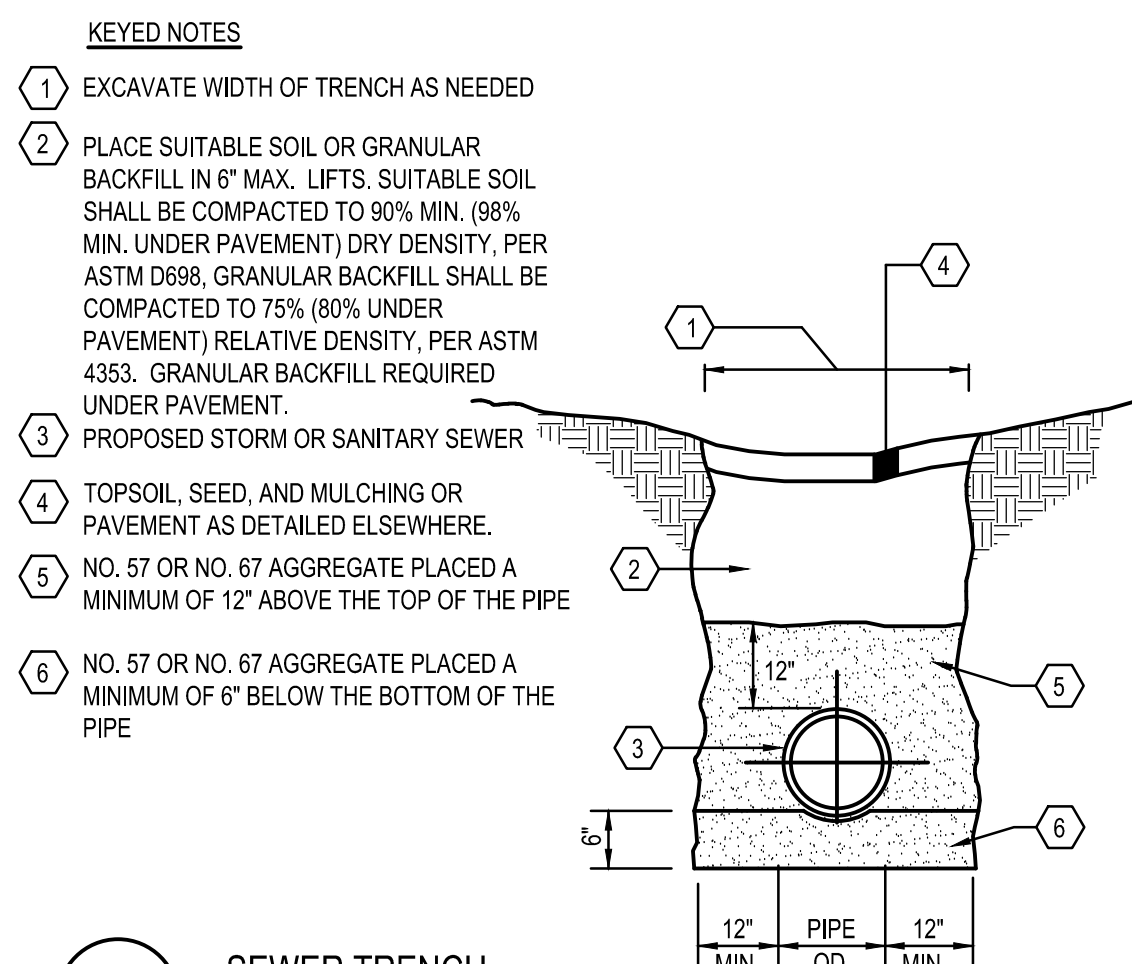

B4 SEWER TRENCH
N.T.S.

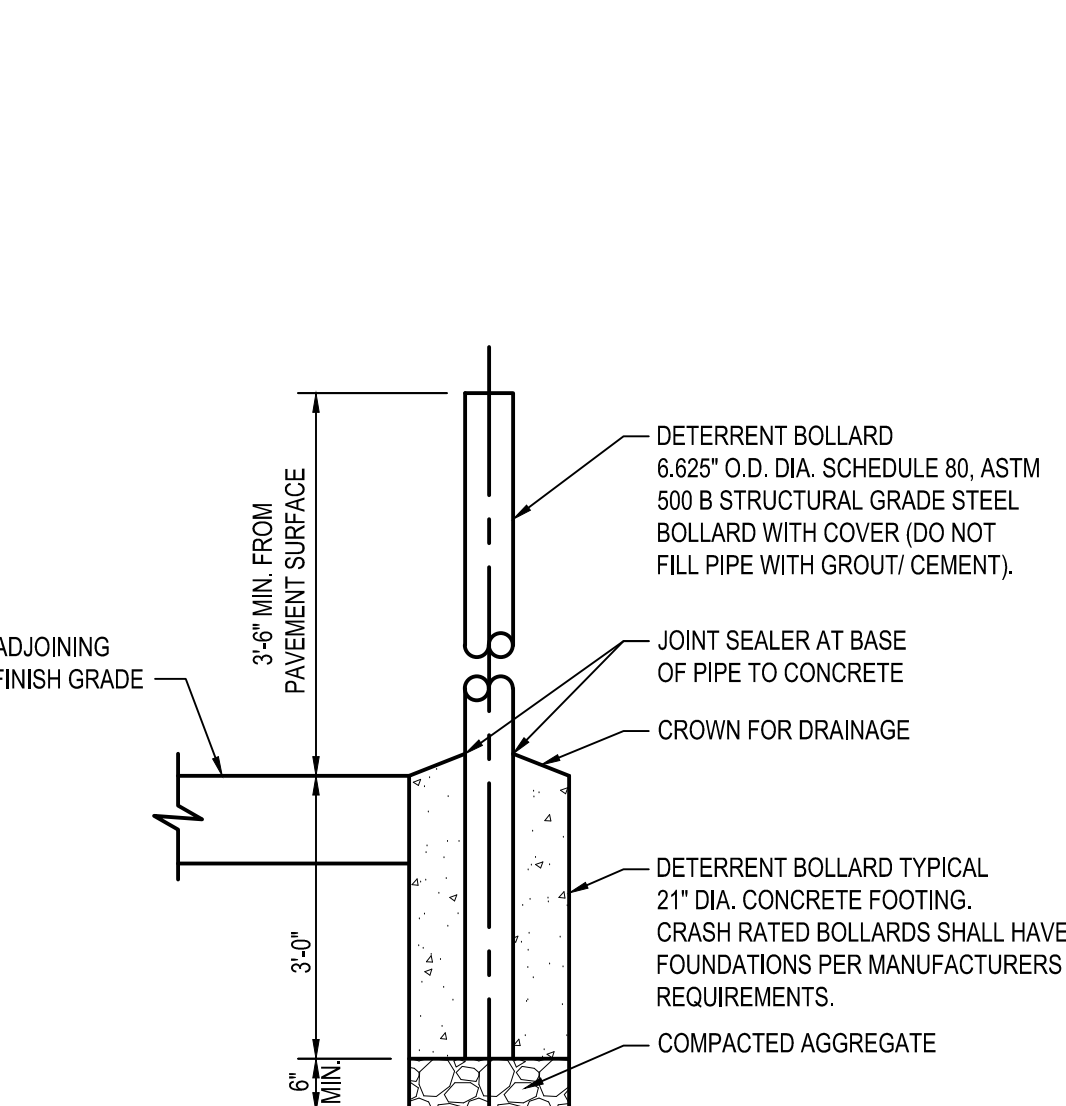

A4 DETERRENT BOLLARD
N.T.S.

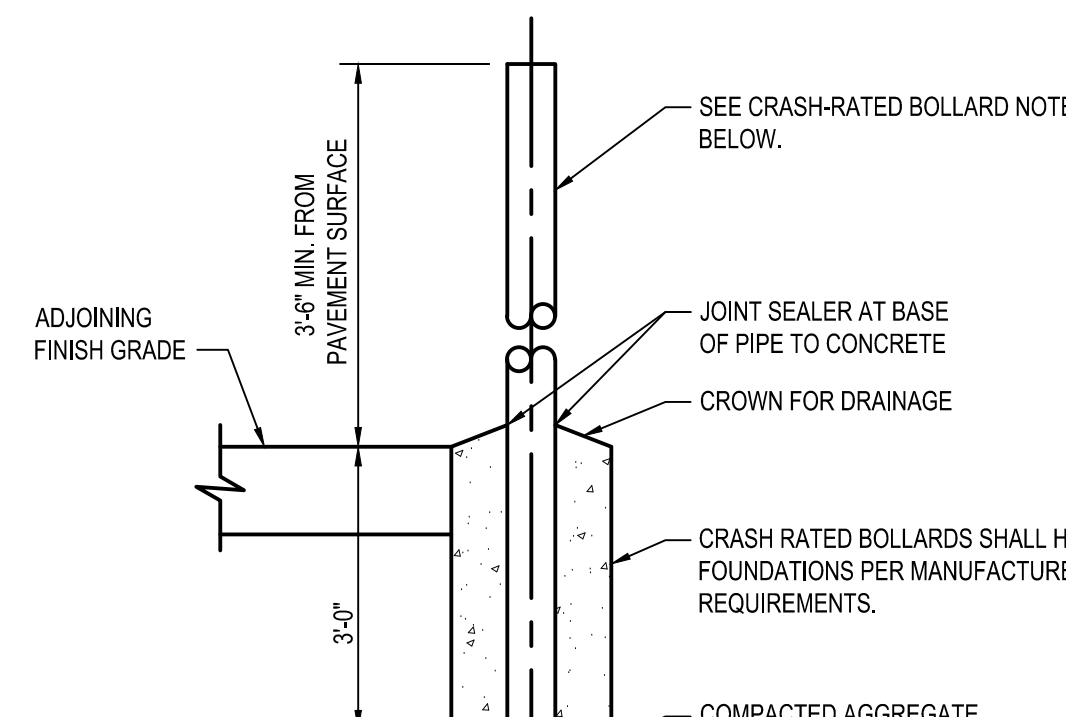

- CRASH-RATED BOLLARD NOTES:
- WHERE BOLLARDS ARE SEPARATING PEDESTRIANS / STOREFRONTS AND VEHICLES THE CONTRACTOR SHALL INSTALL A CRASH RATED BOLLARD AND FOOTING PER ASTM F3016/3016M. TYPICAL CLEAR SPACING OF 60" WITH AN ANTICIPATED S20 RATING FOR RIDING PURPOSES. FINAL SPACING AND RATING SHALL BE IN ACCORDANCE WITH ASTM AND THE MANUFACTURERS REQUIREMENTS FOR PROPOSED LOCATIONS AND POSSIBLE VEHICLE APPROACH SPEED. INSTALLER / CONTRACTOR SHALL BE OR BECOME CERTIFIED INSTALLERS (CONTACT MANUFACTURERS) FOR DETAILS.

D5 CRASH-RATED BOLLARD
N.T.S.

- KEYED NOTES:
- 1.5 INCH ASPHALT SURFACE COURSE (PER CURRENT NYSDOT SPECIFICATIONS)
 - 2.5 INCH ASPHALT INTERMEDIATE COURSE (PER CURRENT NYSDOT SPECIFICATIONS) (TWO LAYERS)
 - MIN. 8.0 INCH CRUSHED VIRGIN LIMESTONE AGGREGATE BASE (PER CURRENT NYSDOT SPECIFICATIONS)
 - SUBGRADE COMPACTION (PER CURRENT NYSDOT SPECIFICATIONS)
 - PROOF ROLLING (PER CURRENT NYSDOT SPECIFICATIONS)
 - TACK COAT (PER CURRENT NYSDOT SPECIFICATIONS)

- NOTES:
- APPLY LIQUID ASPHALT AT ALL JOINTS BETWEEN CONCRETE AND ASPHALT AND WHERE PROPOSED ASPHALT MEETS EXISTING ASPHALT INCLUDING SAW CUT JOINTS.
 - SUBGRADE SHALL BE PROPERLY PREPARED WITH SUFFICIENT STRENGTH FOR PAVING OPERATIONS. SEE GEOTECHNICAL ENGINEERING REPORT FOR MORE INFORMATION.
 - NO RAP SHALL BE PERMITTED IN ASPHALT SURFACE COURSE.
 - MAXIMUM 35% RAP IN THE INTERMEDIATE COURSE.

C5 HEAVY DUTY ASPHALT PAVEMENT
N.T.S.



- NOTE: "SEE TABLE" REFERS TO THE DOWEL & TIE BAR DIMENSION TABLE FOR TYPICAL SPACING.

SLAB THICKNESS - "T"	CONSTRUCTION / EXPANSION JT		CONTRACTION JT		DOWEL SPACING (12" TYPICAL OFF JOINT LINE)		TIE BAR DIMENSIONS (DIAMETER X MINIMUM LENGTH - "L")		TIE BAR SPACING (15" TYPICAL OFF JOINT LINE)	
	ROUND	SQUARE	ROUND	SQUARE	ROUND	SQUARE	ROUND	SQUARE	ROUND	SQUARE
5 - < 6 INCHES	3/4" X 10' LONG	3/4" X 10' LONG	-	-	12" SPACING	14" SPACING	1/2" X 24" LONG	1/2" X 24" LONG	30" SPACING	30" SPACING
6 - < 8 INCHES	1" X 13' LONG	1" X 13' LONG	1" X 18' LONG	1" X 18' LONG	12" SPACING	14" SPACING	1/2" X 24" LONG	1/2" X 24" LONG	30" SPACING	30" SPACING
8 - < 10 INCHES	1-1/4" X 15' LONG	1-1/4" X 15' LONG	1-1/4" X 18' LONG	1-1/4" X 18' LONG	12" SPACING	14" SPACING	1/2" X 30" LONG	1/2" X 30" LONG	30" SPACING	30" SPACING
10 INCHES	1-1/2" X 18' LONG	1-1/2" X 18' LONG	1-1/2" X 22' LONG	1-1/2" X 22' LONG	12" SPACING	14" SPACING	1/2" X 30" LONG	1/2" X 30" LONG	30" SPACING	30" SPACING

DOWEL & TIE BAR DIMENSIONS TABLE

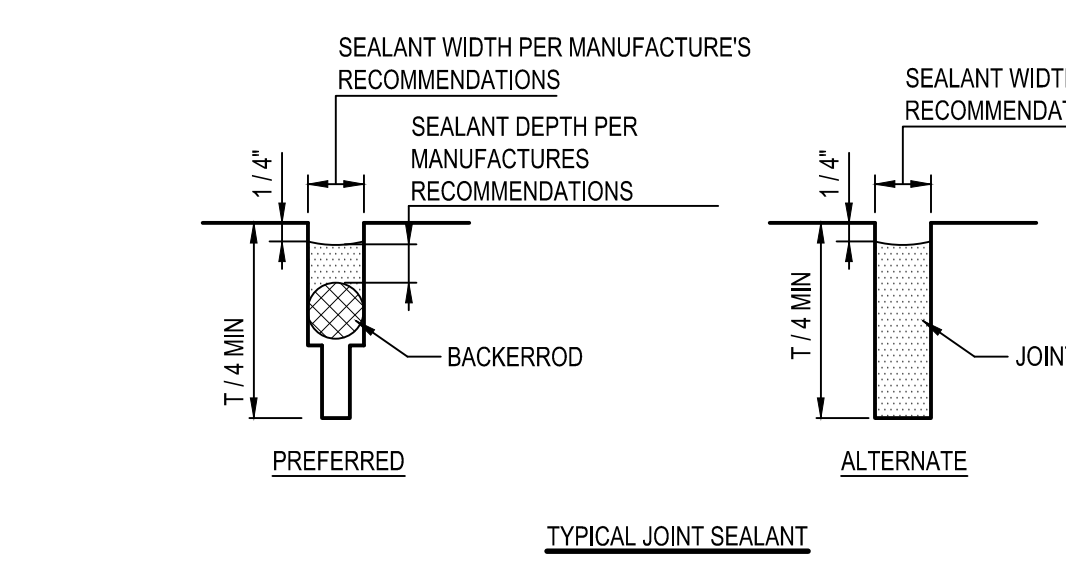
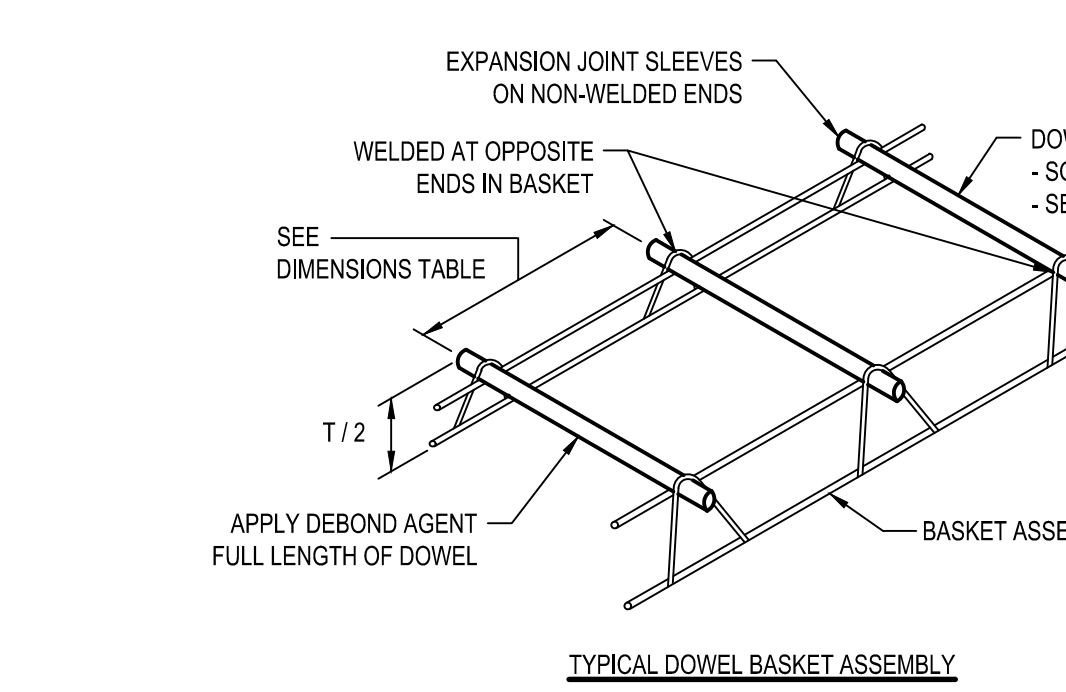

A5 JOINTING DETAILS
N.T.S.

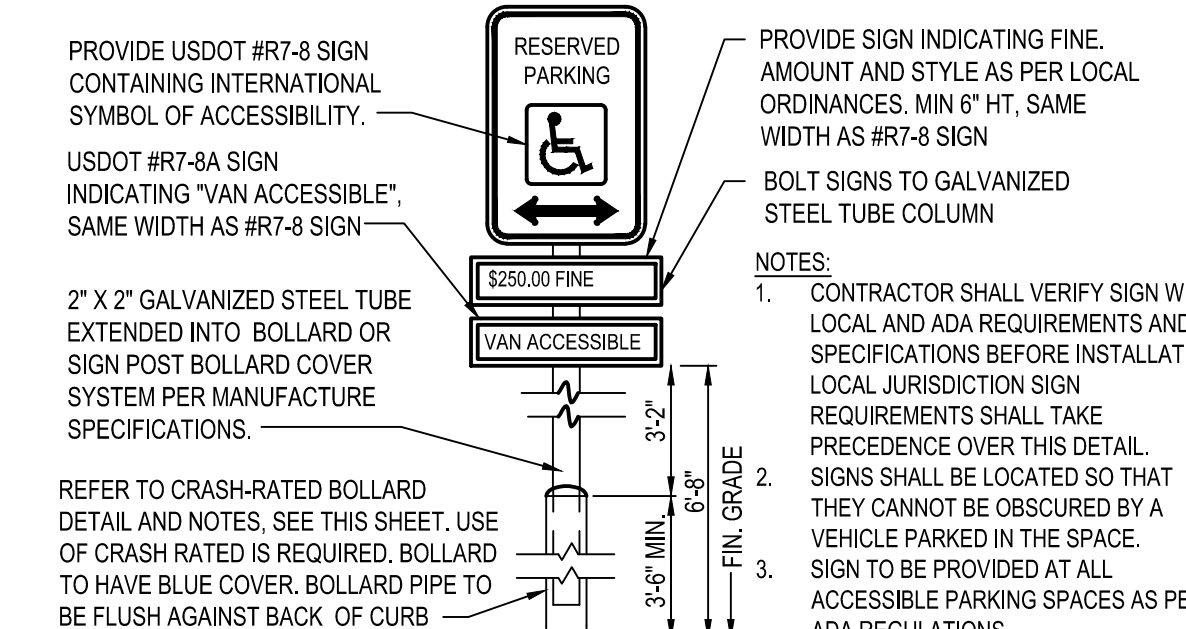

- PROVIDE US DOT #R7-8 SIGN CONTAINING INTERNATIONAL SYMBOL OF ACCESSIBILITY.
- US DOT #R7-8A SIGN INDICATING "VAN ACCESSIBLE". SAME WIDTH AS #R7-8 SIGN.
- 2" X 2" GALVANIZED STEEL TUBE EXTENDED INTO BOLLARD OR SIGN POST BOLLARD COVER SYSTEM PER MANUFACTURE SPECIFICATIONS.
- REFER TO CRASH-RATED BOLLARD DETAIL AND NOTES. SEE THIS SHEET. USE OF CRASH RATED IS REQUIRED. BOLLARD TO HAVE BLUE COVER. BOLLARD PIPE TO BE FLUSH AGAINST BACK OF CURB.
- FINISHED SURFACE PAVEMENT AS DETAILED ELSEWHERE.
- EXPANSION JOINT AROUND BOLLARD PIPE.
- SEALANT PER CRASH RATED MANUFACTURE.

D6 ADA PARKING SIGN
N.T.S.

- NOTES:
- CONTRACTOR SHALL VERIFY SIGN WITH LOCAL AND ADA REQUIREMENTS AND SPECIFICATIONS BEFORE INSTALLATION. LOCAL JURISDICTION SIGN REQUIREMENTS SHALL TAKE PRECEDENCE OVER THIS DETAIL.
 - SIGNS SHALL BE LOCATED SO THAT THEY CANNOT BE OBTAINED BY A VEHICLE PARKED IN THE SPACE. SIGN TO BE PROVIDED AT ALL ACCESSIBLE PARKING SPACES AS PER ADA REGULATIONS.

- NOTES:
- APPLY LIQUID ASPHALT AT ALL JOINTS BETWEEN CONCRETE AND ASPHALT AND WHERE PROPOSED ASPHALT MEETS EXISTING ASPHALT INCLUDING SAW CUT JOINTS.
 - SUBGRADE SHALL BE PROPERLY PREPARED WITH SUFFICIENT STRENGTH FOR PAVING OPERATIONS. SEE GEOTECHNICAL ENGINEERING REPORT FOR MORE INFORMATION.
 - NO RAP SHALL BE PERMITTED IN ASPHALT SURFACE COURSE.
 - MAXIMUM 35% RAP IN THE INTERMEDIATE COURSE.

C6 CONCRETE WHEELSTOP
N.T.S.