

PROVIDE ADDITIONAL HEAD(S) AND PIPING TO PROVIDE COVERAGE IN AREA AND EXTEND EXISTING SYSTEM.

FIRE PROTECTION LEGEND

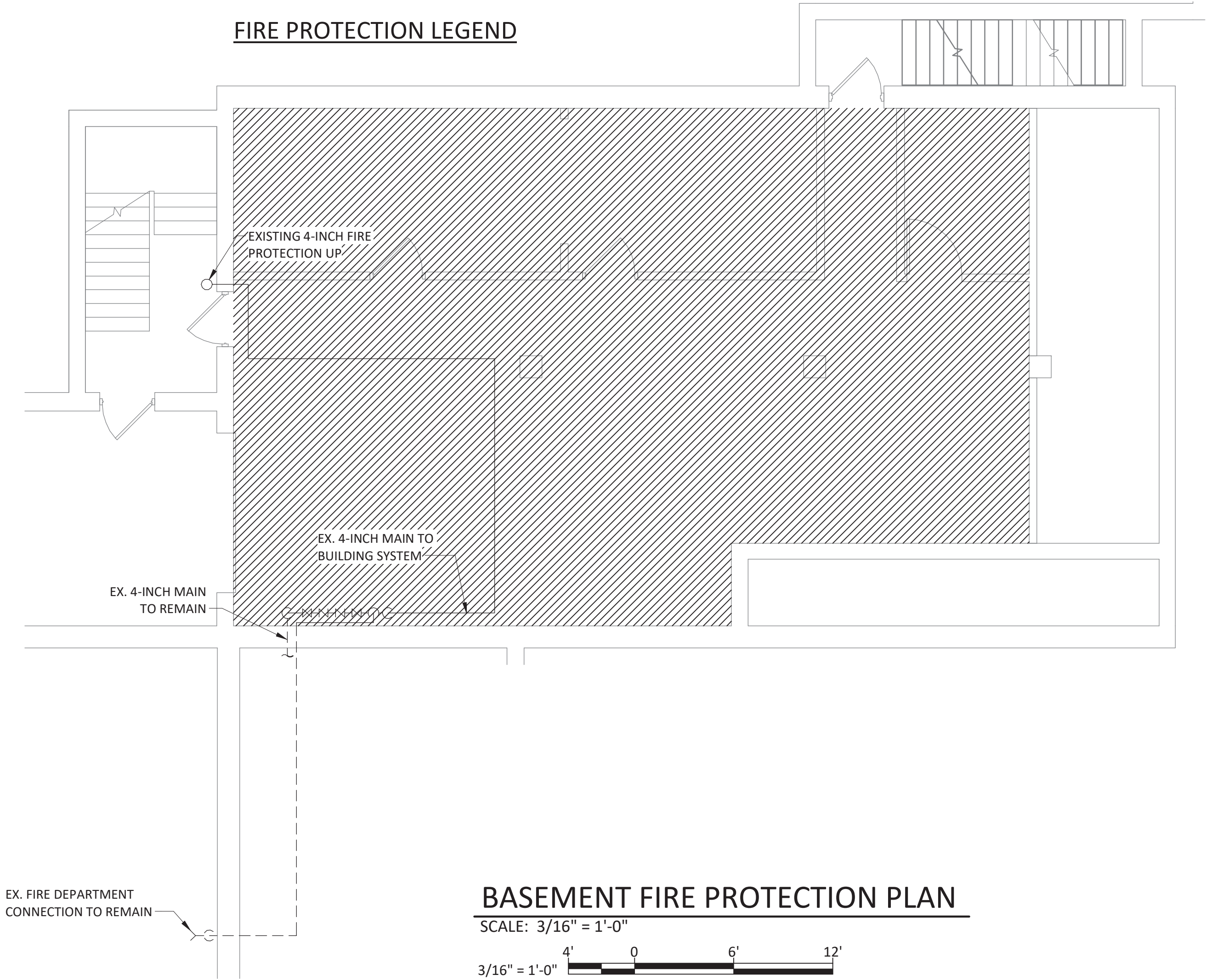

BASEMENT FIRE PROTECTION PLAN

SCALE: 3/16" = 1'-0"



- GENERAL NOTES:**
- EXISTING FIRE PROTECTION SYSTEM TO REMAIN. CONTRACTOR SHALL COORDINATE WITH THE LOCAL UTILITY AND CONDUCT A FIRE FLOW TEST IN ACCORDANCE WITH NFPA 13 PRIOR TO PERFORMING ANY WORK. CONTRACTOR SHALL PAY FOR ANY/ALL FEES ASSOCIATED WITH THE TEST.
  - MODIFY EXISTING SPRINKLER HEAD LOCATIONS AND BRANCH PIPING AS REQUIRED TO PROVIDE SPRINKLER COVERAGE OF NEW OFFICE CONFIGURATIONS ON THE FIRST AND SECOND FLOORS IN ACCORDANCE WITH NFPA 13.
  - THESE DRAWINGS ARE DIAGRAMMATIC AND APPROXIMATE; IT IS THE RESPONSIBILITY OF THE INSTALLING CONTRACTOR FOR VERIFICATION OF ALL DIMENSIONS, MEASUREMENTS, AND LOCATIONS OF EXISTING FACILITIES, UTILITIES, EQUIPMENT, AND OTHER EXISTING CONDITIONS WHICH MAY AFFECT CONSTRUCTION PRIOR TO SHOP DRAWINGS AND INSTALLATION. HOWEVER, IN THE EVENT OF DISCREPANCIES BETWEEN THE DRAWINGS AND ACTUAL FIELD CONDITIONS, CONTACT THE CONTRACTING OFFICER IMMEDIATELY.
  - THE DESIGN AND INSTALLATION/MODIFICATION OF THE FIRE PROTECTION SYSTEMS SHALL BE IN STRICT ACCORDANCE WITH NFPA 13, 2016 EDITION; AND ANY APPLICABLE LOCAL, STATE, OR NATIONAL CODES AND STANDARDS.
  - THE ENTIRE FACILITY IS BEING PROTECTED BY AN AUTOMATIC WET PIPE SPRINKLER SYSTEM. COORDINATE SHUTDOWNS AND INTERRUPTIONS IN SPRINKLER PROTECTION WITH THE BUILDING OWNER AND THE AUTHORITY HAVING JURISDICTION.
  - THE SPRINKLER SYSTEM SHALL CONTINUE TO BE MONITORED BY THE FIRE ALARM SYSTEM.
  - THE INTENT OF THE FIRE PROTECTION WORK IS TO MODIFY THE EXISTING SYTEMS TO ACCOMMODATE THE NEW FLOOR PLAN.
  - ALL HANGERS SHALL BE PROVIDED AND INSTALLED IN ACCORDANCE WITH NFPA 13.
  - PROVIDE SLEEVES AND FIRESTOP SEALANTS WHERE PIPES PENETRATE FIRE RATED FLOORS AND WALLS. COMPLY WITH ASTM E-814 AND UL 1479. PROVIDE PIPE SLEEVES WITH FIRE STOP SEALANTS FOR ALL PIPING PENETRATING DRYWALL PARTITIONS, MASONRY PARTITIONS, AND FLOORS.
  - A MAXIMUM OF ONE SPRINKLER MAY BE SUPPLIED BY A SINGLE 1" OUTLET WITHOUT PROVIDING HYDRAULIC CALCULATIONS TO VALIDATE ADEQUACY. NEW MECHANICAL OUTLETS FOR NEW PENDENT HEADS SHOULD BE INSTALLED ON NEARBY BRANCHLINES.
  - FIRE PROTECTION PIPING IS TO BE LOCATED ABOVE THE CEILING UNLESS OTHERWISE NOTED.
  - COORDINATE WITH OTHERS THE FINAL LOCATIONS OF SPRINKLER HEADS, PIPING, AND ALL NEW WORK WITH EXISTING AND NEW LIGHT FIXTURES, DIFFUSERS, GRILLES, REGISTERS, SMOKE DETECTORS, SPEAKERS, AND OTHER CEILING MOUNTED DEVICES.
  - CENTER HEADS IN ALL CEILING TILES UNLESS ARCHITECT APPROVES ALTERNATE LOCATION. PROVIDE ADDITIONAL HEADS WHERE REQUIRED TO MEET COVERAGE REQUIREMENTS.
  - RELOCATE EXISTING SPRINKLER HEADS OR ADD NEW SPRINKLER HEADS AS SHOWN TO PROVIDE A CODE COMPLIANT SYSTEM WHILE ADHERING TO ALL OBSTUCTION RULES WITHIN NFPA 13.
  - LIGHT HAZARD OCCUPANCY, MAXIMUM OF 225FT² PER HEAD, MAXIMUM SPACING IS 15', MINIMUM SPACING IS 6', MINIMUM DISTANCE FROM WALL IS 4".
  - SEE ARCHITECTURAL PLANS FOR CEILING MATERIAL AND COORDINATE HEAD TYPE IN EACH LOCATION.
  - SEAL ALL PENETRATIONS IN ACCORDANCE WITH THE FIRE RATING OF WALLS, CEILINGS OR FLOORS. SEE ARCHITECTURAL PLANS FOR ADDITIONAL INFORMATION.
  - EACH CONTRACTOR SHALL BE RESPONSIBLE FOR ALL CUTTING AND PATCHING ASSOCIATED WITH THEIR WORK. WHERE EQUIPMENT IS COMPLETELY DEMOLISHED OR REMOVED AND REPLACED WITH NEW EQUIPMENT, ALL FINISHES, FLOORING, BASE AND WALL SHALL BE PATCHED TO MATCH SURROUNDING AREAS. FEATHER INTO EXISTING FINISHED CONDITIONS TO TRANSITION NEW PATCH WORK WITH EXISTING FINISHED CONDITIONS. ALL PATCHING AND PAINTING SHALL BE DONE IN A MANNER TO MATCH THE EXISTING SURFACE IN APPEARANCE AND FUNCTION. ALL PATCHING SHALL BE PERFORMED BY A CONTRACTOR SKILLED IN THE APPROPRIATE CRAFT AND FINAL PATCHING IS SUBJECT TO REVIEW AND APPROVAL BY THE ARCHITECT.
  - PIPING SHALL BE AS FOLLOWS:
    - ALLIED SCHEDULE 40 WITH CAST IRON THREADED FITTINGS FOR BRANCH PIPING 1"-2" DIAMETER, OR APPROVED EQUAL.
    - ALLIED SCHEDULE 10 WITH GROOVED FITTINGS FOR SUPPLY AND MAIN PIPING 2-1/2" DIAMETER AND LARGER, U.O.N.
    - ALL HEADS SHALL BE FED USING 1-INCH DIAMETER PIPING MINIMUM SIZE.

DESIGN CRITERIA FOR WET PIPE SYSTEM:

- LIGHT HAZARD PER NFPA 13, MAXIMUM OF 225 FT² PER HEAD.
- QUICK RESPONSE CONCEALED, PENDANT OR UPRIGHT HEADS.
- DESIGN AREA = 1,500 SF
- DENSITY = 0.10 GPM/SF
- FLOW RATE (SPRINKLERS) 1,500 SF X .10 GPM/SF = 150 GPM
- FLOW RATE (HOSE STREAM) = 100 GPM
- FLOW RATE (MAX.) = 250 GPM
- DURATION OF SUPPLY = 30 MINUTES

IT IS A VIOLATION OF THE NEW YORK STATE EDUCATION LAW, ARTICLE 145 §7209 SPECIAL PROVISIONS, FOR ANY PERSON, UNLESS THEY ARE ACTING UNDER THE DIRECTION OF A LICENSED PROFESSIONAL ENGINEER, ARCHITECT, LANDSCAPE ARCHITECT, OR LAND SURVEYOR, TO ALTER ANY ITEM IN ANY WAY, IF AN ITEM BEARING THE STAMP OF A LICENSED PROFESSIONAL IS ALTERED, THE ALTERING PROFESSIONAL SHALL STAMP THE DOCUMENT AND INCLUDE THE NOTATION "ALTERED BY:" FOLLOWED BY THEIR SIGNATURE, THE DATE OF SUCH ALTERATION, AND A SPECIFIC DESCRIPTION OF THE ALTERATION.

REVISIONS

CITY OF MIDDLETOWN  
NEW COURTHOUSE FACILITY  
CONTRACT 1B - MECHANICAL CONSTRUCTION  
**FIRE PROTECTION GENERAL NOTES AND  
BASEMENT FIRE PROTECTION PLAN**  
ORANGE COUNTY, NEW YORK  
CITY OF MIDDLETOWN

443 Electronics Parkway  
Liverpool, NY  
13088  
**Barton & Loguidice, D.P.C.**



NYS EXP.: 11/30/2025

Date  
AUGUST, 2024

Scale  
AS SHOWN

Sheet Number  
**FP101**

Project Number  
**1753.008.001**

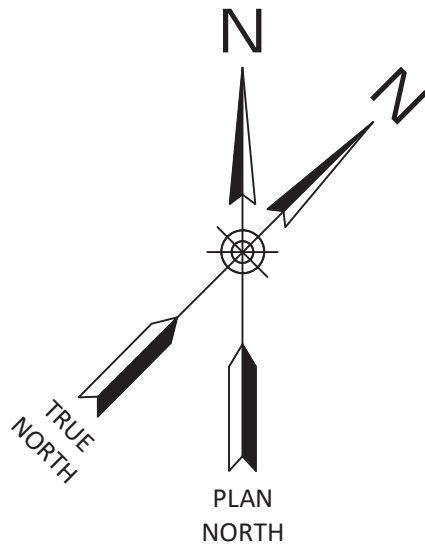

- EXISTING SYSTEM TO REMAIN
- MODIFY EXISTING SYSTEM TO ACCOMMODATE NEW CEILING, CENTER HEADS IN NEW CEILING TILES
- PROVIDE ADDITIONAL HEAD(S) AND PIPING TO PROVIDE COVERAGE IN AREA AND EXTEND EXISTING SYSTEM.
- SECURITY AREA – PROVIDE TAMPERPROOF, INSTITUTIONAL STYLE, RECESSED SECURITY, SPRINKLER HEADS WITHIN SECURITY CEILING. COORDINATE WITH GC AND CEILING MANUFACTURER REQUIREMENTS

FIRE PROTECTION LEGEND

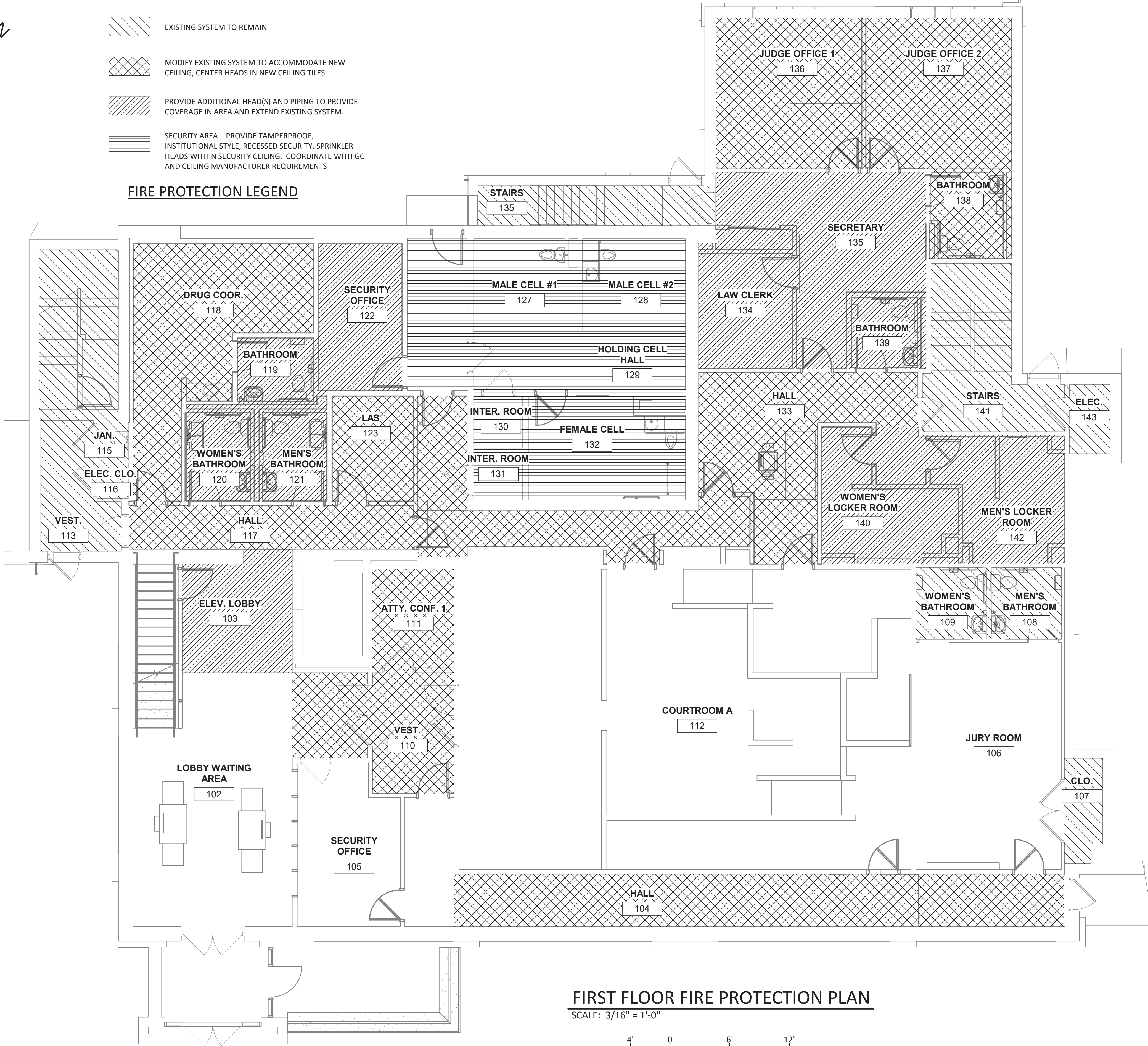

FIRST FLOOR FIRE PROTECTION PLAN

SCALE: 3/16" = 1'-0"



- GENERAL NOTES:**
- EXISTING FIRE PROTECTION SYSTEM TO REMAIN. CONTRACTOR SHALL COORDINATE WITH THE LOCAL UTILITY AND CONDUCT A FIRE FLOW TEST IN ACCORDANCE WITH NFPA 13 PRIOR TO PERFORMING ANY WORK. CONTRACTOR SHALL PAY FOR ANY/ALL FEES ASSOCIATED WITH THE TEST.
  - MODIFY EXISTING SPRINKLER HEAD LOCATIONS AND BRANCH PIPING AS REQUIRED TO PROVIDE SPRINKLER COVERAGE OF NEW OFFICE CONFIGURATIONS ON THE FIRST AND SECOND FLOORS IN ACCORDANCE WITH NFPA 13.
  - THESE DRAWINGS ARE DIAGRAMMATIC AND APPROXIMATE; IT IS THE RESPONSIBILITY OF THE INSTALLING CONTRACTOR FOR VERIFICATION OF ALL DIMENSIONS, MEASUREMENTS, AND LOCATIONS OF EXISTING FACILITIES, UTILITIES, EQUIPMENT, AND OTHER EXISTING CONDITIONS WHICH MAY AFFECT CONSTRUCTION PRIOR TO SHOP DRAWINGS AND INSTALLATION. HOWEVER, IN THE EVENT OF DISCREPANCIES BETWEEN THE DRAWINGS AND ACTUAL FIELD CONDITIONS, CONTACT THE CONTRACTING OFFICER IMMEDIATELY.
  - THE DESIGN AND INSTALLATION/MODIFICATION OF THE FIRE PROTECTION SYSTEMS SHALL BE IN STRICT ACCORDANCE WITH NFPA 13, 2016 EDITION; AND ANY APPLICABLE LOCAL, STATE, OR NATIONAL CODES AND STANDARDS.
  - THE ENTIRE FACILITY IS BEING PROTECTED BY AN AUTOMATIC WET PIPE SPRINKLER SYSTEM. COORDINATE SHUTDOWNS AND INTERRUPTIONS IN SPRINKLER PROTECTION WITH THE BUILDING OWNER AND THE AUTHORITY HAVING JURISDICTION.
  - THE SPRINKLER SYSTEM SHALL CONTINUE TO BE MONITORED BY THE FIRE ALARM SYSTEM.
  - THE INTENT OF THE FIRE PROTECTION WORK IS TO MODIFY THE EXISTING SYTEMS TO ACCOMMODATE THE NEW FLOOR PLAN.
  - ALL HANGERS SHALL BE PROVIDED AND INSTALLED IN ACCORDANCE WITH NFPA 13.
  - PROVIDE SLEEVES AND FIRESTOP SEALANTS WHERE PIPES PENETRATE FIRE RATED FLOORS AND WALLS. COMPLY WITH ASTM E-814 AND UL 1479. PROVIDE PIPE SLEEVES WITH FIRE STOP SEALANTS FOR ALL PIPING PENETRATING DRYWALL PARTITIONS, MASONRY PARTITIONS, AND FLOORS.
  - A MAXIMUM OF ONE SPRINKLER MAY BE SUPPLIED BY A SINGLE 1" OUTLET WITHOUT PROVIDING HYDRAULIC CALCULATIONS TO VALIDATE ADEQUACY. NEW MECHANICAL OUTLETS FOR NEW PENDENT HEADS SHOULD BE INSTALLED ON NEARBY BRANCHLINES.
  - FIRE PROTECTION PIPING IS TO BE LOCATED ABOVE THE CEILING UNLESS OTHERWISE NOTED.
  - COORDINATE WITH OTHERS THE FINAL LOCATIONS OF SPRINKLER HEADS, PIPING, AND ALL NEW WORK WITH EXISTING AND NEW LIGHT FIXTURES, DIFFUSERS, GRILLES, REGISTERS, SMOKE DETECTORS, SPEAKERS, AND OTHER CEILING MOUNTED DEVICES.
  - CENTER HEADS IN ALL CEILING TILES UNLESS ARCHITECT APPROVES ALTERNATE LOCATION. PROVIDE ADDITIONAL HEADS WHERE REQUIRED TO MEET COVERAGE REQUIREMENTS.
  - RELOCATE EXISTING SPRINKLER HEADS OR ADD NEW SPRINKLER HEADS AS SHOWN TO PROVIDE A CODE COMPLIANT SYSTEM WHILE ADHERING TO ALL OBSTUCTION RULES WITHIN NFPA 13.
  - LIGHT HAZARD OCCUPANCY, MAXIMUM OF 225FT² PER HEAD, MAXIMUM SPACING IS 15', MINIMUM SPACING IS 6', MINIMUM DISTANCE FROM WALL IS 4".
  - SEE ARCHITECTURAL PLANS FOR CEILING MATERIAL AND COORDINATE HEAD TYPE IN EACH LOCATION.
  - SEAL ALL PENETRATIONS IN ACCORDANCE WITH THE FIRE RATING OF WALLS, CEILINGS OR FLOORS. SEE ARCHITECTURAL PLANS FOR ADDITIONAL INFORMATION.
  - EACH CONTRACTOR SHALL BE RESPONSIBLE FOR ALL CUTTING AND PATCHING ASSOCIATED WITH THEIR WORK. WHERE EQUIPMENT IS COMPLETELY DEMOLISHED OR REMOVED AND REPLACED WITH NEW EQUIPMENT, ALL FINISHES, FLOORING, BASE AND WALL SHALL BE PATCHED TO MATCH SURROUNDING AREAS. FEATHER INTO EXISTING FINISHED CONDITIONS TO TRANSITION NEW PATCH WORK WITH EXISTING FINISHED CONDITIONS. ALL PATCHING AND PAINTING SHALL BE DONE IN A MANNER TO MATCH THE EXISTING SURFACE IN APPEARANCE AND FUNCTION. ALL PATCHING SHALL BE PERFORMED BY A CONTRACTOR SKILLED IN THE APPROPRIATE CRAFT AND FINAL PATCHING IS SUBJECT TO REVIEW AND APPROVAL BY THE ARCHITECT.
  - PIPING SHALL BE AS FOLLOWS:
    - A. ALLIED SCHEDULE 40 WITH CAST IRON THREADED FITTINGS FOR BRANCH PIPING 1"-2" DIAMETER, OR APPROVED EQUAL.
    - B. ALLIED SCHEDULE 10 WITH GROOVED FITTINGS FOR SUPPLY AND MAIN PIPING 2-1/2" DIAMETER AND LARGER, U.O.N.
    - C. ALL HEADS SHALL BE FED USING 1-INCH DIAMETER PIPING MINIMUM SIZE.

DESIGN CRITERIA FOR WET PIPE SYSTEM:

- LIGHT HAZARD PER NFPA 13, MAXIMUM OF 225 FT² PER HEAD.
- QUICK RESPONSE CONCEALED, PENDANT OR UPRIGHT HEADS.
- DESIGN AREA = 1,500 SF
- DENSITY = 0.10 GPM/SF
- FLOW RATE (SPRINKLERS) 1,500 SF X .10 GPM/SF = 150 GPM
- FLOW RATE (HOSE STREAM) = 100 GPM
- FLOW RATE (MAX.) = 250 GPM
- DURATION OF SUPPLY = 30 MINUTES

IT IS A VIOLATION OF THE NEW YORK STATE EDUCATION LAW, ARTICLE 145 §7209 SPECIAL PROVISIONS, FOR ANY PERSON, UNLESS THEY ARE ACTING UNDER THE DIRECTION OF A LICENSED PROFESSIONAL ENGINEER, ARCHITECT, LANDSCAPE ARCHITECT, OR LAND SURVEYOR, TO ALTER ANY ITEM IN ANY WAY, IF AN ITEM BEARING THE STAMP OF A LICENSED PROFESSIONAL IS ALTERED, THE ALTERING PROFESSIONAL SHALL STAMP THE DOCUMENT AND INCLUDE THE NOTATION "ALTERED BY" FOLLOWED BY THEIR SIGNATURE, THE DATE OF SUCH ALTERATION, AND A SPECIFIC DESCRIPTION OF THE ALTERATION.

REVISIONS

CITY OF MIDDLETOWN  
NEW COURTHOUSE FACILITY  
CONTRACT 1B - MECHANICAL CONSTRUCTION  
**FIRST FLOOR FIRE PROTECTION PLAN**  
CITY OF MIDDLETOWN  
ORANGE COUNTY, NEW YORK

443 Electronics Parkway  
Liverpool, NY  
13088  
**Barton & Loguidice, D.P.C.**



NYS EXP.: 11/30/2025

Date  
AUGUST, 2024

Scale  
AS SHOWN

Sheet Number  
**FP102**

Project Number  
**1753.008.001**

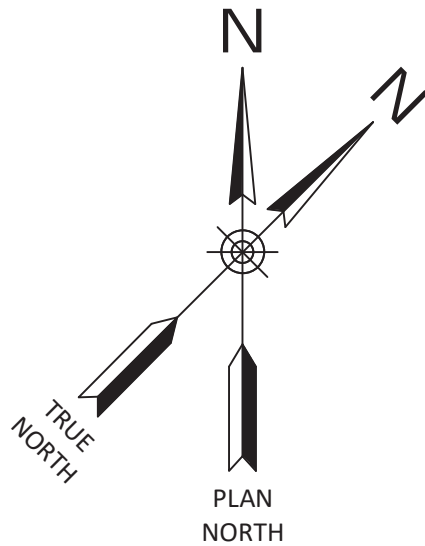

- EXISTING SYSTEM TO REMAIN
- MODIFY EXISTING SYSTEM TO ACCOMMODATE NEW CEILING, CENTER HEADS IN NEW CEILING TILES
- PROVIDE ADDITIONAL HEAD(S) AND PIPING TO PROVIDE COVERAGE IN AREA AND EXTEND EXISTING SYSTEM.

FIRE PROTECTION LEGEND

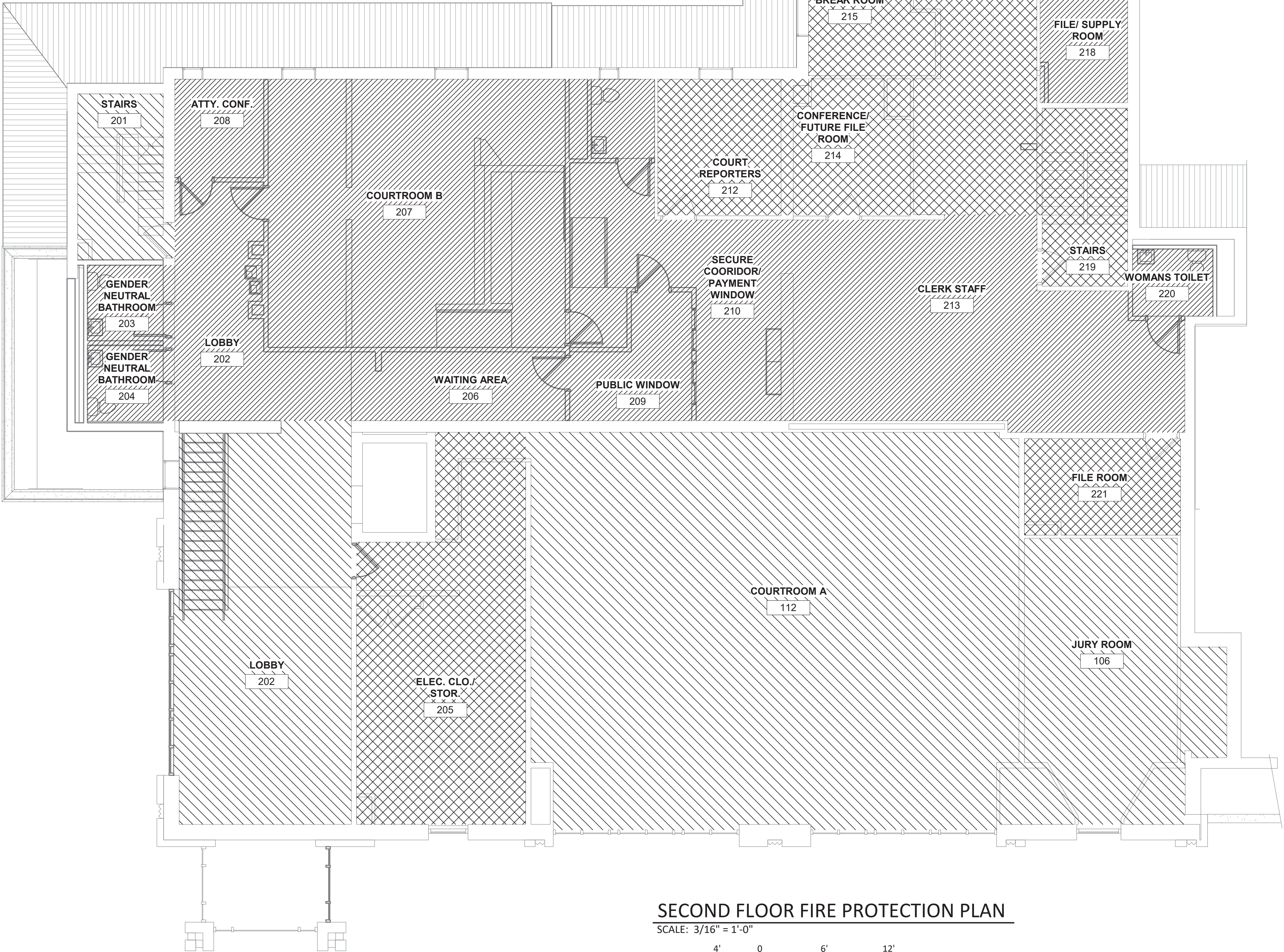

SECOND FLOOR FIRE PROTECTION PLAN

SCALE: 3/16" = 1'-0"



- GENERAL NOTES:**
- EXISTING FIRE PROTECTION SYSTEM TO REMAIN. CONTRACTOR SHALL COORDINATE WITH THE LOCAL UTILITY AND CONDUCT A FIRE FLOW TEST IN ACCORDANCE WITH NFPA 13 PRIOR TO PERFORMING ANY WORK. CONTRACTOR SHALL PAY FOR ANY/ALL FEES ASSOCIATED WITH THE TEST.
  - MODIFY EXISTING SPRINKLER HEAD LOCATIONS AND BRANCH PIPING AS REQUIRED TO PROVIDE SPRINKLER COVERAGE OF NEW OFFICE CONFIGURATIONS ON THE FIRST AND SECOND FLOORS IN ACCORDANCE WITH NFPA 13.
  - THESE DRAWINGS ARE DIAGRAMMATIC AND APPROXIMATE; IT IS THE RESPONSIBILITY OF THE INSTALLING CONTRACTOR FOR VERIFICATION OF ALL DIMENSIONS, MEASUREMENTS, AND LOCATIONS OF EXISTING FACILITIES, UTILITIES, EQUIPMENT, AND OTHER EXISTING CONDITIONS WHICH MAY AFFECT CONSTRUCTION PRIOR TO SHOP DRAWINGS AND INSTALLATION. HOWEVER, IN THE EVENT OF DISCREPANCIES BETWEEN THE DRAWINGS AND ACTUAL FIELD CONDITIONS, CONTACT THE CONTRACTING OFFICER IMMEDIATELY.
  - THE DESIGN AND INSTALLATION/MODIFICATION OF THE FIRE PROTECTION SYSTEMS SHALL BE IN STRICT ACCORDANCE WITH NFPA 13, 2016 EDITION; AND ANY APPLICABLE LOCAL, STATE, OR NATIONAL CODES AND STANDARDS.
  - THE ENTIRE FACILITY IS BEING PROTECTED BY AN AUTOMATIC WET PIPE SPRINKLER SYSTEM. COORDINATE SHUTDOWNS AND INTERRUPTIONS IN SPRINKLER PROTECTION WITH THE BUILDING OWNER AND THE AUTHORITY HAVING JURISDICTION.
  - THE SPRINKLER SYSTEM SHALL CONTINUE TO BE MONITORED BY THE FIRE ALARM SYSTEM.
  - THE INTENT OF THE FIRE PROTECTION WORK IS TO MODIFY THE EXISTING SYTEMS TO ACCOMMODATE THE NEW FLOOR PLAN.
  - ALL HANGERS SHALL BE PROVIDED AND INSTALLED IN ACCORDANCE WITH NFPA 13.
  - PROVIDE SLEEVES AND FIRESTOP SEALANTS WHERE PIPES PENETRATE FIRE RATED FLOORS AND WALLS. COMPLY WITH ASTM E-814 AND UL 1479. PROVIDE PIPE SLEEVES WITH FIRE STOP SEALANTS FOR ALL PIPING PENETRATING DRYWALL PARTITIONS, MASONRY PARTITIONS, AND FLOORS.
  - A MAXIMUM OF ONE SPRINKLER MAY BE SUPPLIED BY A SINGLE 1" OUTLET WITHOUT PROVIDING HYDRAULIC CALCULATIONS TO VALIDATE ADEQUACY. NEW MECHANICAL OUTLETS FOR NEW PENDENT HEADS SHOULD BE INSTALLED ON NEARBY BRANCHLINES.
  - FIRE PROTECTION PIPING IS TO BE LOCATED ABOVE THE CEILING UNLESS OTHERWISE NOTED.
  - COORDINATE WITH OTHERS THE FINAL LOCATIONS OF SPRINKLER HEADS, PIPING, AND ALL NEW WORK WITH EXISTING AND NEW LIGHT FIXTURES, DIFFUSERS, GRILLES, REGISTERS, SMOKE DETECTORS, SPEAKERS, AND OTHER CEILING MOUNTED DEVICES.
  - CENTER HEADS IN ALL CEILING TILES UNLESS ARCHITECT APPROVES ALTERNATE LOCATION. PROVIDE ADDITIONAL HEADS WHERE REQUIRED TO MEET COVERAGE REQUIREMENTS.
  - RELOCATE EXISTING SPRINKLER HEADS OR ADD NEW SPRINKLER HEADS AS SHOWN TO PROVIDE A CODE COMPLIANT SYSTEM WHILE ADHERING TO ALL OBSTUCTION RULES WITHIN NFPA 13.
  - LIGHT HAZARD OCCUPANCY, MAXIMUM OF 225FT² PER HEAD, MAXIMUM SPACING IS 15', MINIMUM SPACING IS 6', MINIMUM DISTANCE FROM WALL IS 4".
  - SEE ARCHITECTURAL PLANS FOR CEILING MATERIAL AND COORDINATE HEAD TYPE IN EACH LOCATION.
  - SEAL ALL PENETRATIONS IN ACCORDANCE WITH THE FIRE RATING OF WALLS, CEILINGS OR FLOORS. SEE ARCHITECTURAL PLANS FOR ADDITIONAL INFORMATION.
  - EACH CONTRACTOR SHALL BE RESPONSIBLE FOR ALL CUTTING AND PATCHING ASSOCIATED WITH THEIR WORK. WHERE EQUIPMENT IS COMPLETELY DEMOLISHED OR REMOVED AND REPLACED WITH NEW EQUIPMENT, ALL FINISHES, FLOORING, BASE AND WALL SHALL BE PATCHED TO MATCH SURROUNDING AREAS. FEATHER INTO EXISTING FINISHED CONDITIONS TO TRANSITION NEW PATCH WORK WITH EXISTING FINISHED CONDITIONS. ALL PATCHING AND PAINTING SHALL BE DONE IN A MANNER TO MATCH THE EXISTING SURFACE IN APPEARANCE AND FUNCTION. ALL PATCHING SHALL BE PERFORMED BY A CONTRACTOR SKILLED IN THE APPROPRIATE CRAFT AND FINAL PATCHING IS SUBJECT TO REVIEW AND APPROVAL BY THE ARCHITECT.
  - PIPING SHALL BE AS FOLLOWS:
    - A. ALLIED SCHEDULE 40 WITH CAST IRON THREADED FITTINGS FOR BRANCH PIPING 1"-2" DIAMETER, OR APPROVED EQUAL.
    - B. ALLIED SCHEDULE 10 WITH GROOVED FITTINGS FOR SUPPLY AND MAIN PIPING 2-1/2" DIAMETER AND LARGER, U.O.N.
    - C. ALL HEADS SHALL BE FED USING 1-INCH DIAMETER PIPING MINIMUM SIZE.

DESIGN CRITERIA FOR WET PIPE SYSTEM:

- LIGHT HAZARD PER NFPA 13, MAXIMUM OF 225 FT² PER HEAD.
- QUICK RESPONSE CONCEALED, PENDANT OR UPRIGHT HEADS.
- DESIGN AREA = 1,500 SF
- DENSITY = 0.10 GPM/SF
- FLOW RATE (SPRINKLERS) 1,500 SF X .10 GPM/SF = 150 GPM
- FLOW RATE (HOSE STREAM) = 100 GPM
- FLOW RATE (MAX.) = 250 GPM
- DURATION OF SUPPLY = 30 MINUTES

IT IS A VIOLATION OF THE NEW YORK STATE EDUCATION LAW, ARTICLE 145 §7209 SPECIAL PROVISIONS, FOR ANY PERSON, UNLESS THEY ARE ACTING UNDER THE DIRECTION OF A LICENSED PROFESSIONAL ENGINEER, ARCHITECT, LANDSCAPE ARCHITECT, OR LAND SURVEYOR, TO ALTER ANY ITEM IN ANY WAY, IF AN ITEM BEARING THE STAMP OF A LICENSED PROFESSIONAL IS ALTERED, THE ALTERING PROFESSIONAL SHALL STAMP THE DOCUMENT AND INCLUDE THE NOTATION "ALTERED BY" FOLLOWED BY THEIR SIGNATURE, THE DATE OF SUCH ALTERATION, AND A SPECIFIC DESCRIPTION OF THE ALTERATION.

REVISIONS

CITY OF MIDDLETOWN  
NEW COURTHOUSE FACILITY  
CONTRACT 1B - MECHANICAL CONSTRUCTION  
SECOND FLOOR FIRE PROTECTION PLAN  
CITY OF MIDDLETOWN  
ORANGE COUNTY, NEW YORK

443 Electronics Parkway  
Liverpool, NY  
13088  
**Barton & Loguidice, D.P.C.**



NYS EXP.: 11/30/2025

Date  
AUGUST, 2024

Scale  
AS SHOWN

Sheet Number  
FP103

Project Number  
1753.008.001