

FLOOR PLAN NOTES

1. PROVIDE VAPOR BARRIER AND WIRE MESH AT EXTENT OF FUTURE OFFICE AREAS AS INDICATED. SEE STRUCTURAL DRAWINGS FOR CONCRETE SLAB DESIGN, VAPOR BARRIER, AND WIRE MESH REQUIREMENTS. PROVIDE INSULATION BELOW SLAB AT EXTENT OF FUTURE OFFICE AREAS.
2. PROVIDE INTERIOR WHITE FACED INSULATING SHEATHING PANELS PER ENERGY CODE AND IN ACCORDANCE WITH ICC REPORT ES-ESR-1859 AS FOLLOWS:
 - EXTERIOR WALLS FROM FROM 13'-0" AFF TO DECK
3. STRUCTURAL COLUMNS SHALL BE FACTORY PRIMED AND PAINTED AS FOLLOWS:
 - SAFETY YELLOW FROM FINISH FLOOR TO 12'-0" AFF, WHITE TO BOTTOM OF JOISTS
4. PROVIDE MECHANICAL DOCK LEVELERS AS SHOWN ON DRAWINGS. PROVIDE DOCK BUMPERS, SEALS, LIGHTS, AND TRACK GUARDS PER OUTLINE SPECIFICATIONS.
 - CAPACITY: 40,000 LBS
5. FIRE PROTECTION RISERS AND INSPECTOR TEST LINES SHALL RECEIVE ONE (1) COAT OSHA SAFETY RED ALKYD PAINT FROM FINISH FLOOR TO THE ELBOW AT THE ROOF LINE.
6. FIRE PUMP ROOM: ALL FIRE PROTECTION PIPING SHALL BE PAINTED RED, ROOF LADDER AND PLATFORM SHALL BE PAINTED SAFETY YELLOW, AND INTERIOR WALLS SHALL BE PAINTED WHITE.

FLOOR PLAN LEGEND

- | | | | |
|--|------------------------------|-----------|----------------|
| | EXTENT OF VAPOR BARRIER | KO | KNOCKOUT PANEL |
| | FULLY EQUIPPED DOCK POSITION | | MATCHLINE |
| | FUTURE RESTROOM LOCATION | | |

PARTITION LEGEND

- | | |
|--|-----------------------|
| | 1 HOUR RATED ASSEMBLY |
|--|-----------------------|

SHEET NOTES

- 208 STEEL STAIR WITH GUARDRAIL AND HANDRAIL, ALL MATERIALS TO BE GALVANIZED.
222 BOLLARD, 8" DIA. CONCRETE FILLED, GALVANIZED STEEL, WITH "TOP-GUARD" CAP, PAINTED YELLOW.

DESIGNER / BUILDER

ARCO
DESIGN/BUILD

44 SOUTH BROADWAY, SUITE 1003
WHITE PLAINS, NY 10601
P: 914.821.5535 F: 914.306.6010

ADB / DESIGN SERVICES

PROJECT TITLE

**ROCKLAND
LOGISTICS
CENTER BLDG 3**

**25 OLD MILL RD.
SUFFERN, NY 10901**

OWNER

BROOKFIELD PROPERTIES
1 MEADOWLANDS PLAZA SUITE 802
EAST RUTHERFORD, NJ 07073

ARCHITECT

ADB / DESIGN SERVICES LLC
44 SOUTH BROADWAY, SUITE 1003
WHITE PLAINS, NY 10601

CIVIL ENGINEER

DYNAMIC ENGINEERING CONSULTANTS
1904 MAIN STREET
LAKE COMO, NJ 07719

STRUCTURAL ENGINEER

ADB STRUCTURAL ENGINEERING
325 S. ALABAMA ST. SUITE 200
INDIANAPOLIS, IN 46204

MECHANICAL ENGINEER

NATIONAL DESIGN BUILD SERVICES
11840 BORMAN DRIVE
MARYLAND HEIGHTS, MO 63146

ELECTRICAL ENGINEER

FXB ENGINEERING
5 CHRISTY DRIVE, SUITE 307
CHADD'S FORD, PA 19317

PLUMBING ENGINEER

MCCARTHY ENGINEERING
2500 E HIGH STREET, SUITE 630
POTTSTOWN, PA 19464

FIRE PROTECTION ENGINEER

S.A. COMUNALE
2900 NEWPARK DRIVE
BARBERTON, OH 44203

SEAL

JOSEPH V. DIGIORGIO | NY: 042948

KEY PLAN

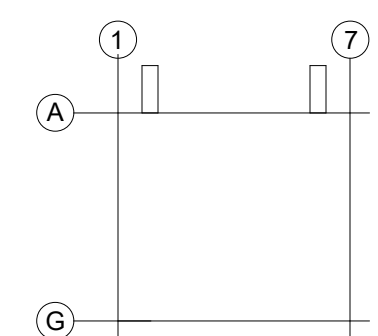

N

NORTH

SUBMITTALS

NO.	DATE	DESCRIPTION
	02.09.2024	ISSUE FOR PERMIT

PROJECT NO.

AS397-22 | NY154

DRAWN BY

ADB

SHEET TITLE

**OVERALL FLOOR
PLAN**

SHEET NO.

A2.10