

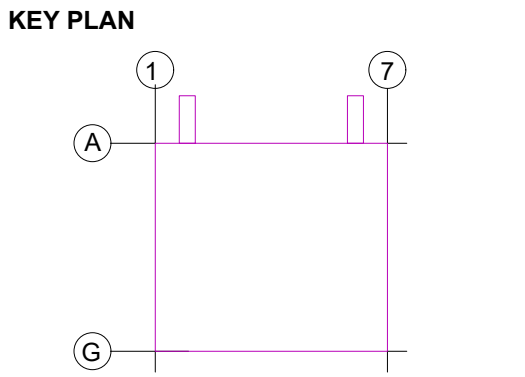

*Peter J. Bonner*



SUBMITTALS

NO.	DATE	DESCRIPTION
A	11.20.2024	ISSUE FOR REVIEW
B	02.02.2024	ISSUE FOR REVIEW
0	02.09.2024	ISSUE FOR PERMIT

PROJECT NO.  
AS397-22 | NY154

DRAWN BY  
NGF

SHEET TITLE  
**ENLARGED LIGHTING AND POWER PLANS**

SHEET NO.

**E4.0**

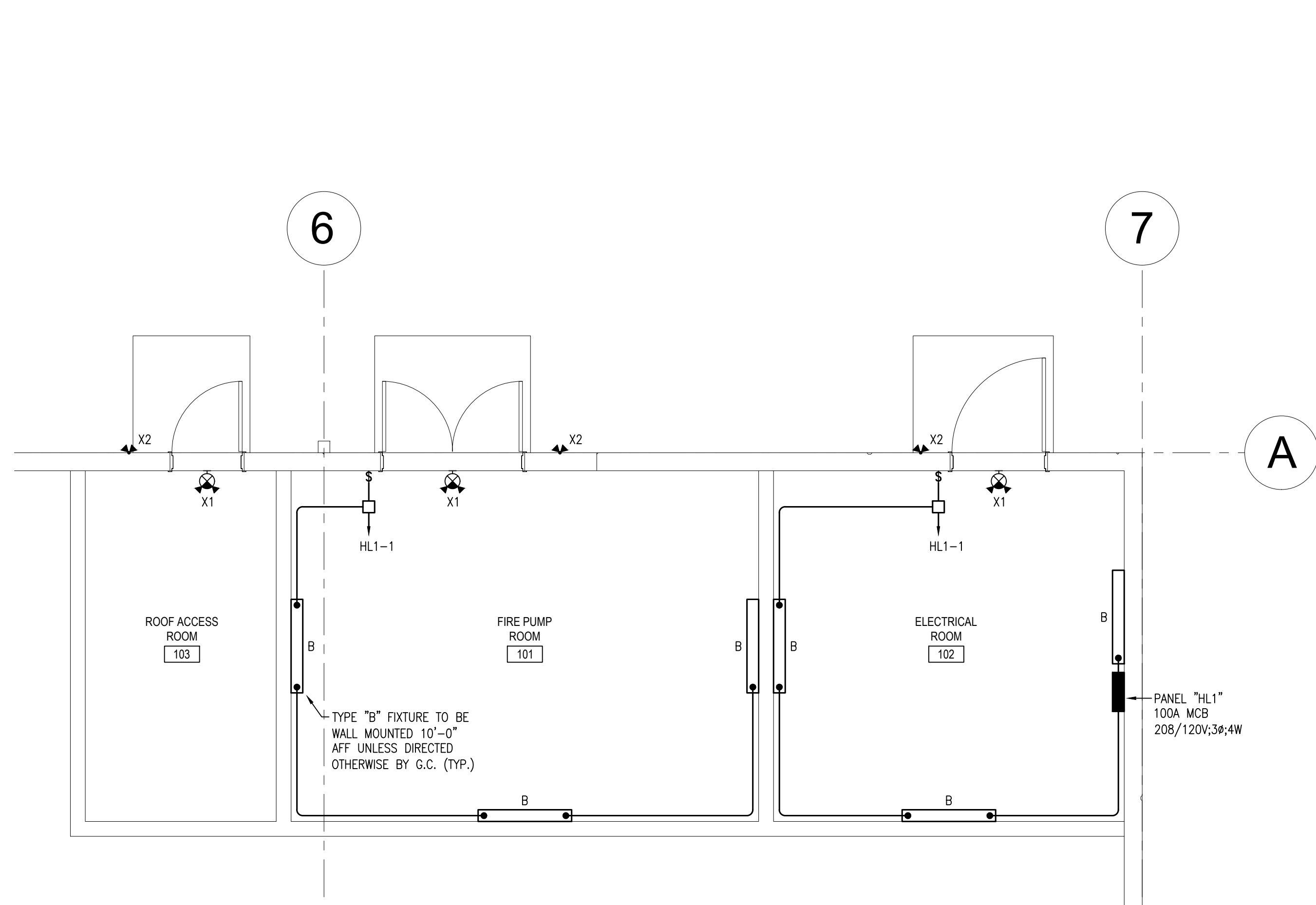

1  
E4.0  
**ENLARGED LIGHTING PLAN**  
SCALE: 1/4" = 1'-0"

- NOTES:
- ALL SHOWN IS NEW & BY EC UNLESS SPECIFICALLY NOTED OTHERWISE
  - ALL EXIT SIGNAGE & EMERGENCY LIGHTING TO BE WIRED TO LOCAL LIGHTING CIRCUIT AND AHEAD OF ALL SWITCHING
  - ALL LIGHTING FIXTURES WITHIN THE SPECIFIED AREA SHALL BE CIRCUITED TO THE CIRCUIT NUMBER(S) INDICATED ON THIS PLAN, UNLESS NOTED OTHERWISE. SEE PANEL SCHEDULES ON DRAWING E5.0 FOR ADDITIONAL INFORMATION.
  - VERIFY ALL FIXTURE LOCATIONS, WATTAGES, AND FIXTURE CATALOG NUMBERS WITH OWNER & GC PRIOR TO PURCHASING/INSTALLATION.

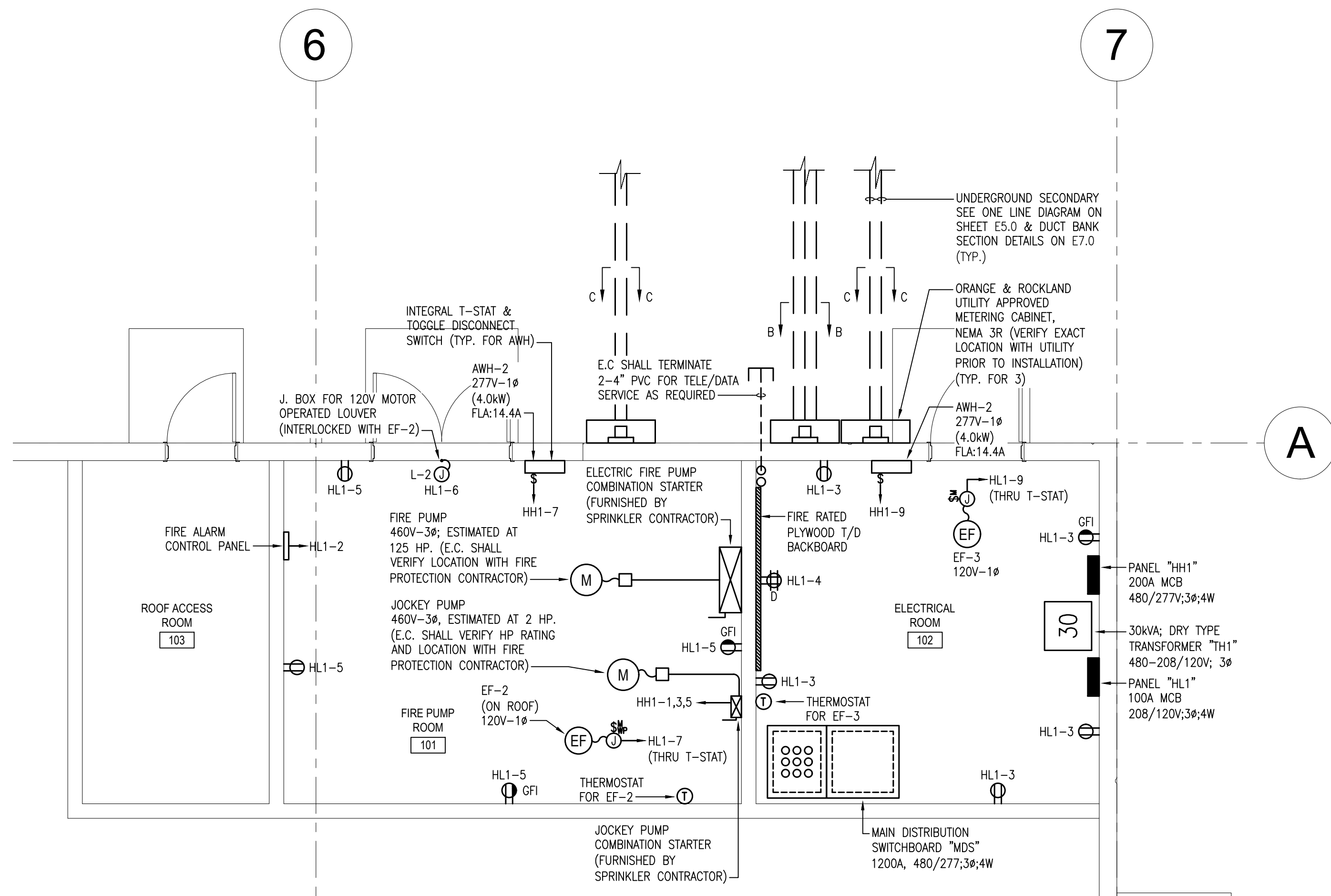

2  
E4.0  
**ENLARGED POWER PLAN**  
SCALE: 1/4" = 1'-0"

- NOTES:
- ALL SHOWN IS NEW & BY EC UNLESS SPECIFICALLY NOTED OTHERWISE.
  - E.C. SHALL VERIFY ALL MECHANICAL/HVAC EQUIPMENT LOCATIONS AND ELECTRICAL REQUIREMENTS WITH MECHANICAL/HVAC DRAWINGS PRIOR TO INSTALLATION.

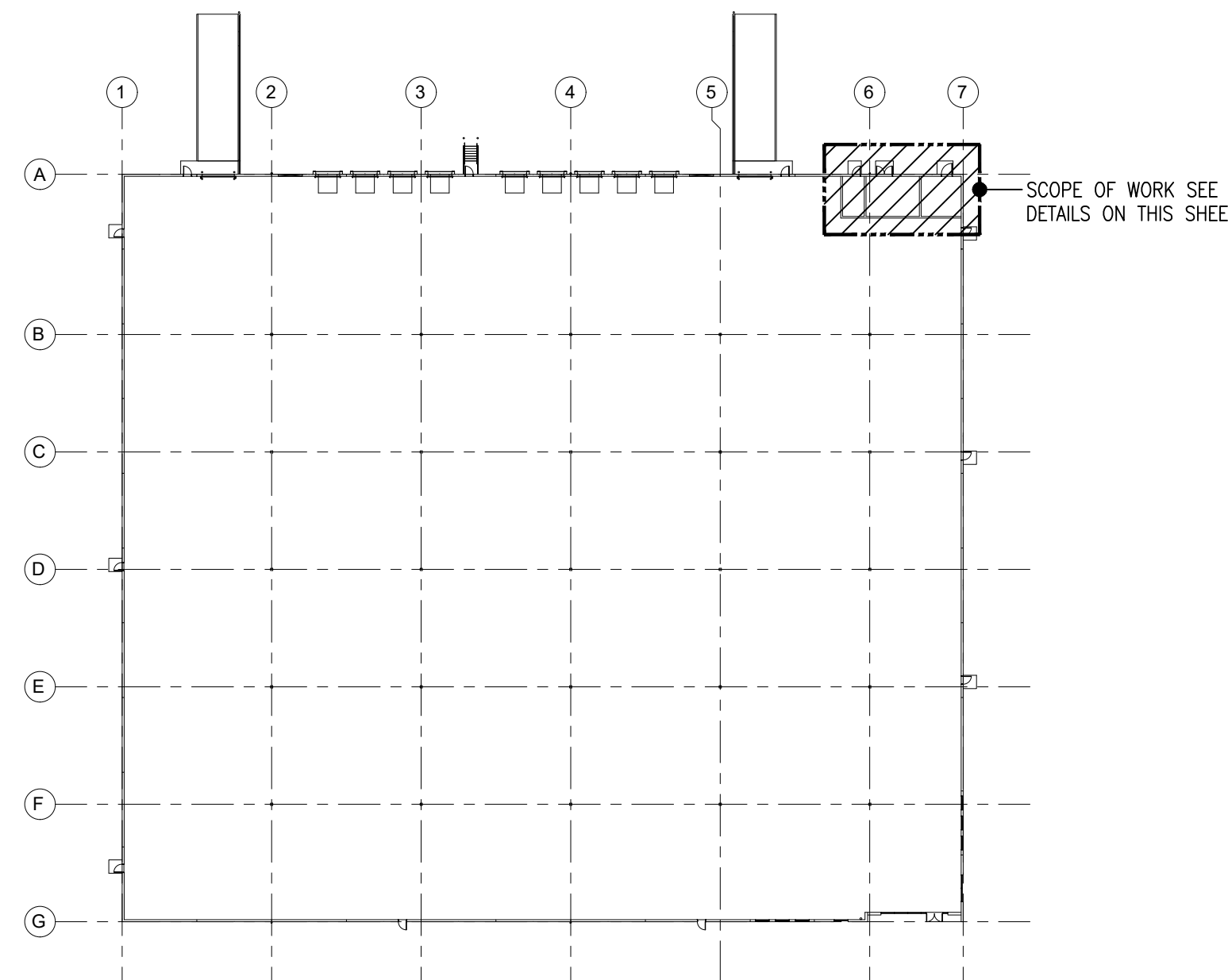

**KEY PLAN**  
SCALE: NONE