

DESIGNER / BUILDER

ARCO
DESIGN/BUILD

44 SOUTH BROADWAY, SUITE 1003
WHITE PLAINS, NY 10601
P: 914.821.5535 F: 914.306.6010

ADB | DESIGN SERVICES

PROJECT TITLE

ROCKLAND
LOGISTICS
CENTER BLDG 3

25 OLD MILL RD.
SUFFERN, NY 10901

OWNER

BROOKFIELD PROPERTIES
1 MEADOWLANDS PLAZA SUITE 802
EAST RUTHERFORD, NJ 07073

ARCHITECT

ADB | DESIGN SERVICES LLC
44 SOUTH BROADWAY, SUITE 1003
WHITE PLAINS, NY 10601

CIVIL ENGINEER

DYNAMIC ENGINEERING CONSULTANTS
1904 MAIN STREET
LAKE COMO, NJ 07719

STRUCTURAL ENGINEER

NATIONAL DESIGN BUILD SERVICES
325 S. ALABAMA ST. SUITE 200
INDIANAPOLIS, IN 46204

MECHANICAL ENGINEER

NATIONAL DESIGN BUILD SERVICES
11840 BORKMAN DRIVE
MARYLAND HEIGHTS, MO 63146

ELECTRICAL ENGINEER

FXB ENGINEERING
5 CHRISTY DRIVE, SUITE 307
CHADDYS FORD, PA 19317

PLUMBING ENGINEER

MCCARTHY ENGINEERING
2500 E HIGH STREET, SUITE 630
POTTSTOWN, PA 19464

FIRE PROTECTION ENGINEER

S.A. COMUNALE
2900 NEWPARK DRIVE
BARBERTON, OH 44203

SEAL

NY License #: 077635-1
NY License Expiration Date: 04/30/2026



Peter J. Bonner

KEY PLAN

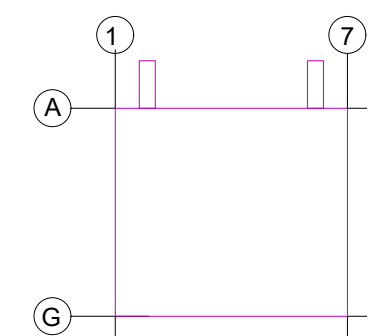

SUBMITTALS

NO.	DATE	DESCRIPTION
A	11.20.2024	ISSUE FOR REVIEW
B	02.02.2024	ISSUE FOR REVIEW
0	02.09.2024	ISSUE FOR PERMIT

PROJECT NO.
AS397-22 | NY154

DRAWN BY
NGF

SHEET TITLE

ELECTRICAL PANEL
SCHEDULES

SHEET NO.

E6.0

PANEL SCHEDULE "HH1"

VOLTS: 480Y/277V
AMPS: 200A MCB

PHASE: 3Ø
WIRE: 4W

LOCATION: MAIN ELEC. ROOM
MOUNTING: SURFACE

SHORT CIRCUIT RATING: 42KAIC
PANEL LOAD: 30.2 kVA (36.4 A)

CIR. NO.	DESCRIPTION	LOAD KVA	WIRE SIZE	CIRCUIT BKR			CIRCUIT BKR			WIRE SIZE	LOAD KVA	DESCRIPTION	CIR. NO.
				AMPS	POLES	Ø	AMPS	POLES					
1	COCKEY PUMP	0.90	#12	20	3	A	20	1	#10	0.37		SITE LIGHTING - WALL MOUNTED	2
3	▼	0.90	▼	▼	▼	B	20	1	#10	1.43		SITE LIGHTING - POLE MOUNTED	4
5	▼	0.90	▼	▼	▼	C	20	1	#10	1.91		SITE LIGHTING - POLE MOUNTED	6
7	AWH-1 (4.0 KW)	4.00	#12	20	1	A	20	1	#10	2.10		SITE LIGHTING - POLE MOUNTED	8
9	AWH-2 (4.0 KW)	4.00	#12	20	1	B	20	1	#10	1.77		SITE LIGHTING - POLE MOUNTED	10
11	SPARE			20	1	C	20	1				SPARE	12
13	SPARE			20	1	A	20	1				SPARE	14
15	SPARE			20	1	B	20	1				SPARE	16
17	SPACE ONLY					C						SPACE ONLY	18
19	SPACE ONLY					A						SPACE ONLY	20
21	SPACE ONLY					B						SPACE ONLY	22
23	SPACE ONLY					C						SPACE ONLY	24
25	SPACE ONLY					A						SPACE ONLY	26
27	SPACE ONLY					B						SPACE ONLY	28
29	SPACE ONLY					C						SPACE ONLY	30
31	SPACE ONLY					A						SPACE ONLY	32
33	SPACE ONLY					B						SPACE ONLY	34
35	SPACE ONLY					C						SPACE ONLY	36
37	PANEL "HL1" THRU 30KVA TRANSFORMER	1.57	#6	50	3	A	30	2	#8	3.84		ENCLOSED CIRCUIT BREAKER "ECB-1" THRU 10KVA TRANSFORMER	38
39	▼	1.79	▼	▼	▼	B	▼	▼	▼	3.84	▼		40
41	▼	0.92	▼	▼	▼	C						SPACE ONLY	42
				A	B	C							
				12.8	13.7	3.7							