

Demolition Key Notes

- WITHIN HATCHED AREA, REMOVE ALL CONSTRUCTION IN ITS ENTIRETY (WALLS, CEILINGS, FLOOR FINISHES, ETC). STRUCTURE TO REMAIN, TYPICAL UNO. REMOVE ALL FINISH MATERIALS AND OTHER ITEMS ATTACHED TO FACE OF WALLS SCHEDULED TO REMAIN, TYPICAL UNO. REMOVE FLOOR FINISHES INCLUDING ANY TILE SETTING BEDS, AND LEVEL SLABS WITH ADJACENT SLABS AS REQUIRED FOR SCHEDULED FLOOR FINISHES. REMOVE LOCKER BASES TO ADJACENT SLAB LEVELS AND PREP AREAS TO RECEIVE SCHEDULED FINISHES. PERFORM ABATEMENT PRIOR TO DEMOLITION. COORDINATE ADDITIONAL REQUIRED DEMOLITION WITH MECHANICAL, ELECTRICAL AND PLUMBING DRAWINGS.
- 1F REMOVE EXISTING WALL TILE WAINSCOT AND SETTING BED BACK TO EXISTING CMU WALL FACE. PREPARE SURFACE TO RECEIVE NEW WALL FINISH.
- 1G REMOVE INTERIOR PARTITION FULL-HEIGHT, PORTION AS INDICATED OR AS REQUIRED TO PERFORM SCHEDULED WORK. EXISTING STRUCTURE TO REMAIN.
- 1H SAW CUT, OR ENLARGE EXISTING, OPENING IN WALL TO EXTENT REQUIRED TO PERFORM SCHEDULED WORK. PROVIDE LINTEL PER LINTEL SCHEDULE. PATCH EXPOSED SURFACES TO MATCH ADJACENT FINISHES / SURFACES.
- 8B REMOVE DOOR AND FRAME COMPLETELY. PATCH EXPOSED SURFACES TO MATCH ADJACENT FINISHES / SURFACES.
- 9A REMOVE CEILING SYSTEM AND/OR SOFFIT SYSTEM IN ITS ENTIRETY. (ADJACENT SOFFITS TO REMAIN WHERE EXISTING UNO). REFER TO REFLECTED CEILING PLANS FOR ADDITIONAL INFORMATION. REFER TO OTHER DISCIPLINE'S DRAWINGS FOR ASSOCIATED WORK WITH CEILING MOUNTED ITEMS.
- 9B REMOVE PORTION OF CEILING SYSTEM AND/OR SOFFIT SYSTEM, TO EXTENT REQUIRED TO PERFORM NEW WORK. CAREFULLY TRIM CEILING GRID TO REMAIN. SALVAGE AND REINSTALL CEILING PANELS.
- 9C REMOVE AND SALVAGE FOR REINSTALLATION PORTION OF CEILING SYSTEM AND CEILING MOUNTED ITEMS / DEVICES. COORDINATE EXTENT REQUIRED WITH OTHER DISCIPLINE'S DRAWINGS.
- 9D REMOVE FLOOR FINISH, MASTIC AND WALL BASE TO EXTENT REQUIRED TO PERFORM SCHEDULED WORK. AT ALL AREAS OF FLOOR REMOVAL, LEVEL SLAB WITH ADJACENT SLABS AT LOCATIONS SCHEDULED TO RECEIVE FLOOR FINISH. INCLUDE CONCRETE FLOOR PATCHING AND LEVELING MATERIALS TO MAKE SURFACE LEVEL. PREPARE FOR FINISH. PATCH AREAS OF WALLS TO REMAIN THAT WERE DAMAGED BY REMOVAL OF WALL BASE.
- SUFFIX KEY (FLOOR FINISH IDENTIFICATIONS):  
A CARPET  
B CERAMIC FLOOR TILE  
I VAT/VST  
K WOOD FLOORING.
- 10B REMOVE TOILET PARTITIONS IN THEIR ENTIRETY. PATCH EXPOSED SURFACES TO MATCH ADJACENT FINISHES / SURFACES TO EXTENT REQUIRED TO PERFORM SCHEDULED WORK.
- 10C REMOVE TOILET AND BATH ACCESSORIES. PATCH EXPOSED SURFACES TO MATCH ADJACENT FINISHES / SURFACES TO EXTENT REQUIRED TO PERFORM SCHEDULED WORK.
- 10D REMOVE EXISTING SKYLIGHT SHAFT CONSTRUCTION TO UNDERSIDE OF DECK.
- 12B REMOVE DISPLAY CASEWORK (INCLUDING ALL ASSOCIATED COMPONENTS). PATCH EXPOSED SURFACES TO MATCH ADJACENT FINISHES / SURFACES. PROTECT AND DELIVER TO OWNERS STORAGE LOCATION FOR THEIR REUSE.
- 12C REMOVE EXISTING SKYLIGHT SHAFT CONSTRUCTION IN ITS ENTIRETY UP TO DECK. EXISTING ROOFED OVER SKYLIGHT OPENING TO REMAIN.
- 12D REMOVE EXISTING SHELVING SYSTEM COMPLETE.
- 13A REMOVE EXISTING OPERABLE PARTITION SYSTEM INCLUDING OVERHEAD SUPPORTING WALL CONSTRUCTION IN ITS ENTIRETY.
- 13B REMOVE EXISTING WALL MOUNTED LADDER IN ITS ENTIRETY. PATCH EXISTING WALL AT LADDER FASTENER LOCATIONS.
- 13C REMOVE EXISTING FLOOR ACCESS HATCH IN ITS ENTIRETY AND PREPARE EXISTING OPENING TO RECEIVE NEW ACCESS HATCH.
- 13D REMOVE EXISTING BENT STEEL LADDER STEPS IN THEIR ENTIRETY. PATCH EXISTING WALL AT STEP REMOVAL LOCATIONS.
- 14A REMOVE EXISTING WALL MOUNTED LADDER. PATCH WALLS TO MATCH EXISTING ADJACENT FINISHES.

General Demolition Notes

- A. - - - - - REMOVE ITEMS INDICATED BY DASHED LINE.
- B. KEYED DEMOLITION TAGS REFER TO SPECIFIC LOCATIONS AS FOLLOWS:
- DEMOLITION TAGS LOCATED WITHIN THE MIDDLE OF A SPACE REFER TO DEMOLITION OF ALL ITEMS OF THAT SAME TYPE WITHIN THAT ENTIRE SPACE.
  - DEMOLITION TAGS PLACED IMMEDIATELY ON OR ADJACENT TO A DASHED LINE INDICATING ITEM REMOVAL OR THAT HAVE A LEADER POINTING TO SPECIFIC ITEM(S) REFER TO DEMOLITION OF THAT SPECIFIC ITEM ONLY OF THAT TYPE WITHIN THAT SPACE.
  - DEMOLITION TAGS IN SERIES REFER TO DEMOLITION OF ALL THOSE ITEMS EITHER WITHIN THAT ENTIRE SPACE OR TO THE SPACE IDENTIFIED BY THAT LEADER.
- C. WHEN AN ITEM IS INDICATED TO BE DEMOLISHED REMOVE ALL ASSOCIATED COMPONENTS AS PART OF THAT WORK.
- D. ALL ARTWORK/PLAQUES NOT PERMANENTLY AFFIXED TO EXISTING CONSTRUCTION SHALL BE REMOVED AND STORED BY OWNER PRIOR TO BEGINNING DEMOLITION WORK. CONTACT OWNERS AGENTS IF ANY ARTWORK/PLAQUES ARE ENCOUNTERED PRIOR TO START OF DEMOLITION WORK.
- E. COORDINATE DEMOLITION PLANS WITH NEW WORK PLANS FOR DIMENSIONS OF CERTAIN ITEMS.
- F. COORDINATE ALL REMOVALS WITH ABATEMENT DRAWINGS.

Alternate Legend

- ALTERNATE NO. HS-1
- ALTERNATE NO. HS-2
- ALTERNATE NO. HS-3

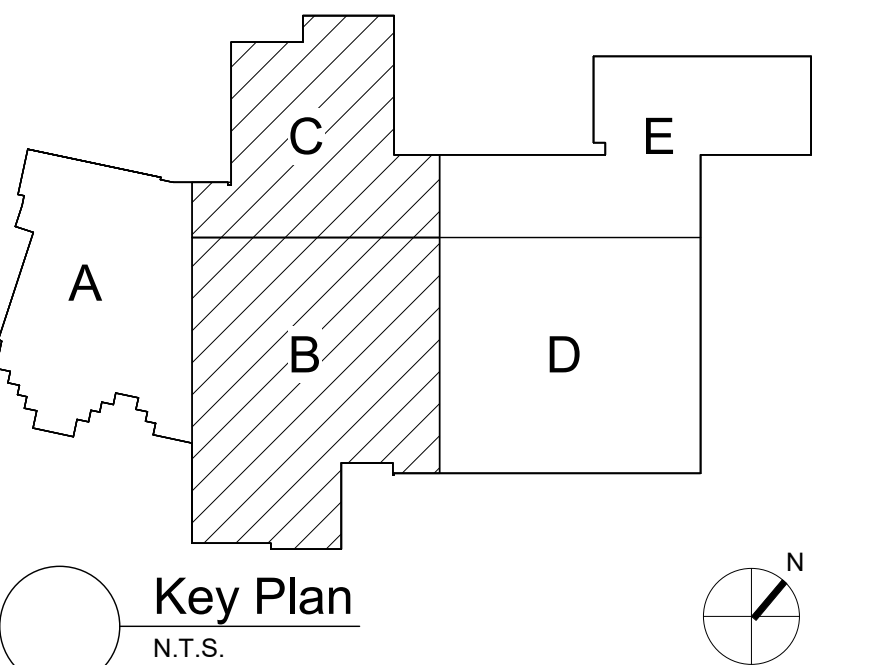

S.E.D. Control No. 62-18-01-06-0-007-019

Rev. No.: Date: Description:



complex world CLEAR SOLUTIONS

Tetra Tech Engineers, Architects & Landscape Architects, P.C.

BID SET



Walkkill Central School District  
Walkkill, New York

Reconstruction to:  
Walkkill Senior High School

First Floor Demolition Plan - Partial  
Areas B and C

Drawn By: TS Date: 06/30/2023 Drawing Number:  
Project No.: 17597-22002 AA101

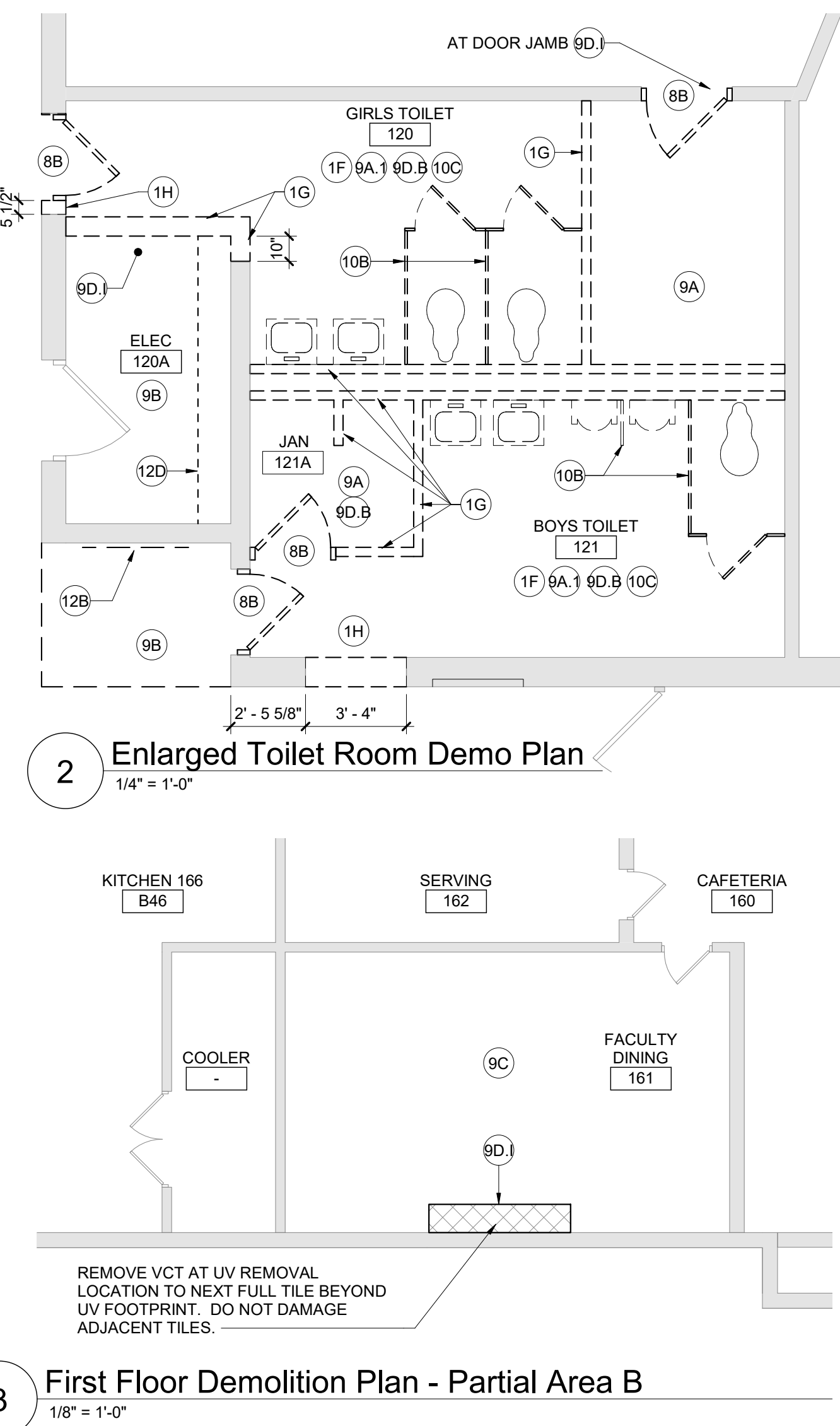

3 First Floor Demolition Plan - Partial Area B