

2 Basement Key Plan  
3/64" = 1'-0"

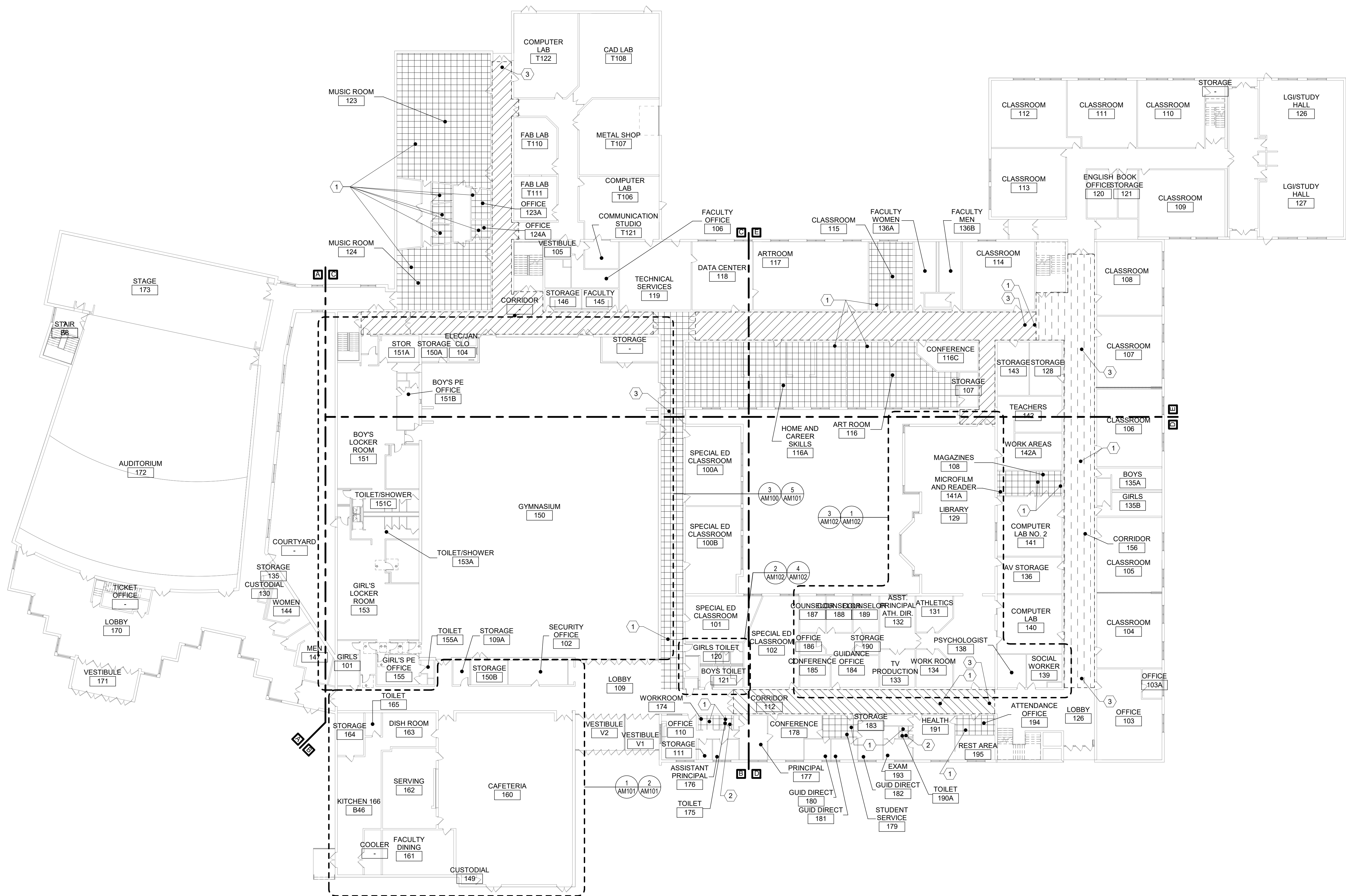

1 First Floor Key Plan  
3/64" = 1'-0"

- General Notes**
- THE FOLLOWING GENERAL NOTES APPLY TO ALL "AM" SERIES DRAWINGS.
  - REFER TO ALL CONTRACT DOCUMENTS, DRAWINGS AND SPECIFICATIONS FOR DETAILED STANDARDS AND REQUIREMENTS.
  - REPORT UNSAFE OR UNSATISFACTORY CONDITIONS IN WRITING TO ARCHITECT AND RESOLVE ISSUES BEFORE PROCEEDING.
  - WORK INCLUDES ALL LABOR AND MATERIALS REQUIRED TO PROVIDE COMPLETE WORKING SYSTEMS.
  - COORDINATE PHASING REQUIREMENTS AT JOB MEETINGS AND ON WORK SCHEDULES.
  - DO NOT SCALE DRAWINGS. PIPING AND DUCTWORK ARE SHOWN DIAGRAMMATICALLY. IT IS NOT POSSIBLE TO SHOW EVERY TRANSITION, FITTING, ASPECT RATIO CHANGE, ETC.; PROVIDE AS REQUIRED TO FIT WITHIN STRUCTURAL CONSTRAINTS. EXAMINE CONDITIONS UNDER WHICH THE WORK IS TO BE PERFORMED AND VERIFY ALL ACCESS, LOCATIONS, DIMENSIONS, ARRANGEMENTS, ELECTRICAL CHARACTERISTICS AND INTERFERENCE IN THE FIELD PRIOR TO BID.
  - VERIFY EXTENT OF CEILING WORK SHOWN ELSEWHERE IN THE CONTRACT DOCUMENTS. PROVIDE FOR ADDITIONAL CEILING REQUIRED FOR CONTRACT WORK.
  - DEMOLITION DRAWINGS SHOW THE GENERAL SCOPE OF ITEMS AND SYSTEMS TO BE REMOVED. IT IS NOT THE INTENT TO SHOW ALL ITEMS TO BE REMOVED. FIELD VERIFY AND REMOVE ALL ASSOCIATED ITEMS BACK TO POINT OF CONTINUED SERVICE, UNLESS OTHERWISE NOTED. VERIFY WHAT ALL EQUIPMENT SERVES PRIOR TO REMOVAL.
  - GIVE ALL REMOVED EQUIPMENT TO THE OWNER. DELIVER ON SITE WHERE DESIGNATED BY THE OWNER. PROMPTLY REMOVE FROM THE SITE AND LEGALLY DISPOSE OF ANY SUCH ITEMS DECLINED BY OWNER.
  - IF UNANTICIPATED MECHANICAL, ELECTRICAL, OR STRUCTURAL CONFLICTS ARE ENCOUNTERED, INVESTIGATE AND REPORT BOTH NATURE AND EXTENT OF THE CONFLICT. RE-ROUTE WORK AS REQUIRED.
  - CUT, DRILL, OR OTHERWISE CREATE OPENINGS AS NEATLY AS POSSIBLE, AS REQUIRED FOR THE INDICATED CONTRACT WORK. PROVIDE SUPPORT AS REQUIRED FOR AND USE METHODS LEAST LIKELY TO DAMAGE ELEMENTS TO REMAIN. PRIOR TO WORK, VERIFY LOCATIONS OF ALL STRUCTURAL MEMBERS INCLUDING CROSS BRACING, ELECTRICAL WIRING, PLUMBING, ETC. PROMPTLY NOTIFY ARCHITECT OF ANY CONFLICTS. DO NOT CUT ANY STRUCTURAL MEMBERS OR OTHER SERVICES UNTIL SPECIFICALLY DIRECTED TO DO SO. PENDING RECEIPT OF DIRECTIVE, REARRANGE SCHEDULE AS NECESSARY TO CONTINUE OVERALL JOB PROGRESS WITHOUT DELAY.
  - PATCH ALL DISTURBANCES RESULTING FROM DEMOLITION OR NEW WORK TO MATCH SURROUNDING SURFACES. PATCH FOLLOWING DEMOLITION, AND AGAIN FOLLOWING WORK. WHERE HOLES REMAIN FROM REMOVALS, INFILL AND PATCH TO MATCH UNLESS HOLE IS TO BE REUSED.
  - PROTECT ALL CONTRACT EQUIPMENT, ELEMENTS TO REMAIN, OWNERS' BELONGINGS, AND EQUIPMENT TO BE REUSED OR RETAINED BY OWNER DURING ALL CONTRACT WORK. AT NO ADDITIONAL COST TO OWNER, REPAIR OR REPLACE ITEMS WHICH ARE DAMAGED.
  - THOROUGHLY CLEAN FOLLOWING DEMOLITION AND BEFORE BEGINNING CONTRACT INSTALLATIONS. THOROUGHLY CLEAN AGAIN DURING AND FOLLOWING CONTRACT WORK AS REQUIRED. LEAVE ALL WORK AREAS CLEANER THAN FOUND. LEGALLY DISPOSE OF ALL CONSTRUCTION DEBRIS.
  - PROVIDE TEMPORARY PIPING, DUCT, HEAT, WEATHERPROOFING, ETC. TO SERVICES TO REMAIN UNTIL PERMANENT INSTALLATIONS CAN BE MADE.
  - ALL EXCESS MATERIALS AND SCRAPS ARE CONTRACTOR'S PROPERTY. PROMPTLY REMOVE FROM SITE UNLESS SPECIFICALLY DIRECTED OTHERWISE.
  - EXISTING HVAC COMPONENTS IN THIS BUILDING MAY CONTAIN, BE ASBESTOS CONTAINING OR OTHER HAZARDOUS MATERIALS. REFER TO ABATEMENT SERIES DRAWINGS AND SPECIFICATIONS COMPLETE FOR ADDITIONAL INFORMATION. PROVIDE FOR RE-INSULATION AS SPECIFIED FOR ALL EXISTING TO REMAIN HVAC COMPONENTS WHERE INSULATION IS REMOVED AS A PART OF ABATEMENT WORK.
  - SEAL ALL FLOOR, WALL AND CEILING PENETRATIONS PER FIRE RESISTANCE RATINGS NOTED ON BG-SERIES DRAWINGS, BUT NOT LESS THAN 1-HOUR, AND IN ACCORDANCE WITH SECTION 07 84 13 - PENETRATION FIRESTOPPING. THIS INCLUDES ALL NEW PENETRATIONS AND EXISTING UNFIRESTOPPED PENETRATIONS CREATED BY REMOVALS, AS REQUIRED TO PERFORM THE WORK.

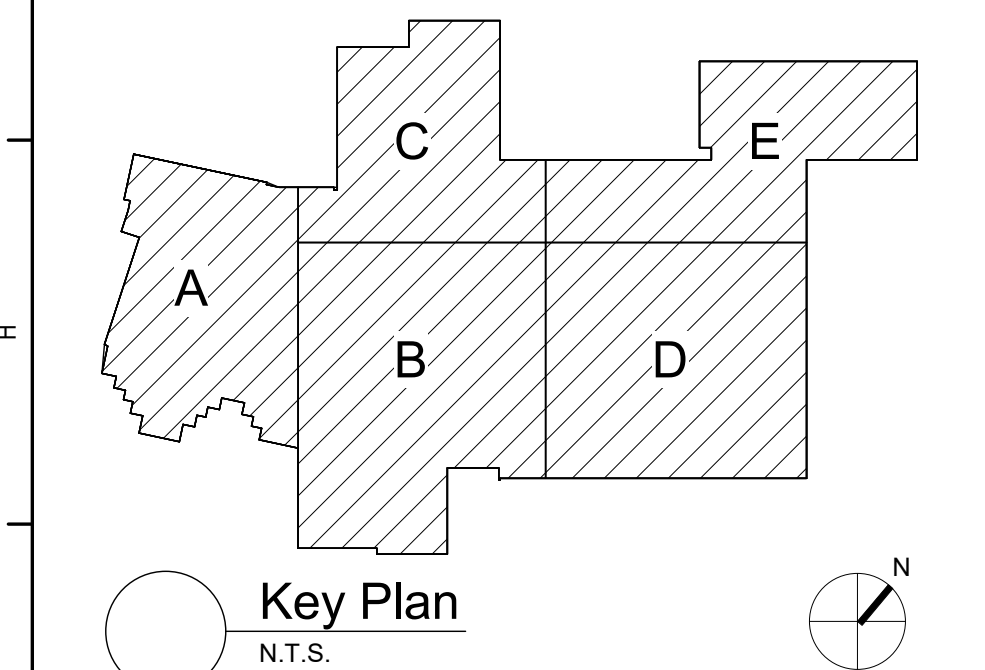

S.E.D. Control No. 62-18-01-06-0-007-019

Rev. No.: Date: Description:



complex world | CLEAR SOLUTIONS

Tetra Tech Engineers, Architects & Landscape Architects, P.C.



Walkkill Central School District  
Walkkill, New York

Reconstruction to:  
Walkkill Senior High School

Basement and First Floor Key Plans

Drawn By: JPF/1pgm Date: 06/30/2023 Drawing Number:  
Project No.: 17597-22002  
AM050