

Demolition Key Notes

- (1G) REMOVE INTERIOR PARTITION FULL-HEIGHT, PORTION AS INDICATED OR AS REQUIRED TO PERFORM SCHEDULED WORK. EXISTING STRUCTURE TO REMAIN.
- (8B) REMOVE DOOR AND FRAME COMPLETELY. PATCH EXPOSED SURFACES TO MATCH ADJACENT FINISHES / SURFACES.
- (9A) REMOVE SPLINE CEILING SYSTEM IN ITS ENTIRETY (ADJACENT SOFFITS TO REMAIN WHERE EXISTING UNO). REFER TO REFLECTED CEILING PLANS FOR ADDITIONAL INFORMATION. REFER TO OTHER DISCIPLINE'S DRAWINGS FOR ASSOCIATED WORK WITH CEILING MOUNTED ITEMS.
- (9A.1) REMOVE CEILING SYSTEM AND/OR SOFFIT SYSTEM IN ITS ENTIRETY.
- (9C) REMOVE AND SALVAGE FOR REINSTALLATION PORTION OF CEILING SYSTEM AND CEILING MOUNTED ITEMS / DEVICES. COORDINATE EXTENT REQUIRED WITH STRUCTURAL DRAWINGS.
- (9D.X) REMOVE FLOOR FINISH, MASTIC AND WALL BASE TO EXTENT REQUIRED TO PERFORM SCHEDULED WORK. AT ALL AREAS OF FLOOR REMOVAL, LEVEL SLAB WITH ADJACENT SLABS AT LOCATIONS SCHEDULED TO RECEIVE FLOOR FINISH. INCLUDE CONCRETE FLOOR PATCHING AND LEVELING MATERIALS TO MAKE SURFACE LEVEL. PREPARE FOR FINISH. PATCH AREAS OF WALLS TO REMAIN THAT WERE DAMAGED BY REMOVAL OF WALL BASE.
- SUFFIX KEY (FLOOR FINISH IDENTIFICATIONS):
A. CARPET.
B. VCT.
- (10A) REMOVE EXISTING OPERABLE PARTITION SYSTEM INCLUDING OVERHEAD SUPPORTING WALL/CONSTRUCTION IN ITS ENTIRETY.
- WITHIN HATCHED AREA: REMOVE ALL CONSTRUCTION IN ITS ENTIRETY. STRUCTURE TO REMAIN, TYPICAL UNO. REMOVE ALL FINISH MATERIALS OR OTHER ITEMS ATTACHED TO FACE OF WALLS SCHEDULED TO REMAIN, TYPICAL UNO. REMOVE LOCKER BASES TO ADJACENT SLAB LEVELS AND PREP AREAS TO RECEIVE SCHEDULED FINISHES. PERFORM ABATEMENT PRIOR TO DEMOLITION. COORDINATE ADDITIONAL REQUIRED DEMOLITION WITH MECHANICAL, ELECTRICAL AND PLUMBING DRAWINGS.

General Demolition Notes

- A. - - - REMOVE ITEMS INDICATED BY DASHED LINE.
- B. KEYED DEMOLITION TAGS REFER TO SPECIFIC LOCATIONS AS FOLLOWS:
- DEMOLITION TAGS LOCATED WITHIN THE MIDDLE OF A SPACE REFER TO DEMOLITION OF ALL ITEMS OF THAT SAME TYPE WITHIN THAT ENTIRE SPACE.
 - DEMOLITION TAGS PLACED IMMEDIATELY ON OR ADJACENT TO A DASHED LINE INDICATING ITEM REMOVAL OR THAT HAVE A LEADER POINTING TO SPECIFIC ITEM(S) REFER TO DEMOLITION OF THAT SPECIFIC ITEM ONLY OF THAT TYPE WITHIN THAT SPACE.
 - DEMOLITION TAGS IN SERIES REFER TO DEMOLITION OF ALL THOSE ITEMS EITHER WITHIN THAT ENTIRE SPACE OR TO THE SPACE IDENTIFIED BY THAT LEADER.
- C. WHEN AN ITEM IS INDICATED TO BE DEMOLISHED REMOVE ALL ASSOCIATED COMPONENTS AS PART OF THAT WORK.
- D. ALL ARTWORK NOT PERMANENTLY AFFIXED TO EXISTING CONSTRUCTION SHALL BE REMOVED AND STORED BY OWNER PRIOR TO BEGINNING DEMOLITION WORK. CONTACT OWNERS AGENT(S) IF ANY ARTWORK IS ENCOUNTERED PRIOR TO START OF DEMOLITION WORK.

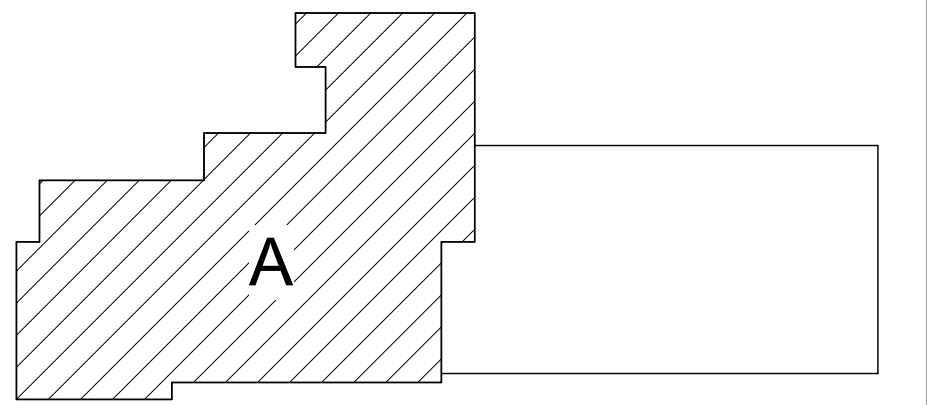

Key Plan
N.T.S.

S.E.D. Control No. 62-18-01-06-0-002-015

Rev. No.: Date: Description:



complex world
CLEAR SOLUTIONS

Tetra Tech Engineers, Architects
& Landscape Architects, P.C.



Wallkill Central School District
Wallkill, New York

Reconstruction to:
John G. Borden Middle School

First Floor Demolition Plan - Area A

Drawn By: TS Date: 06/30/2023 Drawing Number:
Project No.: 17597-22002 BA100