

- Keyed Notes:**
- 1 PROVIDE (3)W3/0, (1)W6G IN 2" C. TO MDP. PROVIDE 200A, 208V, 3P BREAKER
 - 2 PROVIDE (3)W1/0, (1)W6G IN 1-1/2" C. TO MDP. PROVIDE 175A, 208V, 3P BREAKER
 - 3 PROVIDE (3)W4, (1)W8G IN 1" C. TO MDP. PROVIDE 100A, 208V, 3P BREAKER
 - 4 PROVIDE (2)W12, (1)W12G IN 1/2" C. TO PANEL PP1-UV. PROVIDE 20A, 120V, 1P BREAKER
 - 5 PROVIDE FAN SHUTDOWN AND SUPPLY SIDE DUCT DETECTOR. CONNECT TO EXISTING FIRE ALARM CIRCUIT. PROVIDE REQUIRED TESTING AND PROGRAMMING.
 - 6 PROVIDE (2)W12, (1)W12G IN 1/2" C. TO PANEL PP-MB2. PROVIDE 20A, 208V, 2P BREAKER
 - 7 PROVIDE FAN SHUTDOWN AND CONNECT TO EXISTING FIRE ALARM CIRCUIT. PROVIDE REQUIRED TESTING AND PROGRAMMING.
 - 8 PROVIDE (2)W12, (1)W12G IN 1/2" C. TO PANEL PP-MB2. PROVIDE 20A, 120V, 1P BREAKER

- General Notes:**
- A. REFER TO DRAWING AE050 FOR GENERAL NOTES
 - B. REFER TO AE600 PANEL BOARD SCHEDULES FOR ADDITIONAL INFORMATION

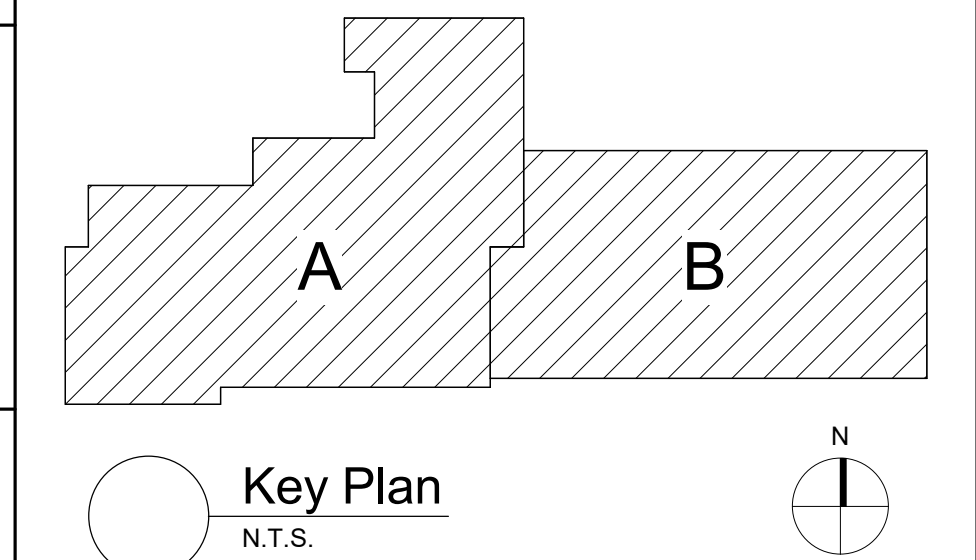

S.E.D. Control No. 62-18-01-06-0-002-015

Rev. No.:	Date:	Description:

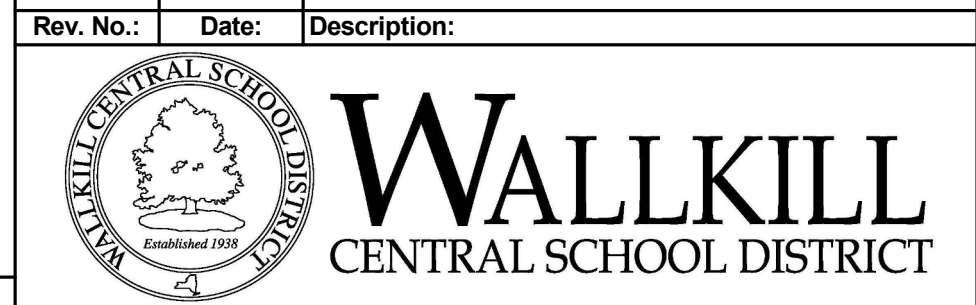

complex world
CLEAR SOLUTIONS

Tetra Tech Engineers, Architects
& Landscape Architects, P.C.

BID SET

TETRA TECH
ARCHITECTS & ENGINEERS

Wallkill Central School District
Wallkill, New York

Reconstruction to:
John G. Borden Middle School

Roof Plan

Drawn By:
GLK/ded

Date:
06/30/2023

Project No.:
17597-22002

Drawing Number:
BE162