

THE NEW YORK STATE UNIFORM FIRE PREVENTION AND BUILDING CODE (THE "UNIFORM CODE"); CONSTRUCTION SHALL CONFORM TO THE CURRENT EDITIONS OF THE 2018 INTERNATIONAL BUILDING CODE (IBC), THE 2020 NEW YORK STATE CODE SUPPLEMENT, THE 2018 INTERNATIONAL ENERGY CONSERVATION CODE (IECC), THE 2020 SUPPLEMENT TO THE NEW YORK STATE ENERGY CONSERVATION CONSTRUCTION CODE, AS WELL AS ALL OTHER CURRENT LOCAL, STATE, AND FEDERAL CODES AND REGULATIONS APPLICABLE TO THIS PROJECT. CONTRACTOR SHALL CONSTRUCT THE PROJECT IN ACCORDANCE WITH THE APPLICABLE CODES.

**OCCUPANCY CLASSIFICATION:** (CHAPTERS 3 & 5)  
☒ SINGLE   ☐ MIXED   ☐ NON-SEPARATED   ☐ COMBINATION  
 IF SEPARATED, FIRE RESISTANCE RATING OF FIRE BARRIER (TABLE 508.4): \_\_\_\_\_ HR  
 OCCUPANCY CLASSIFICATION(S): U  
 USES: HIGHWAY VEHICLE & MISCELLANEOUS STORAGE

**AUTOMATIC SPRINKLER SYSTEM PROVIDED:** ☐ YES ☒ NO

**NFPA STANDARD:** ☐ 13 ☐ 13R

HEIGHT & AREA - ACTUAL			(CHAPTER 5)
BUILDING HEIGHT	HEIGHT IN FEET	HEIGHT IN STORIES	
	28' – 3"	1	
BUILDING AREA SUMMARY	BUILDING AREA		
FIRST	11,644 SF		
TOTAL (NOT INCLUDING BASEMENT)	11,644 SF		

HEIGHT & AREA – ALLOWABLE				(CHAPTER 5)
AREA PER TABLE 504.3 & 506.2				
OCCUPANCY CLASSIFICATION	TABULAR AREA	TABULAR HEIGHT		INCREASE DUE TO FRONTAGE ALLOWED, THEREFORE ALLOWABLE AREA INCREASED TO 14,875 SF
		FEET	STORIES	
U	8,500 SF	55 FT	2	

	<b>REQUIRED</b>	<b>PROVIDED</b>	<b>SECTION</b>
STRUCTURAL FRAME	0	0	TABLE 601
BEARING WALLS (EXTERIOR)	NA	NA	TABLE 601
BEARING WALLS (INTERIOR)	NA	NA	TABLE 601
NON-BEARING WALLS (EXTERIOR)	0	0	TABLE 601
NON-BEARING WALLS (INTERIOR)	0	0	TABLE 601
FLOOR CONSTRUCTION	0	0	TABLE 601
ROOF CONSTRUCTION	0	0	TABLE 601
VERTICAL EXIT ENCLOSURE	NA	NA	713.4
SHAFT ENCLOSURE	NA	NA	713.4
CORRIDORS	NA	NA	TABLE 1020.1

INTERIOR FINISHES:			
BASED ON MOST RESTRICTIVE			
USE GROUP B	REQUIRED	PROVIDED	SECTION
WALLS & CEILING: EXITS	NA	NA	TABLE 803.13
WALLS & CEILING: CORRIDORS	NA	NA	TABLE 803.13
WALLS & CEILING: ROOMS	NA	NA	TABLE 803.13
FLOORS	NA	NA	TABLE 803.13

1. ALL WORK SHALL CONFORM TO FEDERAL, STATE AND LOCAL CODES AS INTERPRETED BY THE LOCAL AUTHORITY HAVING JURISDICTION.

2. DO NOT INSTALL FIRE EXTINGUISHERS/CABINETS/BRACKETS UNTIL ALL LOCATIONS HAVE BEEN REVIEWED AND APPROVED BY THE CODE AUTHORITY HAVING JURISDICTION. CONTRACTOR SHALL COORDINATE WITH FIRE MARSHALL PRIOR TO INSTALLATION.

3. THE ARCHITECTS CERTIFICATION ON THIS PROJECT IS ONLY FOR THE CONSTRUCTION WORK SHOWN TO BE DONE. IT DOES NOT CONSTITUTE APPROVAL OF ANY PRE-EXISTING CONDITIONS OR REVIEW OF THOSE CONDITIONS FOR CODE COMPLIANCE.

4. THE ARCHITECTS CERTIFICATION ON THIS PROJECT IS FOR COMPLIANCE WITH THE BUILDING CODE OF NEW YORK STATE AND ITS VARIOUS REFERENCE STANDARDS, FOR PURPOSES OF OBTAINING A BUILDING PERMIT THROUGH THE AUTHORITY HAVING JURISDICTION AND TO CONVEY CONSTRUCTION REQUIREMENTS FOR THE PROJECT. CERTIFICATION DOES NOT GUARANTEE COMPLIANCE WITH LOCAL CODES THAT MAY APPLY.

5. GENERAL CONDITIONS OF THE CONTRACT FOR CONSTRUCTION, AIA DOCUMENT A201-2007 AND ANY OTHER DOCUMENTS AS PROVIDED BY THE OWNER SHALL BE INCORPORATED INTO THE OWNER-CONTRACTOR CONTRACT BY REFERENCE.

6. CONSTRUCTION SHALL CONFORM TO CURRENT EDITIONS OF THE NEW YORK STATE UNIFORM FIRE PREVENTION AND BUILDING CODE (THE "UNIFORM CODE"); CONSTRUCTION SHALL CONFORM TO CURRENT EDITIONS OF THE 2018 INTERNATIONAL BUILDING CODE (IBC) AND THE 2018 INTERNATIONAL ENERGY CONSERVATION CODE (IECC); THE 2020 SUPPLEMENT TO THE NEW YORK STATE ENERGY CONSERVATION CONSTRUCTION CODE, 2010 AMERICAN SOCIETY OF MECHANICAL ENGINEERS (ASME) YOUNG WOODS DESIGN STANDARD FOR ACCESSIBLE DESIGN (28 CFR PART 36, SUBPART D); 2009 ADA ACCESSIBILITY AND USABLE BUILDINGS AND FACILITIES (504 AND 508); AS WELL AS WITH ALL OTHER CURRENT LOCAL, STATE AND FEDERAL CODES AND REGULATIONS APPLICABLE TO THIS PROJECT. CONTRACTOR SHALL CONSTRUCT THE PROJECT IN ACCORDANCE WITH THE APPLICABLE CODES RELEVANT TO THIS PROJECT.

7. CONTRACTOR IS RESPONSIBLE FOR OBTAINING ALL REQUIRED PERMITS AND PAYMENT OF ALL PERMIT AND APPLICATION FEES FOR THE CONSTRUCTION OF THE PROJECT.

8. TO THE BEST OF MY KNOWLEDGE, BELIEF AND PROFESSIONAL JUDGEMENT, THESE PLANS ARE IN CONFORMANCE WITH THE 2020 SUPPLEMENT OF THE NEW YORK STATE ENERGY CONSERVATION CONSTRUCTION CODE.

9. THE FOLLOWING IS AN EXCERPT FROM THE NEW YORK EDUCATION LAW ARTICLE 145 SECTION 7209 AND APPLIES TO THESE DRAWINGS: "IT IS A VIOLATION OF THIS LAW FOR ANY PERSON UNLESS HE IS ACTING UNDER THE DIRECT SUPERVISION OF A LICENSED ARCHITECT TO ALTER AN ITEM IN ANY WAY," IF ANY ITEM BEARING THE SEAL OF AN ARCHITECT IS ALTERED, THE ALTERING ARCHITECT SHALL AFFIX HIS SEAL AND NOTATION "ALTERED BY" FOLLOWED BY HIS SIGNATURE AND DATE OF SUCH ALTERATION AND SPECIFIC DESCRIPTION OF THE ALTERATION.

FIRE PROTECTION SYSTEMS:

CHAPTER 9

SIZE AND LOCATION OF FIRE AREAS INDICATED ON CODE COMPLIANCE DRAWING(S)

FIRE PROTECTION SYSTEM	REQUIRED	PROVIDED	SECTION
AUTOMATIC SPRINKLER	-	-	903
ALTERNATIVE AUTO FIRE EXIT	-	-	904
STANDPIPE	-	-	905
PORTABLE FIRE EXTINGUISHER	NO	YES	906
FIRE ALARM & DETECTION	-	-	907
EMERGENCY ALARM	-	-	908
SMOKE CONTROL SYSTEM	-	-	909
SMOKE & HEAT VENTS	-	-	910
FIRE COMMAND CENTER	-	-	911

MEANS OF EGRESS:		CHAPTER 10
DESIGN OCCUPANT LOAD SUMMARY		
FLOOR LEVEL	DESIGN OCCUPANT LOAD	
FIRST	58	
TOTAL	58	

MEANS OF EGRESS ELEMENT	REQUIRED	PROVIDED	SECTION
NUMBER OF EXITS	2	6	TABLE 1006.2.1
EXIT ACCESS TRAVEL DISTANCE	300	75	TABLE 1017.2
DEAD-END LIMIT	20	-	1020.4
COMMON PATH OF TRAVEL LIMIT	75	75	1006.2.1

ELEMENT	REQUIRED	PROVIDED	SECTION
DOORS – FIRST FLOOR	2.8	36	1005.3.2
STAIRS	NA	NA	1005.3.1
CORRIDORS – FIRST FLOOR	44" MIN	-	1020.2

[illegible]

SEPARATE FACILITIES FOR EACH GENDER REQUIRED?	<input type="checkbox"/> YES	<input checked="" type="checkbox"/> NO	2902.2
SEPARATE EMPLOYEE FACILITIES REQUIRED?	<input type="checkbox"/> YES	<input checked="" type="checkbox"/> NO	2902.2
LOCATION OF EMPLOYEE FACILITIES COMPLIES?	<input checked="" type="checkbox"/> YES	<input type="checkbox"/> NO	2902.2
LOCATION OF PUBLIC FACILITIES COMPLIES?	<input checked="" type="checkbox"/> YES	<input type="checkbox"/> NO	2902.2
OTHER PLUMBING FIXTURE REQUIREMENTS?	Lavatories will be provided in new highway garage facility		

• TO THE BEST OF OUR KNOWLEDGE, BELIEF, AND PROFESSIONAL JUDGEMENT, THE DESIGN IS IN COMPLIANCE WITH THE ENERGY CODE. THIS STATEMENT IS BEING PROVIDED AS REQUIRED OF THE 2020 NYS ENERGY CODE SUPPLEMENT, SECTION C103.2.2.

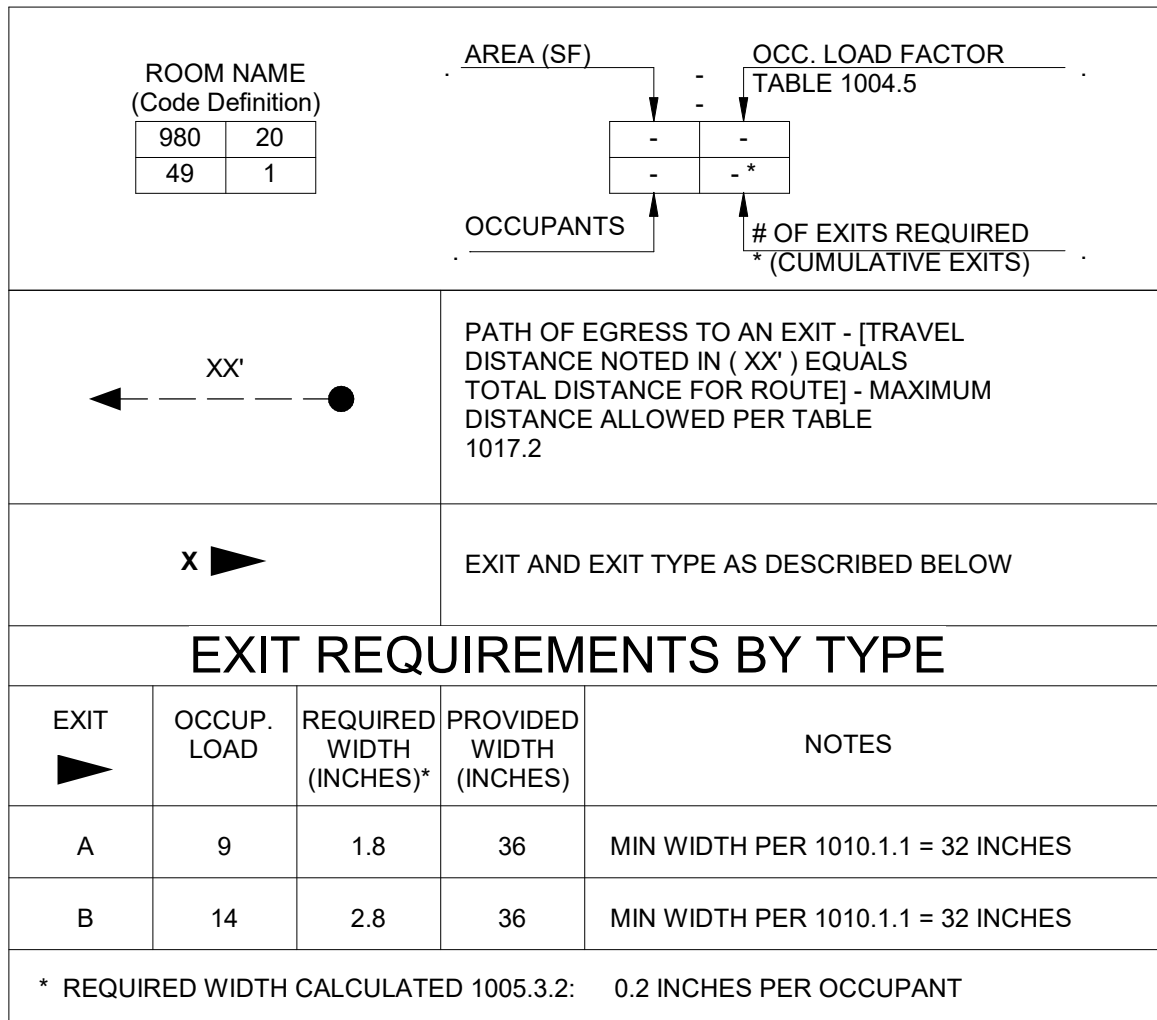

EXIT ▶	OCCUP. LOAD	REQUIRED WIDTH (INCHES)*	PROVIDED WIDTH (INCHES)	NOTES
A	9	1.8	36	MIN WIDTH PER 1010.1.1 = 32 INCHES
B	14	2.8	36	MIN WIDTH PER 1010.1.1 = 32 INCHES
* REQUIRED WIDTH CALCULATED 1005.3.2:				0.2 INCHES PER OCCUPANT

**DELAWARE**  
**ENGINEERING, D.P.C.**  
CIVIL AND ENVIRONMENTAL ENGINEERING

28 MADISON AVENUE EXTENSION, ALBANY, NY 12203 • 518.452.1290  
55 SOUTH MAIN ST. ONEONTA, NY 13820 • 518.432.8073  
16 EAST MARKET ST. RED HOOK, NY 12571 • 518.452.1290  
548 BROADWAY, MONTICELLO, NY 12071 • 845.791.7777  
223 MAIN ST. GOSHEN, NY 10824 • 845.615.9232

[illegible]

**RHINEBECK WTP  
IMPROVEMENTS  
VILLAGE OF RHINEBECK  
DUTCHESS COUNTY, NY**

## CODE COMPLIANCE & LIFE SAFETY PLANS

A001

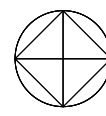

WARNING - IT IS A VIOLATION OF NEW YORK EDUCATION LAW SECTION 7209.2, FOR ANY PERSON, UNLESS HE IS ACTING UNDER THE DIRECTION OF A LICENSED PROFESSIONAL ENGINEER OR LAND SURVEYOR, TO ALTER THIS DOCUMENT IN ANY WAY. IF ALTERED THE ALTERING PERSON SHALL COMPLY WITH THE REQUIREMENTS OF NEW YORK EDUCATION LAW, SECTION 7209.2.