



HEALTHCARE
ARCHITECTURE
DESIGN
PLANNING

Montefiore Nyack Hospital
160 North Midland Avenue
Nyack, New York 10960

***Outpatient Diagnostic
& Treatment Facility***
18 North Highland Avenue
Nyack, NY 10960

Manual 2 of 2
Equipment Specifications

Project No.: 23035

**Issued for Bidding
February 3, 2025**

Pomarico Design Studio Architecture, PLLC
Architect/Planner

Michael A. Pomarico, Architect
New York License No. 019680
19 Front Street
Newburgh, NY 12508
Tel: 845-561-0448
Fax: 845-561-0446
solutions@healthcaredesign.com

Pomarico Design Studio Architecture, PLLC

19 Front Street, Newburgh, NY 12550
171 E. 117th Street, New York, NY 10035

T:845-561-0448 | F:845-561-0446
www.healthcaredesign.com
solutions@healthcaredesign.com

Outpatient Diagnostic & Treatment Facility

EQUIPMENT SPECIFICATIONS

ACCESSORY EQUIPMENT

A01a GRAB BAR – 42”
A01b GRAB BAR – 36”
A01g GRAB BAR – 18”
A02q TOILET TISSUE DISPENSER
A03b SOAP DISPENSER
A03n ANTISEPTIC GEL DISPENSER
A05q PAPER TOWEL DISPENSER
A06e VANITY MIRROR
A29b GLOVE DISPENSER
A30a SHARPS CONTAINER
A33a CUBICLE TRACK

COMMUNICATION EQUIPMENT

C08a OFFICE TELEPHONE
C08d COURTESY TELEPHONE
C12f TELEVISION
C16e TELEVISION WALL MOUNT
C17a COMPUTER WORKSTATION
C19f PRINTER – FREESTANDING

DIETARY EQUIPMENT

D01c REFRIGERATOR - FREESTANDING
D07j MICROWAVE
D27a WATER COOLER

FIXED EQUIPMENT

E10b DIAGNOSTIC INSTRUMENT SET
E42a LOCKER SYSTEM

FURNITURE

F02a GUEST CHAIR
F03a TASK CHAIR
F05a CAFETERIA/DINING CHAIR
F06a DESK SYSTEM
F07b FILING CABINET
F09c END TABLE

**Montefiore Nyack Hospital
18 North Highland Avenue
Nyack, New York 10960**

02/03/2025

Outpatient Diagnostic & Treatment Facility

FURNITURE (CONT'D)

F09d CAFETERIA/DINING TABLE

MOVEABLE EQUIPMENT

M02b CODE CART
M04d EXAM CHAIR
M08b WIRED RACK
M11j MOBILE VITALS
M12d SOILED LINEN HAMPER
M13b WASTE RECEPTACLE
M13c WASTE RECEPTACLE
M13d WASTE RECEPTACLE
M16a WHEELCHAIR
M28b EXAMINATION ROOM STOOL
M34g PHYSICIAN SCALE

PLUMBING EQUIPMENT

P09c LAVATORY – WALL HUNG
P09j LAVATORY – COUNTER TOP
P12d WATERCLOSET
P15k MOP BASIN

EQUIPMENT MANUAL

Accessory Equipment

Identification:

Equipment description and/or comment.

A items

Measurement Guide

Wall Clearance:

This is commonly known as bar offset. All AJW bars have 1 1/2" clearance between the mounting surface and inside of the bar with the exception of wall to floor bars. (Complies with Federal specification WW-p-541/8b)

Sizing Bars:

All stainless steel grab bars are measured centerline to centerline. Three sided bars (ex: Configuration-V) must have finished wall sizes supplied when pricing and ordering bars.

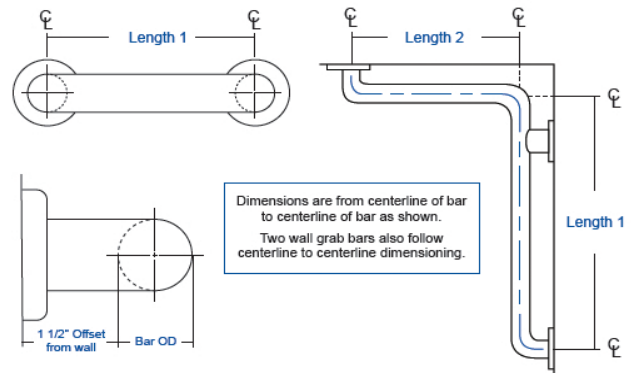

Flange Types

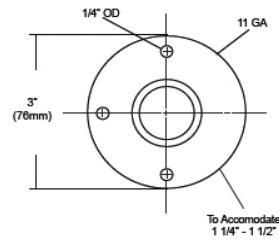
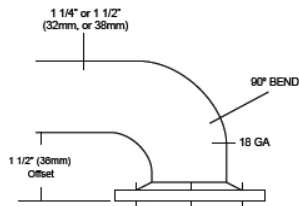

Exposed Flange

3" O.D. 11 gauge 4 satin finish stainless steel with three (3) mounting points (for 1/4" dia fasteners). Flange is TIG welded to bar for one-piece construction.

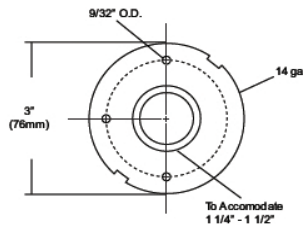
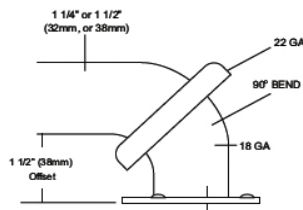

Concealed Snap Flange

3" O.D. deep drawn, 22 gauge stainless steel cover with a satin finish. A 12 gauge stainless steel mounting plate is welded to the bar with 3 (three) mounting points.

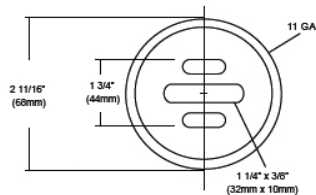
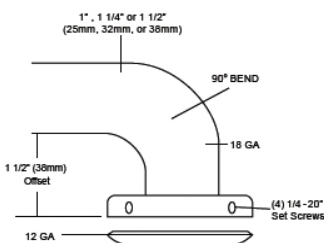

Concealed Set Screw Flange

3" O.D. deep drawn 11 gauge satin finish stainless steel. 12 gauge tennon plate. Flange is secured to plate by means of four (4) 1/4 - 20 stainless steel tamper resistant set screws.

Identification:

Grab Bars - UG20x, 42" long surfaced mount, stainless steel tubing, peened surface, concealed snap flange. Provide appropriate blocking. Coordinate with Handicap Accessibility guideline requirements. Acceptable substitutes: Bobrick, American Standard or approved equal..



UG20-A Grab Bars

Revised 03/11

JOB #:

ITEM #:

QUANTITY:

MOUNTING

HANDING

TYPE

SIZE

OTHER

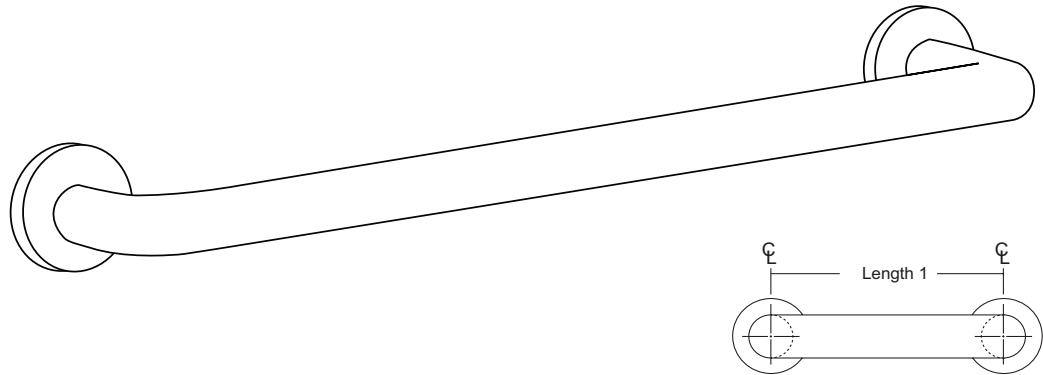

SPECIFICATIONS & INSTALLATION

Tubing: Fabricated of #18 ga stainless steel with a #4 satin finish. Available in 1 1/4" outside diameter. All bends are formed by an automatic mandrel bending process. All bars maintain a constant 1 1/2" offset.

Finish: Standard finish is a #4 satin finish. For a non-slip finish (peened) add suffix X to model number. (Ex. UG20X-A)

Flange: Flanges are fabricated of 3" diameter, 1/2" drawn #11 ga stainless steel with #4 satin finish to match tubing. Flanges are heliarc welded to bar to form a one piece construction. Each flange is secured to concealed mounting plate with four (4) 1/4"-20 stainless steel tamper resistant set screws.

Strength: Bars with a 1 1/2" offset clearance will support loads in excess of 900lbs when properly installed. Bars with greater offsets will support loads up to 250lbs when properly installed.

Installation: Before installing grab bars, verify with all state and local codes for requirements on bar diameter and type finish. Recommended mounting heights for grab bars are 33" - 36" centerline above finished floor. All mounting of grab bars when possible should have in wall mounting back plates. Secure mounting plate to wall surface at specified location with proper anchors (snugly) until proper centerline dimension is achieved. Place bar over plates and secure with supplied set screws. (4 per flange).

Standard Lengths (Other sizes available upon request): 12", 16", 18", 24", 30", 32", 36", 42", 48", 50", 52", 54", 56"

NOTES

FLANGE INFORMATION

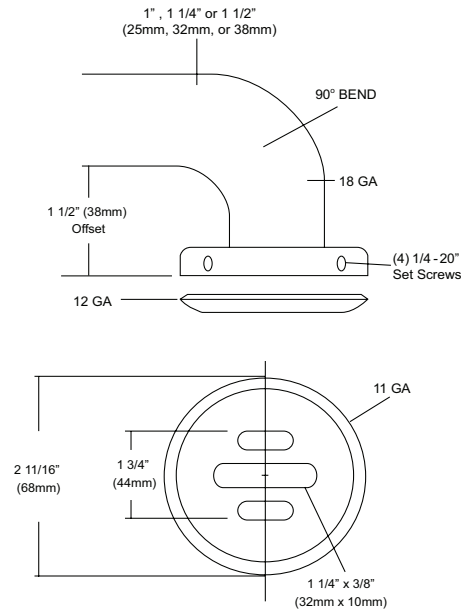

This information is subject to change without formal notice. If you need additional help, AJW has a technical support staff that is ready to assist you by phone: (845) 562-3332, fax: (845)562-3391, email: engineering@ajw.com or visit our website: www.ajw.com. Copyright © 2013 AJW Architectural Products

Identification:

Grab Bars - UG20x, 42" long surfaced mount, stainless steel tubing, peened surface, concealed snap flange. Provide appropriate blocking. Coordinate with Handicap Accessibility guideline requirements. Acceptable substitutes: Bobrick, American Standard or approved equal..

A01a
2 of 2

Measurement Guide

Wall Clearance:

This is commonly known as bar offset. All AJW bars have 1 1/2" clearance between the mounting surface and inside of the bar with the exception of wall to floor bars. (Complies with Federal specification WW-p-541/8b)

Sizing Bars:

All stainless steel grab bars are measured centerline to centerline. Three sided bars (ex: Configuration-V) must have finished wall sizes supplied when pricing and ordering bars.

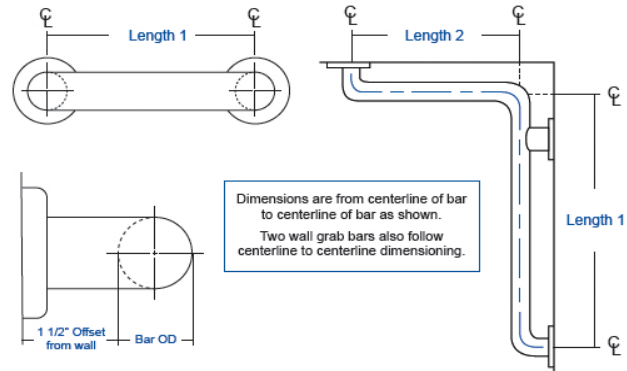

Flange Types

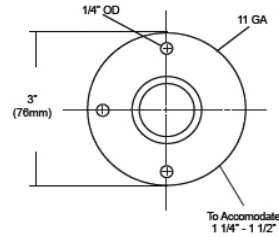
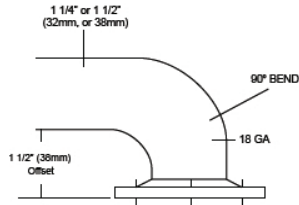

Exposed Flange

3" O.D. 11 gauge 4 satin finish stainless steel with three (3) mounting points (for 1/4" dia fasteners). Flange is TIG welded to bar for one-piece construction.

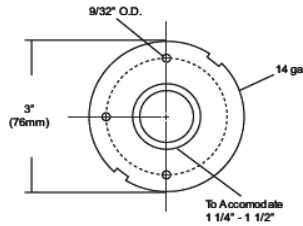
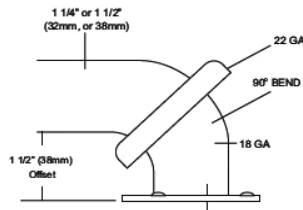

Concealed Snap Flange

3" O.D. deep drawn, 22 gauge stainless steel cover with a satin finish. A 12 gauge stainless steel mounting plate is welded to the bar with 3 (three) mounting points.

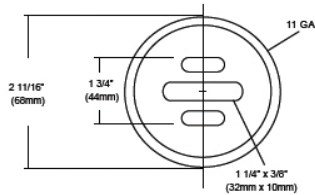
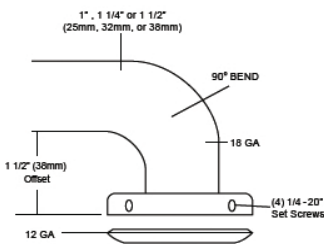

Concealed Set Screw Flange

3" O.D. deep drawn 11 gauge satin finish stainless steel. 12 gauge tennon plate. Flange is secured to plate by means of four (4) 1/4 - 20 stainless steel tamper resistant set screws.

Identification:

Grab Bars - UG20x, 36" long surfaced mount, stainless steel tubing, peened surface, concealed snap flange. Provide appropriate blocking. Coordinate with Handicap Accessibility guideline requirements. Acceptable substitutes: Bobrick, American Standard or approved equal.



UG20-A Grab Bars

Revised 03/11

JOB #:

ITEM #:

QUANTITY:

MOUNTING

HANDING

TYPE

SIZE

OTHER

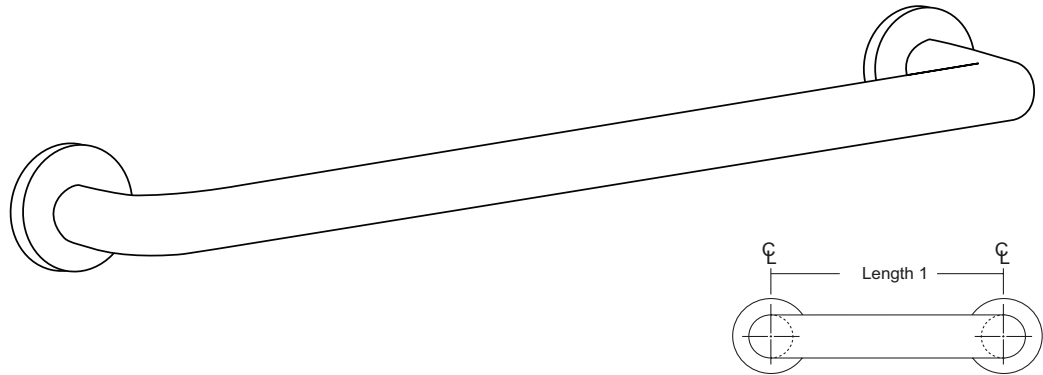

SPECIFICATIONS & INSTALLATION

Tubing: Fabricated of #18 ga stainless steel with a #4 satin finish. Available in 1 1/4" outside diameter. All bends are formed by an automatic mandrel bending process. All bars maintain a constant 1 1/2" offset.

Finish: Standard finish is a #4 satin finish. For a non-slip finish (peened) add suffix X to model number. (Ex. UG20X-A)

Flange: Flanges are fabricated of 3" diameter, 1/2" drawn #11 ga stainless steel with #4 satin finish to match tubing. Flanges are heliarc welded to bar to form a one piece construction. Each flange is secured to concealed mounting plate with four (4) 1/4"-20 stainless steel tamper resistant set screws.

Strength: Bars with a 1 1/2" offset clearance will support loads in excess of 900lbs when properly installed. Bars with greater offsets will support loads up to 250lbs when properly installed.

Installation: Before installing grab bars, verify with all state and local codes for requirements on bar diameter and type finish. Recommended mounting heights for grab bars are 33" - 36" centerline above finished floor. All mounting of grab bars when possible should have in wall mounting back plates. Secure mounting plate to wall surface at specified location with proper anchors (snugly) until proper centerline dimension is achieved. Place bar over plates and secure with supplied set screws. (4 per flange).

Standard Lengths (Other sizes available upon request): 12", 16", 18", 24", 30", 32", 36", 42", 48", 50", 52", 54", 56"

NOTES

FLANGE INFORMATION

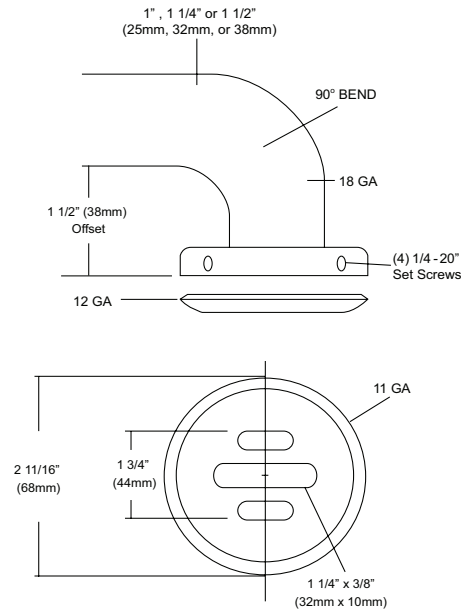

This information is subject to change without formal notice. If you need additional help, AJW has a technical support staff that is ready to assist you by phone: (845) 562-3332, fax: (845)562-3391, email: engineering@ajw.com or visit our website: www.ajw.com. Copyright © 2013 AJW Architectural Products

Identification:

Grab Bars - UG20x, 36" long surfaced mount, stainless steel tubing, peened surface, concealed snap flange. Provide appropriate blocking. Coordinate with Handicap Accessibility guideline requirements. Acceptable substitutes: Bobrick, American Standard or approved equal.

A01b
2 of 2

CONFIGURATIONS

Grab Bars

Job #:

Item #:

Quantity:

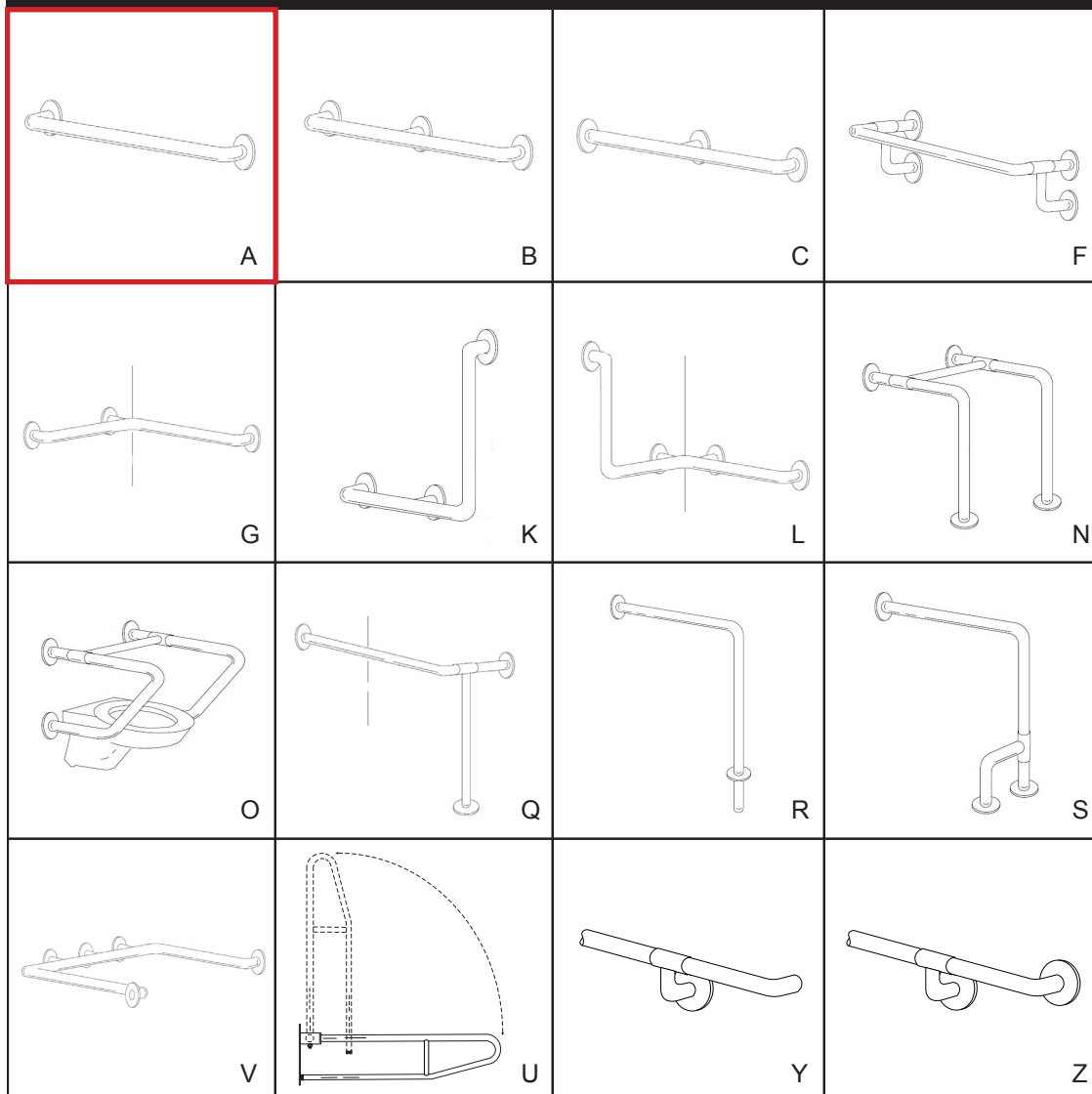

*When measuring and ordering grab bars, remember bars are sized centerline to centerline.

*Grab Bars comply with ADA Code 4.26.2

*Non-chloric and non-abrasive cleaners should be used to clean surface of bars and flanges.

*Custom sizes available upon request

This information is subject to change without formal notice. If you need additional help, AJW has a technical support staff that is ready to assist you by phone: (845) 562-3332, fax: (845) 562-3391, email: engineering@ajw.com or visit our website: www.ajw.com. Copyright © 2013 AJW Architectural Products

Identification:

Grab Bars - UG20x, vertically installed, 18" long surfaced mount, stainless steel tubing. Provide appropriate blocking. Coordinate with Handicap Accessibility guideline requirements. Acceptable substitutes: Bobrick, American Standard or approved equal.

A01g
1 of 1

< CORELESS

SHARE



Scott® Essential Coreless Jumbo Roll Toilet Paper Dispenser

ESSENTIAL PRODUCT CODE #09603 ★★★★★ (0)



Feedback



COLOR White
BRAND Scott®

COLOR

<https://www.kcprofessional.com/en-us/products/dispensers/toilet-paper-and-seat-cover-dispensers/jumbo-roll/coreless/scott-essential-coreless-jumbo-roll-toilet-paper-dispenser/09603#>

1/13

Identification:

Toilet Tissue Dispenser, #09603. Owner provide and installed. Provide appropriate blocking. Coordinate with Handicap Accessibility guideline requirements. Manufacturer: Kimberly-Clark or approved equal.

A02q
1 of 4

5/20/24, 3:23 PM

Scott® Essential™ Coreless Jumbo Roll Toilet Paper Dispenser (09603), with Stub Roll, White, 14.25" x 9.75" x 6.00" (Qty 1)

Black

White

TYPE

Coreless

Coreless Twin Roll

Request a Quote >

Buy Online >

Find a Distributor >

Product Overview & Guides



Scott® provides a reliable balance of efficiency, performance, and value in state-of-the-art solutions. If you're responsible for a high-traffic restroom, you need a high capacity bathroom tissue dispenser. Scott® Coreless Jumbo Roll Toilet Paper Dispensers offer high capacity, easy maintenance systems that can help lower maintenance costs. Available in double-roll and single-roll configurations, these dispensers are designed to dispense 9.38" diameter x 3.8" wide coreless tissue rolls. Since the dispenser is suited to a jumbo roll with no core, it helps keep your washroom environmentally conscious. The easy-to-load system has no door, no key, and no core to throw away. Look for compatible coreless jumbo roll toilet paper from Kleenex® and Scott® Brands. After all, you have better things to do than worry about refilling toilet paper! This dispenser is backed by a lifetime warranty and is designed to save you time and money while reducing service disruptions and user complaints.

- 1 Scott® Essential™ Coreless Jumbo Roll Toilet Paper Dispenser/Case; White; with Stub Roll; 14.25" x 9.75" x 6.00"
- High-capacity design can help minimize runout, waste, and maintenance time.
- Easy-to-load system has no door, no key, and no core to throw away.
- Available in double-roll and single-roll configurations.
- Backed by a lifetime warranty and is designed to save you time and money while reducing service disruptions and user complaints.

Buy Online

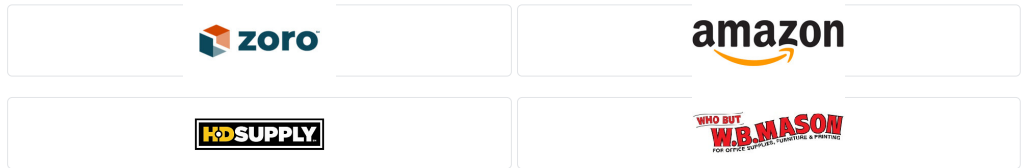

Find a Distributor



Address

or

Distributor

within



101 Results

MULTI-BRANCH DISTRIBUTOR

<https://www.kcpprofessional.com/en-us/products/dispensers/toilet-paper-and-seat-cover-dispensers/jumbo-roll/coreless/scott®-essential--coreless-jumbo-roll-toilet-paper-dispenser/09603#>

2/13

Identification:

Toilet Tissue Dispenser, #09603. Owner provide and installed. Provide appropriate blocking. Coordinate with Handicap Accessibility guideline requirements. Manufacturer: Kimberly-Clark or approved equal.

A02q
2 of 4

5/20/24, 3:23 PM

Scott® Essential™ Coreless Jumbo Roll Toilet Paper Dispenser (09603), with Stub Roll, White, 14.25" x 9.75" x 6.00" (Qty 1)

QUANTITY PER UNIT UOM

Unit(s) / Pack

Dimensions

UNITS PER CASE

1

UNIT SIZE

14.25" x 9.75" x 6.00"

Shipping Data

UNITS PER CASE

1

QUANTITY PER CASE

1

QUANTITY PER CASE UOM

Unit(s) / Case

QUANTITY PER UNIT

1

QUANTITY PER UNIT UOM

Unit(s) / Pack

Technical Support



Bid Specification - 09603, 09602



Loading Instructions - 09603



Installation and Usage Instructions for 09602, 09603 Jumbo Roll Tissue Dispenser

Compatible Products



Scott® Essential Coreless Jumbo Roll Toilet Paper
SKU 07006

About brand Scott®



Very few locations within a facility impact satisfaction as much as the restroom. A negative experience can have a truly damaging effect on your reputation. Scott®, one of the world's most recognized restroom brands, offers solutions designed to help you increase productivity, enhance your image, and improve employee, patient and guest satisfaction.



Parts & Accessories



<https://www.kcpprofessional.com/en-us/products/dispensers/toilet-paper-and-seat-cover-dispensers/jumbo-roll/coreless/scott-essential-coreless-jumbo-roll-toilet-paper-dispenser/09603#>

11/13

Identification:

Toilet Tissue Dispenser, #09603. Owner provide and installed. Provide appropriate blocking. Coordinate with Handicap Accessibility guideline requirements. Manufacturer: Kimberly-Clark or approved equal.

A02q
3 of 4

5/20/24, 3:23 PM

Scott® Essential™ Coreless Jumbo Roll Toilet Paper Dispenser (09603), with Stub Roll, White, 14.25" x 9.75" x 6.00" (Qty 1)



Main Roll Metal Spring/Plunger
SKU 770949

Reviews



HOME / DISPENSERS / TOILET PAPER & SEAT COVER DISPENSERS / JUMBO ROLL / CORELESS

Brands

Kleenex®
Scott®
Cottonelle®
WypAll®
KleenGuard®
Kimtech®
Onvation™ Smart Restroom Management System

Products

Dispensers
Restroom & Hygiene
Wiping & Cleaning
Safety & Personal Protection
Scientific & Research

Ready To Buy

Request Product Consultation
Savings Calculator
How to Buy

Solutions

Kimberly-Clark Professional™ ICON™ Dispenser Collection
Restroom Collections
RightCycle® PPE Recycling Program
Onvation® Connected Software Solution
Workplace Hygiene Tools and Solutions
Nonwoven Base Sheets

Workplace Insights

About

About Us
News Releases
Sustainability

Statements and Disclosures

Privacy Policy
Do Not Sell or Share My Personal Information
Limit the Use of My Sensitive Personal Information

Feedback

<https://www.kcprofessional.com/en-us/products/dispensers/toilet-paper-and-seat-cover-dispensers/jumbo-roll/coreless/scott-essential-coreless-jumbo-roll-toilet-paper-dispenser/09603#>

12/13

Identification:

Toilet Tissue Dispenser, #09603. Owner provide and installed. Provide appropriate blocking. Coordinate with Handicap Accessibility guideline requirements. Manufacturer: Kimberly-Clark or approved equal.

A02q
4 of 4

Nexa™

Hand Hygiene Dispensing Technology for the Modern Hospital

EFFICIENT. SAFE. ELEGANTLY SIMPLE. SUSTAINABLE.



Nexa Classic Manual

FLEXIBLE OPTIONS HELP IMPROVE EFFICIENCY

- Large bottle size extends interval between change-outs
- Small bottle fits in Classic dispenser
- Smaller footprint of Compact dispenser fits tight spaces
- Evacuates product more fully, compared to a leading competitive dispensing system, especially for gels and lotions
- Adjustable dosing helps improve staff satisfaction and manage product use

ENHANCING SAFETY THROUGHOUT YOUR FACILITY

- Antimicrobial protection in the manual dispenser pushbar works continuously to inhibit the growth of bacteria, mold and mildew that can cause degradation
- Optional locking mechanism helps deter tampering
- Meets ADA compliance requirements
- 750 mL size reduces alcohol quantity to support fire code compliance



Nexa Compact Touch Free

SIMPLICITY SUPPORTS YOUR REPUTATION FOR EXCELLENT CARE

- Language-free, color-coded badges make product identification easy
- The same bottle fits manual and touch free dispensers for optimized inventory management
- Product level and expiration date are visible through dispenser window

SUSTAINABLE SOLUTIONS FOR YOUR HOSPITAL AND THE PLANET

- HDPE recyclable bottle
- Less packaging waste
- Assembled in the USA

☐ ☒ All dispensers come in black or white.

ECOLAB®
Everywhere It Matters.™

Identification:

EcoLab Soap Dispenser. Model # 92021184 White/6. Owner provided and installed.
Contractor to provide wall blocking.

A03b
1 of 2

Sophisticated design and enhanced simplicity

DISPENSER OPTIONS FOR EVERY NEED

Two sizes, two dispensing options and two colors give you flexible choices to meet the hand hygiene needs of your facility.

SIZES

CLASSIC

- Holds 1250 mL soap or 1200 mL sanitizer
- Large bottle size extends interval between change-outs
- Holds large or small bottle

COMPACT

- Smaller footprint fits tight spaces to help you increase availability of dispensers
- Smaller sanitizer size means less alcohol per dispenser, so you can extend dispenser access within fire code limitations

DISPENSING OPTIONS

MANUAL

- Worry free and environmentally friendly
- No batteries to wear out, change or dispose of

TOUCH FREE

- Improved battery life
- Easy battery change—no tools required
- Thumb screws prevent screws from getting lost

WORKING TOGETHER TO PROMOTE BETTER HAND HYGIENE

- Complete installation management
- Onsite support to oversee your conversion
- Simple installation
- Comprehensive staff training

CLASSIC		COMPACT	
Dimensions: 11.1" x 6.12" x 3.97" With drip tray: 18.3" x 6.12" x 3.97"		Dimensions: 9.34" x 5.5" x 3.97" With drip tray: 16.54" x 5.5" x 3.97"	
MANUAL	TOUCH FREE	MANUAL	TOUCH FREE
92023021 White/8	92021188 White/8	92023000 White/6	92021184 White/6
92023022 Black/8	92021189 Black/8	92023020 Black/6	92021183 Black/6
			

☐ ☒ All dispensers come in black or white.

ANTIBACTERIAL SOAP	LOTION
Bacti-Foam® 6000070 6/750 mL 6000090 4/1250 mL	Revitalizing Skin Lotion Fragrance Free 6000062 6/750 mL
HAND SOAP	HAND SANITIZER
Endure® Foam 6000061 6/750 mL 6000069 4/1250 mL Endure® Sensitive Skin Foam 6000063 6/750 mL 6000084 4/1250 mL	Quik-Care® Nourishing Foam 6000082 6/750 mL 6000098 4/1200 mL Quik-Care® Foam 6000073 6/750 mL 6000094 4/1200 mL Express Gel 6000083 6/750 mL 6000099 4/1200 mL
BODY WASH	
Total Body Shampoo 6000064 6/750 mL	

World Headquarters
370 Wabasha Street N St. Paul, MN 55102
www.ecolab.com 866 781 8787
©2013 Ecolab USA Inc. All rights reserved.

ECOLAB®
Everywhere It Matters.™

Identification:

EcoLab Soap Dispenser. Model # 92021184 White/6. Owner provided and installed.
Contractor to provide wall blocking.

A03b
2 of 2

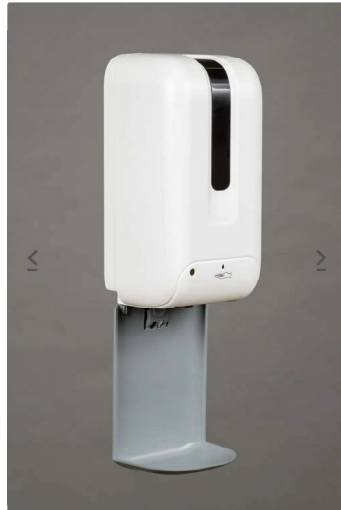

PRODUCTS > DISPENSERS > AUTOMATIC SANITIZER DISPENSER

✓ In Stock

Automatic Sanitizer Dispenser – White (Wall Mount – 1000ML)

~~\$79.99~~ **\$69.99**

The Automatic Sanitizer Dispenser is a touch-less, battery-operated hand sanitizer dispenser that can be mounted on a wall (wall-mounting tools and drip tray included).

Availability: Ships in 1-2 business day.

Select Sanitizer Type

Add Sanitizer

+

Add Mat

+

1

Add to cart

About the Automatic Sanitizer Dispenser

The Automatic Sanitizer Dispenser is a touch-less, battery-operated hand sanitizer dispenser that can be mounted on a wall (wall-mounting tools and drip tray included).

It has a 1000mL universal, refillable reservoir that works with most Liquid/Gel Hand Sanitizers. The station is ADA Compliant and can be operated with one hand, making it accessible to people with disabilities.

It includes an infrared sensor for fully-automatic non-touch operation. Drip tray catches extra sanitizer so floors remain clean. 1000mL Capacity refillable reservoir. Battery Type – C, 4 – 1.5V batteries required (batteries or 6V, 1A adapter cord NOT INCLUDED). Features lock to help prevent theft and vandalism as well as an On & Off button.

FAQ:

When does it ship? It ships 1-2 business day after you place your order.

Where does it ship from? It ships from Dallas, TX.

Can I use any sanitizer in this? The dispenser has a universal, refillable 1000mL reservoir that takes most liquid or gel sanitizer.

Does it take foam sanitizer? No, it does not.

Is it touch-less? Yes, there is an infrared sensor that automatically dispenses when your hand is underneath.

How does it dispense? Is it like a spray or like a drop? It drops, it does not spray.

How many dispenses will I get before I need to refill the reservoir? You will get roughly 1280 dispenses before needing to refill the reservoir.

Do I need to plug it in? The unit works with either FOUR (4) C Batteries (1.5V) or DC 6 Volt, 1 AMP (6V, 1A) adapter plug. Batteries or the cord are not included.

What kind of batteries does it take? It takes four (4) C Batteries (1.5 V). Batteries are not included.

Are batteries included? No, batteries are not included.

How many dispenses do I get before I need to change the batteries? 30,000 dispenses

Can I use this station outside? No, it is not waterproof

How much does the dispenser weigh? 3 lbs.

1/4

Identification:

Automatic Sanitizer Dispensing Unit, 1000mL. Owner provided and installed. Contractor to provide wall blocking. Coordinate with Handicap Accessibility guideline requirements. Manufacturer: Stand Up Stations or approved equal.

A03n
1 of 2

How do I get sanitizer refills from you? You can email info@standupstations.com or call [800-413-9490](tel:800-413-9490) to order more sanitizer solution from us.

What kind of sanitizer do you have? We have both liquid and gel sanitizer with the WHO-recommended formula (80% alcohol)

Do I have to buy refills from you? No, you can use any bulk liquid or gel sanitizer solution. Simply open the reservoir and pour in the solution from a gallon jug.

Does it have a warranty? We are not offering refunds or returns on our stands unless there is damage upon delivery, or there is a defect in materials or craftsmanship affecting the quality and functionality. See our limited warranty details [here](#).

Included with every dispenser order:

- Touch-less automatic dispenser with refillable reservoir that works with any bulk liquid or gel hand sanitizer product
- Drip tray
- Mounting tools for installation on wall

Add-Ons:

- 1 Gallon of gel or liquid hand sanitizer, WHO-recommended formula (80% alcohol)
- Water-absorbent mat

Product Specs

Width	5.75"
Depth	4.25"
Height	10.75"
Dispenser Color	White
Dispenser Accent Color	Black Stripe
Dispenser Type	Automatic
Dispenser Capacity	1000 ML
Dispenser Power	4 C Batteries (not included)
Material	ABS Plastic
Orientation	Vertical
SKU	11671401071-1000ML-W
Use	Indoor Only

Related products

AC-9

Identification:

Automatic Sanitizer Dispensing Unit, 1000mL. Owner provided and installed. Contractor to provide wall blocking. Coordinate with Handicap Accessibility guideline requirements. Manufacturer: Stand Up Stations or approved equal.

A03n
2 of 2

< HARD ROLL

➕ SHARE



Scott® Pro Hard Roll Towel Dispenser

PRO PRODUCT CODE #34347 ★★★★★ (0)



Feedback

See on My Wall

<https://www.kcprofessional.com/en-us/products/dispensers/paper-towel-dispensers/hard-roll/scott®-pro-hard-roll-towel-dispenser/34347#>

1/13

Identification:

Paper Towel Dispenser, Manual #34347. Owner provide and installed. Provide appropriate blocking. Coordinate with Handicap Accessibility guideline requirements.
Manufacturer: Kimberly-Clark or approved equal.

A05q
1 of 4

5/20/24, 3:18 PM

Scott® Pro™ Manual Hard Roll Towel Dispenser (34347), White, for Blue Core Scott® Pro™ Roll Towels, 12.66" x 16.44" x 9.18" (Qty 1)

BRAND

Scott®

FORMAT

Manual

Automatic

COLOR: CORE COLOR

Black; Blue Core

White; Blue Core

Request a Quote >

Buy Online >

Find a Distributor >

Product Overview & Guides



Scott® Pro™ Hard Roll Paper Towel Dispensers (for Blue Core Scott® Pro Roll towels) are designed to take hand hygiene to another level. The Scott® Pro™ Dispenser Systems have innovative internal dispensing that plug and play to customize it to meet your needs. Scott® Pro™ Hard Roll Towel Dispensers are available in various colors as well as in automatic and manual configurations. Automatic dispenser models are 99.99% jam free - guaranteed, so you can count on its reliable, touchless operation. Manual dispenser models offer the hygiene of touchless dispensing without the batteries. Both models offer quiet dispensing, hygienic and touch-free dispensing. Automatic and manual hard roll towel dispenser modules are also available. This system combines touchless technology with the bacteria-reducing benefits of drying with paper towels, supporting and promoting better hand and surface hygiene. This dispenser is backed by a lifetime warranty and is designed to save you time and money while reducing service disruptions and user complaints.

- 1 Scott® Pro™ Manual Hard Roll Towel Dispenser/Case; White; for Blue Core Scott® Pro™ Roll Towels; 12.66" x 16.44" x 9.18"
- Features durable construction and a sleek, professional design.
- Compatible with Scott® and Kleenex® Blue Core hard roll towels.
- Available in various colors as well as in automatic and manual configurations.
- Backed by a lifetime warranty and is designed to save you time and money while reducing service disruptions and user complaints.

2024 Wiping Solutions Catalog

2024 Restroom Solutions Catalog

Buy Online



amazon

HD SUPPLY

**WHO BUY
W.B. MASON**
FOR OFFICE SUPPLIES, EQUIPMENT & SERVICES

STAPLES
Advantage

Feedback

Find a Distributor



Address

USE CURRENT LOCATION

City, State or Postal Code

or

<https://www.kcprofessional.com/en-us/products/dispensers/paper-towel-dispensers/hard-roll/scott®-pro-hard-roll-towel-dispenser/34347#>

2/13

Identification:

Paper Towel Dispenser, Manual #34347. Owner provide and installed. Provide appropriate blocking. Coordinate with Handicap Accessibility guideline requirements.
Manufacturer: Kimberly-Clark or approved equal.

A05q
2 of 4

5/20/24, 3:18 PM

Scott® Pro™ Manual Hard Roll Towel Dispenser (34347), White, for Blue Core Scott® Pro™ Roll Towels, 12.66" x 16.44" x 9.18" (Qty 1)

USA
EMAIL
customersupport@wbmason.com

MULTI-BRANCH DISTRIBUTOR

WB Mason

29 Mill St.
Albany, NY 12204

SUPPORT
8889262766

DELIVERY TO
USA

EMAIL
customersupport@wbmason.com

1 2 >

Specifications



Details

BRAND	Scott®
SUB BRAND	Pro
UNIT SIZE	12.66" x 16.44" x 9.18"
COUNTRY OF ORIGIN	Mexico
GTIN	10036000343479
MATERIAL NUMBER	103434702

Dimensions

UNITS PER CASE	1
UNIT SIZE	12.66" x 16.44" x 9.18"

Shipping Data

UNITS PER CASE	1
----------------	---

Technical Support



Scott® Pro Hard Roll Towel Dispenser Mounting Template

Scott® Pro Manual Hard Roll Towel Dispenser



Compatible Products



<https://www.kcpprofessional.com/en-us/products/dispensers/paper-towel-dispensers/hard-roll/scott®-pro-hard-roll-towel-dispenser/34347#>

11/13

Identification:

Paper Towel Dispenser, Manual #34347. Owner provide and installed. Provide appropriate blocking. Coordinate with Handicap Accessibility guideline requirements.
Manufacturer: Kimberly-Clark or approved equal.

A05q
3 of 4

5/20/24, 3:18 PM

Scott® Pro™ Manual Hard Roll Towel Dispenser (34347), White, for Blue Core Scott® Pro™ Roll Towels, 12.66" x 16.44" x 9.18" (Qty 1)



Kleenex® Hard Roll Paper Towels with Color Core
SKU 25637

About brand Scott®



Very few locations within a facility impact satisfaction as much as the restroom. A negative experience can have a truly damaging effect on your reputation. Scott®, one of the world's most recognized restroom brands, offers solutions designed to help you increase productivity, enhance your image, and improve employee, patient and guest satisfaction.

Parts & Accessories



Decorator Lock Plug - White Scott® Pro HRT & eCassette
SKU 774042

Reviews



HOME / DISPENSERS / PAPER TOWEL DISPENSERS / HARD ROLL
+ SHARE

Brands

Kleenex®
Scott®
Cottonelle®
WypAll®
KleenGuard®
Kimtech®
Onvation™ Smart Restroom Management System

Products

Dispensers
Restroom & Hygiene
Wiping & Cleaning
Safety & Personal Protection
Scientific & Research

Feedback

<https://www.kcprofessional.com/en-us/products/dispensers/paper-towel-dispensers/hard-roll/scott®-pro-hard-roll-towel-dispenser/34347#>

12/13

Identification:

Paper Towel Dispenser, Manual #34347. Owner provide and installed. Provide appropriate blocking. Coordinate with Handicap Accessibility guideline requirements.
Manufacturer: Kimberly-Clark or approved equal.

A05q
4 of 4



U711 Series Channel Frame Mirror

Revision 02/12

JOB #:

ITEM #:

QUANTITY:

MOUNTING

HANDING

TYPE

SIZE

OTHER

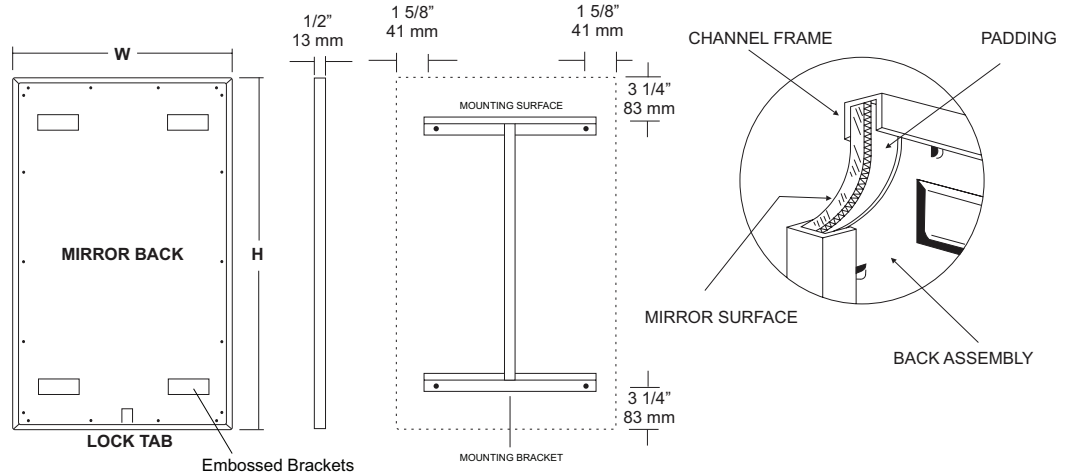

SPECIFICATIONS

Frame: Fabricated of #20 ga stainless steel, #4 satin finish. Roll formed 1/2" x 1/2" x 1/2" channel frame has mitered corners and secured with stainless steel rivet.

Mirror: 1/4" thick type 1 transparent flat type, class 1 - clear glass mirrors. Mirror is coated with silver and sealed with a uniform electrolytic copper plating, along with two coats of paint for added protection. Mirrors are guaranteed against silver spoilage for a period of 15 years. Mirrors conform to ASTM C1036 and ASTM C1503-R8.

Filler: Full size, 1/8" shock absorbing, water resistant, nonabrasive, polyethylene padding protects all concealed mirror surfaces.

Back: #20 ga pre-plated galvanized steel, with embossed horizontal lower mounting brackets. Embossed theft resistant pressure activated clip lock device, locks mirror in place to wall hangers.

Hangers: Fabricated of #20 ga pre-plated steel galvanized steel with mounting points.

Standard Sizes Available (W x H): 16"x24", 16"x20", 16"x30", 18"x24", 18"x30", 18"x36", 20"x60", 24"x30", 24"x36", 24"x42", 24"x48", 24"x60", 24"x72", 18"x60", 24"x60", 18"x72"

Mirrors conform to Federal Specifications DD-M-00411b & DD-g-541D.

Options:

-VC: Safety Glass(Vinyl clad)

-T: Tempered Glass

-LG: Laminated Glass

-PM: Plastic Acrylic

-8B: #8 Reflective s/s

-LX: Polycarbonate

Max size-8B mirrors: 72" x 47 1/2"

Mirrors are always ordered Width x Height

Fabricated to a tolerance of ± 1/8"

INSTALLATION

Coordinate installation with architect / contractor for specific mounting location and height for each mirror application. Making sure "I" bracket is level, transfer all mounting point locations to wall surface from drawing. Secure brackets with proper fasteners for each application. Slide mirror down over horizontal brackets until clip lock secures mirror in place. Mirror can only be removed by inserting tool through hole at bottom of frame depressing clip. This will allow mirror to slide up over brackets. Fillers are available if mirrors are mounted above and below tile line. (U004 Filler) filler material will match mirror frame to form a one piece construction.

To meet ADA Code, bottom edge of reflective surface can be no higher than 40" above finished floor. (4.19.6) Full length mirrors may be used for universal application when installed in correct locations.

Abrasive cleaners & chloric solutions should not be used on mirrors. Discoloring and /or scratching of frame and reflective surface may occur.

NOTES

This information is subject to change without formal notice. If you need additional help, AJW has a technical support staff that is ready to assist you by phone: (845) 562-3332, fax: (845)562-3391, email: engineering@ajw.com or visit our website: www.ajw.com. Copyright © 2013 AJW Architectural Products

Identification:

AJW U711 Series. Channel frame, surface mounted mirror with tempered glass. Provide appropriate blocking. Coordinate with Handicap Accessibility guideline requirements.

A06e

1 of 1

38

CENTRAL SUPPLY



Glove Box Holders

- Keeps gloves clean and available
- Multiple types and configurations available
- Industrial strength materials are easy to clean and provide years of trouble-free service
- Quick and easy loading
- Horizontal or vertical mounting available depending on space constraints



Item No.	Description	Quantity
0901PS040212	Glove Box Holder, Triple, with Biohazard Bag Dispenser, Quartz	1 / EA
0901MCGP085	Surgical Glove Dispenser, Vertical Mount, Clear PETG Plastic	1 / EA, 4 / CS
0901MCGB027	Poly Dietary Glove Dispenser, Powder-Coated Metal	1 / EA, 12 / CS
0901MCGB144	Glove Box Holder, Single, 22-Gauge White Powder-Coated Metal	1 / EA, 12 / CS
0901GL420212	Glove Box Holder, ABS Quartz Plastic, Quad with Shelf, Horizontal, 20" x 11½" x 3½"	1 / EA
0901MCGB001	Glove Box Holder, Single, 22-Gauge White Powder-Coated Metal, Adjustable Spring, 5½" x 10" x 3¾"	1 / EA, 12 / CS
0901MCGB002	Glove Box Holder, Double, 22-Gauge White Powder-Coated Metal, 10½" x 10" x 3¾"	1 / EA, 6 / CS
0901MCGB003	Glove Box Holder, Triple, 22-Gauge White Powder-Coated Metal, 15¾" x 10" x 3¾"	1 / EA, 6 / CS
0901MCGB006	Glove Box Holder, Double, Horizontal, 22-Gauge White Powder-Coated Metal, 20" x 5½" x 3¾"	1 / EA, 4 / CS
0901MCGB011	Glove Dispenser, Bulk, Double Bin, 22-Gauge White Powder-Coated Metal, 13" x 6½" x 4¼"	1 / EA, 6 / CS
0901MCGB012	Glove Box Holder, Expands to Hold One or Two Glove Boxes Horizontally, 22-Gauge White Powder-Coated Metal, 9" to 15½" x 5¼" x 4"	1 / EA

Item No.	Description	Quantity
0901MCGB059	Glove Box Holder, Quad, 22-Gauge White Powder-Coated Metal, 22¼" x 10" x 3¾"	1 / EA, 4 / CS
0901MCGB067	Glove Box Holder, Double, Holds Two Glove Boxes End-to-End, 22-Gauge White Powder-Coated Metal, 5½" x 20" x 3¾"	1 / EA, 4 / CS
0901MCGB068	Glove Box Holder, Triple, Holds Glove Boxes End-to-End, 5¾" x 30" x 3¾"	1 / EA, 4 / CS
0901MCGB074	Glove Box Holder, Single, Adjustable Spring, 22-Gauge White Powder-Coated Metal, 6½" x 10" x 3¾"	1 / EA, 12 / CS
0901MCGC009	Glove Dispenser, Bulk, Hinged Lid, White Sintra Plastic, 5" x 11" x 4"	1 / EA
0901MCGC016	Glove Box Holder, Single, Beige, Sintra Plastic, 5½" x 10" x 3¾"	1 / EA, 12 / CS
0901MCGC017	Glove Box Holder, Single, Gray Sintra Plastic, 5¾" x 10" x 3¾"	1 / EA, 12 / CS
0901MCGC018	Glove Box Holder, Single, Adjustable Spring, White Sintra Plastic, 5½" x 10" x 3¾"	1 / EA, 12 / CS
0901MCGC019	Glove Box Holder, Single, Adjustable Spring, Blue Sintra Plastic, 5½" x 10" x 3¾"	1 / EA, 12 / CS
0901MCGC023	Glove Box Holder, Single, Adjustable Spring, White Sintra Plastic, 6½" x 10" x 3¾"	1 / EA, 12 / CS
0901MCGD011	Single Glove Caddy, Attaches to Protection Organizer, Quartz ABS Plastic, 10" x 5¼" x 4"	1 / EA, 12 / CS
0901MCGD012	Glove Caddy, Double, Attaches to Bottom of LD-035 Organizer, Quartz ABS, 22½" x 5¼" x 4"	1 / EA
0901MCGD013	Glove Dispenser, Single, Clips onto Organizer, ABS Quartz Plastic, 5½" x 9½" x 3½"	1 / EA, 12 / CS
0901MCGD030	Glove Box Holder, Locking, White ABS Plastic, 5¾" x 12" x 4¼"	1 / EA, 12 / CS
0901MCGD042	Glove Box Holder, Double with Divider, ABS Quartz, 11" x 9¾" x 3½"	1 / EA, 6 / CS
0901MCGD043	Glove Box Holder, Triple with Dividers, ABS Quartz, 16½" x 9¾" x 3½"	1 / EA, 6 / CS
0901MCGD084	Dispenser for Surgical Gloves, Adjustable Divider, Countertop, White ABS Plastic, 6½" x 5" x 13¾"	1 / EA, 4 / CS
0901MCGD105	Glove Hook for Mounting Poly Glove Box, White ABS Plastic, 2¼" x 1" x 1"	1 / EA, 12 / CS
0901MCGD111	Glove Box Holder with Additional Shelf, Attaches to Protection Organizer, Quartz ABS Plastic, 22½" x 5½" x 4"	1 / EA
0901MCGP004	Glove Box Holder, Single, Hinge Lid, Clear PETG Plastic, 5½" x 10¼" x 3½"	1 / EA, 6 / CS
0901MCGP013	Glove Box Holder, Single, Adjustable Spring, Clear PETG Plastic, 5½" x 9¾" x 3¾"	1 / EA, 12 / CS
0901MCGP014	Glove Box Holder, Double, Clear PETG Plastic, 10½" x 10" x 3¾"	1 / EA, 6 / CS
0901MCGP015	Glove Box Holder, Triple, Clear PETG Plastic, 15¾" x 10" x 3¾"	1 / EA, 6 / CS
0901MCGP020	Glove Box Holder, Single, Adjustable Spring, Clear PETG Plastic, 6½" x 10" x 4"	1 / EA, 12 / CS
0901MCGP025	Glove Box Holder, Poly Food Service Gloves, Clear PETG Plastic, 8¼" x 7" x 1"	1 / EA, 12 / CS
0901MCGP042	Glove Box Holder, Double with Divider, Clear PETG Plastic, 11" x 9¾" x 3½"	1 / EA, 6 / CS
0901MCGP043	Glove Box Holder, Triple with Dividers, Clear PETG Plastic, 16½" x 9½" x 3½"	1 / EA, 4 / CS
0901MCGP061	Glove Box Holder, Quad, Clear PETG Plastic, 22¼" x 10" x 3¾"	1 / EA, 4 / CS

MEDICHOICE® quality | value | service

Identification:

MedChoice Surgical Glove Dispenser. Model #0901MCGB002. Owner provided, Contractor installed. Coordinate number and locations with hospital. Provide appropriate blocking. Coordinate with Handicap Accessibility guideline requirements.

A29b
1 of 1

SHARPS CONTAINER

BY OWNER
(N.I.C.)

Identification:

Sharps Container. Owner provided. Provide appropriate blocking where required.
Coordinate with Handicap Accessibility guideline requirements.

A30a
1 of 1



Perfect Panel

Perfect Panel™ offers an innovative solution for changing privacy curtains. The design allows for replacement of soiled curtain panels without having to switch out the entire large curtain.

Designed with snaps, privacy curtains are removed, easily replaced, and within reach without the use of tools, ladders or step stools.

A sampling of our comprehensive line of quality products is featured here.

For access to our full product line, contact a dedicated healthcare consultant at 1.800.999.0400.

[View Healthcare Fabrics](#)



On the Right Track

On The Right Track® is an innovative technology that eliminates the hassle and time associated with replacing privacy curtains.

The On the Right Track® design allows curtains to be easily removed without the hassle of separating them from individual carriers.

A sampling of our comprehensive line of quality products is featured here.

For access to our full product line, contact a dedicated healthcare consultant at 1.800.999.0400.

[View Healthcare Fabrics](#)



Impact

Standard Textile exclusively provides Impact™ Technology –the only flame resistant fabric for decorative applications– engineered to provide stain resistance, splash protection, and antimicrobial properties.

Certified third party testing results validate Impact's efficacy against prevalent bacteria, including staphylococci, enterococci, and MRSA.

A sampling of our comprehensive line of quality products is featured here.

[View Healthcare Fabrics](#)



Hardware

As a leading manufacturer of track and hardware, Standard Textile offers complete privacy curtain solutions along with fabric and finished curtains.

Full track sets and/or individual track components are available.

A sampling of our comprehensive line of quality products is featured here.

For access to our full product line, contact a dedicated healthcare consultant at 1.800.999.0400.



Cubicle Curtains

Standard Textile fabricates cubicle curtains to exact styles and specifications.

Choose from a diverse collection of patterns and colorways, or work with our sales consultants to develop a cubicle curtain solution.

A sampling of our comprehensive line of quality products is featured here.

For access to our full product line, contact a dedicated healthcare consultant at 1.800.999.0400.

[View Healthcare Fabrics](#)

Identification:

Cubicle Curtain Tracks & Hardware. Furnished and installed by Contractor. Owner to provide curtains.

A33a
1 of 1

EQUIPMENT MANUAL

Communication Equipment

Identification:

Equipment description and/or comment.

C items

OFFICE TELEPHONE

Identification:

Office telephone. Provide drop and rough in box. Install appropriate blocking at wall mounted phones.

C08a

1 of 1

COURTESY PHONE

BY OWNER
(N.I.C.)

Identification:

Courtesy telephone. Not in contract, Owner supplied and installed. Contractor to provide drop and rough in box. Contractor to install blocking at wall mounted phones.

C08d

1 of 1



- 4 million : 1 dynamic contrast ratio
- 60Hz refresh rate
- Slim design, super-thin bezel
- Powerful 20W audio
- HDMI port supports CEC, ARC, and MHL®

BREATHTAKING HD IMAGES.

The LC-32LE551U is an LED TV that delivers legendary AQUOS picture quality, with 60Hz refresh rate and 4 million : 1 dynamic contrast ratio for precision clarity during fast-motion scenes. The AQUOS panel's advanced pixel structure gives you crystal clear picture, brilliant color, and captivating detail.

TECHNICAL SPECIFICATIONS

PANEL SPECIFICATIONS	
Display Panel Type	LCD
Backlight Type Source	Direct LED
Resolution	1920 x 1080
Aspect Ratio	16x9
Dynamic Contrast Ratio	4,000,000:1
Refresh Panel Rate	60Hz
BROADCAST SYSTEM	
Analog	NTSC
BEZEL & TABLE STAND	
Narrow Bezel	Yes
Bezel Color	Black
Stand Color	Black
Stand Type	Fixed
AUDIO	
Speakers (channel)	2
Speaker Location	Bottom, Down Firing
Speaker Output Power	10W+10W
Virtual Surround	Yes
AV INPUT/OUTPUTS (#, LOCATION)	
Total USB Input(s)	1
USB feature	JPG, MP3, MPEG-2
Total HDMI Input(s)	2 (1 with MHL)
Antenna	1 (Down) F-type
Component plus Stereo Audio	1
Composite plus Stereo Audio	1 (Shared with component)
Digital Audio Output	1 (optical)
Analog Stereo Output	1 (RCA)

CONNECTIVITY	
Network Function	-
Wi-Fi	-
CONVENIENCE FEATURES	
Remote Type	Normal (GJ221-R)
Power Saving Mode	Yes
Auto Power	Yes
Language (English/French/Spanish)	Yes
POWER	
Power Source (Voltage, Hz)	AC 120V, 60Hz
ENERGY STAR® Qualified	Yes
WALL MOUNT	
Wall Mount	Yes
DIMENSIONS/WEIGHT(inches/lbs.)	
Excluding Stand (w/retail)	28-27/64" x 18-1/2" x 2-31/64"
Including Stand (w/retail)	28-27/64" x 16-53/64" x 6-35/64"
Shipping (w/retail)	34-1/8" x 20-37/64" x 4-28/32"
Product Weight (Excluding Stand/Including Stand)	10.36 lbs/10.36 lbs
Shipping Weight	15.65 lbs
UPC	074000376502
WARRANTY/UPC	
Parts	1 year limited
Labor	1 year limited

© 2014 Sharp Electronics Corporation. Sharp, AQUOS, SmartCentral, Quattron, Q+, and Revelation related trademarks are trademarks or registered trademarks of Sharp Corporation and/or its affiliated entities. Roku and the Roku logo are registered trademarks of Roku, Inc. in the United States and other countries. Product specification and design are subject to change without notice.

SHARP ELECTRONICS CORPORATION
Sharp Plaza, Mahwah, NJ 07495
1-800-BE-SHARP
www.sharpsusa.com



Identification:

Sharp 32" HD LED TV, model # LC-32LE551U. Owner provided and Contractor installed.
Contractor to provide appropriate blocking and connections.
Manufacturer: Sharp or approved equal.

C12f
1 of 1

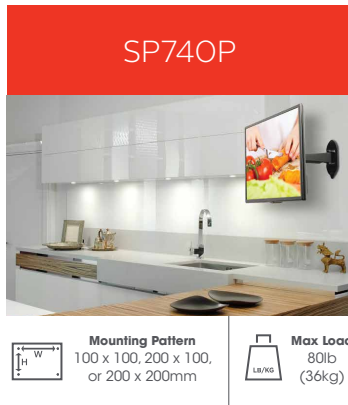

SMARTMOUNT[®] Pivoting Wall Mount

FOR 22" TO 43" DISPLAYS*

The SmartMount[®] Pivoting Wall Mount series offers the most versatile installation features and mounting options. Vertical adjustment ability allows for post installation leveling, making it easier than ever to find the perfect display position. With SP740P, extend the display up to 12.41" (315mm) or fully-retract it to just 3.03" (77mm) from the wall for an improved viewing angle. The display can now simply be installed by a single person with the Hook-and-Hang[™] system. One-Touch[™] tilt technology offers +15°/-5° vertical tilt movement for the ideal viewing angle. Integrated cable management protects, contains and conceals cables for a clean installation.

- Accommodates 100 x 100, 200 x 100, or 200 x 200mm VESA[®] mounting patterns
- Retracts to hold display just 3.03" (77mm) from the wall
- ±90° of pivot allows for perfect display positioning
- Easy leveling ±5° after display installation
- Quick and easy, Hook-and-Hang[™] one-person installation
- Landscape or portrait mounting options increases display versatility
- Includes all necessary wall and display attachment hardware
- Design is UL listed and tested to four times stated load capacity

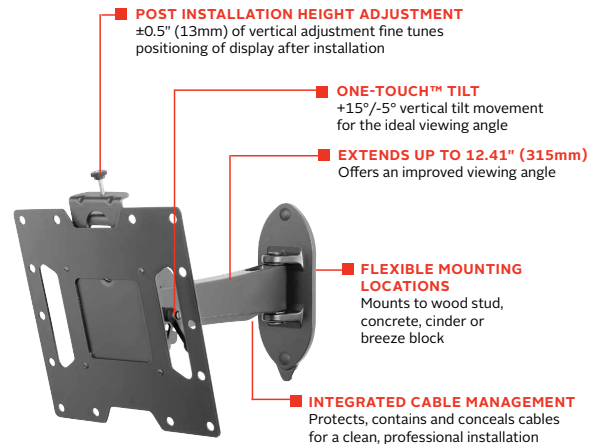

Please visit peerless-av.com/en-us/patents for patent information.

*This display size range is simply a guideline for product selection. Displays larger than the screen size range may still be compatible as long as they fall within the VESA[®] pattern and max weight of the Peerless-AV[®] product.



Extend, turn, tilt, or retract the display for an improved viewing angle.



Integrated cable management keeps cords and cables out of the way.



Comes in color packaging with included installation hardware and easy to follow instructions.

✉ info@peerless-av.com
🌐 peerless-av.com

peerless-AV[®]
Driving Technology Through Innovation

Identification:

Peerless AV SPL740P. 22"-43" Television Wall Mount. Owner provided and Contractor installed. Provide appropriate blocking and connections.
Manufacturers: Peerless AV or approved equal.

C16e
1 of 2

Model Numbers

WARRANTY: Limited 5-year

SP740P SmartMount® Pivoting Wall Mount for 22" to 43" Displays

Product Specifications

	DIMENSIONS (W x H x D)	PRODUCT WEIGHT	LOAD CAPACITY	FINISH	AVAILABLE COLORS
SP740P	15.35" x 10.15" x 3.03"-12.41" (390 x 258 x 77-315mm)	5.40lb (2.45kg)	80lb (36kg)	Scratch Resistant Fused Epoxy	Semi-gloss black

Package Specifications

	PACKAGE SIZE (W x H x D)	PACKAGE SHIP WEIGHT	PACKAGE UPC CODE	PACKAGE CONTENTS	UNITS IN PACKAGE
SP740P	20.50" x 4.19" x 12.00" (521 x 106 x 305mm)	6.2lb (2.8kg)	735029237341	Wall Mount, Wall and Display Installation Hardware, Installation Instructions	1

Accessories

ACC4X4: VESA® 400 x 400mm Adaptor Plate
ACC-UCM: Universal AV Component Mount
ESHV models: AV Wall Shelves
IBA4-W: Easy Mount Recessed Low Voltage Cable Plate
IBA5-W: Recessed Low Voltage Media Plate with Duplex Surge Suppressor
WSP700/WSP701: Metal Stud Wall Plates for 16"/24" Center Metal Studs

All dimensions = inch (mm)

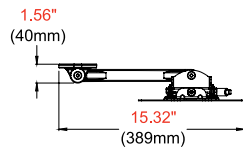

TOP VIEW

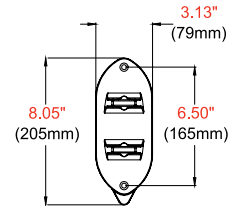

**WALL PLATE
DETAIL**

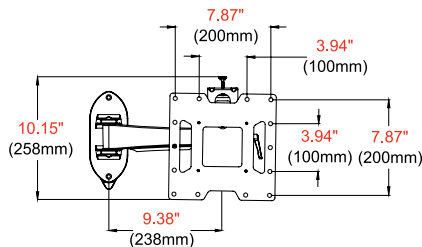

FRONT VIEW

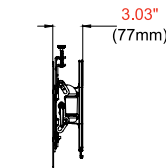

**SIDE VIEW
COLLAPSED**

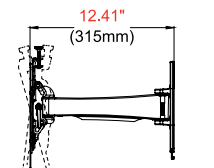

**SIDE VIEW EXTENDED
+15°/-5° TILT**

Architect Specifications

The SmartMount® Pivoting Wall Mount shall be a Peerless-AV model SP740P and shall be located where indicated on the plans. Assembly and installation shall be done according to instructions provided by the manufacturer.

Visit peerless-av.com to see the complete line of AV solutions from Peerless-AV, including outdoor displays, wireless, kiosks, digital audio, display mounts, projector mounts, carts/stands, and a full assortment of accessories.

Peerless-AV
2300 White Oak Circle
Aurora, IL 60502 USA
(800) 865-2112
(630) 375-5100
Fax: (800) 359-6500

Peerless-AV EMEA
Unit 3 Watford Interchange
Colonial Way, Watford
Herts, WD24 4WP
United Kingdom
+44 (0) 1923 200100
Fax: +44 (0) 1923 200101

Peerless-AV Latin America
Ave de las Industrias 413
Parque Industrial Escobedo
Escobedo, N.L.,
Mexico 66062
+52 (81) 8384-8300
Fax: +52 (81) 8384-8360

peerless-AV®
Driving Technology Through Innovation

© 2019 Peerless Industries, Inc. Peerless-AV® and SmartMount® are registered trademarks of Peerless Industries, Inc. All rights reserved.

LIT-1384 rev.2

Identification:

Peerless AV SPL740P. 22"-43" Television Wall Mount. Owner provided and Contractor installed. Provide appropriate blocking and connections.
Manufacturers: Peerless AV or approved equal.

C16e
2 of 2

COMPUTER WORKSTATION SINGLE MONITOR

BY OWNER
(N.I.C.)

Identification:

Computer Workstation, Single Monitor as selected by Owner. Provide appropriate millwork mounting bracket where required. Provide appropriate electrical and communications connections.

C17a
1 of 1

FREE-STANDING MULTI-FUNCTION PRINTER/COPIER

Identification:

Free-Standing, Multi-Function Printer/Copier. Provide appropriate electrical and data connections.

C19f
1 of 1

EQUIPMENT MANUAL

Dietary Equipment

Identification:

Equipment description and/or comment.

D items

FRIGIDAIRE

FFTR1821T D/S/W/B

**TOP MOUNT
REFRIGERATOR**
18.0 CU. FT. TOP MOUNT



AVAILABLE COLORS



PRODUCT DIMENSIONS

Height (Including Hinges & Rollers)	66-1/8"
Width	30"
Depth (Including Door)	29-7/8"

MORE EASY-TO-USE FEATURES

Clear Dairy Bin
Keep foods like butter, cheese and yogurt organized.

CERTIFICATIONS

A.D.A.- Compliant¹
With accessible shelving, and controls that are positioned within arm's reach and allow one-hand operation, our top-freezer refrigerator is A.D.A.- Compliant.



¹When properly installed, this model is A.D.A.-qualified based on the United States Access Board's A.D.A./A.B.A. Accessibility Guidelines and the Department of Justice's 2010 A.D.A. Standards for Accessible Design.

SIGNATURE FEATURES

Store-More™ Humidity-Controlled Crisper Drawers

Keep your fruits and vegetables fresh in our humidity-controlled crisper drawers.

Store-More™ Gallon Door Shelf

Door storage gives you room for larger items like a gallon of milk.

Full-Width Wire Freezer Shelf

Gives you a way to organize items in your freezer better so you can find food quickly.

Reversible Door

Door can be installed to open left or right based on your needs.

frigidaire.com / frigidaire.ca

Identification:

Frigidaire Full-Height Refrigerator, 18 cu. ft. #FFTR1821T. Owner supplied and installed. Contractor to provide appropriate connections. Manufacturer: Frigidaire or approved equal.

D01c
1 of 3

FFTR1821T D/S/W/B TOP MOUNT REFRIGERATOR

18.0 CU. FT.

FRIGIDAIRE

FEATURES

Door Design	UltraSoft™
Door Handle Design	Black Stainless (D), Stainless Steel (S), Color-Coordinated (W/B)
Cabinet Finish (Textured)	Black (D/S), Color-Coordinated (W/B)
Door Stops	Yes
Door Hinge Covers	Black (D/S), Color-Coordinated (W/B)
Door Reverse Option	Yes
Rollers - Front/Rear	Fixed/Yes
Sound Package	
Toe Grille	Black (D/S), Color-Coordinated (W/B)

REFRIGERATOR FEATURES

Interior Lighting	Standard
Refrigerator Shelves	2 Full-Width Glass
Deli Drawer	1 Half-Width
Wine/Can Rack	
Store-More™ Crisper Drawers	2 Clear
Humidity Controls	2
Dairy Compartment	Clear Dairy Door
Door Bins	
Door Racks	3 Full-Width White
Non-Slip Bin Liner	
Tall Bottle Retainers	
Gallon Door Storage	1

FREEZER FEATURES

Door Bins	
Door Racks	2 Full-Width White
Freezer Shelves	1 Full-Width Wire
Factory Ice Maker w/ Large Ice Bin	Optional (PN# IM116)
Lighting	

CERTIFICATIONS

A.D.A. Compliant†	Yes
-------------------	-----

SPECIFICATIONS

Total Capacity (Cu. Ft.)	18.0
Refrigerator Capacity (Cu. Ft.)	14.1
Freezer Capacity (Cu. Ft.)	3.9
Power Supply Connection Location	Right Bottom Rear
Water Inlet Connection Location	Bottom Right
Voltage Rating	120V/60Hz
Connected Load (kW Rating) @ 120 Volts‡	0.72
Amps @ 120 Volts	6.0
Minimum Circuit Required (Amps)	15
Shipping Weight (Approx.)	205 Lbs.

†When properly installed, this model is A.D.A.-qualified based on the United States Access Board's A.D.A./A.B.A. Accessibility Guidelines and the Department of Justice's 2010 A.D.A. Standards for Accessible Design.

‡For use on adequately wired 120V, dedicated circuit having 2-wire service with a separate ground wire. Appliance must be grounded for safe operation.

PRODUCT DIMENSIONS

A - Height (Including Hinges & Rollers)	66-1/8"
B - Width	30"
C - Depth (Including Door)	29-7/8"
Depth with Door Open 90°	58-1/2"

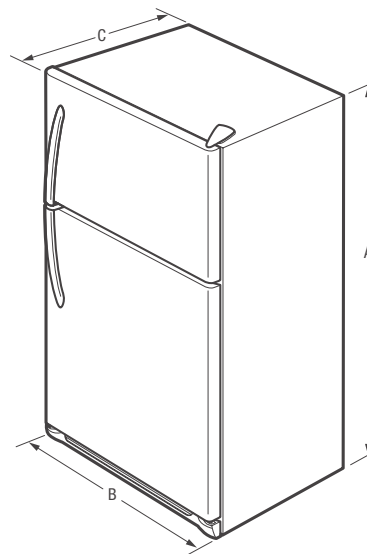

Note: For planning purposes only. Always consult local and national electric, gas and plumbing codes. Refer to Product Installation Guide for detailed installation instructions on the web at frigidaire.com / frigidaire.ca. Specifications subject to change. Accessories information available on the web at frigidaire.com / frigidaire.ca

FRIGIDAIRE

USA • 10200 David Taylor Drive • Charlotte, NC 28262 • 1-800-FRIGIDAIRE • frigidaire.com
CANADA • 5855 Terry Fox Way • Mississauga, ON L5V 3E4 • 1-800-265-8352 • frigidaire.ca

FFTR1821T 10/17

© 2017 Electrolux Home Products, Inc.

Identification:

Frigidaire Full-Height Refrigerator, 18 cu. ft. #FFTR1821T. Owner supplied and installed.
Contractor to provide appropriate connections. Manufacturer: Frigidaire or approved equal.

D01c
2 of 3

FFTR1821T D/S/W/B TOP MOUNT REFRIGERATOR

18.0 CU. FT.

FRIGIDAIRE

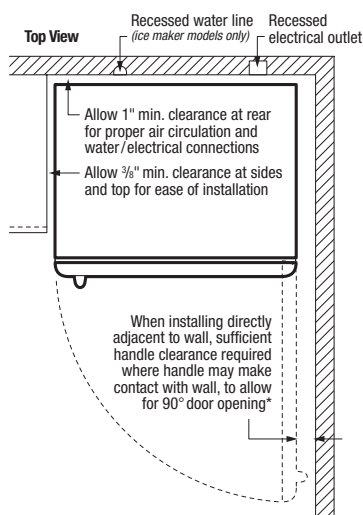

* When installing refrigerator adjacent to wall, cabinet or other appliance that extends beyond front edge of unit, 20" minimum clearance recommended to allow for optimum 140° door swing, providing complete crisper access and removal. (Absolute 3" minimum clearance will ONLY allow for 90° door swing which will provide limited crisper access with restricted removal.)

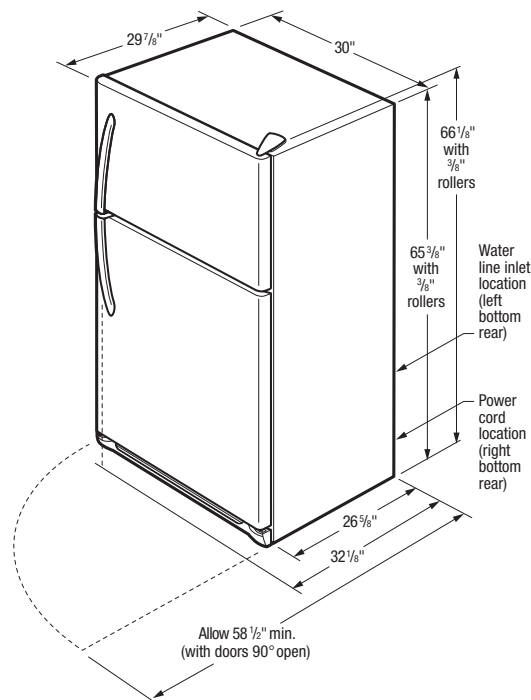

INSTALLATION SPECIFICATIONS

- Product Shipping Weight (approx.) - 205 Lbs.
- An electrical supply with grounded three-prong receptacle is required. The power supply circuit must be installed in accordance with current edition of National Electrical Code (NFPA 70) and local codes & ordinances.
- Voltage Rating - 120V/60 Hz
- Connected Load (kW Rating) @ 120 Volts = 0.72kW
- Amps @ 120 Volts = 6.0 Amps
- Always consult local and national electric & plumbing codes.
- Floor should be level surface of hard material, capable of supporting fully loaded refrigerator.
- Minimum 3/8" clearance required for sides and top of refrigerator with 1" clearance at rear to allow for ease of installation, proper air circulation, and plumbing/electrical connections.
- When installing refrigerator adjacent to wall, cabinet or other appliance that extends beyond front edge of unit, 20" minimum clearance recommended to allow for optimum 140° door swing, providing complete crisper access and removal. (Absolute 3" minimum clearance will ONLY allow for 90° door swing which will provide limited crisper access with restricted removal.)

- To ensure optimum performance, do not install in areas where temperature drops below 55°F or rises above 110°F and avoid installing in direct sunlight or close proximity to range, dishwasher or other heat source.
- For proper ventilation, front grille MUST remain unobstructed.
- Recess electrical outlet when possible.
- Optional Ice Maker Kit (PN# IM116) available for installation in ice maker-ready models only.
- Water recess on rear wall recommended to prevent water line damage.
- Water Pressure - Cold water line must provide between 30 and 100 pounds per square inch (psi).
- Copper tubing with 1/4" O.D. recommended for water supply line with length equal to distance from rear of unit to household water supply line plus 7 additional feet. Optional Water Supply Installation Kits available.

OPTIONAL ACCESSORIES

- Ice Maker Kit - (PN# IM116).



FRIGIDAIRE

USA • 10200 David Taylor Drive • Charlotte, NC 28262 • 1-800-FRIGIDAIRE • frigidaire.com
CANADA • 5855 Terry Fox Way • Mississauga, ON L5V 3E4 • 1-800-265-8352 • frigidaire.ca

Note: For planning purposes only. Always consult local and national electric, gas and plumbing codes. Refer to Product Installation Guide for detailed installation instructions on the web at frigidaire.com / frigidaire.ca. Specifications subject to change. Accessories information available on the web at frigidaire.com / frigidaire.ca.

FFTR1821T 10/17

© 2017 Electrolux Home Products, Inc.

Identification:

Frigidaire Full-Height Refrigerator, 18 cu. ft. #FFTR1821T. Owner supplied and installed.
Contractor to provide appropriate connections. Manufacturer: Frigidaire or approved equal.

D01c
3 of 3

FRIGIDAIRE

Microwave

FFCE1638L S

Countertop



Product Dimensions

Height	12-7/8"
Width	21-3/4"
Depth	18-1/2"

More Easy-To-Use Features

Ready-Select™ Controls

Easily select options with the touch of a button.

Auto One-Touch Options

Our microwaves feature easy-to-use one-touch buttons so you can cook beverages, baked potatoes, popcorn, fresh veggies or even add thirty seconds with the touch of a button.

Effortless™ Defrost

Makes it easy to defrost almost anything, quickly and evenly.

Effortless™ Reheat

Reheat almost anything at the touch of a button.

Multi-Stage Cooking

Our Multi-Stage Cooking option allows you to program power levels and cooking times in advance, so you can program it to defrost, cook and keep a meal warm all at once.

10 Cooking Power Levels

Provides the versatility needed to prepare everything from frozen pizza to pot roast quickly and easily.

Control Lock Option

Electronic Clock/Timer

Helps you keep track of cook times.

Attractive Stainless Steel Exterior

Interior Light

Illuminates the contents of the microwave for increased visibility.

Large Glass Turntable

Even large items fit on our large glass turntable.

Available in:



Stainless
(S)

frigidaire.com

Signature Features

Sensor One-Touch Options

Microwave automatically adjusts power levels and cooking times to cook a variety of items, effortlessly.

Keep Warm Setting

Keep food warm until everything — and everyone — is ready.

Melt & Soften

Use the microwave to quickly melt or soften butter or cheeses for your recipes.

Easy-Set™ Start

Quickly start cooking — one to six minutes — with just one touch.

Identification:

Frigidaire Microwave. Model #FFCE1638L. Owner provided. Contractor to provide appropriate electrical and water connections as per Owner directive. Note: If not readily available, substitutions may be made of equal performance. Manufacturer: Frigidaire or approved equal.

D07j
1 of 2

FRIGIDAIRE

Microwave

FFCE1638L S Countertop

Features	
Control/Timing System	Ready-Select™
Exterior Door Finish	Stainless Steel
Handle Design	Push Button
Microwave Features	
Microwave Capacity (Cu.Ft.)	1.6
Watts (IEC-705 Test Procedure)	1,100
Interior Light	Yes
Interior Color	White
Turntable Diameter	14-1/4"
Turntable On/Off	
Control Lock	Yes
Clock	Yes
Touch Pad Buttons	23
Power Levels	10
Accessory Metal Rack	
Microwave Control Options	
Easy-Set™ Start	Yes
Popcorn Button	Yes
Chicken Nugget Button	
Baked Potato Button	Yes
Sensor Reheat Button	Yes
Snack Button	
Beverage	Yes
Melt & Soften Options	4 / 4
Auto Reheat Options	
Snack Menu Options	
Auto Cook Options	
Auto Defrost Options	Yes
Keep Warm	Yes
Add-30-Seconds	Yes
Sensor Cooking Options	7
Vegetable Cook Sensor	Yes
Delay Start	
User Preferences	
Power Ratings	
Frequency (Mhz)	2,450
Watts @ 120 Volts	1,550
Amps @ 120 Volts	15
Specifications	
Oven Interior Height	10-5/16"
Oven Interior Width	17-1/4"
Oven Interior Depth	15-3/8"
Power Supply Connection Location	Rear
Voltage Rating	120V / 60Hz / 15A
Minimum Circuit Required (Amps)	15
Shipping Weight (Approx.)	47

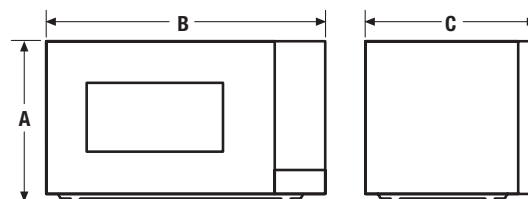

NOTE: For planning purposes only. Always consult local and national electric codes. Refer to Product Installation Guide for detailed installation instructions on the web at frigidaire.com.



Product Dimensions ¹	
A - Height	12-7/8"
B - Width	21-3/4"
C - Depth	18-1/2"

¹A minimum clearance of 3 inches is required between microwave oven and adjacent walls. Leave a minimum clearance of 12 inches above microwave oven.

Accessories information available on the web at frigidaire.com

FRIGIDAIRE

USA • 10200 David Taylor Drive • Charlotte, NC 28262 • 1-800-FRIGIDAIRE • frigidaire.com
CANADA • 5855 Terry Fox Way • Mississauga, ON L5V 3E4 • 1-800-265-8352 • frigidaire.ca

FFCE1638L S 08/10

© 2010 Electrolux Home Products, Inc.

Specifications subject to change.
Printed in the U.S.A.

Identification:

Frigidaire Microwave. Model #FFCE1638L. Owner provided. Contractor to provide appropriate electrical and water connections as per Owner directive. Note: If not readily available, substitutions may be made of equal performance. Manufacturer: Frigidaire or approved equal.

D07j
2 of 2

WATER COOLER

BY OWNER
(N.I.C)

Identification:

Fixed Water Cooler, Owner provided and installed. Contractor to provide cold water and 110v power connections.

D27a

1 of 1

EQUIPMENT MANUAL

Fixed Equipment

Identification:

Equipment description and/or comment.

E items

Hillrom is a part of Baxter

Baxter



Hillrom™

Explore Welch Allyn Green Series 777 Integrated Wall Systems & Transformers featuring our latest Welch Allyn Exam Tools

Welch Allyn **Green Series 777** Integrated Wall Systems and Transformers can help you stay efficient during your examinations. Choose our wide-view **PanOptic Plus** Ophthalmoscope and **MacroView Plus** Otoscope, digital or manual blood pressure devices and integrated or stand-alone oral/axillary/rectal thermometry with a Welch Allyn **SureTemp Plus** Thermometer.

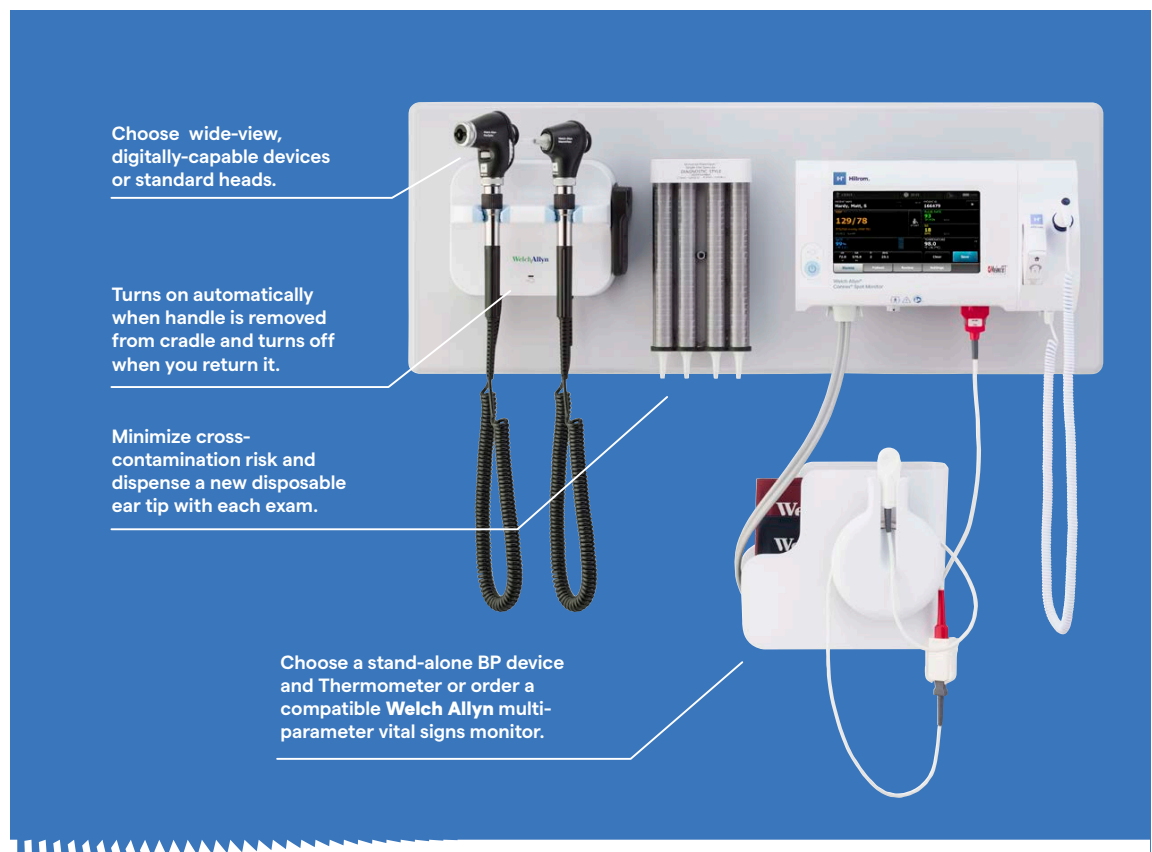

- Easy to upgrade devices from the Welch Allyn 767-series to the 777 Integrated Wall System
- Automatic on/off sensors help conserve energy
- Handle-based rheostats for quick light intensity adjustments
- Modular coiled cords designed to withstand daily use

Identification:

Diagnostic Integrated Wall Systems and Transformers, Green Series 777. Owner provided. Size and configuration as selected by Owner. Contractor to install and provide appropriate blocking and connections. Manufacturer: Baxter - Hillrom|Welch Allyn or approved equal.

E10b

1 of 9

SPECIFICATIONS

Shipping Dimensions & Weight	Width: 34.33 in; Height: 12.83 in; Depth: 9.48 in; Weight: 24.25 lbs
Installed Dimensions	Width: 30.00 in; Height: 11.75 in
Coiled Power Cord Length (extended)	12 ft
Operating Environment	Temperature Limitation: 15°C to 40°C (59°F to 104°F) Humidity Limitation: 15% to 95% Atmospheric Limitation: 700 hPa to 1060 hPa
Transport & Storage	Temperature Limitation: -20°C to 50°C (-4°F to 120°F) Humidity Limitation: 15% to 95% Atmospheric Limitation: 700 hPa to 1060 hPa
Safety Class	II Intermittent Operation
Electrical	Input: 100-240 VAC, 50-60 Hz, 0.18A Output: 5 VDC 1A
Materials	ABS and elastomer rubber. Made from non-latex material.
Approvals	IEC 60601-1, UL 60601-1, IEC 60601-1-2, CAN/CSA C22.2 No 601.1-M90, AS/NZS3200

GUIDANCE ON INSTALLATION

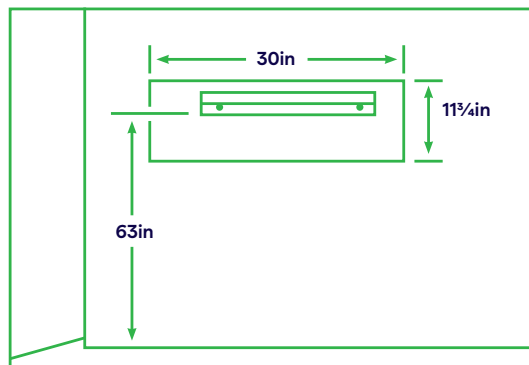

PARTS & ACCESSORIES

- **118-3-US: PanOptic** Plus Ophthalmoscope (head only)
- **238-3: MacroView** Plus Otoscope (head only)
- **21504:** Insufflator Bulb for **MacroView** Otoscope
- **11840-IEX-US: iExaminer SmartBracket** Accessory for **MacroView** Plus Otoscope
- **52432-CLR-1:** 2.75 mm pediatric size **LumiView** Clear Single-Use Ear Specula
- **52434-CLR-1:** 4.25 mm adult size **LumiView** Clear Single-Use Ear Specula
- **05031-750: SureTemp** Plus Thermometer Disposable Probe Covers (Case of 7,500)
- **104299:** Coiled Cord and Handle Assembly (12 ft)
- **PWCD-GS777-B: Green Series 777** Wall System & Transformer Power Cord Kit
- **772320: Green Series 777** Wall System & Transformer USB Power Cord (18 in)

Connect with your **Baxter** representative today to discuss the best **Welch Allyn** Physical Exam & Diagnostic solution for your clinical needs.

hillrom.com

Hill-Rom reserves the right to make changes without notice in design, specifications and models. The only warranty Hill-Rom makes is the express written warranty extended on the sale or rental of its products.

Baxter, Connex, Green Series, Hillrom, iExaminer, LumiView, MacroView, PanOptic, SmartBracket, SureTemp, and Welch Allyn are trademarks of Baxter International Inc. or its subsidiaries. ALL RIGHTS RESERVED. APR348801 Rev 1 27-OCT-2022 ENG-US

Identification:

Diagnostic Integrated Wall Systems and Transformers, Green Series 777. Owner provided. Size and configuration as selected by Owner. Contractor to install and provide appropriate blocking and connections. Manufacturer: Baxter - Hillrom|Welch Allyn or approved equal.

E10b
2 of 9

WALL SYSTEMS AND TRANSFORMERS

		OPHTHALMOSCOPES					OTOSCOPES & ACCESSORIES				VITAL SIGNS			
		Wall Board	777 Wall Transformer	PanOptic Plus with Quick Eye Alignment	PanOptic Basic	Coastal	MacroView Plus, Digitally-Capable	MacroView Basic	Examiner SmartBracket for MacroView Plus	Ear Spec Dispenser	Wall Aneroid	SureTemp Plus Thermometer	Comex Spot Monitor/4-in-1 Vital Signs Device*	5-Year Warranty**
				118-3-US	118-2-US	11720-L	238-3	238-2	11840-EX-US					
777 Integrated Wall Systems	777-PMSWCX-US	✓	✓	✓			✓		✓	✓	✓	✓	✓	✓
	777-PMSWAS-US	✓	✓	✓			✓		✓	✓	✓	✓		✓
	777-PMSWAS-US	✓	✓	✓			✓		✓	✓	✓	✓		✓
	777-PMSWXS-US	✓	✓	✓			✓		✓	✓	✓	✓		✓
	777-PMSWCX-US	✓	✓	✓			✓		✓	✓	✓	✓		✓
	777-PMSWCX-US	✓	✓		✓		✓		✓	✓	✓		✓	
	777-PMSWAS-US	✓	✓		✓		✓		✓	✓	✓	✓		
	777-PMSWAS-US	✓	✓		✓		✓		✓	✓	✓	✓		
	777-PMSWXS-US	✓	✓		✓		✓		✓	✓	✓	✓		
	777-PMSWXS-US	✓	✓		✓		✓		✓	✓	✓	✓		
Wall Transformers	777-SM2WXA	✓	✓			✓		✓		✓	✓	✓		
	777-SM2WXA	✓	✓			✓		✓		✓	✓	✓		
	777-SM2WXA	✓	✓			✓		✓		✓	✓	✓		
	777-SM2WXA	✓	✓			✓		✓		✓	✓	✓		
	777-PMSXXX-US		✓				✓		✓					✓
	777-PMSXXX-US		✓		✓		✓		✓					
	777-SM2CXA	✓				✓								

*Choosing these models will ensure the necessary mounting bracket ships with your wall board.
Welch Allyn Comex Spot Monitor and/or Spot Vital Signs Device must be ordered separately.
**5-year warranty is only applicable to the PanOptic Plus Ophthalmoscope and MacroView Plus Otolaryngoscope heads.

Welch Allyn Green Series 777 Integrated Wall Systems and Transformers can help you stay efficient during your examinations. Select from wide-view and standard ophthalmoscopes and otoscopes, digital or manual blood pressure devices and integrated or stand-alone oral/axillary/rectal thermometry with a **Welch Allyn SureTemp Plus Thermometer**.

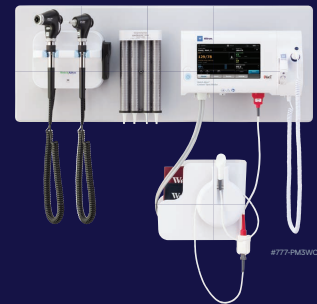

#777-PMSWCX-US

DIAGNOSTIC SETS

	OPHTHALMOSCOPES			OTOSCOPES & ACCESSORIES				POWER HANDLES <small>(each includes one power handle)</small>					
	PanOptic Plus with Quick Eye Alignment	PanOptic Basic	Coastal	MacroView Plus, Digitally-Capable	MacroView Basic	Traditional	Examiner SmartBracket for MacroView Plus	Lithium-Ion Plus with built-in USB	Lithium-Ion	Nickel Cadmium	Hard Case	Soft Case	5-Year Warranty
	118-3-US	118-2-US	11720-L	238-3	238-2	250-2	11840-EX-US						
71-PMSLXE-US	✓			✓				✓			✓		✓
71-PMSLXE				✓				✓			✓		✓
71-PKSLXERF-US	✓		✓					✓			✓		✓
71-PKSLXE-US	✓							✓			✓		✓
71-PMSLXE-US	✓			✓			✓					✓	✓
71-PMSLXU-US		✓			✓				✓		✓		
71-SM2LXU			✓		✓					✓	✓		
71-SM2CXA			✓			✓				✓	✓		
71-SM2CXA			✓		✓					✓	✓		

**5-year warranty is only applicable to the PanOptic Plus Ophthalmoscope and MacroView Plus Otolaryngoscope heads.

Welch Allyn Diagnostic Sets are the perfect solution to keep your exam tools secure for whenever you need them. Try our wide-view optics and fast charge power supplies built into our Plus models.



#71-PMSLXE-US

Identification:

Diagnostic Integrated Wall Systems and Transformers, Green Series 777. Owner provided. Size and configuration as selected by Owner. Contractor to install and provide appropriate blocking and connections. Manufacturer: Baxter - Hillrom|Welch Allyn or approved equal.

E10b
3 of 9

DESK SETS

All **Welch Allyn** Desk Sets shown below ship with a Universal Desk Charger and power supply.

Welch Allyn Desk Sets are compact and perfect for smaller offices to support eye and ear examinations. Try our wide-view optics our Plus models.





#71-PM3LDE-US

	OPHTHALMOSCOPES			OTOSCOPES & ACCESSORIES			POWER HANDLES (sets include two of the same handle)		
	PanOptic Plus with Quick Eye Alignment	PanOptic Basic	Coaxial	MacroView Plus, Digitally-Capable	MacroView Basic	iExaminer SmartBracket for MacroView Plus	Lithium-Ion	Nickel Cadmium	5-Year Warranty**
	118-3-US	118-2-US	11720-L	238-3	238-2	11840-IEX-US			
71-PM3LDE-US	✓			✓		✓	✓		✓
71-PM2LDX-US		✓			✓		✓		
71-SM2LDX			✓		✓		✓		
71-SM2NDX			✓		✓			✓	
71-XXXLDE							✓		

**5-year warranty is only applicable to the PanOptic Plus Ophthalmoscope and MacroView Plus Otoscope heads.

Welch Allyn Ophthalmoscopes

			
	11720-L	118-2-US	118-3-US
Model	Traditional	PanOptic Basic	PanOptic Plus
Warranty	1 year	1 year	5 year
Larger field of view	—	20X	20X
Designed with DuraShock	—	Yes	Yes
Quick Eye alignment technology	—	—	Yes

Welch Allyn Otoscopes

			
	250-2	238-2	238-3
Model	Traditional	MacroView Basic	MacroView Plus
Warranty	1 year	1 year	5 year
Larger field of view	—	3X	3X
Designed with DuraShock	—	Yes	Yes
Digitally-capable for image capture	—	—	Yes

Connect with your **Baxter** representative today to discuss the best **Welch Allyn** Physical Exam & Diagnostic solution for your clinical needs.



hillrom.com

Hill-Rom reserves the right to make changes without notice in design, specifications and models. The only warranty Hill-Rom makes is the express written warranty extended on the sale or rental of its products.
Baxter, Connex, DuraShock, Hillrom, iExaminer, MacroView, PanOptic, Quick Eye, SmartBracket, SureTemp and Welch Allyn are trademarks of Baxter International Inc. or its subsidiaries. ALL RIGHTS RESERVED. APR226002 R3 EN-US 22-APR-2022

Identification:

Diagnostic Integrated Wall Systems and Transformers, Green Series 777. Owner provided. Size and configuration as selected by Owner. Contractor to install and provide appropriate blocking and connections. Manufacturer: Baxter - Hillrom|Welch Allyn or approved equal.

E10b
4 of 9

Welch Allyn®

30" Integrated Wall Panel (REF 77790-3, 4, 5)

Manual part no. 725898, 80021929 Ver. B Revised 2017-04
© 2017 Welch Allyn

WARNING Welch Allyn is not responsible for the integrity of any mounting installation. Welch Allyn recommends that customers contact their Biomedical Engineering Department or maintenance service to ensure professional installation for safety and reliability of any mounting accessory.

1. Choose a location for the panel near the examination table and an electrical outlet.

Sample room layout

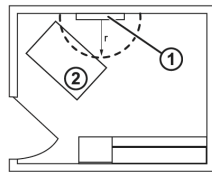

1. Panel
2. Examination table

2. On the selected wall, find and mark the studs, and choose the panel height and corresponding height for the mounting rail bracket.

Recommendation: Place the bracket 63 in. (160 cm) from the floor.

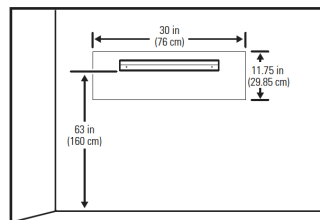

3. Affix the mounting rail bracket to two studs at the selected height using the available screws.

Caution Ensure that the upper "lip" of the bracket sticks out from the wall and that the bracket is level.

4. Hang the panel on the mounting rail bracket.

WARNING Ensure that the channel on the back of the panel fully engages the mounting rail bracket. The panel should be level and flush to the wall.

5. Secure the unit to the wall using the "A" screw.

WARNING Failure to install this security screw may result in personal injury and equipment damage.

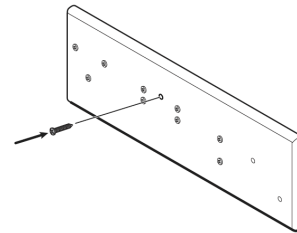

6. Mount the Welch Allyn products to the panel according to the figures on the reverse side of this instruction sheet.

Aneroid blood pressure gauge; position the gauge bottom on the pre-installed screw and then secure the top of the gauge using the two additional screws provided.

SureTemp® Plus thermometer; position the thermometer on the pre-installed screws and then secure it with the two additional screws provided.

Install the remaining products on the pre-installed screws.

For diagnostic systems without SureTemp thermometry, cover the unused screw holes with the FastCaps provided.

Identification:

Diagnostic Integrated Wall Systems and Transformers, Green Series 777. Owner provided. Size and configuration as selected by Owner. Contractor to install and provide appropriate blocking and connections. Manufacturer: Baxter - Hillrom|Welch Allyn or approved equal.

E10b
5 of 9

Instrument location—Aneroid blood pressure gauge

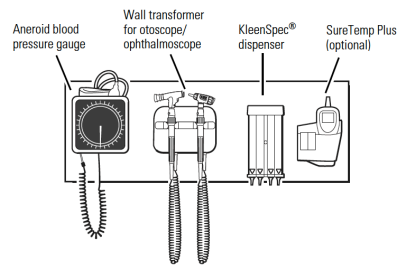

Instrument location—Spot Vital Signs®

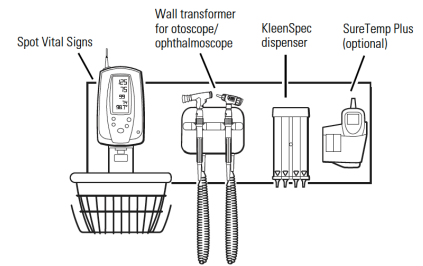

Instrument location—ProBP™

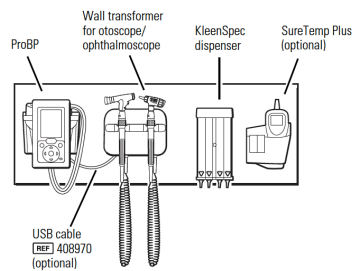

Instrument location—Spot Vital Signs® LXi

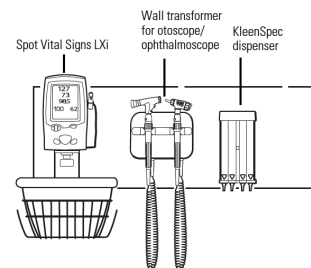

Welch Allyn, Inc.
4341 State Street Road
Skaneateles Falls, NY 13153-0220 USA
www.welchallyn.com

EC REP Regulatory Affairs Representative
Welch Allyn Limited
Navan Business Park
Dublin Road
Navan, County Meath
Republic of Ireland

Manufactured in the USA for Welch Allyn by Heartwood. P/N: 725898

Identification:

Diagnostic Integrated Wall Systems and Transformers, Green Series 777. Owner provided. Size and configuration as selected by Owner. Contractor to install and provide appropriate blocking and connections. Manufacturer: Baxter - Hillrom|Welch Allyn or approved equal.

E10b
6 of 9

Welch Allyn®

34" Integrated Wall Panel (REF 77790-3, 4, 5)

Manual part no. 718345, 80017426 Ver. B Revised 2016-06
© 2016 Welch Allyn

WARNING Welch Allyn is not responsible for the integrity of any mounting installation. Welch Allyn recommends that customers contact their Biomedical Engineering Department or maintenance service to ensure professional installation for safety and reliability of any mounting accessory.

1. Choose a location for the panel near the examination table and an electrical outlet.

Sample room layout

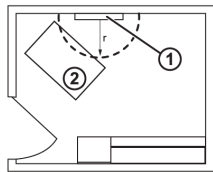

1. Panel
2. Examination table

2. On the selected wall, find and mark the studs, and choose the panel height and corresponding height for the mounting rail bracket.

Recommendation: Place the bracket 63 in. (160 cm) from the floor.

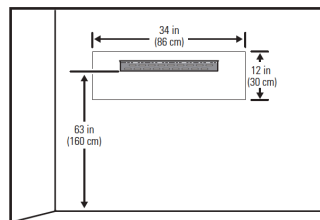

3. Affix the mounting rail bracket to two studs at the selected height using the available screws (anchors are provided for additional support).

If studs are not available, use three anchors and screws.

CAUTION Ensure that the upper "lip" of the bracket sticks out from the wall and that the bracket is level.

4. Hang the panel on the mounting rail bracket.

WARNING Ensure that the channel on the back of the panel fully engages the mounting rail bracket. The panel should be level and flush to the wall.

5. Secure the unit to the wall using the "A" screw.

WARNING Failure to install this security screw may result in personal injury and equipment damage.

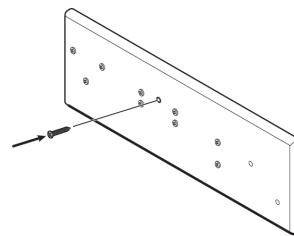

6. Mount the Welch Allyn products to the panel according to the figures on the reverse side of this instruction sheet.

Aneroid blood pressure gauge: position the gauge bottom on the pre-installed screw and then secure the top of the gauge using the two additional screws provided.

SureTemp® Plus thermometer: position the thermometer on the pre-installed screws and then secure it with the two additional screws provided.

Install the remaining products on the pre-installed screws.

For diagnostic systems without SureTemp thermometry, cover the unused screw holes with the FastCaps provided.

Identification:

Diagnostic Integrated Wall Systems and Transformers, Green Series 777. Owner provided. Size and configuration as selected by Owner. Contractor to install and provide appropriate blocking and connections. Manufacturer: Baxter - Hillrom|Welch Allyn or approved equal.

E10b
7 of 9

Instrument location—Aneroid blood pressure gauge

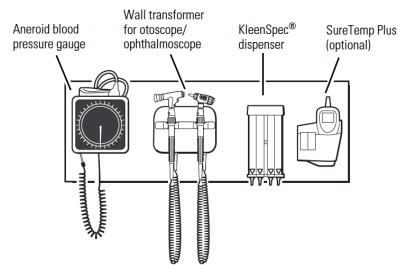

Instrument location—Spot Vital Signs®

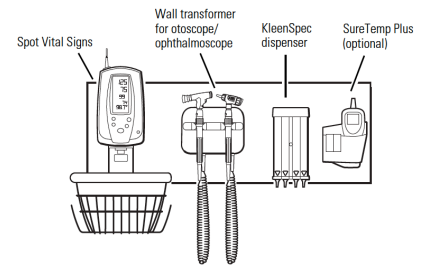

Instrument location—ProBP™

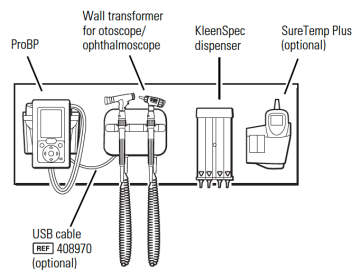

Instrument location—Spot Vital Signs® LXi

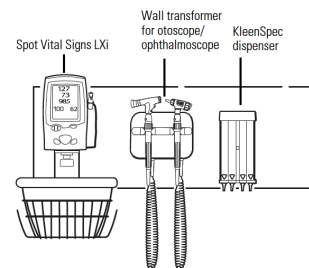

Welch Allyn, Inc.
4341 State Street Road
Skaneateles Falls, NY 13153-0220 USA
www.welchallyn.com

EC REP Regulatory Affairs Representative
Welch Allyn Limited
Navan Business Park
Dublin Road
Navan, County Meath
Republic of Ireland

Manufactured in the USA for Welch Allyn by Heartwood. P/N: HRT718345

Identification:

Diagnostic Integrated Wall Systems and Transformers, Green Series 777. Owner provided. Size and configuration as selected by Owner. Contractor to install and provide appropriate blocking and connections. Manufacturer: Baxter - Hillrom|Welch Allyn or approved equal.

E10b
8 of 9

WelchAllyn®

36" Integrated Wall Panel (REF 77790-6)

Manual part no. 725899, 80021930 Ver. B Revised 2017-04
© 2017 Welch Allyn

WARNING Welch Allyn is not responsible for the integrity of any mounting installation. Welch Allyn recommends that customers contact their Biomedical Engineering Department or maintenance service to ensure professional installation for safety and reliability of any mounting accessory.

1. Choose a location for the panel near the examination table and an electrical outlet.

Sample room layout

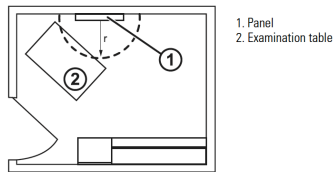

2. On the selected wall, find and mark the studs, and choose the panel height and corresponding height for the mounting rail bracket.

Recommendation: Place the bracket 63 in. (160 cm) from the floor.

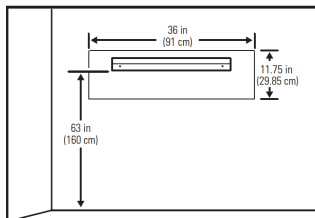

3. Affix the mounting rail bracket to three studs at the selected height using the available screws.

Caution Ensure that the upper "lip" of the bracket sticks out from the wall and that the bracket is level.

4. Hang the panel on the mounting rail bracket.

WARNING Ensure that the channel on the back of the panel fully engages the mounting rail bracket. The panel should be level and flush to the wall.

5. Secure the unit to the wall using the "A" screw.

WARNING Failure to install this security screw may result in personal injury and equipment damage.

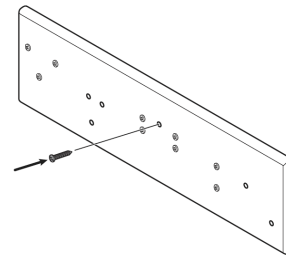

6. Mount the Welch Allyn products to the panel according to the figure below.

Aneroid blood pressure gauge: position the gauge bottom on the pre-installed screw and then secure the top of the gauge using the two additional screws provided.

Basket: secure the basket with the screws provided.

SureTemp® Plus thermometer: position the thermometer on the pre-installed screws and then secure it with the two additional screws provided.

Install the remaining products on the pre-installed screws.

For diagnostic systems without SureTemp thermometry, cover the unused screw holes with the FastCaps provided.

Identification:

Diagnostic Integrated Wall Systems and Transformers, Green Series 777. Owner provided. Size and configuration as selected by Owner. Contractor to install and provide appropriate blocking and connections. Manufacturer: Baxter - Hillrom|Welch Allyn or approved equal.

E10b
9 of 9

LAMINATE LOCKER SYSTEM



*Sample One-Wide
5' High Single Tier
15\"*



*Sample One-Wide
6' High Double Tier
18\"*



*Sample Three-Wide
5' High Triple Tier
15\"*



*Sample Three-Wide
6' High Box Style
21\"*

Identification:

Laminate Locker System, Lockers.com or equal. Refer to finish plans for color selection. Lock as selected by owner. Owner provided and Contractor installed.

E42a

1 of 2

SPECIFICATIONS

TIERS:

SINGLE
TWO
TWO "S" STYLE
THREE
FOUR

FIVE
SIX
SINGLE (ADA)
TWO (ADA)
THREE (ADA)

HEIGHT:

FIVE FEET
SIX FEET

WIDTH:

12"
15"

DEPTH:

15"
18"
21"

FILLER PANELS:

SLOPING HOOD
FLAT TOP
CORNER
IN-LINE
FRONT
SIDE

LOCK OPTION:

BUILT-IN COMBINATION
BUILT-IN LOCK (2) KEYS
PADLOCK (COMBO)
PADLOCK (2) KEYS
ELECTRONIC
CUSTOM
RESETTABLE COMBO

MASTER KEY
MASTER KEY
MASTER KEY
KEY BLANKS

KEY BLANKS

MASTER KEY

Identification:

Laminate Locker System, Lockers.com or equal. Refer to finish plans for color selection. Lock as selected by owner. Owner provided and Contractor installed.

E42a
2 of 2

EQUIPMENT MANUAL

Furniture Equipment

Identification:

Equipment description and/or comment.

F items

GUEST SEATING

BY OWNER
(N.I.C.)

Identification:

Guest Seating. Not in contract, Owner provided.

F02a

1 of 1

TASK CHAIR

BY OWNER
(N.I.C.)

Identification:

Task Chair. Not in contract, Owner provided.

F03a

1 of 1

CAFETERIA / DINING CHAIR

BY OWNER
(N.I.C.)

Identification:

Cafeteria / Dining Chair. Not in contract, Owner provided.

F05a

1 of 1

DESK SYSTEM

BY OWNER
(N.I.C.)

Identification:

Desk System. Not in contract, Owner provided.

F06a

1 of 1

LATERAL FILE CABINET

BY OWNER
(N.I.C.)

Identification:

Lateral File Cabinet. Not in contract, Owner provided.

F07b

1 of 1

END TABLE

BY OWNER
(N.I.C.)

Identification:

End Table. Not in contract, Owner provided.

F09c

1 of 1

CAFETERIA / DINING TABLE

BY OWNER
(N.I.C.)

Identification:

Cafeteria / Dining Table. Not in contract, Owner provided.

F09d

1 of 1

EQUIPMENT MANUAL

Moveable Equipment

Identification:

Equipment description and/or comment.

M items

CODE CART

BY OWNER
(N.I.C)

Identification:

Code Cart. Not in contract, Owner provided.

M02b

1 of 1

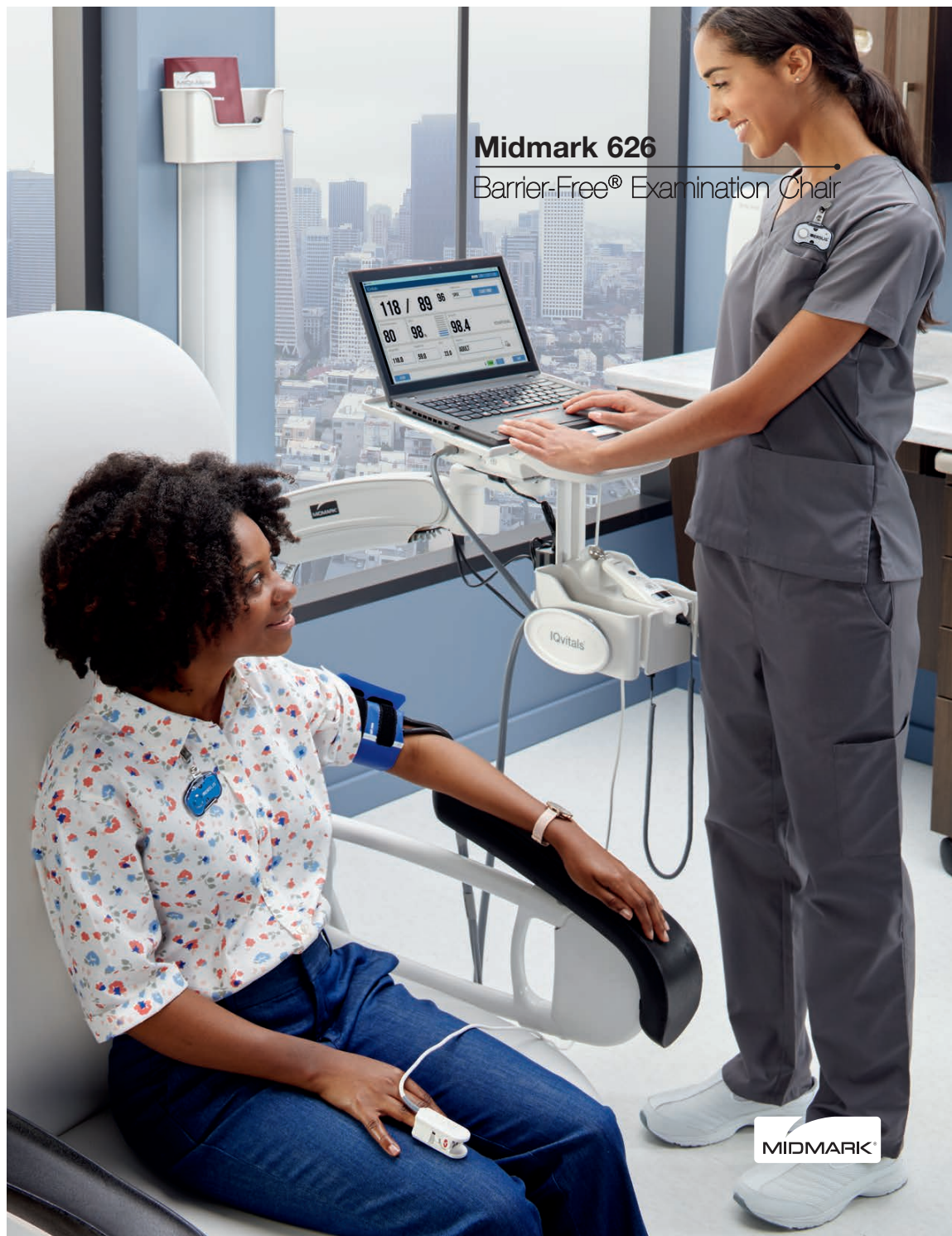

Identification:

Power Examination Chair. Midmark #626. Owner provided.
Manufacturer: Midmark or approved equal.

M04d

1 of 2

Specifications and Color Options

Specifications

Patient Weight Capacity:
650 lb (295 kg)

Height:
Uncompressed: 15.5" Low/37" High
(39 cm/94 cm)

Compressed: 14.6" Low (36 cm)

Premium Upholstery Dimensions (top):
28" W x 60" L
(71 cm/152 cm)

Length with Footrest Extended:
76" (193 cm)

Pelvic Tilt: 5 1/5°

Heated Drawer (24.6 watt)

Heated Drawer Temperature: 92° F to
112° F at 115 VAC input voltage, 70° F
ambient

Paper Roll Holder: Holds 24" x 3.56" dia.
paper roll (61 cm x 9 cm)

Electrical Receptacle:
Electrical Draw: 4A

Hospital-grade, electrical
receptacles on left and right sides

Table Weight:
435 lb (197 kg)

Shipping Weight:
485 lb (220 kg)

Electrical Ratings

115 VAC, 50/60Hz, 12A

Safety Standards

ANSI/AAMI ES60601-1:2005+A2
(R2012) +A1

CAN/CSA-C22.2 No. 60601-1:14

Options

Heated Upholstery Temperatures:
Temperature: Low: 95° F / High:
102° F

Wide Premium Top:
32" W x 60" L (97 x 152 cm)
IQscale®:
Scale Capacity: 650 lb (294.8 kg)
Scale Resolution: 0.2 lb (0.1 kg)

Scale Accuracy:
30 - 100 lb
(13.6 - 45.4 kg) ± 0.2 lb (0.1 kg)
100 - 300 lb
(45.4 - 136.1 kg) ± 0.4 lb (0.2 kg)
300 - 500 lb
(136.1 - 226.8 kg) ± 0.6 lb (0.3 kg)
500 - 650 lb
(226.8 - 294.8 kg) ± 0.8 lb (0.4 kg)

Vitals device ports on left and right
sides, plus rear of table.

Accessories

Patient Support Rails Plus™

Patient Support Rails™

Articulating Knee Crutches

Standard Knee Crutches

Stainless Steel Treatment Pan

IQvitals® Table Mount

Standard Upholstery Colors

-  Mist-813
-  Stone-814
-  Restful Path-858
-  Iron Ore-851
-  Lunar Gray-845
-  Obsidian-857
-  Oasis-843
-  Soothing Blue-855
-  Dream-847
-  Mineral-844
-  Healing Waters-848
-  Shaded Garden-853
-  Citrus-849
-  Sandy Retreat-850
-  Curative Copper-846
-  Cranberry-859
-  Dark Linen-856
-  Latte-860
-  Robust Brown-852
-  Deep Earth-854

UltraFree® Upholstery Colors

-  UltraFree Stone-865
-  UltraFree Restful Path-868
-  UltraFree Obsidian-867
-  UltraFree Harbor-861
-  UltraFree Wheatgrass-862
-  UltraFree Spice-863
-  UltraFree Cranberry-869
-  UltraFree Dark Linen-866
-  UltraFree Latte-870
-  UltraFree Branch-864

*UltraLeather® by Ultrafabrics

Midmark 626 Comparison Chart

	14.6" Seat Height (Compressed)	Clean Assist™ Roller System	Active Sensing Technology®	Lockout Hand & Foot Controls	650 lb Weight Capacity	Standard Rail Accessory Receivers	Tempen- Resistant Electrical Receptacles	Drawer Heater & Pelvic Tilt	Heated Upholstery	IQscale
626-001	•	•	•	•	•	•	•	•		
626-002	•	•	•	•	•	•	•	•	•	
626-003	•	•	•	•	•	•	•	•		•
626-004	•	•	•	•	•	•	•	•	•	•

Midmark is an ISO 13485 Certified Company
For more information or a demonstration, contact your Midmark
dealer or call: 1-800-MIDMARK
Outside the U.S.A. call: 1-937-526-3662
or visit our website at midmark.com

© 2018 Midmark Corporation
Midmark Corporation, Dayton, OH.
Products subject to improvement changes without notice
Litho in U.S.A. 007-10066-00 Rev. A (1/18)



Identification:

Power Examination Chair. Midmark #626. Owner provided.
Manufacturer: Midmark or approved equal.

M04d
2 of 2

SUPER ERECTA® SHELVING SYSTEM



Genuine Metro



LEARN MORE



**The easiest way
to build Shelving.**



**SHELVING
ASSEMBLY**



Super Erecta® Shelving System

The original wire storage system.

A storage system that defines the extent of space, Super Erecta's revolutionary concept was fresh and innovative from its start — nearly 50 years ago. It has continued to evolve, with nearly 100 highly specialized accessories, aimed at meeting the diversity of today's challenges.

- **Adjustable:** Shelves can be set and repositioned at precise 1" (25mm) increments along the length of the numbered posts.
- **Unique Design:** Open-wire design minimizes dust accumulation, allows a free circulation of air, and greater visibility of stored items.
- **Mobile:** Full choice of caster types available for mobile applications.



SiteSelect posts provide a visual guide for positioning and adjusting shelves, saving considerable time during assembly and adjustment. An easy-to-identify double groove, every 8" (203mm), offers a quick way to align all shelves.

Identification:

Metro Super Erecta Wire Shelving System. Refer to architectural drawings for appropriate sizing, configuration and locations. Owner provided.
Manufacturer: Metro or approved equal

M08b

1 of 9



SUPER ERECTA® SHELVING SYSTEM

Available Finishes



Wire
& Solid



Type 304 Polished Stainless Steel
Addresses the most aggressive applications and environments. All-stainless solid and wire options exist for high temperature automated cart wash and autoclave applications.

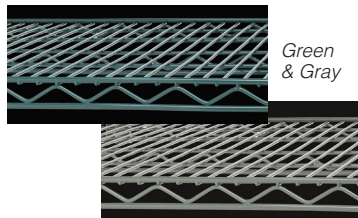

Green
& Gray



Metroseal™ Epoxy
Corrosion resistant finish for wet or high humidity environments with a 12-year warranty against rust and corrosion. Microban antimicrobial is built into the finish to keep the product "cleaner between cleanings."

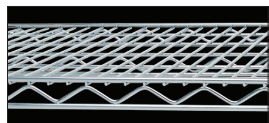

Chrome Plating
Nickel-chrome finish for dry, low humidity environments. Metro's durable chrome finish includes a protective lacquer coat.

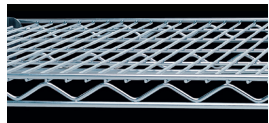

Brite
Economical, chromate finish for dry, low humidity environments. Metro's Brite finish provides the look of chrome and includes a protective lacquer coat.



Standard Epoxy and Designer Finishes

A pleasing aesthetic and basic protection for dry environments.



Available Posts

Standard Stationary Post with adjustable leveling foot. Stainless models also feature a stainless leveling foot. Use Foot Plates for greater stability.

Standard Mobile-Ready Posts accept Metro stem casters. Use these for the majority of standard duty transport and movable storage applications.

Cart Wash and Autoclave Applications
Swaged stainless post has a fastened aluminum post cap and is specifically designed to withstand high temperatures. See page 59 for part numbers.

Heavy Duty Transport
Staked post attaches to a dolly truck to address abusive transport applications. The reinforced connection between the base receptacle and post provides a more secure connection to the dolly truck. See page 60 for part numbers.



1.800.992.1776 • WWW.METRO.COM

Identification:

Metro Super Erecta Wire Shelving System. Refer to architectural drawings for appropriate sizing, configuration and locations. Owner provided.
Manufacturer: Metro or approved equal

M08b
2 of 9

SUPER ERECTA® SHELVING SYSTEM



Wire Shelves — {10.01a} {10.10a}

Weight capacity is 800 lbs. (363kg) per shelf for lengths of 18" to 48" (457 to 1219mm) 600 lbs. (272kg) for lengths of 54" (1370mm) or longer. Stationary units have a maximum capacity of 2,000 lbs. (907kg). Mobile units have a maximum capacity of three times the caster load rating up to but not exceeding 1,000 lbs. (453kg) total.

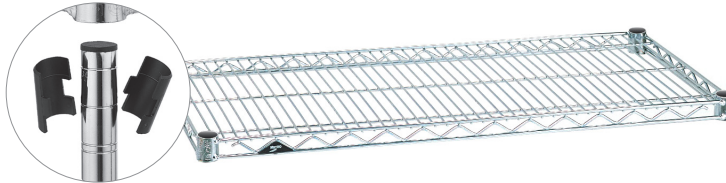

**The easiest way
to build Shelving.**

Nominal Width/Length		Cat. No.	Cat. No.	Cat. No.	Cat. No.	Cat. No.
(in.)	(mm)	Super Erecta Brite	Chrome	Metroseal Green (K3) with Microban	Metroseal Gray (K4) with Microban	Stainless
14x24	355x610	1424BR	1424NC	1424NK3	1424NK4	1424NS
14x30	355x760	1430BR	1430NC	1430NK3	1430NK4	1430NS
14x36	355x914	1436BR	1436NC	1436NK3	1436NK4	1436NS
14x42	355x1066	1442BR	1442NC	1442NK3	1442NK4	1442NS
14x48	355x1219	1448BR	1448NC	1448NK3	1448NK4	1448NS
14x60	355x1524	1460BR	1460NC	1460NK3	1460NK4	1460NS
14x72	355x1829	1472BR	1472NC	1472NK3	1472NK4	1472NS
18x18	457x457	-	1818NC	1818NK3	1818NK4	-
18x24	457x610	1824BR	1824NC	1824NK3	1824NK4	1824NS
18x30	457x760	1830BR	1830NC	1830NK3	1830NK4	1830NS
18x36	457x914	1836BR	1836NC	1836NK3	1836NK4	1836NS
18x42	457x1066	1842BR	1842NC	1842NK3	1842NK4	1842NS
18x48	457x1219	1848BR	1848NC	1848NK3	1848NK4	1848NS
18x54	457x1370	1854BR	1854NC	1854NK3	1854NK4	1854NS
18x60	457x1524	1860BR	1860NC	1860NK3	1860NK4	1860NS
18x72	457x1829	1872BR	1872NC	1872NK3	1872NK4	1872NS
21x24	530x610	2124BR	2124NC	2124NK3	2124NK4	2124NS
21x30	530x760	2130BR	2130NC	2130NK3	2130NK4	2130NS
21x36	530x914	2136BR	2136NC	2136NK3	2136NK4	2136NS
21x42	530x1066	2142BR	2142NC	2142NK3	2142NK4	2142NS
21x48	530x1219	2148BR	2148NC	2148NK3	2148NK4	2148NS
21x54	530x1370	2154BR	2154NC	2154NK3	2154NK4	2154NS
21x60	530x1524	2160BR	2160NC	2160NK3	2160NK4	2160NS
21x72	530x1829	2172BR	2172NC	2172NK3	2172NK4	2172NS
24x24	610x610	2424BR	2424NC	2424NK3	2424NK4	2424NS
24x30	610x760	2430BR	2430NC	2430NK3	2430NK4	2430NS
24x36	610x914	2436BR	2436NC	2436NK3	2436NK4	2436NS
24x42	610x1066	2442BR	2442NC	2442NK3	2442NK4	2442NS
24x48	610x1219	2448BR	2448NC	2448NK3	2448NK4	2448NS
24x54	610x1370	2454BR	2454NC	2454NK3	2454NK4	2454NS
24x60	610x1524	2460BR	2460NC	2460NK3	2460NK4	2460NS
24x72	610x1829	2472BR	2472NC	2472NK3	2472NK4	2472NS

Note: The actual length of the shelves is .12" (3.2mm) shorter than the nominal dimension shown. The actual depth of the shelves is .12" (3.2mm) greater than the nominal dimension shown.

SHELVING HEIGHT GUIDELINES

Shelf Depth	14" (356mm)	18" (457mm)	21" (533mm)	24" (610mm)	30" (762mm)	36" (914mm)
Maximum Allowable Post Height						
Stationary	*63" (1600mm)	*86" (2184mm)	*86" (2184mm)	96" (2438mm)	96" (2438mm)	96" (2438mm)
Mobile	54" (1372mm)	74" (1880mm)	74" (1880mm)	86" (2184mm)	86" (2184mm)	86" (2184mm)

*Note: For stationary units with foot plates or wall brackets properly attached to the floor or wall, the maximum allowable height is 96" (2438mm).

Identification:

Metro Super Erecta Wire Shelving System. Refer to architectural drawings for appropriate sizing, configuration and locations. Owner provided.
Manufacturer: Metro or approved equal



SUPER ERECTA® SHELVING SYSTEM

Super Wide Shelving — {10.01a} {10.10a}

30" & 36" wide shelves are best for large quantities of supplies or large, bulky objects.

Cat. No. Chrome	Cat. No. Metroseal Green	Cat. No. Metroseal Gray	Cat. No. Stainless Steel	Width/Length		Pkd. Wt.	
				(in.)	(mm)	(lbs.)	(kg)
3036NC	3036NK3	3036NK4	3036NS	30x36	760x914	14.2	6.4
3048NC	3048NK3	3048NK4	3048NS	30x48	760x1219	17.7	8.0
3060NC	3060NK3	3060NK4	3060NS	30x60	760x1524	20.2	9.2
3072NC	3072NK3	3072NK4	3072NS	30x72	760x1829	22.7	10.3
3636NC	3636NK3	-	3636NS	36x36	910x914	16.7	7.6
3648NC	3648NK3	-	3648NS	36x48	910x1219	21.6	9.8
3660NC	3660NK3	-	3660NS	36x60	910x1524	26.4	12.0
3672NC	3672NK3	-	3672NS	36x72	910x1829	31.6	14.3

Load Capacity Per Shelf 800 lbs. (363kg) for lengths 48" (1219mm) or shorter. 600 lbs. (272kg) for lengths 54" (1370mm) or longer.



SiteSelect® Posts — {10.01a} {10.10a}

Stationary Super Erecta® SiteSelect posts are fitted with adjustable leveling bolts. Mobile posts come without leveling bolt assembly to accommodate stem casters.

Stationary Posts

Cat. No. Chrome	Cat. No. Metroseal Green (K3) with Microban	Cat. No. Metroseal Gray (K4) with Microban	Cat. No. Stainless Steel	Actual Height		Approx. Pkd. Wt.	
				(in.)	(mm)	(lbs.)	(kg)
7P	7PK3	7PK4	-	7.4	187	0.5	0.3
13P	13PK3	13PK4	13PS	14.4	365	1	0.5
27P	27PK3	27PK4	27PS	28.4	720	1.75	0.75
33P	33PK3	33PK4	33PS	34.4	873	2	0.9
54P	54PK3	54PK4	54PS	54.4	1382	3	1.4
63P	63PK3	63PK4	63PS	62.4	1585	3.5	1.6
74P	74PK3	74PK4	74PS	74.5	1892	4	1.8
86P	86PK3	86PK4	86PS	86.5	2197	5	2.3
*96P	-	-	-	96.5	2450	5.5	2.5

*96P should not be used on units less than 24" (610mm) deep. Consult Metro Engineering for alternate recommendations.

Mobile Posts (For use with Stem Casters)

Cat. No. Chrome	Cat. No. Metroseal Green (K3) with Microban	Cat. No. Metroseal Gray (K4) with Microban	Cat. No. Stainless Steel	Actual Height		Approx. Pkd. Wt.	
				(in.)	(mm)	(lbs.)	(kg)
13UP	13UPK3	13UPK4	13UPS	13.75	349	1	0.5
27UP	27UPK3	27UPK4	27UPS	27.75	704	1.75	0.75
33UP	33UPK3	33UPK4	33UPS	33.75	857	2	0.9
54UP	54UPK3	54UPK4	54UPS	53.8	1366	3	1.4
63UP	63UPK3	63UPK4	63UPS	61.8	1570	3.5	1.6
70UP	70UPK3	70UPK4	-	69.75	1771	3.75	1.7
74UP	74UPK3	74UPK4	74UPS	73.9	1876	4	1.8
86UP	86UPK3	86UPK4	86UPS	85.9	2181	4.5	2.0

Staked Posts (For use with Truck Dollies)

- Each post connects to the truck dolly through the stem receptacle. The stem receptacle is staked into the bottom of the post for abusive mobile applications. Each includes a leveling/connecting bolt.

Cat. No. Chrome	Cat. No. Stainless Steel	Height		Pkd. Wt.	
		(in.)	(mm)	(lbs.)	(kg)
54P-STKD	54PS-STKD	54.4	1382	3	1.4
63P-STKD	63PS-STKD	62.4	1585	3.5	1.6
74P-STKD	74PS-STKD	74.5	1892	4	1.8

Swaged Posts (For use with Stem Casters in Cart Wash Applications)

- Each post has an aluminum cap swaged into the top of the post.

Cat. No. Stainless Steel	Height		Pkd. Wt.	
	(in.)	(mm)	(lbs.)	(kg)
33UPS-SW	33.75	857	2	.9
54UPS-SW	53.8	1366	3	1.4
63UPS-SW	61.8	1570	3.5	1.6



SiteSelect Posts feature double grooves every 8" (203mm) to aid assembly.



Stationary Post



Post for Stem Caster



Staked Post



Swaged Post

Special Length Posts

Cut posts are available. Consult your Metro representative for more information.

1.800.992.1776 • WWW.METRO.COM

49

Identification:

Metro Super Erecta Wire Shelving System. Refer to architectural drawings for appropriate sizing, configuration and locations. Owner provided.
Manufacturer: Metro or approved equal

M08b
4 of 9

SUPER ERECTA® SHELVING SYSTEM



Designer Color Shelving — {10.14}

Width/Length (in.)	(mm)	Pkd. Wt. (lbs.) (kg)	Cat. No. Black	Cat. No. White	Cat. No. Smoked Glass	Cat. No. Copper Hammertone†
14x24	355x610	6 2.7	1424NBL	1424NW	1424N-DSG	1424N-DCH
14x30	355x760	7 3.2	1430NBL	1430NW	1430N-DSG	1430N-DCH
14x36	355x914	8 3.6	1436NBL	1436NW	1436N-DSG	1436N-DCH
14x42	355x1066	9.5 4.3	1442NBL	1442NW	1442N-DSG	1442N-DCH
14x48	355x1219	10.5 4.7	1448NBL	1448NW	1448N-DSG	1448N-DCH
14x60	355x1524	14 6.3	1460NBL	1460NW	1460N-DSG	1460N-DCH
14x72	355x1829	17 7.7	1472NBL	1472NW	1472N-DSG	1472N-DCH
18x18	457x457	6 2.7	1818NBL	1818NW	1818N-DSG	1818N-DCH
18x24	457x610	7 3.2	1824NBL	1824NW	1824N-DSG	1824N-DCH
18x30	457x760	8 3.6	1830NBL	1830NW	1830N-DSG	1830N-DCH
18x36	457x914	9.5 4.3	1836NBL	1836NW	1836N-DSG	1836N-DCH
18x42	457x1066	11 5.0	1842NBL	1842NW	1842N-DSG	1842N-DCH
18x48	457x1219	12 5.4	1848NBL	1848NW	1848N-DSG	1848N-DCH
18x54	457x1370	14.5 6.6	1854NBL	1854NW	1854N-DSG	1854N-DCH
18x60	457x1524	17 7.7	1860NBL	1860NW	1860N-DSG	1860N-DCH
18x72	457x1829	20 9.1	1872NBL	1872NW	1872N-DSG	1872N-DCH
21x24	530x610	8 3.6	2124NBL	2124NW	2124N-DSG	2124N-DCH
21x30	530x760	9 4.1	2130NBL	2130NW	2130N-DSG	2130N-DCH
21x36	530x914	11 5.0	2136NBL	2136NW	2136N-DSG	2136N-DCH
21x42	530x1066	12 5.4	2142NBL	2142NW	2142N-DSG	2142N-DCH
21x48	530x1219	14 6.4	2148NBL	2148NW	2148N-DSG	2148N-DCH
21x54	530x1370	16 7.3	2154NBL	2154NW	2154N-DSG	2154N-DCH
21x60	530x1524	18 8.2	2160NBL	2160NW	2160N-DSG	2160N-DCH
21x72	530x1829	24 10.9	2172NBL	2172NW	2172N-DSG	2172N-DCH
24x24	610x610	9 4.1	2424NBL	2424NW	2424N-DSG	2424N-DCH
24x30	610x760	11 5.0	2430NBL	2430NW	2430N-DSG	2430N-DCH
24x36	610x914	13 5.9	2436NBL	2436NW	2436N-DSG	2436N-DCH
24x42	610x1066	15 6.8	2442NBL	2442NW	2442N-DSG	2442N-DCH
24x48	610x1219	16 7.3	2448NBL	2448NW	2448N-DSG	2448N-DCH
24x54	610x1370	19 8.6	2454NBL	2454NW	2454N-DSG	2454N-DCH
24x60	610x1524	21 9.5	2460NBL	2460NW	2460N-DSG	2460N-DCH
24x72	610x1829	26 11.8	2472NBL	2472NW	2472N-DSG	2472N-DCH

Note: White epoxy Super Erecta shelves come with white split sleeves.

Note: All Black, Smoked Glass and Designer Super Erecta shelves come with black split sleeves.

Note: Black shelving is NSF listed. White, Smoked Glass, and Designer Colors are not NSF listed.

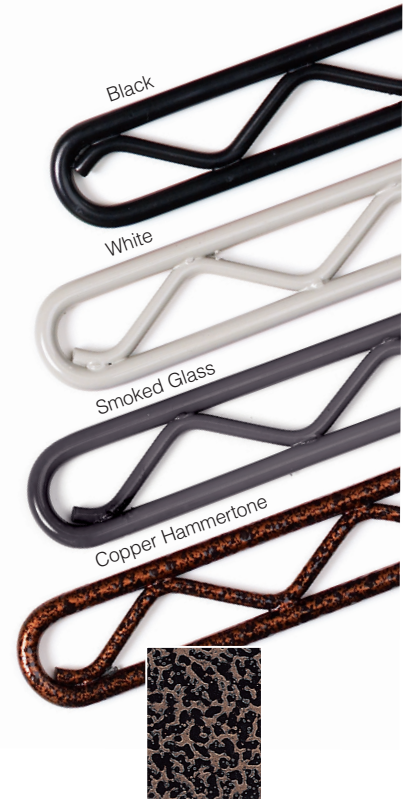

Posts — {10.14}

Stationary Posts

Height* (in.)	(mm)	Pkd. Wt. (lbs.) (kg)	Cat. No. Black	Cat. No. White	Cat. No. Smoked Glass	Cat. No. Copper Hammertone
7.4	191	0.5 0.3	7PBL	7PW	7P-DSG	7P-DCH
14.4	370	1 0.5	13PBL	13PW	13P-DSG	13P-DCH
28.4	699	1.75 .75	27PBL	27PW	27P-DSG	27P-DCH
34.4	875	2 0.9	33PBL	33PW	33P-DSG	33P-DCH
54.4	1385	3 1.4	54PBL	54PW	54P-DSG	54P-DCH
62.4	1590	3.5 1.6	63PBL	63PW	63P-DSG	63P-DCH
74.5	1895	4 1.8	74PBL	74PW	74P-DSG	74P-DCH
86.5	2200	5 2.3	86PBL	86PW	86P-DSG	86P-DCH

Mobile Posts

Height* (in.)	(mm)	Cat. No. Black	Cat. No. White	Cat. No. Smoked Glass	Cat. No. Copper Hammertone
—	—	—	—	—	—
27.75	699	27UPBL	27UPW	27UP-DSG	27UP-DCH
33.75	875	33UPBL	33UPW	33UP-DSG	33UP-DCH
53.8	1358	54UPBL	54UPW	54UP-DSG	54UP-DCH
61.8	1590	63UPBL	63UPW	63UP-DSG	63UP-DCH
73.9	2200	74UPBL	74UPW	74UP-DSG	74UP-DCH
85.9	2454	86UPBL	86UPW	86UP-DSG	86UP-DCH



50

1.800.992.1776 • WWW.METRO.COM

Identification:

Metro Super Erecta Wire Shelving System. Refer to architectural drawings for appropriate sizing, configuration and locations. Owner provided.
Manufacturer: Metro or approved equal

M08b
5 of 9



SUPER ERECTA® SHELVING SYSTEM

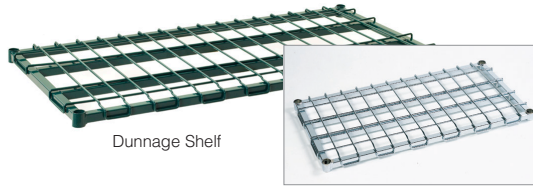

Heavy-Duty Dunnage Shelves — {10.45}

Enhance the weight-bearing capacity. 36" (914mm) shelf holds 1,600 pounds (725kg) (uniformly distributed); 48" (1219mm) shelves carry up to 1,300 pounds (590kg); 60" (1524mm) shelves bear up to 1,000 pounds (453kg).

- Removable wire mat: Lifts off for easy cleaning. .31" (7.9mm) diameter wire. Support frames: 1" (25mm) square tubing.

Width/Length (in.)	Width/Length (mm)	Cat. No. Chrome	Cat. No. Metroseal Green with Microban®	Cat. No. Stainless
18x24	457x610	1824DRC	1824DRK3	-
18x30	457x760	1830DRC	1830DRK3	-
18x36	457x914	1836DRC	1836DRK3	1836DRS
18x48	457x1219	1848DRC	1848DRK3	1848DRS
18x60	457x1524	1860DRC	1860DRK3	1860DRS
21x24	530x610	-	2124DRK3	-
21x30	530x760	-	2130DRK3	-
21x36	530x914	-	2136DRK3	-
21x48	530x1219	-	2148DRK3	-
21x60	530x1524	-	2160DRK3	-
24x24	610x610	2424DRC	2424DRK3	-
24x30	610x760	2430DRC	2430DRK3	-
24x36	610x914	2436DRC	2436DRK3	2436DRS
24x48	610x1219	2448DRC	2448DRK3	2448DRS
24x60	610x1524	2460DRC	2460DRK3	2460DRS

Important: In stationary shelving, stability decreases as the ratio of height to width increases and when heavier loads are placed on upper shelves. Shelving stability is attained by keeping units as wide and low as possible, and placing heavy loads low on the shelving unit.

Cantilever Shelves — {10.05}

Adds convenient space above a storage unit. Drop mat design creates a retaining ledge around the entire 12" (305mm) deep shelf. Remember to order rear posts taller than front posts to accommodate these shelves.

Length (in.)	Length (mm)	Approx. Pkd. Wt. Each (lbs.) (kg)	Cat. No. Chrome	Cat. No. Black	Cat. No. White	Cat. No. Smoked Glass
24	610	4.5 2.0	1224CSNC	1224CSNBL	1224CSNW	1224CSN-DSG
30	750	5 2.3	1230CSNC	1230CSNBL	1230CSNW	1230CSN-DSG
36	914	5.75 2.6	1236CSNC	1236CSNBL	1236CSNW	1236CSN-DSG
42	1066	6.75 3.1	1242CSNC	1242CSNBL	1242CSNW	1242CSN-DSG
48	1219	7.75 3.5	1248CSNC	1248CSNBL	1248CSNW	1248CSN-DSG
60	1524	9.5 4.3	1260CSNC	1260CSNBL	1260CSNW	1260CSN-DSG



Cantilever Shelves

Super Erecta® Convenience Pack — {10.03}

- A complete shelving unit in a single box — the easy-to-order alternative to separate shelving components.
- Available in Super Erecta Brite, chrome and Metroseal Green finishes.

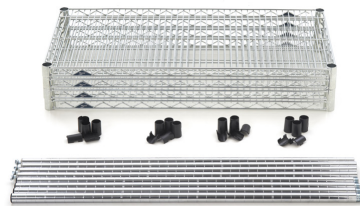

Unassembled Convenience Pack

Each pack includes four shelves with split sleeves and four split posts with threaded connectors and leveling feet.



Width/Length/Height (in.)	Width/Length/Height (mm)	Approx. Pkd. Wt. (lbs.) (kg)	Cat. No. Super Erecta Brite	Cat. No. Chrome	Cat. No. Metroseal 3 with Microban®
18x36x74.5	457x914x1890	51 23	EZ1836BR-4	EZ1836NC-4	EZ1836NK3-4
18x48x74.5	457x1219x1890	63 28.5	EZ1848BR-4	EZ1848NC-4	EZ1848NK3-4
18x60x74.5	457x1524x1890	82 37	EZ1860BR-4	EZ1860NC-4	EZ1860NK3-4
24x36x74.5	610x914x1890	66 30	EZ2436BR-4	EZ2436NC-4	EZ2436NK3-4
24x48x74.5	610x1219x1890	76 34.5	EZ2448BR-4	EZ2448NC-4	EZ2448NK3-4
24x60x74.5	610x1524x1890	102 46	EZ2460BR-4	EZ2460NC-4	EZ2460NK3-4

Indicates antimicrobial product.

1.800.992.1776 • WWW.METRO.COM

51

Identification:

Metro Super Erecta Wire Shelving System. Refer to architectural drawings for appropriate sizing, configuration and locations. Owner provided.
Manufacturer: Metro or approved equal

M08b
6 of 9

SUPER ERECTA® STARTER AND ADD-ON UNITS



Shelving Starter and Add-On Units — {10.90}

- Starter Units consist of four posts and indicated number of Super Erecta shelves.
- Add-On Units consist of two posts, indicated number of shelves, and two "S" Hooks per shelf, for attaching shelf to adjacent unit.

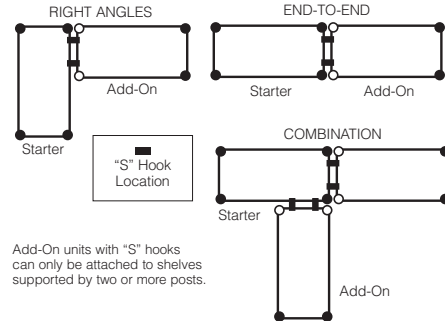

Chrome Finish

4-Shelf
Chrome Unit with
63" Posts

4-Shelf
Chrome Unit
with 74" Posts

5-Shelf
Chrome Unit with
74" Posts

Nominal Width/Length (in.)	Nominal Width/Length (mm)	Cat. No. Starter Unit	Cat. No. Add-On Unit	Cat. No. Starter Unit	Cat. No. Add-On Unit	Cat. No. Starter Unit	Cat. No. Add-On Unit
18x24	457x610	N316C	AN316C	-	5N317C	5AN317C	
18x30	457x760	N326C	AN326C	-	5N327C	5AN327C	
18x36	457x914	N336C	AN336C	N337C	5N337C	5AN337C	
18x42	457x1060	N346C	AN346C	N347C	5N347C	5AN347C	
18x48	457x1219	N356C	AN356C	N357C	5N357C	5AN357C	
18x60	457x1524	N366C	AN366C	N367C	5N367C	5AN367C	
18x72	457x1829	N376C	AN376C	N377C	5N377C	5AN377C	
21x24	530x610	N416C	AN416C	-	5N417C	5AN417C	
21x30	530x760	N426C	AN426C	-	5N427C	5AN427C	
21x36	530x914	N436C	AN436C	-	5N437C	5AN437C	
21x42	530x1060	N446C	AN446C	-	5N447C	5AN447C	
21x48	530x1219	N456C	AN456C	-	5N457C	5AN457C	
21x60	530x1524	N466C	AN466C	-	5N467C	5AN467C	
21x72	530x1829	N476C	AN476C	-	5N477C	5AN477C	
24x24	610x610	N516C	AN516C	-	5N517C	5AN517C	
24x30	610x760	N526C	AN526C	-	5N527C	5AN527C	
24x36	610x914	N536C	AN536C	N537C	5N537C	5AN537C	
24x42	610x1060	N546C	AN546C	N547C	5N547C	5AN547C	
24x48	610x1219	N556C	AN556C	N557C	5N557C	5AN557C	
24x60	610x1524	N566C	AN566C	N567C	5N567C	5AN567C	
24x72	610x1829	N576C	AN576C	N577C	5N577C	5AN577C	

Actual Dimensions: Width: Add .12" (3.2mm) to nominal size. Length: Subtract .12" (3.2mm) from nominal size.

Brite Finish

4-Shelf
Brite Unit with
63" Posts

5-Shelf
Brite Unit with
74" Posts

Cat. No. Starter Unit	Cat. No. Add-On Unit	Cat. No. Starter Unit	Cat. No. Add-On Unit
N316BR	AN316BR	5N317BR	5AN317BR
N326BR	AN326BR	5N327BR	5AN327BR
N336BR	AN336BR	5N337BR	5AN337BR
N346BR	AN346BR	5N347BR	5AN347BR
N356BR	AN356BR	5N357BR	5AN357BR
N366BR	AN366BR	5N367BR	5AN367BR
N376BR	AN376BR	5N377BR	5AN377BR
N416BR	AN416BR	5N417BR	5AN417BR
N426BR	AN426BR	5N427BR	5AN427BR
N436BR	AN436BR	5N437BR	5AN437BR
N446BR	AN446BR	5N447BR	5AN447BR
N456BR	AN456BR	5N457BR	5AN457BR
N466BR	AN466BR	5N467BR	5AN467BR
N476BR	AN476BR	5N477BR	5AN477BR
N516BR	AN516BR	5N517BR	5AN517BR
N526BR	AN526BR	5N527BR	5AN527BR
N536BR	AN536BR	5N537BR	5AN537BR
N546BR	AN546BR	5N547BR	5AN547BR
N556BR	AN556BR	5N557BR	5AN557BR
N566BR	AN566BR	5N567BR	5AN567BR
N576BR	AN576BR	5N577BR	5AN577BR

For additional wire shelves, order from page 48.



Replacement "S" Hook

2 are required for each storage level.
Cat. No. 9995Z



Security "S" Hook

2 are required for each storage level. Bag of 2.
Chrome. Cat. No. H9995C
Black. Cat. No. H9995B

Identification:

Metro Super Erecta Wire Shelving System. Refer to architectural drawings for appropriate sizing, configuration and locations. Owner provided.
Manufacturer: Metro or approved equal

SUPER ERECTA® STEM CASTERS



Casters for Dry Areas



**CASTER
INSTALLATION**



GOOD

Plated Stem Casters — {11.20}

Plated caster horns and hardware for basic dry environments.



5LD



5MB



5MDBA



5MPB



5MPR

Wheel Diameter (in.) (mm)	Face (in.) (mm)	Load Rating (lbs.) (kg)	Type	Wheel Tread	Temperature Range (Continuous Usage) (Fahrenheit) (Celsius)	Cat. No.
4	102	.5 12	125 56	Stem/Swivel Resilient Donut	-20°-160° -29°-71°	4LD
5	127	.5 12	125 56	Stem/Swivel Resilient Donut	-20°-160° -29°-71°	5LD
5	127	1.25 32	200 90	Stem/Swivel Resilient, Flat	-20°-160° -29°-71°	5M
5	127	1.25 32	200 90	Stem/Brake Resilient, Flat	-20°-160° -29°-71°	5MB
5	127	1.25 32	200 90	Stem/Rigid Resilient, Flat	-20°-160° -29°-71°	5MR
5	127	1.25 32	250 113	Stem/Swivel High Modulus Donut	-20°-180° -29°-82°	5MDA
5	127	1.25 32	250 113	Stem/Brake High Modulus Donut	-20°-180° -29°-82°	5MDBA
5	127	1.25 32	250 113	Stem/Rigid High Modulus Donut	-20°-180° -29°-82°	5MDRA
5	127	1.25 32	300 135	Stem/Swivel Polyurethane, Flat	-20°-180° -29°-82°	5MP
5	127	1.25 32	300 135	Stem/Brake Polyurethane, Flat	-20°-180° -29°-82°	5MPB
5	127	1.25 32	300 135	Stem/Rigid Polyurethane, Flat	-20°-180° -29°-82°	5MPR
6	152	1.5 38	400 182	Stem/Swivel Polyurethane, Flat	-20°-180° -29°-82°	6MP
6	152	1.5 38	400 182	Stem/Brake Polyurethane, Flat	-20°-180° -29°-82°	6MPB
6	152	1.5 38	400 182	Stem/Rigid Polyurethane, Flat	-20°-180° -29°-82°	6MPR

Note: Rigid casters are held in place by a connecting channel. When ordering, shelf width must be provided. Rigid connecting channel (stainless steel): Cat. No. 14RS, 18RS, 21RS, 24RS, 30RS, or 36RS. Load Height for all 5M and 5MP casters — 6.09" ± .06" (155 ± 1.5mm). Load Height for 4LD caster — 4.62" ± .06" (118 ± 1.5mm). Load Height for 5LD caster — 5.06" ± .06" (143 ± 1.5mm). Brakes are foot-operated.

Plated Stem Casters

Use with Super Erecta posts and shelves (see pages 42 and 48) to create a mobile shelving unit to meet your special needs. Stem casters are shipped with donut bumper at no additional charge.



Donut Bumper

Donut Bumpers — {11.40}

- Non-phthalate, flexible vinyl material

Diameter (in.) (mm)	Height (lbs.) (kg)	Cat. No.	Each
3.5 89	.75 19	9992DB*	9.40
5.5 140	.81 21	9992N	14.60

*Included with each Super Erecta stem caster as noted on previous page.

Low Profile 3" Casters — {11.20}

Ideal for creating shorter height mobile units for undercounter use. Threaded stem fits stationary posts with threaded base. (Remove leveling foot and install caster)

Wheel Diameter (in.) (mm)	Face (in.) (mm)	Load Rating (lbs.) (kg)	Type	Wheel Thread	Temperature Range (Continuous Usage) (Fahrenheit) (Celsius)	Cat. No.
3	76	.94 24	100 45	Threaded Stem, Swivel	Resilient Rubber -30° - 160° -34° - 71°	3TM
3	76	.94 24	100 45	Threaded Stem, Swivel/Brake	Resilient Rubber -30° - 160° -34° - 71°	3TMB

Note 1: Not intended for carts that travel long distances.



3TM



3TMB

Decorative Casters — {10.06}

- Black nylon housing with non-marking polymer tread.
- 2.5" (63mm) models have threaded stem and attach to stationary shelving posts.
- 4" (100mm) casters include threaded insert for use with mobile posts.

Type	Diameter (in.) (mm)	Fits Post Type	Cat. No.
Swivel/Brake	2.5 63	Stationary	HDC3BB
Swivel	4 100	Mobile	HDC5B
Swivel/Brake	4 100	Mobile	HDC5BB

Castors shipped with post inserts for adaptability to mobile posts.



HDC5B

HDC5BB

Wheel Material? What's the difference?

Wheel Material	Oil & Grease Resistance	Rollability	Noise
Resilient Rubber	LOW	FAIR	LOW
Neoprene	HIGH	GOOD	LOW
Polyurethane	HIGH	GOOD	MODERATE
High-Modulus Rubber	HIGH	GOOD	LOW
Conductive	LOW	FAIR	LOW

Identification:

Metro Super Erecta Wire Shelving System. Refer to architectural drawings for appropriate sizing, configuration and locations. Owner provided.
Manufacturer: Metro or approved equal



SUPER ERECTA® STEM CASTERS

Casters for Wet or Corrosive Areas



GOOD

Polymer Stem Casters — {11.20}

Basic rust resistant - nylon and Polyurethane wheel tread.

- Harder tread for maneuvering of heavier loads.



5PC



5PCB

Wheel Diameter	Face	Load Rating	Type	Wheel Tread	Temperature Range (Continuous Usage)	Cat. No.	Cat. No. Antimicrobial
(in.) (mm)	(in.) (mm)	(lbs.) (kg)			(Fahrenheit) (Celsius)		
5 127	1.25 32	300 135	Stem/Swivel	Polyurethane, Flat	-20°-120° -29°-49°	5PC	5PCM
5 127	1.25 32	300 135	Stem/Brake	Polyurethane, Flat	-20°-120° -29°-49°	5PCB	5PCBM
5 127	1.25 32	300 135	Stem/Rigid	Polyurethane, Flat	-20°-120° -29°-49°	5PCR	

Note 1: Rigid casters are held in place by a connecting channel. When ordering, shelf width must be provided. Rigid connecting channel (aluminum) for 5PCR casters: Cat. No. P14RC, P18RC, P21RC, P24RC, P30RC, or P36RC. **Not suitable for cart wash and autoclave applications.**



BETTER

Polymer & Stainless Total-Guard Casters — {52.20}

Advanced rust & moisture protection - nylon rig, Stainless stem, TPE wheel tread.

Break caster has total lock function. When the brake is engaged, the caster wheel and swivel are locked.

- Best for high humidity chambers, MRI areas, RFID storage
- Very good chemical resistance
- Good for cart wash chambers
- Quieter than polyurethane options



5PSTE



5PSTEB

Wheel Diameter	Face	Load Rating	Type	Wheel Tread	Temperature range (continuous)	Cat. No.
(in.) (mm)	(in.) (mm)	(lbs.) (kg)			(Fahrenheit) (Celsius)	Model No.
5 127	1.25 32	250 113	Stem/Swivel	TPE, Flat	-20° - 120° -29° - 49°	5PSTEX
5 127	1.25 32	250 113	Stem/Brake	TPE, Flat	-20° - 120° -29° - 49°	5PSTEBX



BEST

Stainless Steel Cart-Washable Stem Casters — {11.20}

Type 304 Stainless rigs for intense cleaning and sterilization protocols.

- Best chemical resistance
- Best for high temperature cart wash chambers.
- Best for high impact mobile uses.



5MPGSA



5MPBGSA



5MHTN



5MHTNB

Wheel Diameter	Face	Load Rating	Type	Wheel Tread	Temperature Range (Continuous Usage)	Cat. No.
(in.) (mm)	(in.) (mm)	(lbs.) (kg)			(Fahrenheit) (Celsius)	
5 127	1.25 32	250 113	Stem/Swivel	High Modulus Donut	-20°-180° -29°-82°	5MDGSA
5 127	1.25 32	250 113	Stem/Brake	High Modulus Donut	-20°-180° -29°-82°	5MDBGSA
5 127	1.25 32	250 113	Stem/Rigid	High Modulus Donut	-20°-180° -29°-82°	5MDRGSA
5 127	1.25 32	300 135	Stem/Swivel	Polyurethane, Flat	-20°-180° -29°-82°	5MPGSA
5 127	1.25 32	300 135	Stem/Brake	Polyurethane, Flat	-20°-180° -29°-82°	5MPBGSA
5 127	1.25 32	300 135	Stem/Rigid	Polyurethane, Flat	-20°-180° -29°-82°	5MPRGSA

Note: Rigid casters are held in place by a connecting channel. When ordering, shelf width must be provided. Rigid connecting channel (stainless steel): Cat. No. 14RS, 18RS, 21RS, 24RS, 30RS, or 36RS. Load Height for all 5MD and 5MP casters — 6.09" ± .06" (155 ± 1.5mm). All casters are grease sealed with zerkl fittings in swivel and axle. Brakes are foot-operated.

High-temperature Autoclave Stem Casters

Wheel Diameter	Face	Load Rating	Type	Wheel Tread	Temperature Range (Continuous Usage)	Cat. No.
(in.) (mm)	(in.) (mm)	(lbs.) (kg)			(Fahrenheit) (Celsius)	
5 127	1.5 38	300 135	Stem/Swivel	Nylon, Flat	-20°-475° -29°-250°	5MHTN
5 127	1.5 38	300 135	Stem/Brake	Nylon, Flat	-20°-475° -29°-250°	5MHTNB

Swaged Posts — For cart wash and autoclave applications

Type 304 stainless post with aluminum cap swaged into the the post. Use with stem casters.

Description	Dimensions (in.)	Dimensions (mm)	Cat. No.
Stem Caster Post	33	875	33UPS-SW
Stem Caster Post	54	1370	54UPS-SW
Stem Caster Post	63	1600	63UPS-SW



Swaged Post

Identification:

Metro Super Erecta Wire Shelving System. Refer to architectural drawings for appropriate sizing, configuration and locations. Owner provided.
Manufacturer: Metro or approved equal

MOBILE VITALS UNIT

BY OWNER
(N.I.C)

Identification:

Mobile Vitals Unit. Not in contract, Owner provided.

M11j

1 of 1

SOILED LINEN HAMPER

BY OWNER
(N.I.C)

Identification:

Soiled Linen Hamper. Not in contract, Owner provided.

M12d

1 of 1

38 Indoor Utility Containers

UTILITY REFUSE

Profile Containers

Attractive design suits many decors.

- Wall mounting keeps the container out of pedestrian traffic and allows for floor cleaning
- Spring-loaded swing door helps control odor and hides trash from public view
- Comes with complete hardware and instructions for wall mounting
- Factory Mutual (FM) approved for fire safety when wall mounted; ideal for hallways and other uncontrolled public areas
- Slim design limits intrusion into corridors, washrooms, kitchens, and other limited space areas



NO.	COLOR	DESCRIPTION	U.S. DIMENSIONS	U.S. CAPACITY	U.S. SHIP WT/CTN	METRIC DIMENSIONS	METRIC CAPACITY	METRIC SHIP WT/CTN	PACK
FG782200	BEIG	Slim Jim® Wall-Mounted Container	19.5" l x 11.9" w x 32.6" h	15.0 gal	11.6 lb	49.5 cm x 30.2 cm x 82.9 cm	56.8 L	5.3 kg	1

Fire-Resistant Wastebaskets

Great for use in areas requiring increased levels of fire protection, such as hospitals, schools, and hotels.

- UL® Classification ensures fire safety
- Textured finish for enhanced aesthetics



CSFM



FG254100

FG254300

NO.	COLOR	DESCRIPTION	U.S. DIMENSIONS	U.S. CAPACITY	U.S. SHIP WT/CTN	METRIC DIMENSIONS	METRIC CAPACITY	METRIC SHIP WT/CTN	PACK
FG254100	BLA, BEIG	Fire-Resistant Wastebasket	11.1" l x 8.3" w x 12.3" h	14.0 qt	19.6 lb	28.3 cm x 21.0 cm x 31.1 cm	13.2 L	8.9 kg	6
FG254300	GRAY, BLA, BEIG	Fire-Resistant Wastebasket	14.5" l x 10.5" w x 15.3" h	28.0 qt	30.4 lb	36.8 cm x 26.7 cm x 38.9 cm	26.5 L	13.8 kg	6
FG254400	BEIG	Fire-Resistant Wastebasket	15.0" l x 11.3" w x 20.0" h	40.0 qt	29.6 lb	38.1 cm x 28.6 cm x 50.8 cm	37.9 L	13.4 kg	4

For Other Fire-Rated Containers See:



Profile
Wall-Mounted



Step-On
Containers



Steel Containers



Plaza®
Containers



Ranger®
Containers



Smoking Management
Containers

When ordering products with **BOLD** color codes, please specify color code after the product number. Refer to the Standard Color Guide at the back of the catalog.

Identification:

28 qt. Fire-Resistant Wastebasket, #FG254300. Owner provided.
Manufacturer: Rubbermaid Commercial or approved equal.

M13b
1 of 1

34 Indoor Utility Containers

UTILITY REFUSE

Legacy Step-On Containers

The Rubbermaid Commercial Legacy Step-On Container provides sanitary waste management.

- Slow-close, integrated lid damper keeps odors and bacteria from escaping
- Puncture-resistant, all-plastic construction
- Ideal for medical waste containment



FG614500BEIG



FG614500RED



FG614500WHT



2089824

NO.	COLOR	DESCRIPTION	U.S. DIMENSIONS	U.S. CAPACITY	U.S. SHIP WT/CTN	METRIC DIMENSIONS	METRIC CAPACITY	METRIC SHIP WT/CTN	PACK.
FG614300	BEIGE, RED, WHITE	8G Legacy Step-On	15.8" l x 16.3" w x 17.1" h	8.0 gal	6.8 lb	40.1 cm x 41.4 cm x 43.4 cm	30.0 L	3.1 kg	1
2089825	BLACK	8G Legacy Step-On	15.8" l x 16.3" w x 17.1" h	8.0 gal	6.8 lb	40.1 cm x 41.4 cm x 43.4 cm	30.0 L	3.1 kg	1
FG614400	BEIGE, RED, WHITE	12G Legacy Step-On	15.0" l x 16.3" w x 23.6" h	12.0 gal	9.0 lb	38.1 cm x 41.4 cm x 59.9 cm	45.0 L	4.1 kg	1
2089820	BLACK	12G Legacy Step-On	15.0" l x 16.3" w x 23.6" h	12.0 gal	9.0 lb	38.1 cm x 41.4 cm x 59.9 cm	45.0 L	4.1 kg	1
FG614500	BEIGE, RED, WHITE	18G Legacy Step-On	14.8" l x 19.8" w x 26.5" h	18.0 gal	12.4 lb	37.6 cm x 50.3 cm x 67.3 cm	68.0 L	5.6 kg	1
2089824	BLACK	18G Legacy Step-On	14.8" l x 19.8" w x 26.5" h	18.0 gal	12.4 lb	37.6 cm x 50.3 cm x 67.3 cm	68.0 L	5.6 kg	1
FG614600	BEIGE, RED, WHITE	23G Legacy Mobile Step-On	16.5" l x 19.8" w x 32.6" h	23.0 gal	16.2 lb	41.9 cm x 50.3 cm x 82.8 cm	87.0 L	7.3 kg	1
2089821	BLACK	23G Legacy Step-On	16.5" l x 19.8" w x 32.6" h	23.0 gal	16.2 lb	41.9 cm x 50.3 cm x 82.8 cm	87.0 L	7.3 kg	1

When ordering products with **BOLD** color codes, please specify color code after the product number. Refer to the Standard Color Guide at the back of the catalog.

Identification:

Rubbermaid Step-On Waste Container, 12 gal. - White. Owner provided.
Manufacturer: Rubbermaid Commercial or approved equal.

M13c
1 of 1

34 Indoor Utility Containers

UTILITY REFUSE

Legacy Step-On Containers

The Rubbermaid Commercial Legacy Step-On Container provides sanitary waste management.

- Slow-close, integrated lid damper keeps odors and bacteria from escaping
- Puncture-resistant, all-plastic construction
- Ideal for medical waste containment



FG614500BEIG



FG614500RED



FG614500WHT



2089824

NO.	COLOR	DESCRIPTION	U.S. DIMENSIONS	U.S. CAPACITY	U.S. SHIP WT/CTN	METRIC DIMENSIONS	METRIC CAPACITY	METRIC SHIP WT/CTN	PACK.
FG614300	BEIGE, RED, WHITE	8G Legacy Step-On	15.8" l x 16.3" w x 17.1" h	8.0 gal	6.8 lb	40.1 cm x 41.4 cm x 43.4 cm	30.0 L	3.1 kg	1
2089825	BLACK	8G Legacy Step-On	15.8" l x 16.3" w x 17.1" h	8.0 gal	6.8 lb	40.1 cm x 41.4 cm x 43.4 cm	30.0 L	3.1 kg	1
FG614400	BEIGE, RED, WHITE	12G Legacy Step-On	15.0" l x 16.3" w x 23.6" h	12.0 gal	9.0 lb	38.1 cm x 41.4 cm x 59.9 cm	45.0 L	4.1 kg	1
2089820	BLACK	12G Legacy Step-On	15.0" l x 16.3" w x 23.6" h	12.0 gal	9.0 lb	38.1 cm x 41.4 cm x 59.9 cm	45.0 L	4.1 kg	1
FG614500	BEIGE, RED, WHITE	18G Legacy Step-On	14.8" l x 19.8" w x 26.5" h	18.0 gal	12.4 lb	37.6 cm x 50.3 cm x 67.3 cm	68.0 L	5.6 kg	1
2089824	BLACK	18G Legacy Step-On	14.8" l x 19.8" w x 26.5" h	18.0 gal	12.4 lb	37.6 cm x 50.3 cm x 67.3 cm	68.0 L	5.6 kg	1
FG614600	BEIGE, RED, WHITE	23G Legacy Mobile Step-On	16.5" l x 19.8" w x 32.6" h	23.0 gal	16.2 lb	41.9 cm x 50.3 cm x 82.8 cm	87.0 L	7.3 kg	1
2089821	BLACK	23G Legacy Step-On	16.5" l x 19.8" w x 32.6" h	23.0 gal	16.2 lb	41.9 cm x 50.3 cm x 82.8 cm	87.0 L	7.3 kg	1

When ordering products with **BOLD** color codes, please specify color code after the product number. Refer to the Standard Color Guide at the back of the catalog.

Identification:

Rubbermaid Step-On Waste Container, 12 gal. - Red. Owner provided.
Manufacturer: Rubbermaid Commercial or approved equal.

M13d
1 of 1

WHEELCHAIR

BY OWNER
(N.I.C.)

Identification:

Wheelchair. Not in contract, Owner provided.

M16a

1 of 1

EXAMINATION ROOM STOOL

BY OWNER
(N.I.C.)

Identification:

Examination Room Stool. Not in contract, Owner provided.

M28b

1 of 1

Weigh Beam Eye-Level Physician Scales

DETECTO's innovatively-designed, analog physician scales feature dual-readings on either side of the weigh beam making weighing simple and fast. Pounds, kilograms, or pounds/kilograms are all available on the aluminum easy-to-read beam. The dual-reading height rod measures in inches

or centimeters at a glance, and the platform cover can be easily removed for cleaning. The scale's capacity may be increased by using an optional counterweight. The scales are 59 inches (150 cm) high. Models are available with height rod, wheels and handpost. Stainless steel models are also available.

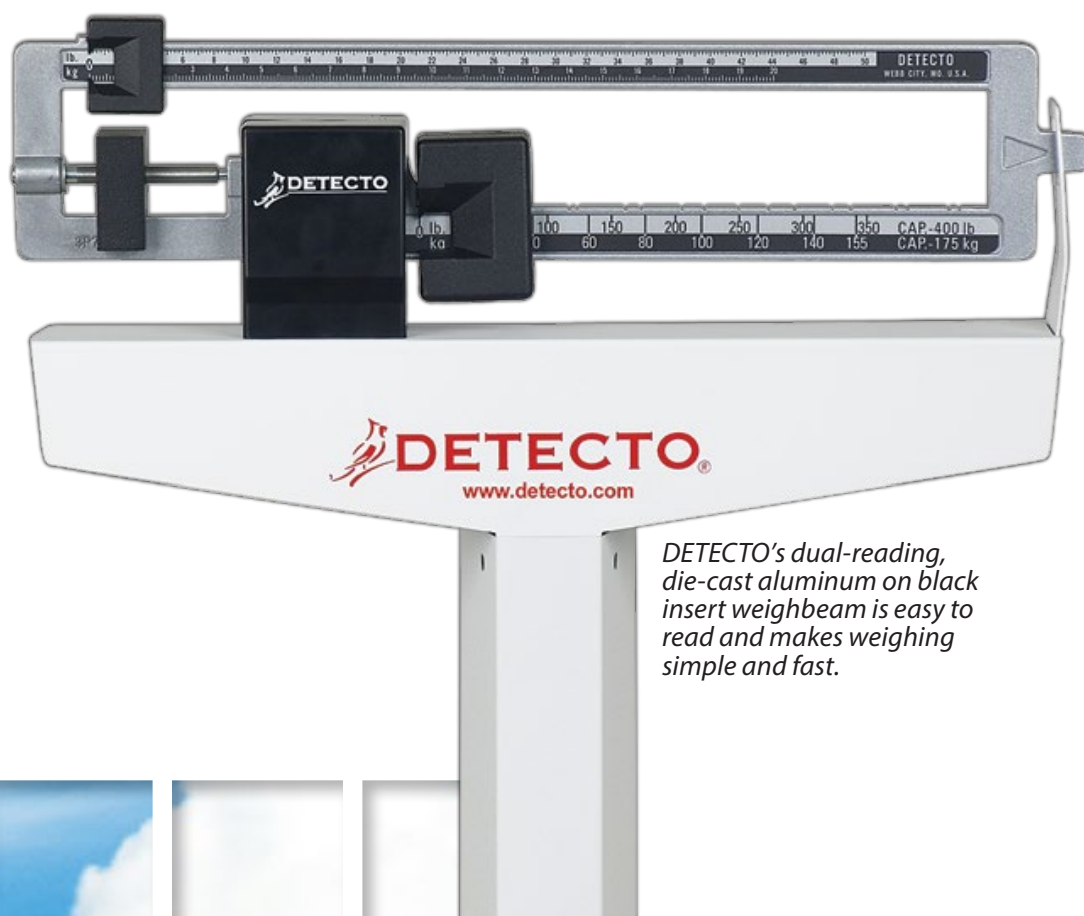

DETECTO's dual-reading, die-cast aluminum on black insert weighbeam is easy to read and makes weighing simple and fast.

Identification:

Detecto Weigh Beam Eye-Level Physician Scale. Owner provided.
Manufacturer: Detecto or approved equal.

M34g
1 of 2



THE WORLD STANDARD IN CLINICAL WEIGHING SINCE 1900

- 400 lb x 4 oz/180 kg x 100 g, or 400 lb x 4 oz/175 kg x 100 g capacities
- 10.5 inch x 14.5 inch (27 x 37 cm) platform
- Mild steel with electrostatic powder paint finish
- Heavy-duty, sturdy, stable base

 **DETECTO**
www.Detecto.com **4**

Identification:

Detecto Weigh Beam Eye-Level Physician Scale. Owner provided.
Manufacturer: Detecto or approved equal.

M34g
2 of 2

EQUIPMENT MANUAL

Plumbing Equipment

Identification:

Equipment description and/or comment.

P items



LUCERNE™ WALL-HUNG LAVATORY

- Wall-hung sink
- Vitreous china
- Front overflow
- D-shaped bowl
- Self-draining deck area with contoured back and side splash shields
- Faucet ledge
- Compliant with Texas accessibility standard (TAS) for children age group 13 and up

Faucet holes on 203mm (8") centers (illus.):

- ☐ **0356.028** For exposed bracket support
Shown with 4801.862 Amarilis Heritage faucet with Triune Cross handles (not included)
- ☐ **0356.015** For wall hanger (included) or concealed arms support
- ☐ **0356.915** For wall hanger (included) or concealed arms support
 - Less overflow

Faucet holes on 102mm (4") centers:

- ☐ **0355.027** For exposed bracket support
- ☐ **0355.012** For wall hanger (included) or concealed arms support
- ☐ **0355.912** For wall hanger (included) or concealed arms support
 - Less overflow

Single center faucet hole (illus.):

- ☐ **0356.041** For exposed bracket support
Shown with 1340.000 metering faucet (not included)
- ☐ **0356.421** For wall hanger (included) or concealed arms support
- ☐ **0356.921** For wall hanger (included) or concealed arms support
 - Less overflow
- ☐ **0356.439** For wall hanger (included) or concealed arms support
 - Single faucet hole on right
- ☐ **0356.066** For exposed bracket support
 - Single faucet hole on right

Nominal Dimensions:

521 x 464mm
(20-1/2" x 18-1/4")

Bowl sizes:

381mm (15") wide
254mm (10") front to back
165mm (6-1/2") deep

Compliance Certifications -

Meets or Exceeds the Following Specifications:

- ASME A112.19.2 / CSA B45.1 for Vitreous China Fixtures

LUCERNE™ WALL-HUNG LAVATORY VITREOUS CHINA



0356.028



0356.041

SEE FOLLOWING PAGES FOR ROUGHING-IN DIMENSIONS

To Be Specified:

- ☐ Color: ☐ White
- ☐ Faucet*:
- ☐ Faucet Finish:
- ☐ Supplies:
- ☐ 1-1/4" Trap:
- ☐ Nipple:
- ☐ Bracket Support (by others):
- ☐ Concealed Arms Support (by others):

* See faucet section for additional models available



MEETS THE AMERICANS WITH DISABILITIES ACT GUIDE-
LINES AND ANSI A117.1 ACCESSIBLE AND USABLE
BUILDINGS AND FACILITIES - CHECK LOCAL CODES.
Top of front rim mounted 864mm (34") from finished floor.

M31

© 2014 AS America Inc.

Revised 3/14

Identification:

American Standard Lucerne wall-hung lavatory. Refer to plumbing drawings for location. Refer to Architectural drawings for mounting heights. Installation to conform with ADA requirements.

P09c
1 of 3

*American
Standard*

 **BARRIER FREE**

- 0356.028** 8" CTRS FOR EXPOSED BRACKET SUPPORT
0356.015 8" CTRS FOR WALL HANGER OR CONCEALED ARMS
0356.915 LESS OVERFLOW

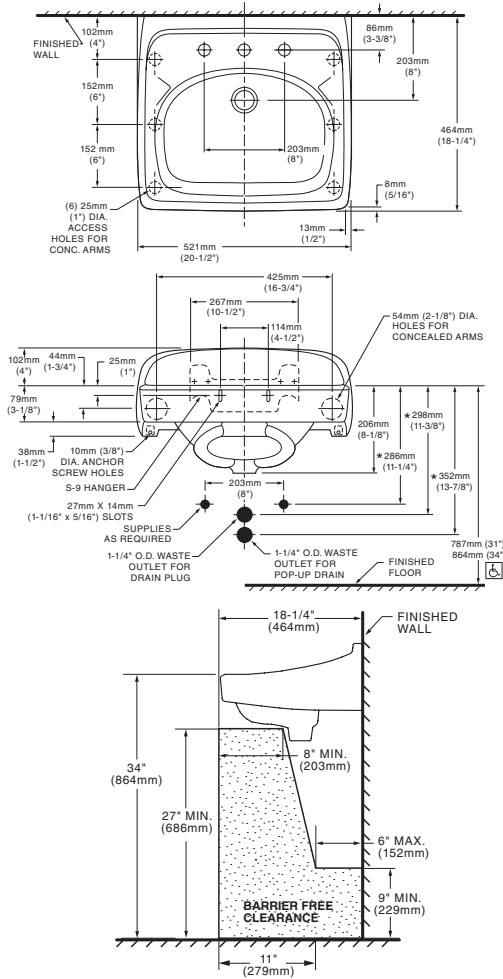

NOTES:

* DIMENSIONS SHOWN FOR LOCATION OF SUPPLIES AND "P" TRAP ARE SUGGESTED.
PROVIDE SUITABLE REINFORCEMENT FOR ALL WALL SUPPORTS.
FITTINGS NOT INCLUDED AND MUST BE ORDERED SEPARATELY.
CONCEALED ARM SUPPORT AS REQUIRED TO BE FURNISHED BY OTHERS.

IMPORTANT: Dimensions of fixtures are nominal and may vary within the range of tolerances established by ANSI Standard A112.19.2. These measurements are subject to change or cancellation. No responsibility is assumed for use of superseded or voided pages.



LAVATORY DESIGNED TO MEET ADA HANDICAPPED GUIDELINES WITH MOUNTING HEIGHT SET AT 864MM (34") ABOVE FINISHED FLOOR.

**LUCERNE™
WALL-HUNG LAVATORY
VITREOUS CHINA**

- 0355.021** 4" CTRS FOR EXPOSED BRACKET SUPPORT
0355.012 4" CTRS FOR WALL HANGER OR CONCEALED ARMS
0355.912 LESS OVERFLOW

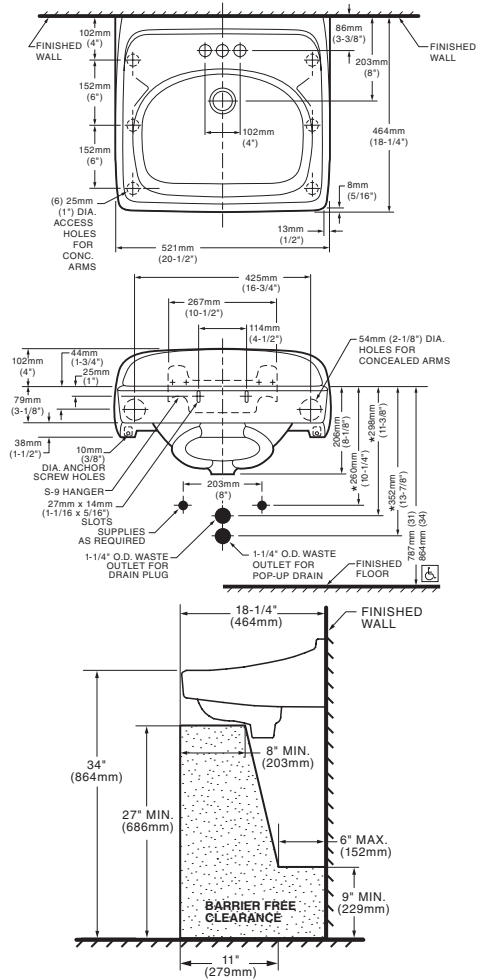

Identification:

American Standard Lucerne wall-hung lavatory. Refer to plumbing drawings for location. Refer to Architectural drawings for mounting heights. Installation to conform with ADA requirements.

*American
Standard*

 **BARRIER FREE**

- 0356.041** SINGLE CENTER HOLE FOR EXPOSED
BRACKET SUPPORT
0356.421 SINGLE CENTER HOLE FOR WALL
HANGER OR CONCEALED ARMS
0356.921 LESS OVERFLOW

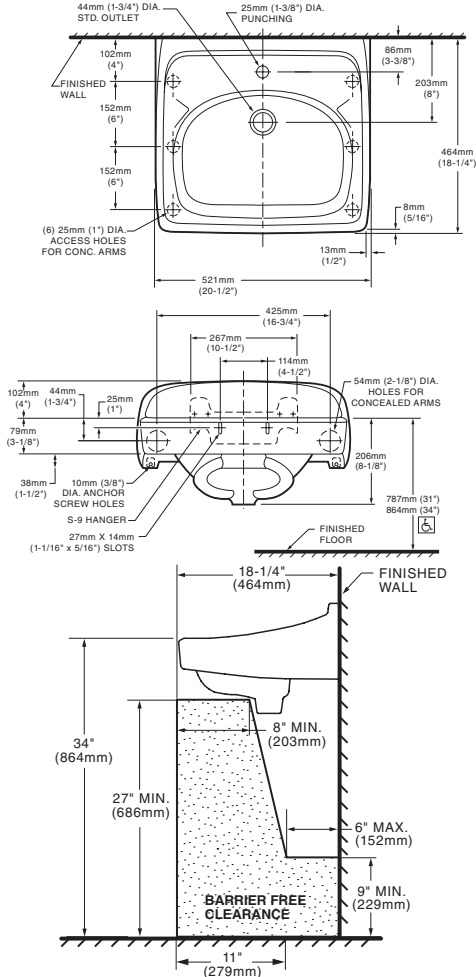

NOTES:

* DIMENSIONS SHOWN FOR LOCATION OF SUPPLIES AND "P" TRAP ARE SUGGESTED.
PROVIDE SUITABLE REINFORCEMENT FOR ALL WALL SUPPORTS.
FITTINGS NOT INCLUDED AND MUST BE ORDERED SEPARATELY.
CONCEALED ARM SUPPORT AS REQUIRED TO BE FURNISHED BY OTHERS.

IMPORTANT: Dimensions of fixtures are nominal and may vary within the range of tolerances established by ANSI Standard A112.19.2. These measurements are subject to change or cancellation. No responsibility is assumed for use of superseded or voided pages.

 **LAVATORY DESIGNED TO MEET ADA HANDICAPPED GUIDELINES WITH MOUNTING HEIGHT SET AT 864MM (34") ABOVE FINISHED FLOOR.**

**LUCERNE™
WALL-HUNG LAVATORY
VITREOUS CHINA**

- 0356.439** SINGLE CENTER HOLE ON RIGHT FOR WALL
HANGER OR CONCEALED ARMS
0356.066 SINGLE CENTER HOLE ON RIGHT FOR
EXPOSED BRACKET SUPPORT

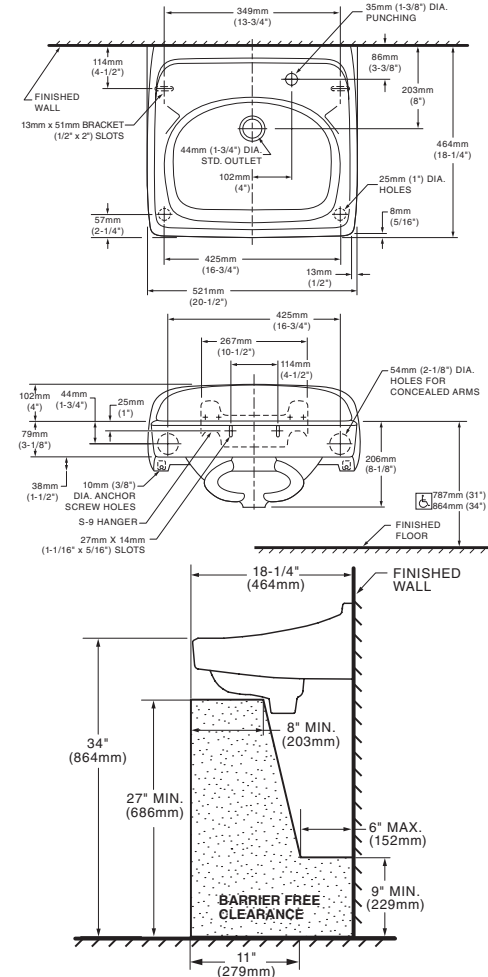

Identification:

American Standard Lucerne wall-hung lavatory. Refer to plumbing drawings for location. Refer to Architectural drawings for mounting heights. Installation to conform with ADA requirements.

P09c
3 of 3

ELKAY® SPECIFICATIONS

Elkay Lustertone Classic Stainless Steel 19" x 18" x 5-1/2" Single Bowl Drop-in ADA Sink Model(s) LRAD191855

PRODUCT SPECIFICATIONS

Elkay Lustertone™ Classic Stainless Steel 19" x 18" x 5-1/2", Single Bowl Drop-in ADA Sink. Sink is manufactured from 18 gauge 304 Stainless Steel with a Lustrous Satin finish, Rear Center drain placement, and Bottom only pads.

Installation Type:	Drop-in
Material:	304 Stainless Steel
Finish:	Lustrous Satin
Gauge:	18
Sound Deadening:	Bottom only pads
Number of Bowls:	1
Sink Dimensions:	19" x 18" x 5-1/2"
Bowl 1 Dimensions:	16" x 11-1/2" x 5-3/8"
Drain Size:	3-1/2" (89mm)
Drain Location:	Rear Center
Minimum Cabinet Size:	24"
Mounting Hardware:	Part # 64090012 included for countertops up to 3/4" (19mm) thick
Template Included:	No
Cutout Template #:	1000001260

Template is available for download at [elkay.com](#). CAD software will be required to open the template.

Cutout Dimensions for Drop-in Installation:

18-3/8" x 17-3/8" (467mm x 441mm) with 1-1/2" (38mm) corner radius

Custom Options	
<input type="checkbox"/> Type 316 Stainless Steel	
Drain Location	
<input type="checkbox"/> Right Rear	<input type="checkbox"/> Left Rear
<input type="checkbox"/> Center	<input type="checkbox"/> Center Rear
Overflow Location	
<input type="checkbox"/> Front	<input type="checkbox"/> Rear
Alternate Punching	
<input type="checkbox"/> Faucet Model:	<input type="checkbox"/> Punch Required:
Sink Size	
<input type="checkbox"/> Bowl Depth:	<input type="checkbox"/> Drainboard Width:



AMERICAN PRIDE. A LIFETIME TRADITION.
Like your family, the Elkay family has values and traditions that endure. For almost a century, Elkay has been a family-owned and operated company, providing thousands of jobs that support our families and communities.



Product Compliance: ADA & ICC A117.1
ASME A112.19.3/CSA B45.4
Buy American Act



Sinks are listed by IAPMO® as meeting the applicable requirements of the Uniform Plumbing Code®, International Plumbing Code®, and National Plumbing Code of Canada.



Complies with ADA & ICC A117.1 accessibility requirements when installed according to the requirements outlined in these standards.

[Clean and Care Manual \(PDF\)](#)
[Installation Instructions \(PDF\)](#)
[Warranty \(PDF\)](#)

Similar models are available with: 4" 4-1/2" 5" 6" and 6-1/2" depths, CuVerro antimicrobial copper, Quick-Clip Mounting System

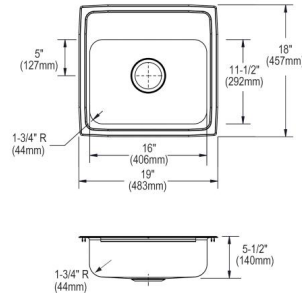

PART: _____ QTY: _____
PROJECT: _____
CONTACT: _____
DATE: _____
NOTES: _____
APPROVAL: _____

In keeping with our policy of continuing product improvement, Elkay reserves the right to change product specifications without notice. Please visit [elkay.com](#) for the most current version of Elkay product specification sheets. This specification describes an Elkay product with design, quality, and functional benefits to the user. When making a comparison of other producers' offerings, be certain these features are not overlooked.

Elkay REV 11192021
[LRAD191855](#)

1333 Butterfield Road, Suite 200
Downers Grove, IL 60515

© 2021 Page 1
LRAD191855_spec.pdf

Identification:

Elkay countertop mounted lavatory, model LRAD-1918. Basin to be ordered with 6" depth & off centered rear drain hold. Refer to plumbing drawings for location. Refer to Architectural drawings for mounting heights. Installation to conform with all ADA requirements. Order as required for faucet set specified.

P09j
1 of 2

ELKAY[®] SPECIFICATIONS

Elkay Lustertone Classic Stainless Steel 19" x 18" x 5-1/2"
Single Bowl Drop-in ADA Sink
Model(s) LRAD191855

Hole Drilling Configurations:

1-1/2" (38mm) Diameter Faucet Holes on 4" (102mm) Centers

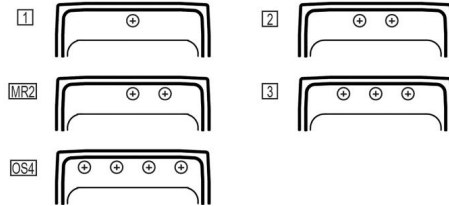

Installation Profile:

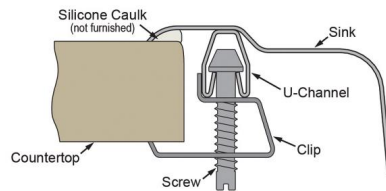

Optional Accessories

LK99	Elkay Deluxe 3-1/2" Drain Type 304 Stainless Steel Body Strainer Basket Rubber Seal and Tailpiece Spec Sheet (PDF)	
LKAD35	Elkay 3-1/2" Drain Fitting" Stainless Steel Body Strainer Basket and Offset Tailpiece Spec Sheet (PDF)	

In keeping with our policy of continuing product improvement, Elkay reserves the right to change product specifications without notice. Please visit elkay.com for the most current version of Elkay product specification sheets. This specification describes an Elkay product with design, quality, and functional benefits to the user. When making a comparison of other producers' offerings, be certain these features are not overlooked.

Elkay REV 11192021
[LRAD191855](#)

1333 Butterfield Road, Suite 200
Downers Grove, IL 60515

© 2021 Page 2
LRAD191855_spec.pdf

Identification:

Elkay countertop mounted lavatory, model LRAD-1918. Basin to be ordered with 6" depth & off centered rear drain hold. Refer to plumbing drawings for location. Refer to Architectural drawings for mounting heights. Installation to conform with all ADA requirements. Order as required for faucet set specified.

P09j
2 of 2

*American
Standard*

 **BARRIER FREE**

CHAMPION® 4 ELONGATED RIGHT HEIGHT® ONE-PIECE TOILET WITH SEAT VITREOUS CHINA

CHAMPION® 4 ELONGATED RIGHT HEIGHT® ONE-PIECE TOILET WITH SEAT

2034.314

- Vitreous china
- EverClean® surface inhibits the growth of stain- and odor-causing bacteria, mold, and mildew on the surface
- Low-consumption (6.0 Lpf/1.6 gpf)
- Features **Champion® 4 Flushing System** performance platform
- 4" non-adjustable, piston action Accelerator™ flush valve
- 16-1/2" rim height for accessible applications
- Elongated siphon action jetted bowl
- 2-3/8" fully-glazed trapway
- Chrome trip lever
- 2 bolt caps
- Slow close seat included
- 10 year warranty

Nominal Dimensions:

756 x 451 x 749mm
(29-3/4" x 17-3/4" x 29-1/2")

Fixture with seat, supply by others

Compliance Certifications -

Meets or Exceeds the Following Specifications:

- ASME A112.19.2M for Vitreous China Fixtures- includes Flush Performance, Ball Pass Diameter, Trap Seal Depth and all Dimensions

To Be Specified:

- ☐ Color:
 - ☐ White ☐ Bone ☐ Linen
- ☐ Trip Lever 738772-XXX0A:
 - ☐ 002 Chrome (supplied)
 - ☐ 020 White
 - ☐ 099 Polished Brass
 - ☐ 295 Satin
- ☐ Seat: (supplied)
 - ☐ Champion® Slow Close Elongated #5325.010
- ☐ Supply (by others):

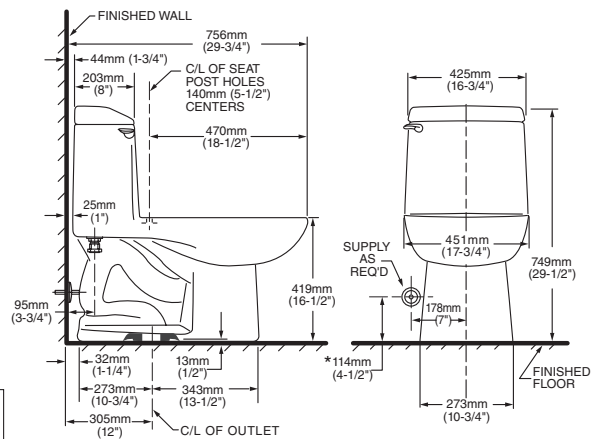

NOTES:

THIS TOILET IS DESIGNED TO ROUGH-IN AT A MINIMUM DIMENSION OF 305MM (12") FROM FINISHED WALL TO C/L OF OUTLET. SUPPLY NOT INCLUDED WITH FIXTURE AND MUST BE ORDERED SEPARATELY. * DIMENSION SHOWN FOR LOCATION OF SUPPLY IS SUGGESTED.

IMPORTANT: Dimensions of fixtures are nominal and may vary within the range of tolerances established by ANSI Standard A112.19.2. These measurements are subject to change or cancellation. No responsibility is assumed for use of superseded or voided pages.

 **MEETS THE AMERICANS WITH DISABILITIES ACT GUIDELINES AND ANSI A117.1 REQUIREMENTS FOR ACCESSIBLE AND USABLE BUILDING FACILITIES-CHECK LOCAL CODES.**

- When installed, top of seat meets minimum requirement of 432 to 483mm (17" to 19") from the finished floor.

CHAMPION® 4
Flushing System

© 2016 AS America Inc.

K1-11

spec_2034.314 Champ4 EL RH1pc-seat 2/16

Identification:

American Standard Toilet, Champion. Contractor provided and installed. Refer to architectural and plumbing drawings for location. Refer to plumbing drawings for fixture information. Installation to conform with all ADA guideline requirements. Manufacturer: American Standard or approved equal.

P12d
1 of 1



Model: **MS-1818** Item #: _____ Date: _____
Project: _____ Qty: _____ Approved By: _____

18" x 18" Floor Mop Sink

Plumbing



Description

- 18" x 18" x 13" Floor Mop Sink, 3-1/2" drain with 2" IPS Outlet

Standard Features

- 3-1/2" drain with 2" IPS outlet
- 18 gauge stainless steel
- Mounting hardware included
- Warranty: 1 years

Specifications

Overall Dimensions	▪ 18" x 18" x 13"
Bowl Dimensions	▪ 15" x 15" x 9"
Pipe Stub	▪ 9" from the wall
Drain	▪ 3-1/2" with 2" IPS Outlet
Material	▪ 18 gauge stainless steel
Weight	▪ 33 lbs

Product Compliance

- NSF-2
- Massachusetts Approved

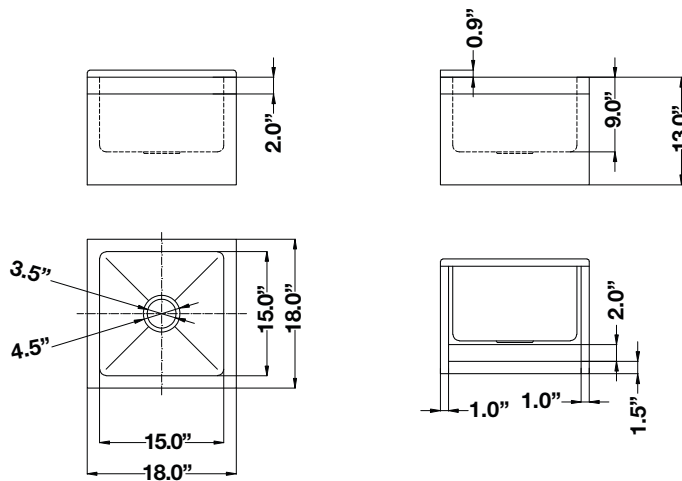

WARNING: Plumbing connections should be made by qualified personnel who will observe all applicable plumbing, sanitary and safety codes.
California Proposition 65 Warning

Krowne Metal Corporation • 100 Haul Rd. Wayne, NJ 07470 • P: (800) 631-0442 • customerservice@krowne.com • krowne.com
Due to our commitment to continued product improvement, specifications are subject to change without notice. Rev. 02/2021 • MS-1818

Identification:

Floor Mop Sink, Model #MS-1818. Contractor provided and installed. Refer to architectural and plumbing drawings for further information. Provide and install mop hanger and hose accessories. Manufacturer: Krowne or approved equal.

P15k
1 of 2



Model No. MS-1818 & MS-2424



Floor Mounted Mop Sink Installation Instructions

Detail

- 20 gauge 304 stainless steel construction
- Easy Installation

Includes

- Floor Mounted Mop Sink
- Mounting Bracket
- Drain Assembly

Instructions

1. Install Mounting Bracket to wall with mounting holes on the bottom with the bottom edge of the bracket at floor level as shown in the drawing to the right.
2. Install Drain Assembly to Mop Sink without installing the Rubber Gland, Compression Nut, or Strainer Plate yet
3. Fit Mop Sink over 2" IPS pipe stub while fitting rear strap onto Mounting Bracket. 2" IPS pipe stub must protrude 3" from floor and x" from the wall

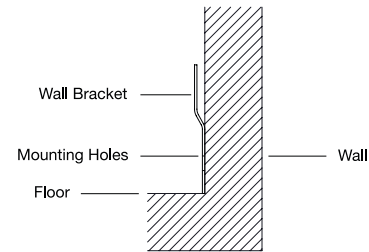

Model	x = Inch's from the Wall
MS-1818	9"
MS-2424	12"

4. Insert Rubber Gland over 2" IPS pipe stub (may use liquid soap for easier installation)
5. Thread Compression Nut over Rubber Gland into drain body. Use Drain Key and flat screw driver to tighten Compression Nut to tightly seal Rubber Gland and IPS pipe stub.
6. Remove Drain Key and install Strainer Plate to the top of the drain

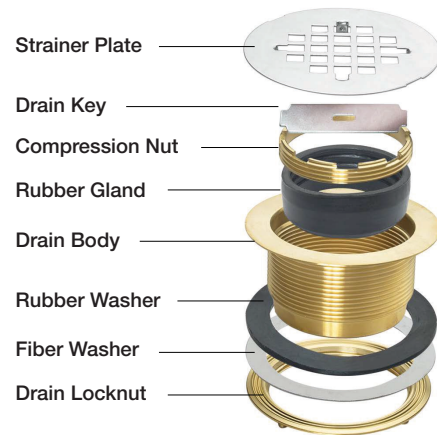

Krowne • 100 Haul Rd. • Wayne, NJ 07470 • krowne.com

Due to our commitment to continued product improvement, specifications are subject to change without notice.

Rev. 04/2021

Identification:

Floor Mop Sink, Model #MS-1818. Contractor provided and installed. Refer to architectural and plumbing drawings for further information. Provide and install mop hanger and hose accessories. Manufacturer: Krowne or approved equal.

P15k
2 of 2