







SEQUENCE OF CONSTRUCTION

- CONSTRUCTION SHALL BE SEQUENCED IN SUCH A MANNER THAT ANY AREA WHICH IS DISTURBED SHALL FIRST BE PROTECTED WITH SEDIMENT EROSION CONTROLS AS INDICATED ON THIS PLAN. PARTICULAR REQUIREMENTS ARE GIVEN AS FOLLOWS:
- DEMOLITION OF EXISTING BUILDINGS AS REQUIRED.
 - INSTALLATION OF SEDIMENT AND EROSION CONTROL MEASURES AS INDICATED ON THIS PLAN.
 - CLEAR UNDEVELOPED PORTION OF PROPERTY WHICH IS TO BE DEVELOPED.
 - STRIP AND STOCKPILE TOPSOIL.
 - BEGIN BUILDING AND PARKING LOT CONSTRUCTION, ROUGH GRADING.
 - INSTALL STORM DRAIN SYSTEM COMPLETE (IMMEDIATELY INSTALL HAYBALE FILTERS ON ALL INLETS).
 - INSTALL PUBLIC UTILITIES (GAS, ELECTRIC AND TELEPHONE) AS REQUIRED.
 - INSTALL CONCRETE AND ASPHALT CONCRETE PAVEMENT COMPLETE.
 - FINISH GRADING, REDISTRIBUTE TOPSOIL AND ESTABLISH VEGETATION AND/OR LANDSCAPING.
 - CLEAN PAVEMENTS AND STORM DRAIN SYSTEM OF ALL ACCUMULATED SEDIMENT IN CONJUNCTION WITH THE REMOVAL OF ALL TEMPORARY SEDIMENT AND EROSION CONTROL DEVICES.
 - COMPLETE SITE AND BUILDING CONSTRUCTION.

LEGEND

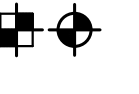
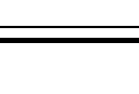
-  PROPOSED INLET PROTECTION
 PROPOSED SILT FENCE
 PROPOSED LIMIT OF DISTURBANCE
 PROPOSED STABILIZED CONSTRUCTION ACCESS
 PROPOSED STOCKPILE AREA
 PROPOSED TREE PROTECTION
 BORING AND TEST PIT LOCATIONS
 PROPOSED STONE CHECK DAM

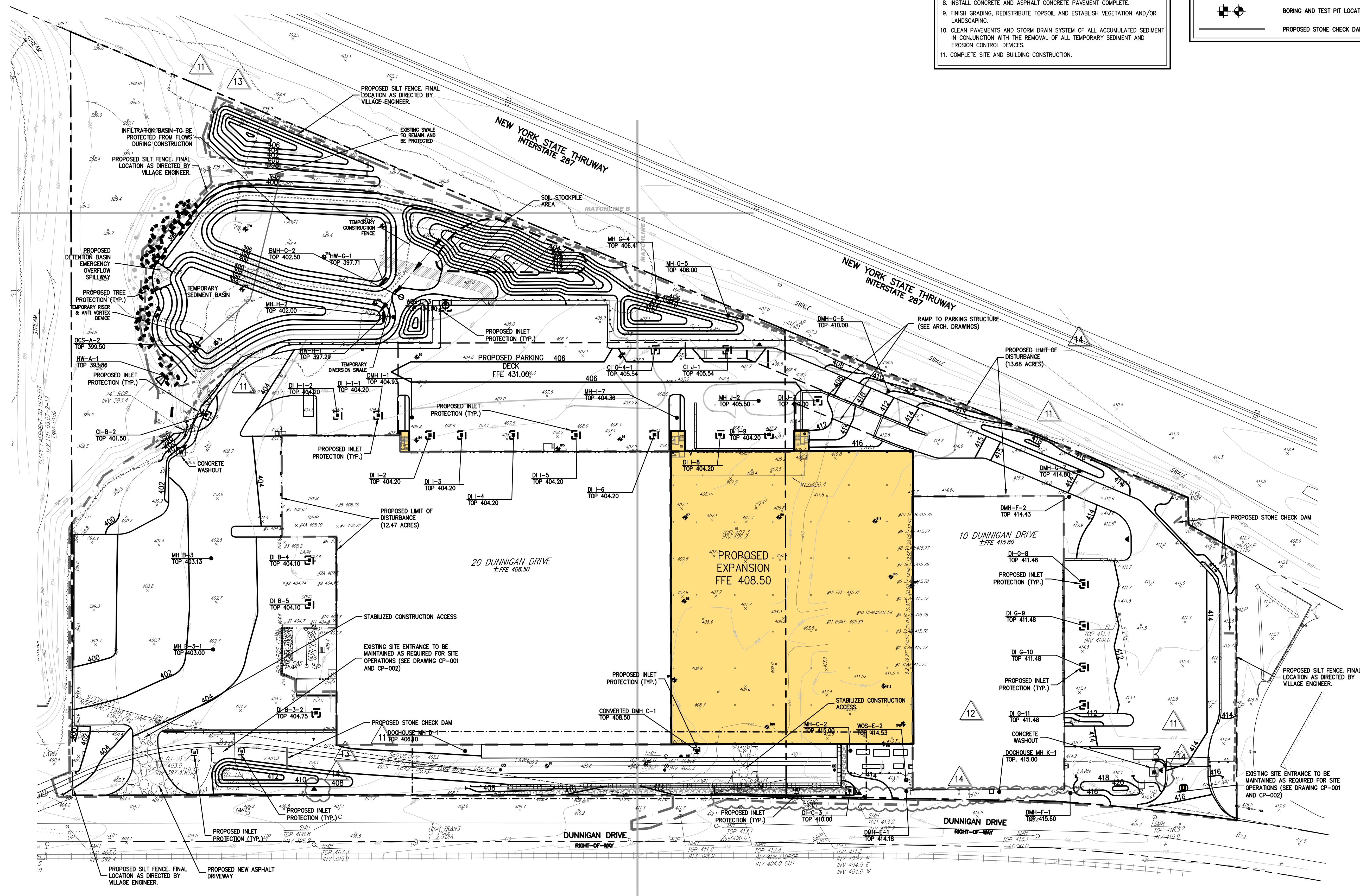

GRAPHIC SCALE

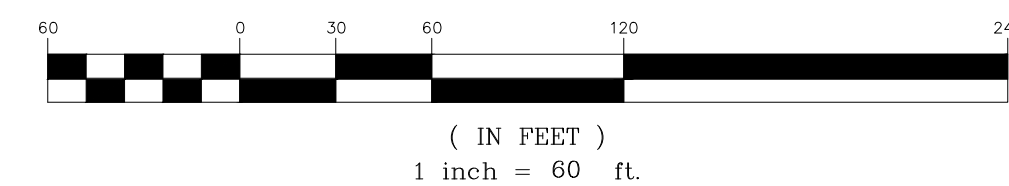

REFER TO DRAWINGS C-001 THROUGH C-006 FOR ALL CIVIL ENGINEERING/SITE DEVELOPMENT NOTES AND SPECIFICATIONS PERTAINING TO THIS PROJECT.

ANY ALTERATION OF PLANS, SPECIFICATIONS, PLATS AND REPORTS BEARING THE SEAL OF A LICENSED PROFESSIONAL ENGINEER OR LICENSED LAND SURVEYOR IS A VIOLATION OF SECTION 7209 OF THE NEW YORK STATE EDUCATION LAW, EXCEPT AS PROVIDED FOR BY SECTION 7209, SUBSECTION 2.

ARCHITECT

di Domenico + Partners LLP

diD
Architecture
Landscape Architecture
Planning

3743 Crescent Street, 3rd Floor
Long Island City, New York 11101
Tel 212-337-0400
Fax 212-337-3567

CIVIL PLANNING ENGINEER

JMC
JMC Planning Engineering Landscape
Architecture & Land Surveying, PLLC
120 Bedford Road
Armonk, New York 10504
Tel 914-273-5225
Fax 914-273-2102

MEP ENGINEER

Burns
BURNS ENGINEERING, PC.
1261 Broadway, Suite 708
New York, New York 10001
Tel 212-962-3503

STRUCTURAL ENGINEER

GEI
GEI50
1385 Broadway, 20th FL
New York, New York 10018
Tel 212-687-8282



MANHATTAN BEER DISTRIBUTORS
20 DUNNIGAN DRIVE
SUFFERN, NEW YORK

REV	DESCRIPTION	DATE
1	REISSUED PER PB COMMENTS	07.16.20
2	REISSUED PER PB COMMENTS	08.21.20
3	REISSUED PER PB COMMENTS	09.17.20
4	REISSUED PER PB COMMENTS	10.20.20
5	FOR PLANNING BOARD APPROVAL	04.09.21
6	REISSUED PER ENGINEER COMMENTS	05.10.21
7	REISSUED PER ENGINEER COMMENTS	05.17.21
8	ISSUED FOR DOB SUBMISSION	09.10.21
9	ISSUED FOR BID	10.15.21
10	REVISED BID/PERMIT SET	02.25.22
11	REVISED WATER & GRADING	06.28.22
12	REVISIONS TO NEW WATER SERVICE	07.25.22
13	REVISED GRADING	09.27.22
14	REVISED/ISSUED FOR CONSTRUCTION	10.19.22

DRAWN BY: DC
CHECKED BY: JPM/JAR
APPROVED BY: DL
DATE: 1.16.2020
SCALE: 1" = 60'
ISSUE:

DRAWING TITLE:
**EROSION AND SEDIMENT
CONTROL PLAN**

DWG NUMBER:

C-400

JMC PROJECT: 19005-1
SCR: LTL/SCR
DWG FILE: 19005-1.LTL