

- 1) ALL SERVICE SHUT DOWN SHALL BE COORDINATED WITH THE BUILDING ENGINEER.
- 2) CONTRACTOR SHALL BE RESPONSIBLE FOR COORDINATING HIS WORK WITH EXISTING CONDITIONS AND NEW WORK OF ALL OTHER TRADES IN FIELD.
- 3) COORDINATE ROUTING OF NEW PIPING WITH EXISTING AND PROPOSED STRUCTURE AND OTHER TRADES. RUN PIPING AS HIGH AS POSSIBLE TO THE UNDERSIDE OF THE FLOOR SLAB SLAB
- 4) STRUCTURAL ENGINEER SHALL SPECIFY TYPES OF ANCHORS/ METHODOLOGY TO USE FOR EVERY TYPE OF HANGING LOAD (SANITARY PIPING, VENT PIPING AND WATER PIPING).
- 5) STRUCTURAL ENGINEER SHALL SPECIFY ALL METHODOLOGY TO USE FOR CORE DRILLING AND ANY REQUIRED REINFORCEMENTS.
- 6) STRUCTURAL ENGINEER SHALL REVIEW SUBMITTALS/SHOP DRAWINGS FOR ALL PROPOSED CORE DRILLS.

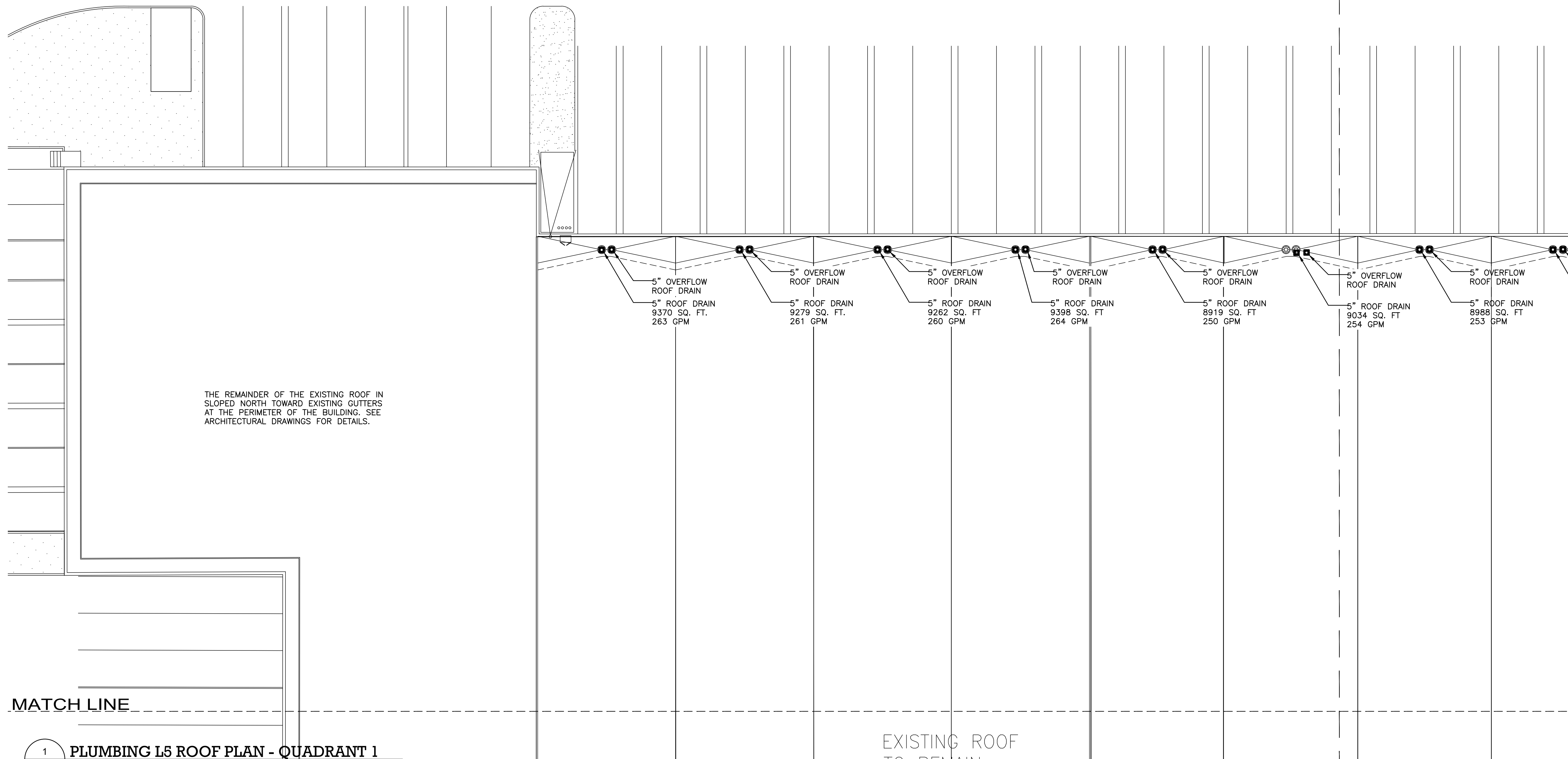

TO THE BEST KNOWLEDGE, BELIEF AND PROFESSIONAL JUDGEMENT,
THESE PLANS AND SPECIFICATIONS ARE IN COMPLIANCE WITH THE 2020
ENERGY CONSERVATION CONSTRUCTION CODE OF NEW YORK STATE.

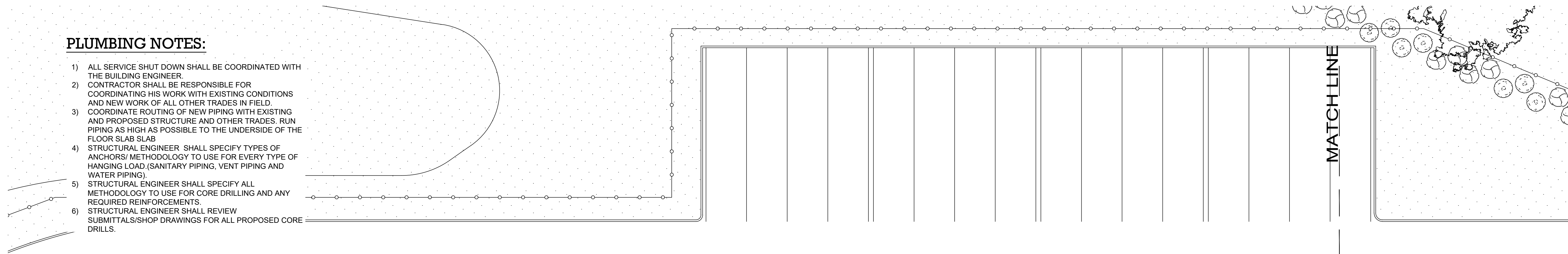

Architecture
Landscape Architecture
Planning



Burns

GEI  Consultants



MANHATTAN
BEER DISTRIBUTORS

KEY PLAN

REV	DESCRIPTION	DATE
	ISSUED FOR DOB SUBMISSION	09/10/2021
	ISSUED FOR BID	10/15/2021
1	ISSUED FOR PROGRESS	01/18/2022
	ISSUED FOR BID	08/30/2022

SCALE : $1/16" = 1'-0"$

PLUMBING L5 ROOF PLAN
QUADRANT 1

P-110