

BUILDING ELEVATIONS:
 BASEMENT = -12'-0"
 FIRST FLOOR = 0'-0"
 SECOND FLOOR = 12'-0"
 ROOF = 23'-9 1/4"

CONDENSATE PITCHED
1/8" PER FOOT
HWS/R CONNECTIONS TO
UNIT VENTILATORS IS 1"

- 1 UTILITY COMPARTMENT
- 2 CONDENSATE PIPED TO EXTERIOR. DRAIN DOWN GRADE.
- 3 DROP TO PIPE ENCLOSURE & ROUTE TO UNIT
- 4 EXPANSION COMPENSATION

REFERENCE DRAWINGS		
TRADE	DESCRIPTION	DATE
MECHANICAL	BRM-11 - FIRST FLOOR PLAN - NORTHWEST	06/06/2023
MECH DETAIL	-	-
RISC	-	-
PLUMBING	-	-
ELECTRICAL	-	-
STRUCTURAL	-	-
MISCELLANEOUS	BM-A10 - FIRST FLOOR PLAN - NORTHEAST	06/06/2023

TRADE	COMPANY	DATE	AUTHORIZED SIGNATURE
PIPE FITTER			
SHEET METAL			
PLUMBER			
SPRINKLER			
ELECTRICIAN			
MECHANICAL ENGINEER			
GENERAL CONTRACTOR			
ENGINEER			

COORDINATION NOTE

ELITE CAD DESIGNS SHALL NOT BE LIABLE FOR ANY MISTAKES, CONSTRUCTION ERRORS OR DELAYS THAT MAY RESULT FROM DECISIONS MADE BY THE USER BASED ON THE INFORMATION PROVIDED ON THESE DRAWINGS. MEASUREMENTS ARE MADE AT A MOMENT IN TIME AND ONLY GIVE MEASUREMENT DATA AT THE MOMENT OF LOCATION.

ELITE CAD DESIGNS DISCLAIMER

INFORMATION APPEARING ON THIS SHEET WAS PREPARED FROM THE INFORMATION AVAILABLE. ELITE CAD DESIGN'S ATTENTION IS CALLED TO THAT CONDITIONS AND QUANTITIES, AS SHOWN ON THE SHEET ARE ESTIMATED, NOT ACTUAL, AND IN ANY EVENT THEY ARE NOT TO BE DETERMINED OR CONSIDERED BY ANYONE AS A WARRANTY OF ACTUAL FIELD CONDITIONS OR QUANTITIES.

ARCHITECT / ENGINEER NOTES:

FOR APPROVAL

REV	DATE	DESCRIPTION
0	12/14/2023	SUBMITTED FOR APPROVAL

KEY PLAN

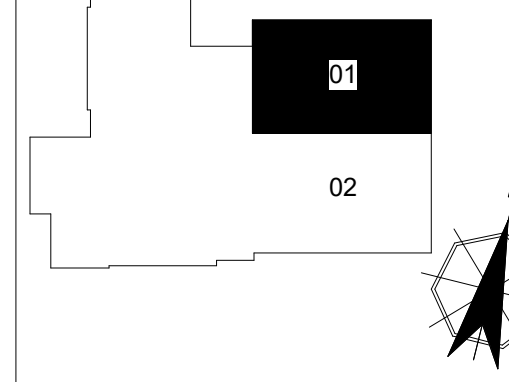

ARCH	KSQ Design		
ENG	Sage Engineering Associates		
PROJECT	Rant Middle School 50 Blaurett Rd #1 Nanuet, NY 12954		
TITLE	LEVEL 01 NORTHEAST		
GRP LDR	MC	PRG MGT	MM
DATE	SCALE	DWG NO	J