

ELECTRIC WATER HEATER SCHEDULE											
TAG NO.	STORAGE CAPACITY (gal.)	RECOVERY		ELECTRICAL DATA				TEMP. SETTING (°F)	MANUFACTURER	MODEL NO.	REMARKS
		RATE (GPH)	DEG. RISE (°F)	NO. OF ELEMENTS	TOTAL KW	VOLTS	PHASE				
EW-H-1	10	12	100°	1	3	208	1	110°	A.O. SMITH	DEL-10	MOUNT WATER HEATER ON SHELF ABOVE JANITORS' SINK. PROVIDE DRIP PAN PIPED TO JANITORS' SINK. PROVIDE LEAK DETECTION SYSTEM AS DETAILLED. PROVIDE SYMMONS MODEL 7-230-CK-FS MIXING VALVE ON HOT WATER SUPPLY.

DOMESTIC HOT WATER RECIRCULATION PUMP SCHEDULE											
TAG NO.	TYPE	CAPACITY (GPM)	HEAD (FT)	ELECTRICAL DATA					MANUFACTURER	MODEL NO.	REMARKS
				HP	VOLTS	HZ	PHASE	RPM			
CP-1	CARTRIDGE	½	4.5	¼ <sub>40</sub>	115	60	1	3250	TACO	003B	-

WATER HAMMER ARRESTER SCHEDULE		
TYPE	FIXTURE UNIT RATING	MODEL
SA "A"	1-11	JAY R. SMITH 5005
SA "B"	12-32	JAY R. SMITH 5010

SERVICE	MAXIMUM SERVICE OPERATING LIMITS			PIPE CLASS	PIPE SIZE RANGE						
	LEGEN D	PRESS (PSIG)	TEMP (°F)		½" TO 3"				4" AND LARGER		
					PIPE	FITTINGS	JOINTS	MECHANICAL JOINTS	PIPE	FITTINGS	JOINTS
DOMESTIC COLD WATER	CW	100	250	A10	Seamless copper water tube, drawn temper, Type L or K, ASTM B-88. See Note 1.	Wrought copper, solder-joint, ASME B16.22	ASTM B-32 solder filler material, Alloy S55 95/5, ASTM B-813 liquid or paste flux. Soldering procedures shall comply with ASTM B-828.	Cast copper alloy unions, hexagonal stock with ball-and-socket joint, solder joint ends. ASME B16.18.	Seamless copper water tube, drawn temper, Type L or K, ASTM B-88. See Notes 2 & 5.	Ductile iron coupling with copper alloy or enamel paint coating, ASTM A-536, Grade "E" EPDM elastomer gasket, ASTM D-2000. Equal to Victaulic Style 606 coupling. ASTM B-75 copper alloy fittings. ASTM B-84 grooved end cast bronze fittings for 6" pipe size.	Rolled groove prepared and assembled in accordance with manufacturer instructions.
DOMESTIC HOT WATER	HW	100	250	A10							
DOMESTIC HOT WATER RECIRCULATION	HWC	100	250	A10							
NON-POTABLE WATER	NPW	100	250	A10							

Notes:

1. Below grade water piping 3" and smaller shall be Type K copper with bituminous coating and copper brazed joints, BcuP filler alloy. ANSI/AWS A5.8, procedures shall be per ANSI/AWS B2.2.
2. Contact between dissimilar metals shall be made with di-electric couplings or di-electric flanges. Contact between ferrous and stud bolts and bronze flanges shall be electrically insulated with non-metallic washers.
3. Provide mechanical joint connections to all equipment such as water heaters, pumps, compressors, etc.

SERVICE	MAXIMUM SERVICE OPERATING LIMITS			PIPE CLASS	PIPE SIZE RANGE					
	LEGEND	PRESS. (PSIG)	TEMP (°F)		½" TO 2"			2½" AND LARGER		
					PIPE	FITTINGS	UNIONS	PIPE	FITTINGS	UNIONS
GAS (NATURAL)	G	50	70	A11	Schedule 40 Carbon Steel ASTM A53 Grade B, A106 Grade A Or A120.	Screwed Malleable Iron 125 PSI.	Screwed 150# Malleable Iron A105 Grade II.	Schedule 40 Carbon Steel ASTM A53 Grade B, A106 Grade A Or A120.	Butt Weld Carbon Steel Schedule 40, A 234.	Use Flanges.
GAS VENT	GV	50	70	A11						

Notes:

1. For Laboratory Gas Piping Systems, Supply an Emergency Gas Shut-Off Ball Valve to Each Lab.
2. Provide a branch ball valve and positive shutoff check valve on each pipe branch within each laboratory the gas pipe floor main to lab fixtures.
3. Provide Two Wrenches For Each Gas Cock Size.
4. Kitchen Selenoid Shall Be Wired To The Hood Suppression System By This Contractor. Field Verify Voltage Selenoid Valve Requirements With Kitchen Supplier.
5. The Contractor, At His Option, May Weld Piping Down To 1-1/4" If Permitted By Local Codes.
6. The Contractor Must Be Certified Per The Requirements Of Section 15000.
7. All above ground exterior gas piping or piping located in a corrosive atmosphere shall be protected by a coating of high density polyethylene or a wrapping of an inert material.





SERVICE	MAXIMUM SERVICE OPERATING LIMITS			PIPE CLASS	ABOVE GRADE						BELOW GRADE			
	LEGEND	PRESS. (PSIG)	TEMP (°F)		PIPE	FITTINGS	JOINTS	PIPE	FITTINGS	JOINTS				
SANITARY WASTE & VENT	S, W, V	GRAVITY	120	D10	3" And Larger: Hubless Cast Iron Soil Pipe, Service Wye, ASTM A-888, CIPSI 301 2 1/2" And Smaller: Hubless Cast Iron Soil Pipe, Service Wye, ASTM A-888, CIPSI 301 Or Type L Copper Tubing, ASTM B697, See Note 1.	3" And Larger: Hubless Cast Iron Fittings, Service Wye, ASTM A-888, CIPSI 801 2 1/2" And Larger: Hubless Cast Iron Fittings, Service Wye, ASTM A-888, CIPSI 301 Or Wrought Copper DWV Fitting, See Note 1.	Hubless Cast Iron: Heavy Duty Stainless Steel Band Coupling With Neoprene Gasket, Bank Trench Or 60 PSI, 15 PSI Pressure Rating, Husky SD 4000 Or Clamp-All HS-Tong 80. See Note 2. Copper: 95/5 Solder.	2" And Larger: Hub And Spigot Cast Iron Soil Pipe, Extra Heavy, ASTM A-74 Or Service Weight If Code Approved, Piping Shall Be Asphalt Or Coal Tar Pitch Coated.	2" And Larger: Hub And Spigot Cast Iron Fittings, Extra Heavy, ASTM A-74 Or Asphalt Or Coal Tar Pitch Coated, DWV Pattern.	Neoprene Compression Gaskets Conforming To ASTM C-564.				

Notes:

1. Copper Tube And Fittings Shall Not Be Used On Urinal Wastes.
2. CSPI 310-Hub Couplings Will Not Be Accepted As Equal To Manufacturers Listed.
3. Piping through electric rooms, sanitary, storm, and vent piping through electric rooms shall be sleeved through a sufficiently sized schedule 10 galvanized sleeve with Grooved style fittings and couplings. Extend dual wall piping to a distance of 1 foot beyond the exterior on each side of the electric room. Terminate with a closure method comprised of a caulked joint at each end with a closed 3/4" ball valve available to monitor the containment area of the piping system

SERVICE	MAXIMUM SERVICE OPERATING LIMITS			PIPE CLASS	PIPE SIZE RANGE					
	LEGEND	PRESS. (PSIG)	TEMP (°F)		½" TO 1½"			2" AND LARGER		
					PIPE	FITTINGS	JOINTS	PIPE	FITTINGS	JOINTS
INDIRECT WASTE	IW	GRAVITY	80	A17	Seamless copper water tube, drawn temper, Type L or K, ASTM B-68. See Note 1.	Wrought copper, solderjoint, ASME B16.22	ASTM B-32 solder filler material, Alloy S85 "95%". ASTM B-813 liquid or paste flux. Soldering procedures shall comply with ASTM B-828.	Hubless Cast Iron Soil Pipe, Service Weight, ASTM-A-888, CISP 801	Hubless Cast Iron Fit-tings, Service Weight, ASTM-A-888, CISP 801.	Heavy Duty Stainless Steel Band Coupling With Neoprene Gasket. Bank Torque Of 90 Foot-Pounds. 15 PSIG Pressure Rating. Husky SD 4050 Or Clamp-A-Hi-Tong 80. See Note 2.

Notes:  
1. CISPI 310 No-Hub couplings will not be accepted as equal to manufacturers listed.

PLUMBING FIXTURE SCHEDULE												
TAG NO.	FIXTURE				FITTING				TRAP	CARRIER	REMARKS	
	TYPE	MANUFACTURER	MODEL	SIZE	TYPE	MANUFACTURER	MODEL	SUPPLY				
P-1/1A	WATER CLOSET	KOHLER	KINGSTON K-4325	-	AUTOMATIC FLUSHOMETER	KOHLER	WAVE K-10673-SV	1" CW	INTEGRAL	J.R. SMITH 0210Y	PROVIDE WALL CARRIER TO SUIT. FURNISH AND INSTALL SOLID PLASTIC ELONGATED OPEN FRONT SEAT.	
P-2	URINAL	KOHLER	BARDON K-4991-ET-0	-	AUTOMATIC FLUSHOMETER	KOHLER	WAVE K-10676-SV-CP	3/4" CW	INTEGRAL	J.R. SMITH 0636	PROVIDE WALL CARRIER TO SUIT. MOUNT AT ADA HEIGHT.	
P-3	LAVATORY	KOHLER	CAXTON K-2210	19 1/2" x 16 1/4"	MOTION SENSOR FAUCET	MAC FAUCETS	F4444HD-31 (18" OIL RUBBED BRONZE FINISH)	1/2" CW 1/2" HW	1 1/2" OFFSET POLISHED CHROME	UNDER COUNTER MOUNT	PROVIDE W/ 0.5GPM AERATOR. PROVIDE W/ AC PLUG-IN ADAPTER. PROVIDE OFFSET GRID DRAIN ASSEMBLY W/ TRUE BRO INSULATION ON PIPING UNDER LAVATORY. PROVIDE NEW C.P.SUPPLIES AND ANGLE STOPS. PROVIDE LEONARD LF-170 MIXING VALVE BELOW SINK.	
P-4	BREAK ROOM SINK	ELKAY	ELUHAD211545	23 1/2" x 18 1/2"	DECK MOUNTED SINGLE CONTROL	WATERSTONE	FULTON 7825-ORB	1/2" CW 1/2" HW	OFFSET POLISHED CP TRAP & TAILPIECE	UNDERMOUNT	PROVIDE ELKAY LKAD35 ADA ACCESSIBLE BASKET STRAINER W/ OFFSET P-TRAP & TAIL PIECE W/ 1/2" CP ANGLE SUPPLIES (2). PROVIDE TRUE BRO INSULATION ON PIPING BENEATH SINK.	
P-5	MOP RECEPTOR	FIAT	TSB-100	24" x 24"	SERVICE SINK FAUCET	CHICAGO FAUCETS	897-CP	1/2" CW 1/2" HW	-	-	3/4" HOSE CONNECTION WITH VB AND PAIL HOOK.	
P-6	DRINKING FOUNTAIN	HALSEY TAYLOR	HRF-SEBP SJ8 CHILLER MOUNTED ABOVE CEILING OF JANITORS CLOSET	37" x 18"	-	-	-	1/2" CW	(2) P-TRAPS	IN-WALL	PROVIDE (1) MODEL HWF172 WATER FILTER AT CW INLET FOR EACH FOUNTAIN. (2) FILTERS TOTAL. REMOTE CHILLER UNIT MOUNTED ABOVE CEILING. REFER TO REMOTE CHILLER DETAIL.	
P-7	REFRIGERATOR SUPPLY BOX	IPS CORP	AB9700 HA 87978	5 1/2" x 4 1/2" x 3 1/2"	-	-	-	1/2" FW	-	-	PROVIDE WHITE POWDER COAT FINISHED. RECESSED ICE MAKER OUTLET BOX WITH QUARTER TURN VALVE AND WATER HAMMER ARRESTOR.	
HB	HOSE BIBB	WOODFORD	24P-1/2	-	-	-	-	1/2" CW	-	-	PROVIDE WITH LOOSE KEY HANDLE.	

**Jacobs**  
Jacobs Architects / Engineers, Inc.  
2301 Chestnut Street  
Philadelphia, Pennsylvania  
19103  
P 215.569.2900  
F 215.569.5963  
W [www.jacobs.com](http://www.jacobs.com)

Fidelity's Engineering Consultant :

NV5

70 Fargo Street, Suite 800  
Boston, MA 02210-1964

Seals:

General Notes:

Project Title:



Fidelity Real Estate Company  
245 Summer Street  
Boston, MA20110

Fidelity Investor Center

2142 Fashion Drive

Nanuet, NY

10954

[illegible]

**Key Plan:**

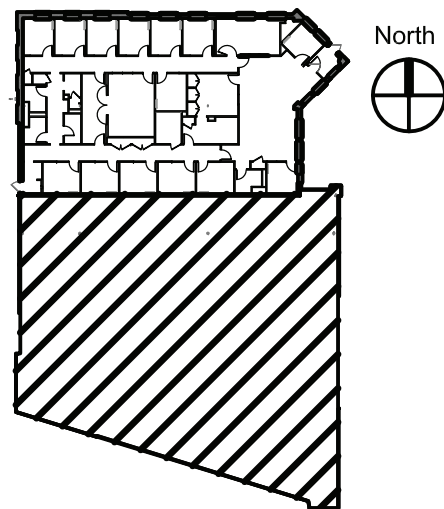

Landlord Comments:

Project No.: Y021006

Copyright: 2021

Drawing Sheet Title:

## PLUMBING SCHEDULES

Drawing Sheet Number:

# P-700

Owner's Branch No.:

532