



FIRST FLOOR PLAN

SCALE: 3/16" = 1'-0"

MATCHLINE (A-101)
MATCHLINE (A-102)

MATCHLINE (A-101)
MATCHLINE (A-102)

SEE A-102 FOR BASE
CONTRACT WORK AT
ENCLOSED PASSAGEWAY

ALTERNATE AREA OF
CONSTRUCTION WORK

DIGITAL
MEDIA
151
296 SQ. FT.

WEST
CORRIDOR
152
37 SQ. FT.

STORAGE
CLASSROOM
154
196 SQ. FT.

WEST
CORRIDOR
153
160 SQ. FT.

NEW SPRINKLER SYSTEM
THROUGHOUT EXISTING
VERNI BUILDING. SEE MEP
DRAWINGS

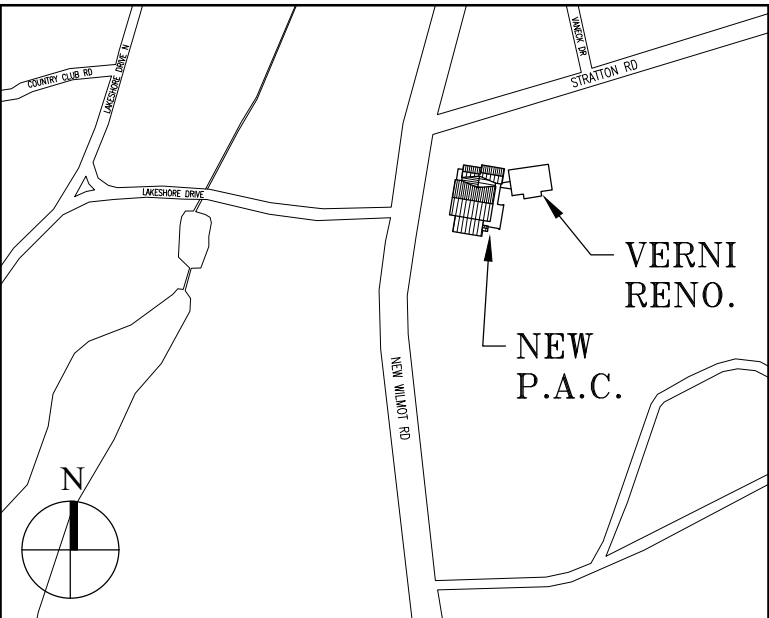

Key Plan (not to scale)

LEGEND:

- EXISTING PARTITION TO REMAIN
- NEW GYP. BD. WALL
- NEW CONCRETE WALL
- NEW DOOR & FRAME
- EXISTING DOOR TO REMAIN
- PARTITION TYPE
- WINDOW TYPE
- EXTERIOR LOUVER SEE PLANS
AND LOUVER SCHEDULE
- FIRE EXTINGUISHER & CABINET
MP DRY CHEM. 10 LBS. UL
RATED 4A-80B.C. CABINETS SHALL
BE ARCH'L SERIES, FIRE-RATED, RED
DIE-CUT LETTERING FULLY OR SEMI
RECESSED CABINET WITH ROLLED
EDGE, BY LARSEN'S OR EQUAL.
PROVIDE V-SHAPE PROJECTING SIGN.

| | | |
|----------------------------------|------------|--------------------------------------|
| 7. | 6/01/2021 | ISSUED FOR BID |
| 6. | 5/07/2021 | RE-ISSUED FOR BUILDING PERMIT REVIEW |
| 5. | 2/01/2021 | ISSUED FOR BUILDING PERMIT REVIEW |
| 4. | 10/14/2020 | ISSUED FOR PLANNING BOARD REVIEW |
| 3. | 9/23/2020 | RESUBMITTED FOR ZONING REVIEW |
| 2. | 8/28/2020 | ISSUED FOR PRELIMINARY DOB REVIEW |
| 1. | 1/10/2020 | ISSUED FOR DD ESTIMATE |
| No. | Date | Revision/Submission |
| STRUCTURAL & SITE CIVIL ENGINEER | | |
| DOMINICK R PILLA | | |
| ASSOCIATES, P.C. | | |
| 143 MAIN STREET | | |
| NYACK, NY 10960 | | |
| 845-727-7793 | | |
| MEP ENGINEER | | ROOFING CONSULTANT |
| JMV CONSULTING | | WATSKY ASSOCIATES |
| ENGINEERING, P.C. | | 20 MADISON AVENUE |
| 37 W. 39 STREET, STE 703 | | VALHALLA, NY 10595 |
| NEW YORK, NY 10018 | | 914-948-3450 |
| 212-852-9855 | | |

Stamp

Project Title

IONA PREPARATORY SCHOOL
ADDITION AND ALTERATION TO THE
PAUL VERNI FINE ARTS CENTER

Project Address

IONA PREPARATORY SCHOOL
255 Wilmot Road
New Rochelle, NY 10804

Drawing Title

VERNI ALTERNATE
CONSTRUCTION PLAN

| Scale | Job No. | Date | Drawing No. |
|----------|---------|------------|-------------|
| AS NOTED | 1618 | 04/03/2019 | A-102a |

Drawn

Peter Gisolfi Associates
Architects Landscape Architects, LLP
566 Warburton Avenue
Hastings on Hudson, NY 10706
914 478 3677
PETER GISOLFI ASSOCIATES