

Key Plan (not to scale)

NOTES:  
SEE FINISH SCHEDULE ON A-950 FOR ADDITIONAL INFORMATION

No.	Date	Revision/Submission
7.	6/01/2021	ISSUED FOR BID
6.	5/07/2021	RE-ISSUED FOR BUILDING PERMIT REVIEW
5.	2/01/2021	ISSUED FOR BUILDING PERMIT REVIEW
4.	10/14/2020	ISSUED FOR PLANNING BOARD REVIEW
3.	9/23/2020	RESUBMITTED FOR ZONING REVIEW
2.	8/28/2020	ISSUED FOR PRELIMINARY DOB REVIEW
1.	1/10/2020	ISSUED FOR DD ESTIMATE

**STRUCTURAL & SITE CIVIL ENGINEER**  
DOMINICK R PILLA  
ASSOCIATES, P.C.  
143 MAIN STREET  
NYACK, NY 10960  
845-727-7793

**MEP ENGINEER**  
JMV CONSULTING  
ENGINEERING, P.C.  
37 W. 39 STREET, STE 703  
NEW YORK, NY 10018  
212-852-9855

**ROOFING CONSULTANT**  
WATSKY ASSOCIATES  
20 MADISON AVENUE  
VALHALLA, NY 10595  
914-948-3450

Stamp

Project Title  
IONA PREPARATORY SCHOOL  
ADDITION AND ALTERATION TO THE  
PAUL VERNI FINE ARTS CENTER

Project Address  
IONA PREPARATORY SCHOOL  
255 Wilmot Road  
New Rochelle, NY 10804

Drawing Title  
SECOND FLOOR  
FLOOR PATTERN PLAN

Scale	Job No.	Date	Drawing No.
AS NOTED	1618	04/03/2019	A-171

Drawn

Peter Gisolfi Associates  
Architects Landscape Architects, LLP  
566 Warburton Avenue  
Hastings on Hudson, NY 10706  
914 478 3677

PETER GISOLFI ASSOCIATES

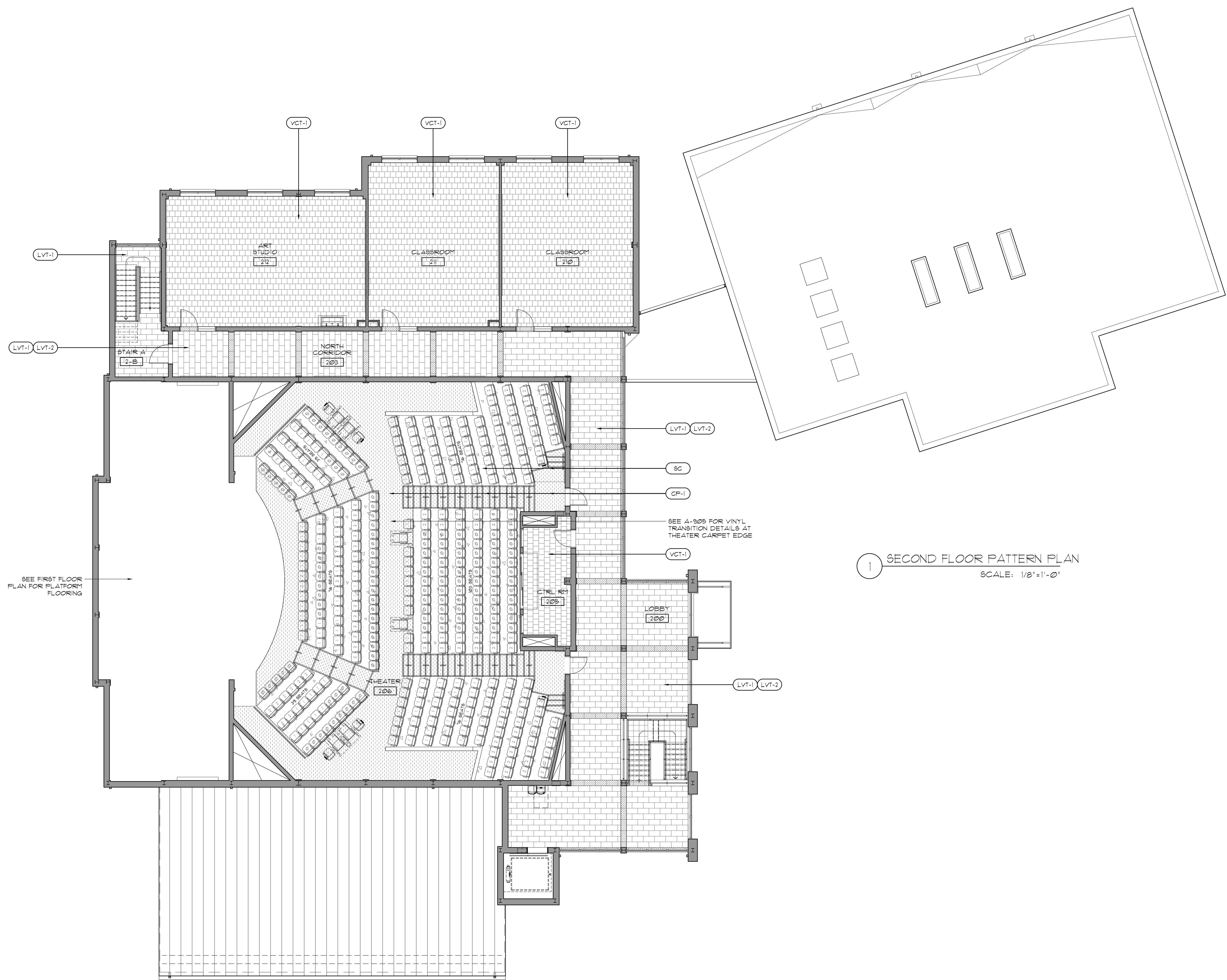

1 SECOND FLOOR PATTERN PLAN  
SCALE: 1/8"=1'-0"