







LEGEND:

	SUPPLY, OUTSIDE AIR DUCT OR CEILING DIFFUSER
	RETURN, EXHAUST AIR DUCT OR RETURN AIR DIFFUSER
	SPACE SENSOR - MH-48\"
	POINT OF CONNECTION
	POINT OF DISCONNECTION
	VOLUME DAMPER
	REMOVALS

ABBREVIATIONS:

AFG	ABOVE FINISHED GRADE
CFM	CUBIC FEET PER MINUTE
SD	SUPPLY DIFFUSER
DN	DOWN
EX.	EXISTING
MIN	MINIMUM
MAX	MAXIMUM
OA	OUTSIDE AIR
RG	RETURN GRILLE
RR	RETURN REGISTER
SD	SUPPLY DIFFUSER
SR	SUPPLY REGISTER

SCOPE OF WORK:

1. THE CONTRACTOR SHALL PROVIDE ALL LABOR, MATERIALS AND EQUIPMENT NECESSARY TO COMPLETE ALL WORK SHOWN OR INFERRED ON THESE CONTRACT DRAWINGS AND DOCUMENTS. THE WORK SHALL INCLUDE, BUT NOT NECESSARILY BE LIMITED TO THE FOLLOWING PRINCIPLE ITEMS OF WORK:
1. PROVIDE REMOVAL OF HVAC EQUIPMENT INCLUDING RECOVERY OF REFRIGERANT FROM CONDENSERS.

2. PROVIDE ONE DUCTED FANCOIL / CONDENSER SYSTEM AS SCHEDULED AND DETAILED.

3. PROVIDE ONE DUCTLESS FANCOIL / CONDENSER SYSTEM AS SCHEDULED AND DETAILED.

4. PROVIDE AND INSTALL NEW DUCTWORK, DUCTWORK INSULATION, DUCTWORK ACCESSORIES, DUCT SUPPORTS, REGISTERS, PROVIDE 7 DAY PROGRAMMABLE SYSTEM CAPABLE THERMOSTAT PROVIDE THERMOSTAT TRAINING TO OWNER AT PROJECT COMPLETION.

6. PROVIDE ALL EQUIPMENT AS SCHEDULE OR EQUAL. EQUAL SHALL BE APPROVED BY ENGINEER DURING SUBMITTAL PROCESS. PROVIDE SUBMITTALS FOR ALL SCHEDULED EQUIPMENT.

7. PROVIDE AIR BALANCING OF SYSTEMS.

8. PROVIDE KITCHEN SINK AS ELKAY LUSTERTONE Q252255. COORDINATE INSTALLATION WITH GC FOR MILLWORK. PROVIDE FAUCET AS AMERICAN STANDARD MONTERREY 2 HANDLE WRIST BLADE STYLE 7500.174. PROVIDE SINK AND FAUCET HW, CW, AND DRAINAGE PIPING CONNECTIONS.

GENERAL MECHANICAL NOTES:

1. IN CERTAIN AREAS OF THE CONTRACT DRAWINGS, DIMENSIONS AND ARE SHOWN DUCTWORK. THE DUCTWORK LAYOUT SHALL BE FIELD VERIFIED PRIOR TO FABRICATION. THE CONTRACTOR MAY MODIFY ELEVATIONS AND LOCATIONS AS NECESSARY TO AVOID INTERFERENCE'S WITH EXISTING AND NEW SERVICES. THE CONTRACTOR SHALL NOT SCALE OFF THESE DRAWINGS FOR THE PURPOSE OF CONSTRUCTION.

2. CONTRACTOR SHALL VISIT THE SITE, BECOME FAMILIAR WITH THE EXISTING FIELD CONDITIONS, AND MAKE HIS OWN ESTIMATE OF THE DIFFICULTIES ATTEMPTING THE EXECUTION OF THE WORK PRIOR TO SUBMITTING HIS BID. NO COMPENSATION WILL BE AWARDED TO THE CONTRACTOR BASED ON A CLAIM OF LACK OF KNOWLEDGE OF EXISTING FIELD CONDITIONS.

3. COORDINATE WITH OWNER REPRESENTATIVE PRIOR TO DOING ANY WORK AFFECTING ANY OPERATIONAL AREA ADJACENT TO THE AREA OF WORK.

4. THE CONTRACTOR SHALL REPORT ALL CHANGES IN THE WORK TO THE OWNER REPRESENTATIVE.

5. IN THIS CONTRACT THE WORK "PROVIDE" SHALL MEAN "FURNISH AND INSTALL."

6. THE CONTRACTOR SHALL CAREFULLY PLAN AND PERFORM ALL WORK TO PREVENT DAMAGE TO EXISTING. PROVIDE PROTECTION DEVICES REQUIRED TO PROTECT EXISTING FACILITIES AND EQUIPMENT DURING THE CONSTRUCTION OF THIS PROJECT. ANY DAMAGE TO EXISTING FACILITIES OR EQUIPMENT RESULTING FROM THE WORK OF THIS CONTRACT SHALL BE REPAIRED OR REPLACED AT THE CONTRACTOR'S EXPENSE TO THE SATISFACTION OF OWNER. THE CONTRACTOR SHALL NOTIFY OWNER IMMEDIATELY OF ANY DAMAGE TO THE NEW EQUIPMENT OR TO EXISTING FACILITIES OR EQUIPMENT.

7. ALL WORK PERFORMED SHALL BE IN ACCORDANCE WITH THE BEST CONSTRUCTION PRACTICES AND AS A MINIMUM SHALL CONFORM TO THE CODES AND STANDARDS OF THE ORGANIZATIONS LISTED BELOW.

A. OCCUPATION SAFETY AND HEALTH ADMINISTRATION (OSHA)

B. AMERICAN SOCIETY OF MECHANICAL ENGINEERS (ASME)

C. AMERICAN NATIONAL STANDARDS (ANSI)

D. SHEET METAL AND AIR CONDITIONING CONTRACTORS NATIONAL ASSOCIATION (SMACNA)

E. NEW YORK STATE CODE RULES AND REGULATIONS

F. NEW YORK STATE ENERGY CONSERVATION CODE RULES AND REGULATIONS

8. THE CONTRACTOR SHALL FIELD VERIFY ALL EXISTING CONDITIONS, LOCATIONS, ELEVATIONS AND DIMENSIONS PRIOR TO START OF WORK AND NOTIFY THE OWNER OF ANY DISCREPANCIES OF PROBLEMS WHICH WOULD INTERFERE WITH THE SATISFACTORY COMPLETION OF THE WORK.

9. ANY DAMAGE TO ANY EXISTING UTILITIES CAUSED BY CONTRACTOR'S WORK SHALL BE IMMEDIATELY REPAIRED BY QUALIFIED PERSONNEL AT CONTRACTOR'S EXPENSE.

MATERIAL SPECIFICATIONS

1. REFRIGERANT PIPING: ACR TUBE: ASTM B 280, WROT COPPER TUBE FITTINGS, SOLDER JOINT: ASME B16.22.CAST COPPER ALLOY TUBE FITTINGS, SOLDER JOINT: ASME B16.18. BRAZING ALLOYS, TYPE 1: AWS A5.8, CLASS BCUP-5, FOR BRAZING COPPER TO BRASS, BRONZE, OR COPPER; ENGELHARD'S SILVALOY 15, J.W. HARRIS CO. INC.'S STAY-SILV 15, AND HANDY & HARMAN'S SIL-FOS. TYPE 2: AWS A5.8, CLASS BAG-7, FOR BRAZING COPPER TO STEEL OR STAINLESS STEEL; ENGELHARD'S SILVALOY-56T, J.W. HARRIS CO. INC.'S SAFETY-SILV 56, AND HANDY & HARMAN'S BRAZE 560.

2. CONDENSATE - COPPER TUBE, PVC SCHEDULE 40 PIPE AND FITTINGS.

3. REFRIGERANT PIPING INSULATION: FLEXIBLE ELASTOMERIC FOAM INSULATION: FM TESTED AND APPROVED, MAXIMUM WATER VAPOR TRANSMISSION 0.10 PERM - INCH BASED ON ASTM E 96, PROCEDURE, K OF 0.27 AT 75 DEGREES F BASED ON ASTM C 518 OR C 177. FIRE SPREAD/SMOKE DEVELOPED RATING: 25/50 OR LESS BASED ON ASTM E 84, ASTM C 534, TYPE I. POLYETHYLENE AND POLYOLEFIN INSULATION IS NOT ACCEPTABLE.

4. DUCTWORK: GAGES OF MATERIALS, FABRICATION, REINFORCEMENT, SEALING REQUIREMENTS, INSTALLATION, AND METHOD OF SUPPORTING DUCTWORK SHALL BE IN ACCORDANCE WITH SMACNA HVAC DUCT CONSTRUCTION STANDARDS. FABRICATE DUCTWORK FROM GALVANIZED SHEET METAL, EXCEPT A 10 FT LENGTH AT THE HUMIDIFIER DISPERSION ASSEMBLY AS INDICATED ON THE INSTALLATION PLAN. GALVANIZED STEEL SHEET: ASTM A 653, CLASS LFQ (LOCK FORMING QUALITY), COATING DESIGNATION G90. STAINLESS STEEL SHEET: AISI TYPE 302 OR 304 STAINLESS STEEL.

5. DUCT LINER: GLASS FIBER INSULATION, NON-CORROSIVE, INCOMBUSTIBLE GLASS FIBER COMPLYING WITH ASTM C1071; FLEXIBLE BLANKET, RIGID BOARD, IMPREGNATED SURFACE AND EDGES COATED WITH POLY VINYL ACETATE POLYMER, ACRYLIC POLYMER, OR BLACK COMPOSITE. ADHESIVE: WATERPROOF, FIRE-RETARDANT TYPE, ASTM C916.

BID SET: 12 APRIL 2021

REVIEW SET: 18 DECEMBER 2020

ISSUES and REVISIONS

AND COPYRIGHTED PROPERTY OF BUTLER ROWLAND MAYS ARCHITECTS, LLP AND MAY NOT BE ALTERED, COPIED OR REPRODUCED BY ANY METHOD FOR ANY PURPOSE WITHOUT THE EXPRESS WRITTEN CONSENT OF BUTLER ROWLAND MAYS ARCHITECTS, LLP.



BUTLER
ROWLAND
MAYS

ARCHITECTS, LLP

57 West High Street
Ballston Spa
New York 12020

PH: 518 ¥ 885 ¥ 1255
FAX: 518 ¥ 885 ¥ 1266
www.brmarshitects.com



SAGE ENGINEERING
ASSOCIATES, LLP

9 COLUMBIA CIRCLE
ALBANY, NY 12203
(518)453-6091 FAX(518)453-6092

Second Floor
Community Room
Renovation for the

Josephine-Louise
Public Library



DWN. BY: RWW

SCALE: AS NOTED

JOB NO.: 19.42.17

DATE: 04.12.2021

LEGEND, SYMBOLS,
ABBREVIATIONS AND
SPECIFICATIONS

TITLE

H001

DWG. NO.

1 OF 5

DIFFUSER, REGISTER AND GRILLE SCHEDULE								
TAG	TYPE	SIZE	NECK SIZE	PATTERN	MOUNTING	MATERIAL	MANUFACTURER & MODEL NO.	REMARKS
RR-1	RETURN WITH FILTER	36X12	36X12	45 DEGREE	SURFACE	STEEL	NAILOR 61FB45	
SR-1	SUPPLY	24X8	24X8	DOUBLE DEFLECTION	DUCT	STEEL	NAILOR 61DV-O	
SR-2	SUPPLY	14X8	14X8	DOUBLE DEFLECTION	DUCT	STEEL	NAILOR 61DV-O	

CONDENSING UNIT SCHEDULE														
		COOLING				HEATING								
TAG	SERVICE	COND. EAT DB (DEG. F)	EVAP. EAT WB (DEG. F)	SENS. CAP. (BTUH)	TOTAL CAP. (BTUH)	COND. EAT DB (DEG. F)	TOTAL CAP. (BTUH)	ELECTRICAL					MFG. AND MODEL	REMARKS
								VOLTS	PHASE	HZ	MCA	MOCP		
ACCU-1	FC-1	95	67	42.2	57.5	N/A	N/A	208	1	60	37.3	60	BRYANT 127ANA060	1,3
ACCU-2	FC-2	91	62.5	24.0	30.7	-4	32.5	230	1	60	23.5	40	LG ARUM036GSS5	2,3
1. SEE DETAIL 1/H003 FOR INSTALLATION. 2. SEE DETAIL 2/H003 FOR INSTALLATION. 3. PROVIDE AS INVERTER SYSTEM.														

FAN COIL UNITS														
FANCOIL														
TAG	SERVICE	STYLE	CFM	SPEED CONTROL	MBH COOLING	MBH HEATING	MOUNTING	ELECTRICAL					MANUFACTURER	REMARKS
								VOLTS	PHASE	HZ	MCA	RLA		
FC-1	LIBRARY SPACE	AHU	945 - 1750	VARIABLE	44.5 - 56.5	N/A	VERTICAL	208	1	60	8.5	6.8	BRYANT FV4CNF006	1,3,4
FC-2	COMMUNITY ROOM	HIGH WALL	671 - 918	VARIABLE	24.0 - 30.7	26.0-42.0	CEILING	208	1	60	1.02	0.81	LG ARNU363SVA4	2,3
1. SEE DETAIL 1/H003 FOR INSTALLATION. 2. SEE DETAIL 2/H003 FOR INSTALLATION. 3. PROVIDE WITH CONDENSATE PUMP , LITTLE GIANT VCMULS-20 OR EQUAL. 4. PROVIDE WITH EC MOTOR.														

CONDENSATE PUMP SCHEDULE									
TAG	SERVICE	FLOWRATE (GPM)	HEAD (FT)	FLUID TEMP. (DEG F)	FLUID TYPE	ELECTRICAL		BASIS OF DESIGN MANUFACTURER & MODEL NO	REMARKS
						MOTOR HP	VOLT/PH		
CP-1	FC-1, FC-2	0.75	10	50	WATER	1/30	230/1	LITTLE GIANT VMCA-20ULS	1,2
1. PROVIDE WITH SAFETY OVERFLOW SWITCH. 2. WIRE SAFETY OVERFLOW SWITCH TO INTERRUPT A/C OPERATION UPON HIGH WATER LEVEL SENSING.									

ELECTRIC CABINET UNIT HEATER SCHEDULE							
TAG	LOCATION / SERVICE	CAPACITY (KW)	LENGTH X WIDTH X HEIGHT (IN. X IN. X IN.)	ELECTRICAL		BASIS OF DESIGN MANUFACTURER & MODEL NO.	REMARKS
				VOLTS	PHASE		
EWH-1	KITCHEN	1.5	10.5 X 5 X 12.5	120	1	BERKO SRA1512DSAF	1,2,3
1. PROVIDE WITH SURFACE MOUNTING FRAME. 2. PROVIDE WITH FACTORY INTEGRAL MOUNTED THERMOSTAT. INITIAL SETTING OF 65 DEGREES. 3. MOUNT WALL HEATER HIGH ON WALL MINIMUM OF 84".							

BID SET: 12 APRIL 2021

REVIEW SET: 18 DECEMBER 2020

ISSUES and REVISIONS

AND COPYRIGHTED PROPERTY OF BUTLER ROWLAND MAYS ARCHITECTS, LLP AND MAY NOT BE ALTERED, COPIED OR REPRODUCED BY ANY METHOD FOR ANY PURPOSE WITHOUT THE EXPRESS WRITTEN CONSENT OF BUTLER ROWLAND MAYS ARCHITECTS, LLP.



BUTLER
ROWLAND
MAYS

ARCHITECTS, LLP

57 West High Street
Ballston Spa
New York 12020

PH: 518 Y 885 Y 1255
FAX: 518 Y 885 Y 1266
www.brmarchitects.com



SAGE ENGINEERING
ASSOCIATES, LLP

9 COLUMBIA CIRCLE
ALBANY, NY 12203
(518)453-6091 FAX(518)453-6092

Second Floor
Community Room
Renovation for the

Josephine-Louise
Public Library



DWN. BY: RWW
SCALE: AS NOTED
JOB NO.: 19.42.17
DATE: 04.12.2021

SCHEDULES

TITLE

H002

DWG. NO.

2 OF 5

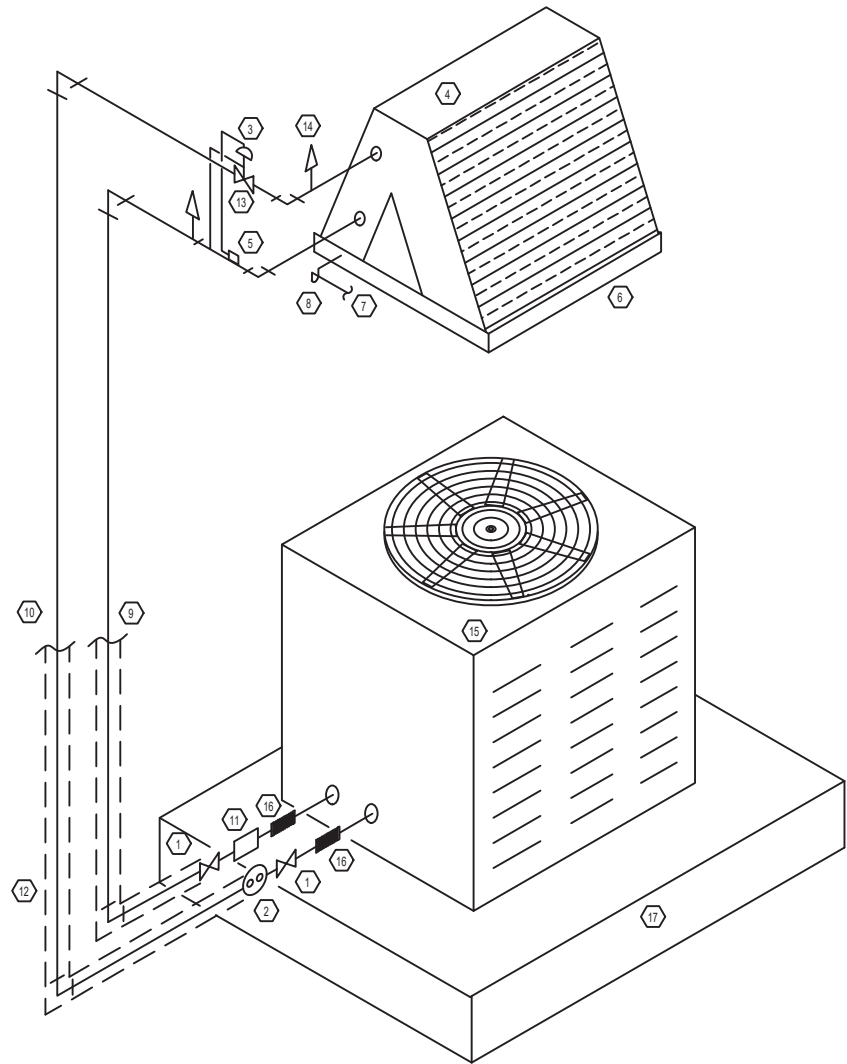

- | | |
|--------------------------------|---|
| 1 SHUT OFF SERVICE VALVE (TYP) | 9 REFRIGERANT SUCTION |
| 2 SIGHT GLASS | 10 REFRIGERANT LIQUID |
| 3 THERMAL EXPANSION VALVE | 11 FILTER-DRIER |
| 4 DX EVAPORATOR COIL | 12 ALUMINUM JACKETING (EXTERIOR EXPOSED PIPING) |
| 5 SENSING BULB | 13 EQUALIZATION LINE |
| 6 CONDENSATE DRAIN PAN | 14 PRESSURE TAP |
| 7 CONDENSATE DRAIN LINE | 15 CONDENSING UNIT |
| 8 CONDENSATE TRAP | 16 FLEXIBLE PIPING CONNECTORS |
| | 17 EQUIPMENT PAD (SECURE TO ROOF) |

1 CONDENSER SPLIT SYSTEM DETAIL (ACCU-1)
H003 SCALE: NTS

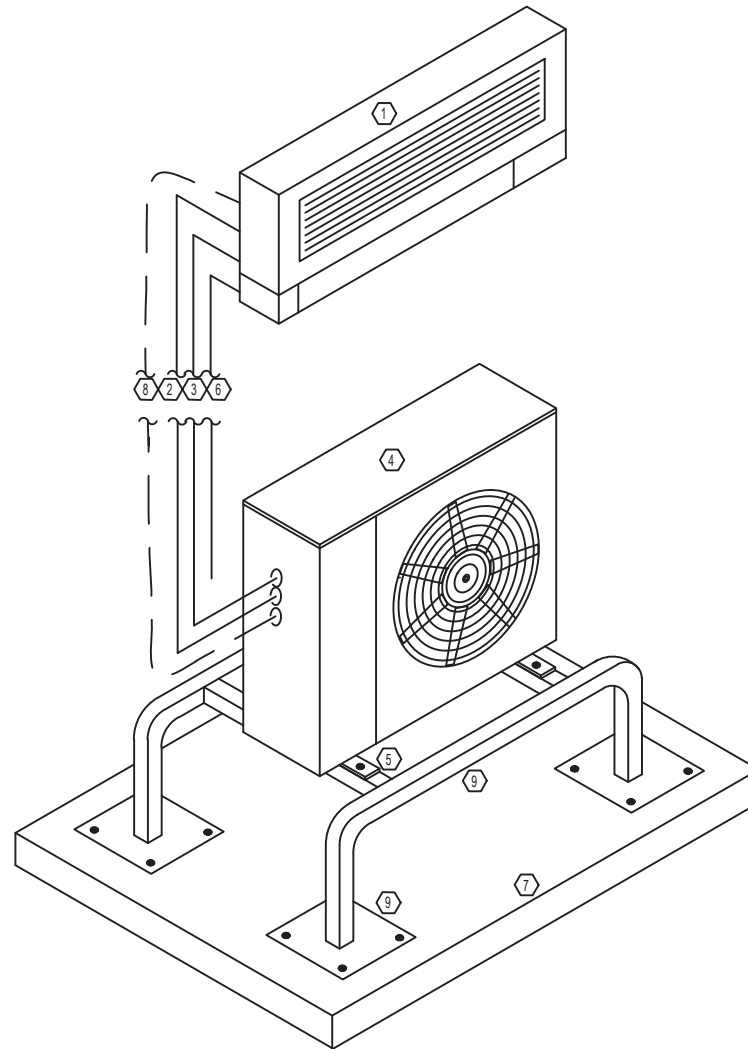

FAN COIL UNIT (TYP). WALL MOUNT SHOWN
SUPPORT AND SPACE AS NECESSARY FOR REFRIGERANT AND
CONDENSATE PIPING CONNECTIONS.

REFRIGERANT LIQUID LINE (TYPE L DRAWN TEMPER COPPER
WITH ELASTOMERIC INSULATION)

CONDENSING UNIT

CONDENSING UNIT ANCHOR POINT
(ANCHOR TO EQUIPMENT STAND TYP 4)



INSULATED CONDENSATE DRAIN LINE. 12" AFG

CONCRETE EQUIPMENT PAD

CONTROL WIRING/POWER WIRING TO EVAPORATOR

HEAT PUMP STAND (MIN 16" AFG)
ANCHOR TO CONCRETE PAD (TYP 16)

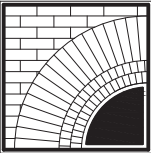
2 HIGHWALL DUCTLESS SPLIT SYSTEM DETAIL (ACCU-2, FC-2)
H003 SCALE: NTS

BID SET: 12 APRIL 2021	
REVIEW SET: 18 DECEMBER 2020	
ISSUES and REVISIONS	
AND COPYRIGHTED PROPERTY OF BUTLER ROWLAND MAYS ARCHITECTS, LLP AND MAY NOT BE ALTERED, COPIED OR REPRODUCED BY ANY METHOD FOR ANY PURPOSE WITHOUT THE EXPRESS WRITTEN CONSENT OF BUTLER ROWLAND MAYS ARCHITECTS, LLP.	
	BUTLER ROWLAND MAYS ARCHITECTS, LLP
57 West High Street Ballston Spa New York 12020	PH: 518 ¥ 885 ¥ 1255 FAX: 518 ¥ 885 ¥ 1266 www.brmarshitects.com
	
SAGE ENGINEERING ASSOCIATES, LLP 9 COLUMBIA CIRCLE ALBANY, NY 12203 (518)453-6091 FAX(518)453-6092	
Second Floor Community Room Renovation for the Josephine-Louise Public Library	
	
DWN. BY: SCALE: JOB NO.: DATE:	RWW AS NOTED 19.42.17 04.12.2021
DETAILS	
TITLE	
H003	
DWG. NO.	

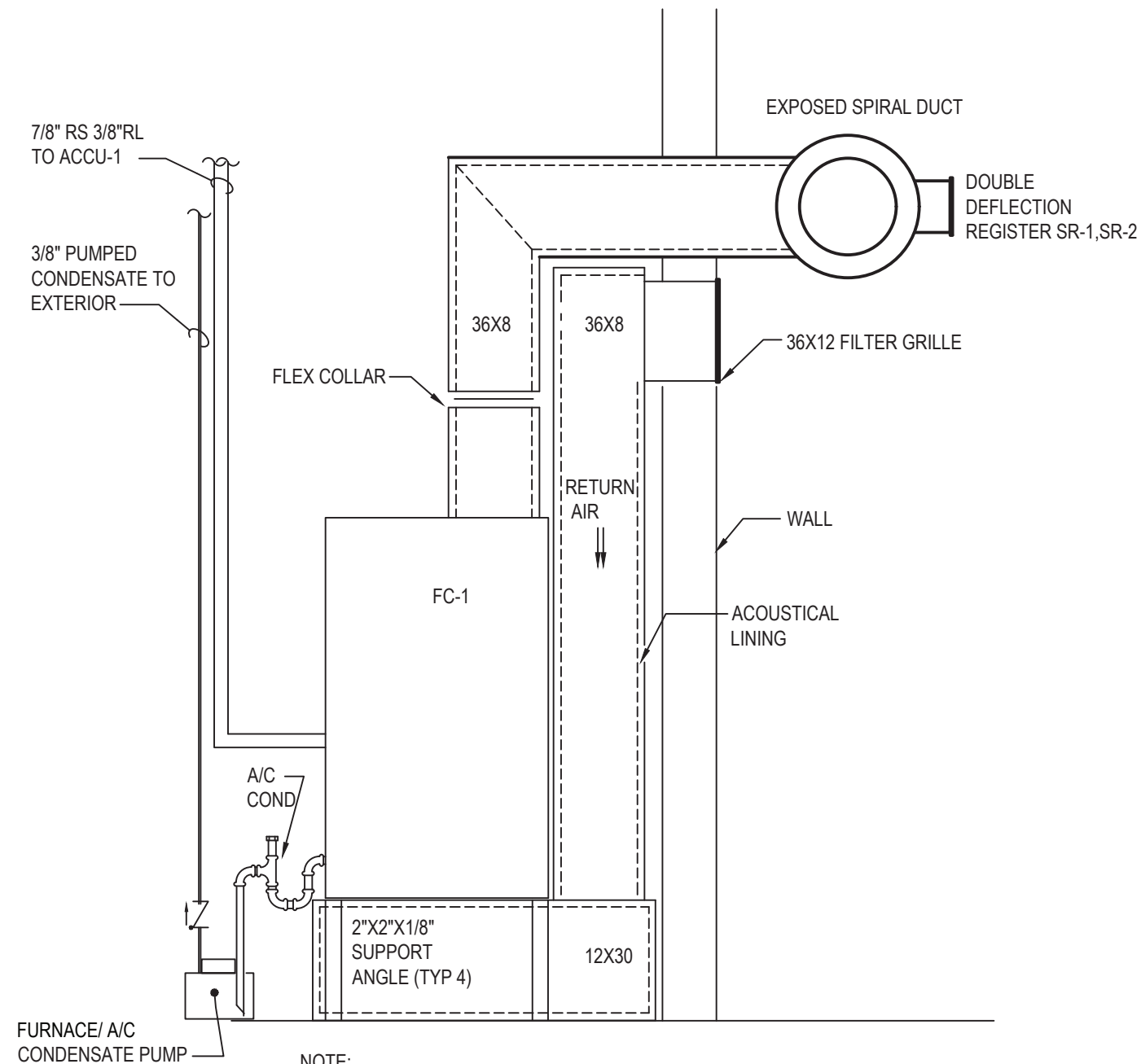

- NOTE:
1. ALL EQUIPMENT AND ACCESSORIES ARE TO BE IN MECHANICAL CLOSET SPACE
 2. EQUIVALENT DUCTWORK SIZES ARE ALLOWED.

1 FANCOIL DETAIL (FC-1)
H004 SCALE: NTS

BID SET: 12 APRIL 2021
REVIEW SET: 18 DECEMBER 2020
ISSUES and REVISIONS
AND COPYRIGHTED PROPERTY OF BUTLER ROWLAND MAYS ARCHITECTS, LLP AND MAY NOT BE ALTERED, COPIED OR REPRODUCED BY ANY METHOD FOR ANY PURPOSE WITHOUT THE EXPRESS WRITTEN CONSENT OF BUTLER ROWLAND MAYS ARCHITECTS, LLP.



**BUTLER
ROWLAND
MAYS**
ARCHITECTS, LLP

57 West High Street
Ballston Spa
New York 12020

PH: 518 ¥ 885 ¥ 1255
FAX: 518 ¥ 885 ¥ 1266
www.brmarshitects.com



**SAGE ENGINEERING
ASSOCIATES, LLP**

9 COLUMBIA CIRCLE
ALBANY, NY 12203
(518)453-6091 FAX(518)453-6092

Second Floor
Community Room
Renovation for the
**Josephine-Louise
Public Library**

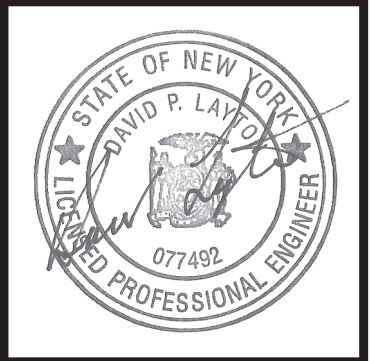

DWN. BY:	RWW
SCALE:	AS NOTED
JOB NO.:	19.42.17
DATE:	04.12.2021

DETAILS
TITLE
H004
DWG. NO.

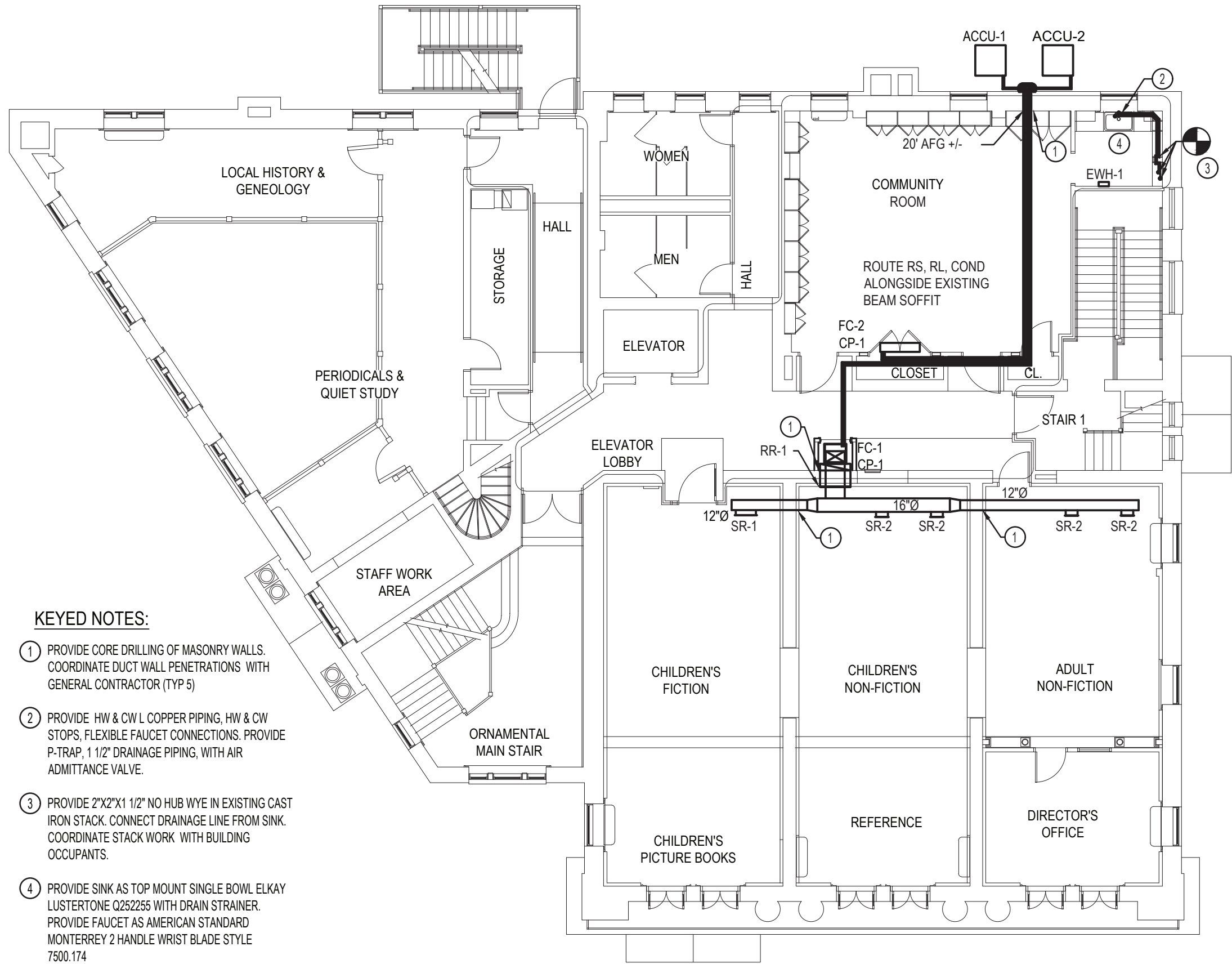

KEYED NOTES:

- 1 PROVIDE CORE DRILLING OF MASONRY WALLS. COORDINATE DUCT WALL PENETRATIONS WITH GENERAL CONTRACTOR (TYP 5)
- 2 PROVIDE HW & CW L COPPER PIPING, HW & CW STOPS, FLEXIBLE FAUCET CONNECTIONS. PROVIDE P-TRAP, 1 1/2" DRAINAGE PIPING, WITH AIR ADMITTANCE VALVE.
- 3 PROVIDE 2"x2"x1 1/2" NO HUB WYE IN EXISTING CAST IRON STACK. CONNECT DRAINAGE LINE FROM SINK. COORDINATE STACK WORK WITH BUILDING OCCUPANTS.
- 4 PROVIDE SINK AS TOP MOUNT SINGLE BOWL ELKAY LUSTERTONE Q252255 WITH DRAIN STRAINER. PROVIDE FAUCET AS AMERICAN STANDARD MONTERREY 2 HANDLE WRIST BLADE STYLE 7500.174

1 MECHANICAL SECOND FLOOR INSTALLATION PLAN
H101 SCALE: 3/32" = 1'-0"

BID SET: 12 APRIL 2021

REVIEW SET: 18 DECEMBER 2020

ISSUES and REVISIONS

AND COPYRIGHTED PROPERTY OF BUTLER ROWLAND MAYS ARCHITECTS, LLP AND MAY NOT BE ALTERED, COPIED OR REPRODUCED BY ANY METHOD FOR ANY PURPOSE WITHOUT THE EXPRESS WRITTEN CONSENT OF BUTLER ROWLAND MAYS ARCHITECTS, LLP.

BUTLER ROWLAND MAYS
ARCHITECTS, LLP

57 West High Street
Ballston Spa
New York 12020

PH: 518 ¥ 885 ¥ 1255
FAX: 518 ¥ 885 ¥ 1266
www.brmarshitects.com

SAGE ENGINEERING ASSOCIATES, LLP

9 COLUMBIA CIRCLE
ALBANY, NY 12203
(518)453-6091 FAX(518)453-6092

Second Floor
Community Room
Renovation for the

Josephine-Louise
Public Library

DWN. BY: RW
SCALE: AS NOTED
JOB NO.: 19.42.17
DATE: 04.12.2021

MECHANICAL SECOND FLOOR INSTALLATION PLAN

TITLE

H101

DWG. NO.

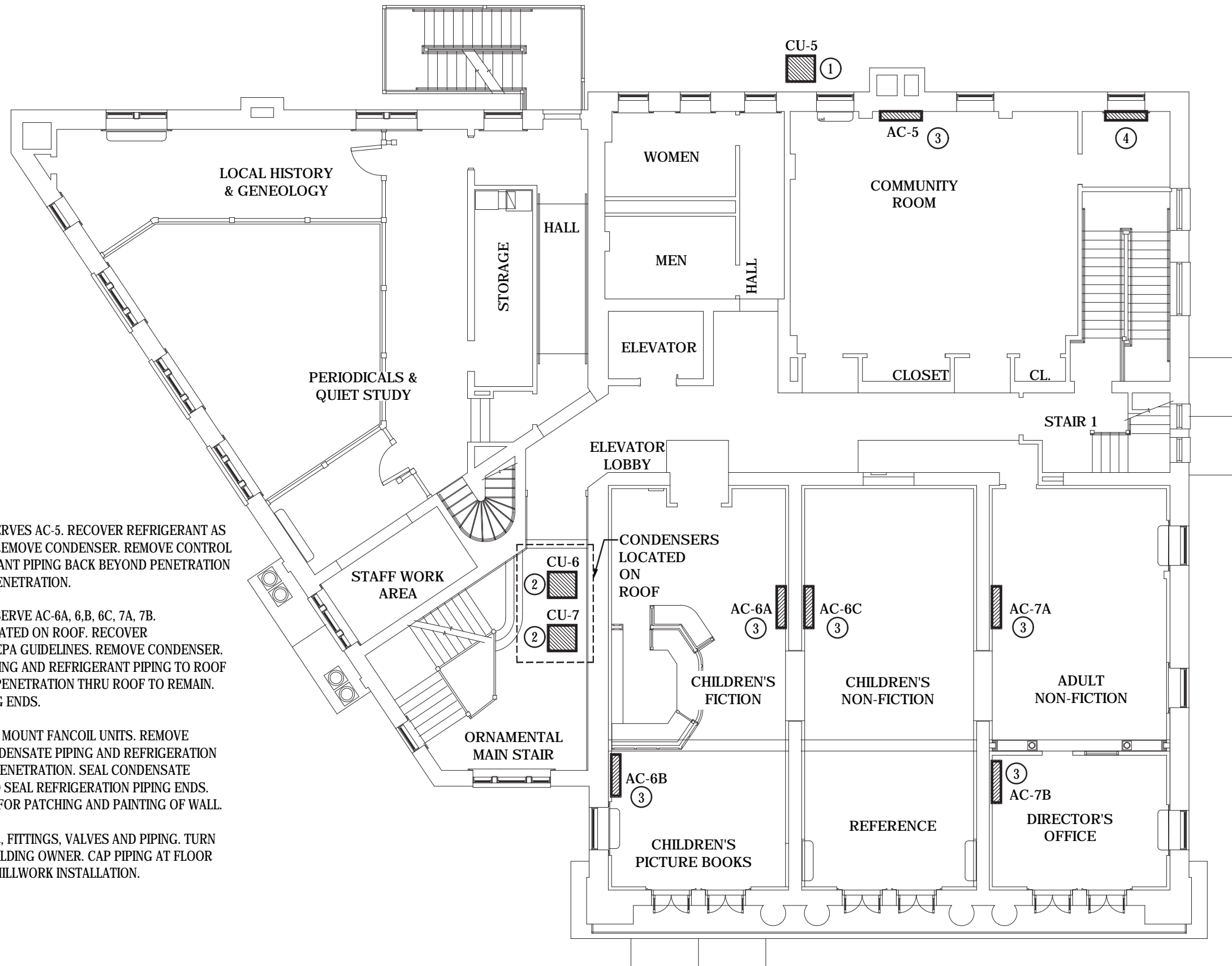

KEYED NOTES:

- 1 VERIFY CONDENSER SERVES AC-5. RECOVER REFRIGERANT AS PER EPA GUIDELINES. REMOVE CONDENSER. REMOVE CONTROL WIRING AND REFRIGERANT PIPING BACK BEYOND PENETRATION INTO BUILDING. SEAL PENETRATION.
- 2 VERIFY CONDENSERS SERVE AC-6A, 6,B, 6C, 7A, 7B. CONDENSERS ARE LOCATED ON ROOF. RECOVER REFRIGERANT AS PER EPA GUIDELINES. REMOVE CONDENSER. REMOVE CONTROL WIRING AND REFRIGERANT PIPING TO ROOF PENETRATION. PIPING PENETRATION THRU ROOF TO REMAIN. CRIMP AND SEAL PIPING ENDS.
- 3 REMOVE AC HIGH WALL MOUNT FANCOIL UNITS. REMOVE CONTROL WIRING, CONDENSATE PIPING AND REFRIGERATION PIPING BEYOND WALL PENETRATION. SEAL CONDENSATE PIPING END. CRIMP AND SEAL REFRIGERATION PIPING ENDS. COORDINATE WITH GC FOR PATCHING AND PAINTING OF WALL.
- 4 REMOVE LPS RADIATOR, FITTINGS, VALVES AND PIPING. TURN RADIATOR OVER TO BUILDING OWNER. CAP PIPING AT FLOOR LEVEL TO ALLOW FOR MILLWORK INSTALLATION.

BID SET: 12 APRIL 2021

REVIEW SET: 18 DECEMBER 2020

ISSUES and REVISIONS

AND COPYRIGHTED PROPERTY OF BUTLER ROWLAND MAYS ARCHITECTS, LLP AND MAY NOT BE ALTERED, COPIED OR REPRODUCED BY ANY METHOD FOR ANY PURPOSE WITHOUT THE EXPRESS WRITTEN CONSENT OF BUTLER ROWLAND MAYS ARCHITECTS, LLP.



**BUTLER
ROWLAND
MAYS**
ARCHITECTS, LLP

57 West High Street
Ballston Spa
New York 12020

PH: 518 Y 885 Y 1255
FAX: 518 Y 885 Y 1266
www.brmarcchitects.com



**SAGE ENGINEERING
ASSOCIATES, LLP**

9 COLUMBIA CIRCLE
ALBANY, NY 12203
(518)453-6091 FAX(518)453-6092

Second Floor
Community Room
Renovation for the

**Josephine-Louise
Public Library**



DWN. BY: RW
SCALE: AS NOTED
JOB NO.: 19.42.17
DATE: 04.12.2021

MECHANICAL SECOND
FLOOR REMOVAL PLAN

TITLE

HR001

DWG. NO.