

8/20/2015 10:39:06 AM NOT FOR CONSTRUCTION

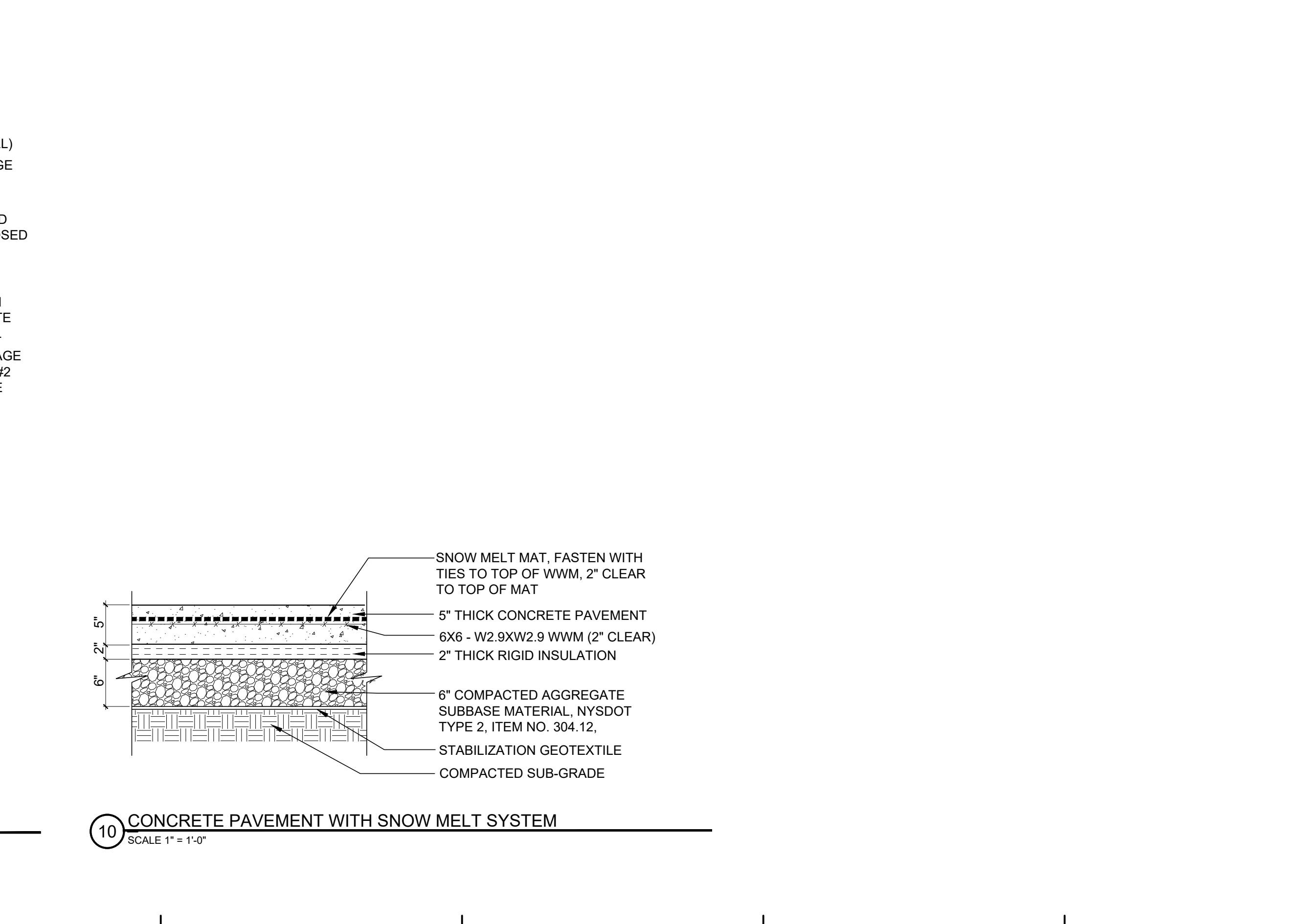
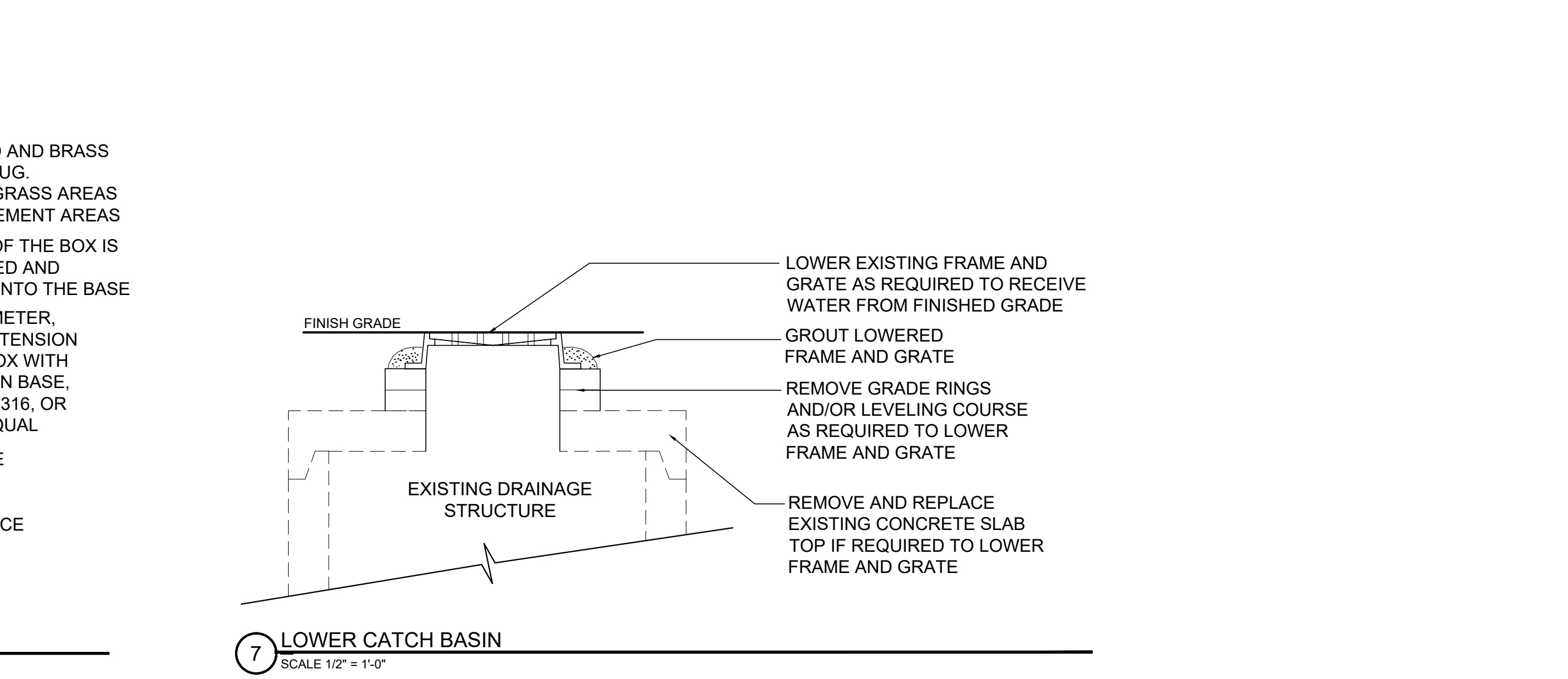
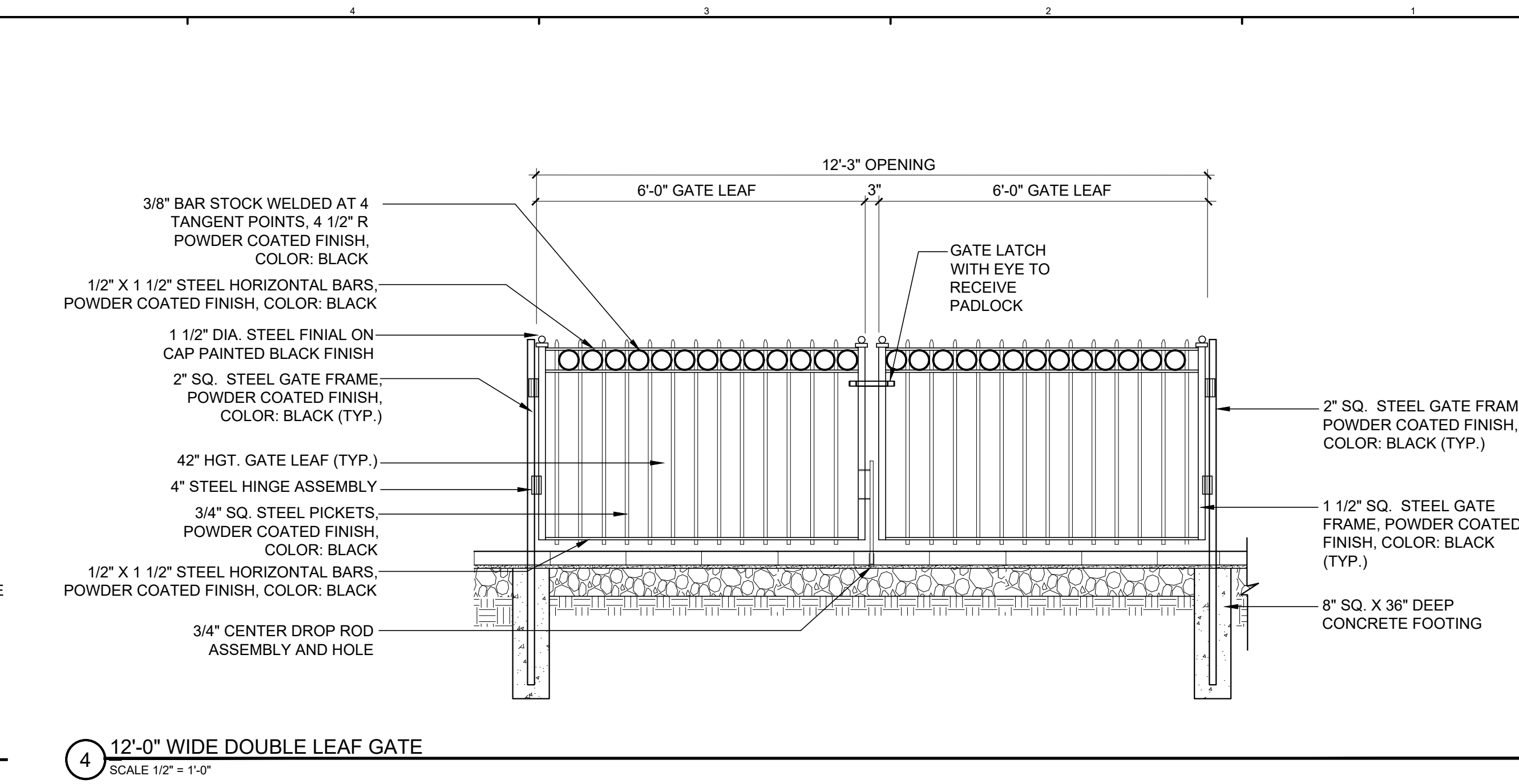
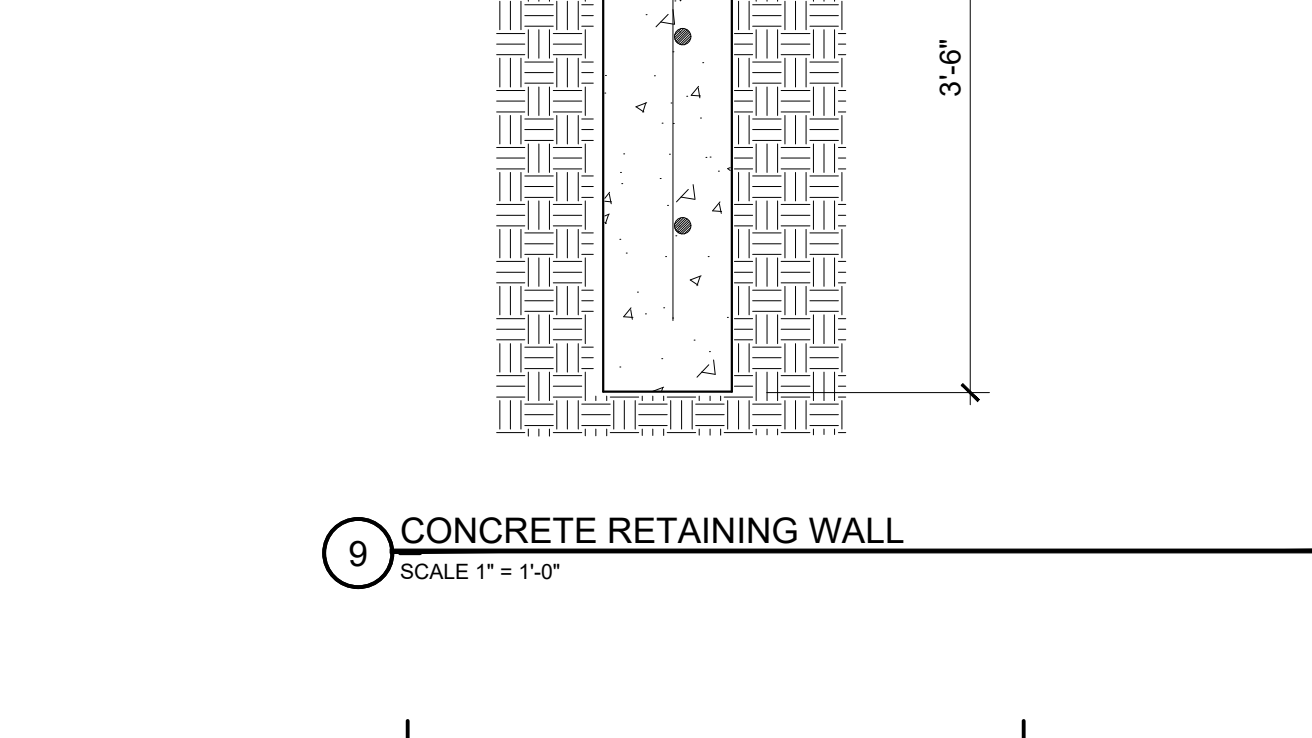
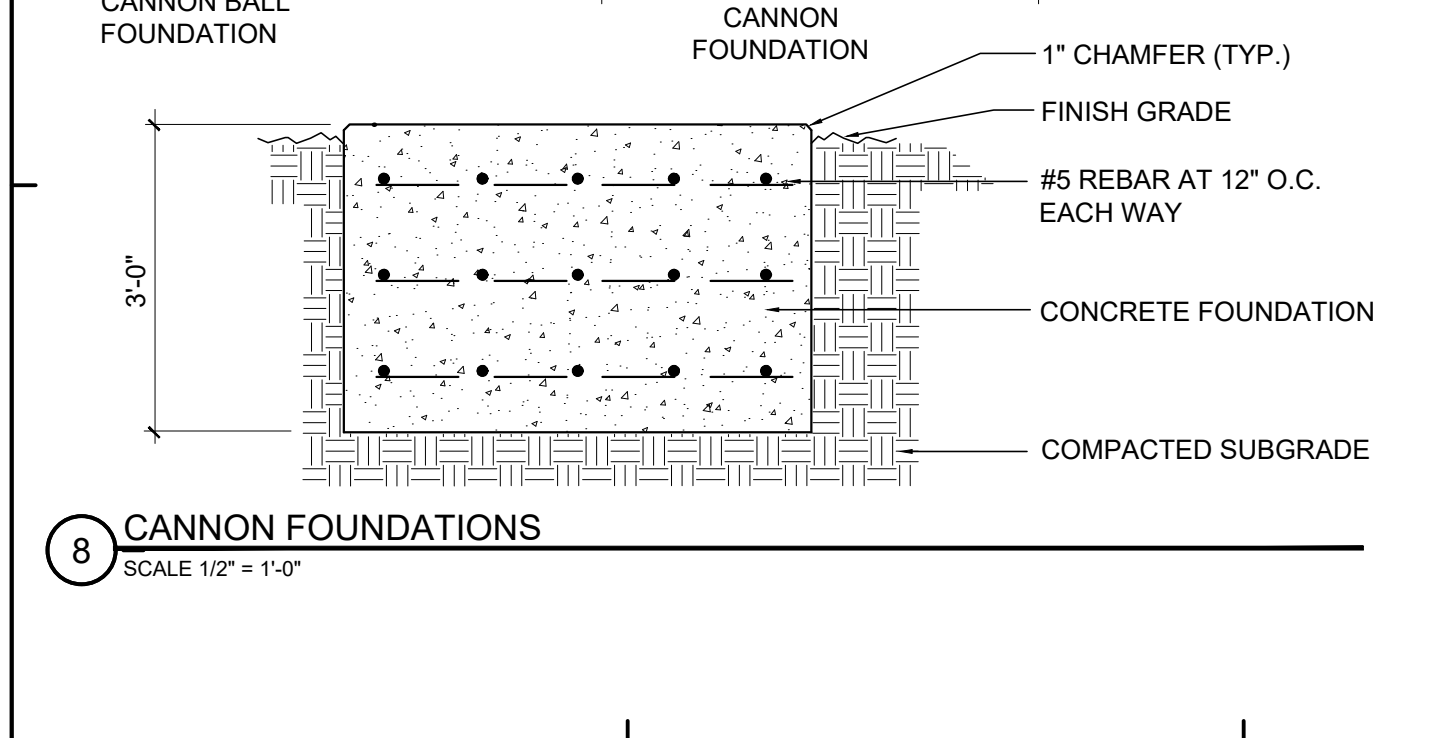
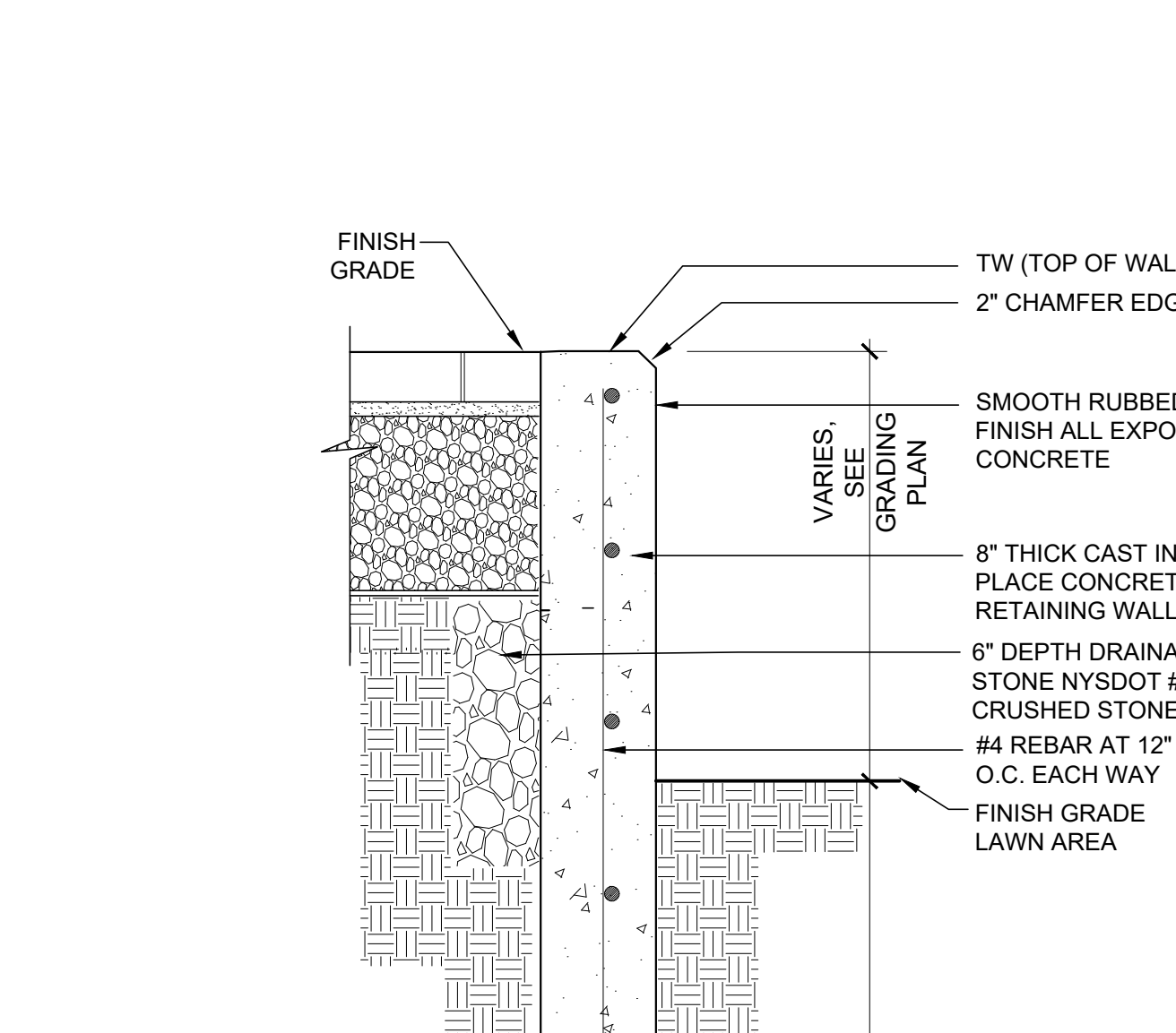
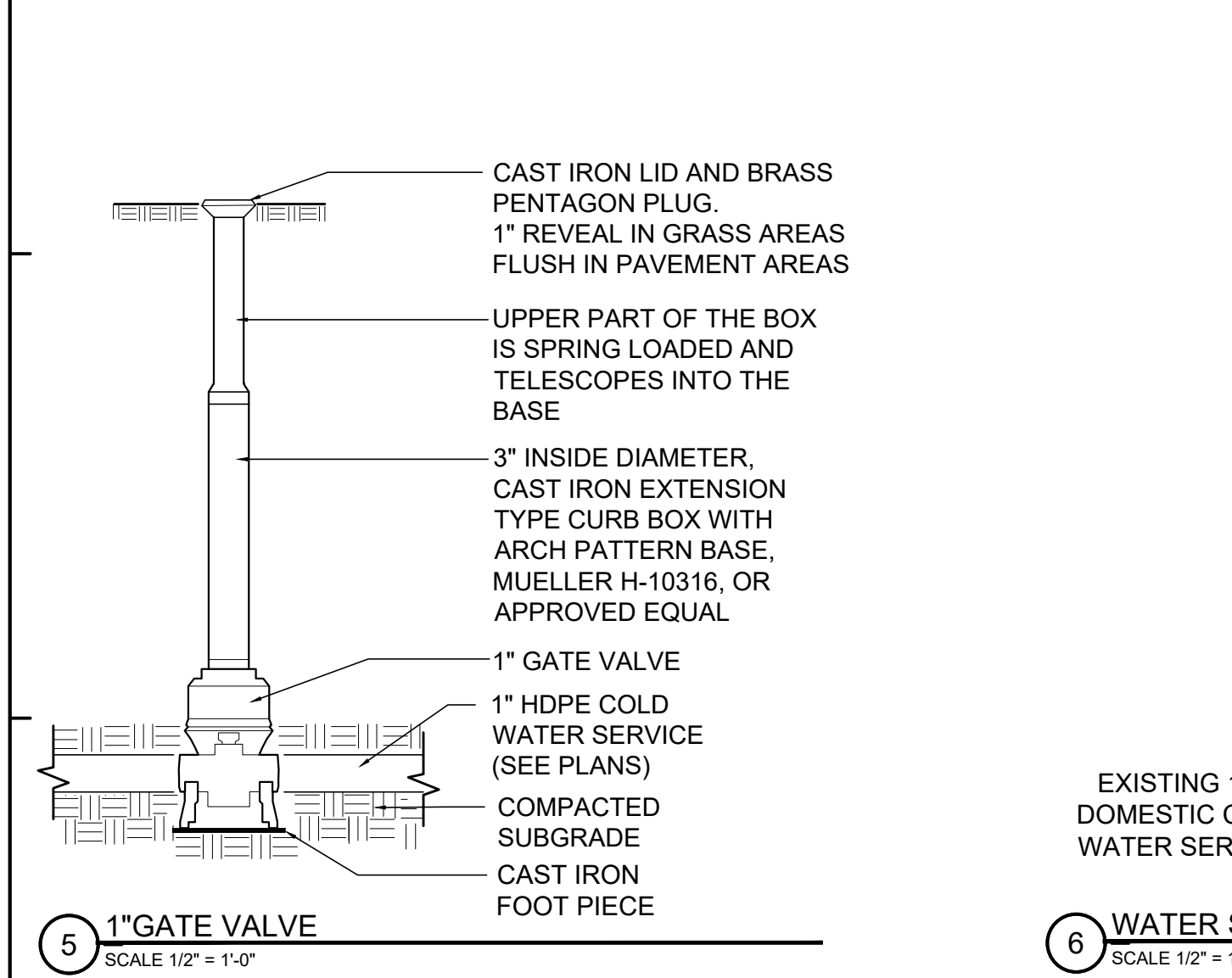
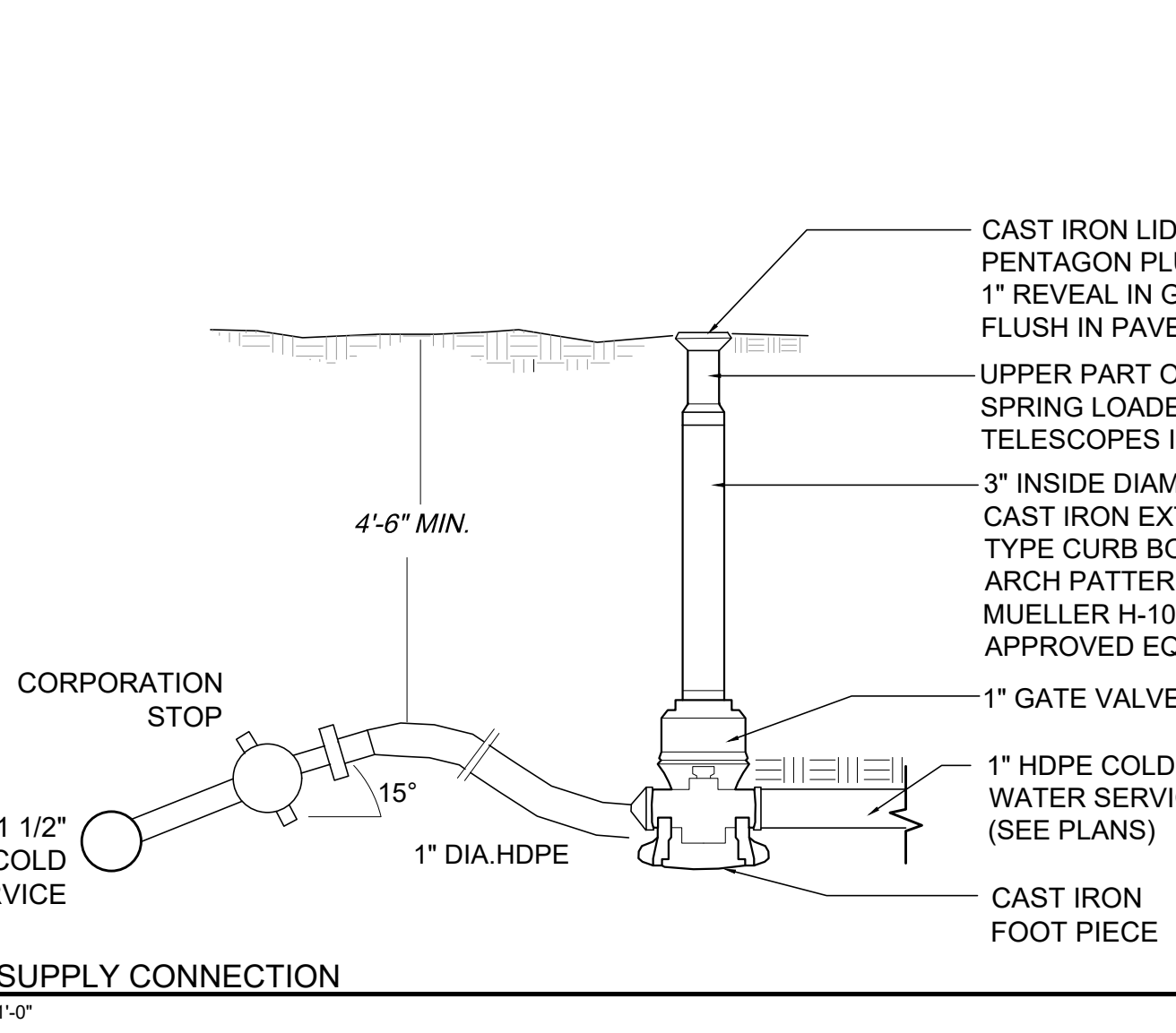
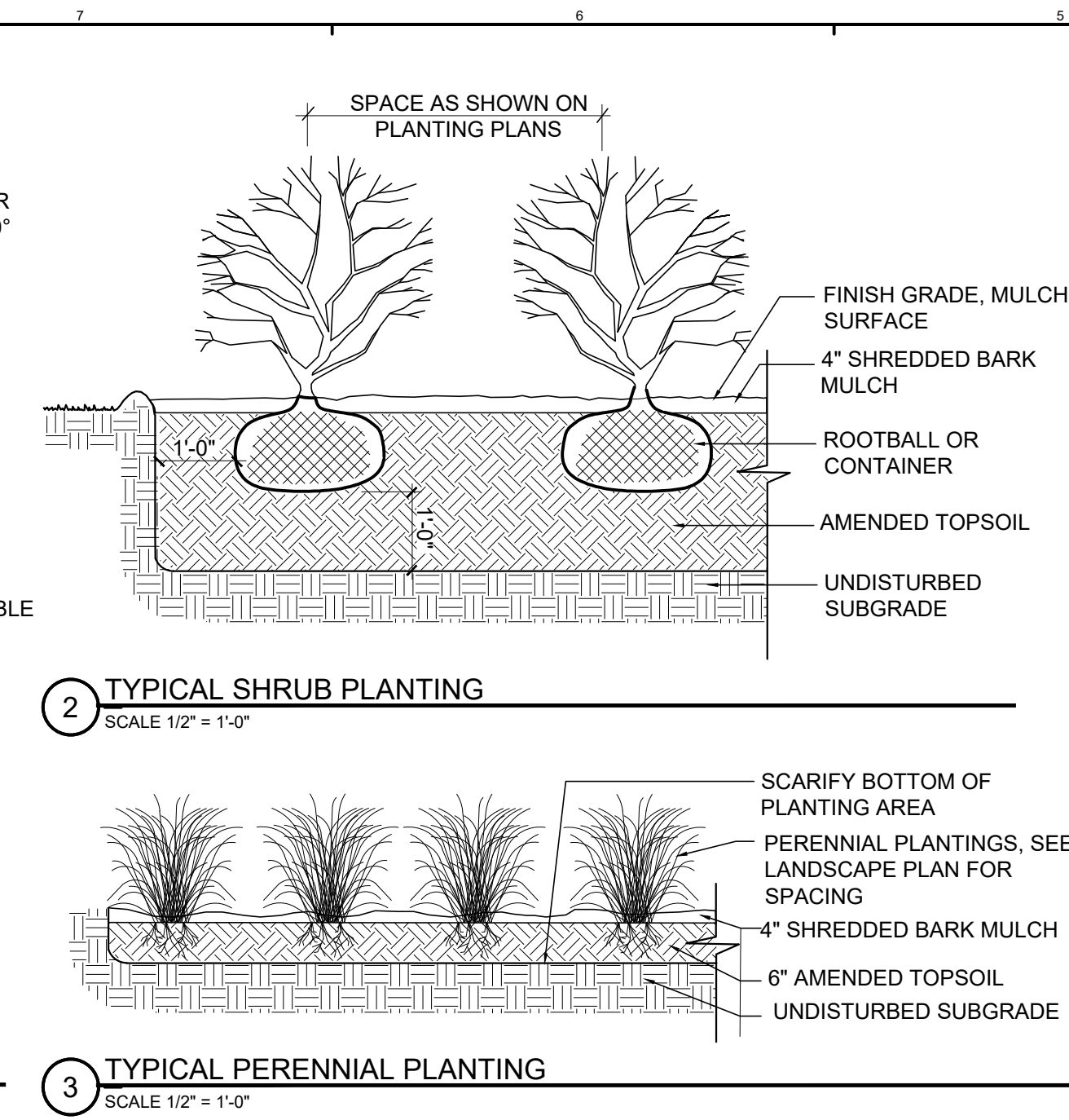
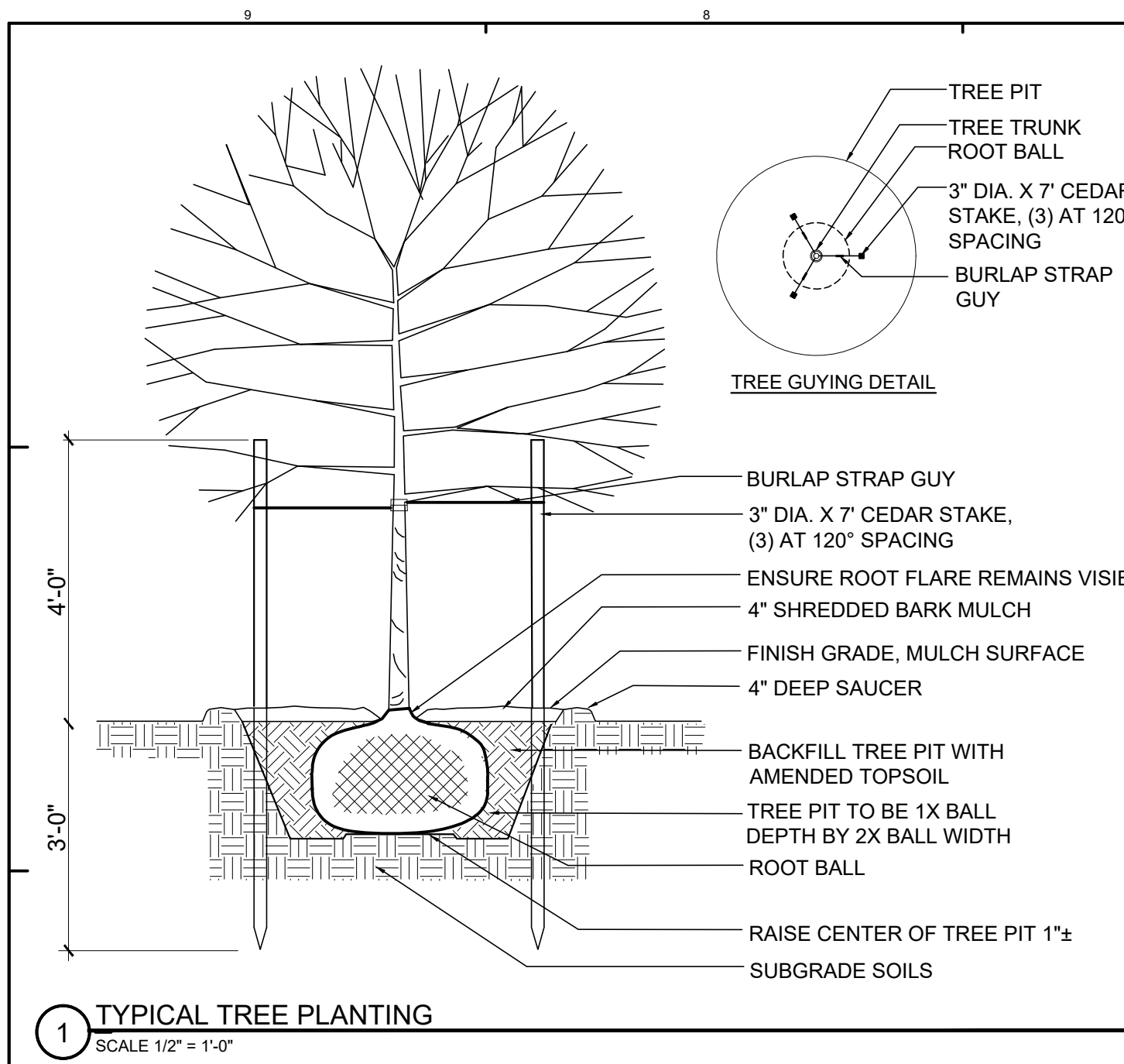

NEW YORK

STATE OF OPPORTUNITY.

Parks, Recreation and Historic Preservation

Governor Andrew M. Cuomo

Commissioner Erik Kulesseid

IT IS A VIOLATION OF STATE EDUCATION LAW FOR ANY PERSON, UNLESS UNDER THE DIRECTION OF A LICENSED ARCHITECT/ENGINEER TO ALTER THIS DOCUMENT IN ANYWAY. ALTERATIONS MUST HAVE THE SEAL AFFIXED ALONG WITH A DESCRIPTION OF THE ALTERATIONS, DATE AND ARCHITECT'S/ENGINEER'S SIGNATURE. COPYRIGHT © 2021

Architect:

SARATOGA ASSOCIATES  
21 CONGRESS STREET, SUITE 201  
SARATOGA SPRINGS, NY 12866

Engineer:

BARTON & LOGUIDICE  
443 ELECTRONICS PARKWAY  
LIVERPOOL, NY 13088

Exhibit Designer:

AMAZE DESIGN  
PO BOX 51905  
BOSTON, MA 02205-9751

**NYS OPRHP Taconic Region**  
9 Old Post Rd, PO Box 308  
Staatsburg, New York 12580  
(845) 889-4100  
Regional Director: Linda Cooper  
District Manager: Garrett Jobson

**Project Title:**  
Philipse Manor Hall State Historic Site:  
Construction of Elevator/Restroom  
Addition, Interior and Exterior  
Rehabilitation and Site Enhancements

**Project Location:**  
29 Warburton Ave, Yonkers, NY 10701

**Key Plan**

Rev No	Description	Date
1		
2		
3		
4		
5		
6		
7		

Drawn By:  
ELG

Design By:  
ELG

Checked By:  
RJM

Approved By:  
DFM

Date:  
05/28/2021

Seal and Signature

**Sheet Title:**  
Site Details

**Bid Documents**

Project Number:  
18006.47

**Drawing Number:**  
**L602**

Sheet: