

H
G
F
E
D
C
B
A

6/4/2021 8:15:27 AM

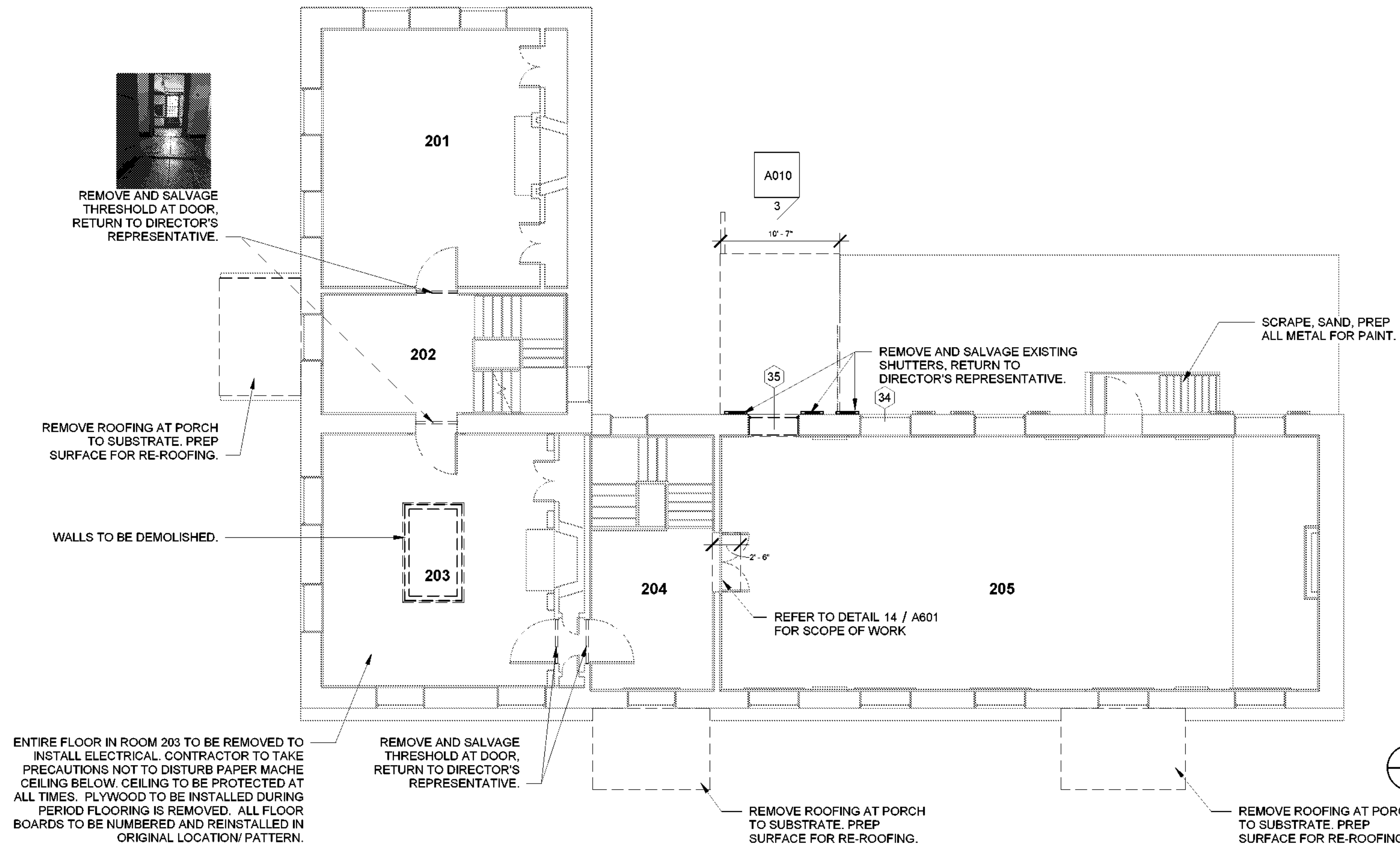

2 SECOND FLOOR DEMOLITION PLAN
1/8" = 1'-0"

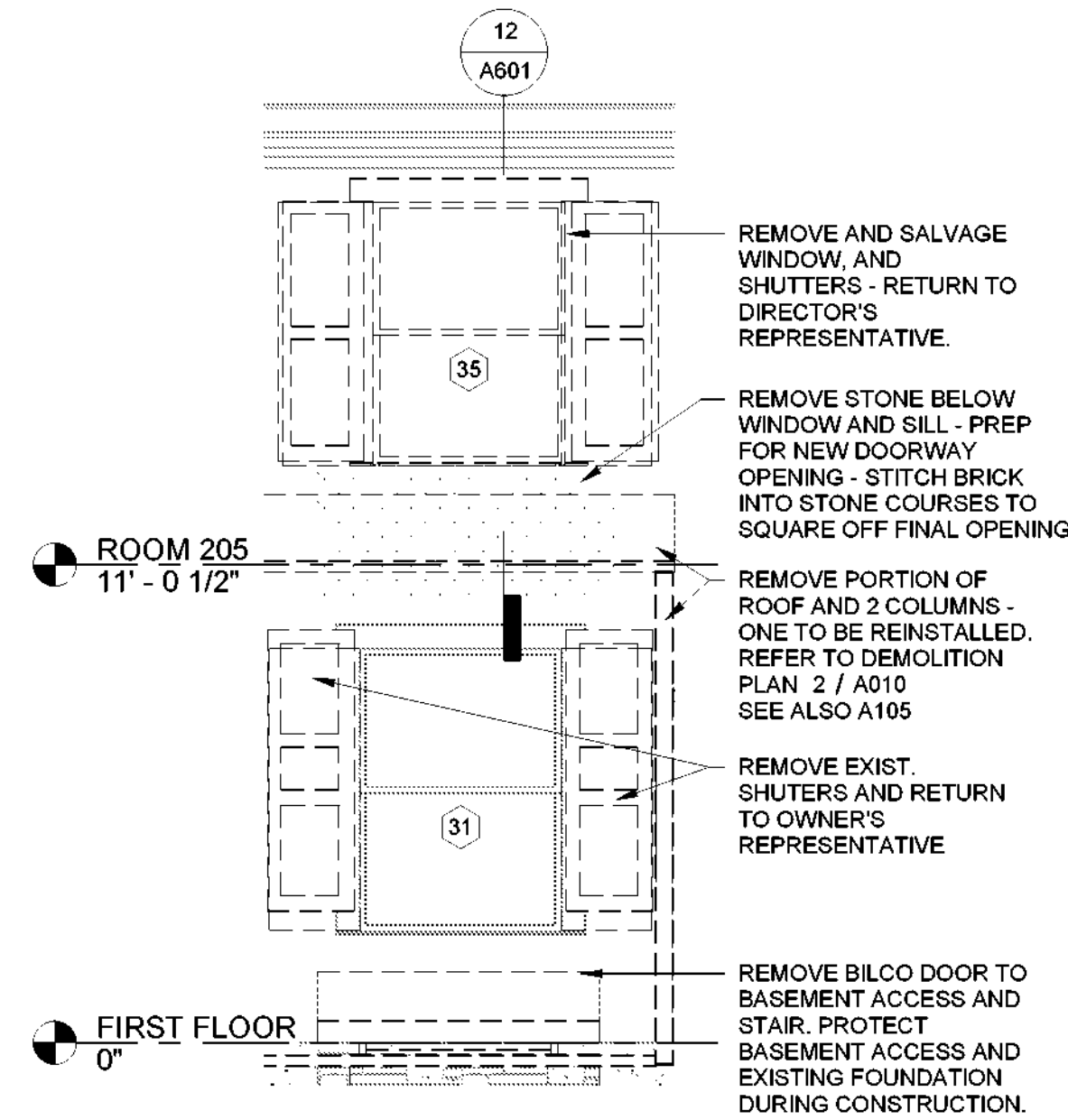

3 ELEVATION AT WINDOW 35 & 31 - DEMOLITION
1/4" = 1'-0"

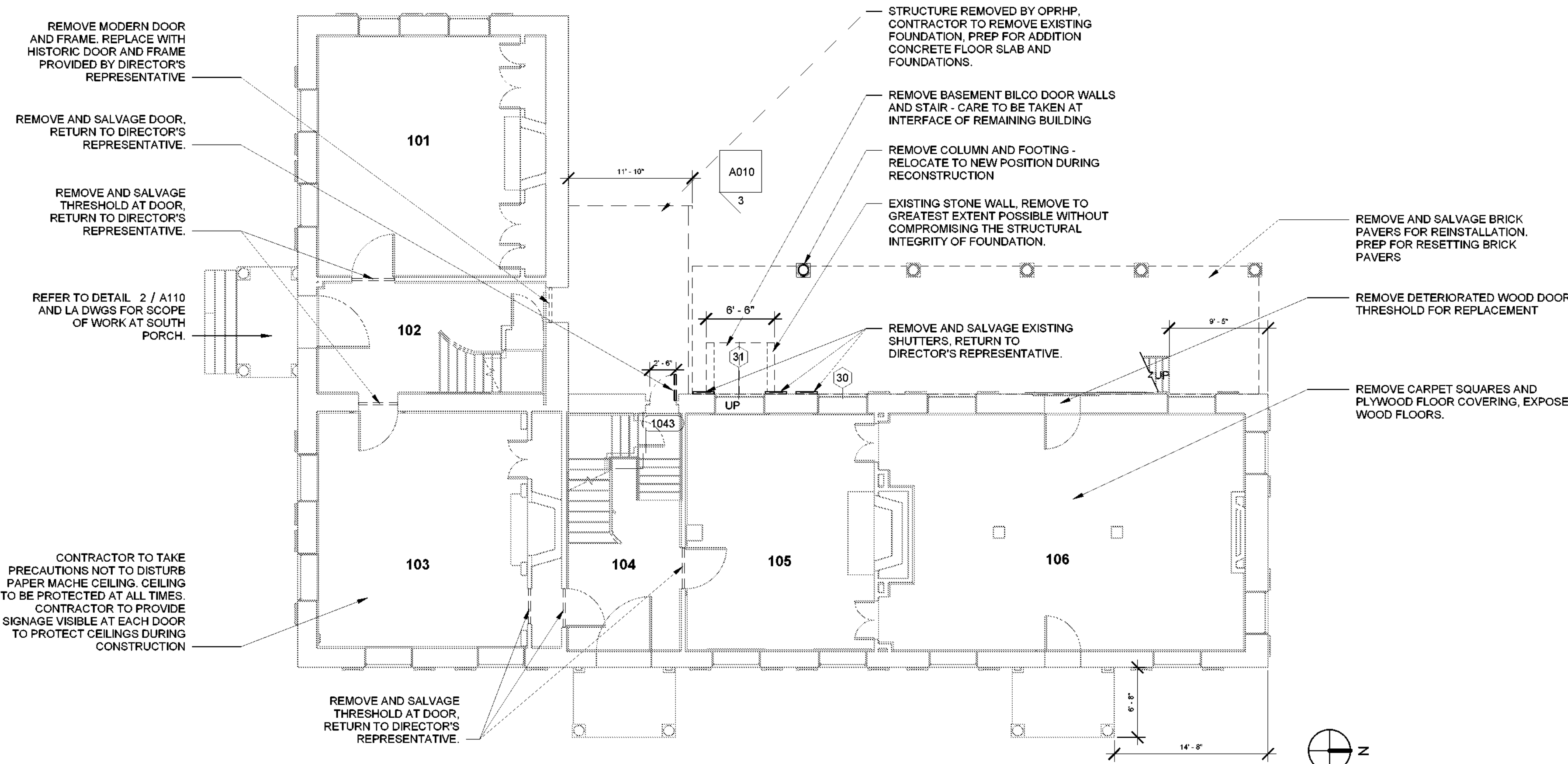

1 FIRST FLOOR DEMOLITION PLAN
1/8" = 1'-0"

GENERAL DEMOLITION NOTES:

1. PROTECT HISTORIC BUILDING FABRIC DURING DEMOLITION
2. SALVAGE HISTORIC MASONRY WALL MATERIAL (STONE), STORE ON PALLET FOR DIRECTOR'S REPRESENTATIVE.
3. PHOTOGRAPH DEMOLITION PROCESS.
4. NO POWER EQUIPMENT TO BE USED ON MANOR STONEMWORK REMOVAL - ONLY PNEUMATIC CHISELS, HAND TOOLS ONLY TO REMOVE MORTAR.
5. STONES TO BE REMOVED INTACT.
6. REMOVE AND SALVAGE DOORS INDICATED TO BE REMOVED. RETURN SALVAGED DOORS TO DIRECTOR'S REPRESENTATIVE.

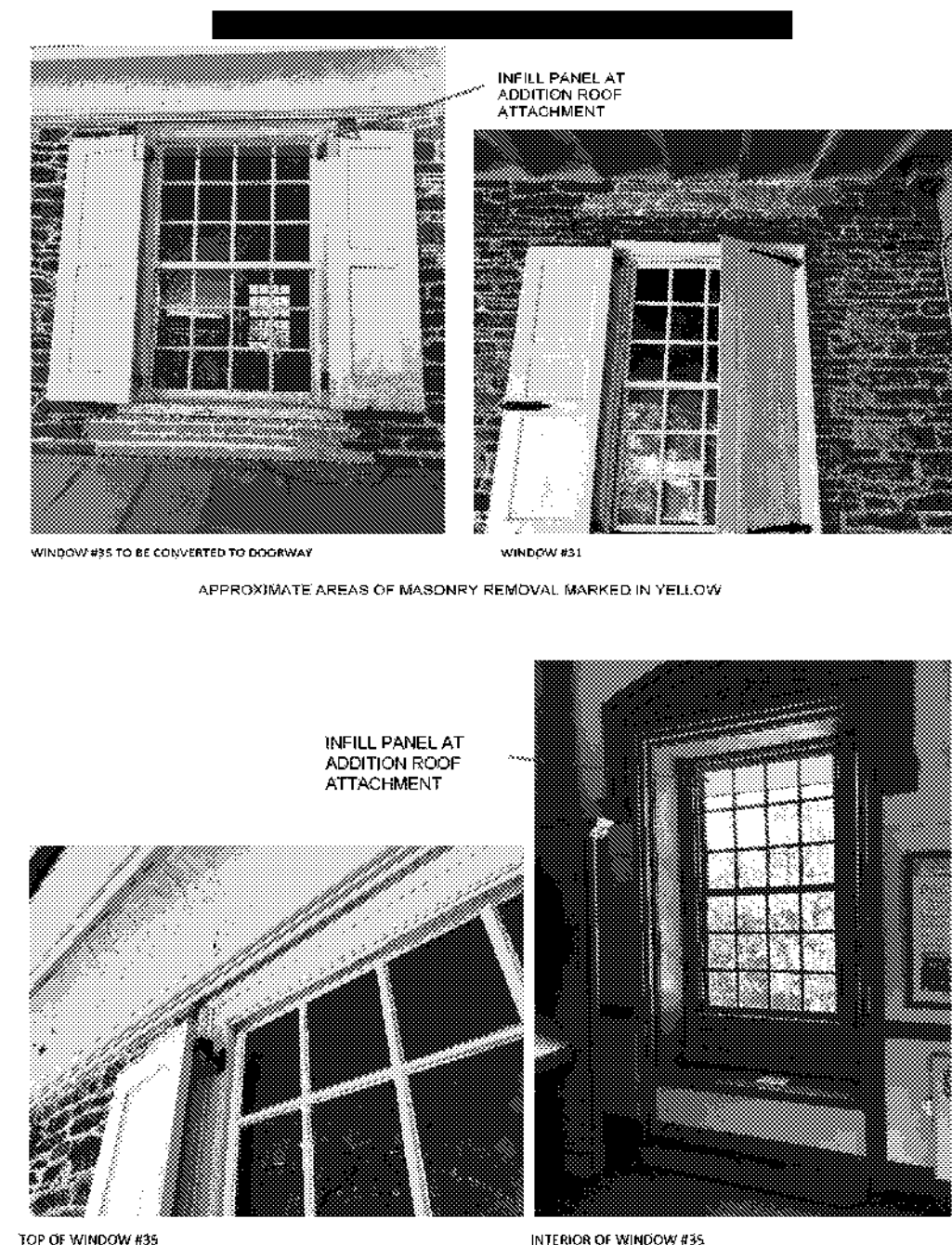

NEW YORK
STATE OF
OPPORTUNITY.

**Parks, Recreation
and Historic Preservation**

Governor Andrew M. Cuomo

Commissioner Erik Kulesseid

Architect:
Saratoga Associates
21 Congress Street, Suite 201
Saratoga Springs, NY 12866

Engineer:
Barton and Loguidice
443 Electronics Parkway
Liverpool, NY 13088

Exhibit Designer:
AMAZE DESIGN
PO Box 51905
Boston, MA 02205-9761

SARATOGA ASSOCIATES
Landscape Architects, Architects,
Engineers, and Planners, P.C.

Barton & Loguidice

amaze DESIGN

NYS OPRHP Taconic Region
9 Old Post Rd, PO Box 308
Staatsburg, New York 12580
(845) 889-4100
Regional Director: Linda Cooper
District Manager: Garrett Jobson

Project Title:
Philipse Manor Hall State Historic Site
Construction of Elevator/Restroom
Addition, Interior and
Exterior Rehabilitation and Site
Enhancements

Project Location:
29 Warburton Ave, Yonkers, NY 10701

Key Plan

REVISIONS		
Rev No	Description	Date

Drawn By:
KET

Design By:
EDW

Checked By:
CTS

Approved By:
DFM

Date:
5/28/2021

Seal and Signature

Sheet Title:
MANOR
DEMOLITION
PLANS

Drawing Number:
A010

Bid Documents

Project Number:
18006.47

Sheet: