

**GENERAL NOTES:**

- A. REFER TO ONE-LINE DIAGRAM FOR ADDITIONAL INFORMATION AND REQUIREMENTS.
- B. ALL CONDUITS BENEATH AREA OF VEHICULAR TRAFFIC SHALL BE RIGID METAL CONDUIT (RMC); RMC SHALL EXTEND A MINIMUM OF 24" BEYOND THE AREA OF VEHICULAR TRAFFIC. REFER TO TYPICAL DUCTBANK SECTION DETAIL.
- C. UNLESS OTHERWISE NOTED, ALL CONDUITS NOT BENEATH AREAS OF VEHICULAR TRAFFIC SHALL BE SCHEDULE 80 RIGID NONMETALLIC CONDUIT (DIRECT BURIED). REFER TO TYPICAL DIRECT BURIED CONDUIT DETAIL.
- D. PROVIDE FIRESTOPPING AND WATERPROOF SEALS AS REQUIRED WHERE PENETRATING EXTERIOR WALLS.
- E. CIRCUIT ALL SITE LIGHTING TO PANEL 'PB-1' USING (2)\*10, (1)\*10G, 1" C. UNLESS OTHERWISE NOTED.
- F. NEW SITE LIGHTING TO BE TIED INTO BMS CONTROLS FOR LIGHTING CONTROL.
- G. THE EC SHALL BE RESPONSIBLE FOR CONDUIT AND WIRING TO LIGHTS, LIGHTS, POLES AND POLE BASES ARE BY OTHERS.

**DRAWING NOTES:**

- ① PROVIDE ELECTRICAL CONDUIT RISER AT EXISTING UTILITY POLE FOR NEW PRIMARY SERVICE CONDUCTORS. SEE UTILITY POLE CONDUIT RISER DIAGRAM.
- ② SEE ONE-LINE DIAGRAM FOR DETAILS AND REQUIREMENTS.
- ③ PROVIDE FIRE ALARM CONNECTIONS TO (3) TAMPER SWITCHES IN SPRINKLER SYSTEM HOT BOX. COORDINATE CONNECTIONS WITH PLUMBING CONTRACTOR.
- ④ PROVIDE UTILITY TRANSFORMER PAD. REFER TO UTILITY TRANSFORMER PAD DETAIL FOR REQUIREMENTS.
- ⑤ PROVIDE GENERATOR AND CONCRETE PAD. REFER TO ONE-LINE DIAGRAM AND DETAILS FOR ADDITIONAL INFORMATION AND REQUIREMENTS.
- ⑥ PROVIDE DEDICATED HANDHOLE FOR FIRE ALARM WIRING. PROVIDE (1)1" CONDUIT FROM MAIN ELECTRICAL ROOM TO SPRINKLER SYSTEM HOT BOX.
- ⑦ PROVIDE DEDICATED HANDHOLE FOR POWER.
- ⑧ PROVIDE (2)\*2 & (1)\*2G AND (2)\*10 & (1)\*10G IN 2" CONDUIT.
- ⑨ PROVIDE (2)\*2 & (1)\*2G IN 1-1/4" CONDUIT.
- ⑩ PROVIDE (2) 3" CONDUITS FOR TELE/DATA AND CATV SERVICES; CABLES BY OTHERS. COORDINATE WITH SERVICE PROVIDER(S). TERMINATE EACH CONDUIT IN DEMARK ENCLOSURES WITHIN BASEMENT ELECTRICAL ROOM, SHOWN ON DETAIL 1/E401.

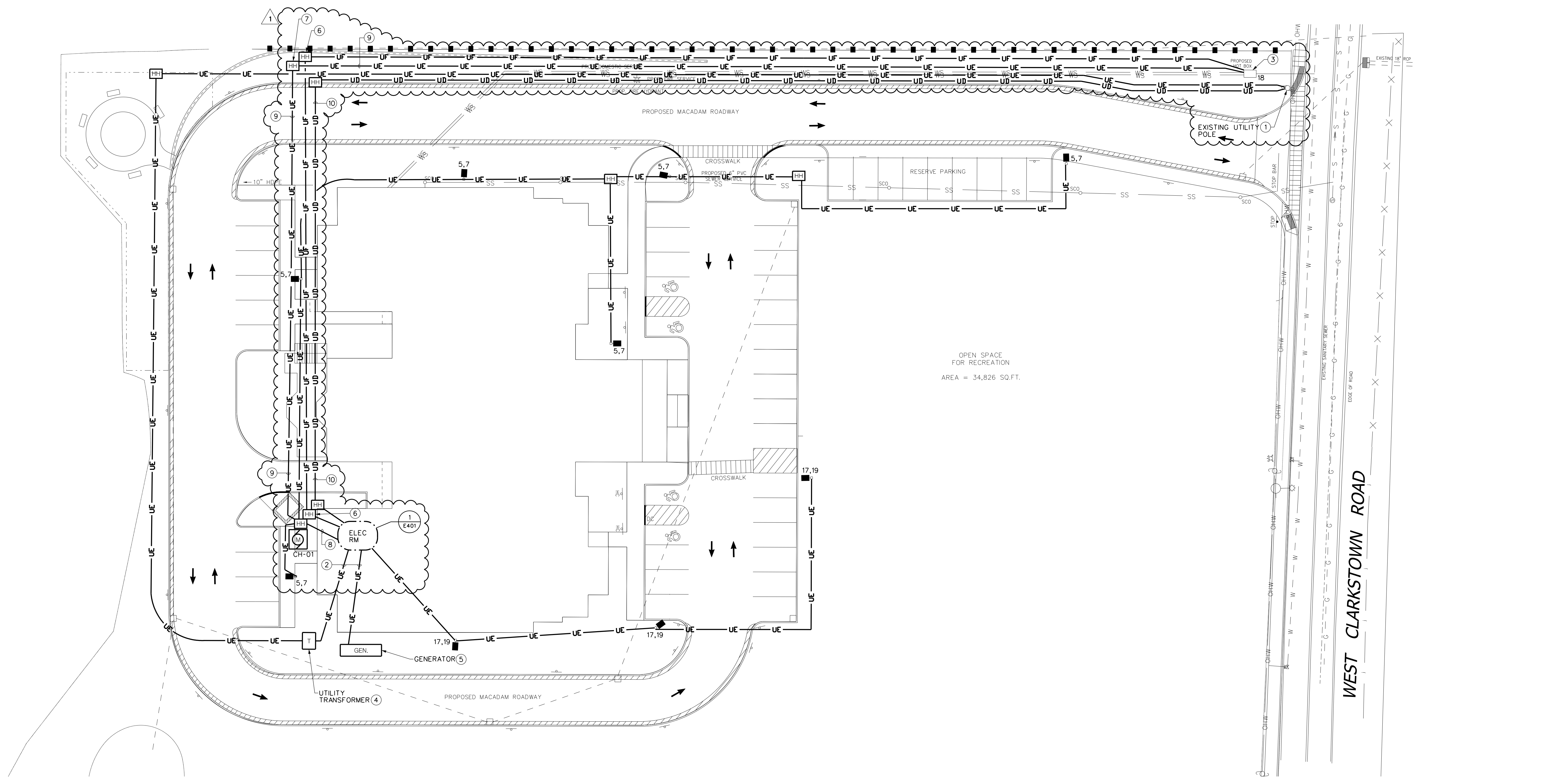

1 ELECTRICAL SITE PLAN  
 E001 SCALE: 1"=20'-0"

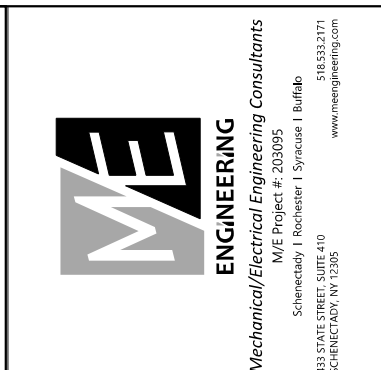

DATE: 9/18/2020  
 REVISION: 10/23/2020  
 AUGENDAM 1

PROJECT NO: 202005  
 DESIGNED BY: CUE  
 DRAWN BY: CUE  
 CHECKED BY: RSA  
 SCALE: AS NOTED  
 NOTES:

**ELECTRICAL SITE PLAN**

**HARRIS A. SANDERS ARCHITECTS, P.C.**  
 252 WASHINGTON AVENUE, ALBANY, NEW YORK 12210

**L'DOR ADULT CARE FACILITY**  
 156 WEST CLARKSTOWN ROAD  
 NEW CITY, N.Y. 10956

SET 9  
**E001**