

SCHEDULE OF EXPANSION TANK				
MARK	MODEL No. ①	TANK VOLUME GALS.	ACCEPTANCE VOLUME GALS.	REMARKS
①	B-800	211	211	REFER TO ②③
NOTES ① AS MANUFACTURED BY "BELL & GOSSETT". ② INSTALL PER MANUFACTURER'S RECOMMENDATIONS. ③ VERTICAL MOUNTING 125PSI ASME TANK, DIMENSIONS 30"x82"H / 2300LBS.				



SCHEDULE OF PUMPS										
MARK	SERVICE	LOCATION	MODEL No. ①	GPM	HEAD FT. H ₂ O	RPM	MOTOR HP	ELECTRIC SERVICE	PHYSICAL DATA LxWxH (IN.) WEIGHT (LBS.)	REMARKS
①	HEATING LOOP	MECHANICAL	SERIES E-1510 3BD ES ②	400	80	1800	10	208/3/60	42X18X24 600	REFER TO ②③
②	HEATING LOOP									
NOTES ① AS MANUFACTURED BY "BELL & GOSSETT". ② INSTALL PUMPS PER MANUFACTURER'S RECOMMENDATIONS. ③ PROVIDE WALL MOUNTED VFD'S.										

SCHEDULE OF BOILERS									
BOILER DATA			BURNER DATA		ELECTRICAL			REMARKS	
MARK	LOCATION	MODEL N ^o ①	INPUT (MBH)	OUTPUT (MBH)	FUEL	SERVICE	MCA		
①	BOILER ROOM	ENDURA EDR-2500	2500	2420	GAS	208/3/60	29	REFER TO ②③④⑤	
NOTES	① AS MANUFACTURED BY "FULTON". BURNER INTEGRAL TO BOILER. HOT WATER BASED ON 140°F E.W.T., 160°F L.W.T.				② PROVIDE MANUFACTURER RECOMMENDED COMBUSTION AIR INTAKE AND EXHAUST VENT PIPING, VENT PIPE CONDENSATE DRAIN, HIGH/LOW LIMIT CONTROL, DUAL LOW WATER CUT OFFS, OUTDOOR AIR TEMPERATURE SENSOR KIT, MULTIPLE BOILER CONDENSATE NEUTRALIZER PACKAGE, VENT PIPING PER THIS MANUFACTURER AL-29-4C OR 316L, BACHNET CONTROLS, DISCONNECT SWITCH, LEAD LAG CONTROLS, MOTORIZED ISOLATION VALVES, BOILER PUMP START/STOP SIGNAL, VENTLESS GAS TRAIN, MODSIGN CONTROL PANEL.				
	③ INSTALL PER MANUFACTURER'S RECOMMENDATIONS.								
	④ BOILER INSTALLATION SHALL CONFORM TO ALL REQUIREMENTS OF INSURANCE UNDERWRITER, NFPA AND ALL AUTHORITIES HAVING JURISDICTION. BOILERS SHALL BE FULLY FIELD COMMISSIONED BY AUTHORIZED TECHNICIAN FOR THE TYPE OF GAS FIRED (LPG OR NG). IF THE TYPE OF GAS IS CHANGED AFTER STARTUP, THE BOILERS SHALL BE FULLY RE-COMMISSIONED BY AUTHORIZED TECHNICIAN.								

SCHEDULE OF AIR HANDLING UNITS																											
GENERAL DATA				FAN DATA				HEATING COIL DATA ①				COOLING COIL DATA ②③				FILTER DATA		PHYSICAL DATA		ELECTRICAL DATA				CONDENSING UNIT		REMARKS	
MARK	SERVICE/LOCATION	MODEL NUMBER	QAI CFM MAX./MIN.	CFM	EXT. S.P. IN H ₂ O	FAN RPM	MOTOR HP	TOTAL CAP. MBH	ENT. AIR TEMP. DB °F	LVG. AIR TEMP. DB °F	GPM	TOTAL CAP. MBH	SENSIBLE CAP. MBH	ENT. AIR TEMP. DB/WB °F	LVG. AIR TEMP. DB/WB °F	QTY.	SIZE (IN.)	TYPE	WEIGHT (LBS.)	LxWxH (IN.)	FLA	MCA	MOP	SERVICE	MARK		
④	LIBRARY/CRAWL SPACE	HCA12	1200 400	1200	1.5	1724	1	64.33	55	103	5	41.61	28.53	80/67	58/56	1	16X32X4	MERV 13	250	44X38X18	7	8.8	15	208/1/60	④	LIBRARY	REFER TO ②③
④	LIBRARY/CRAWL SPACE																										
④	LIBRARY/CRAWL SPACE	HCA30	3000 1000	3000	2.0	1351	3	159.21	55	103	10	100.20	69.46	80/67	59/56	1	16X25X4	MERV 13	600	58X54X34	7.5	9.8	15	208/3/60			②③
NOTES	① AS MANUFACTURED BY "MAGICAIRE".																										
	② BASED ON A.R.I. CERTIFIED COIL SELECTIONS; REFRIGERANT R-410A, SEER 12.0																										
	③ INSTALL IN ACCORDANCE WITH MANUFACTURER'S RECOMMENDATIONS.																										
	④ PROVIDE FACTORY INSTALLED POWERED CONVENIENCE OUTLET, MOTORIZED DAMPERS, DISCONNECT SWITCH, HUMIDITY CONTROLS, MERV 13 FILTERS, DIRTY FILTER STATUS, 100% ECONOMIZER CONTROLS, NEMA 3R VFD.																										
⑤ DESIGN AIR CONDITIONS: SUMMER: OA (94°F/75°F) RA (77°F/65°F); WINTER: OA (5°F/3°F) RA (70°F/55°F).																											

SCHEDULE OF RETURN FANS											
MARK	SERVICE	LOCATION	TYPE	MODEL No. ①	CFM	EXT. S.P. IN H ₂ O	RPM	HP (WATTS)	ELECTRIC SERVICE	PHYSICAL DATA LxWxH WEIGHT	REMARKS
①	LIBRARY	CRAWL SPACE	IN-LINE	SQ-130HP-VG	1200	1.0	1929	3/4	208/1/60	24X21X21 78	REFER TO ②③
②	LIBRARY	CRAWL SPACE	IN-LINE								
③	LIBRARY	CRAWL SPACE	IN-LINE	SQ-160-VG	3000	1.5	1539	2	208/3/60	29X26X26 191	
<div>NOTES</div> <div>① AS MANUFACTURED BY "GREENHECK"</div> <div>② INSTALL PER MANUFACTURER'S RECOMMENDATIONS.</div> <div>③ PROVIDE FACTORY MOUNTED DISCONNECT SWITCH, MOTORIZED DAMPER, VFD WITH VFD RATED MOTOR, SCHEDULED CONTROLS, MOUNTING HARDWARE, SPRING ISOLATORS, COMPANION FLANGES, OUTLET GUARD, MOTOR COVER, NAME PLATE INDICATING MODEL, NO., CFM, STATIC PRESSURE, RPM, HP, AND ELECTRICAL SERVICE</div>											

SCHEDULE OF OUTDOOR CONDENSING UNITS													
GENERAL DATA			CAPACITY	PHYSICAL DATA			ELECTRICAL SUPPLY			EFFICIENCY		REMARKS	
MARK	SERVICE	MODEL No. ①	COOL/HEAT (MBH)	UNIT WEIGHT (POUNDS)	D	W	H	SERVICE	MCA	MOP	EER/SEER		
①	LIBRARY	ARUM192BTES	192 / 216	688	30	49	67	208/3/60	35.7	50	12.4 / 25.9	REFER TO ②③④⑤⑥⑦⑧	
②	DATA CLOSET	LSU120HSVS	12 / 13.6	80	14	34	22	208/1/60	10	15	12.5 / 22.7	REFER TO ②③④⑤⑥⑦⑧	
③	VESTIBULE	ARUN024GSS4	24 / 27	176	16	38	33	208/1/60	19.6	30	10.7 / 17.0	REFER TO ②③④⑤⑥⑦⑧	
NOTES ① AS MANUFACTURED BY "L.G.". ② BASED ON A.R.I. CERTIFIED COIL SELECTIONS; REFRIGERANT R-410A. ③ INSTALL ACCORDING TO MANUFACTURER'S RECOMMENDATIONS. ④ SECURE UNIT TO CONCRETE EQUIPMENT CONDENSING UNIT PADS ON GRADE. ⑤ DC INVERTER COMPRESSOR SPEED CONTROL BASED ON SYSTEM LOAD. ⑥ UNIT SHALL BE CONTROLLED VIA MANUFACTURER'S DDC NETWORK CONTROLLER TO INDOOR HARDWIRED CONTROLLER. ⑦ PROVIDE UNIT WITH SNOW/WIND GUARD AT FAN INTAKE. DISCONNECT SWITCH, EQUIPMENT SUPPORTS, VIBRATION ISOLATION PADS AND LOW AMBIENT CONTROLS. EXTEND CONTROL WIRING FROM OUTDOOR UNIT TO INDOOR UNIT. ⑧ LOW SOUND CONDENSER FAN. ⑨ SECURE UNIT TO ROOF MOUNTED CONCRETE EQUIPMENT CONDENSING UNIT PAVES.													

SCHEDULE OF INDOOR VRF HEAT PUMP UNITS											
INDOOR UNIT INFORMATION											
GENERAL DATA		MODEL ^①	SUPPLY FAN DATA		TOTAL CAPACITY	DIMENSION/WEIGHT			REMARKS		
MARK	SERVICE	No.	CFM HIGH	UNIT MCA	ELECTRIC SERVICE	COOLING/HEATING (MBH)	W (IN.)	D (IN.)			H (IN.)
	DATA CLOSET	LSN120HSVS	338	-	208/1/60	12/13.6	33	8	13	25	REFER TO 2346
	SECURE LOBBY	ARNU073TRD4	265	0.25	208/1/60	7.5/8.5	25	25	10	35	REFER TO 2346
	SECURITY	ARNU053TRD4	265	0.25	208/1/60	5.5/6.1	25	25	10	35	REFER TO 2346
NOTES	① AS MANUFACTURED BY "L.G."					⑤ PROVIDE MOUNTING HARDWARE, DISCONNECT SWITCH AND HARDWIRED REMOTE WALL MOUNTED PREMIUM CONTROLLER/THERMOSTAT, DRY CONTACTS FOR BACNET BMS CONTROLS, ULTRA LONG LIFE PLASMA FILTER KIT, VIBRATION ISOLATORS, SPACER FOR CEILING HEIGHT ADJUSTMENT, DECORATIVE CEILING COVER, INLET GRILLE KIT, DRAFT AIR FLOW CONTROLS, INTEGRAL CONDENSATE PUMP (FOR CASSETTE UNITS).					
	② INSTALL PER MANUFACTURER'S RECOMMENDATIONS.					⑥ PROVIDE MOUNTING HARDWARE, DRY CONTACTS FOR BACNET BMS CONTROLS, VIBRATION ISOLATORS, DISCONNECT AND HARDWIRED REMOTE WALL MOUNTED CONTROLLER/THERMOSTAT.					
	③ BASED ON A.R.I. CERTIFIED COIL SELECTIONS; REFRIGERANT R-410A, EER 12.4/SEER 25.9/HSPF10.3.										
	④ INDOOR UNIT POWERED FROM OUTDOOR UNIT.										

SCHEDULE OF CABINET HEATERS										
MARK	TYPE UNIT	MODEL No. ①	CAPACITY DATA ②			MOTOR HP	MOTOR RPM	ELECTRIC SERVICE	PHYSICAL DATA (IN.) WEIGHT (LBS.)	REMARKS
①	SEMI-RECESSED WALL	RW-1120-03	20.6	335	2.0	0.25	1/15	1050	120/71/60 43Wx25Lx10H	115 REFER TO ②③④
NOTES ① AS MANUFACTURED BY "STERLING". ② INSTALL PER MANUFACTURER'S RECOMMENDATIONS ③ CAPACITIES BASED ON LOW SPEED FAN SETTING AND HW 160°F/140°F ④ PROVIDE THROWAWAY FILTERS, DISCONNECT SWITCH, TWO ROW COIL, REMOTE THERMOSTAT/FAN CONTROLS, ELECTRONICALLY COMMUTATED MOTOR (ECM), OPTIONAL COLOR/FINISH SELECTED BY ARCHITECT, INTEGRAL SPEED CONTROL SWITCH FIELD MOUNTED, RECESSED TRIM SECTION AND SEALS.										

SCHEDULE OF REGISTERS AND DIFFUSERS									
MARK	TYPE	SERVICE	MODEL NO. ①	DIRECTION DISCHARGE	DAMPER TYPE	FINISH	TYPE	REMARKS	
Ⓐ	FLOOR REGISTER	SUPPLY	LBPH – 25C	SINGLE DEFLECTION	OPPOSED BLADE	PER ARCH.	–	REFER TO ② ③ ④ ⑤	
Ⓑ	CEILING REGISTER	EXHAUST	735FF	–	OPPOSED BLADE	PER ARCH.	LAY-IN	REFER TO ② ④ ⑥	
Ⓒ	CEILING DIFFUSER	SUPPLY	SCD	3-WAY	OPPOSED BLADE	PER ARCH.	LAY-IN	REFER TO ③ ④ ⑤	
Ⓓ	CEILING DIFFUSER	SUPPLY	SCD	4-WAY	OPPOSED BLADE	PER ARCH.	LAY-IN	REFER TO ③ ④ ⑥	
ⓧ	EXISTING REGISTER/GRILLE								

SCHEDULE OF DUCT MOUNTED SOUND ATTENUATORS									
MARK	SERVICE	AIR FLOW DIRECTION	CONFIG. TYPE	CFM	LENGTH	HEIGHT	WIDTH	PRESSURE DROP IN. S.P.	REMARKS
①	LIBRARY	SUPPLY	STRAIGHT	3000	36"	18"	24"	.20	REFER TO ②③④⑤
②	LIBRARY	RETURN	ELBOW	3000		20"	20"		
③	LIBRARY	RETURN	ELBOW	1200		14"	18"		
④	LIBRARY	SUPPLY	ELBOW	1200		10"	20"		
⑤	LIBRARY	SUPPLY	STRAIGHT	1200		16"	16"		
⑥	LIBRARY	RETURN	STRAIGHT	1200					
NOTES ① AS MANUFACTURED BY "IAC". ② SEE SPECIFICATION FOR CONSTRUCTION. ③ AIR PRESSURE DROP THROUGH ATTENUATOR SHALL NOT EXCEED 0.20" S.P. ④ INSTALL PER MANUFACTURER'S RECOMMENDATIONS.									

SCHEDULE OF MINIMUM VENTILATION ROOM FLOW RATES										
		A	B	C	D	E	F	G	H	I
		ROOM AREA (SQ.FT.)	PEOPLE DENSITY (#/1000 SQ.FT.)	PEOPLE OUTDOOR AIR FLOW RATE (CFM/PERSON)	AREA OUTDOOR AIR FLOW RATE IN BREATHING ZONE (CFM/SQ.FT.)	EXHAUST AIR FLOW RATE (CFM/SQ.FT.)	NUMBER OF PEOPLE (A+B+1000#P)	OUTDOOR AIR FLOW RATE WITHOUT ZONE EFFECTIVENESS FACTOR (F+C+H+A-D)=CFM	ZONE AIR DISTRIBUTION EFFECTIVENESS FACTOR	MINIMUM ROOM VENTILATION AIR FLOW RATE G+H=CFM
SECURITY	OFFICE SPACE	50	5	5	0.06	0	1	8	0.8	10
SECURE VESTIBULE	MAIN ENTRY LOBBIES	200	10	5	0.06	0	2	22	0.8	28
LIBRARY 114	MEDIA CENTER	1690	25	10	0.12	0	43	633	0.8	791
MAKER LAB 015	MEDIA CENTER	480	25	10	0.12	0	12	178	0.8	222
LEARNING STUDIO 118	MEDIA CENTER	550	25	10	0.12	0	14	206	0.8	258
SGR 119	CLASSROOM (AGES 9+)	65	35	10	0.12	0	3	38	0.8	47

BEFORE FABRICATION THIS CONTRACTOR SHALL VERIFY ALL MEASUREMENTS AND CONDITIONS ON JOB AND COORDINATE HIS WORK WITH THE WORK OF ALL OTHER CONTRACTORS

Revision Schedule		
No.	Description	Date
1	SED Submission	09/15/2020
2	SED Submission Addendum#1	01/08/2021
3	ISSUED FOR BID	01/19/2021

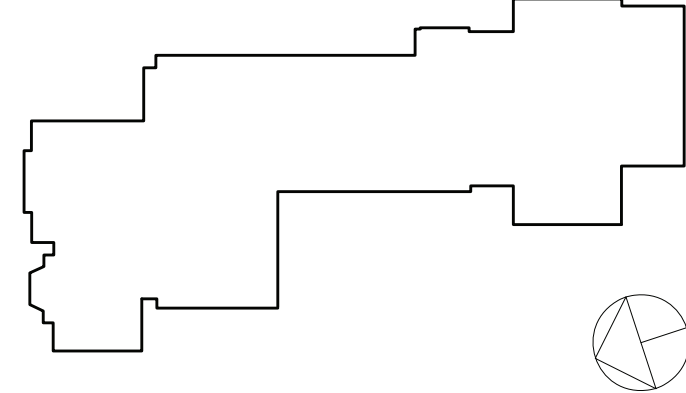

Geddis Architects

Architecture. Planning. Interiors

71 Old Post Road
P.O. Box 1020
Southport, CT 06890
(203) 256-8700



Transforming Education by Design

259 Water Street Suite 1L
Warren, RI 02885 USA
+1 401-289-2789



BARILE GALLAGHER & ASSOCIATES

CONSULTING ENGINEERS
39 MARBLE AVENUE, PLEASANTVILLE, NY 10570
914.328.6000 GENERAL@BGA-ENG.COM WWW.BGA-ENG.COM

Construction Manager
SAVIN ENGINEERS, P.C.
3 Campus Drive
Pleasantville, NY 10570
914-769-3200

Structural Engineer
ODEH ENGINEERS
1223 Mineral Spring Ave
North Providence, RI 02904
401-724-1771

Civil Engineer
WESTON & SAMPSON
1 Winners Circle, Suite 130
Albany, NY 12205
518-463-4400

Acoustic Consultant
DP DESIGN
12 Cold Spring Street
Providence, RI
401-861-3218

SED#: 6618-0001-0002-015

PROJECT

Rye City Schools

555 Theodore Fremd Ave, Suite B-101

Milton Elementary School

12 Hewlett St, Rye, NY 10580

SCHEDULES

SEAL & SIGNATURE DATE: 02/11/20
PROJECT No: 9200
DRAWING BY: BGA
CHK BY: BGA
DWG No: H2-301