

Drawing Name: G:\Savin\Autocad\2060\25-Playland-Mega-2\GE\GE004.dwg
Consultant: Savin Engineers, P.C.
Printed by: Bkittle Date: 2 Jul 2021 10:39 AM Designed by: ---
Xrefs: [TB_24X3E_WestchesterCo_3.dwg] [TSG-SVLOGO.dwg] [TWS-SP0001.dwg] [DBSP-101.dwg]

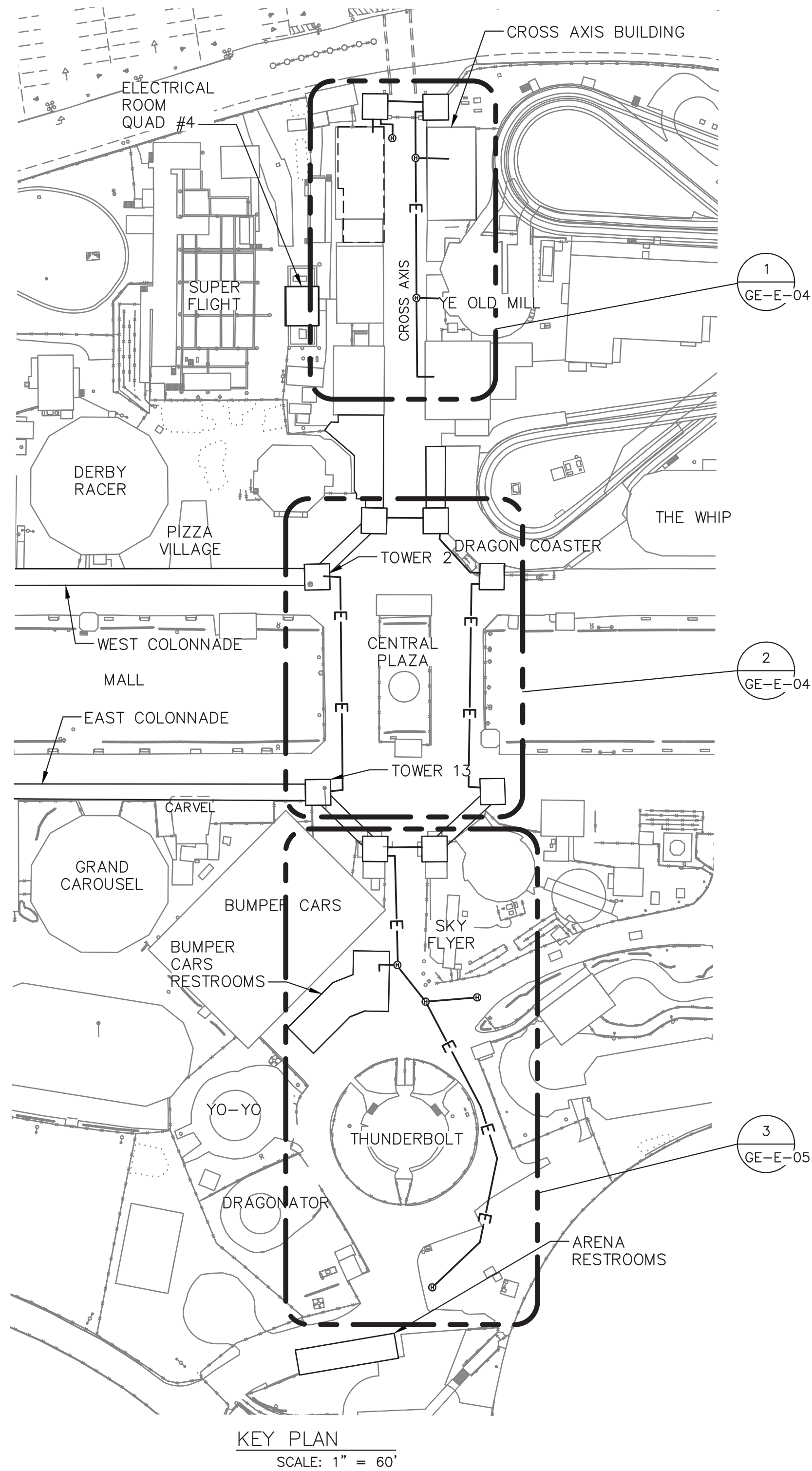

DUCTBANK SCHEDULE		
NAME	CONDUIT SIZE	REMARKS
E1	2" C WITH PULLROPE	AUDIO
E2	2" C WITH PULLROPE	SPARE

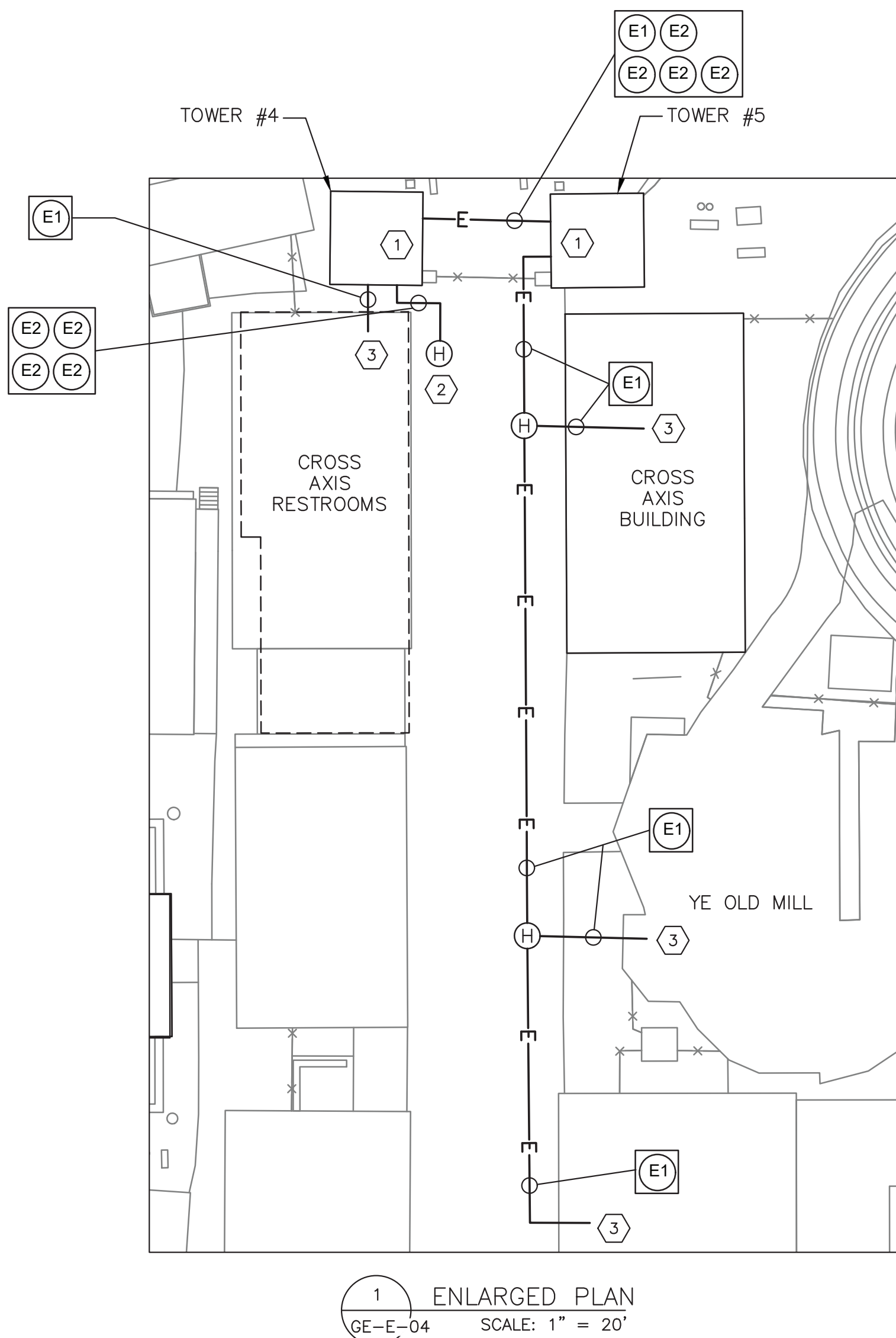

NOTES:

- FOR ADDITIONAL NOTES AND SYMBOLS, SEE GE-E-01.
- UNLESS NOTED OTHERWISE, POLYMER CONCRETE HANDHOLES SHALL BE 12"x12"x24". SEE DRAWING DT-E-03 FOR ADDITIONAL INFORMATION.
- ALL UNDERGROUND CONDUIT SHALL BE SCHEDULE 80 PVC. TRANSITION FROM UNDERGROUND TO ABOVE GROUND CONDUIT USING RIGID GALVANIZED STEEL.
- SEE DRAWING DT-E-03 FOR UNDERGROUND CONDUIT DUCTBANK DETAIL.

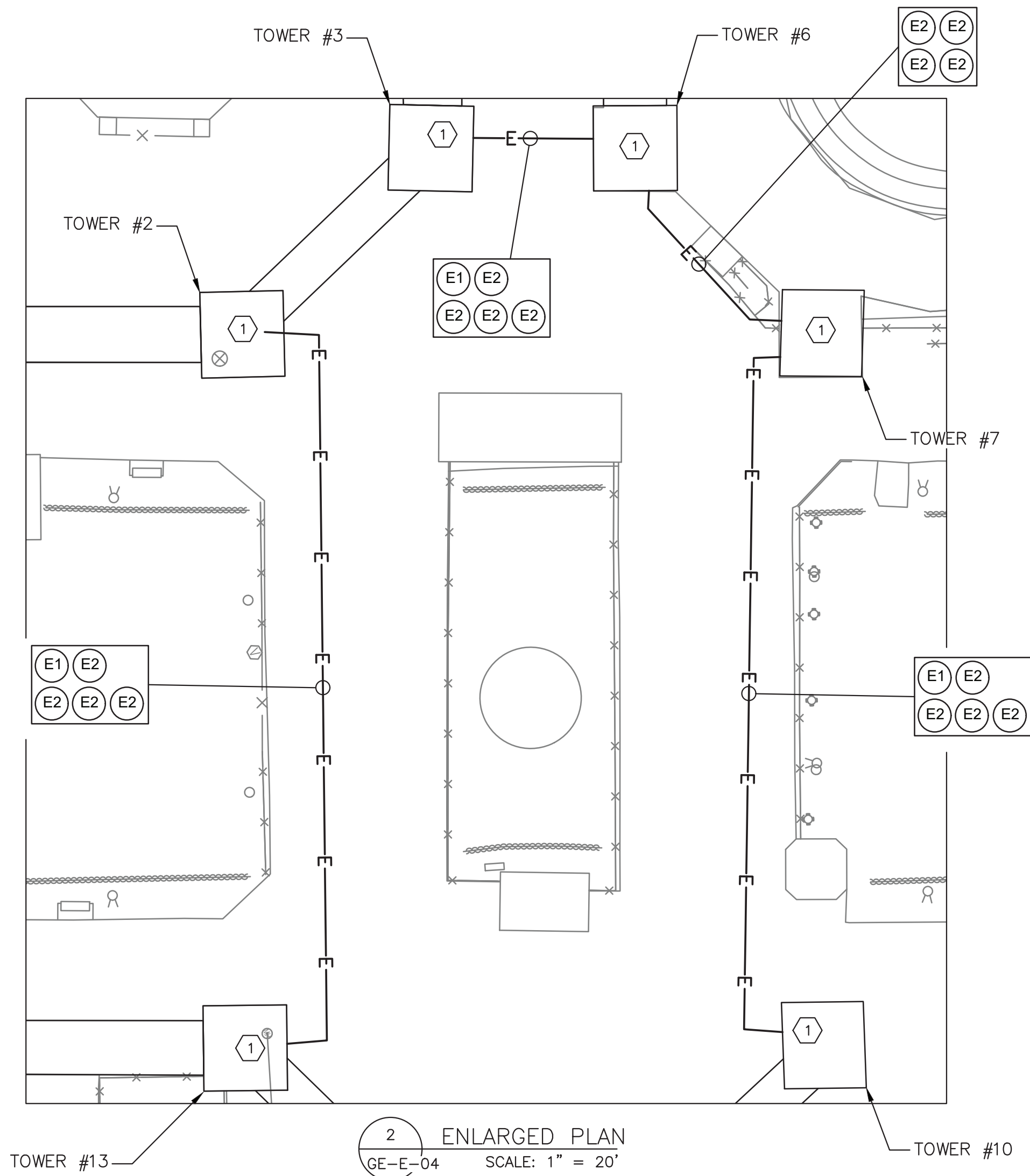

KEY NOTES:

- TOWER WILL HAVE NEW MANHOLE INSTALLED (SEE MAW-1 ADDENDUM STRUCTURAL DRAWINGS FOR ADDITIONAL INFORMATION). INCOMING UNDERGROUND CONDUIT WILL BE ROUTED TO NEW MANHOLE. CONTRACTOR IS ADVISED, UNDER THE MEGA 1 PROJECT, UNDERGROUND CONDUIT WILL BE INSTALLED AND CAPPED 8" PAST THE TOWER FOOTPRINT. MEGA 2 CONTRACTOR WILL INTERCEPT (AT THIS POINT) AND INSTALL NEW CONDUIT AS SHOWN.
- PROVIDE 18" X 18" X 24" POLYMER CONCRETE HANDHOLE AT THIS LOCATION.
- INCOMING UNDERGROUND CONDUIT SHALL BE ROUTED TO ATTIC SPACE OF STRUCTURE. CONCEAL EXPOSED CONDUIT AS MUCH AS PRACTICAL. STUB AND CAP CONDUIT FOR FUTURE USE.

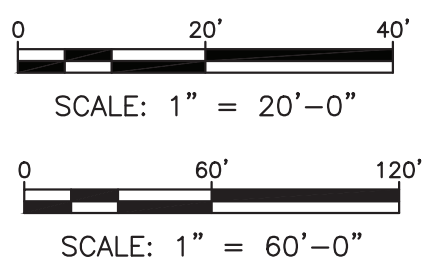

CONSULTANT INFORMATION

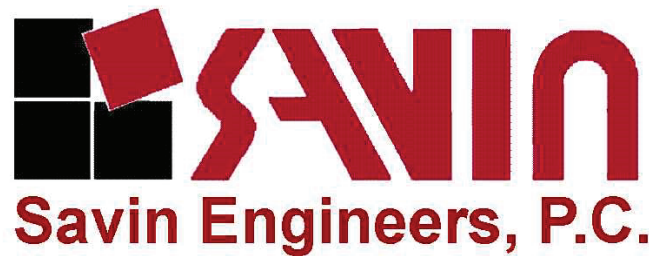

CONSULTANT SEAL



REVISION NUMBER	DATE	MADE BY	APP'D BY	REVISION
1	07/02/2021	RKC	DF	BID ADDENDUM #3

RECORD DRAWING CERTIFICATION

☐ AS BUILT - CHANGES AS NOTED ☐ AS BUILT - NO CHANGES

CONTRACTOR		PROJECT COORDINATOR	
NAME	SIGNATURE	NAME	SIGNATURE
TITLE	DATE	TITLE	DATE

WESTCHESTER COUNTY, NEW YORK
DEPARTMENT OF PUBLIC WORKS AND TRANSPORTATION
DIVISION OF ENGINEERING

INFRASTRUCTURE REHABILITATION - PHASE 2
PLAYLAND PARK, RYE, NEW YORK
GENERAL
DUCT BANK PLAN 1

CONTRACT NUMBER
20-530
SHEET NUMBER
GE-E-04

DWG NO.: Page 289 of 290

SCALE: **AS SHOWN**

DATE: **JULY, 2 2021**

DPW FILE NUMBER
1-118-E-676A

REV. NO.
0