

7 PANEL INSIDE CORNER DETAIL
A-10 6"=1'-0"

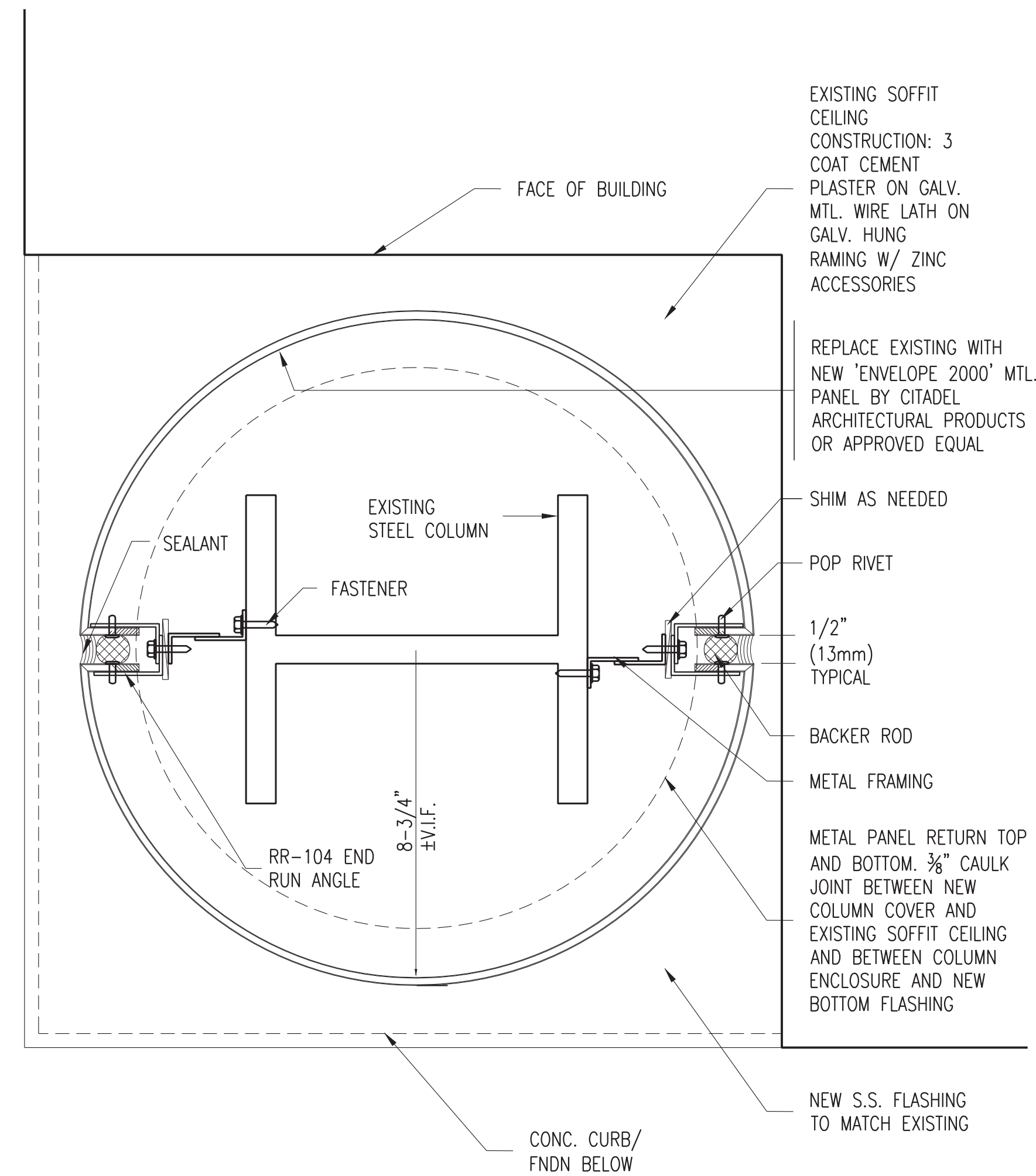

9 COLUMN COVER DETAIL
A-10 6"=1'-0"

IN CHARGE OF ADAM KAPLINSKI, R.A.
CHECKED BY ADAM KAPLINSKI, R.A.
MADE BY ALEXIS GARCIA

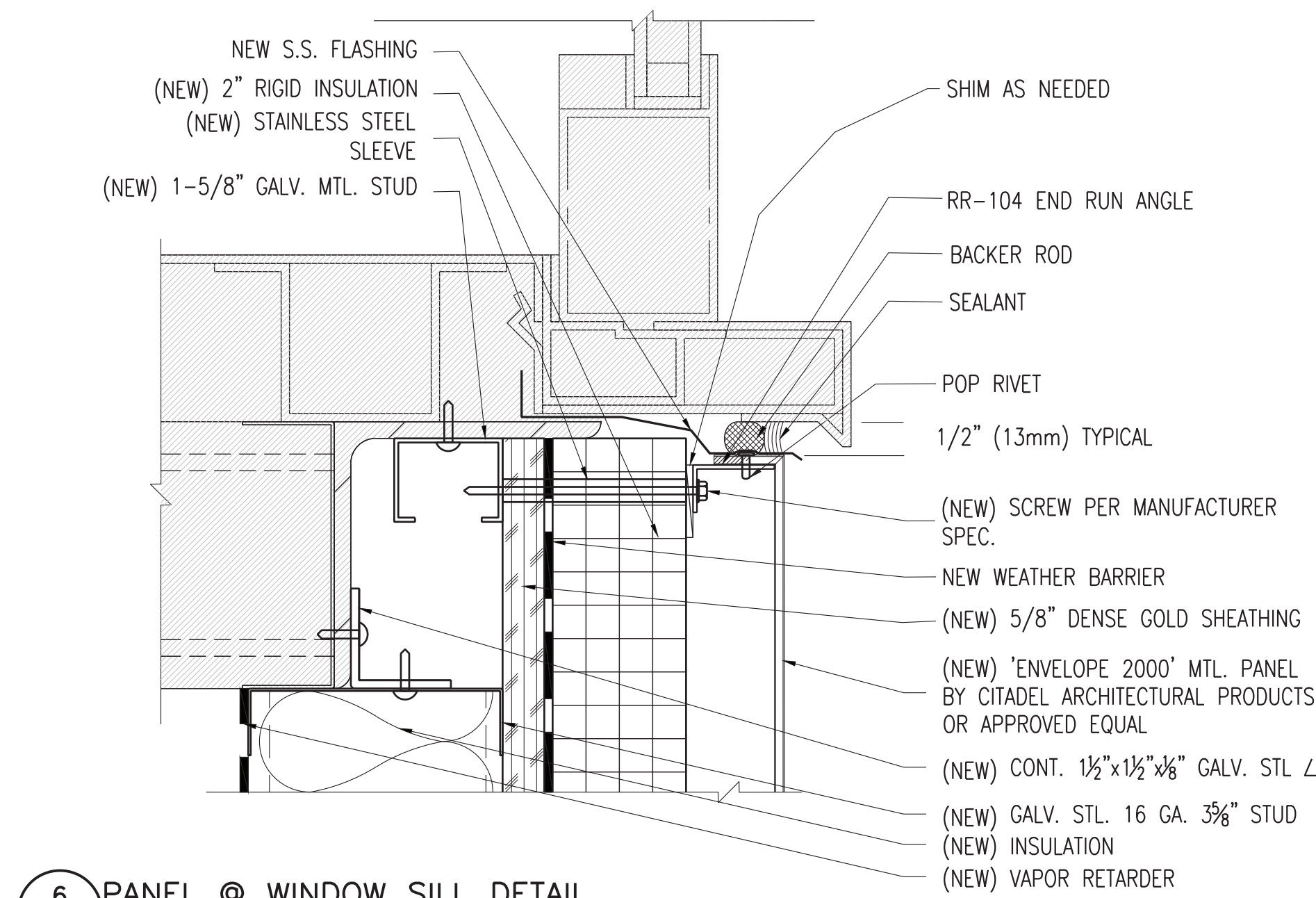

6 PANEL @ WINDOW SILL DETAIL
A-10 6"=1'-0"

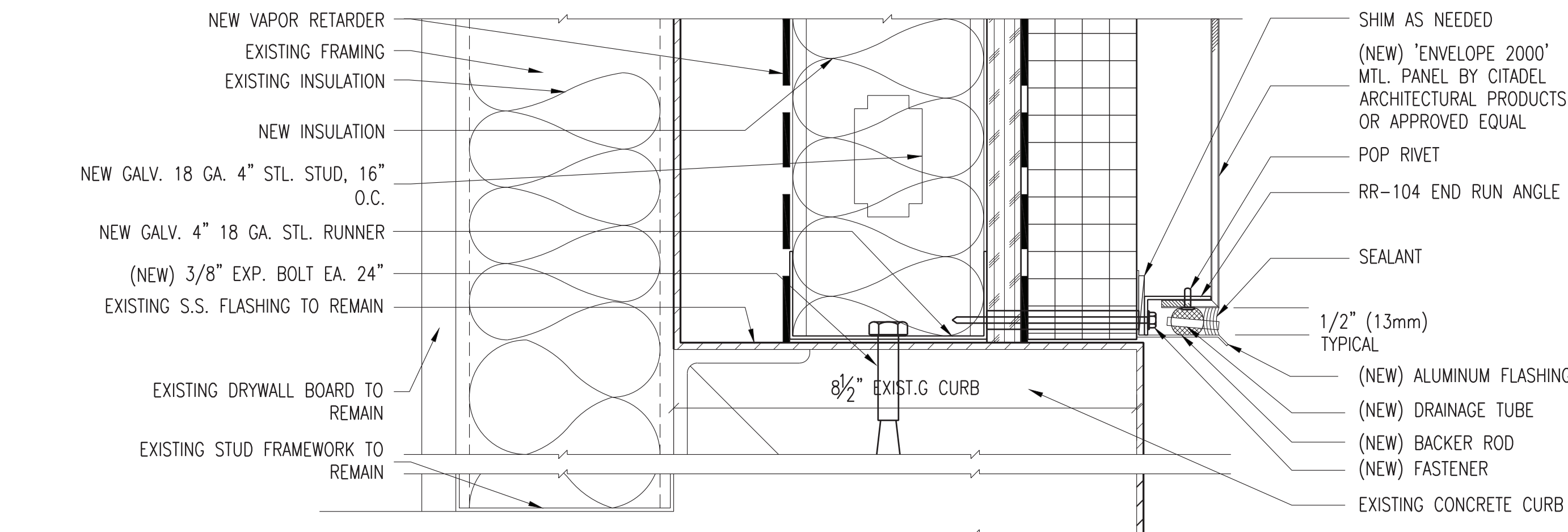

8 PANEL BASE DETAIL
A-10 6"=1'-0"

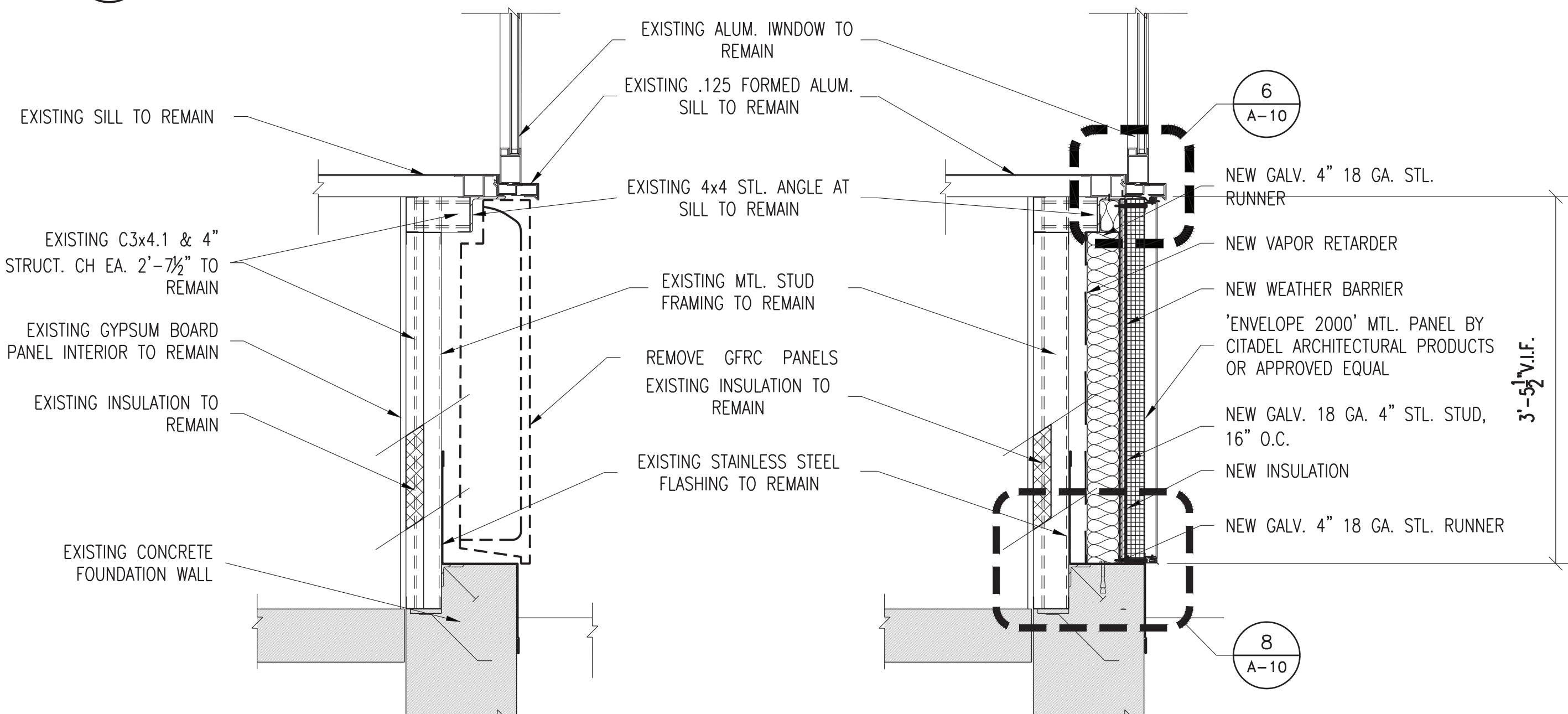

2 NEW WORK SECTION
A-10 1"=1'-0"

NOTE:
FOR ALL WALL PANEL DETAILS ON THIS PAGE:
FOR EXISTING AND NEW FRAMING, SEE SECTIONS 11 AND 12/A-10

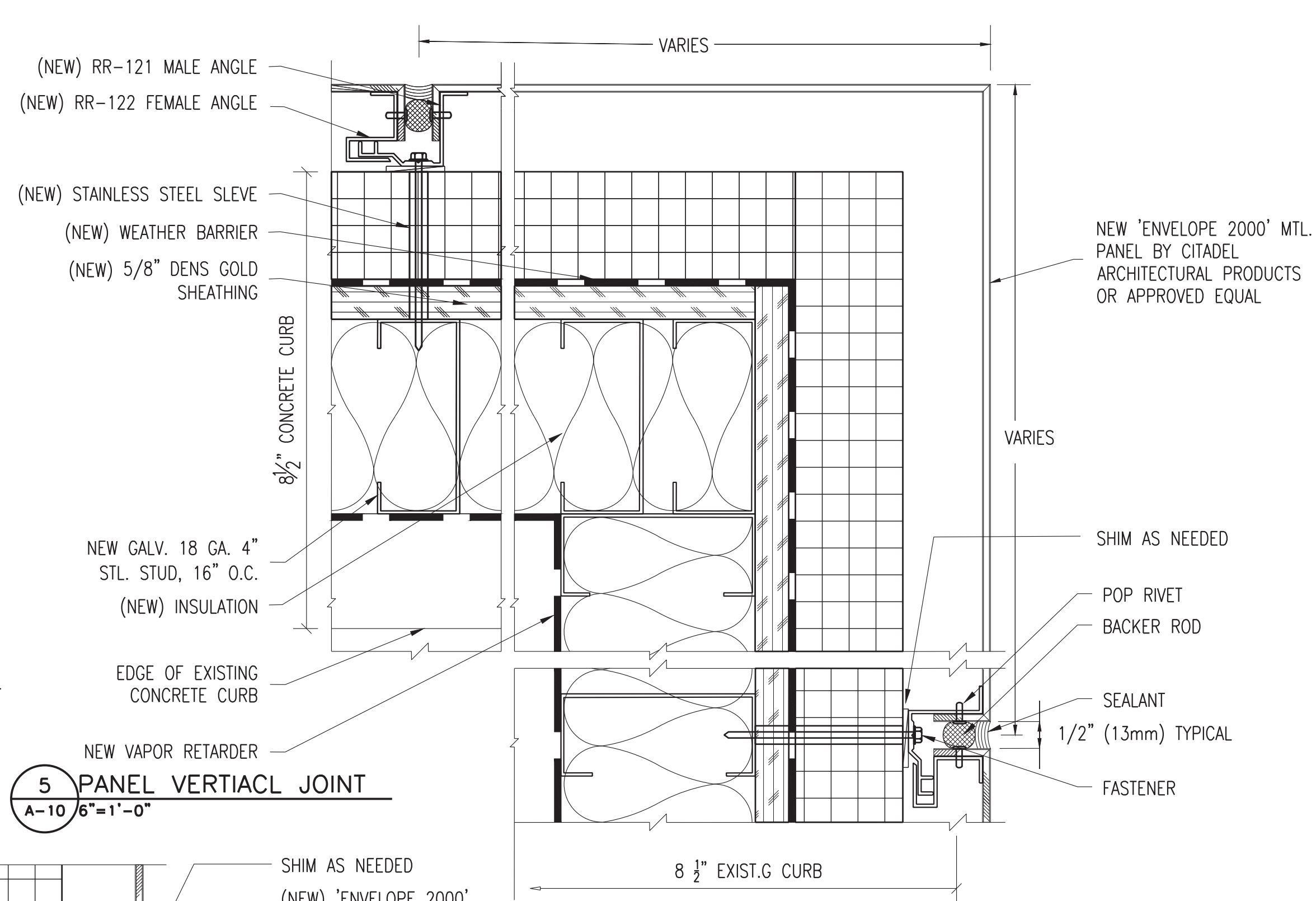

5 PANEL VERTIACL JOINT
A-10 6"=1'-0"

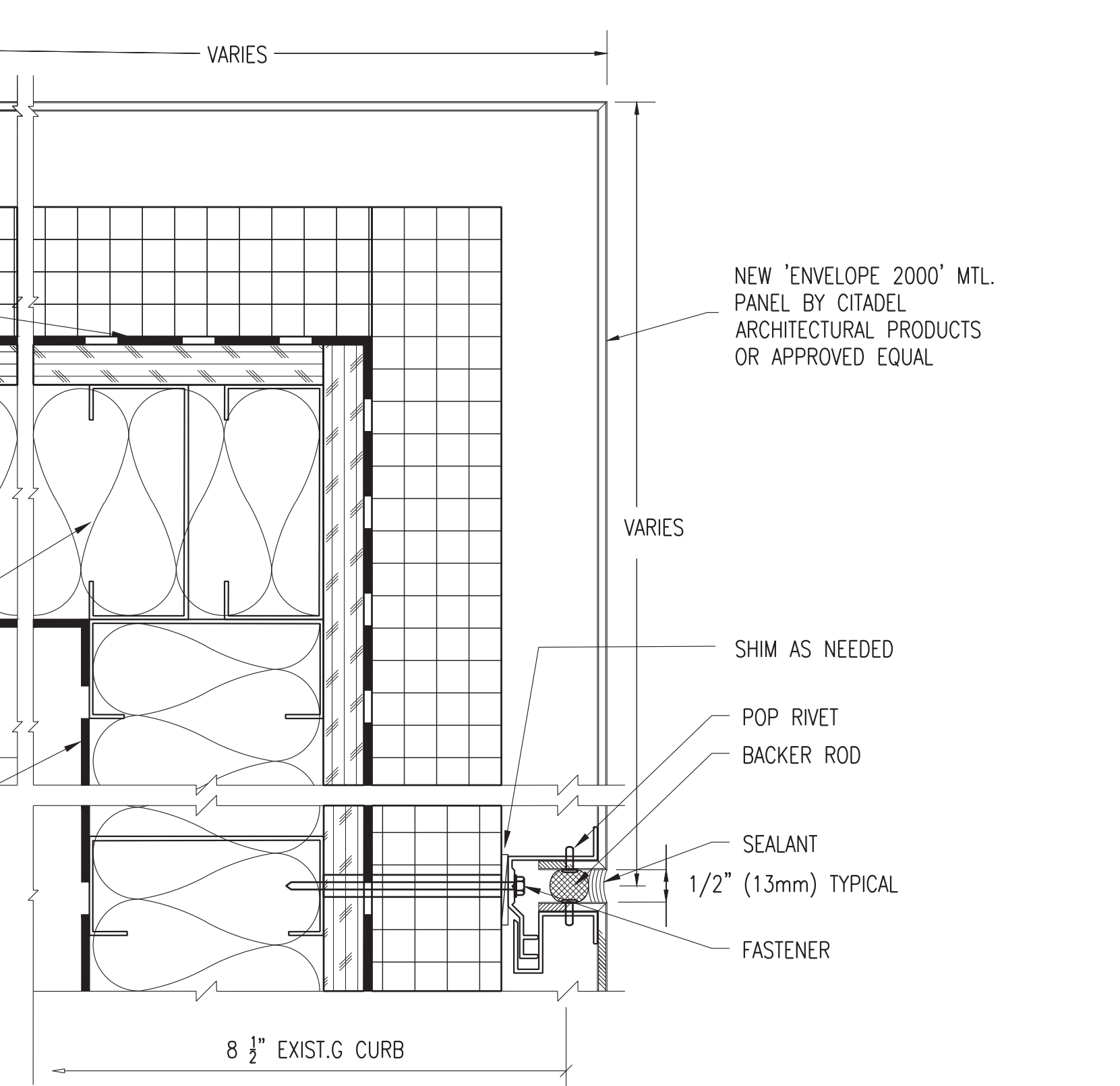

4 OUTSIDE CORNER DETAIL
A-10 6"=1'-0"

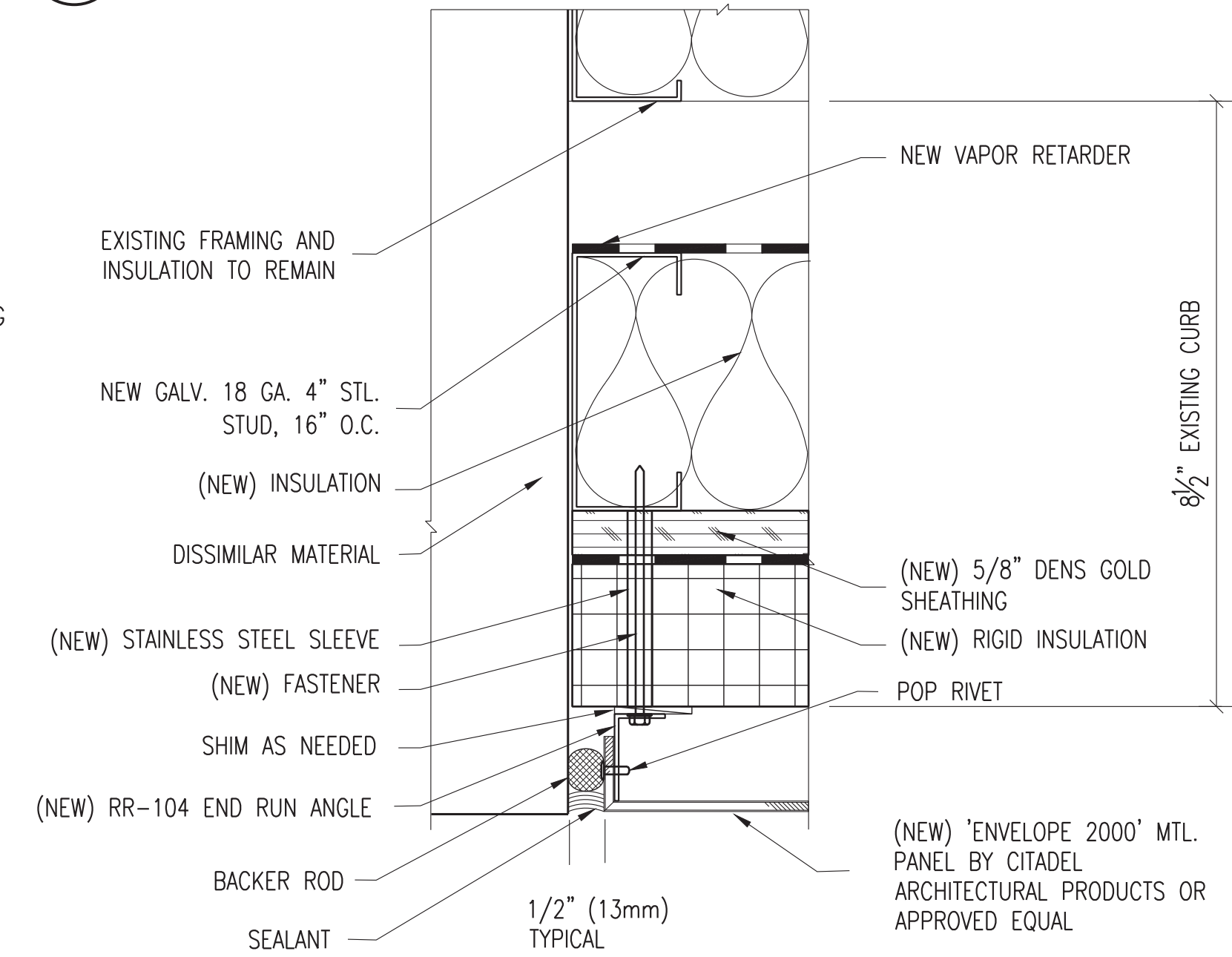

3 PANEL END DETAIL
A-10 6"=1'-0"

1	11/17/21	AG	AK	ADDENDUM # 1
REVISION NUMBER	DATE	MADE BY	APP'D BY	REVISION
RECORD DRAWING CERTIFICATION				
<input type="checkbox"/> AS BUILT - CHANGES AS NOTED <input type="checkbox"/> AS BUILT - NO CHANGES				
CONTRACTOR		PROJECT COORDINATOR		
NAME	DATE	NAME	DATE	
SIGNATURE		SIGNATURE		
TITLE		TITLE		
WESTCHESTER COUNTY, NEW YORK		CONTRACT NUMBER	SHEET NUMBER	
DEPARTMENT OF PUBLIC WORKS AND TRANSPORTATION		19-531	A-10	
DIVISION OF ENGINEERING		SHEET NO. 12 OF 27		
INFRASTRUCTURE UPGRADES		SCALE: AS NOTED	DATE: 10/28/21	
LABS AND RESEARCH		DPW FILE NO.	REV. NO.	
VALHALLA CAMPUS, VALHALLA, NEW YORK		38-54-A-769	1	
EXTERIOR WALL PANEL DETAILS				

ADDENDUM # 1

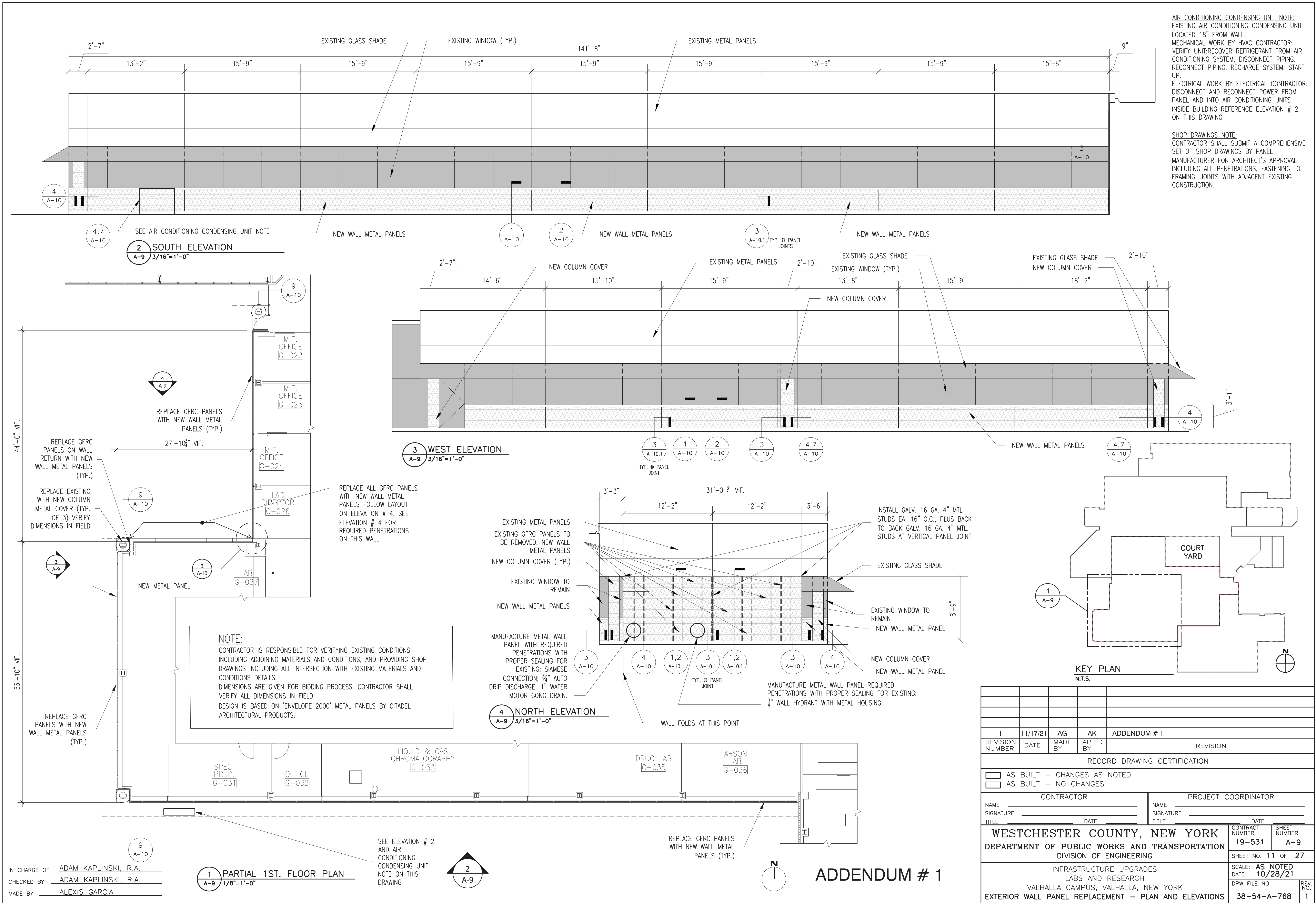

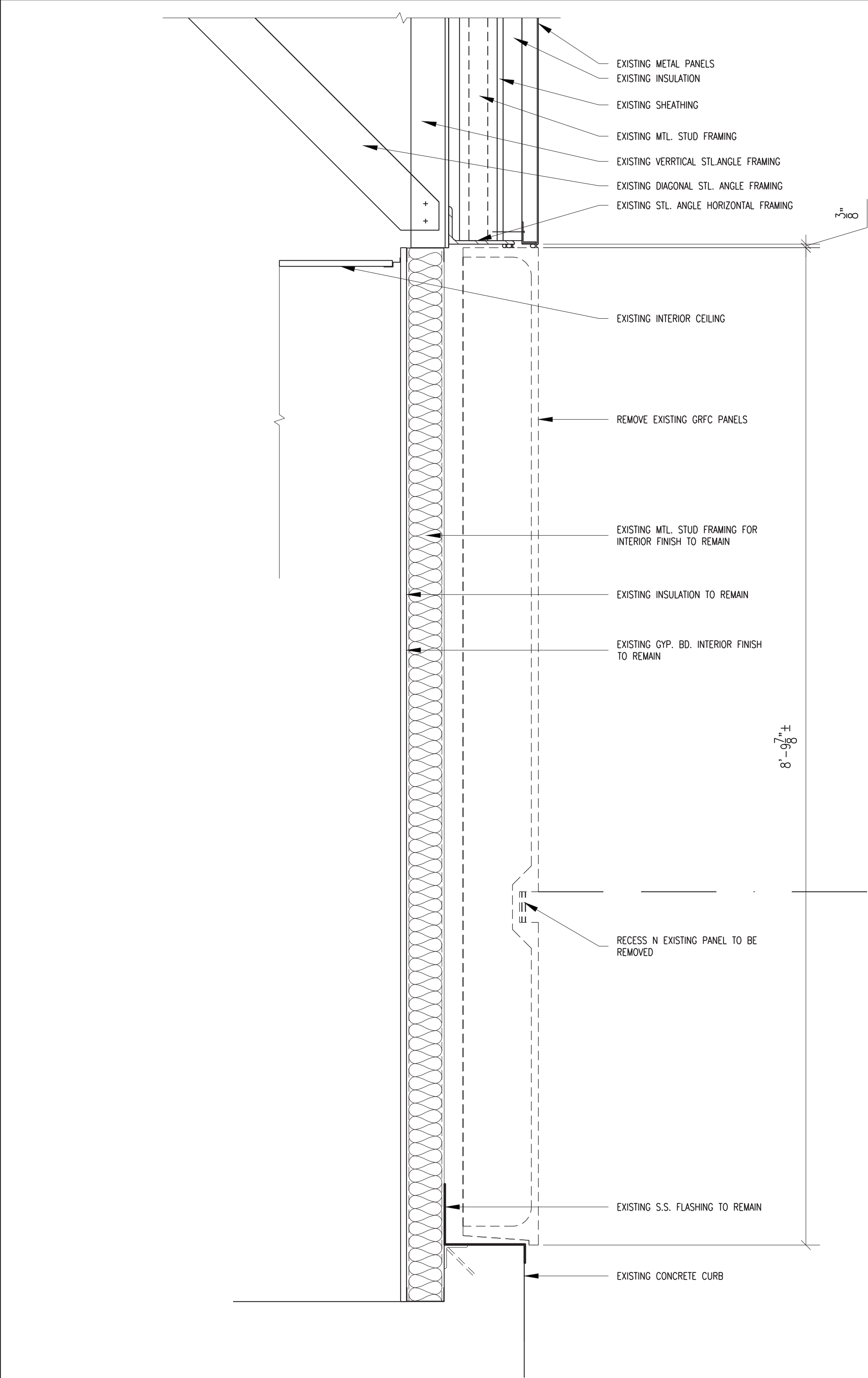

1
A-10.1 1-1/2"=1'-0"

DEMOLITION SECTION
@ NEW METAL PANEL

IN CHARGE OF ADAM KAPLINSKI, R.A.
CHECKED BY ADAM KAPLINSKI, R.A.
MADE BY ALEXIS GARCIA

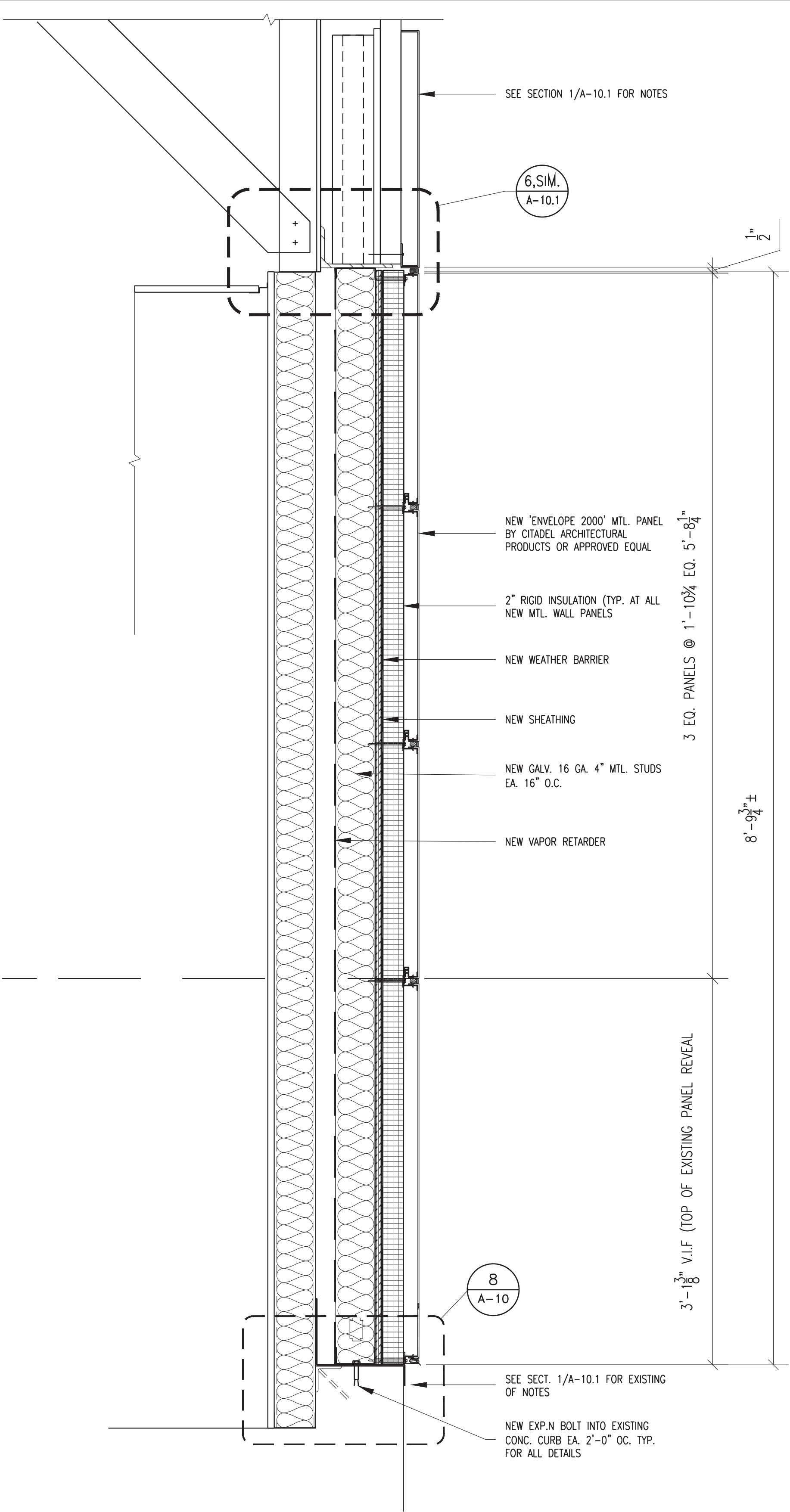

2
A-10.1 1-1/2"=1'-0"

NEW CONSTRUCTION SECTION
@ NEW METAL PANEL

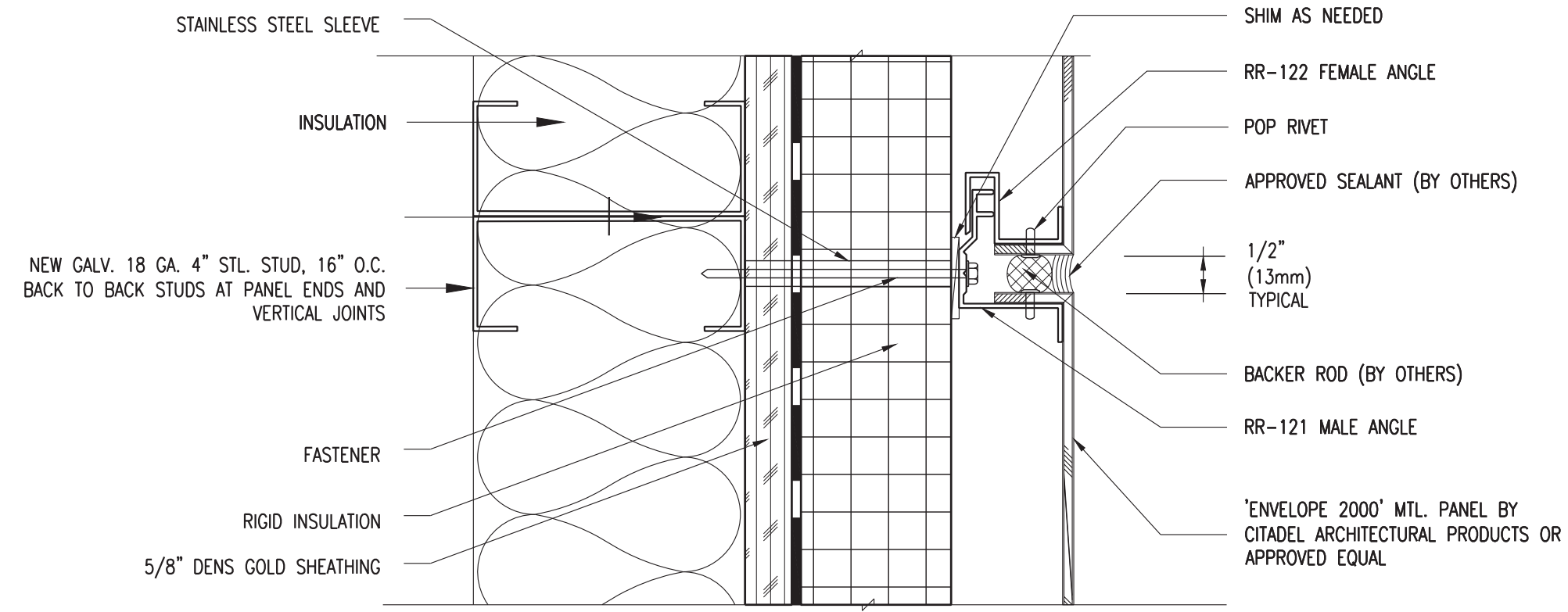

3
A-10.1 1-1/2"=1'-0"

HORIZONTAL/VERTICAL
WALL METAL PANEL JOINT DETAIL

ADDENDUM # 1

1	11/17/21	AG	AK	ADDENDUM # 1
REVISION NUMBER	DATE	MADE BY	APP'D BY	REVISION
RECORD DRAWING CERTIFICATION				
<input type="checkbox"/> AS BUILT - CHANGES AS NOTED <input type="checkbox"/> AS BUILT - NO CHANGES				
CONTRACTOR			PROJECT COORDINATOR	
NAME			NAME	
SIGNATURE			SIGNATURE	
TITLE			TITLE	
WESTCHESTER COUNTY, NEW YORK			CONTRACT NUMBER	SHEET NUMBER
DEPARTMENT OF PUBLIC WORKS AND TRANSPORTATION			19-531	A-10.1
DIVISION OF ENGINEERING			SHEET NO. 28 OF 28	
INFRASTRUCTURE UPGRADES LABS AND RESEARCH VALHALLA CAMPUS, VALHALLA, NEW YORK EXTERIOR WALL PANEL DETAILS			SCALE: AS NOTED DATE: 11/17/21	REV. NO. 1