

Bid Issue Date: 8/9/2021	Drawn By: SLJ/MSP	Checked By: JH/LG	Scale:
-----------------------------	----------------------	----------------------	--------

Sheet Name:	ENLARGED PLANS			
	Revisions:			
Progress Prints:				

GENERAL FLOOR PLAN NOTES

1. GWB INTERIOR PARTITIONS ARE TYPE ① UNLESS OTHERWISE NOTED. REFER TO DRAWINGS A4.1 & A4.2 FOR INTERIOR PARTITION LAYOUT DIMENSIONS. SEE A10.3 FOR PARTITION TYPES
2. F.E. = FIRE EXTINGUISHER
3. F.E.C. = FIRE EXTINGUISHER CABINET
4. REFER TO SHEET A10.1 FOR DOOR SCHEDULE
5. REFER TO SHEET A10.2 FOR EXTERIOR WINDOW SCHEDULE
6. REFER TO SHEET A10.2 FOR INTERIOR WINDOW SCHEDULE
7. REFER TO SHEET SERIES A11 FOR FINISH PLANS & SCHEDULE
8. REFER TO DRAWINGS A4.1 & A4.2 FOR LARGER SCALE FLOOR PLANS INCLUDING DIMENSIONS FOR INTERIOR PARTITIONS
9. MECHANICAL DUCT AS PER MECHANICAL DWGS.
10. PATCH AND REPAIR ALL SURFACES AS A RESULT OF DEMOLITION. SURFACES SHOULD PROVIDE A SUITABLE SUBSTRATE TO THE EXTENT NECESSARY FOR NEW MATERIALS AND CONSTRUCTION AS PER CONSTRUCTION DOCUMENTS AND SPECS.
11. PROVIDE DEFLECTION TRACK AT ALL METAL STUD FRAMING WHERE WALL PARTITION GOES TO UNDERSIDE OF EXISTING STRUCTURE. ALL PARTITIONS SHOULD GO TO UNDERSIDE OF STRUCTURE EXCEPT WHERE NOTED.
12. PROVIDE FIRE RATED CAULKING AT TOP AND BOTTOM OF ALL RATED WALL ASSEMBLIES AND THRU-FLOOR PENETRATIONS AS PER SPECS.
13. (N.N.W.) = NO NEW WORK, EXCEPT WHERE INDICATED
14. ARCHITECTURAL WORK EXCEPT WHERE INDICATED. REFER TO ALL OTHER DISCIPLINE'S DRAWINGS FOR FULL EXTENT OF WORK.
15. ALL GWB TO BE ABUSE RESISTANT UNLESS NOTED OTHERWISE.
16. PROVIDE MOISTURE RESISTANT GWB IN THE FOLLOWING ROOMS/AREAS: TOILET ROOMS AND CATERING KITCHEN
17. ALL WALLS ARE DRAWN FACE OF STUD (GWB NOT SHOWN) ON THE PLANS. COORDINATE WITH PARTITION SCHEDULE FOR REQUIRED GWB THICKNESS.

FLOOR PLAN KEYNOTES

- 1 MILLWORK AS PER DETAILS.
- 1A ALTERNATE: FURNITURE ITEM BY OWNER. ITEM TO MATCH THE MILLWORK PLAN, ELEVATION, DETAIL AND FINISHES SHOWN IN ALL RESPECTS.
- 2 PACKOUT COLUMNS W/ STEEL STUDS. FINISH TO BE PAINTED GWB AND INTEGRATED CORNER GUARDS AS PER DETAILS
- 3 LINE OF SOFFIT. REFER TO REFLECTED CEILING PLAN.
- 4 EXISTING R.W.C. TO REMAIN, SEE PLUMBING DWGS. FOR INFORMATION
- 5 REFER TO MEP FOR PLUMBING FIXTURES
- 6 NEW CANOPY ABOVE
- 7 EXISTING DRINKING FOUNTAIN TO REMAIN.
- 8 NEW STEEL COLUMN, SEE STRICT. DWGS. COLUMN TO BE PAINTED.
- 9 EXISTING EXTERIOR RECEPTACLE TO REMAIN.
- 10 NEW METAL CANOPY ABOVE
- 11 NEW SHELVING, PROVIDE 5 SHELVES EQUALLY SPACED IN CLASSROOM; ADD ALT STORAGE TO HAVE 2 SHELVES AS INDICATED BY OWNER
- 12 APPLIANCES BY OWNER, COORDINATE ELECTRICAL & PLUMBING REQUIREMENTS
- 13 METAL PANEL INFILL WITH NEW LOUVER, SEE DET. 9/A8.3 & MECH. DRAWINGS
- 14 METAL PANEL INFILL, SEE DET. 9/A8.3(SIM.)
- 14 LOCATION OF IN-SITU STAINED-GLASS: EXISTING FRAMES TO BE RE-USED; EXERCISE EXTREME CAUTION WHEN INSTALLING NEW DOOR AND WALL BELOW STAINED GLASS BOX FRAME WITH LIGHTING AND HINGES
- 14a LOCATION OF NEW STAINED-GLASS WINDOWS; PROVIDE OPENING FOR THE WINDOW. ALLOW STAINED-GLASS TO SERVE ITS PURPOSE OF SHEDDING LIGHT ON BOTH SIDES OF SPACE. OWNER TO PROVIDE STAINED GLASS & WINDOW FRAME MATCHING WOOD OF EXISTING FRAME. GC TO COORDINATE WITH OWNER THE OPENING SIZE REQUIREMENT.
- 14b LOCATION OF NEW STAINED-GLASS WINDOWS; PROVIDE OPENING & BACKLIGHTING FOR THE WINDOW. OWNER TO PROVIDE STAINED GLASS & WINDOW FRAME MATCHING WOOD OF EXISTING FRAME. GC TO COORDINATE WITH OWNER THE OPENING SIZE REQUIREMENT & LOCATION OF LIGHTING.
- 15 GC TO ADJUST WALL LOCATIONS AS REQUIRED (TOWARDS MULTI-PURPOSE ROOM) TO CLEAR FRAME OF EXISTING FRAMED STAIN GLASS ITEM ABOVE. REPORT ANY DISCREPANCIES TO ARCHITECT IF/AS NEEDED PRIOR TO CONSTRUCTION
- 16 NOT USED
- 17 NEW WINDOW TYPE ① (ALTERNATE)
- 18 NEW COMPOSITE PANEL WALL CLADDING AS PER DETAILS AND SPECS (ALTERNATE)
- 19 INTERIOR GLASS PARTITION, BASE OF DESIGN: C.R. LAURENCE'S CLEAR VIEW

TOILET ROOM ACCESSORIES LIST

DESCRIPTION	MANUFACTURER / DETAILS
SOAP DISPENSER	GOJO LTX-12 DISPENSER TOUCH-FREE DISPENSER FOR GOJO FOAM SOAP
TOILET PAPER DISPENSER	SCOTT PRO JUMBO ROLL CORELESS - STAINLESS SIZE: 14 1/2" X 10 3/8" X 5 8/9"
PAPER TOWEL DISPENSER	SCOTT PRO MANUAL HARD ROLL - STAINLESS CORE COLOR: GREY CORE
SANITARY NAPKIN DISPOSAL	BOBRICK, B-270 SURFACE - MOUNTED SANITARY NAPKIN DISPOSAL, FINISH: STAINLESS STEEL
COUNTERTOP WITH INTEGRAL SINK	CORIAN GALAXY WHITE
TOILET PARTITIONS W/ HOOK ON DOOR / URINAL SCREEN	REFER TO FINISH SCHEDULE AND SPECS
GRAB BARS, CONCEALED MOUNTING	AMERICAN SPECIALTIES 3800 SERIES
TRASH CAN	BY OWNER
FRAMED MIRROR	KOHLER - TRESHAM FRAMED MIRROR K-99650; FINISH: F69 WOODLAND

PROVIDE BLOCKING AS NECESSARY FOR ALL ACCESSORIES.
PROVIDE ACCESSORIES LISTED ABOVE OR APPROVED EQUAL.

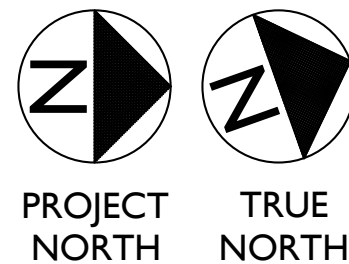

PROJECT
NORTH
TRUE
NORTH

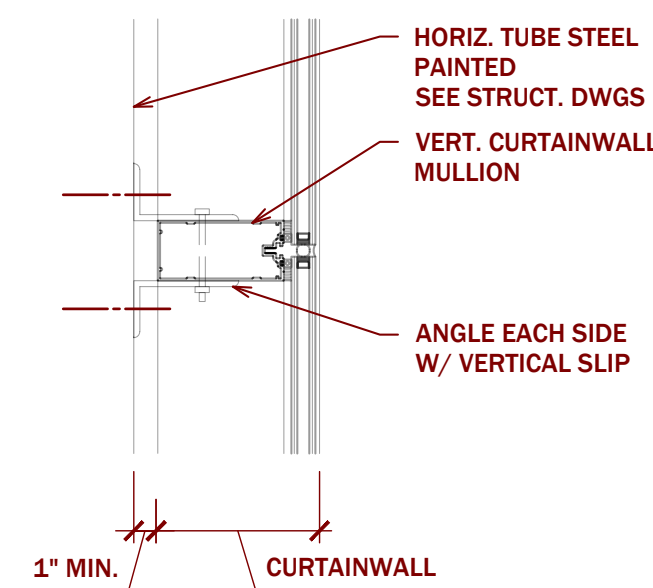

8 CURTAINWALL AT VERT. MULLION
A4.2 SCALE 1 1/2" = 1'-0"

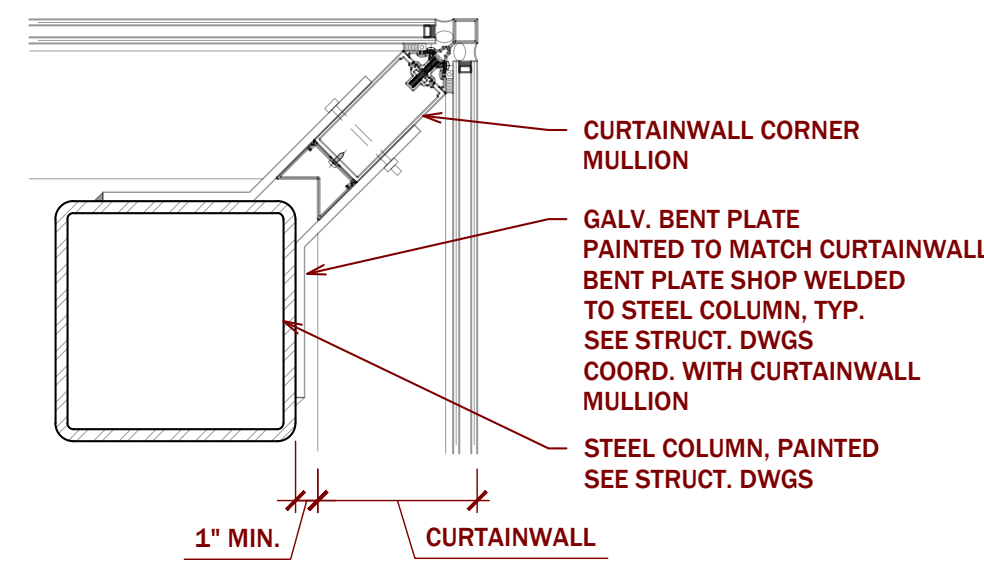

7 CURTAINWALL CORNER DETAIL
A4.2 SCALE 1 1/2" = 1'-0"

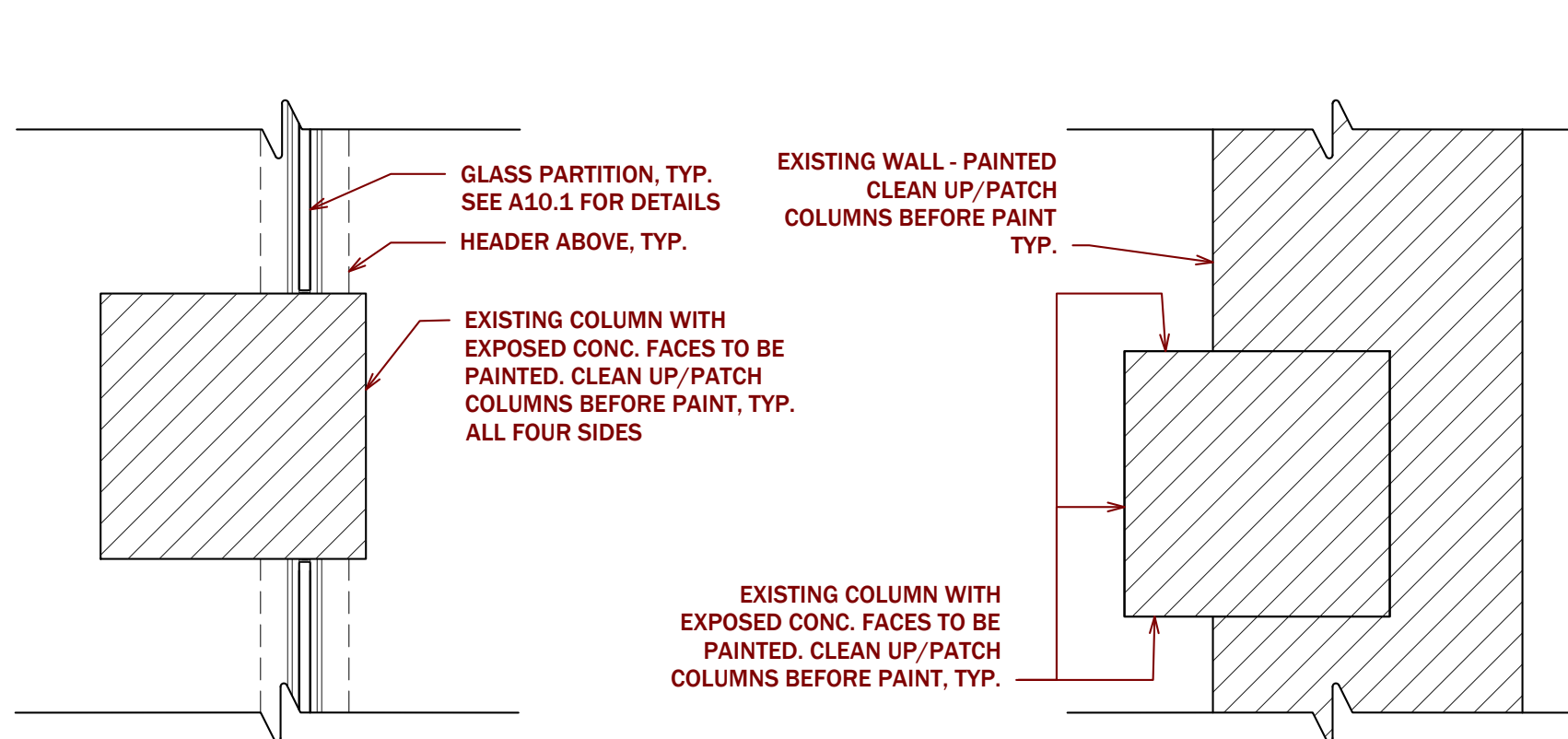

6 COLUMN PLAN DETAIL
A4.2 SCALE 1 1/2" = 1'-0"

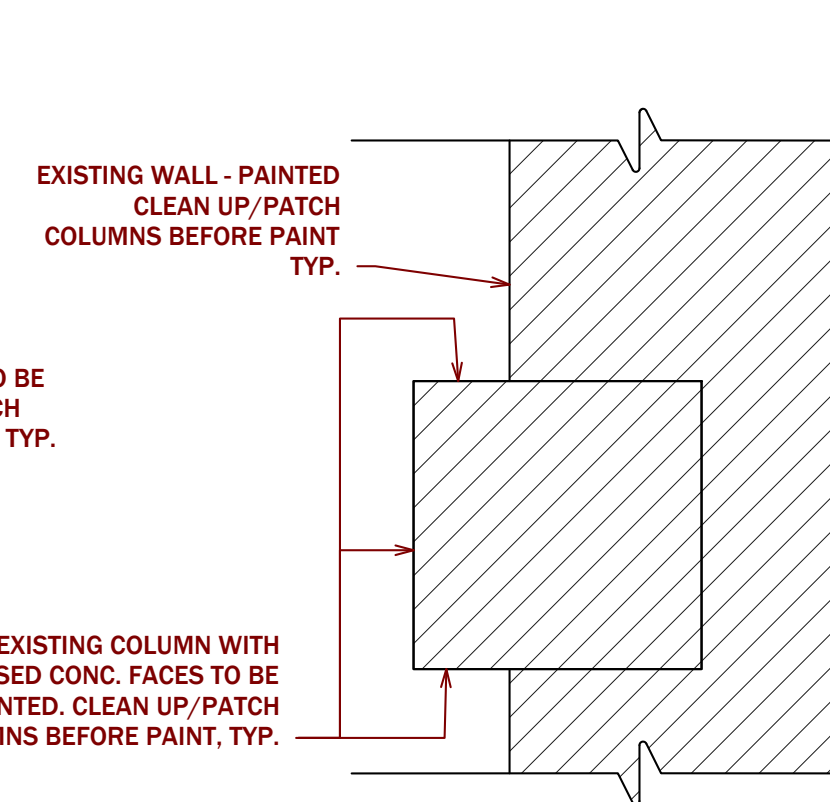

5 COLUMN PLAN DETAIL
A4.2 SCALE 1 1/2" = 1'-0"

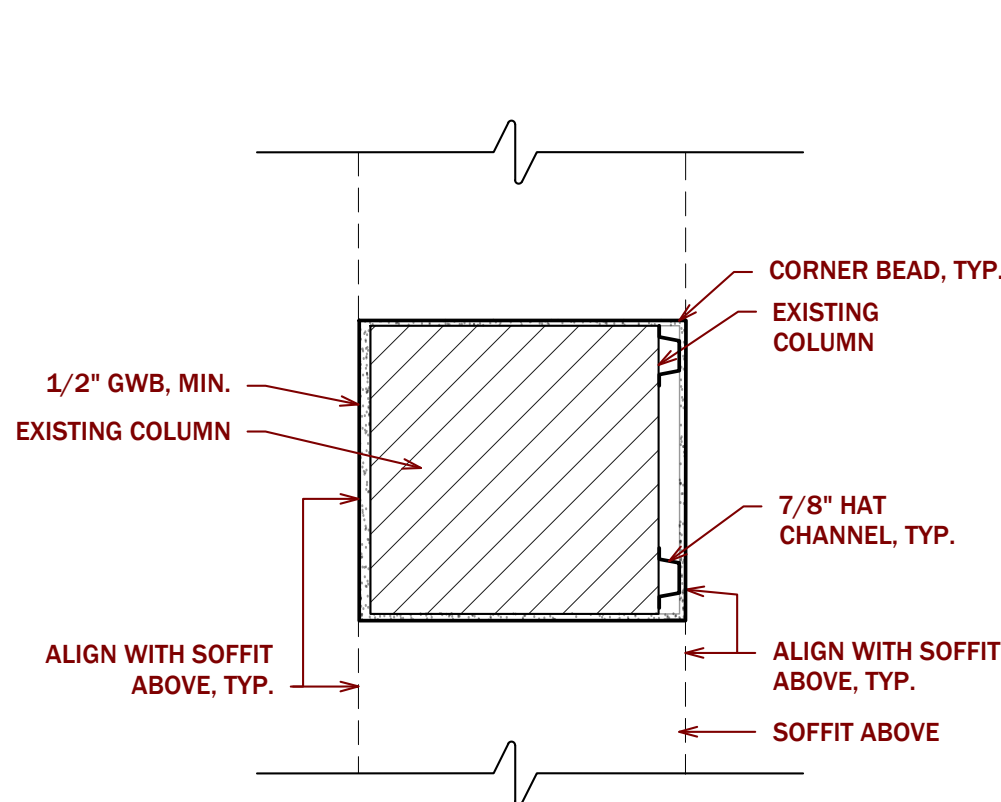

4 COLUMN PLAN DETAIL
A4.2 SCALE 1 1/2" = 1'-0"

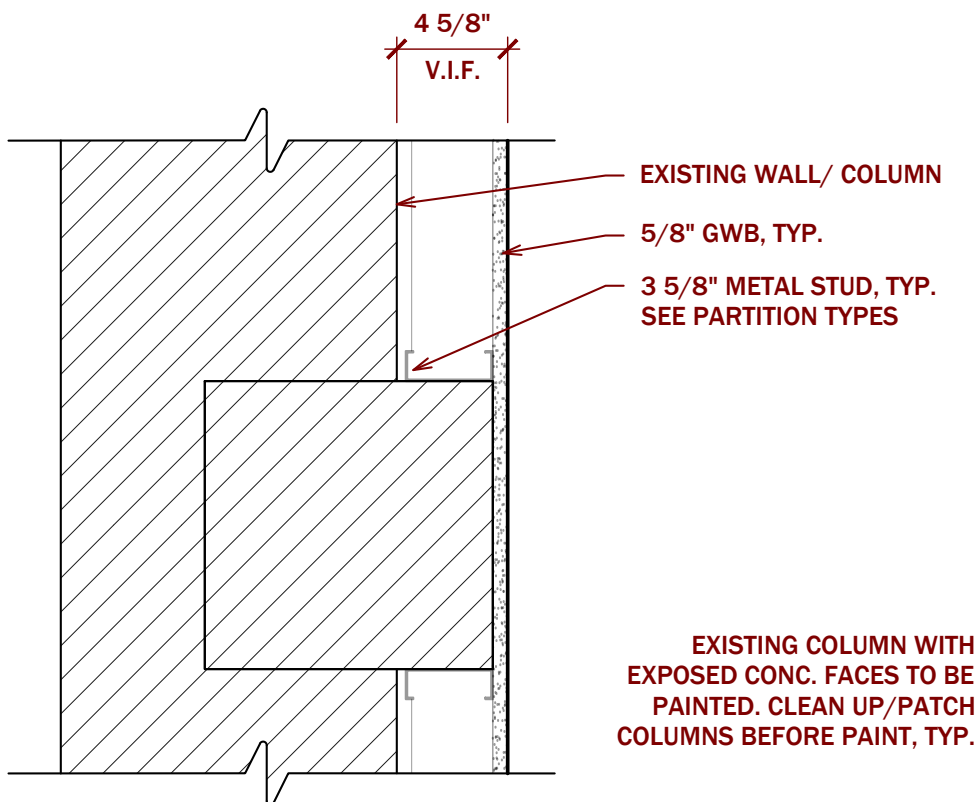

3 COLUMN PLAN DETAIL
A4.2 SCALE 1 1/2" = 1'-0"

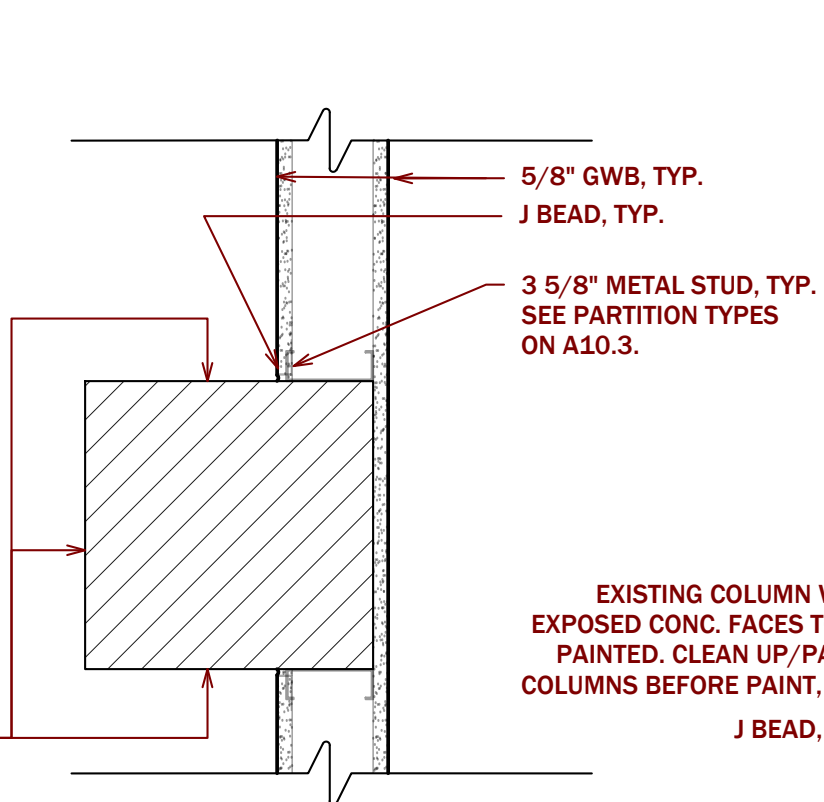

2 COLUMN PLAN DETAIL
A4.2 SCALE 1 1/2" = 1'-0"

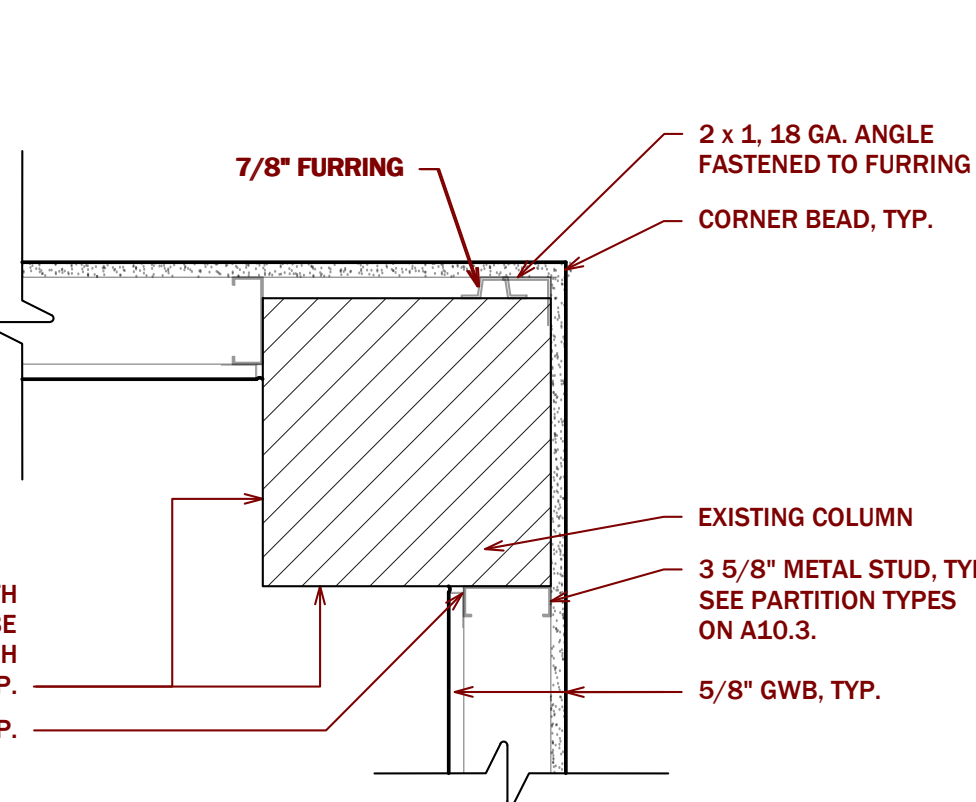

1 COLUMN PLAN DETAIL
A4.2 SCALE 1 1/2" = 1'-0"