

GENERAL NOTES:

1. ALL EXIT LIGHTING SHALL BE WIRED AHEAD OF ANY SWITCHING.

WORK NOTES:

- 1 THE LIGHTING SHALL BE CONNECTED TO EXISTING CIRCUIT AND LIGHTING CONTROL SERVING THE REMAINDER OF CORRIDOR THAT IS NOT BEING RENOVATED. REPLACE EXISTING SWITCH WITH NEW AS SHOWN AND PROVIDE 3-WAY AND 4-WAY AS REQUIRED TO HAVE FULL FUNCTIONAL CORRIDOR LIGHTING OPERATING SIMULTANEOUSLY.
- 2 WIRE FIXTURE TO CORRIDOR LIGHTING AHEAD OF SWITCHING. FIXTURES SHALL BE CONTROLLED VIA PHOTOCELL TYPE TORK 2001 SERIES PHOTOCELL MOUNTED ON THE SIDE OF THE BUILDING.
- 3 GFI RECEPTACLE FOR CONVENIENCE IN ELEVATOR PIT AND TOP OF SHAFT. COORDINATE LOCATION OF POWER WITH ELEVATOR VENDOR BEFORE THE START OF ANY WORK.
- 4 PROVIDE POWER FOR WALL HEATERS. THE ELECTRICAL CONTRACTOR SHALL PROVIDE WALL HEATER MANUFACTURER: Q MARK MODEL #AWH3180F.
- 5 PROVIDE DISCONNECT "JH1" WITH AUXILIARY DRY CONTACTS. REFER TO NOTE 11 REGARDING LOW VOLTAGE WIRING INTERCONNECTION WITH "JH". PROVIDE 3#4+1#6GND IN 1-1/4"TC FROM "JH1" TO "JH". ALSO PROVIDE 3#4+1#6GND IN 1-1/4"TC TO FUSE BOX. COORDINATE WITH SCHINDLER BEFORE THE START OF ANYWORK THE EXACT LOCATION AT TO OF SHAFT THEY WILL INSTALL THEIR FUSE BOX.
- 6 REPLACE EXISTING 250 AMP 3 POLE FUSES IN DISCONNECT SWITCH LABELED PP-AUTO WITH 400 AMP 3 POLE FUSES. REFER TO EXISTING RISER DIAGRAM FOR ADDITIONAL INFORMATION.
- 7 PROVIDE RECEPTACLE FOR SUMP PUMP IN ELEVATOR PIT.
- 8 PROVIDE DIRECT OUTSIDE PHONE LINE FROM ELEVATOR TO MAIN PBX OUTSIDE ELECTRICAL ROOM. ALLOW FOR 400'-0" DISTANCE.
- 9 PROVIDE A COLUMBIA 4' LINEAR VAPORTITE LIGHT FIXTURE WITH SWITCHABLE LUMENS (7000,5000/4500) 4000K COLOR TEMP. MODEL #CV14-LS40. PROVIDE A LIGHT SWITCH NEAR LADDER IN PIT AND AT TOP OF SHAFT BY ELEVATOR DOOR. COORDINATE EXACT AND FINAL LOCATION OF LIGHT SWITCH AND LIGHT FIXTURE WITH ELEVATOR VENDOR BEFORE THE START OF ANY WORK. FIXTURE SHALL PROVIDE 1 FOOT-CANDLE LIGHT IN HOISTWAY.
- 10 PROVIDE EXHAUST FAN MODEL: GREENHECK GB-240HP-A-6-VG/VGD-1-34-X. PROVIDE 2#12+1#12G IN 3/4"TC TO PANEL AS SHOWN. PROVIDE 1P-20 AMP BREAKER AT PANEL. PROVIDE A REVERSE ACTING THERMOSTAT. GC SHALL BE RESPONSIBLE OF THE FLASHING AND THE CURB.

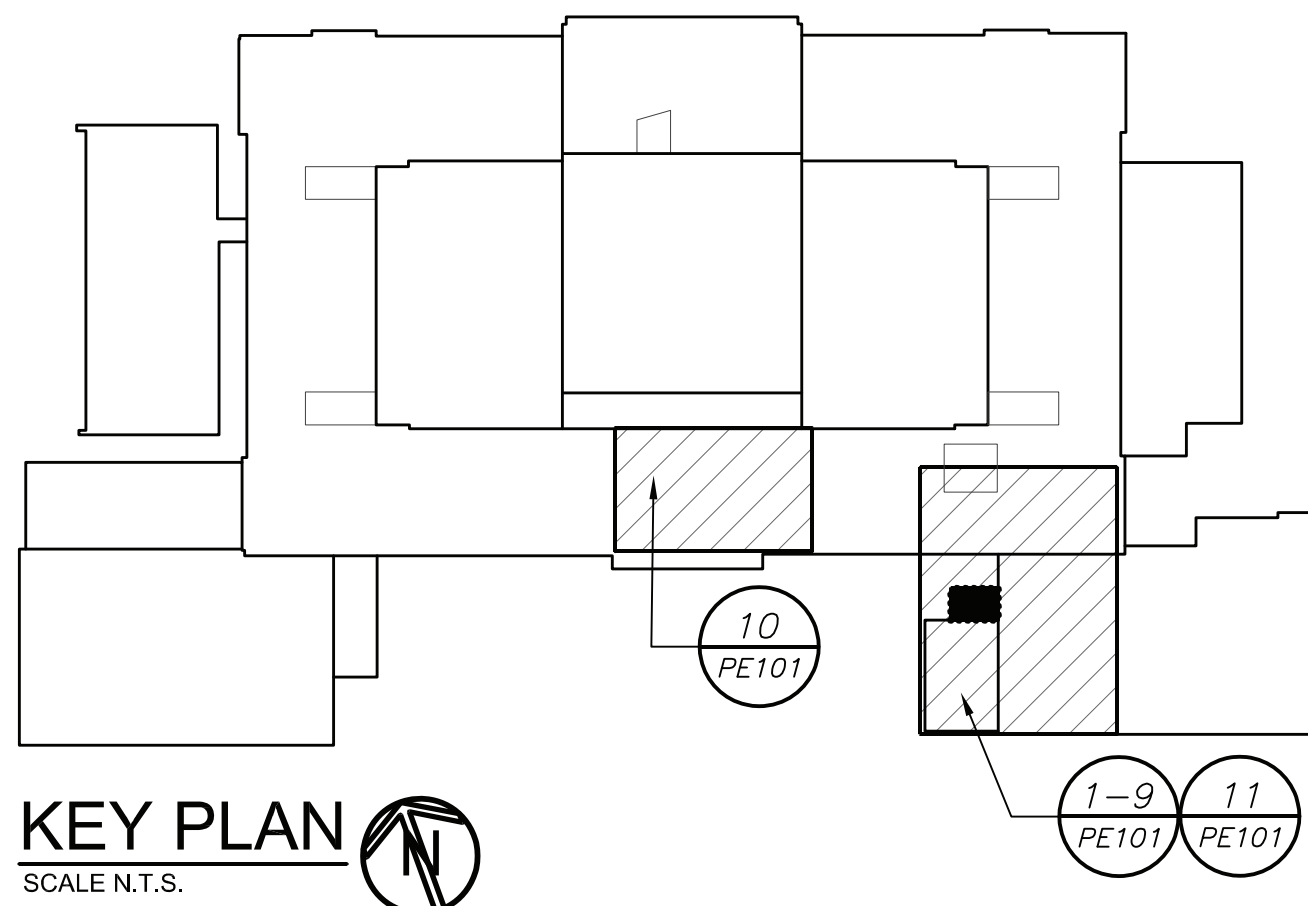

KEY PLAN
SCALE N.T.S.

- 11 CONNECT TO DISCONNECT SWITCH "JH1". CONNECT TO ELEVATOR CAR LIGHT AND VENT AS REQUIRED. COORDINATE WITH ELEVATOR VENDOR BEFORE THE START OF ANY WORK.
- 12 PROVIDE DISCONNECT SWITCH "JH" WITH AUXILIARY DRY CONTACT. PROVIDE A PAIR OF 600V-LISTED 75°C, 18 AWG STRANDED COPPER CONDUCTORS FROM "JH" TO "JH1" AT TOP OF SHAFT. FROM "JH1" TO CONTROLLER AT TOP OF SHAFT, LEAVE 30'-0" OF A PAIR OF 18AWG WIRE COILED FOR VENDOR TO CONNECT TO THEIR CONTROLLER.
- 13 PROVIDE SMOKE DETECTOR AT TOP OF STAIRS.

AS PER USA CONGRESS ARCHITECTURAL WORKS COPYRIGHT PROTECTION ACT OF 1990 ALL IDEAS AND DESIGNS INCLUDING DERIVATIVES THEREOF, ALL DRAWINGS AND SPECIFICATIONS CONSTITUTE THE ORIGINAL COPYRIGHT WORK BY FULLER AND DANIELO, P.C. (F&D). THE DRAWINGS AND SPECIFICATIONS AS INSTRUMENTS OF SERVICE BY F&D ARE CREATED BY F&D FOR THIS PROJECT ONLY AND REMAIN THE PRODUCT AND PROPERTY OF F&D. ANY REPRODUCTION WITHOUT THE PRIOR CONSENT OF F&D IS PROHIBITED.

BARILE GALLAGHER & ASSOCIATES
CONSULTING ENGINEERS
39 MARBLE AVE. PLAINSVILLE, NY 10579
914.338.6600 Central@BG&A.com www.BG&A.com

FULLER DANIELO P.C.
ARCHITECTS PLANNERS
48 KNEELAND ROAD ELMSFORD NEW YORK 10523
TEL 914.898.4444 FAX 914.898.1917
www.fdufuller.com
Copyright 2011 All Rights Reserved by Fuller & DanieLO

S.E.D. CONTROL NUMBER:
66-23-00-01-0-204-019

PROJECT TITLE
YONKERS SCHOOL DISTRICT
GORTON HIGH SCHOOL
CAPITAL IMPROVEMENT PHASE 3
100 SHAWNEE PLACE, YONKERS, NY 10595

DRAWING TITLE
GROUND FLOOR, FIRST FLOOR, AND SECOND FLOOR ELECTRICAL, POWER, FIRE ALARM AND PLUMBING PLAN

12-20-2021	BID
DATE	ISSUED TO
SHEET SIZE 30"x42"	DRAWING NO. PE101
SCALE AS NOTED	FILE NO. 20373.00
DRAWN BY F & D	