

777 Old Saw Mill River Road
Tarrytown, NY 10591-6707
T: 914.847.7400
F: 914.847.7991
www.regeneron.com

Building #17
Campus Expansion Child
Day-care Center

899 Old Saw Mill River Road
Mount Pleasant, NY 10591

Project No. B17-DAYCARE

Architect

Gensler

1700 Broadway, Suite 400
New York, NY 10019
(212) 492-1400 Phone
(212) 492-1472 Fax

Structural Engineer

Thornton Tomasetti
120 Broadway, 15th Floor
New York, NY 10071
(917) 661-7800 Phone
(917) 661-7801 Fax

MEP / IT / Security Engineer

Cosentini Associates
498 Seventh Avenue
New York, NY 10018
(212) 615-3600 Phone
(212) 615-3700 Fax

Civil Engineer

JMC
120 Bedford Road
Armonk, NY 10504
(914) 273-5225 Phone
(914) 273-2102 Fax

Landscape Architect

Langan
21 Penn Plaza, 360 West 31st Street, 8th Floor
New York, NY 10001
(212) 479-5400 Phone
(212) 479-5444 Fax

Key Plan

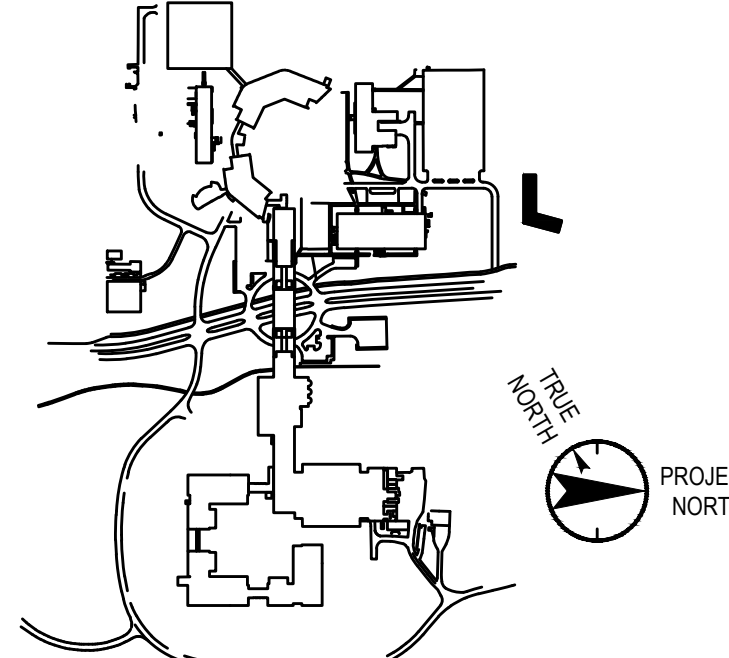

No. Date Description

0 06.20.2022 100% CONSTRUCTION DOCUMENTS
1 07.01.2022 100% CONSTRUCTION DOCUMENTS-1

Plot Date: 07.01.2022

ALL DRAWINGS AND WRITTEN MATERIALS REPRESENTED ON THIS SHEET CONSTITUTE THE COPYRIGHTED WORK AND ARE THE SOLE PROPERTY OF REGENERON PHARMACEUTICALS. THIS SHEET MAY NOT BE REPRODUCED OR COPIED IN WHOLE OR IN PART, NOR MAY ANY OF THE DRAWINGS OR WRITTEN MATERIALS APPEARING HEREIN BE REPRODUCED INTO ANOTHER WORK FOR ANY REASON WITHOUT THE WRITTEN CONSENT OF REGENERON PHARMACEUTICALS. THIS SHEET MAY BE REPRODUCED FOR THE PROJECT ONLY. REGENERON PHARMACEUTICALS, IF REGENERON NAMES OR AUTHORIZES REUSE OF ANY SUCH DOCUMENT OR INFORMATION PROVIDED BY DESIGN PROFESSIONAL OUTSIDE OF THE PROJECT WITHOUT THE EXPRESS WRITTEN CONSENT OF DESIGN PROFESSIONAL, REGENERON ASSUMES FULL RESPONSIBILITY FOR ANY AND ALL ISSUES PROVIDED IN SUCH REUSE.

Professional Seal and Signature

Vendor Name: COSENTINI
Vendor Project No.: 210104
Discipline: TELECOM Drawn By: PG
TELECOM DETAILS SHEET #2

Scale: N.T.S. Floor:

T-501

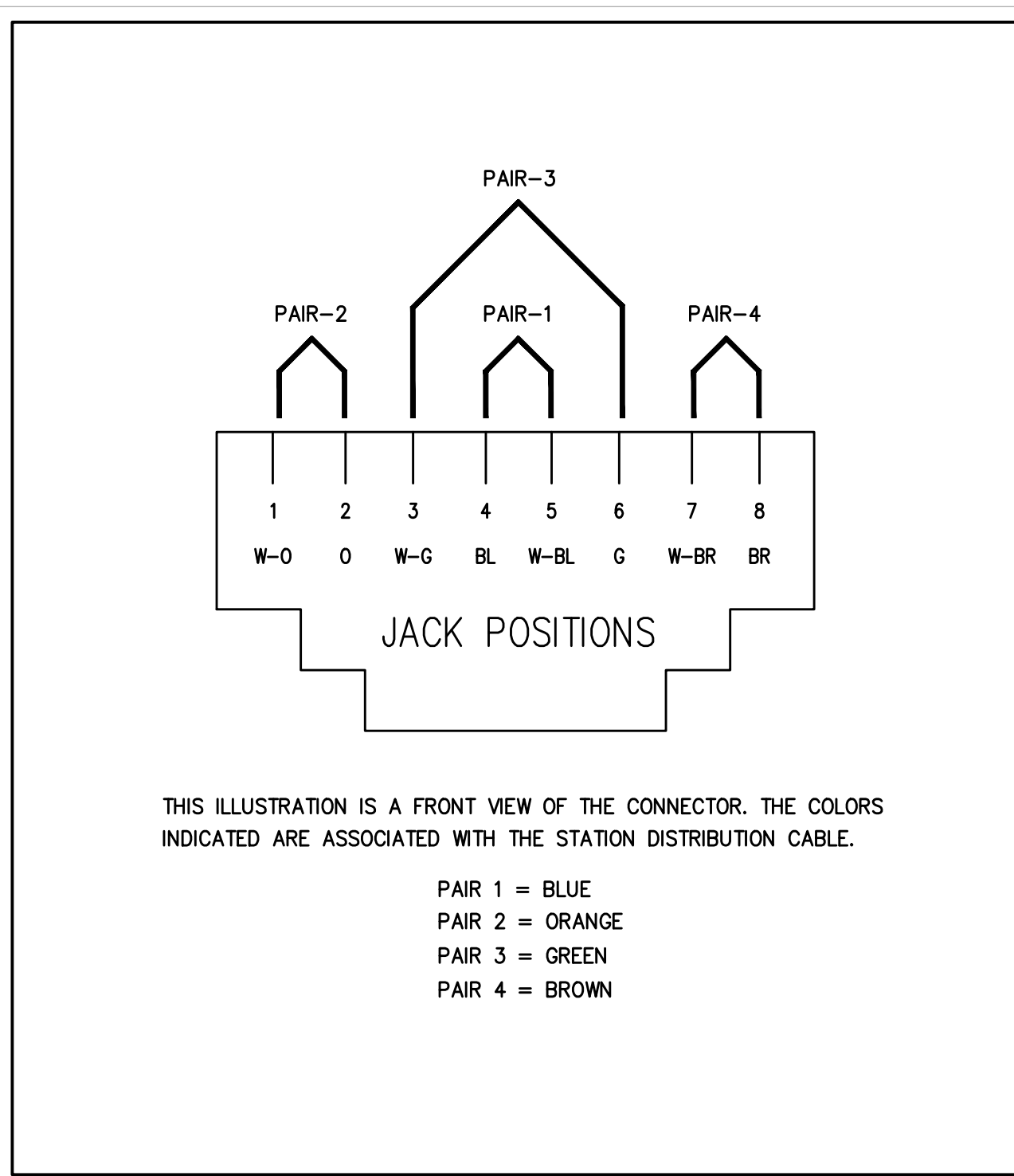

8 POSITION JACK PIN/PAIR
ASSIGNMENTS (DESIGNATION T568B)
NOT TO SCALE

01

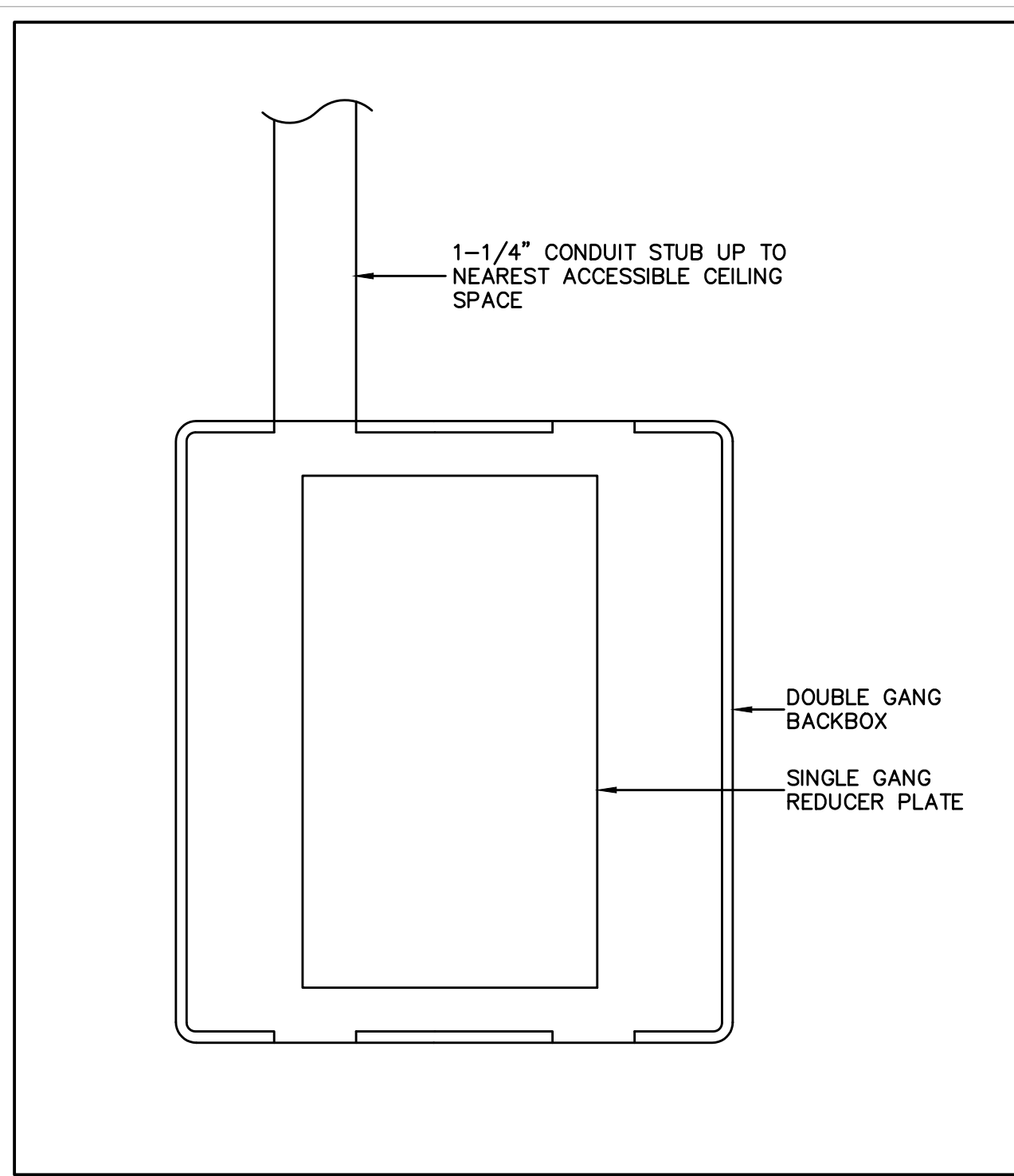

TYPICAL BACKBOX FOR WALL-MOUNTED
TELECOM OUTLET LOCATIONS
NOT TO SCALE

02

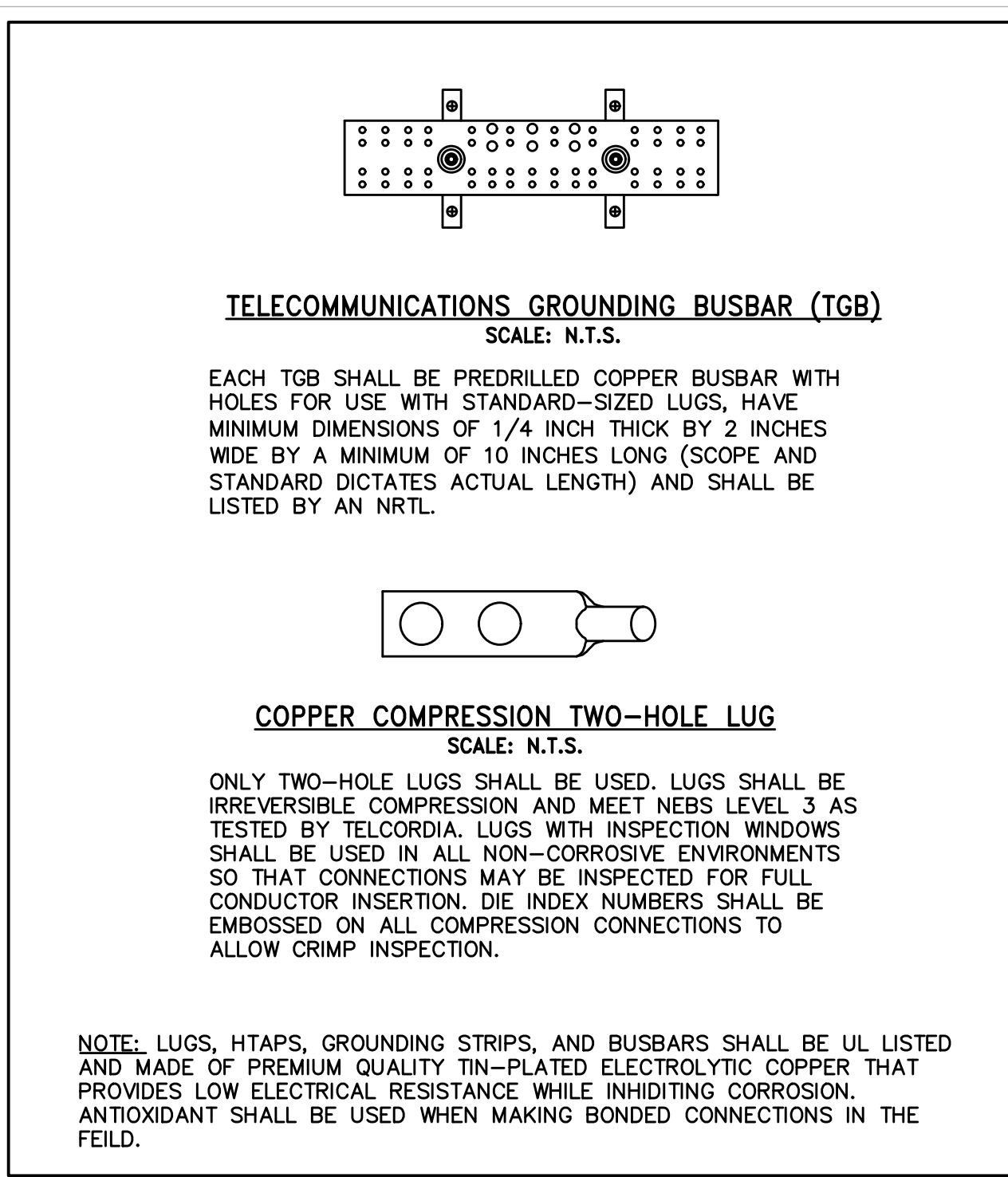

GROUNDING BUSBAR DETAILS AND NOTES
NOT TO SCALE

03

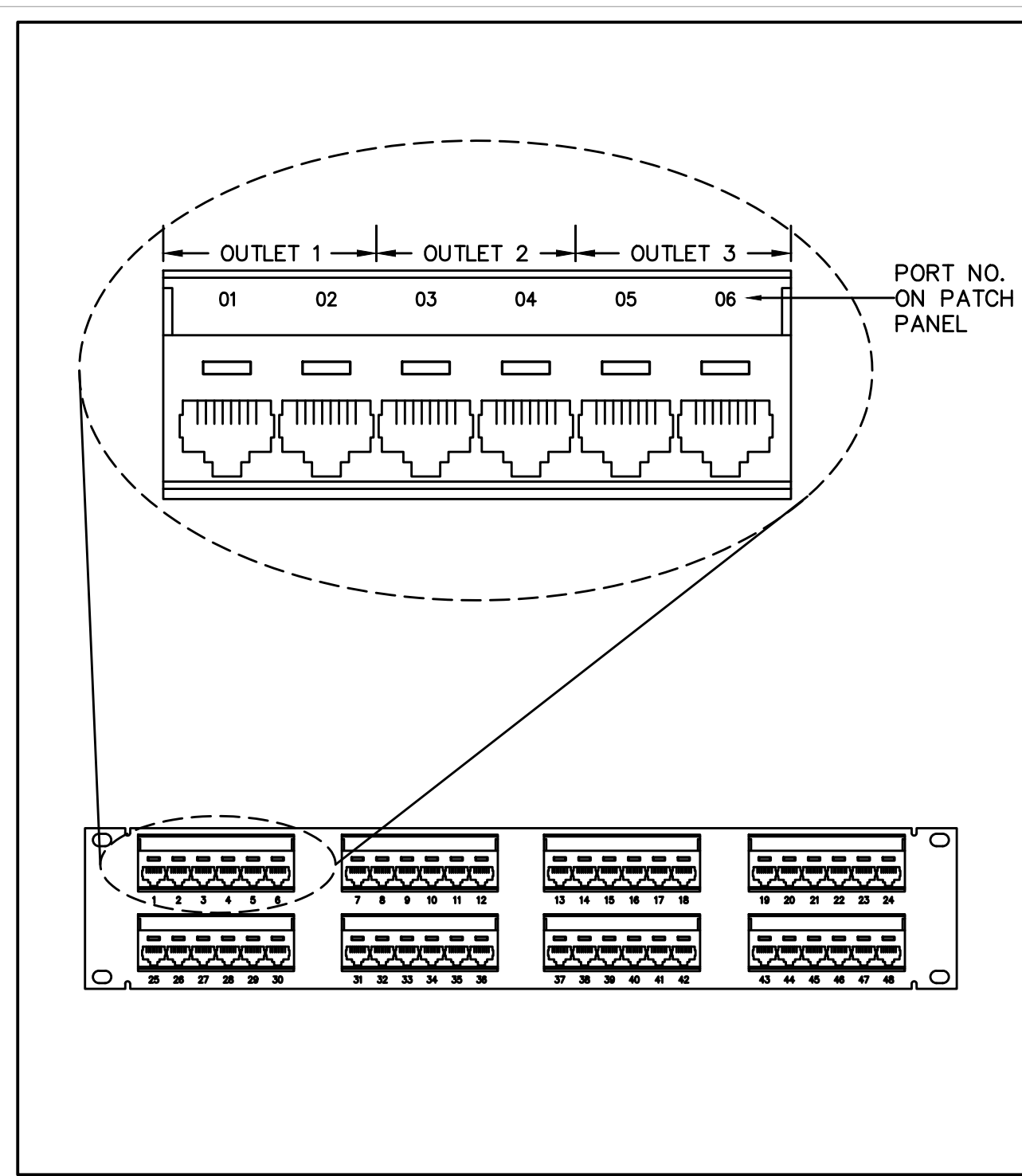

TYPICAL PATCH PANEL LABELLING
SCHEME
NOT TO SCALE

04

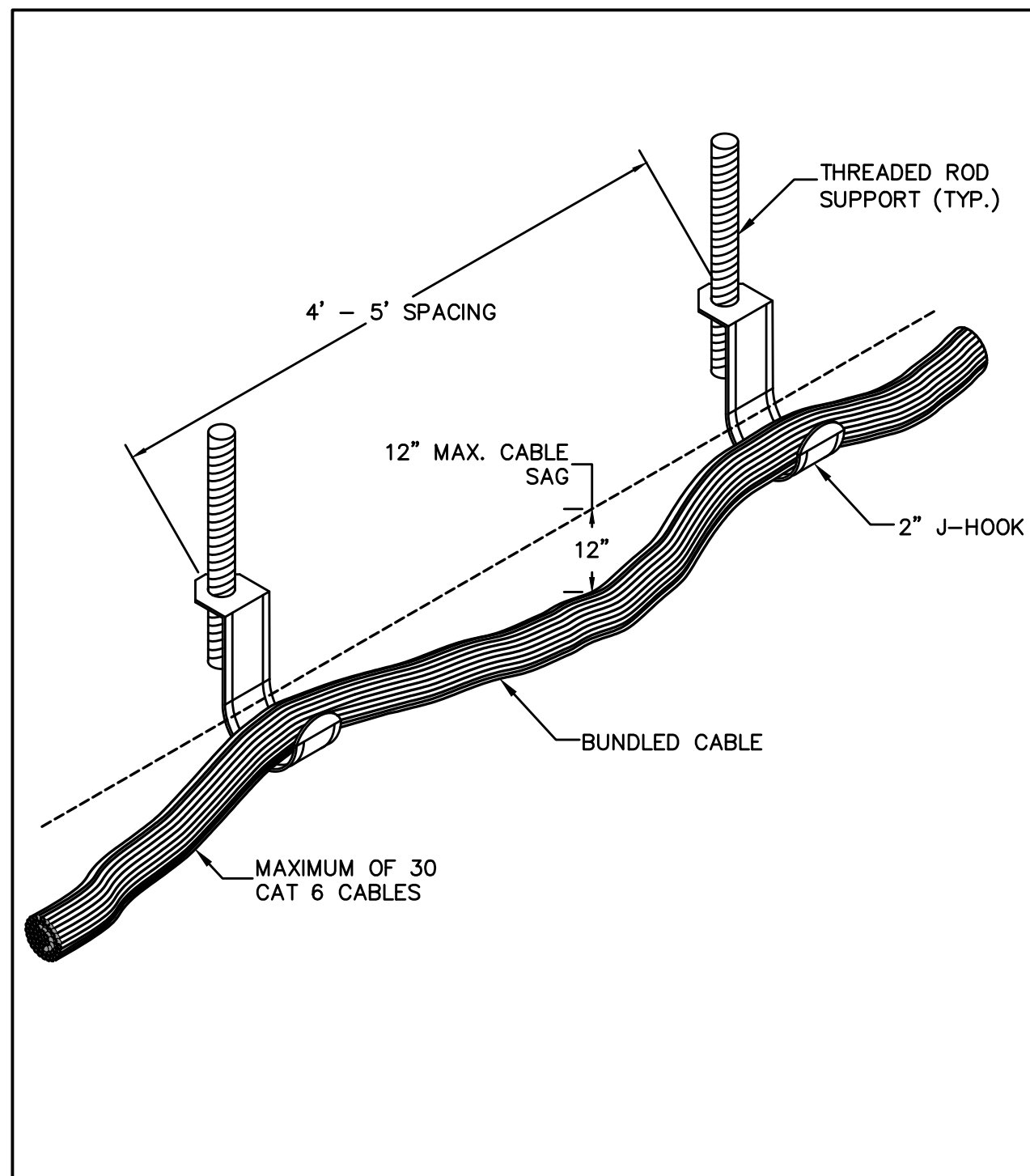

J-HOOK SUPPORT DETAIL
NOT TO SCALE

05

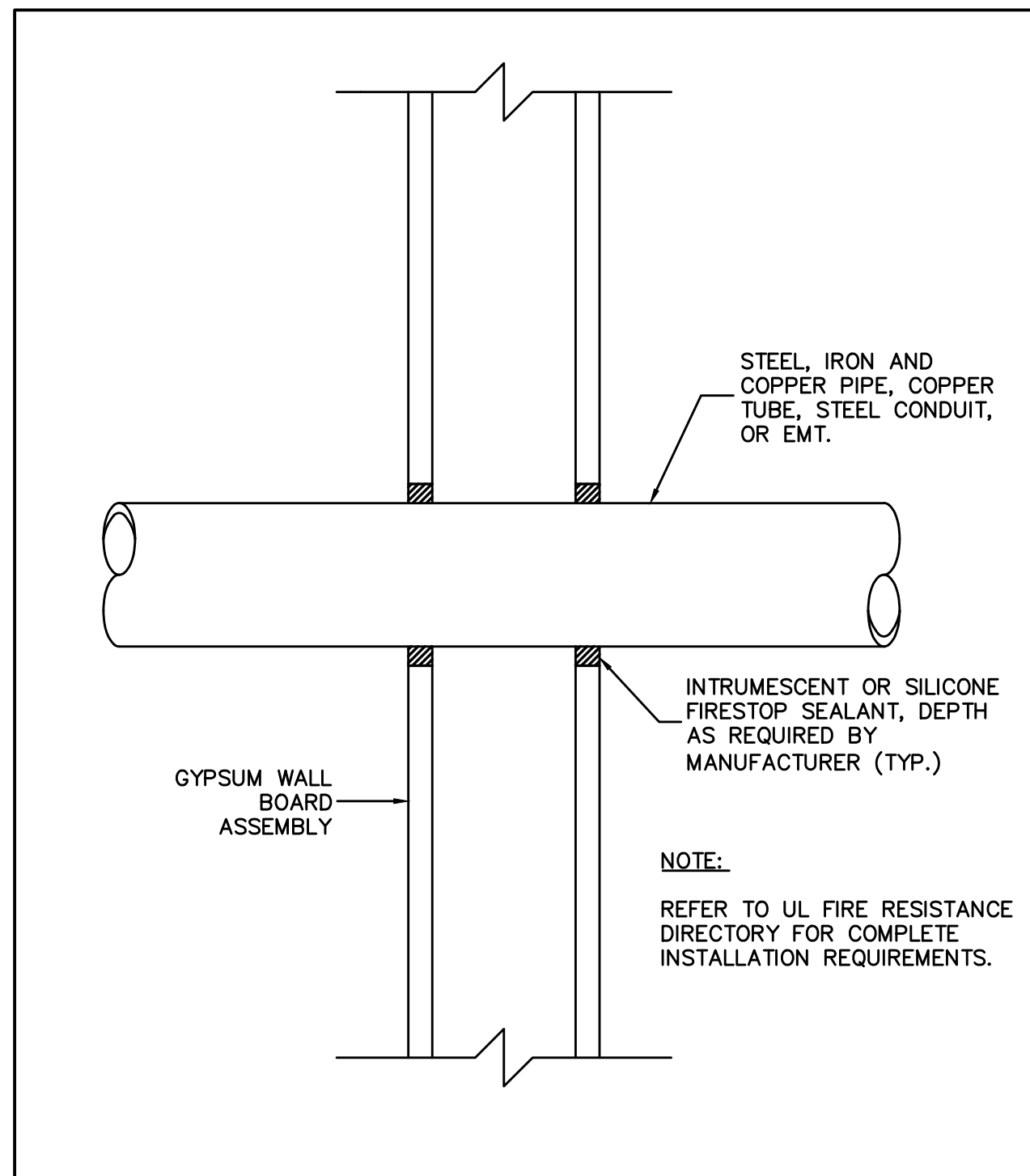

METALLIC PIPE THROUGH GYPSON WALL
BOARD WITH FIRE RATED SEALANT
NOT TO SCALE

06

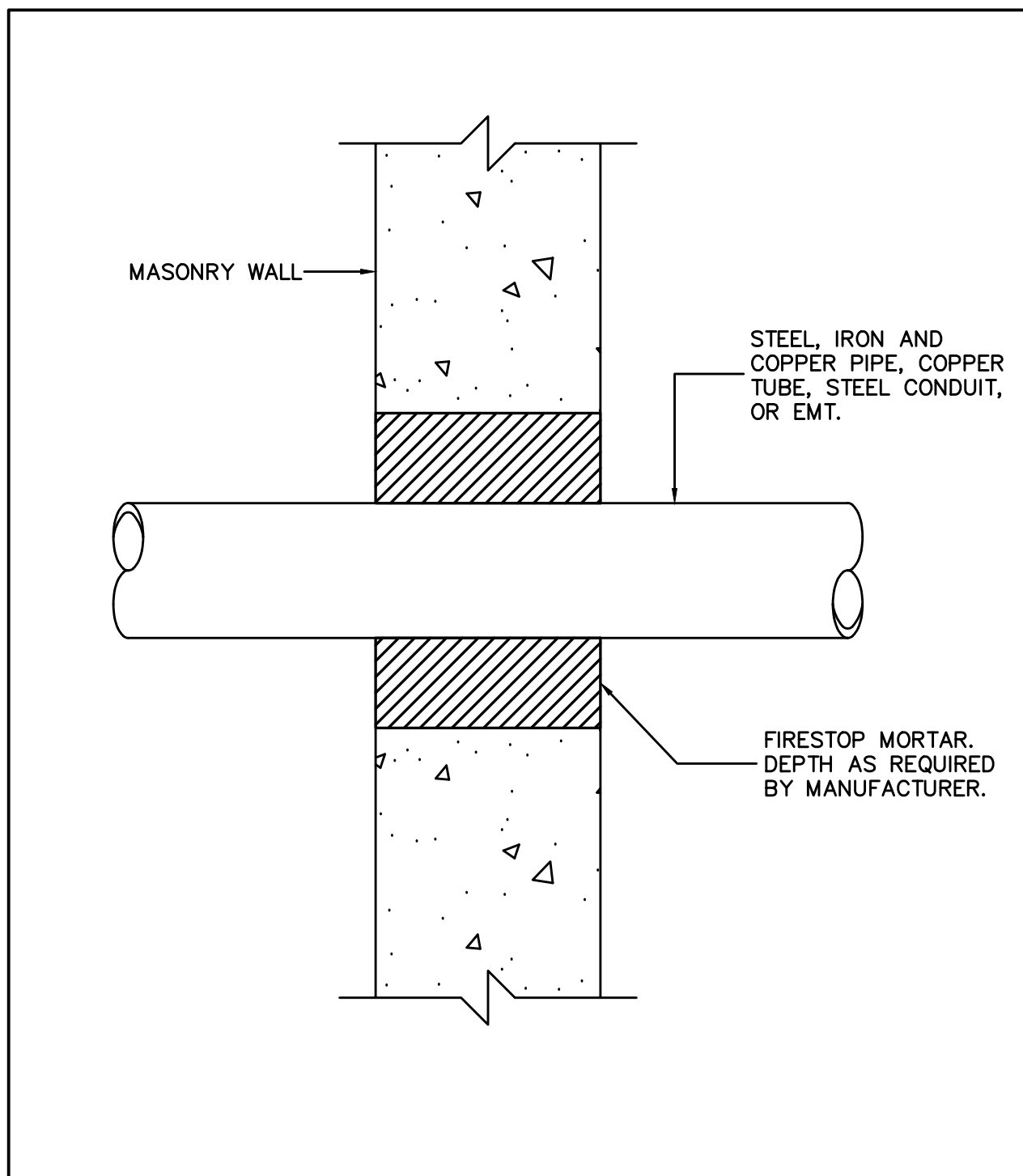

METALLIC PIPE THROUGH CONCRETE
WALL WITH FIRE RATED SEALANT
NOT TO SCALE

07

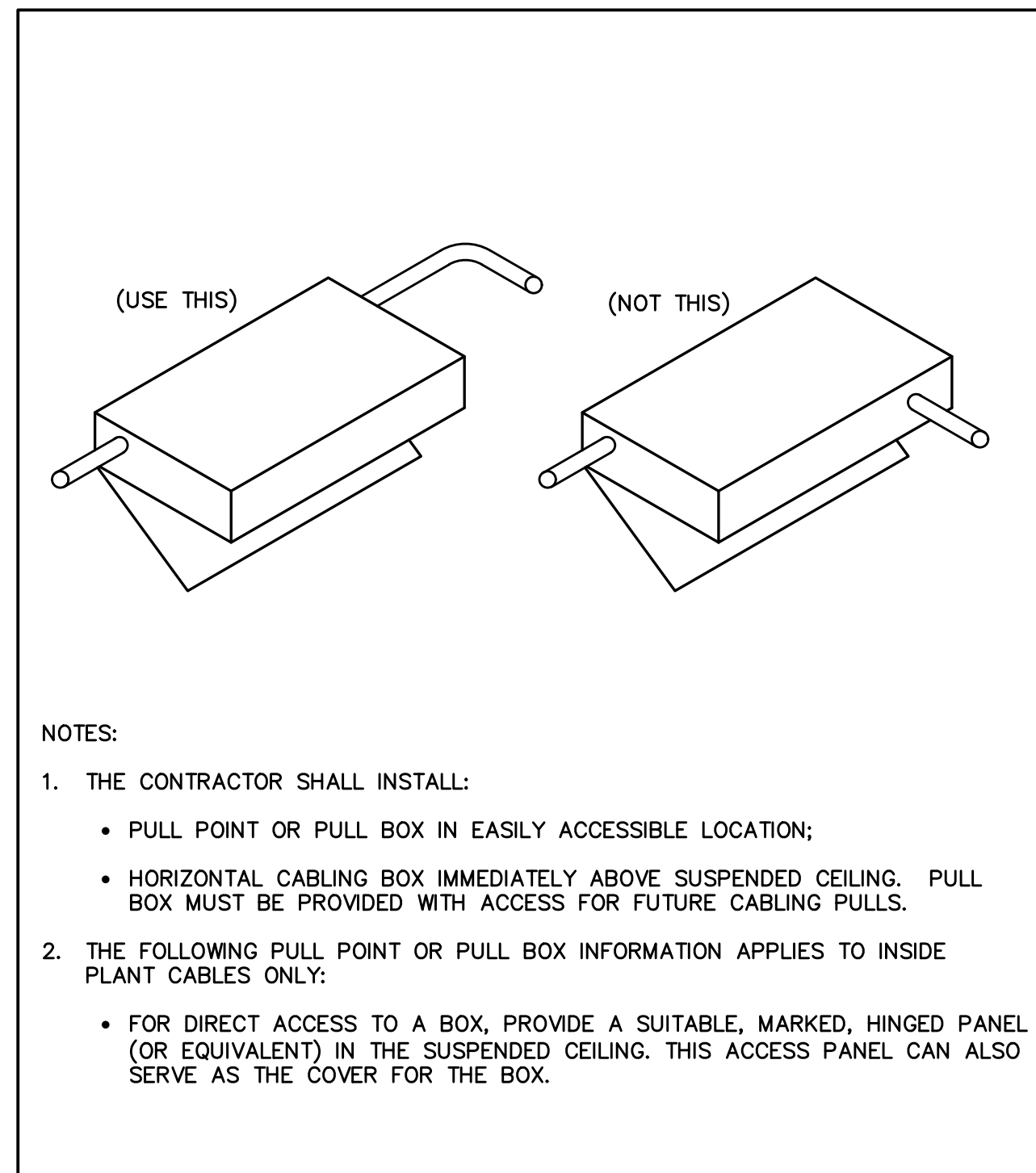

PULLBOX INSTALLATION FOR
CONDUIT RUNS
NOT TO SCALE

08

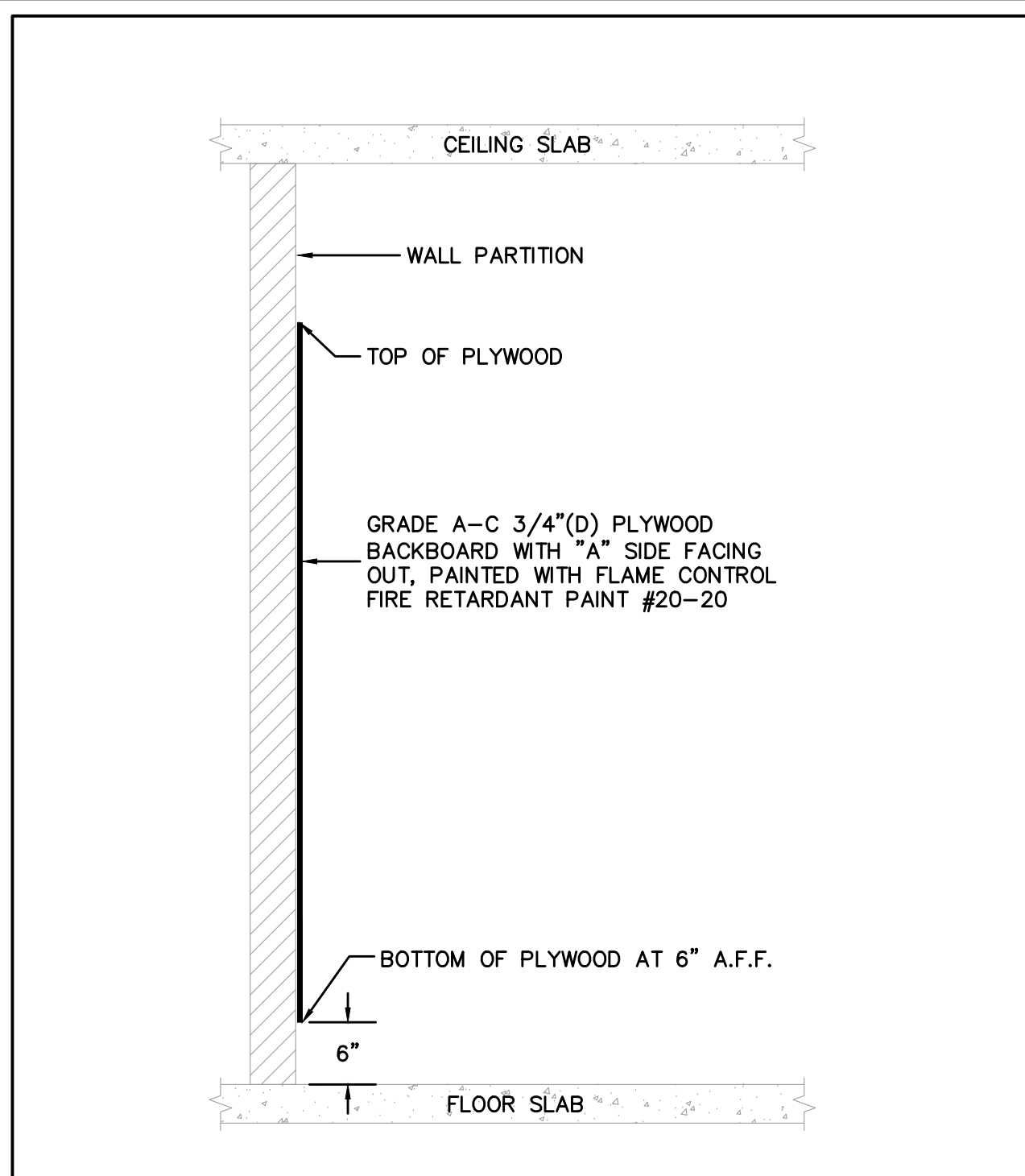

TYPICAL TELECOM ROOM WALLFIELD
CONSTRUCTION
NOT TO SCALE

09

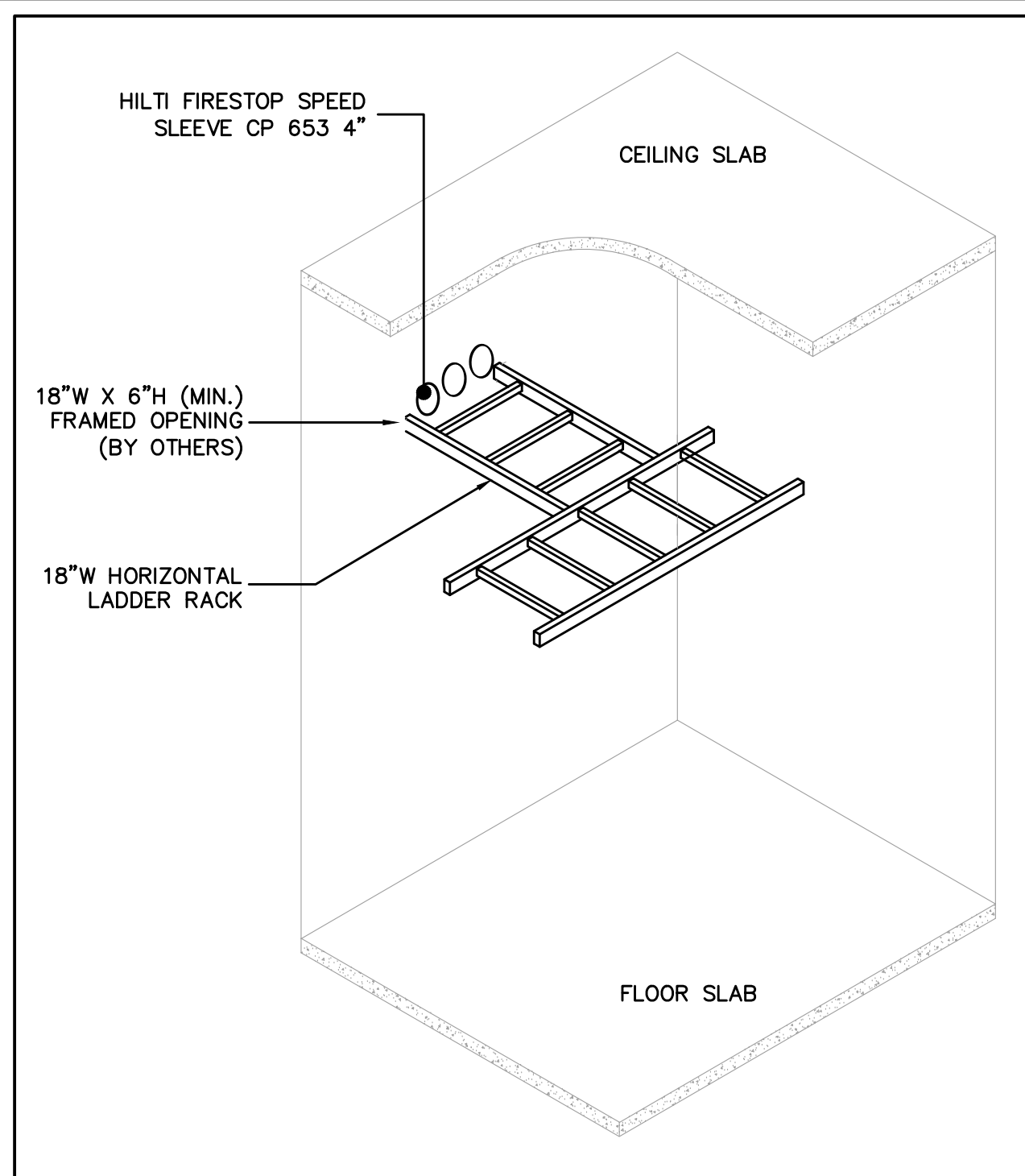

LADDER RACK PENETRATION THROUGH
TELECOM ROOM FRAMED OPENING
NOT TO SCALE

10

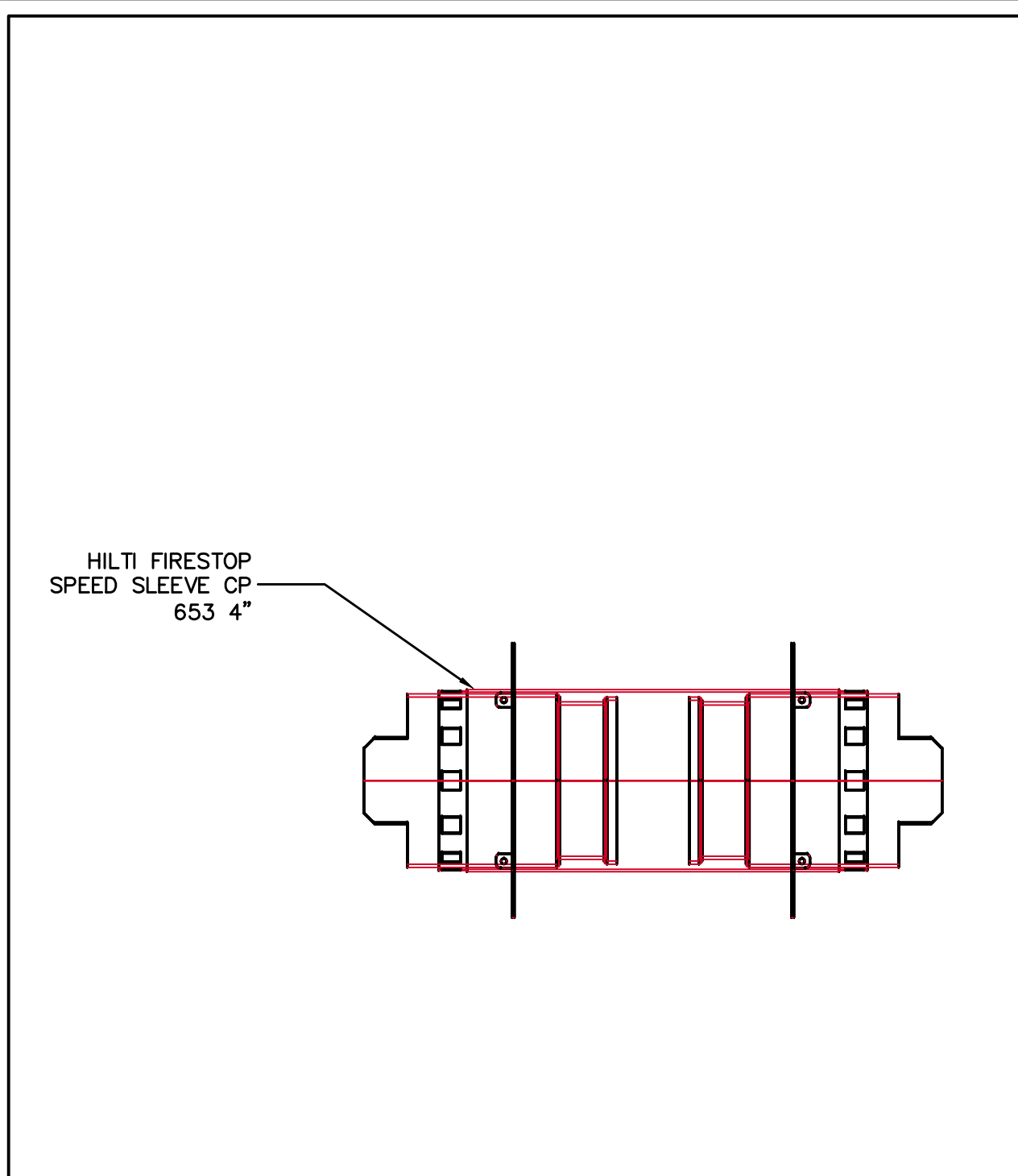

TYPICAL IT ROOM WALL PENETRATION 4"
HILTI SPEED SLEEVE DETAIL
NOT TO SCALE

11

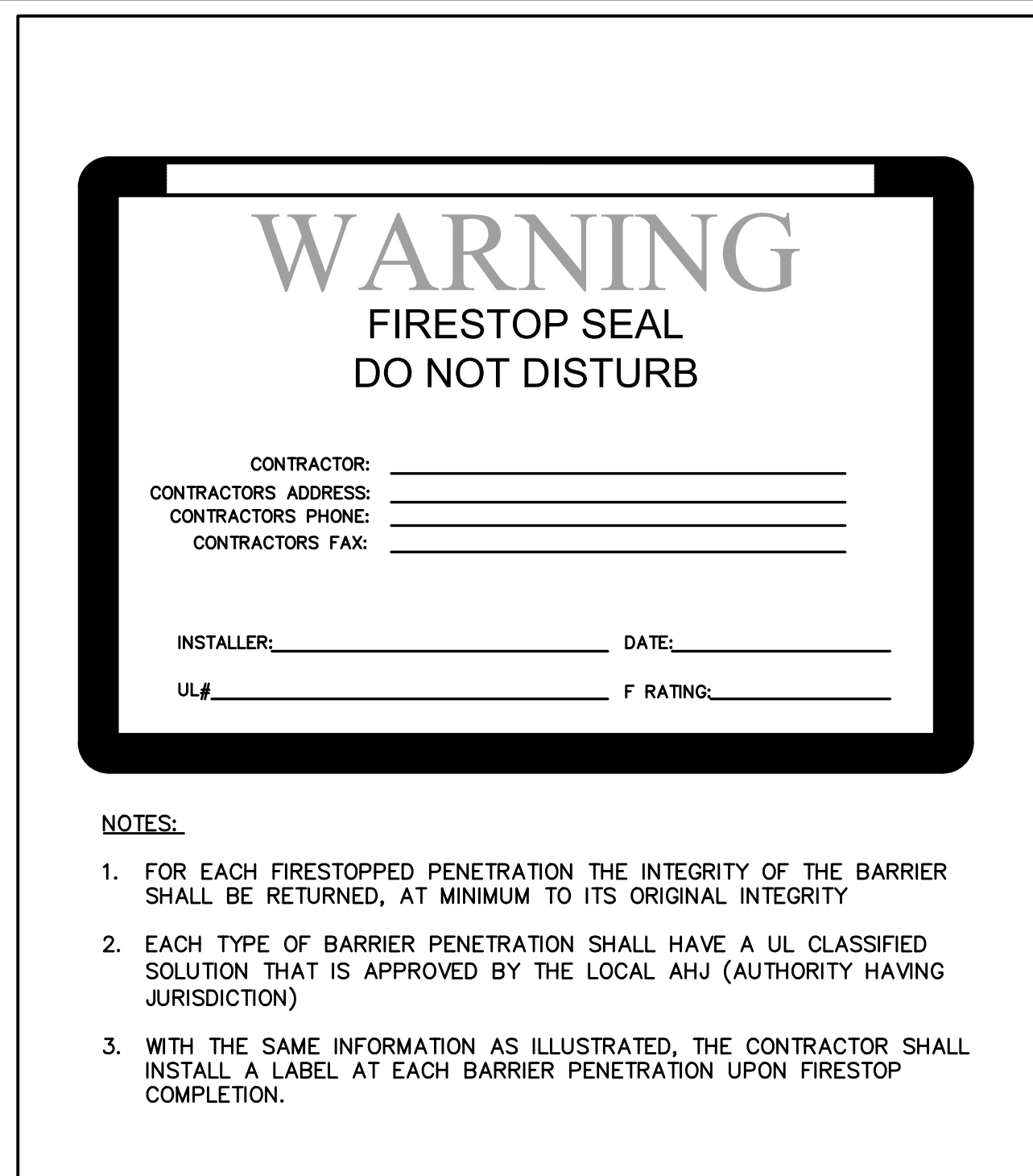

FIRESTOP SEAL
NOT TO SCALE

12

TO THE BEST OF MY KNOWLEDGE, BELIEF AND PROFESSIONAL JUDGMENT, THESE PLANS AND SPECIFICATIONS ARE IN COMPLIANCE WITH THE 2020 ENERGY CONSERVATION CODE OF NYS

This plan is approved only for work indicated on the application specification sheet. All other matters shown are not to be relied upon, or to be considered as either being approved or in accordance with applicable codes.

Alterations or additions to this engineering document by an unlicensed person is a violation of Chapter 16, Title VIII, Article 145 § 7209.2 of the New York State Education Law.