

PLUMBING SPECIALTIES		
TAG	SPECIFICATION	DESIGN BASIS
FD-A	3" floor drain with trap seal and deep seal trap, Dura-Coated cast iron body with bottom outlet, combination invertible membrane clamp and adjustable collar with seepage slots and polished nickel bronze top. Sure Seal Model 3000 Inline Floor Drain Trap Sealer. Floor rating ASSE-1072 AF-GW.	ZURN Z415-ZN
DPCO-A	Adjustable floor cleanout, Dura-Coated cast iron body, with gas and watertight ABS tapered thread plug, and round scoriated polished nickel bronze secured top adjustable to finished floor.	ZURN Z1400

PLUMBING FIXTURE SCHEDULE								
TAG	DESCRIPTION	TRIM AND ACCESSORIES	MOUNTING	CONNECTIONS				BASIS OF DESIGN
				SAN	VENT	CW	HW	
WC-A	FLOOR MOUNTED PRESSURE ASSIST TOILET, 1.1 GPF, WHITE VITREOUS CHINA, ELONGATED BOWL.	ELONGATED TOILET SEAT WITH SLOW CLOSE SNAP-OFF HINGES. QUARTER TURN WALL STOP CHROME PLATED BRASS ONE-PIECE ESCUTCHEON.	FLOOR	3	2	½"	-	AMERICAN STANDARD CADET RIGHT HEIGHT MODEL 2467.100
UR-A	WALL MOUNTED HIGH EFFICIENCY URINAL, 0.12F GPF, WHITE VITREOUS CHINA, WASHOUT FLUSH.	SLOAN ROYAL 186-0.125-DBP MANUAL FLUSHOMETER. FLOOR MOUNTED CARRIER.	WALL	2	1½"	¾"	-	AMERICAN STANDARD DECORUM MODEL 6042.001EC
LAV-A	WALL-HUNG LAVATORY, 18-1/2" x 17" OVERALL. WHITE VITREOUS CHINA.	WALL HANGER. AMERICAN STANDARD MONTERREY SINGLE CONTROL CENTERSET FAUCET LESS POP-UP DRAIN. CHROME PLATED GRID STRAINER. QUARTER TURN WALL STOPS. 1-1/4" CAST BRASS TRAP. CHROME PLATED BRASS ONE-PIECE ESCUTCHEONS.	WALL	1½"	1½"	½"	½"	AMERICAN STANDARD DECLYN MODEL 0321.026
SHA	- 2" PERFORATED CHROME PLATED BRASS SHOWER DRAIN ASSEMBLY.	SHOWER PACKAGE INCLUDING HANDSHOWER, SHOWERHEAD, 60" HANDSHOWER HOSE, WALL SUPPLY ELBOW, SHOWER ARM, WALL DIVERTER VALVE, PRESSURE BALANCE SHOWER VALVE, TRIM, POLISHED CHROME FINISH.	-	2"	1½"	½"	½"	KOHLER SHOWER PACKAGE: BELLWETHER K-9178 DRAIN COVER K-9159 SHOWER DRAIN K-9132 FORTE HANDSHOWER K-22165 FORTE SUPPLY ELBOW K-22174 FORTE SLIDEBAR TRIM KIT K-349 TRANSFER VALVE K-728-K TRANSFER VALVE TRIM K-T10290 SHOWER VALVE K-8304-KS SHOWER VALVE TRIM K-TS10276-4 30" SLIDEBAR K-8524 80" SHOWER HOSE K-9514

ELECTRIC WATER HEATER SCHEDULE											
TAG	LOCATION	NO. OF ELEMENTS	ELEMENT WATTAGE (UPPER / LOWER)	OPERATION	MAX WORKING PRESSURE (PSIG)	CAPACITY (GAL)	RECOVERY		ELECTRICAL		DESIGN BASIS
							GPH	TEMP RISE	VOLTAGE	AMPS	
EW-H-1	MECHANICAL 110	2	4500 / 4500	NON-SIMULTANEOUS	150	40	18	100	208/1	21.6	AO SMITH DEN-40

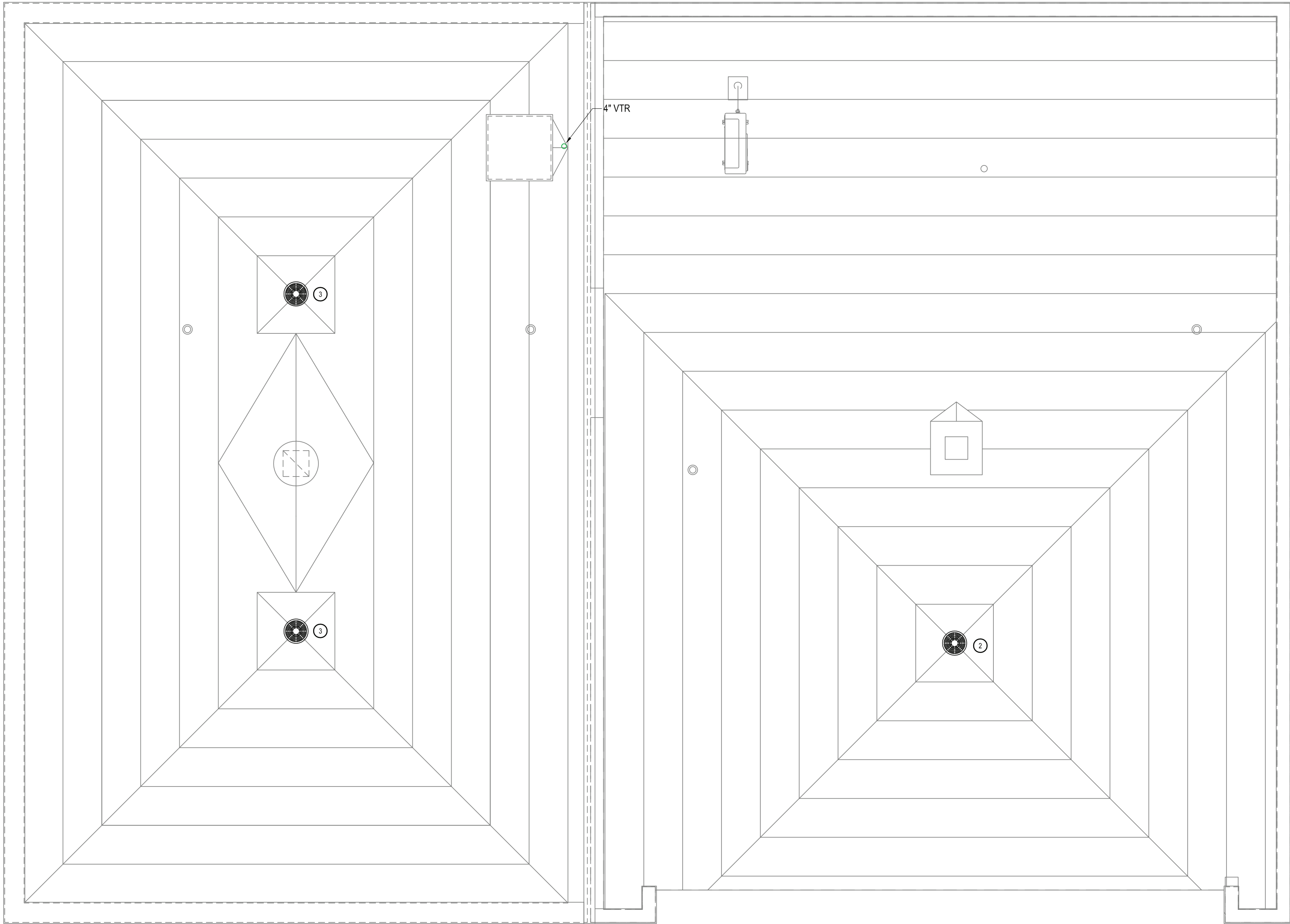

PLUMBING ROOF PLAN
1/4" = 1'-0"

1

DRAWING NOTES

- CONNECT GAS TO UNIT HEATER INSTALLED BY M.C. PROVIDE DIRT LEG AND LISTED SHUTOFF VALVE.
- ROOF DRAIN FURNISHED AND INSTALLED BY THE GC. CONNECT TO EXISTING ROOF LEADER.
- EMERGENCY OVERFLOW TYPE ROOF DRAIN FURNISHED AND INSTALLED BY THE GC. PROVIDE STORM AND OVERFLOW PIPING AS INDICATED.
- 4" EMERGENCY OVERFLOW ROOF DRAIN. DROP DOWN TO ZURN Z199 DOWNSPOUT NOZZLE 24" ABOVE GRADE.
- 3/4" COLD SUPPLY TO HOSE BIB MOUNTED 36" AFF.

S

E

N

W

0

2'

4'

8'

GRAPHIC SCALE: 1/4" = 1'-0"

COPYRIGHT© ALL RIGHTS RESERVED

Project Title			

4			
3			
2			
1			
No	Date	Revision	By

Drawn By:	ks
Checked By:	ks
BDS Proj. #:	21-01
Date:	June 3, 2022

Sheet Title	
PLUMBING ROOF PLAN	

Sheet No.	
P-3	
CONSTRUCTION DOCUMENTS	