

PLUMBING ABBREVIATIONS			
A/E	ARCHITECT / ENGINEER	I/W	INDIRECT WASTE
AD	AREA DRAIN	IWH	INSTANTANEOUS WATER HEATER
AD	ACCESS DOOR	KW	KILOWATT
ADA	AMERICANS WITH DISABILITIES ACT	LAV	LAVATORY
AFF	ABOVE FINISH FLOOR	M	METER
AFG	ABOVE FINISHED GRADE	MC	MECHANICAL CONTRACTOR
AHJ	AUTHORITY HAVING JURISDICTION	MBH	1000 BTUH
ANSI	AMERICAN NATIONAL STANDARDS INSTITUTE	MH	MANHOLE
AP	ACCESS PANEL	NC	NORMALLY CLOSED
ASHRAE	AMERICAN SOCIETY OF HEATING, REFRIGERATION & AIR CONDITIONING ENGINEERS	NG	NATURAL GAS
ASME	AMERICAN SOCIETY OF MECHANICAL ENGINEERS	NIC	NOT IN CONTRACT
ASPE	AMERICAN SOCIETY OF PLUMBING ENGINEERS	NOM	NOMINAL
ASPE	AMERICAN SOCIETY OF PLUMBING ENGINEERS	NPW	NON POTABLE WATER
ASPE	AMERICAN SOCIETY OF PLUMBING ENGINEERS	NTS	NOT TO SCALE
AWWA	AMERICAN WATERWORKS ASSOCIATION	O2	OXYGEN
BFG	BELOW FINISHED GRADE	OD	OUTSIDE DIAMETER
BHP	BREAK HORSEPOWER	OSHA	OCCUPATIONAL SAFETY AND HEALTH ADMINISTRATION
BOR	BASE OF RISER	P	PUMP
BTU	BRITISH THERMAL UNIT	PC	PLUMBING CONTRACTOR
BTUH	BRITISH THERMAL UNIT PER HOUR	PD	PUMP DISCHARGE
C	CELSIUS	PDI	PLUMBING AND DRAINAGE INSTITUTE
CA	COMBUSTION AIR	PF	PLUMBING FIXTURE
CA	COMPRESSED AIR	PG	PRESSURE GAGE
CGA	COMPRESSED GAS ASSOCIATION	PPM	PARTS PER MILLION
CI	CAST IRON	PRS	PRESSURE REDUCING STATION
CO	CLEANOUT	PRV	PRESSURE REDUCING VALVE
CO2	CARBON DIOXIDE	PSI	POUNDS PER SQUARE INCH
COND	CONDENSATE	PSIA	POUNDS PER SQUARE INCH ATMOSPHERE
CP	CIRCULATING PUMP	PSIG	POUNDS PER SQUARE INCH GAUGE
CPVC	CHLORINATED POLYVINYL CHLORIDE	PVC	POLYVINYL CHLORIDE
CU	COPPER	RD	ROOF DRAIN
CW	COLD WATER (DOMESTIC)	RL	RAIN LEADER
D	DRAIN	RO	REVERSE OSMOSIS WATER
DIA	DIAMETER	RPZ	REDUCED PRESSURE ZONE BACKFLOW PREVENTER
DFU	DRAINAGE FIXTURE UNIT	SAN	SANITARY SEWER
DN	DOWN	SMACNA	SHEET METAL AND AIR CONDITIONING CONTRACTORS NATIONAL ASSOCIATION
DPCO	DECK PLATE CLEANOUT	SCFM	STANDARD CUBIC FOOT/MINUTE
DWG	DRAWING	SCW	SOFTENED COLD WATER
DWH	DOMESTIC WATER HEATER	SP	SUMP PUMP
DWV	DRAIN WASTE VENT	SP	SUMP PUMP
EC	ELECTRICAL CONTRACTOR	SOFT	SQUARE FEET
EL	ELEVATION	SS	STAINLESS STEEL
ET	EXPANSION TANK	ST	STORM SEWER
EWC	ELECTRIC WATER COOLER	T&P	TEMPERATURE & PRESSURE (RELIEF VALVE)
EXIST	EXISTING	TD	TRENCH DRAIN
F	FAHRENHEIT	TDH	TOTAL DYNAMIC HEAD
FD	FLOOR DRAIN	TEMP	TEMPERATURE/TEMPORARY
FU	FIXTURE UNITS	TMV	THERMOSTATIC MIXING VALVE
FV	FLUSH VALVE	TP	TRAP PRIMER
G	NATURAL GAS	TSTAT	THERMOSTAT
GAL	GALLON	TW	TEMPERED WATER
GALV	GALVANIZED	TYP	TYPICAL
GC	GENERAL CONTRACTOR	UC	UNDERCUT
GPH	GALLONS PER HOUR	UH	UNIT HEATER
GPM	GALLONS PER MINUTE	UL	UNDERWRITERS LABORATORY
H&CW	HOT AND COLD WATER	UPC	UNIFORM PLUMBING CODE
HB	HOSE BIBB	UR	URINAL
HC	HEATING & HVAC CONTRACTOR	V	VENT
HD	HUB DRAIN	VB	VACUUM BREAKER
HP	HORSEPOWER	VTR	VENT THROUGH ROOF
HS	HAND SINK	WC	WATER CLOSET
HW	HOT WATER (DOMESTIC)	WCO	WALL CLEANOUT
INV	INVERT	WH	WALL HYDRANT
IC	IRRIGATION CONTRACTOR	WHA	WATER HAMMER ARRESTER
		WSFU	WATER SUPPLY FIXTURE UNIT
		XA	EXHAUST AIR

PLUMBING SYMBOLS			
	NEW PIPING AND EQUIPMENT		GAUGE WITH BALL VALVE
	EXISTING TO REMAIN PIPING AND EQUIPMENT		AUTOMATIC AIR VENT
	PIPING AND EQUIPMENT FOR REMOVAL		MANUAL AIR VENT
	BALL VALVE		THERMOMETER
	BALL VALVE (HOSE END & CAP)		BUTTERFLY VALVE
	BALANCING VALVE		PIPE CAP
	CHECK VALVE		END OF LINE CLEAN OUT
	CONTROL VALVE - 2 WAY		HOSE BIBB
	DRAIN VALVE WITH HOSE BIBB		FLOOR DRAIN
	FLANGED CONNECTION		FLOOR DRAIN WITH P-TRAP
	FUSIBLE LINK OIL SHUTOFF VALVE		DECK PLATE CLEAN OUT
	FLOW CONTROL VALVE		GAS OUTLET
	GATE VALVE		WATER HAMMER ARRESTOR
	GLOBE VALVE		WALL HYDRANT
	GAS COCK		VACUUM BREAKER
	LUBRICATED PLUG VALVE		INLINE PUMP
	PRESSURE REDUCING VALVE		WATER METER
	RELIEF VALVE		SUCTION DIFFUSER
	STRAINER WITH BLOWDOWN		FLEXIBLE CONNECTOR
	STRAINER WITH BLOWDOWN		PIPE BREAK
	SOLENOID VALVE		PIPE FLOW ARROW
	THREE-WAY CONTROL VALVE		REVISION/KEYED NOTE
	TRIPLE DUTY GLOBE VALVE		KEYED NOTE
	UNION		KEYED NOTE
	REDUCER OR INCREASER		KEYED NOTE
	BRANCH FROM BOTTOM OF PIPE		POINT OF NEW CONNECTION
	BRANCH FROM TOP OF PIPE		LIMIT OF REMOVAL
	PIPE ELBOW DN		SAW CUT FLOOR
	PIPE ELBOW UP		
	PIPE FLOW ARROW		
	BELOW SLAB PIPING		
	COLD WATER PIPING		
	HOT WATER PIPING		
	HOT WATER RECIRC PIPING		
	INDIRECT WASTE PIPING		
	SANITARY PIPING		
	DRAIN PIPING		
	VENT PIPING		
	NATURAL GAS PIPING		
	SANITARY PIPING (BELOW GRADE)		
	SLEEVE		

GENERAL PLUMBING NOTES:

- DRAWINGS ARE DIAGRAMMATIC AND INDICATE GENERAL ARRANGEMENT OF SYSTEMS AND WORK INCLUDED IN THE CONTRACT. IT IS NOT INTENDED TO SPECIFY OR SHOW EVERY OFFSET, FITTING OR COMPONENT; HOWEVER, CONTRACT DOCUMENTS REQUIRE COMPONENTS AND MATERIALS WHETHER OR NOT INDICATED OR SPECIFICALLY SPECIFIED TO MAKE THE SYSTEMS BEING INSTALLED COMPLETE, CODE COMPLIANT, TESTED AND OPERATIONAL.
- CONTRACTOR SHALL FIELD VERIFY ALL LOCATIONS, DIMENSIONS AND ELEVATIONS PRIOR TO CONSTRUCTION.
- ALL MATERIALS, EQUIPMENT, METHODS OF INSTALLATION, REMOVALS AND DISPOSAL SHALL BE IN ACCORDANCE WITH THE STANDARDS, REGULATIONS, CODES, ORDINANCES, AND LAWS OF LOCAL, STATE, AND FEDERAL GOVERNMENTS, AND OTHER AUTHORITIES THAT HAVE LAWFUL JURISDICTION.
- PERFORM WORK, PROVIDE MATERIALS AND EQUIPMENT FOR SYSTEMS SHOWN, SPECIFIED AND DESCRIBED ON DRAWINGS. COMPLETELY COORDINATE ALL TRADES OF THIS CONTRACT AND PROVIDE COMPLETE AND FULLY FUNCTIONAL INSTALLATION. ALL WORK IN THIS SET TO BE COMPLETED UNDER THIS CONTRACT, UNLESS OTHERWISE INDICATED.
- PROTECT ALL EXISTING AND NEW BUILDING ELEMENTS FROM DAMAGE. CONTRACTOR SHALL RESTORE ALL DAMAGED ELEMENTS TO ORIGINAL OR BETTER CONDITION.
- WORK SHALL BE EXECUTED IN A WORKMANLIKE MANNER AND SHALL PRESENT NEAT, RECTILINEAR APPEARANCE WHEN COMPLETED. MAINTAIN MAXIMUM HEAD ROOM AT ALL TIMES. DO NOT RUN PIPES, DUCTS, AND CONDUIT EXPOSED UNLESS SHOWN AND NOTED TO BE EXPOSED ON DRAWINGS.
- MATERIALS AND EQUIPMENT SHALL BE NEW AND INSTALLED ACCORDING TO MANUFACTURER'S INSTRUCTIONS AND RECOMMENDATIONS. MAINTAIN MANUFACTURER'S EQUIPMENT CLEARANCES.
- CONTRACTOR IS RESPONSIBLE FOR ALL WORK RELATED TO ISOLATING, SHUTTING DOWN, DRAINING, FILLING AND TESTING SYSTEMS TO ALLOW FOR COMPLETION OF WORK. INTERRUPTIONS TO EXISTING SERVICES AND SYSTEMS SHALL BE AS SHORT AS POSSIBLE AND AT A TIME AND DURATION APPROVED BY THE OWNER AND UTILITY AS APPLICABLE. INCLUDE ALL PREMIUM TIME ASSOCIATED WITH INTERRUPTIONS. ALL SYSTEM INTERRUPTIONS SHALL BE SCHEDULED WITH OWNER, UTILITY AND COORDINATED WITH OTHER TRADE WORK.
- ALL EQUIPMENT PIPING, WIRING, INSULATION ETC. INSTALLED IN HVAC AIR PLENUM SPACES SHALL MEET CODE REQUIREMENTS FOR SMOKE AND COMBUSTIBILITY.
- SEAL ALL PENETRATIONS THROUGH FIRE RATED WALLS, PARTITIONS AND FLOORS WITH UL RATED MATERIALS/METHODS EQUIVALENT TO FIRE RATING OF ASSEMBLY.
- PROVIDE PROPER ACCESS TO EQUIPMENT THAT REQUIRES INSPECTION, REPLACEMENT OR REPAIR. ACCESS PANELS/DOORS SHALL BE A MINIMUM OF 12"x12", UNLESS OTHERWISE NOTED.
- DO NOT SUPPORT EQUIPMENT FROM SUSPENDED CEILINGS. ALL SUPPORT SHALL BE FROM BUILDING STRUCTURE OR FROM CEILING SUSPENSION SYSTEM WHICH HAS BEEN REINFORCED. SUPPORTS SHALL BE SELECTED AND INSTALLED TO PROVIDE A VIBRATION FREE INSTALLATION.
- PLUMBING CONTRACTOR IS RESPONSIBLE FOR JETTING/SNAKING ALL SANITARY WASTE LINES (ALL FLOOR DRAINS) SHOWN ON THE DRAWINGS TO BE FULLY OPERATIONAL.
- CLEANING DURING PLUMBING WORK: THE MECHANICAL ROOM AND ROOMS WHERE WORK WILL BE DONE TO MINIMIZE DISTURBANCE IN THE BUILDINGS. WORKERS ARE TO USE PATHWAYS AND FACILITIES AGREED UPON WITH THE DISTRICT DESIGNEE IN WRITING. THE AREA OUTSIDE THE BUILDING WHERE CUTTING, WELDING OR STORAGE IS ALLOWED IS TO BE FENCED AT ALL TIMES. THE CONTRACTOR WILL ON A DAILY BASIS CLEAN THE GROUNDS AND THE BUILDING OF ANY DEBRIS OR GARBAGE GENERATED BY THEIR WORK.
- EACH CONTRACTOR RESPONSIBLE FOR RETURNING WALLS, CEILINGS AND SURFACES THEY DISTURB THAT ARE NOT SCHEDULED FOR REPLACEMENT BACK TO ORIGINAL CONDITIONS.

COORDINATION NOTE:

- COORDINATE WITH ALL CONTRACTORS AND DISTRICT.
- SEE SITE DRAWINGS FOR ADDITIONAL CONTRACTOR WORK AS MARKED.

I, EISENBACH & ROHNKE, ENGINEERS, P.C., CERTIFY THAT THE DESIGNER HAS REVIEWED THE DRAWINGS AND APPROVES THE DESIGN. THE DESIGNER'S SIGNATURE AND DATE MUST BE ON THE SET. ATTACHED TO THE SET IS A COPY OF THE DESIGNER'S CERTIFICATE OF DESIGN REVIEW. THE DESIGNER'S SIGNATURE AND DATE MUST BE ON THE SET. ATTACHED TO THE SET IS A COPY OF THE DESIGNER'S CERTIFICATE OF DESIGN REVIEW.

ENGINEER:



Eisenbach & Rohnke Engineering, P.C.
200 Green Street - Union, NY 10985
Ph: 914-732-1818 Fax: 914-732-1820
www.e-r.com

CONSULTANT(S):



48 KNOLLWOOD ROAD
ELMSFORD NEW YORK 10523
TEL: 914.892.4444
FAX: 914.892.1717
WWW.FULLERDANGELO.COM
Copyright 2009 All Rights Reserved by FULLER & D'ANGELO P.C.

STAMP



WARWICK VALLEY CENTRAL SCHOOL DISTRICT
HIGH SCHOOL RENOVATIONS, FIELD WORK AND
EXTERIOR BATHROOM BUILDING
225 WEST STREET EXT, WARWICK, NY 10990

CBBS SED NO. 44-21-01-06-7-041-001 (BB-FIELD BATHROOM BUILDING) 89 SANGROVILLE ROAD, WARWICK, NY 10990
CUFF SED NO. 44-21-01-06-7-041-001 (FF-W FLOORBALL FIELD) 89 SANGROVILLE ROAD, WARWICK, NY 10990
CDHS SED NO. 44-21-01-06-0-001-040 (GS-W HIGH SCHOOL) 89 SANGROVILLE ROAD, WARWICK, NY 10990

PROJECT NO. 05-21-04
05-20-06

BID SET 04.08.2022

REVISION DATE
DRAWN BY
CHECKED BY
SHEET SIZE 30" x 42"
SCALE AS NOTED

SHEET TITLE
ABBREVIATIONS
AND NOTES

SHEET NO.

P-001

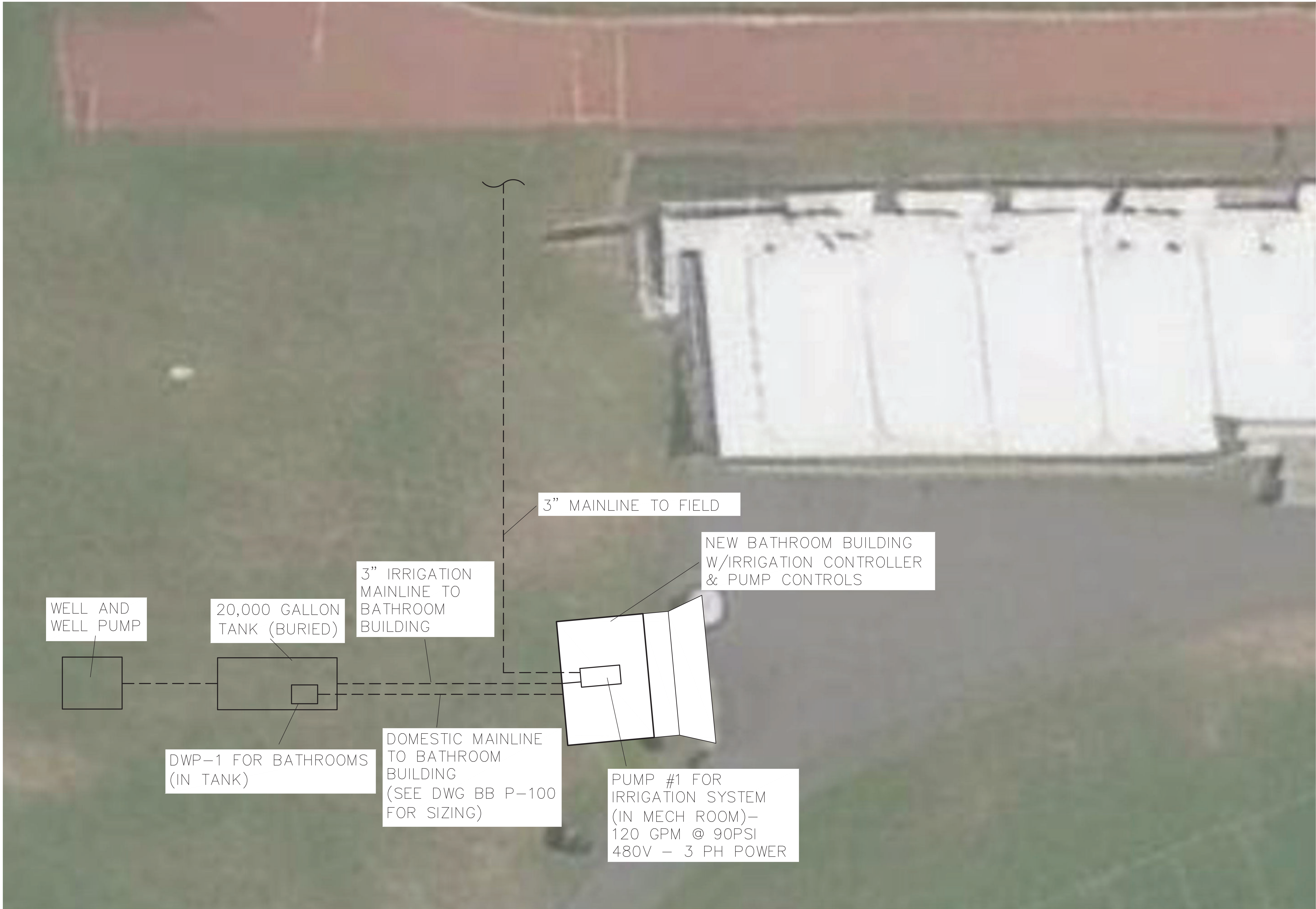

COORDINATION NOTE:

- COORDINATE WITH SITE AND BATHROOM BUILDING DRAWINGS.
- COORDINATE WITH ALL CONTRACTORS AND DISTRICT.

FILE A WARNING OF THE LAW AND ANY PERSON IS FORFEITING THE BENEFIT OF A LICENSED PROFESSIONAL ARCHITECT/PLANNER TO ALTER THIS DRAWING IN ANY MANNER UNLESS THEY HAVE THE SEAL, ATTACHED ALONG WITH A DESCRIPTION OF THE ALTERATION, THE SIGNATURE AND DATE. COPYRIGHT © 2019

ENGINEER:



Eisenbach & Rohrer Engineering P.C.
281 Green Street - Union, NY 10987
Ph: 814-732-1818 Fax: 814-732-6365
www.ebr.com

CONSULTANT(S):



FULLER
D'ANGELO
P.C.



ARCHITECTS
PLANNERS

48 KNOLLWOOD ROAD
ELMBURG NEW YORK 10523
TEL 914.892.4444
FAX 914.892.1717
WWW.FULLERDANGELO.COM
Copyright 2019 All Rights Reserved by FULLER & D'ANGELO P.C.



WARWICK VALLEY CENTRAL SCHOOL DISTRICT
HIGH SCHOOL RENOVATIONS, FIELD WORK AND
EXTERIOR BATHROOM BUILDING
225 WEST STREET EXT, WARWICK, NY 10990

DBB SED NO. 44-21-01-06-7-041-001 (BB-FIELD BATHROOM BUILDING) 89 SANGERVILLE ROAD, WARWICK, NY 10990
FF SED NO. 44-21-01-06-7-041-001 (FF-W FOOTBALL FIELD) 89 SANGERVILLE ROAD, WARWICK, NY 10990
CHS SED NO. 44-21-01-06-0-001-040 (HS-W HIGH SCHOOL) 89 SANGERVILLE ROAD, WARWICK, NY 10990

PROJECT NO.	05-21-04 05-20-06
BD SET	04.08.2022
REVISION	DATE
DRAWN BY	
CHECKED BY	
SHEET SIZE	30" x 42"
SCALE	AS NOTED

PARTIAL SITE PLAN -
NEW WORK

SHEET NO.
FF
P-100

WATERING SCHEDULE

General Notes

IRRIGATION DRAWINGS ARE DIAGNOMATIC. ALL IRRIGATION EQUIPMENT PLACED IN THE FIELD WILL BE APPROVED BY THE OWNER OR ITS REPRESENTATIVE.

CONTRACTOR RESPONSIBLE FOR VERIFICATION OF EQUIPMENT QUANTITY.

DUE TO THE SCALE, ACCURACY OR CONDITION OF SITE PLANS, CONTRACTOR WILL VERIFY PATTERN TO GUARANTEE 100% COVERAGE OF INDICATED AREAS IN CASES WHERE SITE DIMENSIONS CONFLICT WITH DRAWING.

ALL LATERAL PIPE WILL BE 1" UNLESS MARKED.

ALL MAINLINE WILL BE 8" UNLESS MARKED.

ALL SIDEWALK CROSSINGS TO BE SLEEVED.

BACKFLOW AS PER LOCAL CODES.

FLOW RATE IS 110 GPM @ 100 PSI

No.	Revision/Issue	Date
-----	----------------	------

DESIGN SERVICES
PHONE: (914) 347-5656 EXT. 1027
E-MAIL: DESIGN@CENTRALTIS.COM

NEW YORK

**5 NEPPERHAN AVENUE
ELMSFORD, NY. 10523
STORE: (914) 347-5166
FAX: (914) 347-3841
EMAIL: ELMSFORD@CENTRALTIS.COM**

**351 WEST RT. 59
NANUET, NY. 10954
STORE: (845) 356-7000
FAX: (845) 356-7068
EMAIL: NANUET@CENTRALTIS.COM**

**20 MARCONI BLVD
COPIAGUE, NY 11726
STORE: (631) 249-4694
FAX: (631) 249-4696
EMAIL: COPIAGUE@CENTRALTIS.COM**

**502 CENTER AVE.
MAMARONECK, NY 10543
STORE: (914) 381-5520
FAX: (914) 381-5535
EMAIL: MAMARONECK@CENTRALTIS.COM**

**2711 LEXINGTON AVE.
MOHEGAN LAKE, NY 10547
STORE: (914) 743-1818
FAX: (914) 743-1820
EMAIL: MOHEGAN@CENTRALTIS.COM**

**WARWICK HIGH SCHOOL
WARWICK, NY**

Project 15 - Warwick High School		Sheet IR-01
Date 12-07-21		
Drawn by: JP	Checked by: JP	
Scale 1" = 30'-0"		

COORDINATION NOTE:

1. COORDINATE WITH SITE AND BUILDING DRAWINGS.
2. COORDINATE WITH ALL CONTRACTS AND DISTRICT.

STAMP

STATE OF NEW YORK
JACK EISENBACH
LICENSED PROFESSIONAL ENGINEER
No. 059445

WARWICK VALLEY CENTRAL SCHOOL DISTRICT
 HIGH SCHOOL RENOVATIONS, FIELD WORK AND
 EXTERIOR BATHROOM BUILDING
 225 WEST STREET EXT, WARWICK, NY 10900

05-05-21-04 - Nemick Federal Grant Project/CAD/Packaging & Shipping	PROJECT NO.	05-21-04 05-20-06
BID SET		04.08.2022
REVISION		DATE
DRAWN BY		
CHECKED BY		
SHEET SIZE		30" x 42"
SCALE		AS NOTED

**PARTIAL SITE PLAN -
NEW WORK**

SHEET NO.

FF

P-101



ENGINEER:



Erismenbach & Ruhmkö Engineering, P.C.
291 Geneva Street • Union, NJ 07081
Phone: 201-286-1956 Fax: 201-286-4300
www.erngc.com

CONSULTANT:

FULLER
D'ANGELO
P.C.

ARCHITECTS
PLANNERS

8 KNOLLWOOD ROAD
MILFORD NEW YORK 10553
TEL 914.592.4444
FAX 914.592.1717
WWW.FULLERDANGELO.COM

Copyright 2000 All Rights Reserved by FULLER
D'ANGELO P.C.

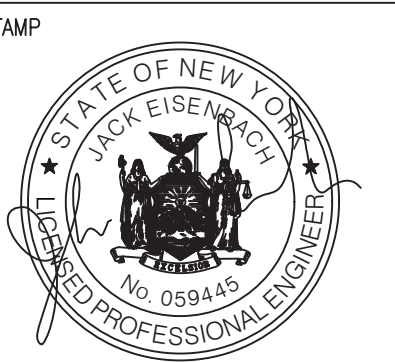

WARWICK VALLEY CENTRAL SCHOOL DISTRICT
HIGH SCHOOL RENOVATIONS, FIELD WORK AND
EXTERIOR BATHROOM BUILDING
225 WEST STREET EXT, WARWICK, NY 10990

☐ SED NO. 44-21-01-06-7-041-001 (FF-IV FOOTBALL FIELD) 89 SANFORDVILLE ROAD, WARWICK, NY 10990
☐ HS SED NO. 44-21-01-06-0-001-040 (HS-IV HIGH SCHOOL) 89 SANFORDVILLE ROAD, WARWICK, NY 10990

PROJECT NO.	05-21-04 05-20-06
NO SET	04.08.2022
REVISION	DATE
DRAWN BY	
CHECKED BY	
SHEET SIZE	30" X 42"
SCALE	AS NOTED
SHEET TITLE	
BATHROOM FLOOR PLAN - NEW WORK	

BB
P-100

FILE PATH -N: \1 - PROJECT DIRECTORIES\1- E & R Projects\05- Warwick Valley CSD\05-21-04 Warwick Federal Grant Project\CAD\Package 2\05-21-04-BBP100.M100.E100.dwg



NOTE: LOCATIONS OF EXISTING EQUIPMENT PROVIDED FOR REFERENCE ONLY

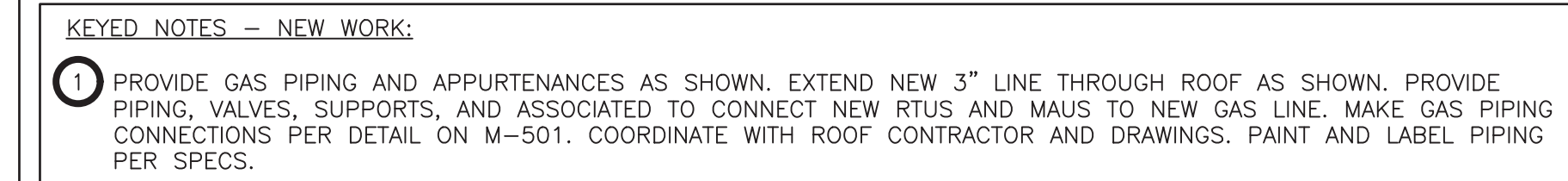

NOTE: LOCATIONS OF EXISTING EQUIPMENT PROVIDED FOR REFERENCE ONLY

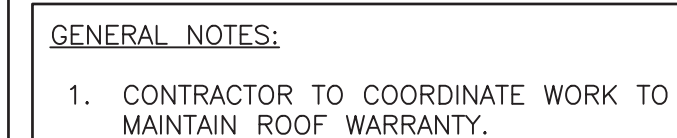

NOTE: MECHANICAL EQUIPMENT SHOWN FOR REFERENCE ONLY. COORDINATE WITH
ROOF DRAWINGS AND MECHANICAL DRAWINGS.

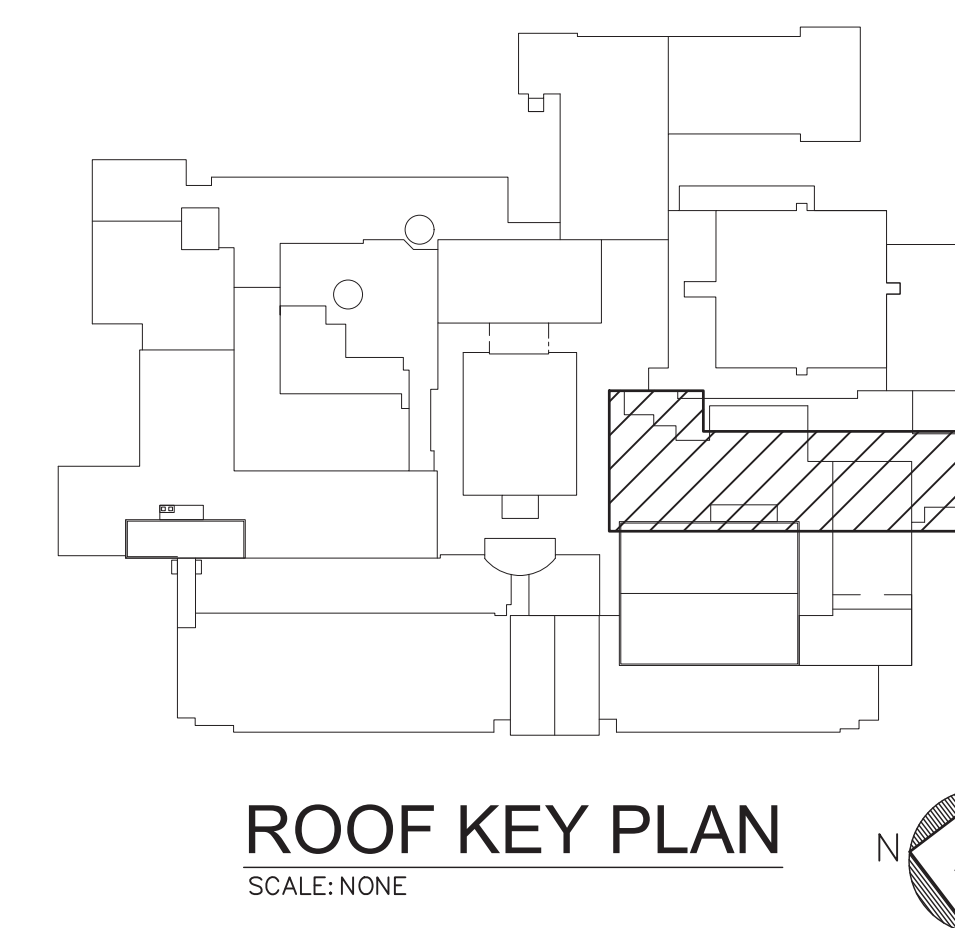

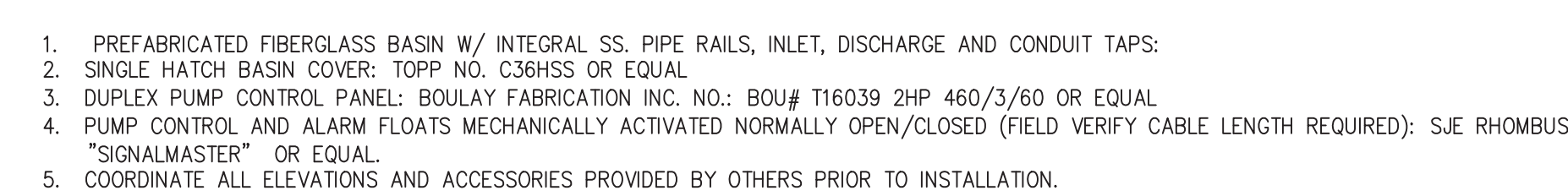

7 SCALE: NONE

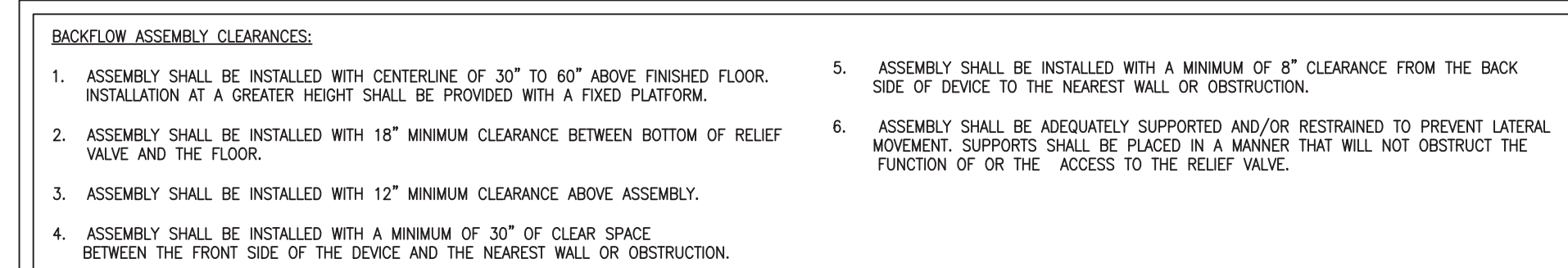

8 SCALE: NONE



ALL INSULATION TO COMPLY WITH 2020 NYS ENERGY CONSERVATION CONSTRUCTION CODE

SIZING DATA BASED ON THE PLUMBING
DRAINAGE STANDARD P.D.I. - WH201.

NOTES:

1. WALL MOUNTED WARE CLOSET AMERICAN STANDARD AFWALL 3351.101 WITH 5901.110 SEAT AND SLOAN FLUSH VALVE RAL 111 ESS-1.6-R--OR--HW
2. WALL MOUNTED URINAL AMERICAN STANDARD WASHROOM 6590.001 WITH SLOAN FLUSH VALVE RAL 186 ESS-1.0--HW
3. WALL HUNG LAVATORY AMERICAN STANDARD 0355.012 R/JR SMITH CARRIER 0700, MCGUIRE 2167--LK--F AND MCGUIRE 8917--LK--F AMERICAN STANDARD 605.001, PKO#H&K, 505X1M1070 HARD WIRED AC MULTI AC
4. PROVIDE STAINLESS STEEL FLEXIBLE SUPPLIES, C/W/H BRASS/CART 51-A AND SHUT OFF VALVES V/ REMOVABLE HANDLES. LAV GARD BY ARCHITECT
5. FLOOR DRAIN MODEL JR SMITH 2101C-A WITH TRAP SEAL BY PREVENT SYSTEMS OR APPROVED EQUAL.
6. PROVIDE CLEANOUT JR SMITH MODEL 4020 OR APPROVED EQUAL.
7. PLUMBING FIXTURES TO BE PROVIDED WITH SHUT-OFF VALVES AS SPECIFIED
7. INSTALL ALL CARRIERS PER MANUFACTURER RECOMMENDATIONS. COORDINATE WITH ARCHITECTURAL DRAWINGS FOR CARRIER HEIGHTS.
8. PROVIDE MOP BASIN FIAT M5B-3636 WITH FIAT 830-AA. PROVIDE MOP BRACKET 889-CC, VINYL GUARDS E-77-AA AND HOSE BRACKET 832-AA OR APPROVED EQUAL.
9. PROVIDE ELKAY MODEL LK4409BF -- BLACK OR APPROVED EQUAL.
10. PROVIDE JR SMITH HOSE BIBB 585(H-X) WITH REMOVABLE HANDLE OR APPROVED EQUAL.

Diagram illustrating the cross-section of a trench for a foreign pipe or structure. The layers shown are:

- ELECTRICAL CONDUIT
- INSULATION SPACER (SEE DETAIL NOTE A)
- TRENCH
- FINAL GRADE
- 1 LAYER OF PLASTIC MESH ROCKSHIELD
- FOREIGN PIPE OR STRUCTURE

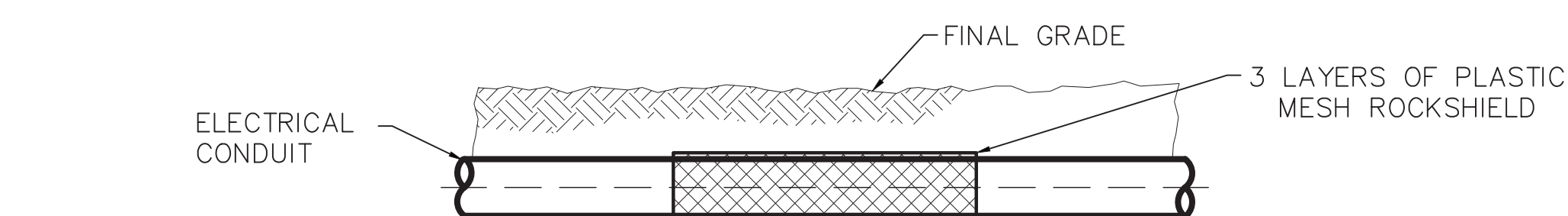
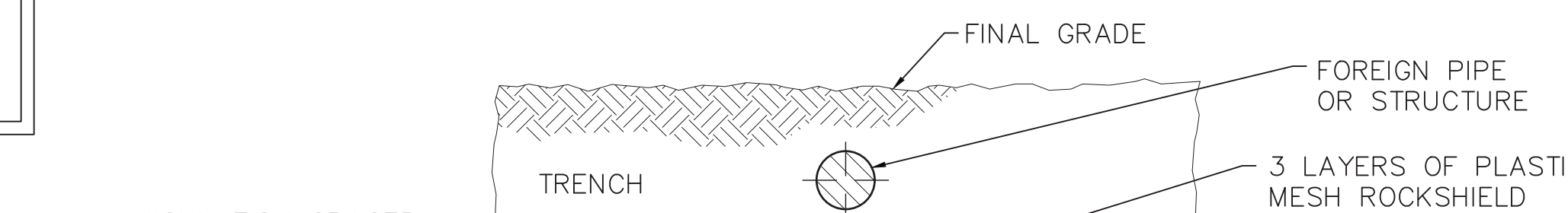

- DETAIL NOTES:
- A. A INSULATIONSPACER SHALL BE INSTALLED BETWEEN METALIC WATER/SEWER PIPE TO PREVENT ELECTRICAL CONTACT WITH THE SUBSURFACE STRUCTURE.
- B. REFER TO SPECIFICATIONS FOR ADDITIONAL REQUIREMENTS.

10 GAS FILL
SCALE: NONE

